

V:\BAKU\US-B\AKO\SWP\p\p\dwg\Create PH file\new\CSWP-P-75\color\pjt
Plot File by: luyang 2025/9/15
PATH P:\PROJECTS\60672559\DRAWING\REPORT\23\23R23_151.dgn

ISO A1 594mm x 841mm
Approved:
Checked:
Designer:
Project Management Initials:

ASR ID	DESCRIPTION	LAND USE (1)	ASSESSMENT HEIGHT (mAG)
A1	YAU MEI SAN TSUEN	R	1.5 - 10
A2	LA MAISON VINEYARD	R	1.5 - 10
A3	LA MAISON VINEYARD	R	1.5 - 10
A4	WAI TSAI TSUEN	R	1.5 - 10
A5	WAI TSAI TSUEN	R	1.5 - 10
A6	ELEGANT PARK	R	1.5 - 10
A7	WAI TSAI TSUEN	R	1.5 - 10
A8	THE VINEYARD	R	1.5 - 10
A9	THE VINEYARD	R	1.5 - 10
A10	GREENACRES VILLA	R	1.5 - 15
A27	SHEUNG CHUK YUEN	R	1.5 - 10
A28	SHEUNG CHUK YUEN	R	1.5 - 10
A29	SHEUNG CHUK YUEN	R	1.5 - 10
A41	TAI YUEN VILLA	R	1.5 - 10
A42	TAI YUEN VILLA	R	1.5 - 10
A45	CHUK YUEN TSUEN	R	1.5 - 10
A46	CHUK YUEN TSUEN	R	1.5 - 10
A47	PALM SPRINGS	R	1.5 - 10
A48	PALM SPRINGS	R	1.5 - 10
A49	MAPLE GARDENS	R	1.5 - 10
A50	CASA PARADIZO	R	1.5 - 10
A51	GREEN CREST	R	1.5 - 10
A52	LA GRANDE VINEYARD	R	1.5 - 10
P1	PROPOSED SCHOOL	E	1.5 - 40
P2	PROPOSED SCHOOL	E	1.5 - 40
P3	PROPOSED SCHOOL	E	1.5 - 40
P4	PROPOSED SCHOOL	E	1.5 - 40
P5	PROPOSED SCHOOL	E	1.5 - 40
P6	PROPOSED SCHOOL	E	1.5 - 40
P7	PROPOSED SCHOOL	E	1.5 - 40
P8	PROPOSED SCHOOL	E	1.5 - 40
P9	PROPOSED SCHOOL	E	1.5 - 40
P10	PROPOSED SCHOOL	E	1.5 - 40
P11	PROPOSED SCHOOL	E	1.5 - 40
P12	PROPOSED RESIDENTIAL	R	1.5 - 180
P13	PROPOSED RESIDENTIAL	R	1.5 - 180
P14	PROPOSED RESIDENTIAL	R	1.5 - 180
P15	PROPOSED RESIDENTIAL	R	1.5 - 180
P16	PROPOSED RESIDENTIAL	R	1.5 - 180
P17	PROPOSED RESIDENTIAL	R	1.5 - 180
P18	PROPOSED RESIDENTIAL	R	1.5 - 180
P19	PROPOSED RESIDENTIAL	R	1.5 - 180
P20	PROPOSED RESIDENTIAL	R	1.5 - 180
P21	PROPOSED RESIDENTIAL	R	1.5 - 180
P22	PROPOSED RESIDENTIAL	R	1.5 - 180
P23	PROPOSED RESIDENTIAL	R	1.5 - 180
P24	PROPOSED RESIDENTIAL	R	1.5 - 180
P25	PROPOSED RESIDENTIAL	R	1.5 - 180
P26	PROPOSED RESIDENTIAL	R	1.5 - 180
P27	PROPOSED RESIDENTIAL	R	1.5 - 180
P28	PROPOSED RESIDENTIAL	R	1.5 - 200
P29	PROPOSED RESIDENTIAL	R	1.5 - 200
P31	PROPOSED RESIDENTIAL	R	1.5 - 200
P32	PROPOSED RESIDENTIAL	R	1.5 - 200
P33	PROPOSED RESIDENTIAL	R	1.5 - 200
P34	PROPOSED RESIDENTIAL	R	1.5 - 200
P35	PROPOSED RESIDENTIAL	R	1.5 - 180
P52	PROPOSED RESIDENTIAL DEVELOPMENT ATOP NGAU TAM MEI DEPOT	R/C	1.5 - 200
P57	PROPOSED RESIDENTIAL	R	1.5 - 180
P58	PROPOSED RESIDENTIAL	R	1.5 - 180
P59	PROPOSED RESIDENTIAL	R	1.5 - 180
P71	PROPOSED UNITOWN	E	1.5 - 100
P72	PROPOSED UNITOWN	E	1.5 - 100
P79	PROPOSED UNITOWN	E	1.5 - 100
P178	PROPOSED G1C	G/1C	1.5 - 15
P179	PROPOSED G1C	G/1C	1.5 - 15
P180	PROPOSED G1C	G/1C	1.5 - 15
P181	PROPOSED G1C	G/1C	1.5 - 15

REMARK:
1. E - EDUCATION, G/1C - GOVERNMENT, INSTITUTION OR COMMUNITY,
R - RESIDENTIAL, R/C - RESIDENTIAL/COMMERCIAL

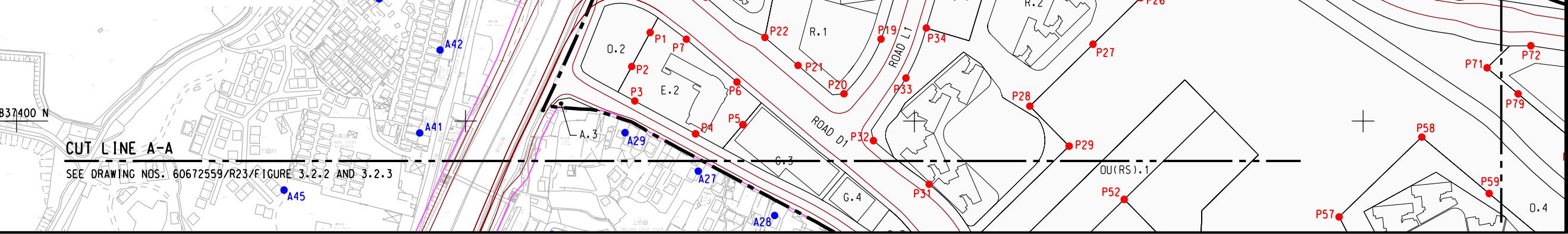

AECOM

PROJECT

LAND USE REVIEW STUDY
FOR NGAU TAM MEI AREA
- FEASIBILITY STUDY

CLIENT

CEDD 土木工程拓展署
Civil Engineering and
Development Department

規劃署
Planning Department

CONSULTANT

AECOM Asia Company Ltd.
www.aecom.com

SUB-CONSULTANTS

ISSUE/REVISION

NO.	DATE	DESCRIPTION	CHK.

I/R 修改 日期 内容描述 校核

STATUS

修改

SCALE DIMENSION UNIT

A3 1: 4000 METRES

KEY PLAN A3 1: 160000

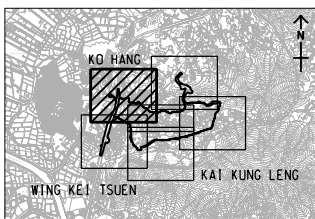

PROJECT NO.

项目编号

60672559

AGREEMENT NO.

协议编号

CE 33/2021

SHEET TITLE

图则名称

LOCATIONS OF REPRESENTATIVE
AIR SENSITIVE RECEIVERS

SHEET NUMBER

图则编号

60672559/R23/FIGURE 3.2.1

SHEET 1 OF 6