

PLANT SCHEDULE:

Key	Botanical Name	Qty.	Size (Ht x Spd)	Remarks
PLANTING - NO SHADE				
Trees				
T1	Albizia lebbek	1	Heavy Standard	
T2	Albizia lebbek	1	Standard	
T3	Alseodaphne moluccana	8	Heavy Standard	
T4	Alseodaphne montana	1	Standard	
T5	Bauhinia bickena	6	Heavy Standard	
T6	Bauhinia bickena	1	Standard	
T7	Bauhinia bickena	1	Standard	
T8	Bombax malabaricum	13	Heavy Standard	
T9	Bombax malabaricum	1	Standard	
T10	Calistemon rigida	7	Heavy Standard	
T11	Celtis sinensis	4	Heavy Standard	
T12	Celtis sinensis	1	Standard	
T13	Cinnamomum camphora	5	Heavy Standard	
T14	Dalmanis regis	6	Heavy Standard	
T15	Dalmanis regis	1	Standard	
T16	Ficus elastica	6	Heavy Standard	
T17	Ficus microcarpa	1	Heavy Standard	
T18	Ficus microcarpa	1	Standard	
T19	Lagerstroemia speciosa	10	Heavy Standard	
T20	Lagerstroemia speciosa	1	Standard	
T21	Ficus virens	1	Heavy Standard	
T22	Hibiscus boscus	1	Heavy Standard	
T23	Hibiscus boscus	1	Standard	
T24	Macaranga tanarius	1	Heavy Standard	
T25	Macaranga tanarius	1	Standard	
T26	Melaleuca leucodendron	7	Heavy Standard	
T27	Melaleuca leucodendron	1	Standard	
T28	Michelia alba	8	Heavy Standard	
T29	Michelia alba	1	Standard	
T30	Tristania conferta	1	Heavy Standard	
T31	Tristania conferta	1	Standard	
Palms				
P1	Archontophoenix alexandreae	23	Trunk 3000 Ht	
P2	Livistonia chinensis	17	Trunk 2000 Ht	
P3	Phoenix roebelenii	10	Trunk 1500 Ht	
Shrubs				
S1	Bauhinia speciosa	1984	600 x 400	400 o.c.
S2	Bauhinia speciosa	2056	450 x 400	400 o.c.
S3	Rhododendron simsii	1556	300 x 300	400 o.c.
S4	Rapidochloa chinensis	1	600 x 400	400 o.c.
S5	Alphitonia speciosa	1	700 x 500	450 o.c.
S6	Calliandra haematocephala	1847	350 x 300	400 o.c.
S7	Calliandra haematocephala	147	750 x 600	450 o.c.
S8	Calliandra haematocephala	1	600 x 400	450 o.c.
S9	Calliandra haematocephala	1	600 x 400	450 o.c.
S10	Calliandra haematocephala	1	600 x 400	450 o.c.
S11	Calliandra haematocephala	1	600 x 400	450 o.c.
S12	Calliandra haematocephala	1	600 x 400	450 o.c.
S13	Calliandra haematocephala	1	600 x 400	450 o.c.
S14	Calliandra haematocephala	1	600 x 400	450 o.c.
S15	Calliandra haematocephala	1611	750 x 600	500 o.c.
Ground Covers				
G1	Calceolaria pumilus	1061	350 x 300	300 o.c.
G2	Lantana montevidensis	1	300 x 300	300 o.c.
G3	Ophopogon japonicus	1	300 x 300	300 o.c.
PLANTING UNDER STRUCTURES				
Palms				
P4	Carota mitis	1	Trunk 1200 Ht	
P5	Carota mitis	1	Trunk 2000 Ht	
P6	Chrysalidocarpus fulvescens	1	Trunk 3000 Ht	
P7	Rapis excelsa	1	1000 x 800	700 o.c.
Shrubs				
S16	Melicope oraria	1	600 x 500	450 o.c.
S17	Dracaena marginata	1	900 x 750	700 o.c.
S18	Philodendron bipinnatifidum	1	900 x 750	700 o.c.
S19	Polka-dot plant	1	900 x 500	500 o.c.
S20	Schefflera arboricola	1	500 x 500	500 o.c.
S21	Schefflera arboricola	1	2000 x 1000	2000 o.c.
Ground Covers				
G4	Spodiopogon sibiricus	1	300 x 250	250 o.c.
G5	Syntherisma chinensis	1	300 x 300	300 o.c.
G6	Syntherisma chinensis	1	300 x 300	300 o.c.
G7	Hymenocallis americana	1	300 x 300	300 o.c.

NOTE: PLANT SCHEDULE FOR THIS DRAWING ONLY.

- LEGEND:
- ⊕ New Tree Planting
 - ⊙ Tree Specimens to be Retained
 - ⊗ Proposed Location for Transplanted Tree
 - ⊖ Shrub Planting
 - Water Point
 - Contract boundary
 - * Climber for Sensitive Areas under the bridge (each symbol represents 1 no. of Parthenocissus himalayana)
 - ⊖ Other Mitigation Areas (e.g. OM-1)

TRANSPLANTED PLANTS LIST:

Key	Botanical Name	Plants No.
AA	Aischrotophone alexandreae	731
AM	Alseodaphne moluccana	163, 387, 430, 688, 702, 203, 204, 1016, 1018
BB	Bauhinia bickena	218, 220, 230
BP	Bauhinia purpurea	1053, 1056, 1057, 1059
BT	Bauhinia striolata	83, 84, 318, 317, 318, 316, 422, 423
CA	Choreospandax axillaris	924
CB	Cinnamomum burmanni	607, 608, 614, 616, 617
CC	Cinnamomum camphora	112, 113, 114, 115, 116, 124, 125
CS	Celtis sinensis	70, 593, 504
DR	Dalmanis regis	83, 181, 242, 434, 504, 128, 123, 127
ES	Erythrina speciosa	400, 413, 414, 287
FM	Ficus microcarpa	245, 246, 247, 810, 721, 897, 740, 743, 744, 745
GM	Gossampinus malabaricum	344, 355, 359, 363
GR	Grevillea robusta	295
LC	Lich chinensis	680
LV	Livistonia chinensis	807 to 859
MA	Michelia alba	950
ML	Melaleuca leucodendron	20, 22, 24, 25, 85, 88, 89, 150, 211, 428
PI	Parthenocissus indica	123
SJ	Syzygium jambu	568, 569, 560, 561, 562
SS	Samantha saman	712 to 720, 726
Hyt	Hydrocotyle area	

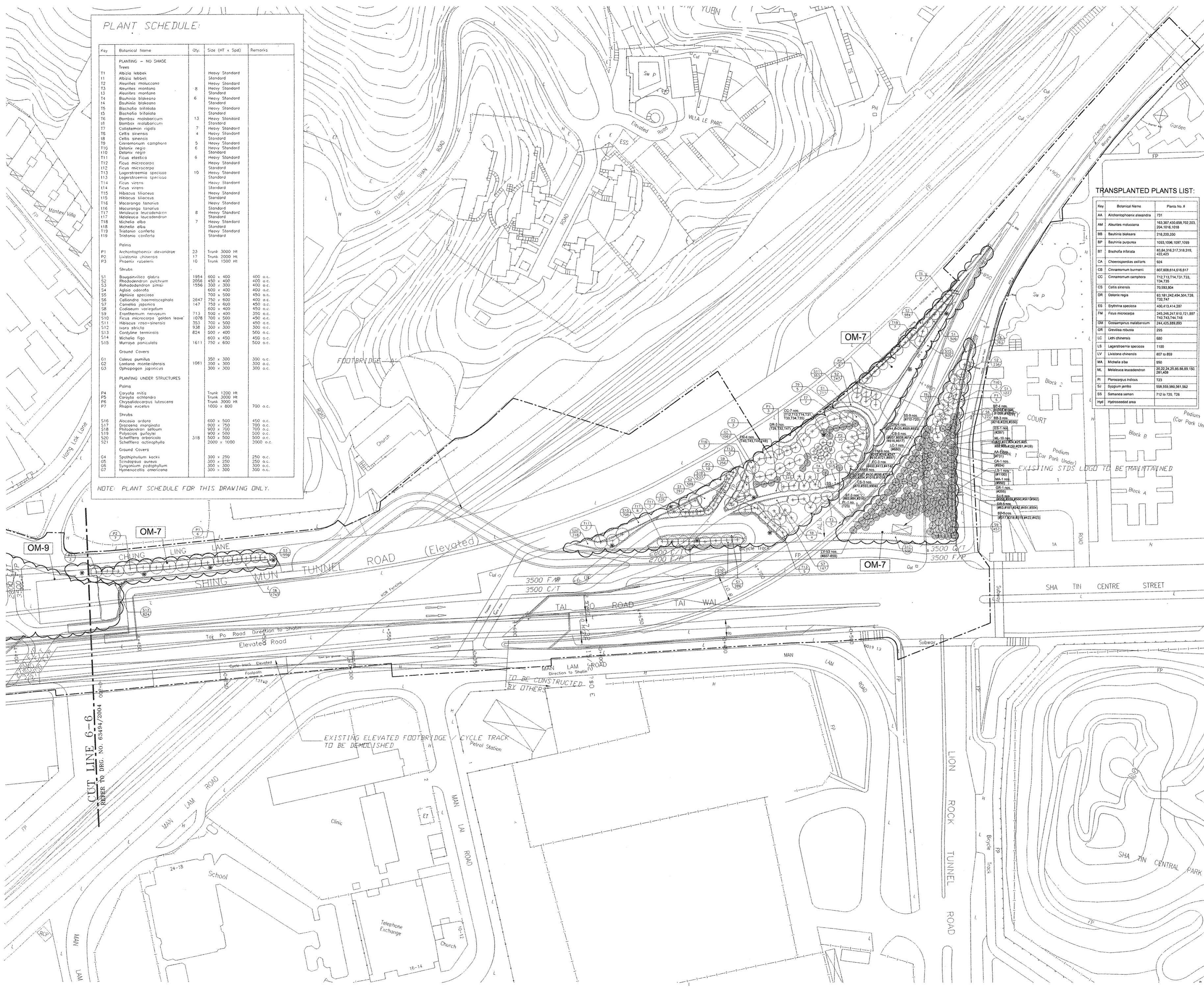

REV	DESCRIPTION	DATE
F	TRANSPLANTED TREE LOCATIONS REVIEWED	17/2
G	EXTENT OF 'OM' AREAS ADDED	18/2

Territory Development Department 拓 展 署
 NT EAST DEVELOPMENT OFFICE
 新 界 東 拓 展 處

SHA TIN NEW TOWN, STAGE II
 ROAD T3 AND ASSOCIATED ROADWORKS
PLANTING PLAN SHEET 6 OF 7

TEAM 73 HK
 LANDSCAPE ARCHITECTS & ENVIRONMENTAL PLANNERS
 地 利 環 境 園 藝 師 事 務 所

MAUNSELL CONSULTANTS ASIA LTD.
 茂 盛 亞 洲 工 程 師 有 限 公 司

DRG. NO. PR/63494/2005
 圖 紙 號 碼

DESIGNED BY TEAM 73 HK
 繪 圖 師

CONTRACT NO. ST 79/02
 合約 號 數

DATE OF ISSUE 12/10/05
 發 出 日 期

SCALE 1:1000
 縮 尺

STATUS PRELIMINARY
 圖 樣

DIMENSIONS ARE IN METRES
 尺 寸 單 位 為 米

COPYRIGHT RESERVED
 版 權 所 有