

LEGEND:

	20mm THK PEBBLE WASHED COLOR: BEIGE		PLANTING AREA		WATER POINT
	300x300x20mm THK NATURAL GRANITE TILES COLOR: STORMY ASH		70mm THK PLAY CUSHION SAFETY MATT COLOR AS SPECIFIED		
	300x300x20mm THK NATURAL GRANITE TILES BORDER COLOR: WESTERN CEDAR		BRIDGE COLUMN		

NOTES:

- THIS DRAWING SHALL BE READ IN CONJUNCTION WITH DRG. 63494/1033
- FOR GENERAL NOTES, REFER TO DRG NO. 63494/2101
- FOR LOCATIONS OF WATER POINT REFER TO DRG. 63494/2001 AND DRG. 63494/2101

Description	Description	Material Type	Size	Colour	Finish	Remarks
Chik Wan Street Playground						
Pathway Area/ Footpath	Main Paving	Pebble Washed	6-10mm ϕ 20mm thk	Beige/Stormy Ash/ Western Cedar	Pebble Washed/ Concrete Flamed	
Stairs	Main Paving	Natural Granite Tiles	300 x 300 x 20mm thk	Stormy Ash	Flamed	
Planter	Wall	Natural Granite Tiles	100 x 100 x 20mm thk	Beige	Honed	
Sitting Area	Bench	Artificial Granite Tiles	100 x 100 x 18mm thk	Beige	Honed Concrete	Pre-Cast
Chess Area		Concrete			Terrazzo	
	Chess Board	Mosaic Tile	50mm ²	Green	Terrazzo Un glazed	
Pavilion	Dome	Galvanized Steel		Green	Curved Polycarbonate	
	Post	Tubular Hollow Steel	100mm ϕ x 4			
	Beam	Galvanized Steel	203 x 133mm	Green		
Trellis	Sphere	Copper	200mm ϕ	Copper		
	Pedestal	Concrete	300mm ϕ		Concrete	
Children's Play Area	Concrete Column	Textured Concrete	300mm ϕ	Green	Emulsion Paint Natural Finish Oil Stain	
	Purlin Beam	Timber	65 x 140mm 65 x 180mm	Canadian White Cedar	Natural Finish Oil Stain	
Along Pathway	Safety Matting	Play Cushion	70mm thk			
	Railing	Tubular Hollow Steel Square Steel Bar	40 x 400mm ϕ 20 x 20mm ϕ	Green Beige	Paint Paint	

MATERIAL SCHEDULE

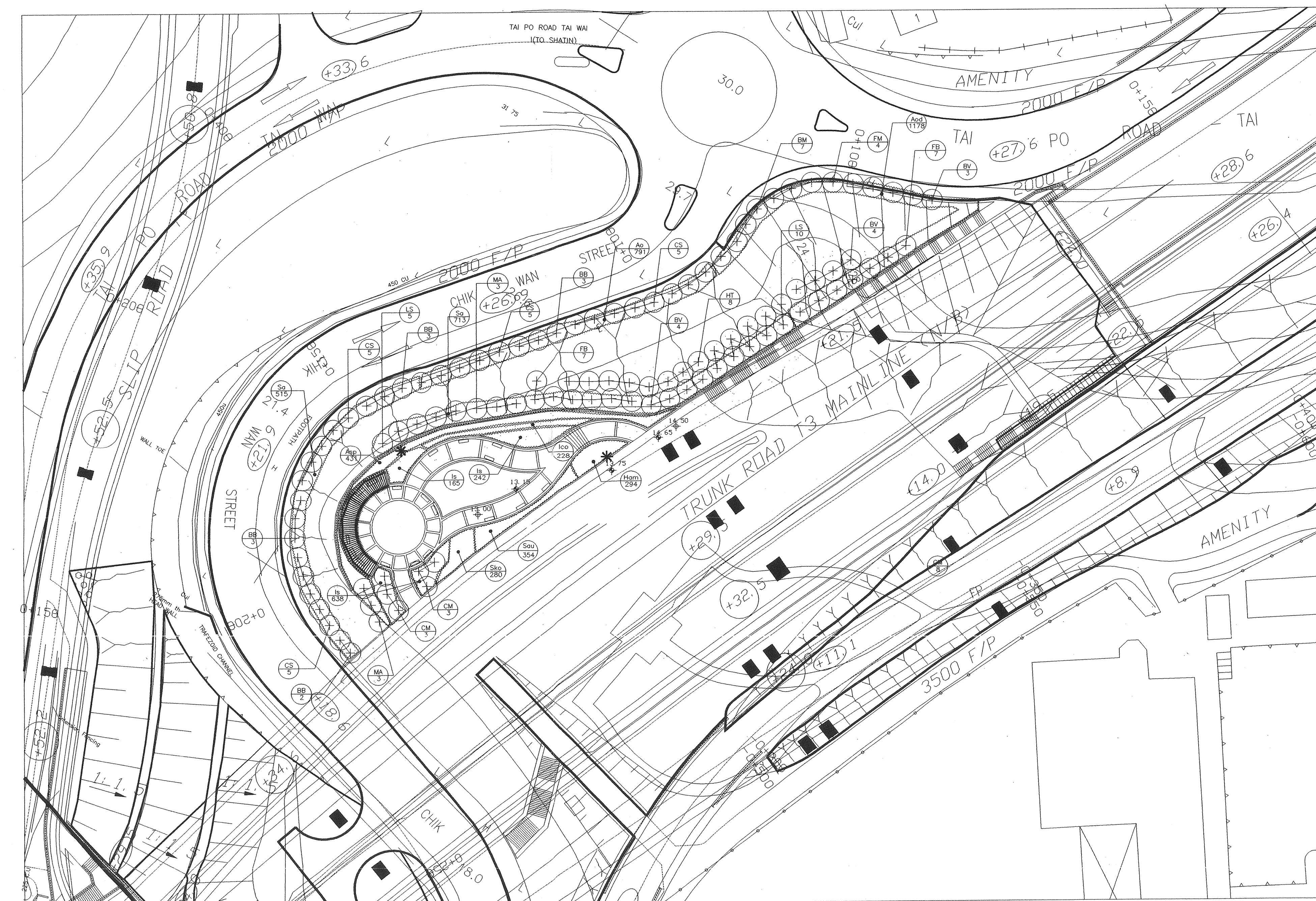

Plant Schedule

Key	Botanical Name	Chinese Name	Qty	Size (Ht x Spd)	Remarks
Trees					
BB	Bauhinia blakeana	羊蹄甲	8	Heavy Standard	
BV	Bauhinia variegata	羊蹄甲	11	Heavy Standard	
BM	Bombax malabaricum	木棉	7	Heavy Standard	
CS	Cassia surattensis	黃槐	20	Heavy Standard	
FB	Ficus benjamina	菩提	14	Extra Heavy Standard	
FM	Ficus microcarpa	細葉榕	4	Standard	
HT	Hibiscus tiliaceus	黃槿	8	Heavy Standard	
LS	Lagerstroemia speciosa	大紫荊	15	Extra Heavy Standard	
MA	Michelia alba	白蘭	6	Extra Heavy Standard	
Palms					
CM	Caryota mitis	魚尾葵	6	2500 Ht	
Shrubs					
Ao	Alocasia odora	海芋	731	600 x 400	400 o.c.
Aol	Azalea odorata	紫荊	1178	600 x 400	400 o.c.
Asp	Alphitonia speciosa	欖山藤	431	700 x 500	450 o.c.
Ico	Ixora coccinea	燈籠樹	228	300 x 300	300 o.c.
Is	Ixora stricta	紅珊瑚	1045	300 x 300	300 o.c.
Sa	Schefflera arboricola	鴨腳木	1228	750 x 500	500 o.c.
Groundcovers					
Han	Hymenocallis americana	雙瓣蘭	294	300 x 300	300 o.c.
Sau	Scindapsus aureus	綠蘿	354	100 x 300	300 o.c.
Sko	Spahiphullum kochii	白掌	280	300 x 300	300 o.c.

A	GENERAL REVISION	T73	RNG	OCT 02
-	FIRST ISSUE	T73	PCA	RJG
REV.	DESCRIPTION	D.E.	P.E.	APPROVED
BY	內務編製	審核	核准	日期

Territory Development Department 拓展署
NT EAST DEVELOPMENT OFFICE
新界東拓展署

SHA TIN NEW TOWN, STAGE II
ROAD T3 AND ASSOCIATED ROADWORKS
CHIK WAN STREET REST GARDEN
PLANTING AND MATERIAL PLAN

TEAM 73 HK
ENVIRONMENTAL PLANNERS
地科環境顧問事務所

MAUNSELL CONSULTANTS ASIA LTD.
茂盛亞洲工程顧問有限公司

DRG. NO. 63494/2102^A
圖紙編號

DESIGNED BY	CONTRACT NO.	DATE OF ISSUE
設計	合約編號	發出日期
TEAM 73 HK	S179/02	

DRAWN BY
繪圖
GS

STATUS
階段
Preliminary Drawing

SCALE
比例
1:400

DIMENSIONS ARE IN
尺寸單位
MILLIMETER

© COPYRIGHT RESERVED
版權所有

Maunsell