

PROJECT NO.: TCS/00408/08

**DSD CONTRACT NO. DC/2007/17
DRAINAGE IMPROVEMENT WORKS IN CHEUNG PO,
MA ON KONG, YUEN KONG SAN TSUEN AND TIN SAM
TSUEN OF YUEN LONG DISTRICT AND SEWERAGE AT
TSENG TAU CHUNG TSUEN, TUEN MUN**

**BASELINE ECOLOGICAL MONITORING REPORT
- KT13**

PREPARED FOR
CHINA ROAD & BRIDGE CORPORATION

Quality Index

Date	Reference No.	Prepared By	Certified By
28 August 08	TCS00408/08/600/R072 (EcoR)	Vincent Lai (Environmental Team's Ecologist)	F.N. Wong (Environmental Team Leader)



Rev.	Date	Prepared by:	Certified by:	Description
0	28 April 08	Vincent Lai	F.N. Wong	First Submission
1	22 May 08	Vincent Lai	F.N. Wong	Ammended against IEC's comments
2	6 July 08	Vincent Lai	F.N. Wong	Ammended against IEC's comments
3	16 July 08	Vincent Lai	F.N. Wong	Ammended against AECD's comments
4	28 August 08	Vincent Lai	F.N. Wong	Updated with the tree survey report in Annex A

**DSD Contract No. DC/2007/17 – Drainage Improvement Works
in Cheung Po, Ma On Kong, Yuen Kong San Tsuen and Tin Sam Tsuen of Yuen Long District and Sewerage at Tseng Tau Chung Tsuen, Tuen Mun**

Response to AFCD's Comments on the KT13 Ecological Baseline Monitoring Report Dated 14 July 2008

AFCD's Comments	ET's Response
Responses to comments (f) & Report for special survey	
According to the findings of the "Reports on Egretty Counts in Hong Kong with Particular Reference to the Mai Po Deep Bay Ramsar Site" conducted by our contractor, records of Chinese Pond Heron has been made since April 2008. The consultants are advised to make effort to ensure accuracy of ecological baseline information collected. Reference should also be made to any updated information available during the literature review.	Noted. Reference will be made to any updated information available during the literature review. We would like to request a copy of the mentioned literature (Reports for 2008) and any further reports for reference.
Any egretty surveys conducted from 1 March 2008 to 31 May 2008 should be included in the Baseline Ecological Monitoring Report and the application of the Construction Works.	The report for special survey has been included in the Baseline Ecological Monitoring Report and the application of the Construction Works.
Report for special survey	
Session 1, Introduction: Results of egretty survey together with the ecological baseline survey should be confirmed with EPD and AFCD before a decision on commencement of any construction activities is made.	Noted. Confirmation from EPD and AFCD will be sought before a decision on commencement of any construction activities is made.
Session 3, Results: Nesting colonies of egrets with the presence of incubating adults/chicks were comparatively inactive regardless of the weather condition. For egrettries built inside dense foliage, landing location and any breeding behavior of egrets should be recorded	Noted. Landing locations will be used as the indicator of nests. Breeding behaviors will also be observed.
Session 4, Conclusion: The consultants should be reminded that if egret nest are found during the period from 1 March 2008 to 31 August 2008, no construction shall take place within the 100m of the Ecological Buffer Area before 1 October 2008.	Noted. If egret nest are found at Ho Pui Egretty during 1 March to 31 August, no construction will be conducted within the 100m Ecological Buffer Area before 1 October of the same year.
Ecological Baseline Monitoring Report	
The wordings "Though no t required by the EM&A Manual "should be deleted.	Noted. Text has been amended.
It is mentioned that "given the fluctuating nature of egrettries...the breeding egret number in the coming year will significantly decrease due to intrinsic factors...even no disturbance impact is caused by the construction works." The contractor should however take into account the continuous record of active egrettries in Ma On Kong in recent years when studying the impact assessment.	Noted. The recent records in Ma On Kong egretty will be taken into account.

END OF TEXT

TABLE OF CONTENT

- 1 INTRODUCTION**
- 2 Methodology for Establishing Ecological Baseline**
- 3 BASELINE MONITORING RESULTS**
- 4 CONCLUSION**

ANNEXES

- Annex A Tree Survey Report**
- Annex B Photographic Records**
- Annex C Egretty Photos**
- Annex D Habitat Map**
- Annex E Report for Special Survey on Ho Pui Egretty**

1. INTRODUCTION

1.1. Project Background

- 1.1.1. The proposed project involves channelisation works at Tai Kek and Hoi Pui of Pat Heung. Ecological mitigation measures including gabion banks and natural substrates as stream bed materials in the affected stream section would be adopted to allow the reestablishment of riparian and stream ecosystems. Chain link fence along the boundary of the CA zone and Ho Pui egretry will be provided, and disturbances to these areas would be strictly avoided.
- 1.1.2. An ecological monitoring programme would also be provided for the proposed project. The objectives of the ecological monitoring programme include the following:
- To verify the accuracy of the impact predictions;
 - To check if the recommended mitigation measures are fully implemented;
 - To examine the effectiveness of the recommended mitigation measures;
 - To check whether the residual impacts comply with the relevant ecological requirements; and
 - To recommend timely action plans to rectify any unacceptable impacts.
- 1.1.3. The ecological monitoring programme consists of a baseline monitoring which should be undertaken prior to the commencement of construction works and aims at to confirm the pre-works ecological conditions with reference to the habitat maps in the ES report, construction phase monitoring and audit which aims at verifying the accuracy of the impact prediction and implementation of mitigation measures, and operation phase monitoring which aims at verifying the establishment of the riparian vegetation and the re-colonization of aquatic fauna.
- 1.1.4. As required in the EM&A Manual, the ecological baseline monitoring should be agreed with Agriculture, Fisheries and Conservation Department (AFCD). Baseline Monitoring proposals and schedules had been submitted to the RE for approval and copied to the Agriculture, Fisheries and Conservation Department (AFCD) for comment. This paper describes the results of the baseline monitoring.
- 1.1.5. Government legislations and guidelines relevant to the consideration of ecology of this study include the following:
- Forests and Countryside Ordinance (Cap.96) and its subsidiary legislation the Forestry Regulations;
 - Wild Animals Protection Ordinance (Cap.170);

2. METHODOLOGY

2.1. Study Area

- 2.1.1. The monitoring areas for the ecological monitoring programme for KT13 would cover 60m on either side of the existing channel as well as the proposed bypass culvert, as shown in Figure 6.1 of the EM&A Manual. In addition, Ma On Kong egretty which is outside the survey area would also be monitored to identify any adverse effects on the breeding egrets.

2.2. Field survey for establishing ecological baseline

- 2.2.1. The baseline monitoring was performed within the monitored areas shown in Figure 6.1 of the EM&A Manual. The monitoring areas for the KT13 ecological monitoring programme were walked through. The conditions of the study areas were compared with the conditions described in the EIA study. Attention was paid to any changes which have taken place after the EIA study, and have the potentials to cause impacts on faunal numbers, diversity and distribution. The presence of any rare or protected species, if any, was also recorded.
- 2.2.2. During the habitat verification surveys, the compositions of habitat types and their boundaries were checked and compared with the habitat map presented in the EIA report. Colour photographs of habitats were taken. In accordance with findings of the verification survey, an updated habitat map would be prepared if needed.
- 2.2.3. Vegetation photographic records covering individual trees (where these are isolated from other trees) and tree clumps (where there is a closed tree canopy) inside the monitoring area were taken during the current baseline monitoring and the separated tree survey to record their conditions. During the construction phase ecological monitoring, these baseline photos will be used as the baseline conditions of the trees and compared with those taken during the construction monitoring.
- 2.2.4. Surveys for the faunal group studied during the previous EIA were also conducted to record their present conditions in the monitoring area.
- 2.2.5. A survey for the two egrettries was also conducted, with the emphasis on whether there were any breeding egrets in Ho Pui Egretty.

3. BASELINE MONITORING RESULTS

- 3.1.1. The project area for KT13 is located between Route 3 Toll Plaza and the West Rail Tai Lam Tunnel portal, and to the north of Tai Lam Country Park. It comprises one of the upstream tributaries of the Kam Tin River, running eastward and joins the existing drainage channel system along the west rail alignment. The field surveys for the ecological baseline monitoring were conducted between 18 and 21 April 2008 and between 10 and 18 May 2008, covering daytime and nighttime.
- 3.1.2. Habitats identified in the Project Area for KT13 and its vicinity during the present monitoring include the following: urbanized areas (including villages, highways and West Rail), stream, channel, hillside grassland, ponds, agricultural land, fallow land, woodlands, shrubland, and orchard/horticultural land.
- 3.1.3. Habitats in the areas such as the villages and its surrounding fallow land were similar with those reported in the EIA study for the present project (i.e. EIA-122/2006 AGREEMENT NO. CE 67/98 Yuen Long, Kam Tin, Ngau Tam Mei & Tin Shui Wai Drainage Improvement Stage 1, Phase 2B - Kam Tin Secondary Drainage Channel KT13 ENVIRONMENTAL IMPACT ASSESSMENT FINAL REPORT). Though there were construction works for new village houses, the construction scale was small and did not have obvious influence on habitat boundaries. No major changes of the habitats within the study area were found during the baseline monitoring. The habitat map in the EIA final report is thus still valid and no revisions are required. The habitat map for the present project is showed in Annex D for reference.
- 3.1.4. The stream in Ho Pui was semi-natural, and was of poor conditions due to severe pollution level from the discharge of domestic sewage and livestock waste. No aquatic fauna had been recorded during the EIA study, and neither was sighted during the present baseline monitoring survey. There were some small and scattered abandoned fishponds within the monitoring area. As reported in EIA reports, these ponds were potentially used by the ardeids of Ho Pui Egret. But no ardeids were observed in abandoned fishponds during the present monitoring survey.
- 3.1.5. Regarding the vegetation photographic records, focus were put on the vicinity of the Project Area which is the concerned area. Indeed large sized trees within the monitoring area were also concentrated along the section of the stream close to the Hoi Pui villages (in the vicinity of the Project Area). The species of large sized trees were mainly fruit trees such as Longan *Dimocarpus longan*. Photos of the trees in the vicinity of the Project Area were taken during the tree survey for the Project, and were shown together with a location map in **Annex A – Tree Survey Report** of this report. Details of the trees including species, sizes and conditions could also refer to the **Tree Survey Report**. Photos of other vegetations within the monitoring area, including agricultural lands, fallow lands, streams were also taken and shown in **Annex B – Photographic Records**.
- 3.1.6. Fauna surveys, covering day and night time, were conducted. Bird and terrestrial fauna were surveyed by direct observation and active search. Acoustic survey for amphibians was also performed. Fish were studied by direct observation while and aquatic fauna were not studied due to the high pollution level. The survey results were presented in the **Table 1 and Table 2** below. Only one individual of one species of ardeids (potential species to utilize the egreties) was recorded during the present survey (i.e. Little Egret). No fish or other aquatic fauna was observed in the stream channel.

3.1.7. Ma On Kong Egretty was surveyed between 10 to 12 May 2008, while Ho Pui Egretty was surveyed between 10 to 12 May as well as between 17 to 18 May 2008. Ma On Kong Egretty is located adjacent to the Tai Lam Tunnel Toll Plaza and Pat Heung Road, comprised by some roadside plantation trees such as *Casuarina equisetifolia*, *Ficus microcarpa*, *Leucaena leucocephala* and *Macaranga tanarius*, as well as some other trees and bamboo within private lands. Currently a large car park is located at the centre and occupies much of the area defined as Ma On Kong Egretty on Figure 6.1. Ho Pui Egretty is composed of four patches of vegetations, mainly fruit trees and bamboos, along a section of the stream course between Ma On Kong Village and Ho Pui Village. No roosting or nesting egrets were sighted in the egretties in Ho Pui and Ma On Kong during the baseline monitoring. Egretty survey is included in the impact stage monitoring, and the results will be compared with those from the last year egretty survey (e.g. the data from AFCD). It however should be noted that the conditions in any given egretties might change year by year, even under normal situations. In 2002, 6 nests of Cattle Egret were found in Ho Pui Egretty (see AFCD 2002. Hong Kong Biodiversity Issue 1), but in 2005, the Ho Pui Egretty was found abandoned (see HKBWS 2006. Egretty Counts in Hong Kong). Photos of the egretties were shown in **Annex C – Egretty Photos**.

3.1.8. In order to decide whether works could be conducted within the 100m ecological buffer area till February next year and the egretty monitoring frequency between June to August, a special egretty survey was thus performed on 31st May 2008 to verify the conditions of the Ho Pui egretty (see Annex – Report for Special Survey on Ho Pui Egretty). No egret nests were found in Ho Pui egretty during the special survey. But two nests were observed in the Ma On Kong egretty. The two nests in Ma On Kong egretty are both Chinese Pond Heron.

Table 1 Bird Species Recorded in the KT 13 Monitoring Area during the Baseline Survey

Common name	Scientific name	Recorded in the KT13 EIA	Recorded in the present baseline survey
Little Egret	<i>Egretta garzetta</i>	✓	1
Cattle Egret	<i>Bubulcus ibis</i>	✓	
Chinese Pond Heron	<i>Ardeola bacchus</i>	✓	
Crested Serpent Eagle	<i>Spilornis cheela</i>	✓	
Bonelli's Eagle	<i>Hieraaetus fasciatus</i>	✓	
Eurasian Hobby	<i>Falco subbuteo</i>	✓	
White-breasted Waterhen	<i>Amaunornis phoenicurus</i>	✓	2
Spotted Dove	<i>Streptopelia chinensis</i>	✓	4
Common Koel	<i>Eudynamys scolopacea</i>	✓	1
Greater Coucal	<i>Centropus sinensis</i>	✓	
Little Swift	<i>Apus affinis</i>	✓	
White-Throated Kingfisher	<i>Halcyon smyrnenis</i>	✓	
Barn Swallow	<i>Hirundo rustica</i>	✓	7
Red-Whiskered Bulbul	<i>Pycnonotus jocosus</i>	✓	6
Chinese Bulbul	<i>Pycnonotus sinensis</i>	✓	4
Long-Tailed Shrike	<i>Lanius schach</i>	✓	
Oriental Magpie Robin	<i>Copsychus saularis</i>	✓	2
Masked Laughingthrush	<i>Garrulax perspicillatus</i>	✓	8

Yellow-Bellied Prinia	<i>Prinia flaviventris</i>	✓	2
Common Tailorbird	<i>Orthotomus sutorius</i>	✓	1
Great Tit	<i>Parus major</i>	✓	3
Japanese White-Eye	<i>Zosterops japonicus</i>	✓	3
White-Rumped Munia	<i>Lonchura striata</i>	✓	15
Eurasian Tree Sparrow	<i>Passer montanus</i>	✓	18
Black-Collared Starling	<i>Sturnus nigricollis</i>	✓	3
Common Myna	<i>Acridotheres tristis</i>	✓	2
Crested Myna	<i>Acridotheres cristatellus</i>	✓	
Large Hawk Cuckoo	<i>Hierococyx sparverioides</i>	\	1
White Wagtail	<i>Motacilla alba</i>	\	2
Hwamei	<i>Garrulax canorus</i>	\	1
Plain Prinia	<i>Prinia inornata</i>	\	1
Fork-Tailed Sunbird	<i>Aethopyga christinae</i>	\	1
No. of Species Recorded		27	22

Table 2 Other Fauna Species Recorded in the KT 13 Monitoring Area during the fauna baseline survey

Scientific Name	Common Name	Record in the EIA study for KT13	Recorded in the present baseline survey
Mammals			
<i>Suncus murinus</i>	Musk Shrew	✓	\
No. of species recorded		1	0
Herpetofauna			
<i>Bufo melanostictus</i>	Asian Common Toad	✓	3
<i>Rana guentheri</i>	Gunther's Frog	✓	1
<i>Rana limnocharis</i>	Paddy Frog	✓	
<i>Polyedates megacephalus</i>	Brown Tree Frog	✓	
<i>Kaloula pulchra</i>	Asiatic Painted Frog	✓	4
<i>Hemidactylus bowringii</i>	Bowring's Gecko	✓	
<i>Calotes versicolor</i>	Changeable Lizard	✓	1
<i>Eumeces chinensis</i>	Chinese Skink	✓	
<i>Mabuya longicaudata</i>	Long-tailed Skink	✓	1
<i>Scincella reevesii</i>	Reeve's Smooth Skink	✓	
<i>Xenochrophis piscator</i>	Checkered Keelback	✓	
<i>Rhabdophis subminiatus</i>	Red-necked Keelback	✓	
<i>Naja atra</i>	Chinese Cobra	✓	
No. of species recorded		13	5
Odonata			

<i>Ischnura senegalensis</i>	Common Bluetail	✓	3
<i>Ceragrion auranticum</i>	Orange-tailed Sprite	✓	
<i>Copera marginipes</i>	Yellow Featherlegs	✓	
<i>Prodasineura autumnalis</i>	Black Threadtail	✓	2
<i>Pseudagrion rubriceps</i>	Orange-faced Sprite	✓	
<i>Brachydiplax chalybea</i>	Blue Dasher	✓	1
<i>Orthetrum glaucum</i>	Common Blue Skimmer	✓	
<i>Orthetrum luzonicum</i>	Marsh Skimmer	✓	
<i>Orthetrum prunosum</i>	Common Red Skimmer	✓	2
<i>Orthetrum Sabina</i>	Green Skimmer	✓	1
<i>Barchythemis contaminata</i>	Asian Amberwing	✓	
<i>Crocothemis servilia</i>	Ruddy marsh skimmer	✓	1
<i>Diplacodes trivialis</i>	Blue Percher	✓	
<i>Neurothemis fulvia</i>	Russet Percher	✓	
<i>Pseudothemis zonata</i>	Skimmer	✓	1
<i>Trithemis aurora</i>	Crimson Dropwing	✓	
<i>Trithemis festiva</i>	Indigo Dropwing	✓	
<i>Rhyothemis variegata</i>	Variegated Flutterer	✓	
<i>Tramea virginia</i>	Saddlebag Glider	✓	1
<i>Hydrobasileus croceus</i>	Amber-winged Glider	✓	
<i>Pantala flavescens</i>	Wandering Glider	✓	3
<i>Tholymis tillarga</i>	Twister	✓	
<i>Zygonyx iris</i>	Clearwing Skimmer	✓	
No. of species recorded		23	9
Butterfly			
<i>Abisara echerius</i>	Plum Judy	✓	
<i>Astictopterus jama</i>	Forest Hopper	✓	
<i>Ariadne ariadne</i>	Angled Castor	✓	2
<i>Athyma selenophora</i>	Spring Sun	✓	
<i>Acytolepis puspa</i>	Common Hedge Blue	✓	
<i>Cupha erymanthis</i>	Rustic	✓	
<i>Cyrestis thyodamas</i>	Common Map	✓	
<i>Charaxes bernardus</i>	Tawny Rajah	✓	
<i>Discophora sondaica</i>	Common Duffer	✓	
<i>Erionota torus</i>	Banana skipper	✓	
<i>Euploea midamus</i>	Blue-spotted Crow	✓	
<i>Elymnias hypermnestra</i>	Common Palmfly	✓	
<i>Euthalia phemius</i>	White-edged Blue Baran	✓	
<i>Eurema blanda</i>	Three-spot Grass Yellow	✓	

<i>Eurema hecabe</i>	Common Grass Yellow	✓	
<i>Famegana alsulus</i>	Small Grass Blue	✓	
<i>Faunis eumeus</i>	Large Faun	✓	1
<i>Graphium agamemnon</i>	Tailed Jay	✓	
<i>Graphium doson</i>	Common Jay	✓	1
<i>Graphium sarpedon</i>	Common Bluebottle	✓	1
<i>Hestina assimilis</i>	Red Ring Skirt	✓	
<i>Hypolimnas bolina</i>	Great Egg-fly	✓	
<i>Hypolimnas misippus</i>	Danaid Eggfly	✓	
<i>Hebomoia glaucippe</i>	Great Orange Tip	✓	
<i>Ideopsis similis</i>	Ceylon Blue Glassy Tiger	✓	
<i>Iraota timoleon</i>	Silverstreak Blue	✓	
<i>Junonia alites</i>	Great Pansy	✓	
<i>Kaniska canace</i>	Blue Admiral	✓	
<i>Lethe confusa</i>	Banded Treebrown	✓	
<i>Lethe rohria</i>	Common Treebrown	✓	
<i>Melanitis leda</i>	Common Evening Brown	✓	
<i>Mycalesis mineus</i>	Dark-branded Bush Brown	✓	1
<i>Neptis hylas</i>	Common Sailer	✓	1
<i>Papilio bianor</i>	Chinese Peacock	✓	
<i>Papilio demoleus</i>	Lime Butterfly	✓	
<i>Papilio helenus</i>	Red Helen	✓	
<i>Papilio memnon</i>	Great Mormon	✓	2
<i>Papilio paris</i>	Tamil Peacock	✓	
<i>Papilio polytes</i>	Common Mormon	✓	1
<i>Papilio protenor</i>	Spangle	✓	
<i>Pantoporia hordonia</i>	Common Lascar	✓	
<i>Parnara guttatus</i>	Common Straight Swift	✓	
<i>Polytremis lubricans</i>	Contiguous Swift	✓	
<i>Potanthus confucius</i>	Chinese Dart	✓	
<i>Pieris canidia</i>	Indian Cabbage White	✓	2
<i>Symbrenthia lilaea</i>	Common Jester	✓	
<i>Ypthima baldus</i>	Common Five-ring	✓	
<i>Zemeros flegyas</i>	Punchinello	✓	1
<i>Zizeeria maha</i>	Pale Grass Blue	✓	3
<i>Zizina otis</i>	Lesser Grass Blue	✓	1
<i>Pieris rapae</i>	Small White	\	3
<i>Catopsilia pomona</i>	Common Emigrant	\	2
No. of species recorded		50	14

3.2. Changes of habitats

- 3.2.1. No major changes of the habitats within the monitoring area were found during the baseline monitoring. The habitat map in the previous ES is thus still valid and no revisions are required. Photos of the vegetations are presented in the Annex B – **Photographic Records** of this report.

3.3. Species of conservation importance

- 3.3.1. During the baseline monitoring, only one individual of one species of ardeids (i.e. Little Egret, potential species to utilize the egrettries) was recorded during the present survey.

4. CONCLUSIONS

- 4.1.1. The field surveys for the ecological baseline monitoring were conducted in April and May 2008. It was found that the habitat map in the previous EIA is thus still valid and no revisions are required. A survey for the egrettries was conducted. No nesting egrets were sighted in the egrettries in Ho Pui and Ma On Kong during the survey. But during a special survey on 31 August 2008, though no egret nests were found in Ho Pui egrettry, two nests were observed in the Ma On Kong egrettry. The two nests in Ma On Kong egrettry are both Chinese Pond Heron. As no nests were found at Ho Pui egrettry, the monitoring frequency on Ho Pui egrettry from June to August would be monthly, while monthly monitoring will also be conducted at Ma On Kong egrettry to provide reference information.
- 4.1.2. It should be noted that the conditions in any given egrettries might change year by year, with or without external factors. As stated in the EM&A Manual, during the impact monitoring stage, monthly walk-through survey and quantitative bird, egrettry and flight line monitoring will be conducted. The egrettry monitoring results will be compared with the breeding egret results reported in previous year (such as data from AFCD) as the compliance parameters. Given the fluctuating nature of egrettries, there is a possibility that the breeding egret number in the coming year will significantly decrease due to intrinsic factors, and then the compliance on action and limit level for ecology might not be met even no disturbance impact is caused by the construction works. On the other hand, though Ho Pui Egrettry was considered a historical egrettry, there were still records in the Ma On Kong Egrettry in recent years. These factors should be taken into account during the impact monitoring stage.

- END -

Annex A
Tree Survey Report

Tree Assessment Schedule

Project Name:

Contract No. DC2007/17
Drainage Improvement Works (KT-13)

Surveyed by:

HK Landscaping Ltd.

Location:

Cheung Po, Ma On Kong, Yuen Long and San Tsuen

Date:

Apr-08

Tree No.	Species	Chinese Name	Overall Height (M)	Tree Size	Trunk Diameter (M)	Form	Health	Amenity value	Survival Rate after Transplanting	Approved Treatment	Remarks
	Scientific Name			Crown Spread (M)		Good / Fair / Poor	Good / Fair / Poor	High / Medium / Low	High / Medium / Low		
T 181	<i>Macaranga tanarius</i>	血桐	3.5	2.5	0.16	Fair	Fair	Low	Medium	Retain	
T 182	<i>Macaranga tanarius</i>	血桐	4	3	0.15	Fair	Poor	Low	Low	Retain	
T 183	Missing Tree		-	-	-	-	-	-	-	-	*
T 184	Missing Tree		-	-	-	-	-	-	-	-	*
T 185	Missing Tree		-	-	-	-	-	-	-	-	*
T 186	<i>Dimocarpus logan</i>	龍眼	8.5	7.5	0.42	Fair	Fair	Medium	Medium	Transplant	
T 187	<i>Melia azedarach</i>	楝	8.5	6.5	0.18	Fair	Fair	Medium	Medium	Retain	
T 188	<i>Dimocarpus logan</i>	龍眼	5.5	5.5	0.32	Fair	Fair	Low	Low	Fell	
T 189	Missing Tree		-	-	-	-	-	-	-	-	*
T 190	<i>Macaranga tanarius</i>	血桐	4.5	4.5	0.13	Fair	Fair	Low	Medium	Retain	
T 191	<i>Ficus hispida</i>	對葉榕	2.5	2.5	0.14	Fair	Fair	Low	Low	Fell	
T 192	<i>Macaranga tanarius</i>	血桐	3	2	0.13	Fair	Poor	Low	Low	Fell	
T 193	<i>Macaranga tanarius</i>	血桐	5.5	4.5	0.23	Fair	Fair	Low	Low	Fell	
T 194	<i>Ilex rotunda</i>	鐵冬青	4	6	0.22	Poor	Poor	Low	Low	Retain	
T 195	<i>Dimocarpus logan</i>	龍眼	5	5	0.32	Poor	Fair	Low	Low	Retain	
T 196	Missing Tree		-	-	-	-	-	-	-	-	*
T 197	Missing Tree		-	-	-	-	-	-	-	-	*
T 198	Missing Tree		-	-	-	-	-	-	-	-	*
T 199	<i>Clausea lansium</i>	黃皮	4.5	3.5	0.14	Fair	Fair	Medium	Medium	Transplant	
T 200	<i>Clausea lansium</i>	黃皮	4.5	3.5	0.14	Fair	Fair	Low	Medium	Retain	
T 201	<i>Clausea lansium</i>	黃皮	4.5	4.5	0.14	Fair	Fair	Medium	Medium	Transplant	
T 202	<i>Clausea lansium</i>	黃皮	4.5	3.5	0.14	Fair	Fair	Medium	Medium	Transplant	
T 203	<i>Litchi chinensis</i>	荔枝	5.5	4.5	0.14	Fair	Fair	Medium	Medium	Transplant	
T 204	<i>Clausea lansium</i>	黃皮	5.5	4.5	0.14	Fair	Fair	Low	Low	Fell	
T 205	<i>Dimocarpus logan</i>	龍眼	6.5	4.5	0.14	Fair	Fair	Medium	Medium	Transplant	

Notes: " * " - "Missing Trees" recorded under the Tree assessment schedule were felled with unknown reasons before the site was handed over to DSD's contractor.

Notes: " # " - Revise due to wrong identification

Tree Assessment Schedule

Surveyed by:

HK Landscaping Ltd.

Project Name:

Contract No. DC2007/17

Drainage Improvement Works (KT-13)

Location:

Cheung Po, Ma On Kong, Yuen Long and San Tsuen

Date:

Apr-08

Tree No.	Species	Chinese Name	Overall Height (M)	Tree Size	Trunk Diameter (M)	Form	Health	Amenity value	Survival Rate after Transplanting	Approved Treatment	Remarks
	Scientific Name			Crown Spread (M)		Good / Fair / Poor	Good / Fair / Poor	High / Medium / Low	High / Medium / Low		
T 206	<i>Averrhoa carambola</i>	楊桃	7.5	6.5	0.24	Fair	Fair	Low	Low	Fell	
T 207	<i>Citrus maxima</i>	柚	5.5	4.4	0.2	Fair	Fair	Medium	Medium	Transplant	
T 208	<i>Dimocarpus logan</i>	龍眼	5.5	3.5	0.13	Fair	Fair	Medium	Medium	Transplant	
T 209	<i>Dimocarpus logan</i>	龍眼	6.5	3.5	0.14	Fair	Fair	Medium	Medium	Transplant	
T 210	<i>Dimocarpus logan</i>	龍眼	6.5	4.5	0.13	Fair	Fair	Medium	Medium	Transplant	
T 211	<i>Dimocarpus logan</i>	龍眼	6.5	4.5	0.15	Fair	Fair	Medium	Medium	Transplant	
T 212	<i>Dimocarpus logan</i>	龍眼	6.5	3.5	0.13	Fair	Fair	Medium	Medium	Transplant	
T 213	<i>Dimocarpus logan</i>	龍眼	6.5	3.5	0.15	Fair	Fair	Medium	Medium	Transplant	
T 214	<i>Dimocarpus logan</i>	龍眼	6.5	5	0.13	Fair	Fair	Medium	Medium	Transplant	
T 215	<i>Dimocarpus logan</i>	龍眼	6.5	4.5	0.14	Fair	Fair	Medium	Medium	Transplant	
T 216	<i>Dimocarpus logan</i>	龍眼	6.5	3.5	0.13	Fair	Fair	Medium	Medium	Transplant	
T 217	<i>Dimocarpus logan</i>	龍眼	5.5	3.5	0.13	Fair	Fair	Medium	Medium	Transplant	
T 218	<i>Dimocarpus logan</i>	龍眼	5.5	4	0.13	Fair	Fair	Medium	Medium	Transplant	
T 219	<i>Dimocarpus logan</i>	龍眼	6.5	3.5	0.14	Fair	Fair	Medium	Medium	Transplant	
T 220	<i>Dimocarpus logan</i>	龍眼	6.5	3.5	0.15	Fair	Fair	Medium	Medium	Transplant	
T 221	<i>Dimocarpus logan</i>	龍眼	4.5	4.5	0.13	Fair	Fair	Medium	Medium	Transplant	
T 222	<i>Dimocarpus logan</i>	龍眼	5.5	4.5	0.14	Fair	Fair	Medium	Medium	Transplant	
T 223	<i>Dimocarpus logan</i>	龍眼	6.5	4.5	0.21	Fair	Fair	Medium	Medium	Transplant	
T 224	<i>Dimocarpus logan</i>	龍眼	7.5	6.5	0.27	Fair	Fair	High	Medium	Transplant	
T 225	<i>Clausena lansium</i>	黃皮	5.5	4.5	0.13	Fair	Fair	Low	Low	Fell	
T 226	<i>Sterculia nobilis</i>	欖婆	6.5	3.5	0.13	Fair	Fair	Low	Low	Fell	
T 227	<i>Sterculia nobilis</i>	欖婆	5.5	3.5	0.14	Fair	Fair	Low	Low	Fell	
T 228	<i>Sterculia nobilis</i>	欖婆	5.5	3.5	0.14	Fair	Fair	Low	Low	Fell	
T 229	<i>Dimocarpus logan</i>	龍眼	5.5	4.5	0.2	Fair	Fair	Medium	Medium	Transplant	
T 230	<i>Litchi chinensis</i>	荔枝	5.5	5.5	0.2	Fair	Fair	Medium	Medium	Transplant	

Notes: " * " - "Missing Trees" recorded under the Tree assessment schedule were felled with unknown reasons before the site was handed over to DSD's contractor.

Notes: " # " - Revise due to wrong identification

Tree Assessment Schedule

Surveyed by:

HK Landscaping Ltd.

Project Name:

Contract No. DC/2007/17

Drainage Improvement Works (KT-13)

Location:

Cheung Po, Ma On Kong, Yuen Long and San Tsuen

Date:

Apr-08

Tree No.	Species	Chinese Name	Overall Height (M)	Tree Size Crown Spread (M)	Trunk Diameter (M)	Form Good / Fair / Poor	Health Good / Fair / Poor	Amenity value High / Medium / Low	Survival Rate after Transplanting High / Medium / Low	Approved Treatment	Remarks
T 231	<i>Dimocarpus logan</i>	龍眼	5.5	4	0.13	Fair	Fair	Low	Medium	Retain	
T 232	<i>Dimocarpus logan</i>	龍眼	5.5	3.5	0.14	Fair	Fair	Low	Medium	Retain	
T 233	<i>Dimocarpus logan</i>	龍眼	5.5	3.5	0.13	Fair	Fair	Low	Medium	Retain	
T 234	<i>Dimocarpus logan</i>	龍眼	6.5	4.5	0.21	Fair	Fair	Low	Medium	Retain	
T 235	<i>Dimocarpus logan</i>	龍眼	8.5	6.5	0.34	Fair	Fair	Medium	Medium	Transplant	
T 236	<i>Dimocarpus logan</i>	龍眼	5.5	3.5	0.13	Poor	Poor	Medium	Medium	Transplant	
T 237	<i>Dimocarpus logan</i>	龍眼	5.5	4.5	0.14	Fair	Fair	Medium	Medium	Transplant	
T 238	<i>Dimocarpus logan</i>	龍眼	6.5	4.5	0.15	Fair	Fair	Medium	Medium	Transplant	
T 239	<i>Dimocarpus logan</i>	龍眼	4.5	4	0.14	Fair	Fair	Low	Medium	Retain	
T 240	<i>Dimocarpus logan</i>	龍眼	5.5	4	0.14	Fair	Fair	Low	Medium	Retain	
T 241	<i>Dimocarpus logan</i>	龍眼	5.5	3.5	0.13	Fair	Fair	Low	Low	Retain	
T 242	<i>Dimocarpus logan</i>	龍眼	5.5	3.5	0.13	Fair	Fair	Low	Medium	Retain	
T 243	<i>Dimocarpus logan</i>	龍眼	5.5	3.5	0.13	Fair	Fair	Medium	Medium	Transplant	
T 244	<i>Dimocarpus logan</i>	龍眼	5.5	4	0.14	Fair	Fair	Medium	Medium	Transplant	
T 245	<i>Dimocarpus logan</i>	龍眼	5.5	3.5	0.13	Fair	Fair	Low	Low	Retain	
T 246	<i>Dimocarpus logan</i>	龍眼	6.5	4.5	0.13	Fair	Fair	Medium	Medium	Transplant	
T 247	<i>Dimocarpus logan</i>	龍眼	6.5	4.5	0.16	Fair	Fair	Medium	Medium	Transplant	
T 248	<i>Dimocarpus logan</i>	龍眼	6.5	4.5	0.13	Fair	Fair	Medium	Medium	Transplant	
T 249	<i>Dimocarpus logan</i>	龍眼	6.5	4.5	0.32	Fair	Fair	Medium	Medium	Transplant	
T 250	<i>Dimocarpus logan</i>	龍眼	6.5	3.5	0.14	Fair	Fair	Medium	Medium	Transplant	
T 251	<i>Dimocarpus logan</i>	龍眼	5.5	3.5	0.13	Fair	Fair	Medium	Medium	Transplant	
T 252	<i>Dimocarpus logan</i>	龍眼	5.5	3.5	0.13	Fair	Fair	Medium	Medium	Transplant	
T 253	<i>Sterculia nobilis</i>	蘋婆	4.5	4.5	0.14	Fair	Fair	Low	Low	Fell	
T 254	<i>Dimocarpus logan</i>	龍眼	5.5	2.5	0.13	Fair	Fair	Low	Medium	Retain	
T 255	<i>Sterculia nobilis</i>	蘋婆	6.5	4.5	0.18	Fair	Fair	Low	Low	Retain	

Notes: " * " - "Missing Trees" recorded under the Tree assessment schedule were felled with unknown reasons before the site was handed over to DSD's contractor.

Notes: " # " - Revise due to wrong identification

Tree Assessment Schedule

Project Name:

Contract No. DC/2007/17

Surveyed by:

HK Landscaping Ltd.

Drainage Improvement Works (KT-13)

Location:

Cheung Po, Ma On Kong, Yuen Long and San Tsuen

Date:

Apr-08

Tree No.	Species	Chinese Name	Overall Height (M)	Tree Size	Trunk Diameter (M)	Form	Health	Amenity value	Survival Rate after Transplanting	Approved Treatment	Remarks
	Scientific Name			Crown Spread (M)		Good / Fair / Poor	Good / Fair / Poor	High / Medium / Low	High / Medium / Low		
T 256	<i>Prunus persica</i>	桃	5.5	3.5	0.13	Fair	Fair	Low	Low	Retain	
T 257	<i>Dimocarpus logan</i>	龍眼	5.5	3.5	0.15	Fair	Fair	Low	Medium	Retain	
T 258	<i>Dimocarpus logan</i>	龍眼	5.5	3.5	0.14	Fair	Fair	Low	Medium	Retain	
T 259	<i>Averrhoa carambola</i>	楊桃	5.5	4.5	0.16	Fair	Fair	Low	Medium	Retain	
T 260	<i>Artocarpus marocarpus</i>	波羅蜜	5.5	3.5	0.13	Fair	Fair	Low	Medium	Retain	
T 261	<i>Artocarpus marocarpus</i>	波羅蜜	6.5	4	0.15	Fair	Fair	Low	Medium	Retain	
T 262	<i>Dimocarpus logan</i>	龍眼	5.5	3.5	0.13	Fair	Fair	Low	Medium	Retain	
T 263	<i>Prunus persica</i>	桃	6.5	4	0.15	Fair	Fair	Low	Medium	Retain	
T 264	<i>Prunus persica</i>	桃	5.5	4.5	0.13	Fair	Fair	Medium	Medium	Transplant	
T 265	<i>Dimocarpus logan</i>	龍眼	7	7	0.34	Fair	Good	Low	Low	Fell	
T 266	<i>Sapium sebiferum</i>	烏柏	3	3	0.13	Fair	Poor	Low	Low	Retain	
T 267	<i>Sapium sebiferum</i>	烏柏	4	3	0.15	Fair	Poor	Low	Low	Retain	
T 268	<i>Sapium sebiferum</i>	烏柏	4	3	0.15	Fair	Poor	Low	Low	Retain	
T 269	<i>Celtis sinensis</i>	朴	5	3	0.13	Fair	Poor	Low	Low	Fell	
T 270	<i>Sapium sebiferum</i>	烏柏	6	4	0.23	Fair	Poor	Low	Low	Fell	
T 271	<i>Celtis sinensis</i>	朴	7	7	0.24	Fair	Poor	Low	Low	Fell	
T 272	<i>Bridelia tomentosa</i>	土密樹	5	5	0.15	Poor	Poor	Low	Low	Fell	
T 273	<i>Celtis sinensis</i>	朴	7	4	0.2	Fair	Fair	Low	Low	Fell	
T 274	<i>Celtis sinensis</i>	朴	7	5	0.21	Fair	Poor	Low	Low	Fell	
T 275	<i>Ficus hispida</i>	對葉榕	7	6	0.38	Fair	Poor	Low	Low	Transplant	
T 276	<i>Celtis sinensis</i>	朴	6	3	0.14	Fair	Fair	Low	Low	Fell	
T 277	<i>Celtis sinensis</i>	朴	7	5	0.22	Fair	Fair	Low	Medium	Transplant	
T 278	<i>Dimocarpus longan</i>	龍眼	8	6	0.27	Good	Fair	Medium	Medium	Transplant	
T 279	<i>Macaranga tinarius</i>	血桐	5	4	0.14	Fair	Poor	Low	Low	Fell	
T 280	Dead Tree	死樹	-	-	-	-	-	-	-	-	

Notes: " * " - "Missing Trees" recorded under the Tree assessment schedule were felled with unknown reasons before the site was handed over to DSD's contractor.

Notes: " # " - Revise due to wrong identification

Tree Assessment Schedule

Surveyed by:

HK Landscaping Ltd.

Project Name:

Contract No. DC/2007/17

Drainage Improvement Works (KT-13)

Location:

Cheung Po, Ma On Kong, Yuen Long and San Tsuen

Date:

Apr-08

Tree No.	Species	Chinese Name	Overall Height (M)	Crown Spread (M)	Trunk Diameter (M)	Form	Health	Amenity value	Survival Rate after Transplanting	Approved Treatment	Remarks
	Scientific Name					Good / Fair / Poor	Good / Fair / Poor	High / Medium / Low	High / Medium / Low		
T 281	<i>Ficus hispida</i>	對葉榕	5	5	0.15	Poor	Poor	Low	Low	Fell	
T 282	<i>Ficus hispida</i>	對葉榕	4	6	0.15	Poor	Poor	Low	Low	Fell	
T 283	<i>Ficus hispida</i>	對葉榕	5	5	0.2	Poor	Poor	Low	Low	Fell	
T 284	Dead Tree	死樹	-	-	-	-	-	-	-	-	
T 285	<i>Dimocarpus longan</i>	龍眼	7	8	0.4	Good	Good	Medium	Medium	Transplant	
T 286	<i>Ficus hispida</i>	對葉榕	3	1	0.16	Poor	Poor	Low	Low	Fell	
T 287	<i>Celtis sinensis</i>	朴	4	4	0.14	Fair	Poor	Low	Low	Fell	
T 288	<i>Celtis sinensis</i>	朴	7	6	0.39	Fair	Poor	Medium	Low	Transplant	
T 289	Missing Tree		-	-	-	-	-	-	-	-	*
T 290	Missing Tree		-	-	-	-	-	-	-	-	*
T 291	<i>Ficus hispida</i>	對葉榕	5	5	0.32	Fair	Poor	Low	Low	Fell	
T 292	<i>Dimocarpus longan</i>	龍眼	3.5	2	0.15	Fair	Fair	Medium	Medium	Transplant	
T 293	Missing Tree		-	-	-	-	-	-	-	-	*
T 294	Missing Tree		-	-	-	-	-	-	-	-	*
T 295	Missing Tree		-	-	-	-	-	-	-	-	*
T 296	Missing Tree		-	-	-	-	-	-	-	-	*
T 297	Missing Tree		-	-	-	-	-	-	-	-	*
T 298	Missing Tree		-	-	-	-	-	-	-	-	*
T 299	Missing Tree		-	-	-	-	-	-	-	-	*
T 300	Missing Tree		-	-	-	-	-	-	-	-	*
T 301	Missing Tree		-	-	-	-	-	-	-	-	*
T 302	Missing Tree		-	-	-	-	-	-	-	-	*
T 303	Missing Tree		-	-	-	-	-	-	-	-	*
T 304	Missing Tree		-	-	-	-	-	-	-	-	*
T 305	Missing Tree		-	-	-	-	-	-	-	-	*

Notes: " * " - "Missing Trees" recorded under the Tree assessment schedule were felled with unknown reasons before the site was handed over to DSD's contractor.

Notes: " # " - Revise due to wrong identification

Tree Assessment Schedule

Project Name: Contract No. DC/2007/17
 Drainage Improvement Works (KT-13)

Surveyed by: HK Landscaping Ltd.

Location: Cheung Po, Ma On Kong, Yuen Long and San Tsuen

Date: Apr-08

Tree No.	Species	Scientific Name	Chinese Name	Overall Height (M)	Tree Size	Crown Spread (M)	Trunk Diameter (M)	Form	Health	Amenity value	Survival Rate after Transplanting	Approved Treatment	Remarks
								Good / Fair / Poor	Good / Fair / Poor	High / Medium / Low	High / Medium / Low		
T 306	Missing Tree			-	-	-	-	-	-	-	-	-	*
T 307	Missing Tree			-	-	-	-	-	-	-	-	-	*
T 308	Missing Tree			-	-	-	-	-	-	-	-	-	*
T 309	Missing Tree			-	-	-	-	-	-	-	-	-	*
T 310	Missing Tree			-	-	-	-	-	-	-	-	-	*
T 311	Missing Tree			-	-	-	-	-	-	-	-	-	*
T 312	Missing Tree			-	-	-	-	-	-	-	-	-	*
T 313	Missing Tree			-	-	-	-	-	-	-	-	-	*
T 314	Missing Tree			-	-	-	-	-	-	-	-	-	*
T 315	Missing Tree			-	-	-	-	-	-	-	-	-	*
T 316	Missing Tree			-	-	-	-	-	-	-	-	-	*
T 317	Missing Tree			-	-	-	-	-	-	-	-	-	*
T 318	Missing Tree			-	-	-	-	-	-	-	-	-	*
T 319	Missing Tree			-	-	-	-	-	-	-	-	-	*
T 320	Missing Tree			-	-	-	-	-	-	-	-	-	*
T 321	Missing Tree			-	-	-	-	-	-	-	-	-	*
T 322	Missing Tree			-	-	-	-	-	-	-	-	-	*
T 323	Missing Tree			-	-	-	-	-	-	-	-	-	*
T 324	Missing Tree			-	-	-	-	-	-	-	-	-	*
T 325	Missing Tree			-	-	-	-	-	-	-	-	-	*
T 326	Missing Tree			-	-	-	-	-	-	-	-	-	*
T 327	Missing Tree			-	-	-	-	-	-	-	-	-	*
T 328	Missing Tree			-	-	-	-	-	-	-	-	-	*
T 329	Missing Tree			-	-	-	-	-	-	-	-	-	*
T 330	Missing Tree			-	-	-	-	-	-	-	-	-	*
T 331	Missing Tree			-	-	-	-	-	-	-	-	-	*

Notes: " * " - "Missing Trees" recorded under the Tree assessment schedule were felled with unknown reasons before the site was handed over to DSD's contractor.

Notes: " # " - Revise due to wrong identification

Tree Assessment Schedule

Project Name: Contract No. DC/2007/17
 Drainage Improvement Works (KT-13)
 Location: Cheung Po, Ma On Kong, Yuen Long and San Tsuen
 Surveyed by: HK Landscaping Ltd.
 Date: Apr-08

Tree No.	Species	Chinese Name	Overall Height (M)	Crown Spread (M)	Trunk Diameter (M)	Form	Health	Amenity value	Survival Rate after Transplanting	Approved Treatment	Remarks
T 332	Missing Tree		-	-	-	-	-	-	-	-	*
T 333	Missing Tree		-	-	-	-	-	-	-	-	*
T 334	Missing Tree		-	-	-	-	-	-	-	-	*
T 335	Missing Tree		-	-	-	-	-	-	-	-	*
T 336	Missing Tree		-	-	-	-	-	-	-	-	*
T 337	Missing Tree		-	-	-	-	-	-	-	-	*
T 338	Missing Tree		-	-	-	-	-	-	-	-	*
T 339	Missing Tree		-	-	-	-	-	-	-	-	*
T 340	Missing Tree		-	-	-	-	-	-	-	-	*
T 341	Missing Tree		-	-	-	-	-	-	-	-	*
T 342	Missing Tree		-	-	-	-	-	-	-	-	*
T 343	Missing Tree		-	-	-	-	-	-	-	-	*
T 344	Missing Tree		-	-	-	-	-	-	-	-	*
T 345	Missing Tree		-	-	-	-	-	-	-	-	*
T 346	Missing Tree		-	-	-	-	-	-	-	-	*
T 347	Missing Tree		-	-	-	-	-	-	-	-	*
T 348	Missing Tree		-	-	-	-	-	-	-	-	*
T 349	Missing Tree		-	-	-	-	-	-	-	-	*
T 350	<i>Delonix regia</i>	鳳凰木	10.5	5.5	0.32	Fair	Fair	Medium	Medium	Transplant	Conflict with proposed channel
T 351	Dead Tree	死樹	-	-	-	-	-	-	-	-	
T 352	Missing Tree		-	-	-	-	-	-	-	-	*
T 353	<i>Delonix regia</i>	鳳凰木	5.5	2.5	0.15	Fair	Fair	Medium	Medium	Transplant	Conflict with proposed channel
T 354	Missing Tree		-	-	-	-	-	-	-	-	*
T 355	Missing Tree		-	-	-	-	-	-	-	-	*
T 356	Missing Tree		-	-	-	-	-	-	-	-	*

Notes: " * " - "Missing Trees" recorded under the Tree assessment schedule were felled with unknown reasons before the site was handed over to DSD's contractor.

Notes: " # " - Revise due to wrong identification

Tree Assessment Schedule

Surveyed by:

HK Landscaping Ltd.

Project Name:

Contract No. DC/2007/17

Drainage Improvement Works (KT-13)

Location:

Cheung Po, Ma On Kong, Yuen Long and San Tsuen

Date:

Apr-08

Tree No.	Species	Chinese Name	Overall Height (M)	Tree Size Crown Spread (M)	Trunk Diameter (M)	Form Good / Fair / Poor	Health Good / Fair / Poor	Amenity value High / Medium / Low	Survival Rate after Transplanting High / Medium / Low	Approved Treatment	Remarks
T 357	Missing Tree		-	-	-	-	-	-	-	-	*
T 358	Missing Tree		-	-	-	-	-	-	-	-	*
T 359	Missing Tree		-	-	-	-	-	-	-	-	*
T 360	Missing Tree		-	-	-	-	-	-	-	-	*
T 361	Missing Tree		-	-	-	-	-	-	-	-	*
T 362	Missing Tree		-	-	-	-	-	-	-	-	*
T 363	Missing Tree		-	-	-	-	-	-	-	-	*
T 364	Missing Tree		-	-	-	-	-	-	-	-	*
T 365	Missing Tree		-	-	-	-	-	-	-	-	*
T 366	Missing Tree		-	-	-	-	-	-	-	-	*
T 367	Missing Tree		-	-	-	-	-	-	-	-	*
T 368	Missing Tree		-	-	-	-	-	-	-	-	*
T 369	Missing Tree		-	-	-	-	-	-	-	-	*
T 370	Missing Tree		-	-	-	-	-	-	-	-	*
T 371	Missing Tree		-	-	-	-	-	-	-	-	*
T 372	Missing Tree		-	-	-	-	-	-	-	-	*
T 373	<i>Dinocarpus logan</i>	龍眼	3.5	2	0.18	Fair	Fair	Medium	Low	Transplant	Conflict with proposed channel
T 374	Missing Tree		-	-	-	-	-	-	-	-	*
T 375	Missing Tree		-	-	-	-	-	-	-	-	*
T 376	Missing Tree		-	-	-	-	-	-	-	-	*
T 377	<i>Spathodea campanulata</i>	火焰木	3.5	2	0.17	Fair	Fair	Medium	Medium	Transplant	Conflict with proposed channel
T 378	<i>Spathodea campanulata</i>	火焰木	4	2.5	0.18	Fair	Fair	Medium	Medium	Transplant	Conflict with proposed channel
T 379	Missing Tree		-	-	-	-	-	-	-	-	*
T 380	<i>Ficus Benjamin</i>	垂榕	5.5	4	0.23	Fair	Fair	Low	Low	Fell	
T 381	Missing Tree		-	-	-	-	-	-	-	-	*

Notes: " * " - "Missing Trees" recorded under the Tree assessment schedule were felled with unknown reasons before the site was handed over to DSD's contractor.

Notes: " # " - Revise due to wrong identification

Tree Assessment Schedule

Surveyed by:

HK Landscaping Ltd.

Project Name:

Contract No. DC/2007/17

Drainage Improvement Works (KT-13)

Location:

Cheung Po, Ma On Kong, Yuen Long and San Tsuen

Date:

Apr-08

Tree No.	Species	Chinese Name	Overall Height (M)	Crown Spread (M)	Trunk Diameter (M)	Form	Health	Amenity value	Survival Rate after Transplanting	Approved Treatment	Remarks
	Scientific Name					Good / Fair / Poor	Good / Fair / Poor	High / Medium / Low	High / Medium / Low		
T 382	Missing Tree		-	-	-	-	-	-	-	-	*
T 383	Missing Tree		-	-	-	-	-	-	-	-	*
T 384	Missing Tree		-	-	-	-	-	-	-	-	*
T 385	Missing Tree		-	-	-	-	-	-	-	-	*
T 386	Missing Tree		-	-	-	-	-	-	-	-	*
T 387	<i>Aleurites molucana</i>	石栗	7.5	5.5	0.28	Fair	Fair	Medium	Medium	Retain	
T 388	<i>Aleurites molucana</i>	石栗	7.5	6	0.29	Fair	Fair	Medium	Medium	Retain	
T 389	<i>Aleurites molucana</i>	石栗	5	4.5	0.26	Fair	Fair	Medium	Medium	Transplant	
T 390	Missing Tree		-	-	-	-	-	-	-	-	*
#T 391	Missing Tree		-	-	-	-	-	-	-	-	*
T 392	Missing Tree		-	-	-	-	-	-	-	-	*
T 393	Missing Tree		-	-	-	-	-	-	-	-	*
#T 394	Missing Tree		-	-	-	-	-	-	-	-	*
#T 395	Missing Tree		-	-	-	-	-	-	-	-	*
#T 396	<i>Albizia lebbek</i>	大葉合歡	6.5	3	0.15	Fair	Fair	Low	High	Transplant	
T 397	<i>Ficus microcarpa</i>	細葉榕	6.5	5.5	0.35	Fair	Fair	Low	Low	Retain	
T 398	<i>Claudia lansium</i>	黃皮	4	2	0.15	Fair	Fair	Medium	Medium	Transplant	
T 399	<i>Dimocarpus logan</i>	龍眼	3.5	2	0.17	Fair	Fair	Low	Low	Retain	
T 400	<i>Macaranga tanarius</i>	血桐	5.5	5.5	0.17	Fair	Fair	Low	Medium	Transplant	
T 401	<i>Macaranga tanarius</i>	血桐	4.5	4.5	0.13	Fair	Fair	Low	Medium	Transplant	
T 402	<i>Macaranga tanarius</i>	血桐	5	5	0.15	Poor	Fair	Low	Low	Retain	
T 403	Dead Tree	死樹	-	-	-	-	-	-	-	-	
T 404	Missing Tree		-	-	-	-	-	-	-	-	*
T 405	<i>Hornalium cochinchinensis</i>	天料木	4.5	4.5	0.14	Fair	Fair	Low	Low	Retain	
T 406	Missing Tree		-	-	-	-	-	-	-	-	*

Notes: "*" - "Missing Trees" recorded under the Tree assessment schedule were felled with unknown reasons before the site was handed over to DSD's contractor.

Notes: "#" - Revise due to wrong identification

Tree Assessment Schedule

Surveyed by:

HK Landscaping Ltd.

Project Name:

Contract No. DC/2007/17

Drainage Improvement Works (KT-13)

Location:

Cheung Po, Ma On Kong, Yuen Long and San Tsuen

Date:

Apr-08

Tree No.	Species	Chinese Name	Overall Height (M)	Tree Size	Form	Health	Amenity value	Survival Rate after Transplanting	Approved Treatment	Remarks
	Scientific Name			Crown Spread (M) Trunk Diameter (M)	Good / Fair / Poor	Good / Fair / Poor	High / Medium / Low	High / Medium / Low		
T 407	<i>Homalium cochinchinensis</i>	天料木	5	4	0.12	Poor	Poor	Low	Low	Retain
T 408	Missing Tree		-	-	-	-	-	-	-	*
T 409	Dead Tree	死樹	-	-	-	-	-	-	-	
T 410	Missing Tree		-	-	-	-	-	-	-	*
T 411	Missing Tree		-	-	-	-	-	-	-	*
T 412	<i>Dimocarpus longan</i>	龍眼	7	0.36	5	Fair	Fair	Medium	Low	Retain
T 413	Dead Tree	死樹	-	-	-	-	-	-	-	
T 414	<i>Artocarpus marocarpus</i>	波羅蜜	8.5	5	0.33	Poor	Fair	Low	Low	Retain
T 415	<i>Dimocarpus longan</i>	龍眼	8.5	5.5	0.33	Fair	Fair	Medium	Low	Retain
T 416	<i>Sterculia lanceolata</i>	假蘋果	5	4	0.12	Fair	Fair	Medium	Low	Retain
T 417	<i>Sterculia lanceolata</i>	假蘋果	5	4	0.12	Poor	Fair	Low	Low	Retain
T 418	<i>Sterculia lanceolata</i>	假蘋果	6	3	0.12	Fair	Fair	Low	Low	Retain
T 419	<i>Ficus hispida</i>	對葉榕	5	4	0.13	Poor	Poor	Low	Low	Retain
T 420	<i>Microcos paniculata</i>	布渣葉	6.5	5.5	0.14	Poor	Poor	Low	Low	Retain
T 421	<i>Sterculia lanceolata</i>	假蘋果	5	5	0.17	Poor	Poor	Low	Low	Retain
T 422	<i>Ficus hispida</i>	對葉榕	5	5	0.14	Poor	Poor	Low	Low	Retain
T 423	Dead Tree	死樹	-	-	-	-	-	-	-	
T 424	<i>Ficus hispida</i>	對葉榕	4	5	0.19	Poor	Poor	Low	Low	Retain
T 425	<i>Sterculia lanceolata</i>	假蘋果	3	4	0.14	Fair	Poor	Low	Low	Retain
T 426	Missing Tree		-	-	-	-	-	-	-	*
T 427	<i>Sterculia lanceolata</i>	假蘋果	5.5	2.5	0.12	Fair	Poor	Low	Low	Retain
T 428	<i>Sterculia lanceolata</i>	假蘋果	5.5	3.5	0.12	Poor	Fair	Low	Low	Retain
T 429	Missing Tree		-	-	-	-	-	-	-	*
T 430	Missing Tree		-	-	-	-	-	-	-	*
T 431	<i>Celtis sinensis</i>	朴	4	3	0.14	Poor	Fair	Low	Low	Retain

Notes: " * " - "Missing Trees" recorded under the Tree assessment schedule were felled with unknown reasons before the site was handed over to DSD's contractor.

Notes: " # " - Revise due to wrong identification

Tree Assessment Schedule

Surveyed by:

HK Landscaping Ltd.

Project Name:

Contract No. DC/2007/17

Drainage Improvement Works (KT-13)

Location:

Cheung Po, Ma On Kong, Yuen Long and San Tsuen

Date:

Apr-08

Tree No.	Species	Chinese Name	Overall Height (M)	Tree Size Crown Spread (M)	Trunk Diameter (M)	Form Good / Fair / Poor	Health Good / Fair / Poor	Amenity value High / Medium / Low	Survival Rate after Transplanting High / Medium / Low	Approved Treatment	Remarks
T 432	Missing Tree		-	-	-	-	-	-	-	-	*
T 433	<i>Carica papaya</i>	番木瓜	3	4	0.13	Fair	Fair	Low	Low	Retain	
T 434	<i>Mangifera indica</i>	芒果	4	3	0.13	Fair	Fair	Low	Low	Retain	
T 435	<i>Salix babylonica</i>	柳	5	3	0.15	Fair	Fair	Medium	Low	Retain	
T 436	<i>Salix babylonica</i>	柳	5	3	0.14	Fair	Fair	Medium	Low	Retain	
T 437	Missing Tree		-	-	-	-	-	-	-	-	*
T 438	Missing Tree		-	-	-	-	-	-	-	-	*
T 439	Missing Tree		-	-	-	-	-	-	-	-	*
T 440	Dead Tree	死樹	-	-	-	-	-	-	-	-	
T 441	<i>Ficus hispida</i>	對葉榕	4	5	0.15	Fair	Fair	Low	High	Fell	
T 442	<i>Ficus hispida</i>	對葉榕	5	7	0.14	Fair	Fair	Low	High	Fell	
T 443	<i>Ficus hispida</i>	對葉榕	4	5	0.14	Poor	Poor	Low	Low	Retain	
T 444	<i>Ficus hispida</i>	對葉榕	4	7	0.14	Poor	Poor	Low	Low	Retain	
T 445	Missing Tree		-	-	-	-	-	-	-	-	*
T 446	<i>Ficus hispida</i>	對葉榕	6	5	0.2	Fair	Fair	Low	High	Fell	
T 447	<i>Ficus hispida</i>	對葉榕	6	6	0.21	Fair	Poor	Low	Low	Fell	
T 448	<i>Sterculia lanceolata</i>	假蘋果	6	4	0.14	Fair	Fair	Low	Low	Fell	
T 449	Missing Tree		-	-	-	-	-	-	-	-	*
T 450	Missing Tree		-	-	-	-	-	-	-	-	*
T 451	Missing Tree		-	-	-	-	-	-	-	-	*
T 452	Missing Tree		-	-	-	-	-	-	-	-	*
T 453	Missing Tree		-	-	-	-	-	-	-	-	*
T 454	Missing Tree		-	-	-	-	-	-	-	-	*
T 455	Missing Tree		-	-	-	-	-	-	-	-	*
T 456	Missing Tree		-	-	-	-	-	-	-	-	*

Notes: "*" - "Missing Trees" recorded under the Tree assessment schedule were felled with unknown reasons before the site was handed over to DSD's contractor.

Notes: "# " - Revise due to wrong identification

Tree Assessment Schedule

Surveyed by:

HK Landscaping Ltd.

Project Name:

Contract No. DC/2007/17

Drainage Improvement Works (KT-13)

Location:

Cheung Po, Ma On Kong, Yuen Long and San Tsuen

Date:

Apr-08

Tree No.	Species	Chinese Name	Overall Height (M)	Crown Spread (M)	Trunk Diameter (M)	Form	Health	Amenity value	Survival Rate after Transplanting	Approved Treatment	Remarks
	Scientific Name					Good / Fair / Poor	Good / Fair / Poor	High / Medium / Low	High / Medium / Low		
T 457	<i>Ligustrum sinense</i>	對葉榕	6	5	0.13	Fair	Fair	Low	Low	Fell	
T 458	<i>Ficus hispida</i>	對葉榕	6	5	0.15	Fair	Poor	Low	Low	Fell	
T 459	<i>Macaranga tanarius</i>	血桐	6	6	0.16	Fair	Poor	Low	Low	Fell	
T 460	<i>Ficus hispida</i>	對葉榕	6	6	0.17	Fair	Fair	Low	High	Fell	
T 461	<i>Ligustrum sinense</i>	山指甲	5	6	0.16	Poor	Poor	Low	Low	Fell	
T 462	<i>Litchi chinensis</i>	荔枝	3.5	3.5	0.13	Fair	Fair	Low	Medium	Retain	
T 463	<i>Clausena lansium</i>	黃皮	3.5	3.5	0.13	Fair	Fair	Low	Low	Retain	
T 464	<i>Clausena lansium</i>	黃皮	3.5	3.5	0.13	Fair	Fair	Low	Medium	Retain	
T 742	<i>Dimocarpus logan</i>	龍眼	8.5	8.5	0.38	Fair	Fair	Medium	Low	Retain	
T 920	<i>Macaranga tanarius</i>	血桐	4.5	2.5	0.18	Fair	Fair	Low	Low	Retain	
T 921	<i>Macaranga tanarius</i>	血桐	4.5	2	0.2	Fair	Fair	Low	Low	Retain	
T 922	<i>Aleurites molucana</i>	石栗	6	3.5	0.25	Fair	Fair	Low	Low	Retain	
T 923	<i>Ficus microcarpa</i>	細葉榕	6.5	3.5	0.27	Fair	Fair	Low	Low	Retain	
T 924	<i>Macaranga tanarius</i>	血桐	4	1.5	0.15	Fair	Fair	Low	Low	Retain	
T 925	<i>Aleurites molucana</i>	石栗	5	2.5	0.2	Fair	Fair	Low	Low	Retain	
T 926	<i>Macaranga tanarius</i>	血桐	3	1	0.15	Fair	Fair	Low	Low	Retain	
T 927	<i>Ficus microcarpa</i>	細葉榕	4.5	2	0.23	Fair	Fair	Low	Low	Retain	
T 928	<i>Koelreuteria formosana</i>	台灣欒	5.5	3.5	0.2	Fair	Fair	Low	Low	Retain	
T 929	<i>Spathodea campanulata</i>	火焰木	4.5	4.5	0.16	Fair	Fair	Low	Low	Retain	
T 930	<i>Ficus microcarpa</i>	細葉榕	5.5	5.5	0.23	Fair	Fair	Low	Low	Retain	
T 931	Missing Tree		-	-	-	-	-	-	-	-	*
T 932	Missing Tree		-	-	-	-	-	-	-	-	*
T 933	Missing Tree		-	-	-	-	-	-	-	-	*
T 934	Missing Tree		-	-	-	-	-	-	-	-	*
T 935	<i>Osmanthus matsumuranus</i>	牛矢果	4.5	4.5	0.13	Fair	Fair	Low	Low	Retain	

Notes: " * " - "Missing Trees" recorded under the Tree assessment schedule were felled with unknown reasons before the site was handed over to DSD's contractor.

Notes: " # " - Revise due to wrong identification

Tree Assessment Schedule

Surveyed by:

HK Landscaping Ltd.

Project Name:

Contract No. DC/2007/17

Drainage Improvement Works (KT-13)

Location:

Cheung Po, Ma On Kong, Yuen Long and San Tsuen

Date:

Apr-08

Tree No.	Species	Chinese Name	Overall Height (M)	Tree Size Crown Spread (M)	Trunk Diameter (M)	Form Good / Fair / Poor	Health Good / Fair / Poor	Amenity value High / Medium / Low	Survival Rate after Transplanting High / Medium / Low	Approved Treatment	Remarks
T 936	Missing Tree		-	-	-	-	-	-	-	-	*
T 937	Missing Tree		-	-	-	-	-	-	-	-	*
T 938	<i>Alstonia scholaris</i>	黑板木	3	3	0.12	Fair	Fair	Low	Low	Retain	
T 939	<i>Dimocarpus logan</i>	龍眼	5.5	5.5	0.2	Fair	Fair	Low	Low	Retain	
T 940	Missing Tree		-	-	-	-	-	-	-	-	*
T 941	Missing Tree		-	-	-	-	-	-	-	-	*
T 942	Missing Tree		-	-	-	-	-	-	-	-	*
T 943	Missing Tree		-	-	-	-	-	-	-	-	*
T 944	Missing Tree		-	-	-	-	-	-	-	-	*
T 951	<i>Sapium sebiferum</i>	烏柏	5	3	0.23	Fair	Fair	Low	Low	Retain	
T 952	<i>Sapium sebiferum</i>	烏柏	4	2	0.16	Poor	Poor	Fair	Fair	Retain	
T 953	<i>Sapium sebiferum</i>	烏柏	5	0	0.3	Fair	Fair	Low	Low	Retain	
T 954	Missing Tree		-	-	-	-	-	-	-	-	*
T 955	Missing Tree		-	-	-	-	-	-	-	-	*
T 956	<i>Sapium sebiferum</i>	烏柏	3.5	0	0.21	Fair	Fair	Low	Low	Fell	
T 957	<i>Sapium sebiferum</i>	烏柏	4.5	0	0.23	Fair	Fair	Low	Low	Fell	
T 958	Missing Tree		-	-	-	-	-	-	-	-	*
T 959	Missing Tree		-	-	-	-	-	-	-	-	*
T 960	Missing Tree		-	-	-	-	-	-	-	-	*
T 961	Missing Tree		-	-	-	-	-	-	-	-	*
T 962	Missing Tree		-	-	-	-	-	-	-	-	*
T 963	Missing Tree		-	-	-	-	-	-	-	-	*

Notes: "*" - "Missing Trees" recorded under the Tree assessment schedule were felled with unknown reasons before the site was handed over to DSD's contractor.

Notes: "#" - Revise due to wrong identification

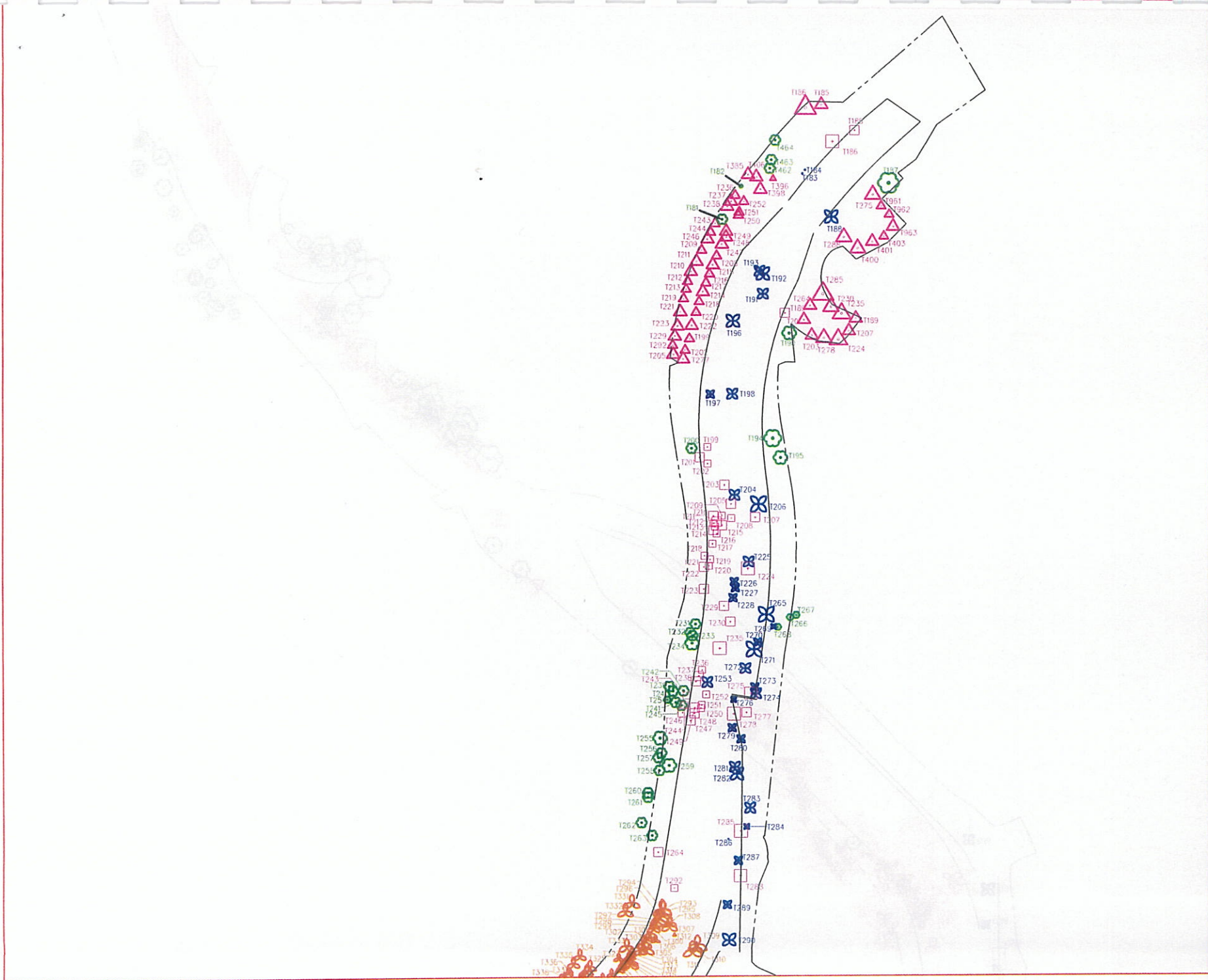

- LEGEND:**
- ▴ EXISTING TREE TO BE TRANSPLANTED
 - PROPOSED LOCATION FOR TRANSPLANTED TREE
 - ⊙ EXISTING TREE TO BE RETAINED
 - ✕ EXISTING TREE TO BE FELLED
 - EXISTING TREE TO BE RELOCATED BY NURSERY OWNER



CONTRACT NO. DC/2007/17

PROJECT TITLE
合約項目
DRAINAGE IMPROVEMENT WORKS IN CHEUNG PO MA ON KONG, YUEN KONG SAN TSUEN AND TIN SAM TSUEN OF YUEN LONG DISTRICT AND SEWERAGE AT TSANG TAU CHUNG TSUEN, YUEN MUN

DRAWING TITLE
圖名
LOCATION PLAN OF INITIAL TREE AT KT-13

DATE: 2007-05-08	SCALE: 1:500	SHEET NO. OF TOTAL SHEETS: 1 OF 3
DESIGNED BY: [Name]	CHECKED BY: [Name]	DATE OF PLOT: 20-05-08
© COPYRIGHT RESERVED		

LEGEND:

- EXISTING TREE TO BE TRANSPLANTED
- △ PROPOSED LOCATION FOR TRANSPLANTED TREE
- ⊗ EXISTING TREE TO BE RETAINED
- ⊗ EXISTING TREE TO BE FELLED
- ⊗ EXISTING TREE TO BE RELOCATED BY NURSERY OWNER



香港特別行政區政府渠務署
THE GOVERNMENT OF THE HONG KONG SPECIAL ADMINISTRATIVE REGION
DRAINAGE SERVICES DEPARTMENT

BLACK & VEATCH HONG KONG LIMITED
博威工程顧問有限公司

CHINA ROAD AND BRIDGE CORPORATION
中國路橋工程有限責任公司

CONTRACT NO. DC/2007/17





CONTRACT TITLE
合約名稱
DRAINAGE IMPROVEMENT WORKS IN CHEUNG PO, MA ON KONG, YUEN KONG SAN TSUEN AND TIN SAM TSUEN OF YUEN LONG DISTRICT AND SEWERAGE AT TSENG TAU, CHUNG TSUEN, TIEN MUN

DRAWING TITLE
圖名
LOCATION PLAN OF INITIAL TREE AT KT-13

DATE OF ISSUE
出圖日期
30-09-08
DRAWN BY
繪圖人
CHECKED BY
校核人
METRES
公尺
COPYRIGHT RESERVED
版權保留



LEGEND:

-  EXISTING TREE TO BE TRANSPLANTED
-  PROPOSED LOCATION FOR TRANSPLANTED TREE
-  EXISTING TREE TO BE RETAINED
-  EXISTING TREE TO BE FELLED
-  EXISTING TREE TO BE RELOCATED BY NURSERY OWNER

 香港特別行政區政府渠務署
THE GOVERNMENT OF THE HONG KONG SPECIAL ADMINISTRATIVE REGION
DRAINAGE SERVICES DEPARTMENT

 BLACK & VEATCH HONG KONG LIMITED
博威工程顧問有限公司

 CHINA ROAD AND BRIDGE CORPORATION
中國路桥工程有限責任公司

CONTRACT NO. DC/2007/17

CONTRACT TITLE
合約項目
DRAINAGE IMPROVEMENT WORKS IN CHEUNG PO, MA ON KONG, YUEN KONG SAN TSUEN AND TIN SAM TSUEN OF YUEN LONG DISTRICT AND SEWERAGE AT TSENG TAU, CHUNG TSUEN, TIEN MUN

MAP TITLE
圖名
LOCATION PLAN OF INITIAL TREE AT KT-13

SCALE 1:1000	DATE OF ISSUE 30-05-08
DESIGNED BY MTS	CHECKED BY
DATE OF ISSUE 30-05-08	DATE OF ISSUE 30-05-08
APPROVED BY	DATE OF ISSUE 30-05-08
DATE OF ISSUE 30-05-08	DATE OF ISSUE 30-05-08

COPYRIGHT RESERVED
版權所有



香港綠化工程有限公司
Hong Kong Landscaping Co., Ltd.

Contract No. DC/2007/17

Drainage Improvement works in Cheung Po,

Ma On Kong, Yuen Long, San Tsuen

Location: Cheung Po, Ma On Kong,

Yuen Long San Tsuen

Tree Report For The Month of April 2008

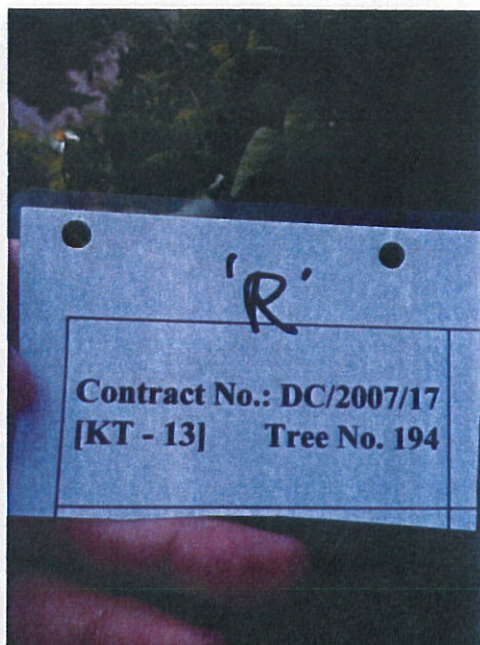

T 194

14/7/2008



香港綠化工程有限公司
Hong Kong Landscaping Co., Ltd.

Contract No. DC/2007/17

Drainage Improvement works in Cheung Po,

Ma On Kong, Yuen Long, San Tsuen

Location: Cheung Po, Ma On Kong,

Yuen Long San Tsuen

Tree Report For The Month of April 2008



1195

T 195

14/7/2008



Contract No. DC/2007/17

Drainage Improvement works in Cheung Po,

Ma On Kong, Yuen Long, San Tsuen

Location: Cheung Po, Ma On Kong,

Yuen Long San Tsuen

Tree Report For The Month of April 2008



1196

T 196
14/7/2008



香港綠化工程有限公司
Hong Kong Landscaping Co., Ltd.

Contract No. DC/2007/17

Drainage Improvement works in Cheung Po,

Ma On Kong, Yuen Long, San Tsuen

Location: Cheung Po, Ma On Kong,

Yuen Long San Tsuen

Tree Report For The Month of April 2008



1197

T 197

14/7/2008



香港綠化工程有限公司
Hong Kong Landscaping Co., Ltd.

Contract No. DC/2007/17

Drainage Improvement works in Cheung Po,

Ma On Kong, Yuen Long, San Tsuen

Location: Cheung Po, Ma On Kong,

Yuen Long San Tsuen

Tree Report For The Month of April 2008

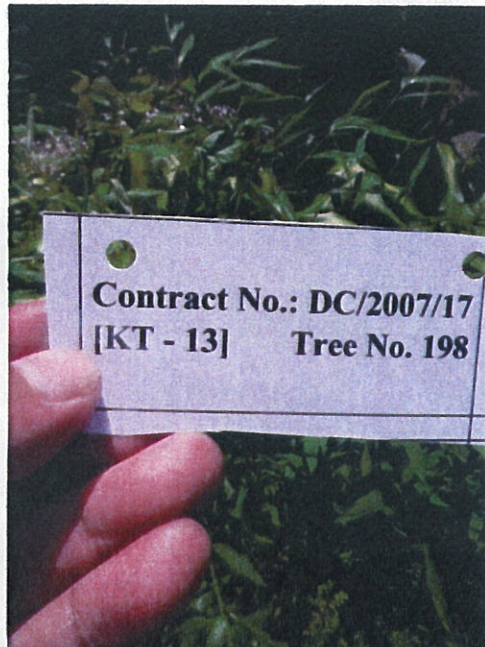

198

T 198

14/7/2008



香港綠化工程有限公司
Hong Kong Landscaping Co., Ltd.

Contract No. DC/2007/17

Drainage Improvement works in Cheung Po,

Ma On Kong, Yuen Long, San Tsuen

Location: Cheung Po, Ma On Kong,

Yuen Long San Tsuen

Tree Report For The Month of April 2008



T 390, T391, T392

5/8/2008

1390

1391

1392



香港綠化工程有限公司
Hong Kong Landscaping Co., Ltd.

Contract No. DC/2007/17

Drainage Improvement works in Cheung Po,

Ma On Kong, Yuen Long, San Tsuen

Location: Cheung Po, Ma On Kong,

Yuen Long San Tsuen

Tree Report For The Month of April 2008



T 393, T394, T395

5/8/2008

T393

T394

T395



香港綠化工程有限公司
Hong Kong Landscaping Co., Ltd.



Contract No. DC/2007/17

Drainage Improvement works in Cheung Po,

Ma On Kong, Yuen Long, San Tsuen

Location: Cheung Po, Ma On Kong,

Yuen Long San Tsuen

Tree Report For The Month of April 2008



T 396
31/7/2008

T396



Contract No. DC/2007/17

Drainage Improvement works in Cheung Po,

Ma On Kong, Yuen Long, San Tsuen

Location: Cheung Po, Ma On Kong,

Yuen Long San Tsuen

Tree Report For The Month of April 2008



T 402

14/7/2008

7402



香港綠化工程有限公司
Hong Kong Landscaping Co., Ltd.

Contract No. DC/2007/17

Drainage Improvement works in Cheung Po,

Ma On Kong, Yuen Long, San Tsuen

Location: Cheung Po, Ma On Kong,

Yuen Long San Tsuen

Tree Report For The Month of April 2008

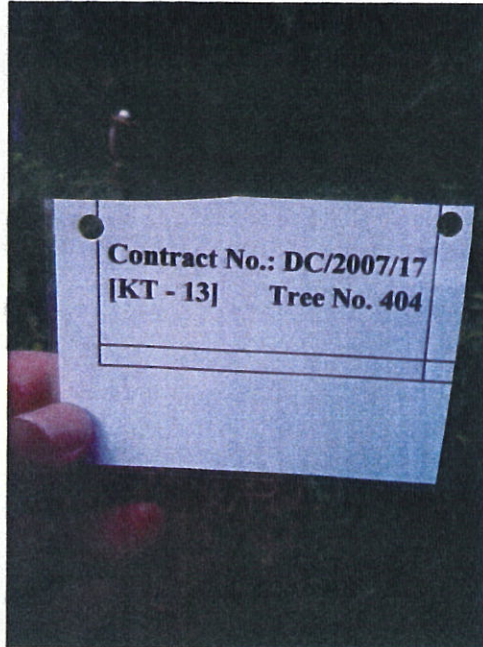

T 404
14/7/2008

T404



香港綠化工程有限公司
Hong Kong Landscaping Co., Ltd.

\Contract No. DC/2007/17

Drainage Improvement works in Cheung Po,

Ma On Kong, Yuen Long, San Tsuen

Location: Cheung Po, Ma On Kong,

Yuen Long San Tsuen

Tree Report For The Month of April 2008

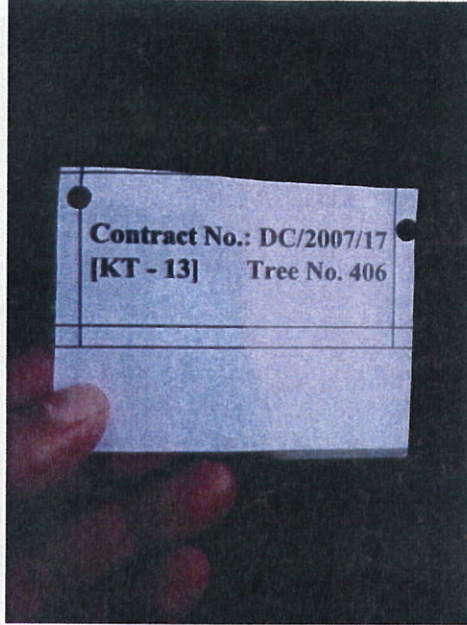

T 406
14/7/2008



香港綠化工程有限公司
Hong Kong Landscaping Co., Ltd.

Contract No. DC/2007/17

Drainage Improvement works in Cheung Po,

Ma On Kong, Yuen Long, San Tsuen

Location: Cheung Po, Ma On Kong,

Yuen Long San Tsuen

Tree Report For The Month of April 2008

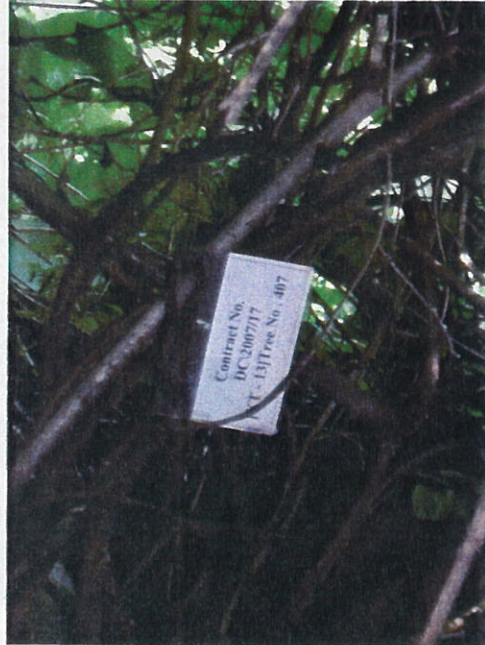

T 407
14/7/2008

1401



香港綠化工程有限公司
Hong Kong Landscaping Co., Ltd.

Contract No. DC/2007/17

Drainage Improvement works in Cheung Po,

Ma On Kong, Yuen Long, San Tsuen

Location: Cheung Po, Ma On Kong,

Yuen Long San Tsuen

Tree Report For The Month of April 2008



T 408
14/7/2008

1408



香港綠化工程有限公司
Hong Kong Landscaping Co., Ltd.

Contract No. DC/2007/17

Drainage Improvement works in Cheung Po,

Ma On Kong, Yuen Long, San Tsuen

Location: Cheung Po, Ma On Kong,

Yuen Long San Tsuen

Tree Report For The Month of April 2008



T 409
14/7/2008

7409



香港綠化工程有限公司
Hong Kong Landscaping Co., Ltd.

Contract No. DC/2007/17

Drainage Improvement works in Cheung Po,

Ma On Kong, Yuen Long, San Tsuen

Location: Cheung Po, Ma On Kong,

Yuen Long San Tsuen

Tree Report For The Month of April 2008

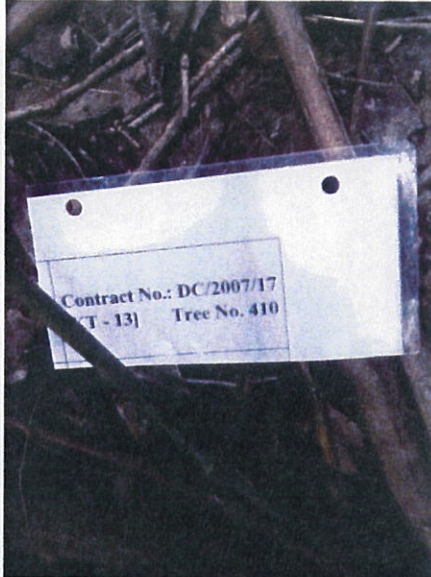

T 410

14/7/2008

410



香港綠化工程有限公司
Hong Kong Landscaping Co., Ltd.

Contract No. DC/2007/17

Drainage Improvement works in Cheung Po,

Ma On Kong, Yuen Long, San Tsuen

Location: Cheung Po, Ma On Kong,

Yuen Long San Tsuen

Tree Report For The Month of April 2008

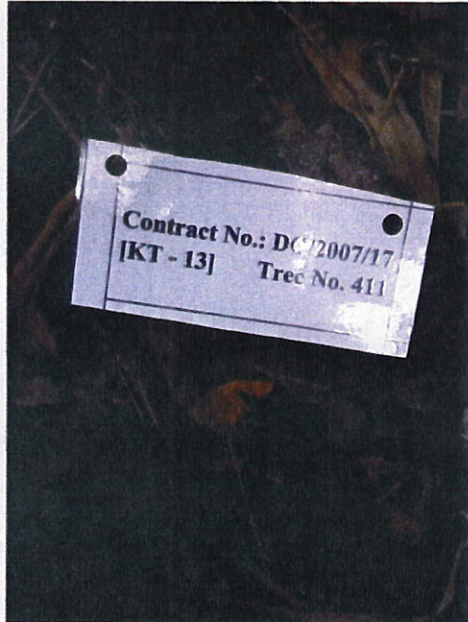

T411

T 411

14/7/2008



香港綠化工程有限公司
Hong Kong Landscaping Co., Ltd.

Contract No. DC/2007/17

Drainage Improvement works in Cheung Po,

Ma On Kong, Yuen Long, San Tsuen

Location: Cheung Po, Ma On Kong,

Yuen Long San Tsuen

Tree Report For The Month of April 2008



1413

T 413
14/7/2008



香港綠化工程有限公司
Hong Kong Landscaping Co., Ltd.

Contract No. DC/2007/17

Drainage Improvement works in Cheung Po,

Ma On Kong, Yuen Long, San Tsuen

Location: Cheung Po, Ma On Kong,

Yuen Long San Tsuen

Tree Report For The Month of April 2008



T 414

14/7/2008

T414



香港綠化工程有限公司
Hong Kong Landscaping Co., Ltd.

Contract No. DC/2007/17

Drainage Improvement works in Cheung Po,

Ma On Kong, Yuen Long, San Tsuen

Location: Cheung Po, Ma On Kong,

Yuen Long San Tsuen

Tree Report For The Month of April 2008



T 416
14/7/2008

T416



香港綠化工程有限公司
Hong Kong Landscaping Co., Ltd.

Contract No. DC/2007/17

Drainage Improvement works in Cheung Po,

Ma On Kong, Yuen Long, San Tsuen

Location: Cheung Po, Ma On Kong,

Yuen Long San Tsuen

Tree Report For The Month of April 2008



1417

T 417

14/7/2008



香港綠化工程有限公司
Hong Kong Landscaping Co., Ltd.

Contract No. DC/2007/17

Drainage Improvement works in Cheung Po,

Ma On Kong, Yuen Long, San Tsuen

Location: Cheung Po, Ma On Kong,

Yuen Long San Tsuen

Tree Report For The Month of April 2008



T 418
14/7/2008



香港綠化工程有限公司
Hong Kong Landscaping Co., Ltd.

Contract No. DC/2007/17

Drainage Improvement works in Cheung Po,

Ma On Kong, Yuen Long, San Tsuen

Location: Cheung Po, Ma On Kong,

Yuen Long San Tsuen

Tree Report For The Month of April 2008



419

T 419
14/7/2008



香港綠化工程有限公司
Hong Kong Landscaping Co., Ltd.

Contract No. DC/2007/17

Drainage Improvement works in Cheung Po,

Ma On Kong, Yuen Long, San Tsuen

Location: Cheung Po, Ma On Kong,

Yuen Long San Tsuen

Tree Report For The Month of April 2008



T 420
14/7/2008

1420



香港綠化工程有限公司
Hong Kong Landscaping Co., Ltd.

Contract No. DC/2007/17

Drainage Improvement works in Cheung Po,

Ma On Kong, Yuen Long, San Tsuen

Location: Cheung Po, Ma On Kong,

Yuen Long San Tsuen

Tree Report For The Month of April 2008



T421

T 421

14/7/2008



香港綠化工程有限公司
Hong Kong Landscaping Co., Ltd.

Contract No. DC/2007/17

Drainage Improvement works in Cheung Po,

Ma On Kong, Yuen Long, San Tsuen

Location: Cheung Po, Ma On Kong,

Yuen Long San Tsuen

Tree Report For The Month of April 2008



1422

ESI T 422
14/7/2008



香港綠化工程有限公司
Hong Kong Landscaping Co., Ltd.

Contract No. DC/2007/17

Drainage Improvement works in Cheung Po,

Ma On Kong, Yuen Long, San Tsuen

Location: Cheung Po, Ma On Kong,

Yuen Long San Tsuen

Tree Report For The Month of April 2008

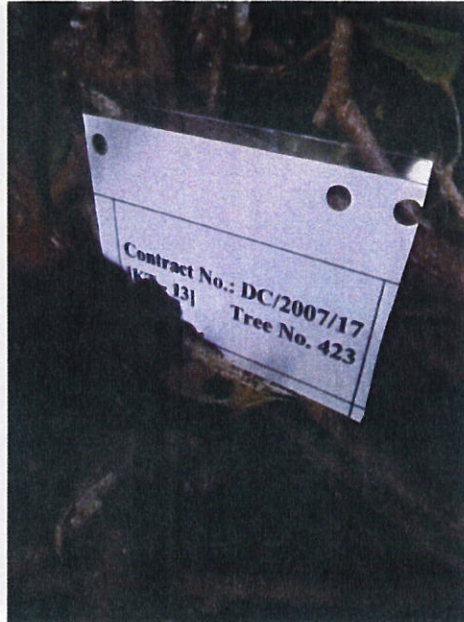

1423

T 423

14/7/2008



香港綠化工程有限公司
Hong Kong Landscaping Co., Ltd.

Contract No. DC/2007/17

Drainage Improvement works in Cheung Po,

Ma On Kong, Yuen Long, San Tsuen

Location: Cheung Po, Ma On Kong,

Yuen Long San Tsuen

Tree Report For The Month of April 2008



T 424

T 424

14/7/2008



香港綠化工程有限公司
Hong Kong Landscaping Co., Ltd.



Contract No. DC/2007/17

Drainage Improvement works in Cheung Po,

Ma On Kong, Yuen Long, San Tsuen

Location: Cheung Po, Ma On Kong,

Yuen Long San Tsuen

Tree Report For The Month of April 2008



T 425
14/7/2008

1425



香港綠化工程有限公司
Hong Kong Landscaping Co., Ltd.

Contract No. DC/2007/17

Drainage Improvement works in Cheung Po,

Ma On Kong, Yuen Long, San Tsuen

Location: Cheung Po, Ma On Kong,

Yuen Long San Tsuen

Tree Report For The Month of April 2008

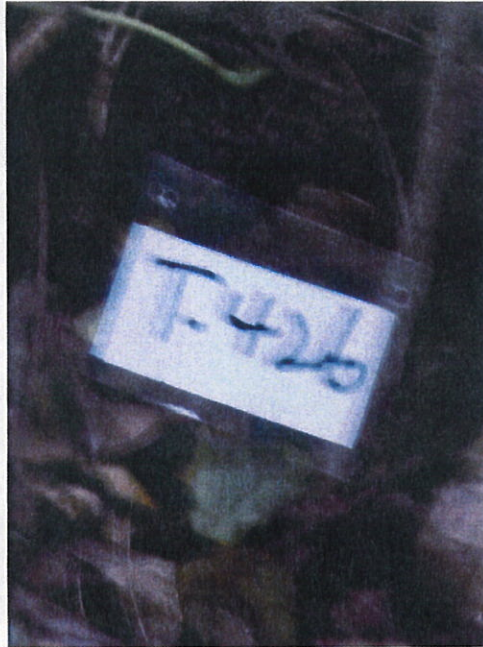

T426

T 426
12/7/2008



香港綠化工程有限公司
Hong Kong Landscaping Co., Ltd.

Contract No. DC/2007/17

Drainage Improvement works in Cheung Po,

Ma On Kong, Yuen Long, San Tsuen

Location: Cheung Po, Ma On Kong,

Yuen Long San Tsuen

Tree Report For The Month of April 2008



T 427
14/7/2008

T427



香港綠化工程有限公司
Hong Kong Landscaping Co., Ltd.

Contract No. DC/2007/17

Drainage Improvement works in Cheung Po,

Ma On Kong, Yuen Long, San Tsuen

Location: Cheung Po, Ma On Kong,

Yuen Long San Tsuen

Tree Report For The Month of April 2008



T 428

14/7/2008



香港綠化工程有限公司
Hong Kong Landscaping Co., Ltd.

Contract No. DC/2007/17

Drainage Improvement works in Cheung Po,

Ma On Kong, Yuen Long, San Tsuen

Location: Cheung Po, Ma On Kong,

Yuen Long San Tsuen

Tree Report For The Month of April 2008

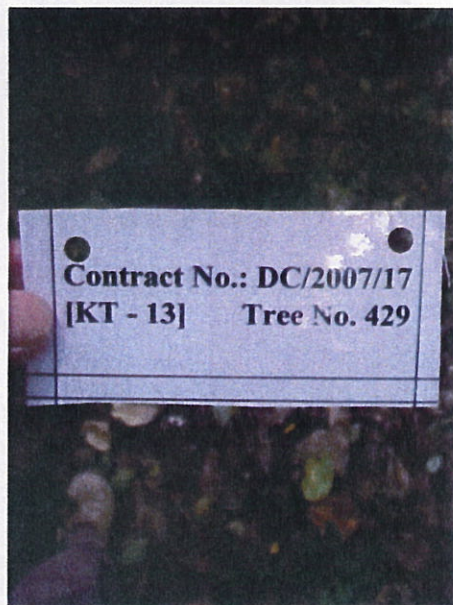

7429

T 429

14/7/2008



香港綠化工程有限公司
Hong Kong Landscaping Co., Ltd.

Contract No. DC/2007/17

Drainage Improvement works in Cheung Po,

Ma On Kong, Yuen Long, San Tsuen

Location: Cheung Po, Ma On Kong,

Yuen Long San Tsuen

Tree Report For The Month of April 2008

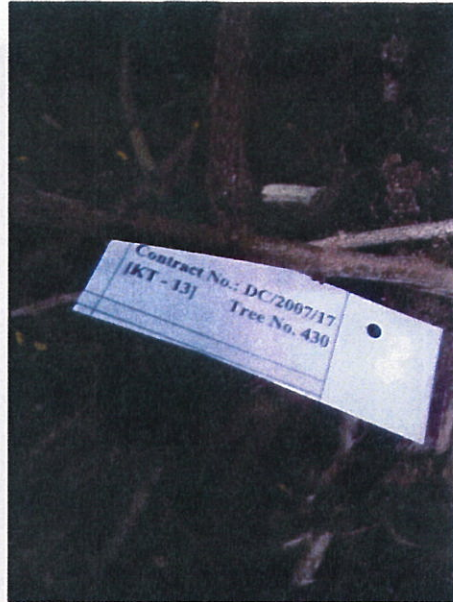

T 430

14/7/2008



香港綠化工程有限公司
Hong Kong Landscaping Co., Ltd.

Contract No. DC/2007/17

Drainage Improvement works in Cheung Po,

Ma On Kong, Yuen Long, San Tsuen

Location: Cheung Po, Ma On Kong,

Yuen Long San Tsuen

Tree Report For The Month of April 2008

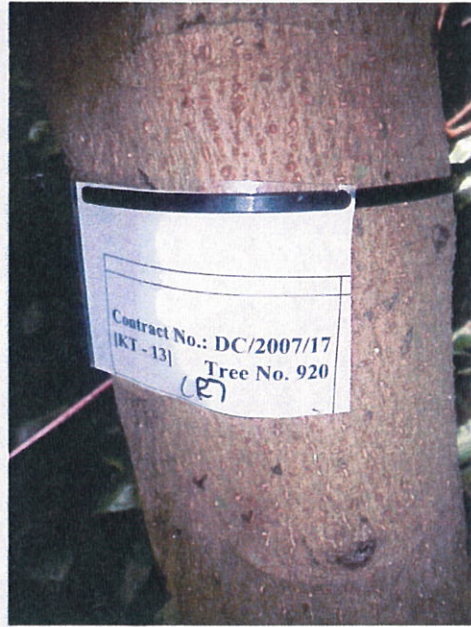

T920

T 920

14/7/2008



Contract No. DC/2007/17

Drainage Improvement works in Cheung Po,

Ma On Kong, Yuen Long, San Tsuen

Location: Cheung Po, Ma On Kong,

Yuen Long San Tsuen

Tree Report For The Month of April 2008

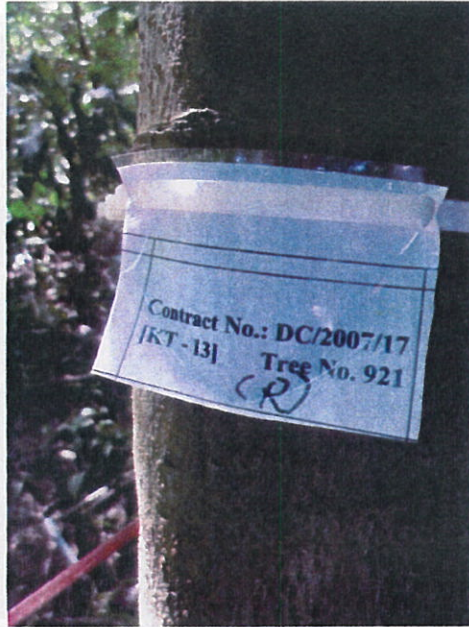

T 921

14/7/2008



香港綠化工程有限公司
Hong Kong Landscaping Co., Ltd.

Contract No. DC/2007/17

Drainage Improvement works in Cheung Po,

Ma On Kong, Yuen Long, San Tsuen

Location: Cheung Po, Ma On Kong,

Yuen Long San Tsuen

Tree Report For The Month of April 2008

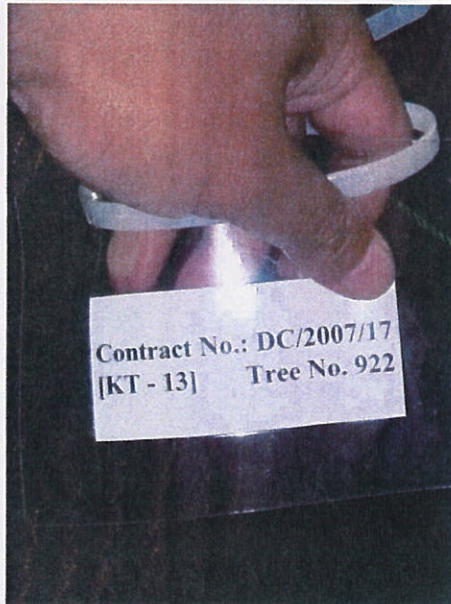

922

T 922
14/7/2008



香港綠化工程有限公司
Hong Kong Landscaping Co., Ltd.

Contract No. DC/2007/17

Drainage Improvement works in Cheung Po,

Ma On Kong, Yuen Long, San Tsuen

Location: Cheung Po, Ma On Kong,

Yuen Long San Tsuen

Tree Report For The Month of April 2008



T 923

T 923

14/7/2008



香港綠化工程有限公司
Hong Kong Landscaping Co., Ltd.

Contract No. DC/2007/17

Drainage Improvement works in Cheung Po,

Ma On Kong, Yuen Long, San Tsuen

Location: Cheung Po, Ma On Kong,

Yuen Long San Tsuen

Tree Report For The Month of April 2008



T 924
14/7/2008



香港綠化工程有限公司
Hong Kong Landscaping Co., Ltd.

Contract No. DC/2007/17

Drainage Improvement works in Cheung Po,

Ma On Kong, Yuen Long, San Tsuen

Location: Cheung Po, Ma On Kong,

Yuen Long San Tsuen

Tree Report For The Month of April 2008

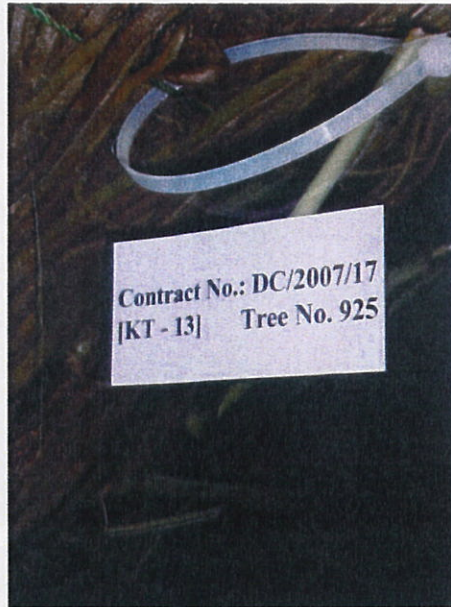

1925

T 925

14/7/2008



香港綠化工程有限公司
Hong Kong Landscaping Co., Ltd.

Contract No. DC/2007/17

Drainage Improvement works in Cheung Po,

Ma On Kong, Yuen Long, San Tsuen

Location: Cheung Po, Ma On Kong,

Yuen Long San Tsuen

Tree Report For The Month of April 2008



T 926

T 926

14/7/2008



香港綠化工程有限公司
Hong Kong Landscaping Co., Ltd.

14/7/2008

Contract No. DC/2007/17

Drainage Improvement works in Cheung Po,

Ma On Kong, Yuen Long, San Tsuen

Location: Cheung Po, Ma On Kong,

Yuen Long San Tsuen

Tree Report For The Month of April 2008



1927

T 927
14/7/2008



香港綠化工程有限公司
Hong Kong Landscaping Co., Ltd.

Contract No. DC/2007/17

Drainage Improvement works in Cheung Po,

Ma On Kong, Yuen Long, San Tsuen

Location: Cheung Po, Ma On Kong,

Yuen Long San Tsuen

Tree Report For The Month of April 2008



T 928

14/7/2008

1928



香港綠化工程有限公司
Hong Kong Landscaping Co., Ltd.

Contract No. DC/2007/17

Drainage Improvement works in Cheung Po,

Ma On Kong, Yuen Long, San Tsuen

Location: Cheung Po, Ma On Kong,

Yuen Long San Tsuen

Tree Report For The Month of April 2008



T 929
14/7/2008

1929



香港綠化工程有限公司
Hong Kong Landscaping Co., Ltd.

Contract No. DC/2007/17

Drainage Improvement works in Cheung Po,

Ma On Kong, Yuen Long, San Tsuen

Location: Cheung Po, Ma On Kong,

Yuen Long San Tsuen

Tree Report For The Month of April 2008



1930

T 930
14/7/2008



香港綠化工程有限公司
Hong Kong Landscaping Co., Ltd.

14/7/2008

Contract No. DC/2007/17

Drainage Improvement works in Cheung Po,

Ma On Kong, Yuen Long, San Tsuen

Location: Cheung Po, Ma On Kong,

Yuen Long San Tsuen

Tree Report For The Month of April 2008



T931

T932



香港綠化工程有限公司
Hong Kong Landscaping Co., Ltd.



Contract No. DC/2007/17

Drainage Improvement works in Cheung Po,

Ma On Kong, Yuen Long, San Tsuen

Location: Cheung Po, Ma On Kong,

Yuen Long San Tsuen

Tree Report For The Month of April 2008



1933

1934



香港綠化工程有限公司
Hong Kong Landscaping Co., Ltd.

Contract No. DC/2007/17

Drainage Improvement works in Cheung Po,

Ma On Kong, Yuen Long, San Tsuen

Location: Cheung Po, Ma On Kong,

Yuen Long San Tsuen

Tree Report For The Month of April 2008

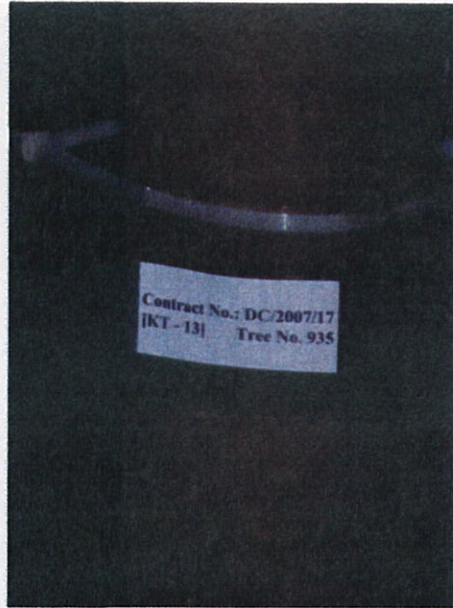

T 935
14/7/2008

1935



香港綠化工程有限公司
Hong Kong Landscaping Co., Ltd.

Contract No. DC/2007/17

Drainage Improvement works in Cheung Po,

Ma On Kong, Yuen Long, San Tsuen

Location: Cheung Po, Ma On Kong,

Yuen Long San Tsuen

Tree Report For The Month of April 2008

7936

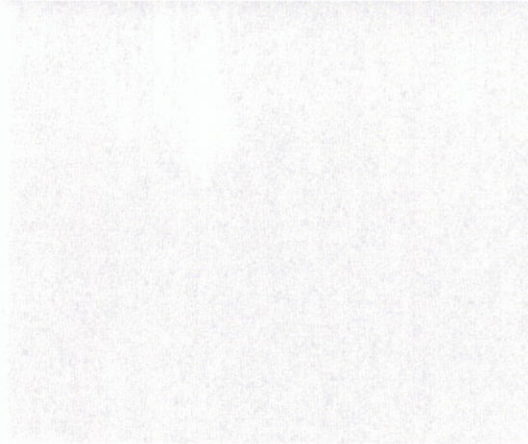



香港綠化工程有限公司
Hong Kong Landscaping Co., Ltd.

Contract No. DC/2007/17

Drainage Improvement works in Cheung Po,

Ma On Kong, Yuen Long, San Tsuen

Location: Cheung Po, Ma On Kong,

Yuen Long San Tsuen

Tree Report For The Month of April 2008

1937



T 937
14/7/2008



香港綠化工程有限公司
Hong Kong Landscaping Co., Ltd.

Contract No. DC/2007/17

Drainage Improvement works in Cheung Po,

Ma On Kong, Yuen Long, San Tsuen

Location: Cheung Po, Ma On Kong,

Yuen Long San Tsuen

Tree Report For The Month of April 2008



T 938
14/7/2008

1938



香港綠化工程有限公司
Hong Kong Landscaping Co., Ltd.

Contract No. DC/2007/17

Drainage Improvement works in Cheung Po,

Ma On Kong, Yuen Long, San Tsuen

Location: Cheung Po, Ma On Kong,

Yuen Long San Tsuen

Tree Report For The Month of April 2008



1939

T 939

14/7/2008



香港綠化工程有限公司
Hong Kong Landscaping Co., Ltd.

Contract No. DC/2007/17

Drainage Improvement works in Cheung Po,

Ma On Kong, Yuen Long, San Tsuen

Location: Cheung Po, Ma On Kong,

Yuen Long San Tsuen

Tree Report For The Month of April 2008

T940

T941

T942



T 940 , T941 , T942
14/7/2008



香港綠化工程有限公司
Hong Kong Landscaping Co., Ltd.

Contract No. DC/2007/17

Drainage Improvement works in Cheung Po,

Ma On Kong, Yuen Long, San Tsuen

Location: Cheung Po, Ma On Kong,

Yuen Long San Tsuen

Tree Report For The Month of April 2008



T 943, T 944

14/7/2008

1943

1944

1847

2008/07/14



香港綠化工程有限公司
Hong Kong Landscaping Co., Ltd.



Contract No. DC/2007/17

Drainage Improvement works in Cheung Po,

Ma On Kong, Yuen Long, San Tsuen

Location: Cheung Po, Ma On Kong,

Yuen Long San Tsuen

Tree Report For The Month of April 2008



T951

T 951
14/7/2008



香港綠化工程有限公司
Hong Kong Landscaping Co., Ltd.

Contract No. DC/2007/17

Drainage Improvement works in Cheung Po,

Ma On Kong, Yuen Long, San Tsuen

Location: Cheung Po, Ma On Kong,

Yuen Long San Tsuen

Tree Report For The Month of April 2008



T952

T 952
14/7/2008



香港綠化工程有限公司
Hong Kong Landscaping Co., Ltd.

Contract No. DC/2007/17

Drainage Improvement works in Cheung Po,

Ma On Kong, Yuen Long, San Tsuen

Location: Cheung Po, Ma On Kong,

Yuen Long San Tsuen

Tree Report For The Month of April 2008



1953

T 953

14/7/2008



香港綠化工程有限公司
Hong Kong Landscaping Co., Ltd.

Contract No. DC/2007/17

Drainage Improvement works in Cheung Po,

Ma On Kong, Yuen Long, San Tsuen

Location: Cheung Po, Ma On Kong,

Yuen Long San Tsuen

Tree Report For The Month of April 2008

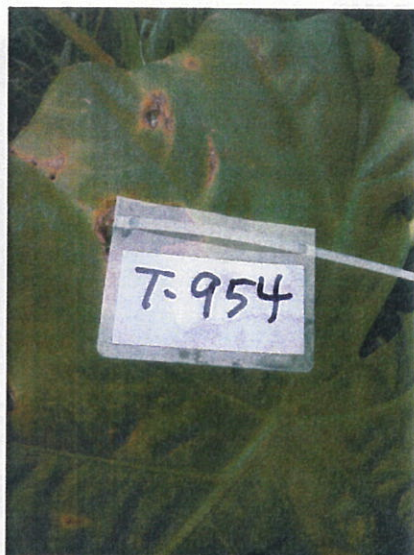

1934

T 954

12/7/2008



香港綠化工程有限公司
Hong Kong Landscaping Co., Ltd.

Contract No. DC/2007/17

Drainage Improvement works in Cheung Po,

Ma On Kong, Yuen Long, San Tsuen

Location: Cheung Po, Ma On Kong,

Yuen Long San Tsuen

Tree Report For The Month of April 2008



1955

T 955

14/7/2008



香港綠化工程有限公司
Hong Kong Landscaping Co., Ltd.

Contract No. DC/2007/17

Drainage Improvement works in Cheung Po,

Ma On Kong, Yuen Long, San Tsuen

Location: Cheung Po, Ma On Kong,

Yuen Long San Tsuen

Tree Report For The Month of April 2008



T 956

14/7/2008



香港綠化工程有限公司
Hong Kong Landscaping Co., Ltd.

Contract No. DC/2007/17

Drainage Improvement works in Cheung Po,

Ma On Kong, Yuen Long, San Tsuen

Location: Cheung Po, Ma On Kong,

Yuen Long San Tsuen

Tree Report For The Month of April 2008

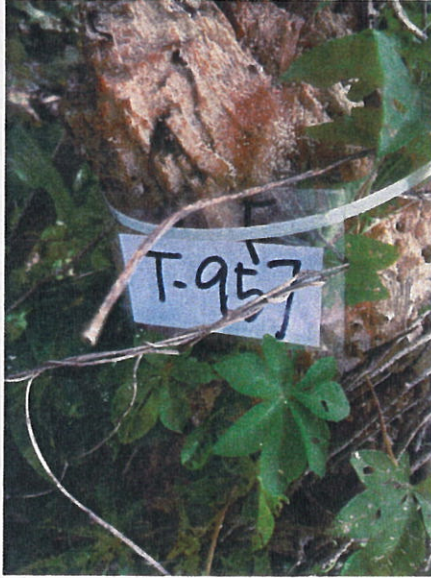

T 957

14/7/2008

1957



香港綠化工程有限公司
Hong Kong Landscaping Co., Ltd.



Contract No. DC/2007/17

Drainage Improvement works in Cheung Po,

Ma On Kong, Yuen Long, San Tsuen

Location: Cheung Po, Ma On Kong,

Yuen Long San Tsuen

Tree Report For The Month of April 2008



T 958

14/7/2008

7958



香港綠化工程有限公司
Hong Kong Landscaping Co., Ltd.



Contract No. DC/2007/17

Drainage Improvement works in Cheung Po,

Ma On Kong, Yuen Long, San Tsuen

Location: Cheung Po, Ma On Kong,

Yuen Long San Tsuen

Tree Report For The Month of April 2008



T 959

14/7/2008

7959



香港綠化工程有限公司
Hong Kong Landscaping Co., Ltd.

Contract No. DC/2007/17

Drainage Improvement works in Cheung Po,

Ma On Kong, Yuen Long, San Tsuen

Location: Cheung Po, Ma On Kong,

Yuen Long San Tsuen

Tree Report For The Month of April 2008



T 960

14/7/2008

7960



香港綠化工程有限公司
Hong Kong Landscaping Co., Ltd.

Contract No. DC/2007/17

Drainage Improvement works in Cheung Po,

Ma On Kong, Yuen Long, San Tsuen

Location: Cheung Po, Ma On Kong,

Yuen Long San Tsuen

Tree Report For The Month of April 2008



T 961
14/7/2008

7961



香港綠化工程有限公司
Hong Kong Landscaping Co., Ltd.

Contract No. DC/2007/17

Drainage Improvement works in Cheung Po,

Ma On Kong, Yuen Long, San Tsuen

Location: Cheung Po, Ma On Kong,

Yuen Long San Tsuen

Tree Report For The Month of April 2008



800 T 962

14/7/2008

1962



香港綠化工程有限公司
Hong Kong Landscaping Co., Ltd.

Contract No. DC/2007/17

Drainage Improvement works in Cheung Po,

Ma On Kong, Yuen Long, San Tsuen

Location: Cheung Po, Ma On Kong,

Yuen Long San Tsuen

Tree Report For The Month of April 2008



T963

T 963

14/7/2008

Annex B

Photographic Records

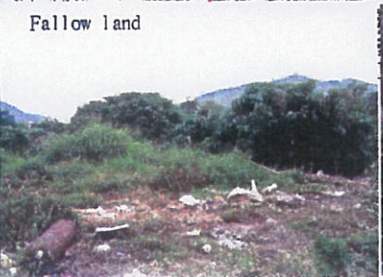
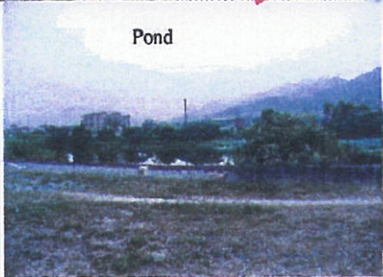

Annex C

Egretty Photos



Conditions of the two egrettries (the green circles indicate the locations of the nests in Ma On Kong Egretty)

Annex D
Habitat Map

LEGEND

- Bare Ground/Works in Progress
- Agricultural Land
- Fishpond
- Hillside Grassland
- Low-lying Grassland/Fallow Land
- Marsh
- Orchard/Horticultural Land
- River/Stream
- Shrubland
- Urban/Industrial Area
- Woodland
- Artificial Drainage Channel
- West Rail Alignment
- Wetland
- Alignment of KT13

--- Ecological Assessment Study Area
 (Area within 500m of proposed works)

Insert Map Legend

- Conservation Zone
- LIC River/Stream

	Design	Check	Drawn	Check
Initial	OV	MC	OV	MC
Date	05/06	05/06	05/06	05/06
Revision	Date	Description	Initial	
A	05/06	Insert added	MC	

Approved

AGREEMENT NO. CE67/98

Contract Title
**YUEN LONG, KAM TIN,
 NGAU TAM MEI AND
 TIN SHUI WAI
 DRAINAGE IMPROVEMENT
 STAGE 1**

Figure Title
Habitat Map for KT13

Drawing No. **4.1** Scale **1 : 8 000**

Client

Consultant

 Black & Veatch Hong Kong Limited
 博誠工程顧問有限公司

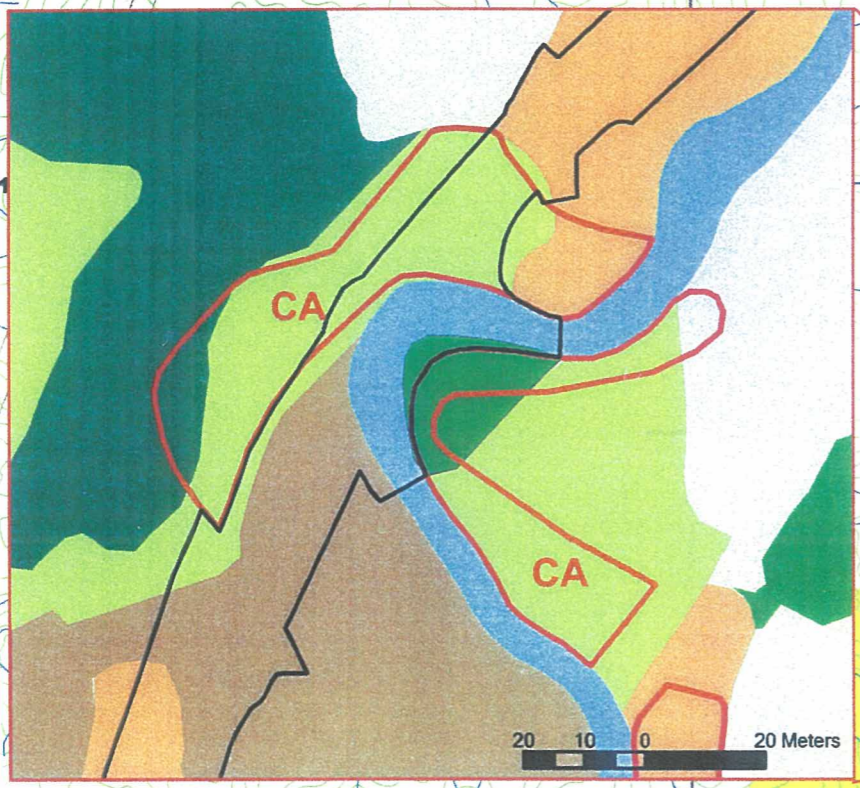
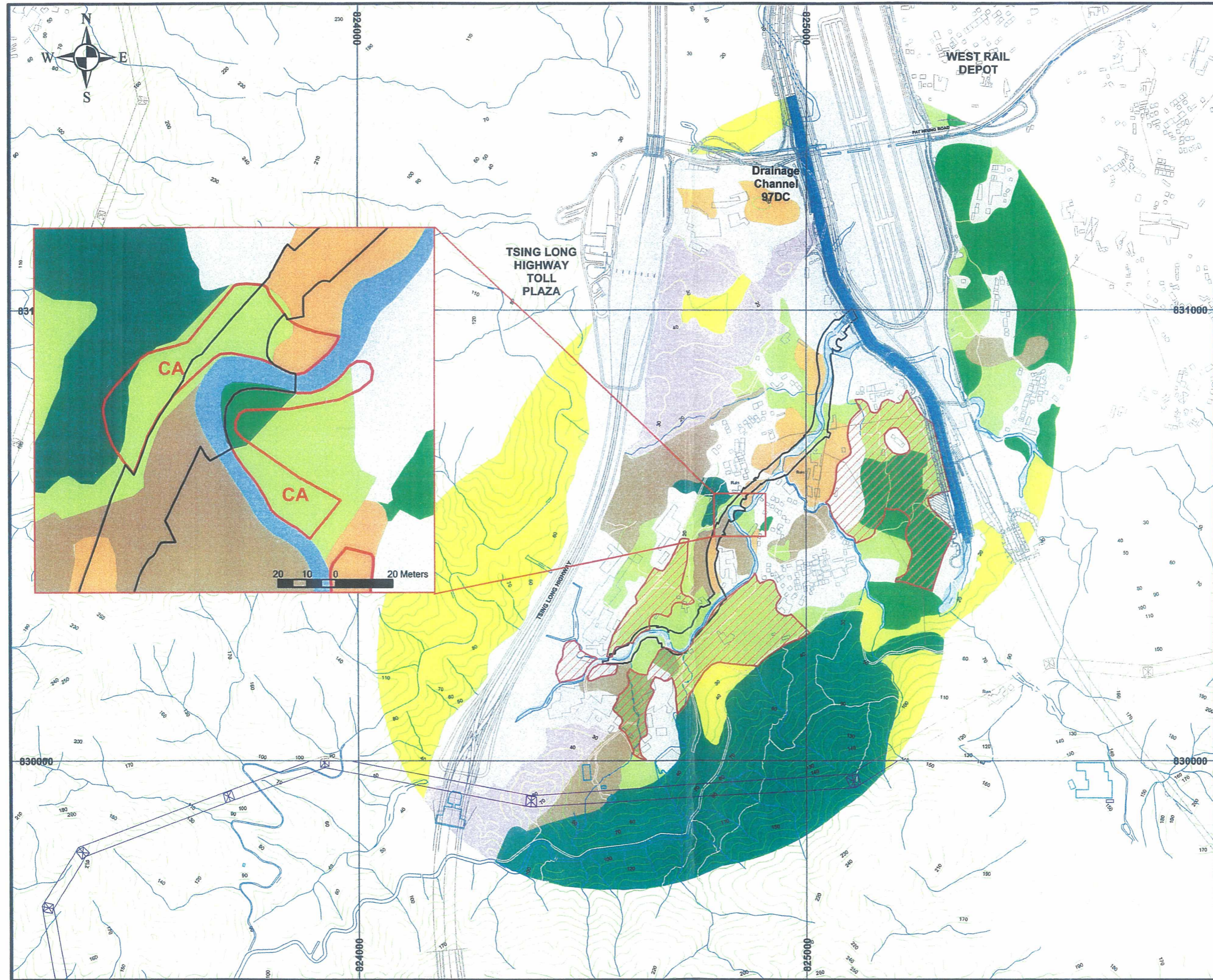

Annex E

Report for Special Survey on Ho Pui Egret



PROJECT No.: TCS/00408/08

**DSD CONTRACT NO. DC/2007/17
 DRAINAGE IMPROVEMENT WORKS IN CHEUNG PO,
 MA ON KONG, YUEN KONG SAN TSUEN AND TIN SAM
 TSUEN OF YUEN LONG DISTRICT AND SEWERAGE AT
 TSENG TAU CHUNG TSUEN, TUEN MUN**

**A REPORT FOR SPECIAL SURVEY ON HO PUI
 EGRETRY ON 31 MAY 2008 – KT13**

PREPARED FOR
 CHINA ROAD & BRIDGE CORPORATION

Quality Index

Date	Reference No.	Prepared By	Certified by	Approved By
		(Environmental Team Ecologist)	(Environmental Team Leader)	(Project Manager)
9 July 2008	TCS00408/08/600/R0210	 Vincent Lai	 FN Wong	 T.W. Tam

Rev.	Date	Prepared by:	Certified by:	Approved by:	Description
1	9 July 2008	Vincent Lai	FN Wong	T.W. Tam	First submission

This report has been prepared by Action-United Environmental Services & Consulting with all reasonable skill, care and diligence within the terms of the Agreement with the client, incorporating our General Terms and Conditions of Business and taking account of the resources devoted to it by agreement with the client. We disclaim any responsibility to the client and others in respect of any matters outside the scope of the above. This report is confidential to the client and we accept no responsibility of whatsoever nature to third parties to whom this report, or any part thereof, is made known. Any such party relies upon the report at their own risk.

CONTENT

1	INTRODUCTION	1
2	METHODOLOGY	2
3	RESULTS	3
4	CONCLUSIONS	4

1 INTRODUCTION

It is stated in the EP for KT13 that the monitoring of the Ho Pui egret shall be carried out during the period from 1st March to 31st August as specified in the EM&A Manual. If no egret nest is found at the egret during the period from 1st March to 31st May, the Permit Holder can start the construction works within 100m of the ecological buffer area upon obtaining the Director's approval until February in the next year. If egret nests are found during the period from 1st March to 31st August, no construction shall take place within 100m of the ecological buffer area before 1st October.

In addition, it is required in the EM&A manual that biweekly monitoring of the Ho Pui egret for the period from 1st March to end of May. Should no egret nest be found at the Ho Pui egret by the end of May, monitoring frequency from June to August can be downgraded to Monthly.

The construction works and associated impact monitoring programme for KT13 will be commenced in June 2008. In order to decide whether works could be conducted within the ecological buffer area till February next year and the monitoring frequency between June to August, it is needed to know the conditions of Ho Pui Egret before the construction works and impact monitoring formally commence.

As requested by IEC, a special egret survey was thus performed on 31st May 2008 to verify the conditions of the Ho Pui egret.

2 METHODOLOGY

All the four patches of trees forming the Ho Pui egretty were checked in close distance by eye as well as by binoculars. Counts were undertaken so as not to cause disturbance to nesting egrets; details of breeding stage were only collected where these can be undertaken with no additional disturbance being caused. In addition to Ho Pui egretty, the Ma On Kong egretty was also checked to provide reference information on the breeding egrets nearby.

3 RESULTS

No egret nests were found in Ho Pui egretty during the special survey. But two nests were observed in the Ma On Kong egretty. The two nests in Ma On Kong egretty are both Chinese Pond Heron. The breeding stage of the two nests could not be confirmed during the survey as the nests were blocked by other tree branches and the nesting egrets were not active probably due to the rainy weather conditions.

4 CONCLUSIONS

The two egrettries were also checked during the baseline monitoring survey for KT13. During which, however, no nesting egrets were found in Ho Pui egrettry and Ma On Kong egrettry.

In the present survey, there was still no nesting egret in Ho Pui egrettry, but two pairs were found in the reference site Ma On Kong egrettry. These two nests might be built recently after the baseline monitoring survey.

The Ho Pui egrettry indeed has no record of breeding egrets for years. It is considered as historical egrettry in a paper published by AFCD (Lee e al. 2007. Review of Egrettries in Hong Kong. *Hong Kong Biodiversity Issue* No.14)

As no egret was nesting in Ho Pui egrettry, construction works would be allowed to be conducted within the 100m ecological buffer area till February next year. And the monitoring frequency for egrettry in KT13 would be monthly between June to August 2008.

END OF TEXT