

305

304

306

302

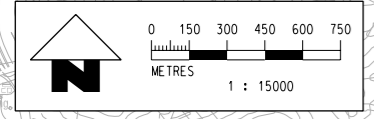

PLOT DRW: J:\SCL\PL01DR\HPLU-A3C.dwg
 MODELNAME: Default
 FILENAME: J:\MTR\23\DCN-CA\C8001_T_XRL_URB_C04_30A3.dgn
 15-Dec-2009 11:37:56

REV	DESCRIPTION	BY	DATE	APPROVED	REV	DESCRIPTION	BY	DATE	APPROVED
A3	THIRD ISSUE	SAN	15DEC09	AD					
A2	SECOND ISSUE	SAN	30JUN09	AD					
A1	DRAFT TREE SURVEY REPORT	SAN	21APR09	AD					

DRAWN	SAN
DESIGNED	JP
CHECKED	TO
APPROVED	AD
DATE	21.APR.2009

MTR

EXPRESS RAIL LINK (XRL)

ORIGINATOR

Planning, Urban Design, Landscape, Golf & Environmental Consultants
 Urbis Limited, 11/F Siu On Centre, 188 Lockhart Road, Wan Chai, Hong Kong.
 Tel 2802 3333 Fax 2802 8662

CADD REF. C8001_T_XRL_URB_C04_301A3.dgn

TITLE

CONSULTANCY AGREEMENT NO. C8001
TREE TRANSPLANTING / FELLING
TREE SURVEY KEYPLAN OF TSUEN WAN DISTRICT

SCALE 1:15000 @ A1

DRAWING NO. C8001/T/XRL/URB/C04/301

REV. A3

DO NOT SCALE DRAWINGS. ALL DIMENSIONS SHALL BE VERIFIED ON SITE.
 © MTR CORPORATION LIMITED 2008. COPYRIGHT IN RESPECT OF THIS DRAWING / DOCUMENT IS OWNED BY THE MTR CORPORATION LIMITED OF HONG KONG. NO REPRODUCTION OF THE DRAWING / DOCUMENT OR ANY PART BY WHATEVER MEANS IS PERMITTED WITHOUT THE PRIOR WRITTEN CONSENT OF THE MTR CORPORATION LIMITED.



LEGEND

- GAZETAL BOUNDARY
- DIVIDING LINE FOR DEPARTMENTAL RESPONSIBILITIES (30m OFFSET FROM KERB OF PUBLIC ROAD)
- PROPOSED LAYOUT
- T0005(R) EXISTING TREE TO BE RETAINED
- T0005(P) EXISTING TREE TO BE RETAINED WITH PRUNING
- T0005(F) EXISTING TREE TO BE FELLED
- T0005(T) EXISTING TREE TO BE TRANSPLANTED
- T0005(D) EXISTING DEAD TREE
- T0005(O) EXISTING TREE OUTSIDE GAZETAL BOUNDARY

0 5 10 15 20 25 METRES
1 : 500

PLOT DRW: J:\ASCL\PL01\DRY\HPLU-A3C.dwg
 MODELNAME: Default
 FILENAME: J:\MTR\23\DCN-CA\C8001_T_XRL_URB_C04_302A3.dgn
 15-Dec-2009 11:39:03

REV	DESCRIPTION	BY	DATE	APPROVED	REV	DESCRIPTION	BY	DATE	APPROVED
A3	THIRD ISSUE	SAN	15DEC09	AD					
A2	SECOND ISSUE	SAN	30JUN09	AD					
A1	DRAFT TREE SURVEY REPORT	SAN	21APR09	AD					

DRAWN	SAN
DESIGNED	JP
CHECKED	JP
APPROVED	AD
DATE	21.APR.2009

EXPRESS RAIL LINK (XRL)

ORIGINATOR

Planning, Urban Design, Landscape, Golf & Environmental Consultants
 Urbis Limited, 11/F Siu On Centre, 188 Lockhart Road, Wan Chai, Hong Kong.
 Tel 2802 3333 Fax 2802 8662

CADD REF. C8001_T_XRL_URB_C04_302A3.dgn

TITLE

CONSULTANCY AGREEMENT NO. C8001

TREE TRANSPLANTING / FELLING

TREE SURVEY PLAN OF TSUEN WAN DISTRICT

(SHEET 1 OF 4)

SCALE 1 : 500 @ A1

DRAWING NO. C8001/T/XRL/URB/C04/302

REV. A3

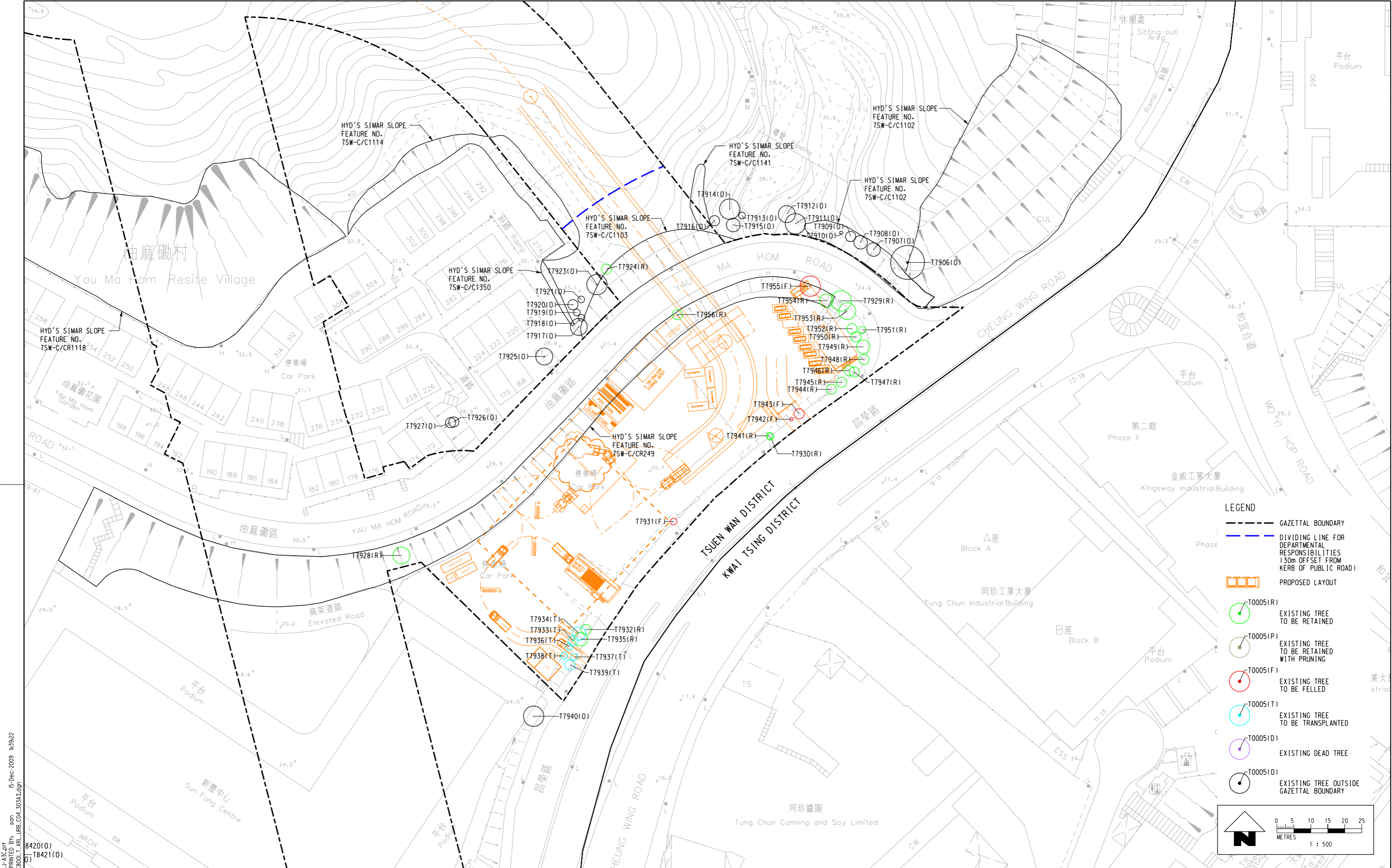

LEGEND

- GAZETAL BOUNDARY
- DIVIDING LINE FOR DEPARTMENTAL RESPONSIBILITIES (30m OFFSET FROM KERB OF PUBLIC ROAD)
- PROPOSED LAYOUT
- T0005(R) EXISTING TREE TO BE RETAINED
- T0005(P) EXISTING TREE TO BE RETAINED WITH PRUNING
- T0005(F) EXISTING TREE TO BE FELLED
- T0005(T) EXISTING TREE TO BE TRANSPLANTED
- T0005(D) EXISTING DEAD TREE
- T0005(O) EXISTING TREE OUTSIDE GAZETAL BOUNDARY

N

0 5 10 15 20 25 METRES
1 : 500

PLOT DRW: J:\ASCL\PL01\DRY\HPLU-A3C.dwg
 MODELNAME: Default
 FILENAME: J:\AMTR\23\DCN-GA\C8001_T_XRL_URB_C04_303A3.dgn
 15-Dec-2009 11:39:22

REV	DESCRIPTION	BY	DATE	APPROVED	REV	DESCRIPTION	BY	DATE	APPROVED
A3	THIRD ISSUE	SAN	15DEC09	AD					
A2	SECOND ISSUE	SAN	30JUN09	AD					
A1	DRAFT TREE SURVEY REPORT	SAN	21APR09	AD					

DRAWN SAN
 DESIGNED JP
 CHECKED JP
 APPROVED AD
 DATE 21.APR.2009

MTR

EXPRESS RAIL LINK (XRL)

ORIGINATOR
 Planning, Urban Design, Landscape, Golf & Environmental Consultants
 Urbis Limited, 11/F Siu On Centre, 188 Lockhart Road, Wan Chai, Hong Kong.
 Tel 2802 3333 Fax 2802 8662

CADD REF. C8001_T_XRL_URB_C04_303A3.dgn

TITLE

CONSULTANCY AGREEMENT NO. C8001
TREE TRANSPLANTING / FELLED
TREE SURVEY PLAN OF TSUEN WAN DISTRICT
(SHEET 2 OF 4)

SCALE 1 : 500 @ A1
 DRAWING NO. C8001/T/XRL/URB/C04/303
 REV. A3

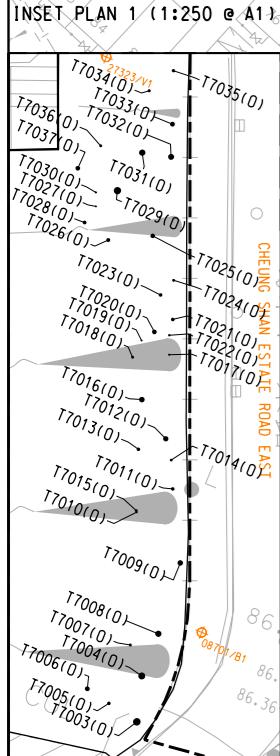
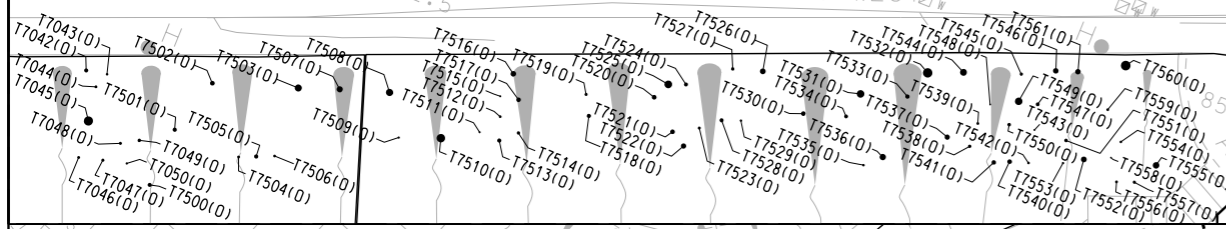

INSET PLAN 2 (1:250 @ A1)

- LEGEND**
- GAZETTED BOUNDARY
 - - - DIVIDING LINE FOR DEPARTMENTAL RESPONSIBILITIES (30m OFFSET FROM KERB OF PUBLIC ROAD)
 - ▭ PROPOSED LAYOUT
 - T0005(R) EXISTING TREE TO BE RETAINED
 - T0005(P) EXISTING TREE TO BE RETAINED WITH PRUNING
 - T0005(F) EXISTING TREE TO BE FELLED
 - T0005(T) EXISTING TREE TO BE TRANSPLANTED
 - T0005(D) EXISTING DEAD TREE
 - T0005(O) EXISTING TREE OUTSIDE GAZETTED BOUNDARY

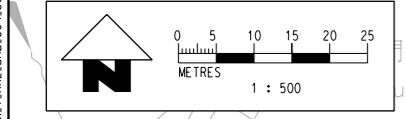

REV	DESCRIPTION	BY	DATE	APPROVED	REV	DESCRIPTION	BY	DATE	APPROVED
A3	THIRD ISSUE	SAN	15DEC09	AD					
A2	SECOND ISSUE	SAN	30JUN09	AD					
A1	DRAFT TREE SURVEY REPORT	SAN	21APR09	AD					

DRAWN	SAN
DESIGNED	JP
CHECKED	JP
APPROVED	AD
DATE	21. APR. 2009
ORIGINATOR	Planning, Urban Design, Landscape, Golf & Environmental Consultants Urbis Limited, 11/F Siu On Centre, 188 Lockhart Road, Wan Chai, Hong Kong. Tel 2802 3333 Fax 2802 8662
CADD REF.	C8001.T.XRL.URB.C04.3043.dgn

MTR

EXPRESS RAIL LINK (XRL)

ORIGINATOR

Planning, Urban Design, Landscape, Golf & Environmental Consultants Urbis Limited, 11/F Siu On Centre, 188 Lockhart Road, Wan Chai, Hong Kong. Tel 2802 3333 Fax 2802 8662

Urbis

TITLE	SCALE	DRAWING NO.	REV.
CONSULTANCY AGREEMENT NO. C8001 TREE TRANSPLANTING / FELLING TREE SURVEY PLAN OF TSUEN WAN DISTRICT (SHEET 3 OF 4)	1 : 500 @ A1	C8001/T/XRL/URB/C04/304	A3

PLOT DRW: J:\ASCL\PL\OTDR\HPL\J-ASCL.PLT
 MODELNAME: Default
 FILENAME: J:\MTR\23\DCN\CAC\8001.T.XRL_URB.C04.3043.dgn
 15-Dec-2009 16:39:42

PLOT DRW: J:\ASCL\PL01\DR\HPLU-A3C.dwg
 MODELNAME: Default
 FILENAME: J:\MTR\23\DCN-GA\C8001_T_XRL_URB_C04_305A3.dgn
 15-Dec-2009 11:40:05

青洲灣
 TSING CHAU WAN

LEGEND

- GAZETAL BOUNDARY
- DIVIDING LINE FOR DEPARTMENTAL RESPONSIBILITIES (30m OFFSET FROM KERB OF PUBLIC ROAD)
- PROPOSED LAYOUT
- T0005(R) EXISTING TREE TO BE RETAINED
- T0005(P) EXISTING TREE TO BE RETAINED WITH PRUNING
- T0005(F) EXISTING TREE TO BE FELLED
- T0005(T) EXISTING TREE TO BE TRANSPLANTED
- T0005(D) EXISTING DEAD TREE
- T0005(O) EXISTING TREE OUTSIDE GAZETAL BOUNDARY

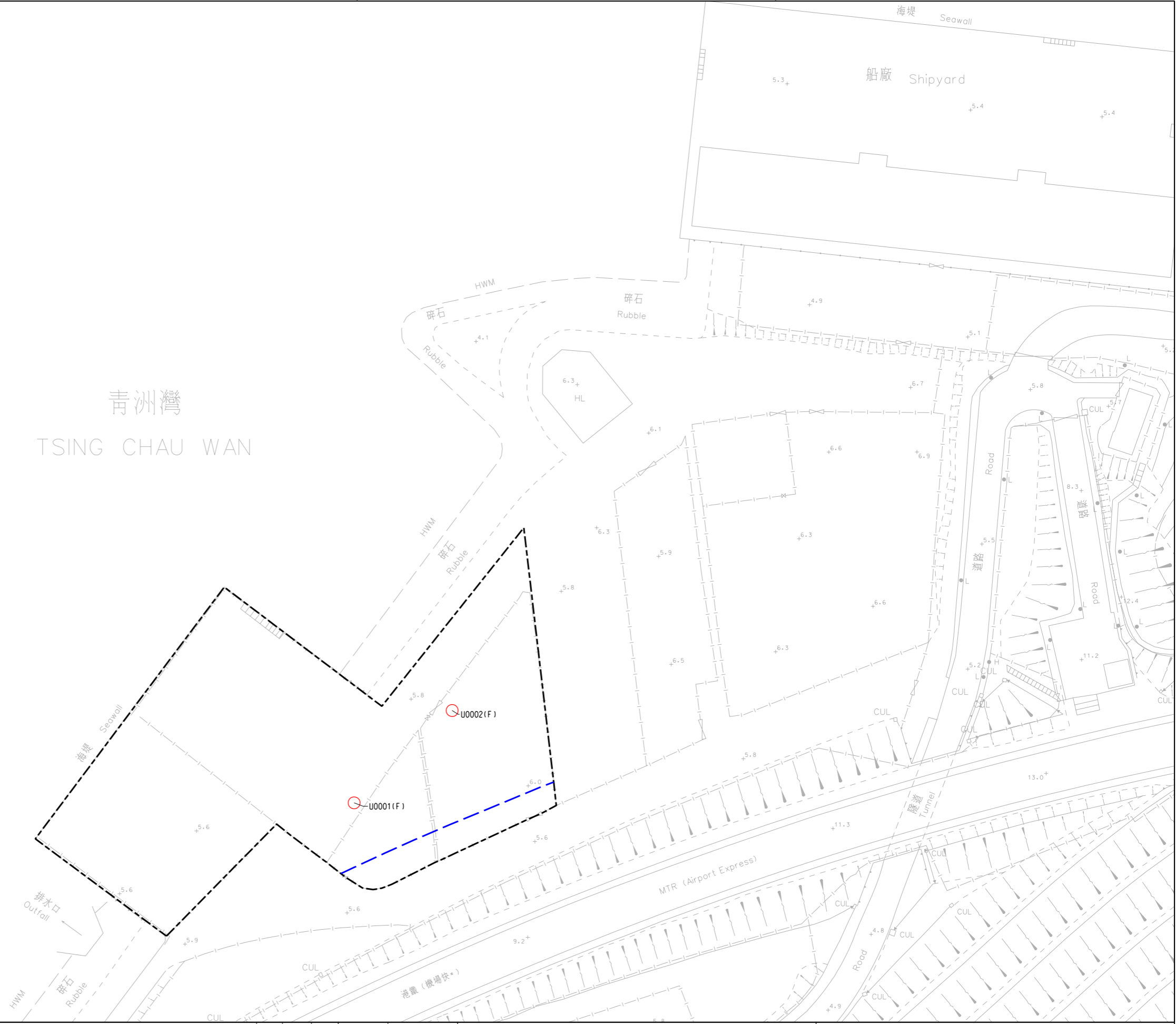

REV	DESCRIPTION	BY	DATE	APPROVED	REV	DESCRIPTION	BY	DATE	APPROVED
A3	THIRD ISSUE	SAN	15DEC09	AD					
A2	SECOND ISSUE	SAN	30JUN09	AD					
A1	FIRST ISSUE	SAN	12MAY09	AD					

DRAWN	SAN
DESIGNED	JP
CHECKED	TO
APPROVED	AD
DATE	12.MAY.2009
MTR	
EXPRESS RAIL LINK (XRL)	
ORIGINATOR	
Planning, Urban Design, Landscape, Golf & Environmental Consultants Urbis Limited, 11/F Siu On Centre, 188 Lockhart Road, Wan Chai, Hong Kong. Tel 2802 3333 Fax 2802 8662	
CADD REF.	C8001_T_XRL_URB_C04_305A3.dgn

TITLE	
CONSULTANCY AGREEMENT NO. C8001 TREE TRANSPLANTING / FELLED TREE SURVEY PLAN OF TSUEN WAN DISTRICT (SHEET 4 OF 4)	
SCALE	DRAWING NO.
1 : 500 @ A1	C8001/T/XRL/URB/C04/305
REV.	A3

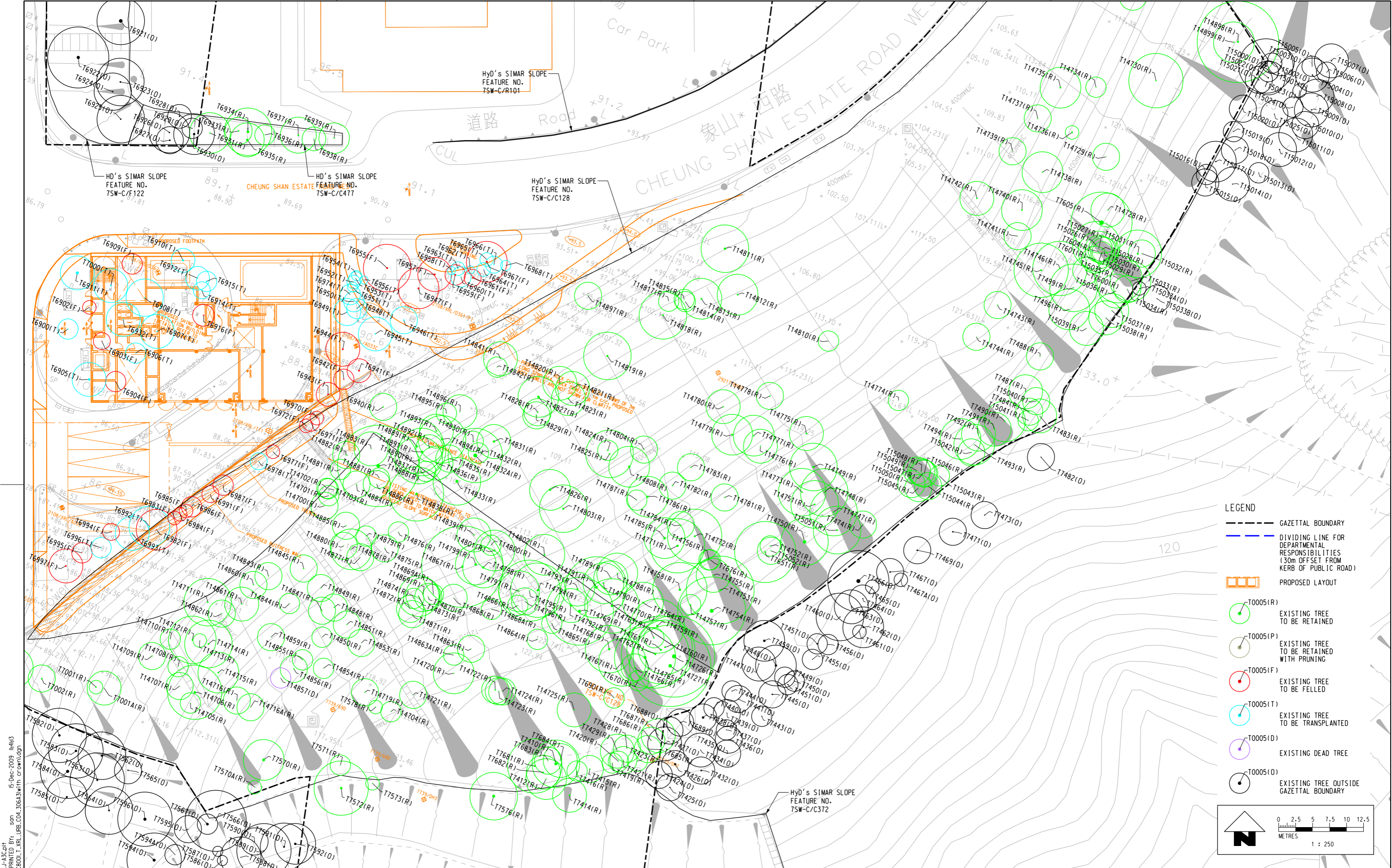

LEGEND

- GAZETAL BOUNDARY
- DIVIDING LINE FOR DEPARTMENTAL RESPONSIBILITIES (30m OFFSET FROM KERB OF PUBLIC ROAD)
- PROPOSED LAYOUT
- T0005(R) EXISTING TREE TO BE RETAINED
- T0005(P) EXISTING TREE TO BE RETAINED WITH PRUNING
- T0005(F) EXISTING TREE TO BE FELLED
- T0005(T) EXISTING TREE TO BE TRANSPLANTED
- T0005(D) EXISTING DEAD TREE
- T0005(O) EXISTING TREE OUTSIDE GAZETAL BOUNDARY

N

0 2.5 5 7.5 10 12.5 METRES
1 : 250

PLOT DRW: J:\ASCL\PL01DRY\HPLU-AS3C.dwg
 MODELNAME: Default
 FILENAME: J:\MTR\23\DCN-GA-C8001.T_XRL_URB_C04_306A3\with crown.dgn
 15-Dec-2009 11:41:3
 15-Dec-2009 11:41:3

DRAWN		SAN			ORIGINATOR	
DESIGNED		JP			Planning, Urban Design, Landscape, Golf & Environmental Consultants	
CHECKED		JP			Urbis Limited, 11/F Siu On Centre, 188 Lockhart Road, Wan Chai, Hong Kong.	
APPROVED		AD			Tel 2802 3333 Fax 2802 8662	
DATE		21.APR.2009				
A3	THIRD ISSUE	SAN	15DEC09	AD	DATE	21.APR.2009
A2	SECOND ISSUE	SAN	30JUN09	AD	DO NOT SCALE DRAWINGS. ALL DIMENSIONS SHALL BE VERIFIED ON SITE.	
A1	DRAFT TREE SURVEY REPORT	SAN	21APR09	AD	© MTR CORPORATION LIMITED 2008. COPYRIGHT IN RESPECT OF THIS DRAWING / DOCUMENT IS OWNED BY THE MTR CORPORATION LIMITED OF HONG KONG. NO REPRODUCTION OF THIS DRAWING / DOCUMENT OR ANY PART BY WHATEVER MEANS IS PERMITTED WITHOUT THE PRIOR WRITTEN CONSENT OF THE MTR CORPORATION LIMITED.	
REV	DESCRIPTION	BY	DATE	APPROVED	CADD REF.	C8001.T_XRL_URB_C04_306A3(with crown).dgn

TITLE

CONSULTANCY AGREEMENT NO. C8001

TREE TRANSPLANTING / FELLING

TREE SURVEY BLOW UP PLAN OF TSUEN WAN DISTRICT

SCALE: 1 : 250 @ A1

DRAWING NO. C8001/T/XRL/URB/C04/306

REV. A3

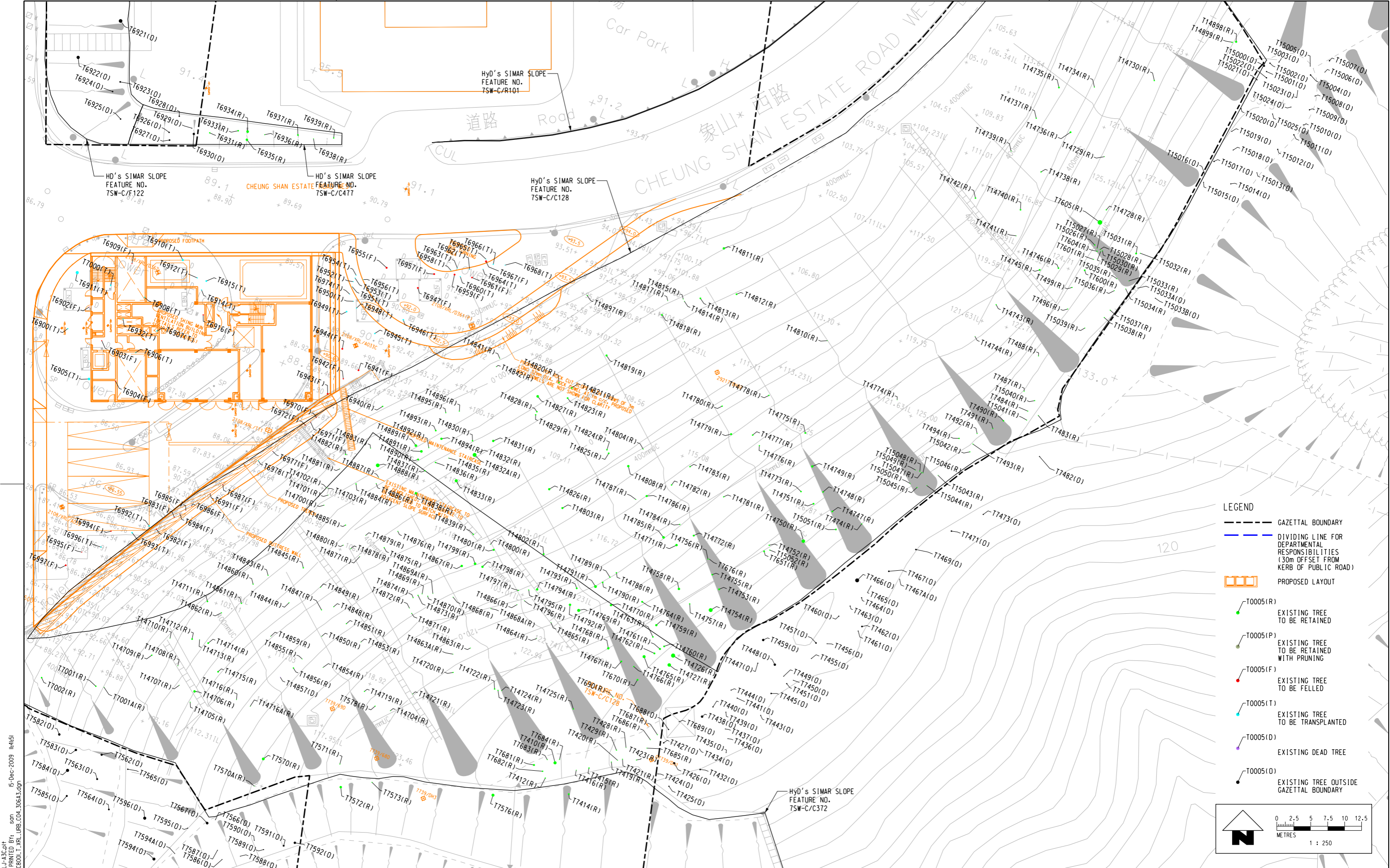

LEGEND

- GAZETAL BOUNDARY
- DIVIDING LINE FOR DEPARTMENTAL RESPONSIBILITIES (30m OFFSET FROM KERB OF PUBLIC ROAD)
- PROPOSED LAYOUT
- T0005(R) EXISTING TREE TO BE RETAINED
- T0005(P) EXISTING TREE TO BE RETAINED WITH PRUNING
- T0005(F) EXISTING TREE TO BE FELLED
- T0005(T) EXISTING TREE TO BE TRANSPLANTED
- T0005(D) EXISTING DEAD TREE
- T0005(O) EXISTING TREE OUTSIDE GAZETAL BOUNDARY

N

0 2.5 5 7.5 10 12.5 METRES
1 : 250

PLOT DRW: J:\SCL\PL01\DRW\PL01-A33.cpl
 MODELNAME: Default
 FILENAME: J:\MTR\23\CON-GA-C8001_T_XRL_URB_C04_306A3.dgn
 15-Dec-2009 14:41:51

REV	DESCRIPTION	BY	DATE	APPROVED	REV	DESCRIPTION	BY	DATE	APPROVED
A3	THIRD ISSUE	SAN	15DEC09	AD					
A2	SECOND ISSUE	SAN	30JUN09	AD					
A1	DRAFT TREE SURVEY REPORT	SAN	21APR09	AD					

DRAWN	SAN
DESIGNED	JP
CHECKED	JP
APPROVED	AD
DATE	21.APR.2009
ORIGINATOR	Planning, Urban Design, Landscape, Golf & Environmental Consultants Urbis Limited, 11/F Siu On Centre, 188 Lockhart Road, Wan Chai, Hong Kong. Tel 2802 3333 Fax 2802 8662
CADD REF.	C8001_T_XRL_URB_C04_306A3.dgn

MTR

EXPRESS RAIL LINK (XRL)

TITLE

CONSULTANCY AGREEMENT NO. C8001
 TREE TRANSPLANTING / FELLED
 TREE SURVEY BLOW UP PLAN OF TSUEN WAN DISTRICT

SCALE: 1 : 250 @ A1
 DRAWING NO.: C8001/T/XRL/URB/C04/306
 REV. A3