

# Leighton Joint Venture

10



Leighton Joint Venture

c/o 39<sup>th</sup> Floor  
Sun Hung Kai Centre  
30 Harbour Road  
Hong Kong

t: (852) 2823-1111  
f: (852) 2529-8784  
e: info@leightonasia.com

**By Hand**

06-MAY-2015

Our Ref: H2613-LJV-EN-LE-1337

The EIA Ordinance Register Office  
Environmental Protection Department  
27/F, Southorn Centre  
130 Hennessy Road  
Wan Chai, Hong Kong

Dear Sir,

**Contract No. HY/2011/08**  
**Central – Wan Chai Bypass – Tunnel Buildings, Systems and Fittings, and Works**  
**Associated with Tunnel Commissioning**  
**Landscape Plan (Rev. 2)**

Pursuant to Condition 2.14 of the Environmental Permit no. FEP-11/364/2009/B and we refer to your letter ref. (12) in EP2/H4/S3/15 Pt. 36 dated 17.04.2015, we enclose four hard copies of our responses-to-comments table with ET's certification letter and IEC's verification letter for your information.

Should you have any query, please do not hesitate to contact our Mr. Malcolm Leung at 6323 9478, or malcolm.leung@leightonasia.com.

Yours faithfully  
For and on behalf of  
Leighton Joint Venture

Colman Wong  
Project Director

CW / ML / PY

cc.    AECOM        -    Mr. David Kwan, CRE  
      LAM            -    Mr. Raymond Dai, ETL  
      ENVIRON     -    Mr. David Yeung, IEC

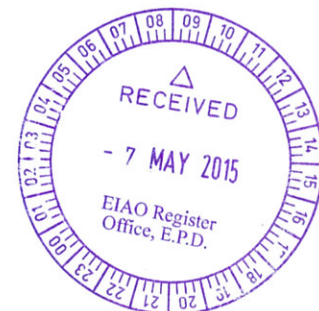

Our Ref: H2613-LJV-EN-LE-1337

Page 1 of 1



# Lam Geotechnics Limited

Ground Investigation & Instrumentation Professionals

華益土力有限公司

Ref : G1120/CS/L982/FEP-11/364/2009/B  
Date : 30 April 2015

**Leighton Joint Venture**  
39/F Sun Hung Kai Centre  
30 Harbour Road  
Wan Chai Hong Kong

**Attn: Site Agent, Mr. Colman Wong**

Dear Mr. Wong,

**Contract No. HY/2011/08**  
**Central – WanChai Bypass Tunnel – Tunnel Buildings, Systems and Fittings, and Works**  
**Associated with Tunnel Commissioning**

**Landscape Plan (Rev. 2)**

Referring to the captioned submission and response to comments table dated 27 April 2015 received through email on 27 April 2015, we have reviewed the submitted details and hereby certified this submission in accordance with Condition 2.14 of FEP-11/364/2009/B.

Should you have any enquiry, please feel free to contact the undersigned at 2839 5666.

Yours faithfully,

Raymond Dai  
Environmental Team Leader

C.C.

HyD	- Mr. Bond Chow	(By Fax: 2714 5289)
AECOM	- Mr. Peter Poon	(By Fax: 3912 3090)
AECOM	- Mr. Frankie Fan	(By Fax: 2587 1877)
ENVIRON	- Mr. David Yeung	(By Fax: 3548 6988)



Ref.: AACWBIECEM00\_0\_6587L.15

By Post and Fax (2140 6799)

**Leighton Joint Venture**  
39<sup>th</sup> Floor  
Sun Hung Kai Centre  
30 Harbour Road  
Hong Kong

Attention: Site Agent, Mr. Colman Wong

Dear Sir,

**Re: Contract No. HY/2011/08**  
**Central – Wan Chai Bypass – Tunnel Buildings, Systems and Fittings, and Works**  
**Associated with Tunnel Commissioning**  
**Landscape Plan (Revision 2)**

References are made to your submission of the Landscape Plan (Revision 2) and respond to comments table dated 27 April 2015 for our review and comment.

Please be informed that we have no further comments on the captioned submission. We write to verify the captioned submission in accordance with Condition 2.14 of FEP-11/364/2009/B.

Thank you for your kind attention.

Yours sincerely,

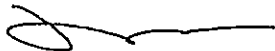

David Yeung  
Independent Environmental Checker

c.c.	HyD	Mr. Bond Chow	by fax: 2714 5289
	AECOM	Mr. Peter Poon	by fax: 3912 3090
	AECOM	Mr. Frankie Fan	by fax: 2587 1877
	LAM	Mr. Raymond Dai (ETL)	by fax: 2882 3331

Q:\Projects\AACWBIECEM00\Corr\AACWBIECEM00\_0\_6587L.15.doc

Ref.	Comments	Responses
<b>General Comment</b>		
	I refer to your letter under reference depositing the captioned submission as per Condition 2.14 of the Further Environmental Permit No. FEP-11/364/2009/B.	Noted.
2.	After consulting Planning Department, we find the submission needs to be revised as per PlanD's comments in Annex.	Noted.
3.	For control of night lighting, please make sure that the guidelines jointly issued by ENB, EPD and EMSD in 2012." has been followed. For details, please find the guideline from the following link => <a href="http://www.enb.gov.hk/sites/default/files/en/node78/guidelines_ex_lighting_install_eng.pdf">http://www.enb.gov.hk/sites/default/files/en/node78/guidelines_ex_lighting_install_eng.pdf</a> .	Noted. The mentioned guidelines would be followed as appropriate.
4.	In view of comments from the PlanD, re-submission of the Landscape Plan is considered necessary. Please submit the revised version to us for further review.	Noted.
<b>Technical Comment</b>		
<b>Landscape</b>		
	It appears that the layout and location of the East Ventilation Building and the Administration Building is different from that in the approved EIA Report. Please clarify and elaborate how the landscape design is conforming to the information and recommendations of the approved EIA report.	Referring to Figure 2.5a Recommended Outline Development Plan of the approved Wan Chai Development Phase II and Central-Wan Chai Bypass EIA Report (Register No. AEIAR-125/2008), there are no alternations to the layout and location of the East Ventilation Building and the Administration Building. Please find the attached figures for your reference.
<b>Visual Impact</b>		
	There is no comment on the captioned submission from visual impact perspective.	Noted.

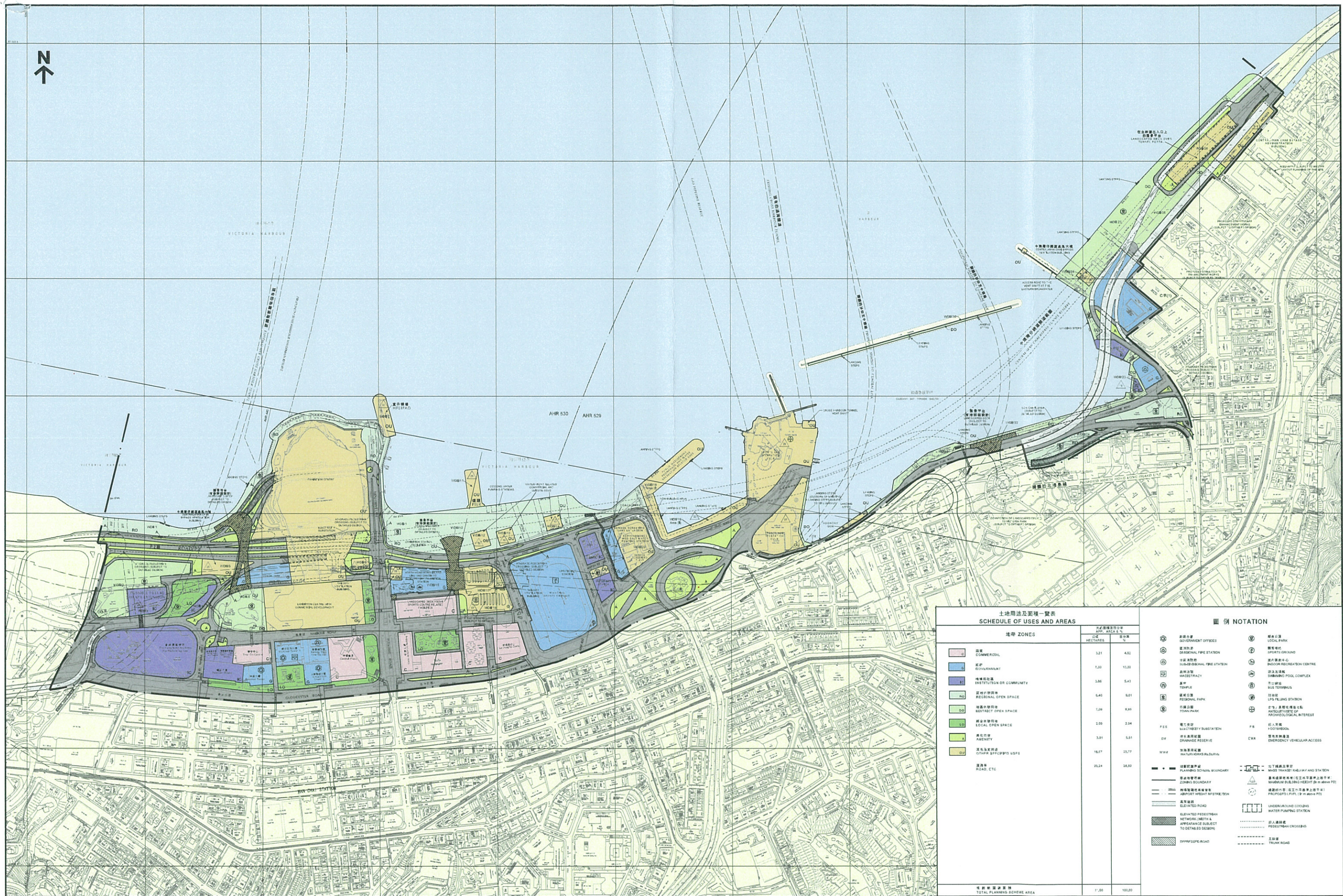

**土地用途及面積一覽表**  
**SCHEDULE OF USES AND AREAS**

地帶 ZONES	次區總面積 (公頃)	
	公頃	呎呎
商業 COMMERCIAL	3.21	4.52
政府 GOVERNMENT	7.33	10.22
機構或社區 INSTITUTION OR COMMUNITY	3.86	5.43
區域性綠地 REGIONAL OPEN SPACE	6.40	8.81
地區性綠地 LOCAL OPEN SPACE	2.09	2.94
康樂及康樂地 AMENITY	3.91	5.41
其他指定用途 OTHER SPECIFIED USES	16.17	22.77
道路 ROAD, ETC.	25.24	34.80
<b>總計 TOTAL PLANNING SCHEME AREA</b>	<b>71.50</b>	<b>100.00</b>

**圖例 NOTATION**

政府辦事處 GOVERNMENT OFFICES	地方公園 LOCAL PARK
區議會 REGIONAL FIRE STATION	體育館 SPORTS GROUND
中央消防局 SUB-REGIONAL FIRE STATION	室內康樂中心 INDOOR RECREATION CENTRE
康樂中心 MARKET	游泳池 SWIMMING POOL COMPLEX
廟宇 TEMPLE	巴士站 BUS TERMINUS
區域公園 REGIONAL PARK	足球場 FOOTBALL STADIUM
區議會 TOWN PARK	古蹟/具歷史價值地點 ANTIQUITY/SITE OF ARCHAEOLOGICAL INTEREST
電力局 ELECTRICITY SUBSTATION	行人橋 FOOTBRIDGE
排水渠排水渠 DRAINAGE RESERVE	緊急車輛通道 EMERGENCY VEHICULAR ACCESS
其他指定用途 INDUSTRIAL/OTHER BUILDING	
規劃界線 PLANNING SCHEME BOUNDARY	地下鐵路及車站 UNDERGROUND RAILWAY AND STATION
區界 ZONE BOUNDARY	最高樓宇高度 (在工務局圖則上顯示) MAXIMUM BUILDING HEIGHT (as shown on PDS)
機場高度限制 AIRPORT HEIGHT RESTRICTION	建築師之手 (在工務局圖則上顯示) ARCHITECT'S PLOT (as shown on PDS)
高架路 ELEVATED ROAD	地下冷卻水抽水機 UNDERGROUND COOLING WATER PUMPING STATION
網絡、寬度及外觀須待詳細設計 NETWORK, WIDTH & APPEARANCE SUBJECT TO DETAILED DESIGN	行人過路橋 PEDESTRIAN CROSSING
雙程路 DOUBLE ROAD	主幹路 TRUNK ROAD

港島規劃區第8區(部份圖則), 第24區(部份圖則)及第25區灣仔北發展大綱圖  
HONG KONG PLANNING AREAS 8 (PART PLAN), 24 (PART PLAN) AND 25 RECOMMENDED WAN CHAI NORTH - OUTLINE DEVELOPMENT PLAN

FIGURE 2.5a

SCALE 1:2 500 比例尺  
METRES

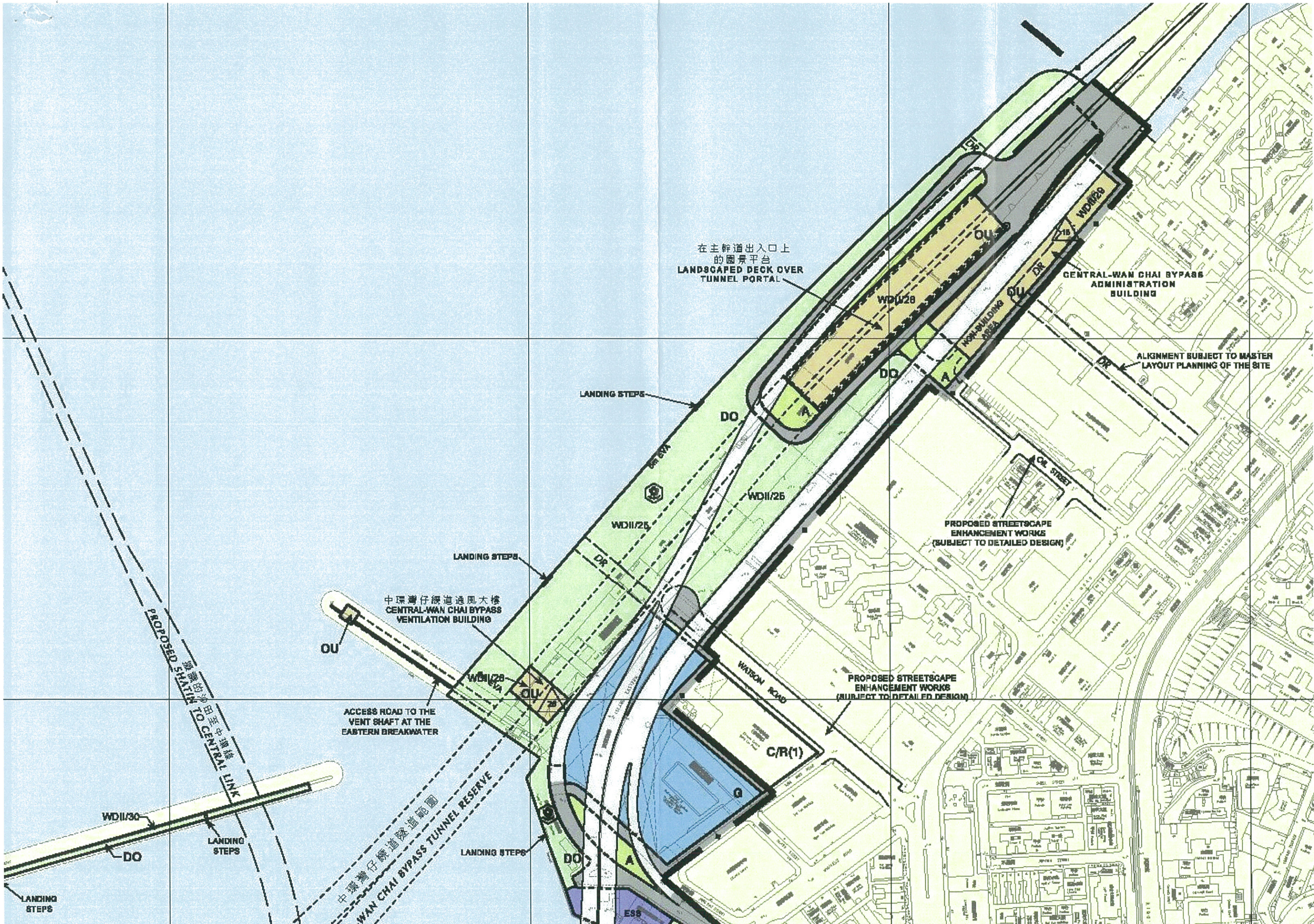

在主幹道出入口上的  
園景平台  
LANDSCAPED DECK OVER  
TUNNEL PORTAL

CENTRAL-WAN CHAI BYPASS  
ADMINISTRATION  
BUILDING

ALIGNMENT SUBJECT TO MASTER  
LAYOUT PLANNING OF THE SITE

LANDING STEPS

DO

DO

WDII/28

OU

PROPOSED STREETSCAPE  
ENHANCEMENT WORKS  
(SUBJECT TO DETAILED DESIGN)

PROPOSED STREETSCAPE  
ENHANCEMENT WORKS  
(SUBJECT TO DETAILED DESIGN)

LANDING STEPS

WDII/25

中環灣仔繞道通風大樓  
CENTRAL-WAN CHAI BYPASS  
VENTILATION BUILDING

OU

ACCESS ROAD TO THE  
VENT SHAFT AT THE  
EASTERN BREAKWATER

WDII/28

OU

C/R(1)

PROPOSED SHANTIN 中環灣仔繞道  
TO CENTRAL LINK 由中環繞道

WDII/30

LANDING  
STEPS

DO

LANDING  
STEPS

中環灣仔繞道隧道範圍  
L-WAN CHAI BYPASS TUNNEL RESERVE

LANDING STEPS

DO

ESS

WATSON ROAD

ACR STREET

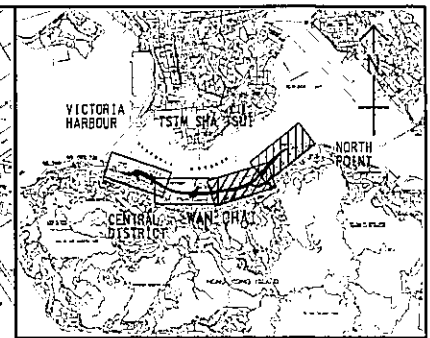
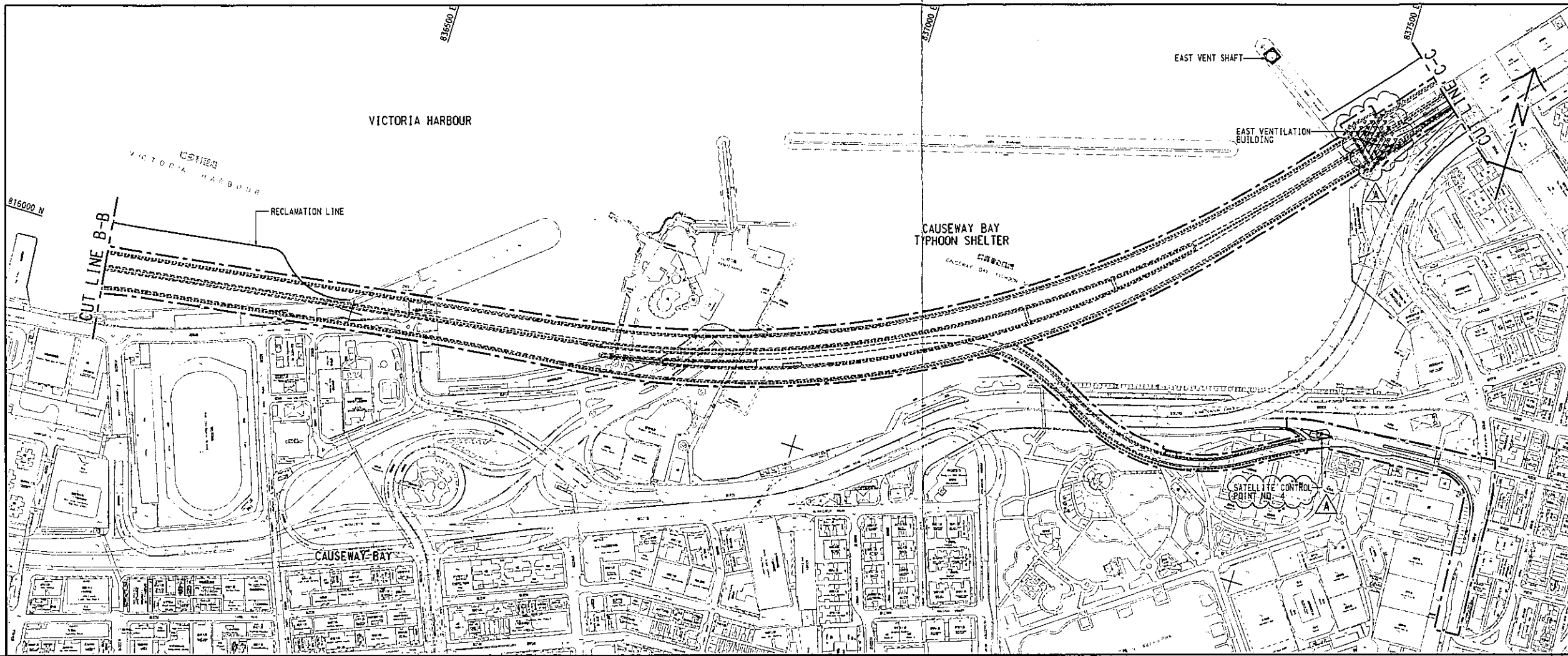

**KEY PLAN**  
SCALE A1 : 10000  
A3 : 20000

- NOTES:**
1. THIS DRAWING SHALL BE READ IN CONJUNCTION WITH DRAWING NOS. 60095653/RW/1001.
  2. FOR NOTES AND LEGEND REFER TO DRAWING NO. 60095653/RW/1001.

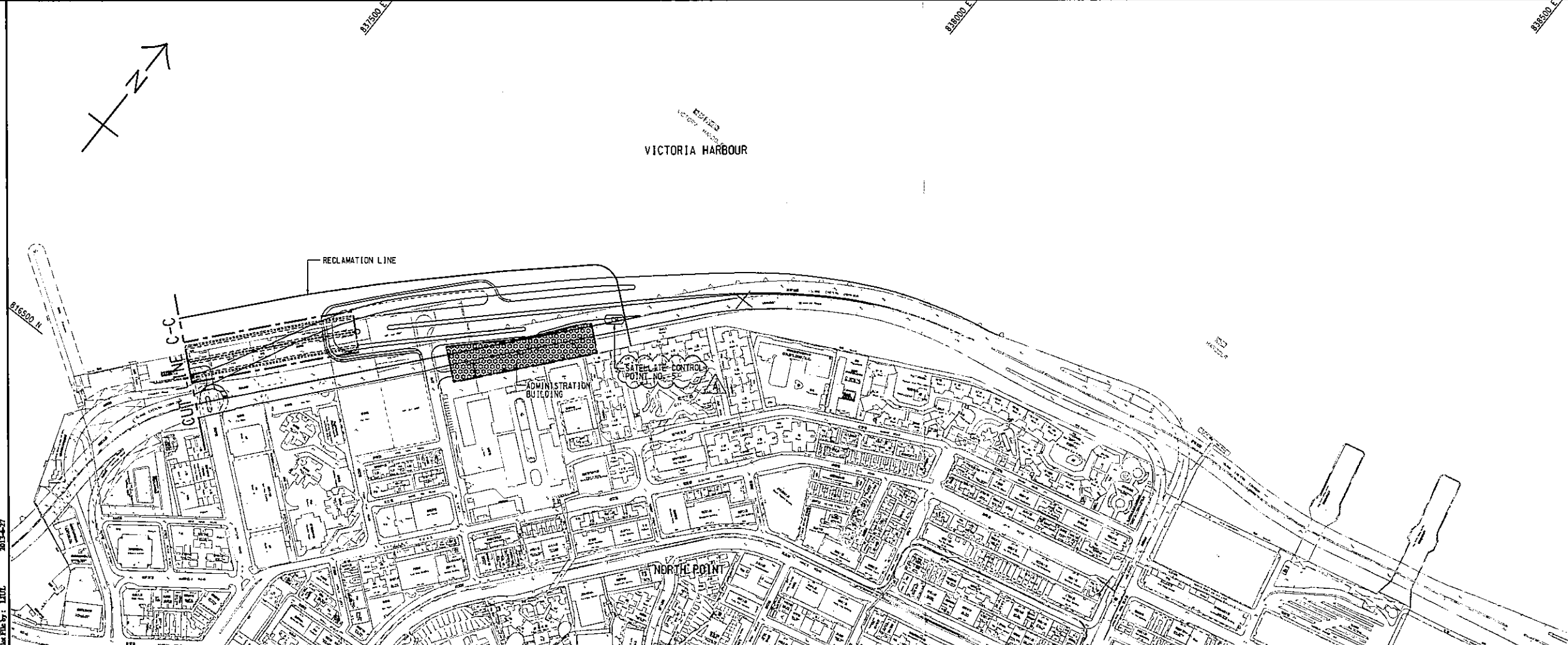

A	TENDER ADDENDUM NO. 1	JWKN/ALCF	JUN 13
-	TENDER DRAWING	JWKN/ALCF	MAY 13
REV.	DESCRIPTION	DATE	BY

Highways Department 路政署  
Major Works Project Management Office

CENTRAL - WAN CHAI BYPASS AND IEC LINK

PWP ITEM NO. 579 TH  
工務計劃項目編號

CENTRAL - WAN CHAI BYPASS -  
TUNNEL BUILDINGS, SYSTEMS AND FITTINGS,  
AND WORKS ASSOCIATED WITH TUNNEL COMMISSIONING

**GENERAL LAYOUT**  
SHEET 2 OF 2



DRGNO. 60095653/RW/1002A  
圖紙編號

DESIGNED BY ALCF	CONTRACT NO. HY/2011/08	APPROVED BY CWN
DRAWN BY ANM	SCALE A1 1 : 5000 A3 1 : 10000	DATE 2013/05/27
DIMENSIONS ARE IN METRES		

© COPYRIGHT RESERVED  
版權所有

LEIGHTON  
禮頓



Contract No. HY/2011/08  
Central-Wan Chai Bypass – Tunnel Building,  
Systems and Fittings, and Works Associated  
with Tunnel Commissioning

## Landscape Plan

*Reviewed by:*

Chris CHAN  
Environmental Officer

*Approved by:*

Colman Wong  
Site Agent

**COPY**

- NO CHANGE
- SAME AS PREVIOUS  
SUBMISSION IN FEB 2015



## About this Document

This document is available for all project employees via the project network. We regularly revise this document and the latest version is always available electronically. Once printed, the document should no longer be considered to be the latest version. It may be distributed to the Highways Department and the Engineer on the understanding that any such document may not be the latest version or it may be distributed to the Highways Department and the Engineer as a controlled document in which case the front cover is to be stamped “Controlled Copy” in red and a copy number added.

The Environmental Officer is responsible for updating and maintaining the plan, including the original hard copy, which is signed by the person in charge of the project to indicate approval.

The status of this plan is identified by a revision number and date on each page. On revision, the plan will be uploaded as a whole to the project server or within the Incite Keystone. The Environmental Officer maintains a record of the revision status of the plan, which is available on request.

If you have any enquiry relating to this plan, please contact the Environmental Officer.

## Revision History and Plan Approval

Revision	Date	Section/Description	Prepared	Reviewed	Authorised by
01	16.07.2014	Issue for Construction	Penny Yiu	Donald Ip	Colman Wong
02	12.02.2015	Responses to Comments	Malcolm Leung	Chris Chan	Colman Wong

**COPY**

*This plan is the property of Leighton Joint Venture and may not be copied, distributed or used without the written consent of Leighton Joint Venture.*

**1. Introduction**

- 1.1. The purpose of this Landscape Plan is to fulfil the Condition 2.14 under Environmental Permit number: FEP-11/364/2009/B.
- 1.2. This Landscape Plan provides the design details, locations, implementation programme, maintenance and management schedules, and drawings of the landscape and visual mitigation measures for mitigation of the landscape and visual impact arising from the construction of the Central - Wan Chai Bypass - Tunnel Building, Systems and Fittings and Works Associated with Tunnel Commissioning (Contract No. HY/2011/08, hereinafter referred to as "the **CWB-CC**") as per the requirements in the approved CWB&IECL EIA Report (Register No. AEIAR-041/2001) and the WDII&CWB EIA Report (Register No. AEIAR-125/2008).
- 1.3. With reference to the Urban Design Study for the New Central Harbourfront (UDS) and the Master Greening Plan (MGP), it is noted that the development in the UDS area might require associated transplanting needed to be addressed in the future. However, the development works in the UDS area and the associated MGP are not covered in CWB-CC.
- 1.4. Moreover, the operational phase mitigation measures for the CWB project as mentioned in EIA Reports are not covered by the CWB-CC.

**2. Project Background (Contract No. HY/2011/08)**

- 2.1. The scope of the CWB-CC mainly includes:
- construction of the tunnel control buildings and ventilation buildings including Administration Building, West Ventilation Building, Central Ventilation Building, East Ventilation Building and East Vent Shaft;
  - provision of associated road lighting, road signing, traffic control and surveillance system; and
  - carrying out other associated works.
- 2.2. The project boundary of the CWB-CC is shown in **Appendix A** and the key visual sensitive receivers (hereinafter referred to as "VSR") for the CWB project were identified in Figure 10.4 of the WDII&CWB EIA Report (**Appendix B**).
- 2.3. Hence, only VSR numbers C1-C37, C50, C52-C54, C54A, C/R1-C/R23, GIC1012, O1-O9, OU1, R1-R7, S1 and T1-T3 and 98-99 in the abovementioned figure have been identified as the key visual sensitive receivers related to the CWB-CC.

**3. EIA Requirements**

- 3.1. In order to fulfil the Condition 2.14 of the EP, the Permit Holder “Leighton JV” shall implement a series of landscape and visual mitigation measures for the reduction of the landscape and visual impact during the construction phase of the CWB-CC.
- 3.2. Sections 7.6.27 and 7.6.28 of the approved CWB&IECL EIA Report listed additional mitigation measures for landscape and visual impacts. Meanwhile, Table 10.5 of the approved WDII&CWB EIA Report listed proposed mitigation measures for landscape and visual impacts during the construction phase. To comply with the requirements, the CWB-CC shall implement the following aspects:
  - Implementation of Landscape Works (Section 4)
    - Soil Mix
    - Tree Preservation and Planting
  - Provision of Hoarding (Section 5)
  - Control of Night Lighting (Section 6)

#### **4. Landscape Works**

- 4.1. The CWB-CC requires carrying out trees and shrubs planting as shown in **Appendix C**. No planned tree transplanting and felling works are required during the construction phase. The proposed landscape works to be implemented include provision of new soil mix and implementation of tree preservation and planting.
- 4.2. Provision of New Soil Mix
- New soil mix shall be used for new planting areas.
  - Soil mix shall be tested by a HOKLAS accredited laboratory and submitted to the Engineer's Representative for approval before installation.
  - Topsoil, where identified, should be stripped and stored for re-use in the construction of the soft landscape works, where practicable.
- 4.3. Implementation of Tree Preservation and Planting
- Initial tree survey shall be carried out after the CWB-CC took over the site portions with trees from other CWB projects.
  - The existing trees recommended to be retained shall be protected by means of fencing to prevent vehicles, construction machines or pedestrian intrusion which may potentially damage the tree canopies, trunks and root zones concerned.
  - Tree inspection for retained trees shall be carried on a bi-monthly basis and reports shall be submitted to the Engineer's Representative.
  - In any cases where trees are required to be felled during the construction phase, proposal and compensation scheme shall be submitted to relevant government department(s) for approval and implemented accordingly upon receipt of approval.

**5. Hoarding Works**

- 5.1. The CWB-CC provides three types of hoardings along the site boundary as shown in **Appendix D**. In the meantime, except hoarding surface treatment, all hoardings shall follow the HyD Standard Drawings H6110 & H6111 and all access gates shall follow the CEDD Standard Drawings C1007.
- 5.2. Before installation of hoardings, hoarding surface treatment shall be submitted to the Engineer's Representative for approval.
- 5.3. Suitable surface treatment in the urban context shall be applied to the screen hoardings. The proposed hoardings intend to illustrate the completed Central – Wan Chai Bypass (CWB) and Island Eastern Corridor Link (IECL) from the view of local people, road users and that on the Kowloon side.
- 5.4. The three types of hoardings are:
  - Type A hoarding – view from local people in North Point.
  - Type B hoarding – view from the Kowloon side.
  - Type C hoarding – view from road users in Central.
- 5.5. Weekly tidying inclusive of cleansing, re-conditioning and/or replacement of hoarding shall be carried out to maintain the hoarding in good work condition.

## **6. Control of Night Lighting**

- 6.1. The CWB-CC shall implement the following mitigation measures to minimise the impacts on its neighbours due to night lighting:
- 6.2. Night Lighting Arrangement
- Any night-time works required shall be carefully planned to minimise the amount of unnatural lighting.
  - The usage of lighting equipment shall be minimised. Assessments shall be conducted carefully to evaluate the need of lighting based on the tasks performed.
  - The lighting equipment shall be directed to the site area and controlled to be diverted from adjoining residential and hotel development.
  - The layout and alignment of construction activities shall be carefully planned to reduce the lighting impact.
- 6.3. On-site Supervision
- During night-time works, the lighting impact shall be monitored, assessed and controlled by designated site supervision staff.
  - Upon receipt of any public concerns and/or complaints, the lighting equipment shall be repositioned, shielded, redirected, dimmed and/or lowered where necessary.

**7. Part D – Implementation Programme, Maintenance and Management Schedule**

7.1. The implementation programme of the mitigation measures is summarised below:

Item	ID No.	Mitigation Measures	Location / Timing
A1.	CM1	Approved new soil-mix for new planting areas.	New planting areas / Entire construction period.
A2.	CM2, 3, 4	Retention and protection of existing trees where feasible and transplanting of trees which are in conflict with the road works (where practicable). All in accordance with the tree preservation, transplanting and felling plans.	Entire works area / Entire construction period. (tree protection and transplanting to be carried in stages to suit the programme of the works)
B.	CM6	Screen hoarding to be installed, where appropriate, with suitable surface treatment in the urban context.	Entire works area / Entire construction period. (hoarding erection to be carried out in stages to suit the programme of the works)
C.	CM5	Control of night time lighting.	Entire works area / Entire construction period.

\*The above mitigation measures with ID no. are made reference to EIA Report AEIAR-125/2008 Table 10.5 Proposed Construction Phase Landscape Mitigation Measures

7.2. The maintenance and management schedules are summarised below:

Item	Maintenance and Management Schedule
A1.	The Contractor of the CWB-CC shall test the proposed soil mix and submit the results to Engineer's Representative for approval before installation.
A2.	The Contractor of the CWB-CC shall implement sufficient tree protection measures and shall rectify deficiencies when necessary. Routine checking and photo records shall be submitted to Engineer's Representative for records.
B.	The Contractor of the CWB-CC is responsible for carrying out weekly tidying which shall include cleansing, re-conditioning and/or replacement of hoarding to good working condition. To comply with these requirements, an inspection checklist for weekly tidying shall be submitted to the Engineer's Representative for records.
C.	The Contractor of the CWB-CC shall check night time lighting every night and switch off unnecessary lighting. If practicable, spotlights shall be diverted away from sensitive receivers.

7.3. With the implementation of mitigation measures by the Contractor of the CWB-CC, the residual landscape and visual impacts would become minimal.



**Leighton JV**

Contract No. HY/2011/08  
Central – Wan Chai Bypass – Tunnel Buildings, Systems and Fittings, and  
Works Associated with Tunnel Commissioning  
Landscape Plan

## **Appendix A Layout Plan of the CWB-CC**

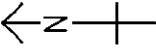

九龍灣  
KOWLOON BAY

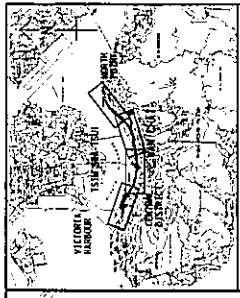

**LOCATION PLAN**  
SCALE AS 1:100000  
DATE: 11/2000

**LEGEND:**

— SITE BOUNDARY

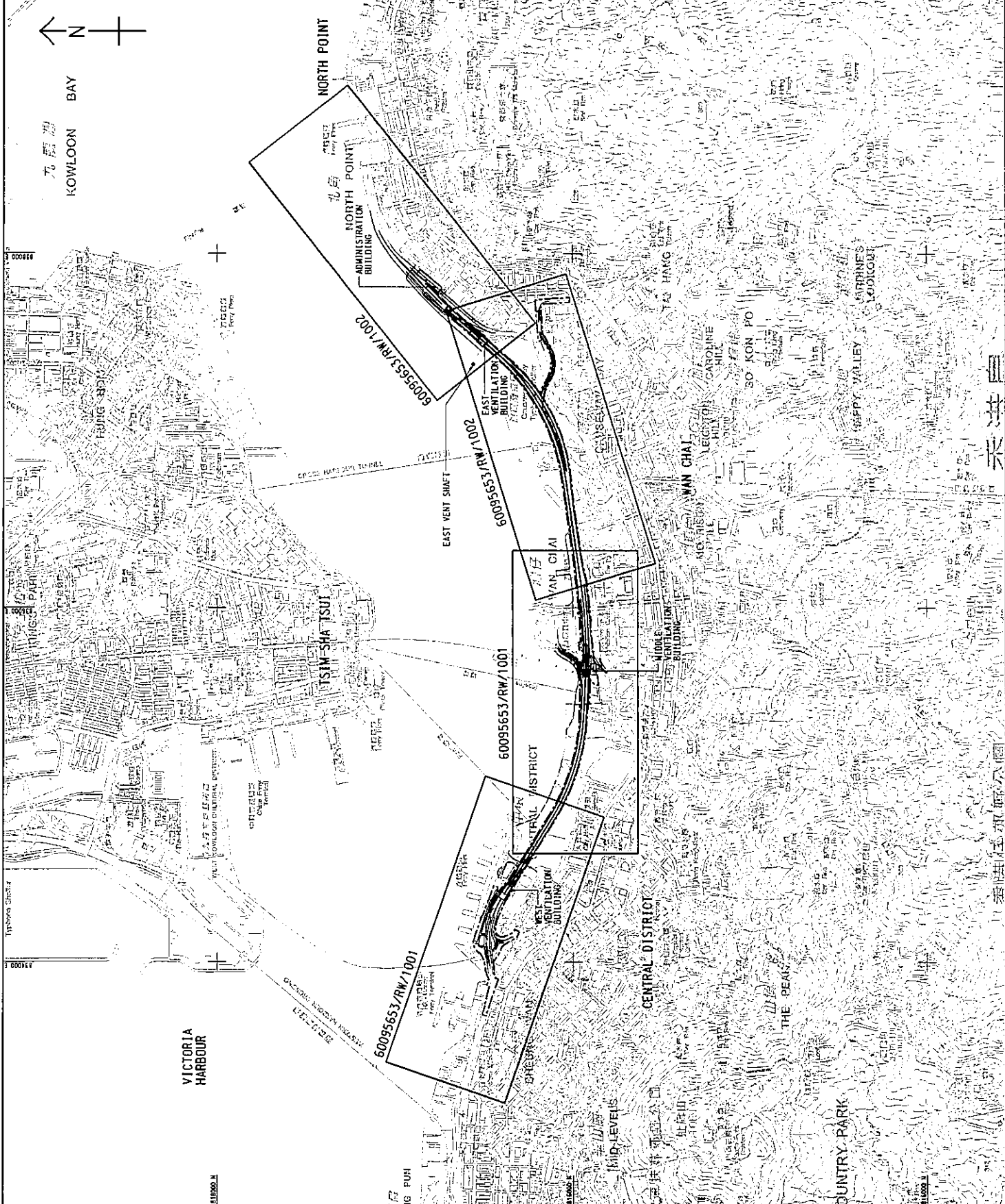

TENDER DRAWING		REVISED BY	DATE
60095653	2000	11/2000	11/2000
<b>Highways Department 路政署</b> Major Works Project Management Office (M)			
<b>CENTRAL - WAI CHAI BYPASS AND EC LINK</b>			
PWP ITEM NO.		579 TH	
TUNNEL, PUMP AND STATION WORKS, AND WORKS ASSOCIATED WITH TUNNEL COMPLETION			
<b>KEY PLAN</b>			
<b>AECOM</b>			
PROJECT NO. 60095653/RW/1000			
DATE	SCALE	PROJECT NO.	SHEET NO.
11/2000	AS SHOWN	60095653/RW/1000	11
DRAWN BY: YAU		CHECKED BY: YAU	
SCALE: 1:10000		DATE: 11/2000	
PROJECT NO. 60095653		SHEET NO. 11	
METRES		© COPYRIGHT RESERVED	

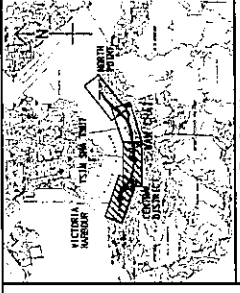

**KEY PLAN**  
 SCALE: 1:20000  
 DATE: 10/2000

- NOTES:**
1. THIS DRAWING TO BE READ IN CONJUNCTION WITH DRAWING NO. 60095653/RW/1002.
  2. ALL DIMENSIONS ARE IN METRES UNLESS NOTED OTHERWISE.
  3. DETAILS INCLUDING DIMENSIONS, LEVELS, DESCRIPTIONS, LOCATIONS, ETC. GIVEN FOR EXISTING ROADS AND UTILITIES SHALL BE THE BASIS FOR THE CONTRACTOR'S DESIGN. THE CONTRACTOR SHALL VERIFY THE ACTUAL EXISTING DETAILS ON SITE.

- LEGEND:**
- SITE BOUNDARY
  - CONTROL POINT
  - WEST VENTILATION BUILDING
  - SATELLITE CONTROL BUILDING
  - SHORE VENTILATION BUILDING
  - EAST VENTILATION BUILDING
  - ADMINISTRATION BUILDING
  - EAST WEST SHIRT

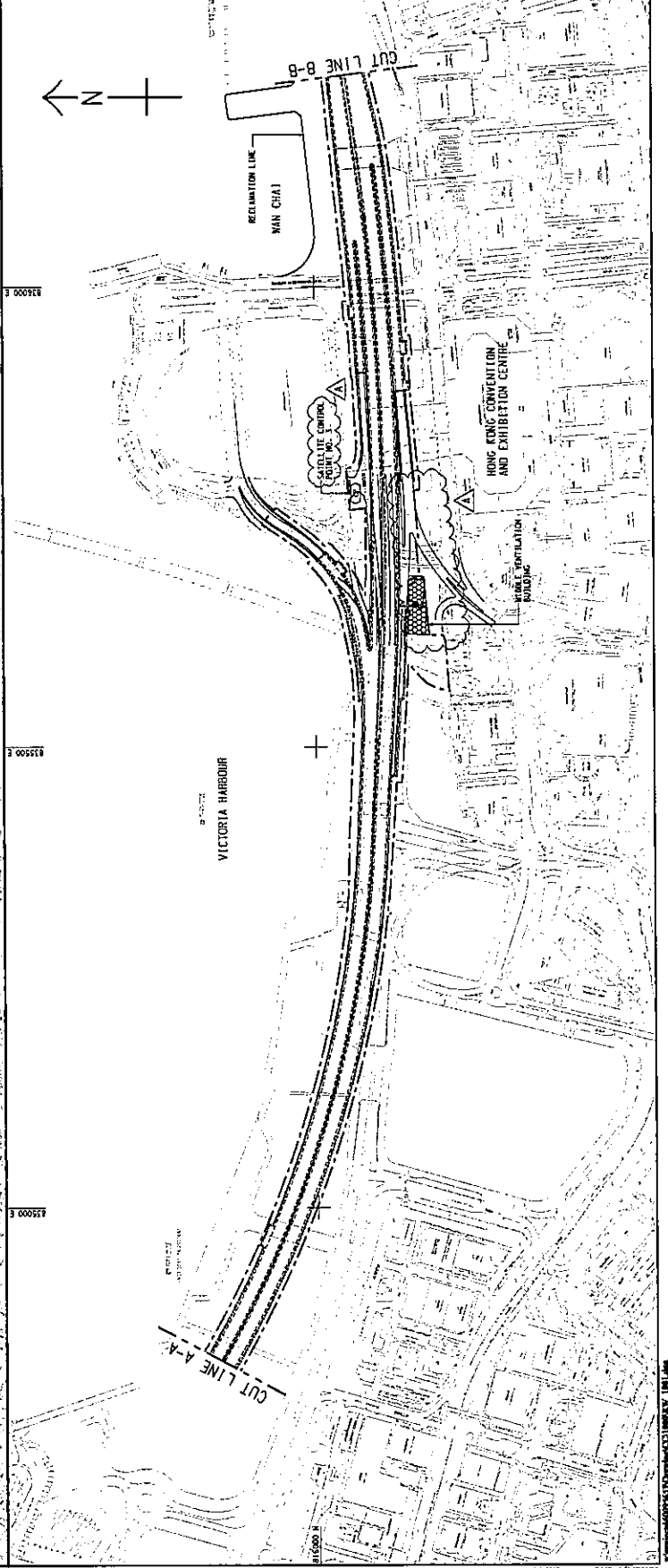
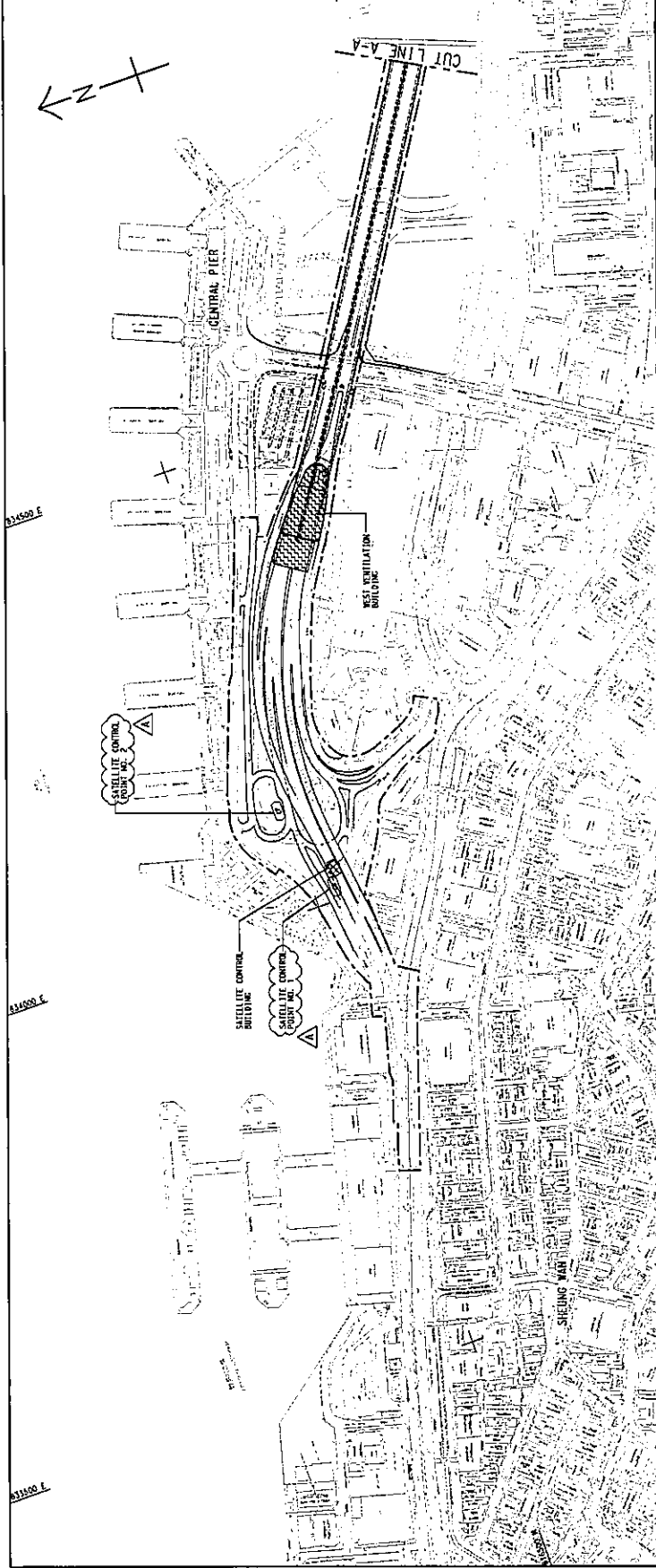

4	TENDER JOB/ORDER NO. 1	UNM/CELESTION 13
4	TENDER DRAWING	UNM/CELESTION 13
4	TENDER NO.	UNM/CELESTION 13
Highways Department 路政署 Major Works Project Management Office 大型工程项目管理处		
CENTRAL - WAN CHAI BYPASS AND EC LINK 中央-灣仔繞道及東區綫		
PMP ITEM NO.	579 TH	
CENTRAL - WAN CHAI BYPASS 中央-灣仔繞道 TUNNEL BUILDINGS, STATIONS AND INFRASTRUCTURE AND WORKS RELATED WITH TUNNEL CONSTRUCTION		
<b>GENERAL LAYOUT</b> SHEET 1 OF 2		
<b>AECOM</b>		
PROJECT NO.	60095653/RW/1001A	
DATE	10/2000	DATE
SCALE	1:20000	SCALE
圖則編號: 60095653/RW/1001A 日期: 2000年10月 比例尺: 1:20000		
圖則編號: 60095653/RW/1001A 日期: 2000年10月 比例尺: 1:20000		
圖則編號: 60095653/RW/1001A 日期: 2000年10月 比例尺: 1:20000		

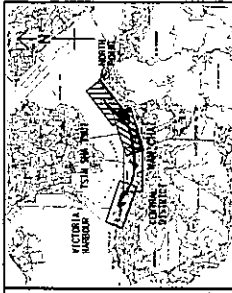

**KEY PLAN**  
SCALE AT 1:10000  
AS 1:20000

**NOTES:**  
1. THIS DRAWING SHALL BE READ IN CONJUNCTION WITH DRAWING NO. 60095653/RW/1002A FOR THE PROJECT.  
2. SEE MEASUREMENTS FOR THE PROJECT.

A	TENDER DOCUMENT NO. 1	20-11-2013	20-11-2013
B	TENDER DRAWING	20-11-2013	20-11-2013
C			
D			

Highways Department 路政署  
Major Works Project Management Office (MWO)

CENTRAL - WAN CHAI BYPASS AND EG LINK

PWP ITEM NO. 579 TH  
工務計劃項目編號

DESIGNED BY: AECOM  
CHECKED BY: AECOM  
AND WORKS ASSOCIATED WITH TENDER COMMISSIONING

GENERAL LAYOUT

SHEET 2 OF 2



PROJECT NO. 60095653/RW/1002A

DATE	DESCRIPTION	BY	CHECKED
20/11/2013	ISSUED FOR TENDER	AECOM	AECOM
20/11/2013	ISSUED FOR TENDER	AECOM	AECOM
20/11/2013	ISSUED FOR TENDER	AECOM	AECOM

SCALE: 1:10000  
DATE: 20/11/2013  
PROJECT NO. 60095653/RW/1002A

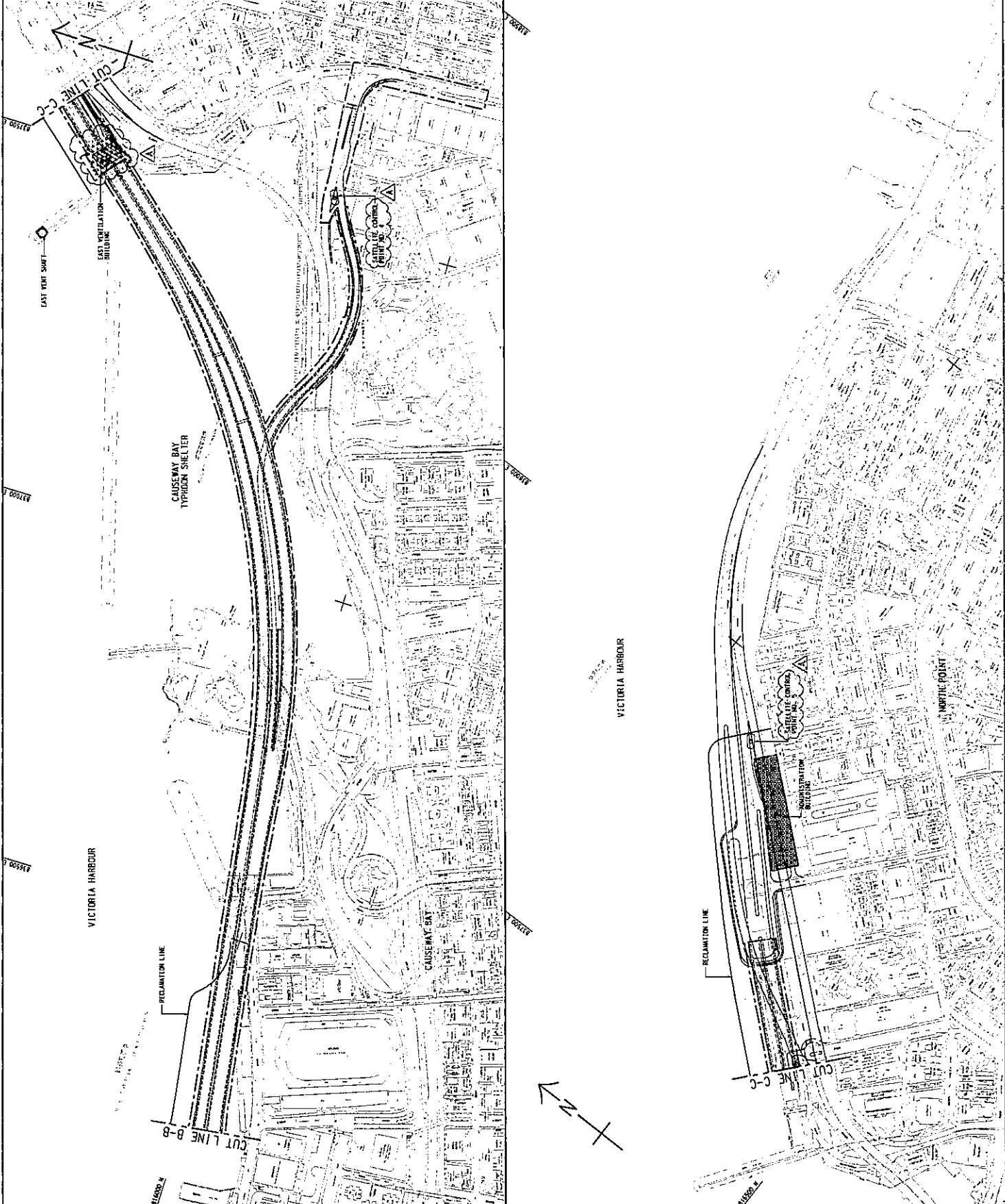

**Leighton JV**

Contract No. HY/2011/08  
Central – Wan Chai Bypass – Tunnel Buildings, Systems and Fittings, and  
Works Associated with Tunnel Commissioning  
Landscape Plan

## **Appendix B**

# **Layout Plan of the Key Visual Sensitive Receivers**

**KEY FOR VISUAL SENSITIVE RECEIVERS**

- C1 International Finance Centre
- C2 Hong Kong Station Development Phase 2
- C3 Exchange Square
- C4 Jansze House
- C5 Hong Kong Club
- C6 Ritz Carlton Hotel
- C7 AA Tower
- C8 Jansze House
- C9 Far East Financial Centre
- C10 Admiralty Centre
- C11 Citic Centre
- C12 Citic Centre
- C13 Citic Centre
- C14 Citic Centre
- C15 Citic Centre
- C16 Citic Centre
- C17 Citic Centre
- C18 Citic Centre
- C19 Citic Centre
- C20 Citic Centre
- C21 Citic Centre
- C22 Citic Centre
- C23 Citic Centre
- C24 Citic Centre
- C25 Citic Centre
- C26 Citic Centre
- C27 Citic Centre
- C28 Citic Centre
- C29 Citic Centre
- C30 Citic Centre
- C31 Citic Centre
- C32 Citic Centre
- C33 Citic Centre
- C34 Citic Centre
- C35 Citic Centre
- C36 Citic Centre
- C37 Citic Centre
- C38 Citic Centre
- C39 Citic Centre
- C40 Citic Centre
- C41 Citic Centre
- C42 Citic Centre
- C43 Citic Centre
- C44 Citic Centre
- C45 Citic Centre
- C46 Citic Centre
- C47 Citic Centre
- C48 Citic Centre
- C49 Citic Centre
- C50 Citic Centre
- C51 Citic Centre
- C52 Citic Centre
- C53 Citic Centre
- C54 Citic Centre
- C55 Citic Centre
- C56 Citic Centre
- C57 Citic Centre
- C58 Citic Centre
- C59 Citic Centre
- C60 Citic Centre
- C61 Citic Centre
- C62 Citic Centre
- C63 Citic Centre
- C64 Citic Centre
- C65 Citic Centre
- C66 Citic Centre
- C67 Citic Centre
- C68 Citic Centre
- C69 Citic Centre
- C70 Citic Centre
- C71 Citic Centre
- C72 Citic Centre
- C73 Citic Centre
- C74 Citic Centre
- C75 Citic Centre
- C76 Citic Centre
- C77 Citic Centre
- C78 Citic Centre
- C79 Citic Centre
- C80 Citic Centre
- C81 Citic Centre
- C82 Citic Centre
- C83 Citic Centre
- C84 Citic Centre
- C85 Citic Centre
- C86 Citic Centre
- C87 Citic Centre
- C88 Citic Centre
- C89 Citic Centre
- C90 Citic Centre
- C91 Citic Centre
- C92 Citic Centre
- C93 Citic Centre
- C94 Citic Centre
- C95 Citic Centre
- C96 Citic Centre
- C97 Citic Centre
- C98 Citic Centre
- C99 Citic Centre
- C100 Citic Centre

- G01 Central Post Office
- G02 P.A. Headquarters at Times
- G03 P.A. Headquarters at Times
- G04 P.A. Headquarters at Times
- G05 P.A. Headquarters at Times
- G06 P.A. Headquarters at Times
- G07 P.A. Headquarters at Times
- G08 P.A. Headquarters at Times
- G09 P.A. Headquarters at Times
- G10 P.A. Headquarters at Times
- G11 P.A. Headquarters at Times
- G12 P.A. Headquarters at Times
- G13 P.A. Headquarters at Times
- G14 P.A. Headquarters at Times
- G15 P.A. Headquarters at Times
- G16 P.A. Headquarters at Times
- G17 P.A. Headquarters at Times
- G18 P.A. Headquarters at Times
- G19 P.A. Headquarters at Times
- G20 P.A. Headquarters at Times
- G21 P.A. Headquarters at Times
- G22 P.A. Headquarters at Times
- G23 P.A. Headquarters at Times
- G24 P.A. Headquarters at Times
- G25 P.A. Headquarters at Times
- G26 P.A. Headquarters at Times
- G27 P.A. Headquarters at Times
- G28 P.A. Headquarters at Times
- G29 P.A. Headquarters at Times
- G30 P.A. Headquarters at Times
- G31 P.A. Headquarters at Times
- G32 P.A. Headquarters at Times
- G33 P.A. Headquarters at Times
- G34 P.A. Headquarters at Times
- G35 P.A. Headquarters at Times
- G36 P.A. Headquarters at Times
- G37 P.A. Headquarters at Times
- G38 P.A. Headquarters at Times
- G39 P.A. Headquarters at Times
- G40 P.A. Headquarters at Times
- G41 P.A. Headquarters at Times
- G42 P.A. Headquarters at Times
- G43 P.A. Headquarters at Times
- G44 P.A. Headquarters at Times
- G45 P.A. Headquarters at Times
- G46 P.A. Headquarters at Times
- G47 P.A. Headquarters at Times
- G48 P.A. Headquarters at Times
- G49 P.A. Headquarters at Times
- G50 P.A. Headquarters at Times
- G51 P.A. Headquarters at Times
- G52 P.A. Headquarters at Times
- G53 P.A. Headquarters at Times
- G54 P.A. Headquarters at Times
- G55 P.A. Headquarters at Times
- G56 P.A. Headquarters at Times
- G57 P.A. Headquarters at Times
- G58 P.A. Headquarters at Times
- G59 P.A. Headquarters at Times
- G60 P.A. Headquarters at Times
- G61 P.A. Headquarters at Times
- G62 P.A. Headquarters at Times
- G63 P.A. Headquarters at Times
- G64 P.A. Headquarters at Times
- G65 P.A. Headquarters at Times
- G66 P.A. Headquarters at Times
- G67 P.A. Headquarters at Times
- G68 P.A. Headquarters at Times
- G69 P.A. Headquarters at Times
- G70 P.A. Headquarters at Times
- G71 P.A. Headquarters at Times
- G72 P.A. Headquarters at Times
- G73 P.A. Headquarters at Times
- G74 P.A. Headquarters at Times
- G75 P.A. Headquarters at Times
- G76 P.A. Headquarters at Times
- G77 P.A. Headquarters at Times
- G78 P.A. Headquarters at Times
- G79 P.A. Headquarters at Times
- G80 P.A. Headquarters at Times
- G81 P.A. Headquarters at Times
- G82 P.A. Headquarters at Times
- G83 P.A. Headquarters at Times
- G84 P.A. Headquarters at Times
- G85 P.A. Headquarters at Times
- G86 P.A. Headquarters at Times
- G87 P.A. Headquarters at Times
- G88 P.A. Headquarters at Times
- G89 P.A. Headquarters at Times
- G90 P.A. Headquarters at Times
- G91 P.A. Headquarters at Times
- G92 P.A. Headquarters at Times
- G93 P.A. Headquarters at Times
- G94 P.A. Headquarters at Times
- G95 P.A. Headquarters at Times
- G96 P.A. Headquarters at Times
- G97 P.A. Headquarters at Times
- G98 P.A. Headquarters at Times
- G99 P.A. Headquarters at Times
- G100 P.A. Headquarters at Times

- R1 Residential Properties fronting Tung Lo Wan Road
- R2 Residential Properties fronting Tung Lo Wan Road
- R3 Residential Properties fronting Tung Lo Wan Road
- R4 Residential Properties fronting Tung Lo Wan Road
- R5 Residential Properties fronting Tung Lo Wan Road
- R6 Residential Properties fronting Tung Lo Wan Road
- R7 Residential Properties fronting Tung Lo Wan Road
- R8 Residential Properties fronting Tung Lo Wan Road
- R9 Residential Properties fronting Tung Lo Wan Road
- R10 Residential Properties fronting Tung Lo Wan Road
- R11 Residential Properties fronting Tung Lo Wan Road
- R12 Residential Properties fronting Tung Lo Wan Road
- R13 Residential Properties fronting Tung Lo Wan Road
- R14 Residential Properties fronting Tung Lo Wan Road
- R15 Residential Properties fronting Tung Lo Wan Road
- R16 Residential Properties fronting Tung Lo Wan Road
- R17 Residential Properties fronting Tung Lo Wan Road
- R18 Residential Properties fronting Tung Lo Wan Road
- R19 Residential Properties fronting Tung Lo Wan Road
- R20 Residential Properties fronting Tung Lo Wan Road
- R21 Residential Properties fronting Tung Lo Wan Road
- R22 Residential Properties fronting Tung Lo Wan Road
- R23 Residential Properties fronting Tung Lo Wan Road
- R24 Residential Properties fronting Tung Lo Wan Road
- R25 Residential Properties fronting Tung Lo Wan Road
- R26 Residential Properties fronting Tung Lo Wan Road
- R27 Residential Properties fronting Tung Lo Wan Road
- R28 Residential Properties fronting Tung Lo Wan Road
- R29 Residential Properties fronting Tung Lo Wan Road
- R30 Residential Properties fronting Tung Lo Wan Road
- R31 Residential Properties fronting Tung Lo Wan Road
- R32 Residential Properties fronting Tung Lo Wan Road
- R33 Residential Properties fronting Tung Lo Wan Road
- R34 Residential Properties fronting Tung Lo Wan Road
- R35 Residential Properties fronting Tung Lo Wan Road
- R36 Residential Properties fronting Tung Lo Wan Road
- R37 Residential Properties fronting Tung Lo Wan Road
- R38 Residential Properties fronting Tung Lo Wan Road
- R39 Residential Properties fronting Tung Lo Wan Road
- R40 Residential Properties fronting Tung Lo Wan Road
- R41 Residential Properties fronting Tung Lo Wan Road
- R42 Residential Properties fronting Tung Lo Wan Road
- R43 Residential Properties fronting Tung Lo Wan Road
- R44 Residential Properties fronting Tung Lo Wan Road
- R45 Residential Properties fronting Tung Lo Wan Road
- R46 Residential Properties fronting Tung Lo Wan Road
- R47 Residential Properties fronting Tung Lo Wan Road
- R48 Residential Properties fronting Tung Lo Wan Road
- R49 Residential Properties fronting Tung Lo Wan Road
- R50 Residential Properties fronting Tung Lo Wan Road
- R51 Residential Properties fronting Tung Lo Wan Road
- R52 Residential Properties fronting Tung Lo Wan Road
- R53 Residential Properties fronting Tung Lo Wan Road
- R54 Residential Properties fronting Tung Lo Wan Road
- R55 Residential Properties fronting Tung Lo Wan Road
- R56 Residential Properties fronting Tung Lo Wan Road
- R57 Residential Properties fronting Tung Lo Wan Road
- R58 Residential Properties fronting Tung Lo Wan Road
- R59 Residential Properties fronting Tung Lo Wan Road
- R60 Residential Properties fronting Tung Lo Wan Road
- R61 Residential Properties fronting Tung Lo Wan Road
- R62 Residential Properties fronting Tung Lo Wan Road
- R63 Residential Properties fronting Tung Lo Wan Road
- R64 Residential Properties fronting Tung Lo Wan Road
- R65 Residential Properties fronting Tung Lo Wan Road
- R66 Residential Properties fronting Tung Lo Wan Road
- R67 Residential Properties fronting Tung Lo Wan Road
- R68 Residential Properties fronting Tung Lo Wan Road
- R69 Residential Properties fronting Tung Lo Wan Road
- R70 Residential Properties fronting Tung Lo Wan Road
- R71 Residential Properties fronting Tung Lo Wan Road
- R72 Residential Properties fronting Tung Lo Wan Road
- R73 Residential Properties fronting Tung Lo Wan Road
- R74 Residential Properties fronting Tung Lo Wan Road
- R75 Residential Properties fronting Tung Lo Wan Road
- R76 Residential Properties fronting Tung Lo Wan Road
- R77 Residential Properties fronting Tung Lo Wan Road
- R78 Residential Properties fronting Tung Lo Wan Road
- R79 Residential Properties fronting Tung Lo Wan Road
- R80 Residential Properties fronting Tung Lo Wan Road
- R81 Residential Properties fronting Tung Lo Wan Road
- R82 Residential Properties fronting Tung Lo Wan Road
- R83 Residential Properties fronting Tung Lo Wan Road
- R84 Residential Properties fronting Tung Lo Wan Road
- R85 Residential Properties fronting Tung Lo Wan Road
- R86 Residential Properties fronting Tung Lo Wan Road
- R87 Residential Properties fronting Tung Lo Wan Road
- R88 Residential Properties fronting Tung Lo Wan Road
- R89 Residential Properties fronting Tung Lo Wan Road
- R90 Residential Properties fronting Tung Lo Wan Road
- R91 Residential Properties fronting Tung Lo Wan Road
- R92 Residential Properties fronting Tung Lo Wan Road
- R93 Residential Properties fronting Tung Lo Wan Road
- R94 Residential Properties fronting Tung Lo Wan Road
- R95 Residential Properties fronting Tung Lo Wan Road
- R96 Residential Properties fronting Tung Lo Wan Road
- R97 Residential Properties fronting Tung Lo Wan Road
- R98 Residential Properties fronting Tung Lo Wan Road
- R99 Residential Properties fronting Tung Lo Wan Road
- R100 Residential Properties fronting Tung Lo Wan Road

- C01 Commercial
- C02 Residential
- C03 Recreational
- C04 Government / Institution / Community
- C05 Transport
- C06 Central-Wanchai Bypass (CWB) including its road tunnel and slip roads
- C07 Road P2 and other roads which are classified as primary/district distributor roads
- C08 Reclamation works including associated dredging works
- C09 Temporary typhoon shelter

- Legend
- Planning and Engineering Review
- Tudy Area Boundary
- Limit of Primary Zone of Visual Influence
- Boundary of Key VSRs
- Photo Taking Point with Photo No.
- Commercial
- Residential
- Recreational
- Government / Institution / Community
- Transport
- Central-Wanchai Bypass (CWB) including its road tunnel and slip roads
- Road P2 and other roads which are classified as primary/district distributor roads
- Reclamation works including associated dredging works
- Temporary typhoon shelter

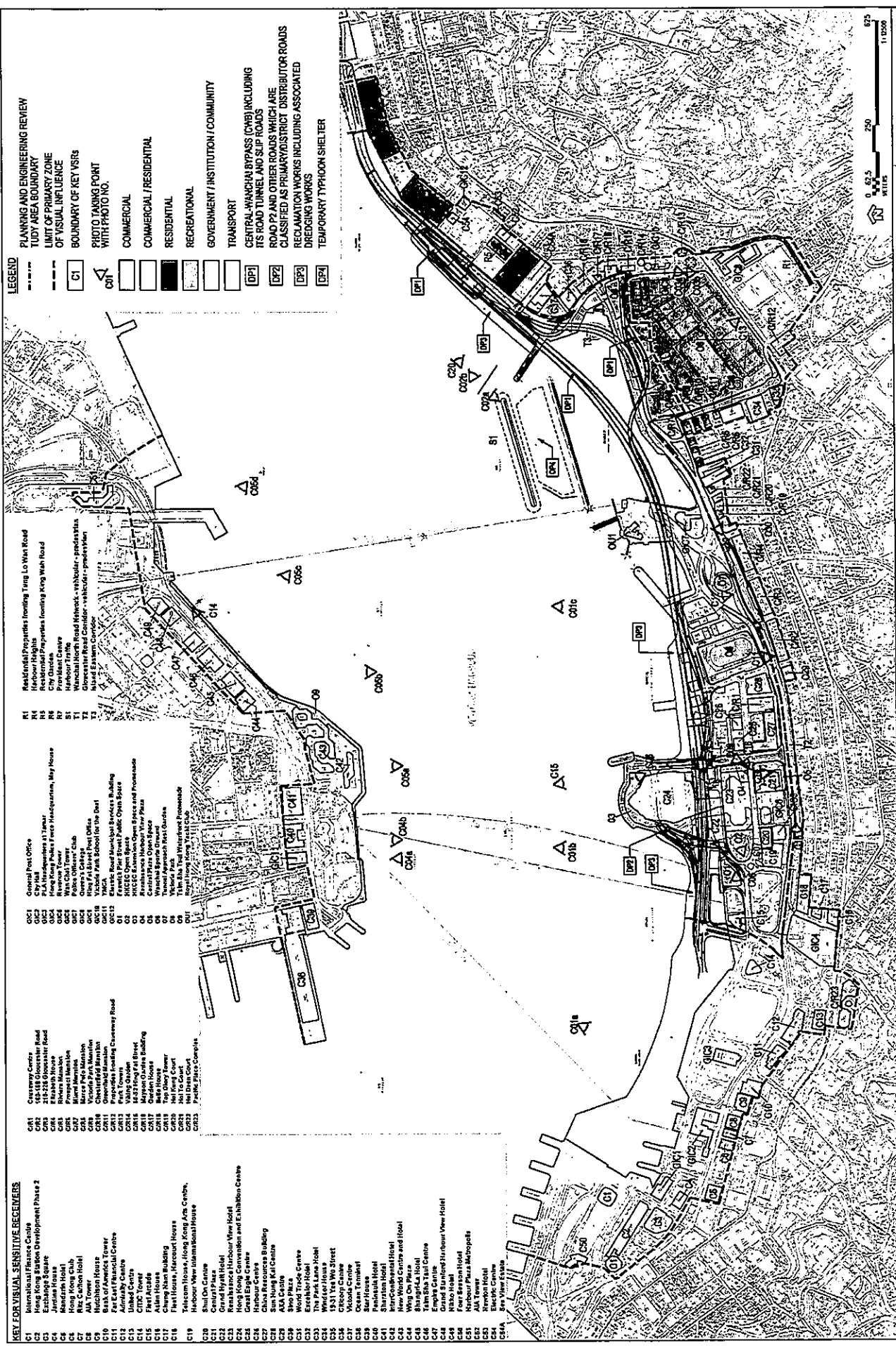

WAN CHAI DEVELOPMENT PHASE II - PLANNING AND ENGINEERING REVIEW

**KEY VSRs AND PRIMARY ZONE OF VISUAL INFLUENCE DURING CONSTRUCTION**

**FIGURE 10.4**

**Leighton JV**

Contract No. HY/2011/08  
Central – Wan Chai Bypass – Tunnel Buildings, Systems and Fittings, and  
Works Associated with Tunnel Commissioning  
Landscape Plan

## **Appendix C**

# **Layout Plan of Tree and Shrub Plantings**

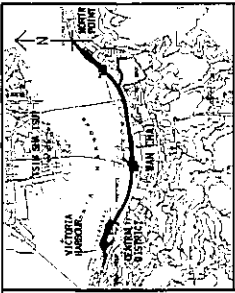
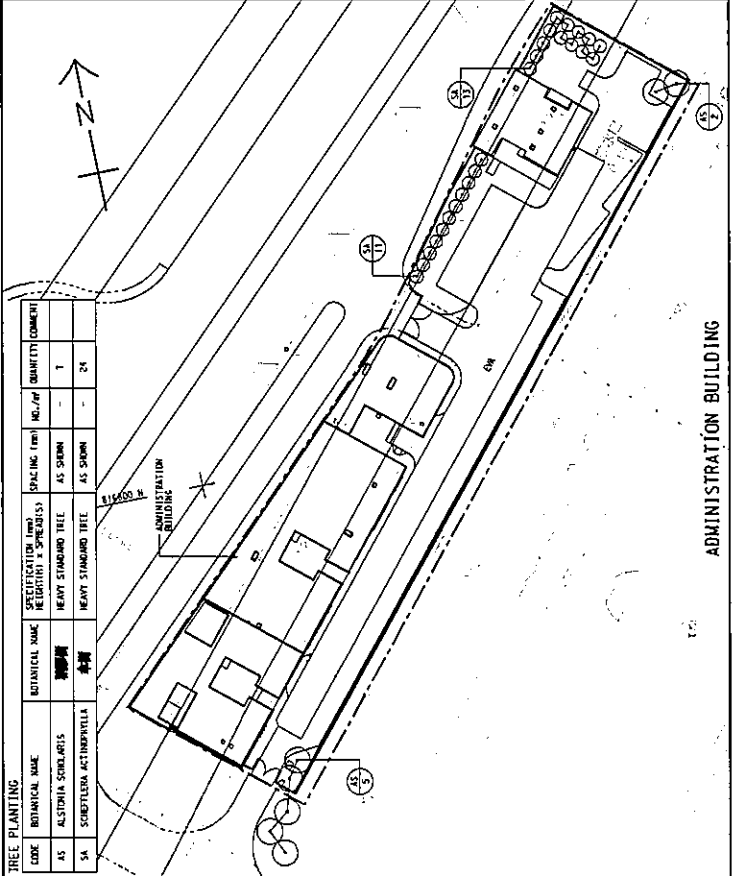
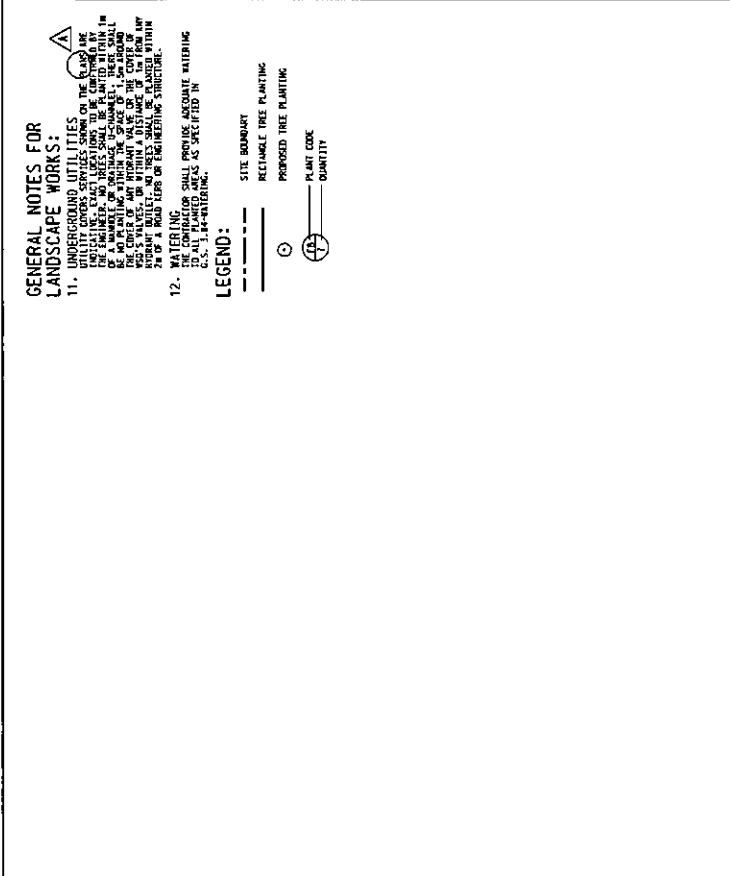
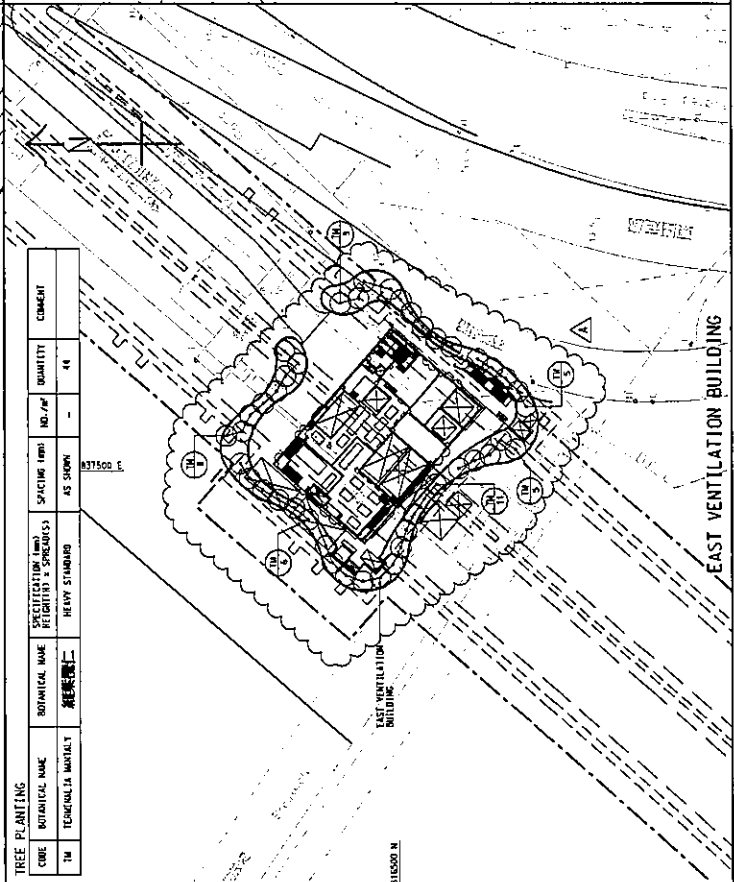
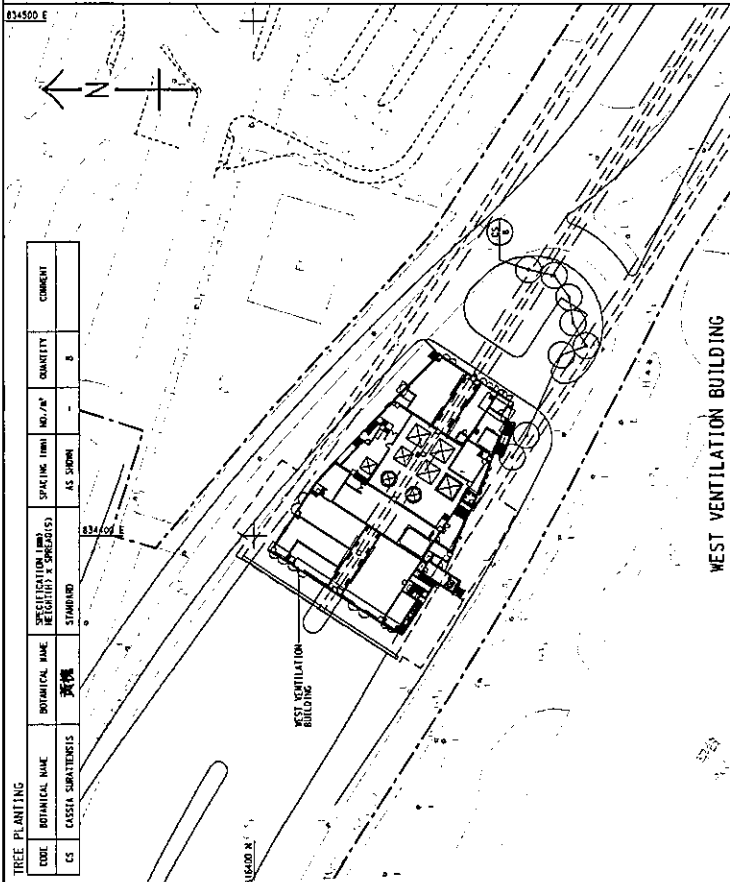

**GENERAL NOTES FOR LANDSCAPE WORKS:**

1. GENERAL INFORMATION: THE CONTRACTOR SHALL PROVIDE ACCURATE WATERING DRAINAGE AND DRAINAGE WORKS TO BE PLANTED IN THE PLANTING AREAS AS SPECIFIED IN THE DRAWINGS.
2. UNDERGROUND UTILITIES: THE CONTRACTOR SHALL PROVIDE ACCURATE WATERING DRAINAGE AND DRAINAGE WORKS TO BE PLANTED IN THE PLANTING AREAS AS SPECIFIED IN THE DRAWINGS.
3. WATERING: THE CONTRACTOR SHALL PROVIDE ACCURATE WATERING DRAINAGE AND DRAINAGE WORKS TO BE PLANTED IN THE PLANTING AREAS AS SPECIFIED IN THE DRAWINGS.
4. PLANTING: THE CONTRACTOR SHALL PROVIDE ACCURATE WATERING DRAINAGE AND DRAINAGE WORKS TO BE PLANTED IN THE PLANTING AREAS AS SPECIFIED IN THE DRAWINGS.
5. MAINTENANCE: THE CONTRACTOR SHALL PROVIDE ACCURATE WATERING DRAINAGE AND DRAINAGE WORKS TO BE PLANTED IN THE PLANTING AREAS AS SPECIFIED IN THE DRAWINGS.
6. PLANTING: THE CONTRACTOR SHALL PROVIDE ACCURATE WATERING DRAINAGE AND DRAINAGE WORKS TO BE PLANTED IN THE PLANTING AREAS AS SPECIFIED IN THE DRAWINGS.
7. PLANTING: THE CONTRACTOR SHALL PROVIDE ACCURATE WATERING DRAINAGE AND DRAINAGE WORKS TO BE PLANTED IN THE PLANTING AREAS AS SPECIFIED IN THE DRAWINGS.
8. PLANTING: THE CONTRACTOR SHALL PROVIDE ACCURATE WATERING DRAINAGE AND DRAINAGE WORKS TO BE PLANTED IN THE PLANTING AREAS AS SPECIFIED IN THE DRAWINGS.
9. PLANTING: THE CONTRACTOR SHALL PROVIDE ACCURATE WATERING DRAINAGE AND DRAINAGE WORKS TO BE PLANTED IN THE PLANTING AREAS AS SPECIFIED IN THE DRAWINGS.
10. PLANTING: THE CONTRACTOR SHALL PROVIDE ACCURATE WATERING DRAINAGE AND DRAINAGE WORKS TO BE PLANTED IN THE PLANTING AREAS AS SPECIFIED IN THE DRAWINGS.

**GENERAL NOTES FOR LANDSCAPE WORKS:**

1. GENERAL INFORMATION: THE CONTRACTOR SHALL PROVIDE ACCURATE WATERING DRAINAGE AND DRAINAGE WORKS TO BE PLANTED IN THE PLANTING AREAS AS SPECIFIED IN THE DRAWINGS.
2. UNDERGROUND UTILITIES: THE CONTRACTOR SHALL PROVIDE ACCURATE WATERING DRAINAGE AND DRAINAGE WORKS TO BE PLANTED IN THE PLANTING AREAS AS SPECIFIED IN THE DRAWINGS.
3. WATERING: THE CONTRACTOR SHALL PROVIDE ACCURATE WATERING DRAINAGE AND DRAINAGE WORKS TO BE PLANTED IN THE PLANTING AREAS AS SPECIFIED IN THE DRAWINGS.
4. PLANTING: THE CONTRACTOR SHALL PROVIDE ACCURATE WATERING DRAINAGE AND DRAINAGE WORKS TO BE PLANTED IN THE PLANTING AREAS AS SPECIFIED IN THE DRAWINGS.
5. MAINTENANCE: THE CONTRACTOR SHALL PROVIDE ACCURATE WATERING DRAINAGE AND DRAINAGE WORKS TO BE PLANTED IN THE PLANTING AREAS AS SPECIFIED IN THE DRAWINGS.
6. PLANTING: THE CONTRACTOR SHALL PROVIDE ACCURATE WATERING DRAINAGE AND DRAINAGE WORKS TO BE PLANTED IN THE PLANTING AREAS AS SPECIFIED IN THE DRAWINGS.
7. PLANTING: THE CONTRACTOR SHALL PROVIDE ACCURATE WATERING DRAINAGE AND DRAINAGE WORKS TO BE PLANTED IN THE PLANTING AREAS AS SPECIFIED IN THE DRAWINGS.
8. PLANTING: THE CONTRACTOR SHALL PROVIDE ACCURATE WATERING DRAINAGE AND DRAINAGE WORKS TO BE PLANTED IN THE PLANTING AREAS AS SPECIFIED IN THE DRAWINGS.
9. PLANTING: THE CONTRACTOR SHALL PROVIDE ACCURATE WATERING DRAINAGE AND DRAINAGE WORKS TO BE PLANTED IN THE PLANTING AREAS AS SPECIFIED IN THE DRAWINGS.
10. PLANTING: THE CONTRACTOR SHALL PROVIDE ACCURATE WATERING DRAINAGE AND DRAINAGE WORKS TO BE PLANTED IN THE PLANTING AREAS AS SPECIFIED IN THE DRAWINGS.

**GENERAL NOTES FOR LANDSCAPE WORKS:**

11. UNDERGROUND UTILITIES: THE CONTRACTOR SHALL PROVIDE ACCURATE WATERING DRAINAGE AND DRAINAGE WORKS TO BE PLANTED IN THE PLANTING AREAS AS SPECIFIED IN THE DRAWINGS.
12. WATERING: THE CONTRACTOR SHALL PROVIDE ACCURATE WATERING DRAINAGE AND DRAINAGE WORKS TO BE PLANTED IN THE PLANTING AREAS AS SPECIFIED IN THE DRAWINGS.

**LEGEND:**

- SITE BOUNDARY
- RECTANGULAR TREE PLANTING
- CIRCULAR TREE PLANTING
- PLANT CODE
- QUANTITY

**WORKING DRAWING**

Highways Department 路政署  
Major Works Project Management Office 主要工程項目管理處  
CENTRAL - WAN CHAI BYPASS AND BEC LINK  
PWP ITEM NO. 579 TH  
工務計劃項目編號

**AECOM**

DRAWING NO. 60095653/RW/1701B  
DATE: 15/11/2010  
SCALE: A1 : 1 : 5000  
DRAWN BY: ALCF  
CHECKED BY: JHU  
DATE: 15/11/2010  
SCALE: A1 : 1 : 5000  
DESIGNED BY: JHU  
DATE: 15/11/2010  
SCALE: A1 : 1 : 5000  
PROJECT NO. 60095653  
PROJECT NAME: CENTRAL - WAN CHAI BYPASS AND BEC LINK  
DRAWN BY: ALCF  
CHECKED BY: JHU  
DATE: 15/11/2010  
SCALE: A1 : 1 : 5000  
DESIGNED BY: JHU  
DATE: 15/11/2010  
SCALE: A1 : 1 : 5000



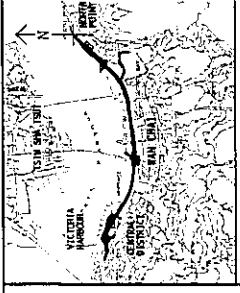

**KEY PLAN**  
SCALE: 1:10000

**NOTES:**

- GENERAL NOTES REFERS TO DRAWING NO. 1.
- CONTRACTOR SHALL BE REFER TO THE STANDARD DRAWING BY THE CONTRACTOR.
- PAVING IN LOC. REFER TO HIGHWAYS DEPARTMENT STANDARD DRAWING FOR PAVING.
- THE CONTRACTOR SHALL BE RESPONSIBLE FOR THE EXACT EXTENT AND DETAILS OF THE PLANTING TO BE PROVIDED BY THE CONTRACTOR AND AGREED ON SITE WITH THE LANDLORD.

**LEGEND:**

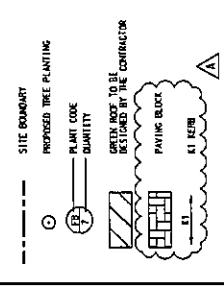

8	FORMING DRAWING	DATE: 11/11/08
9	TENDER DOCUMENT NO. 1	PROJECT: 08/01/08
10	TENDER DRAWING	PROJECT: 08/01/08
11	TENDER DRAWING	PROJECT: 08/01/08

Highways Department 路政署  
Major Works Project Management Office 主要工程項目辦事處  
CENTRAL - WAN CHAI BYPASS AND BIC LINK  
PWP ITEM NO. 579 TH  
GENERAL - WAN CHAI BYPASS AND BIC LINK  
THREE BUILDINGS SYSTEMS AND UTILITIES PLAN FOR SHRUB PLANTING AND ROAD FURNITURE AT VENTILATION BUILDINGS

PROJECT NO.	60095653/RW/1711B
DATE	17/01/08
SCALE	AS SHOWN
STATUS	WORKING DRAWING
DATE	15/1/2008
PROJECT NO.	60095653/RW/1711B
DATE	17/01/08
SCALE	AS SHOWN
STATUS	WORKING DRAWING
DATE	15/1/2008

**AECOM**

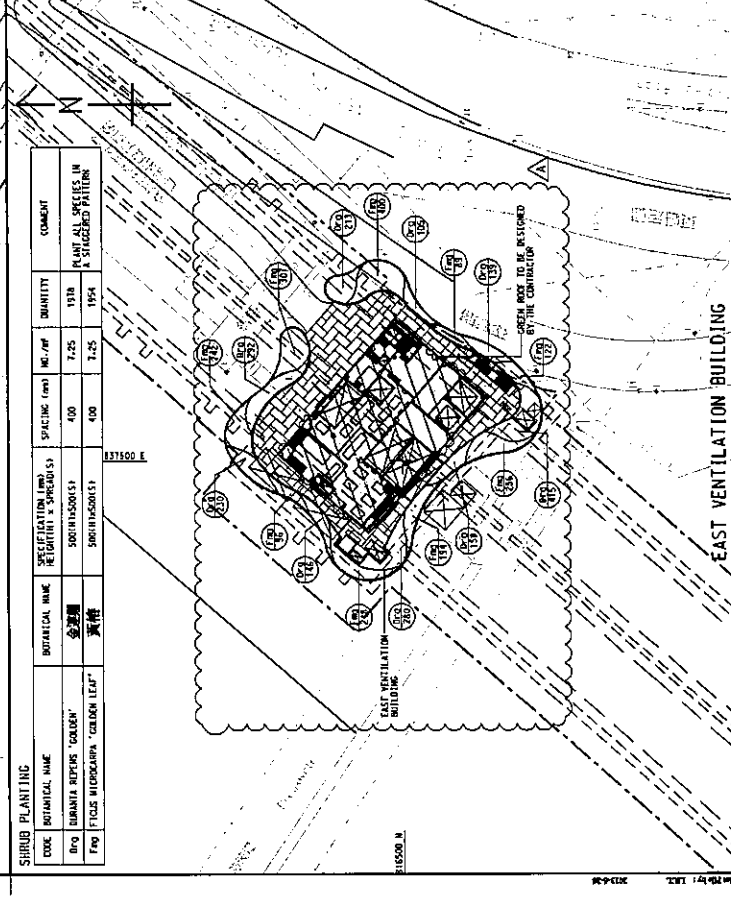
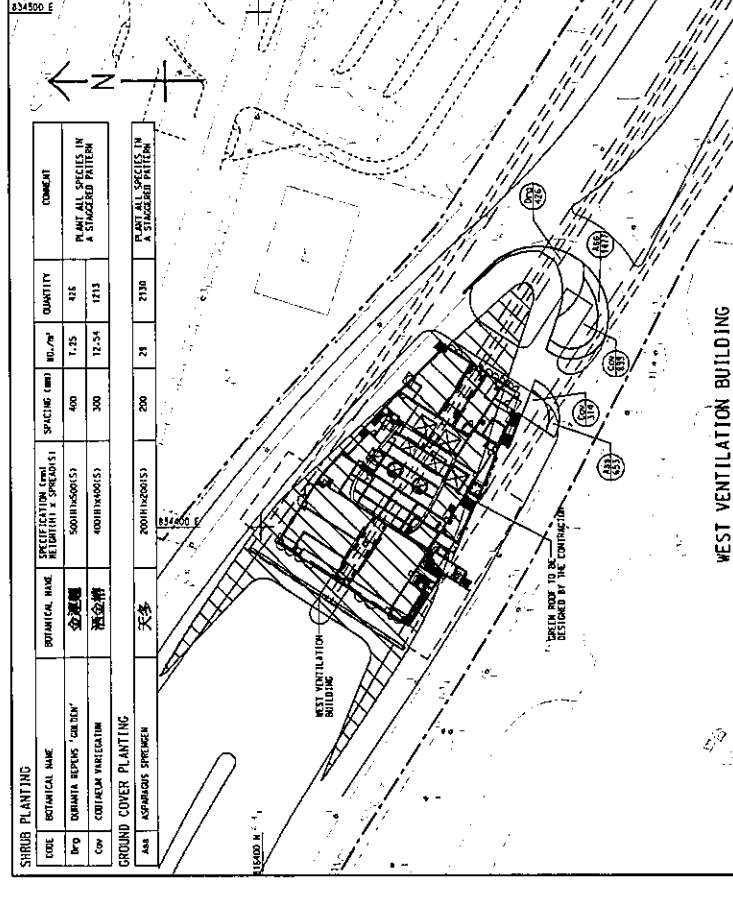
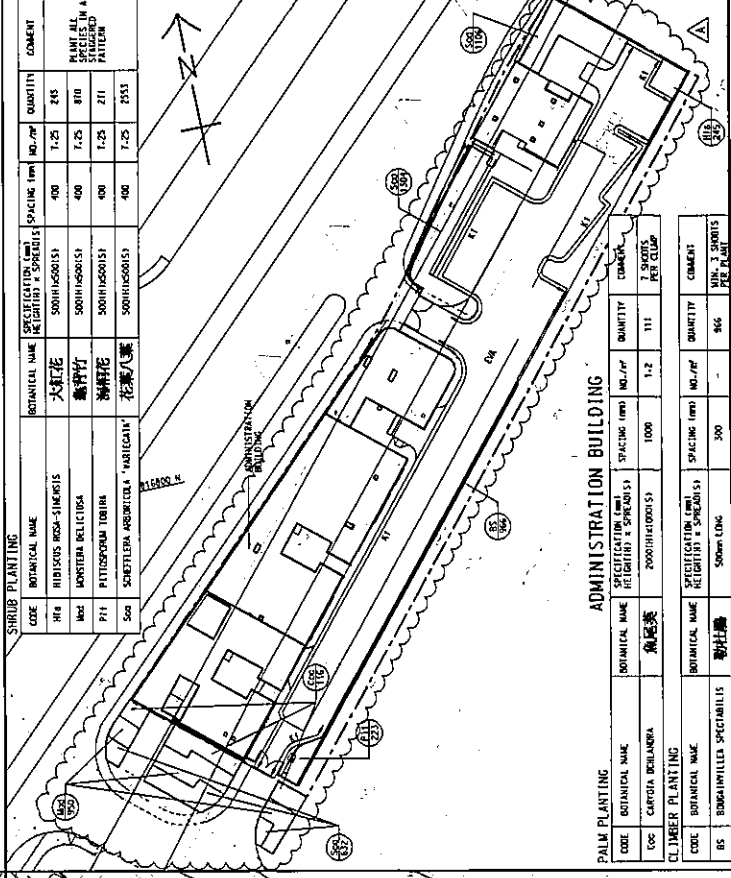
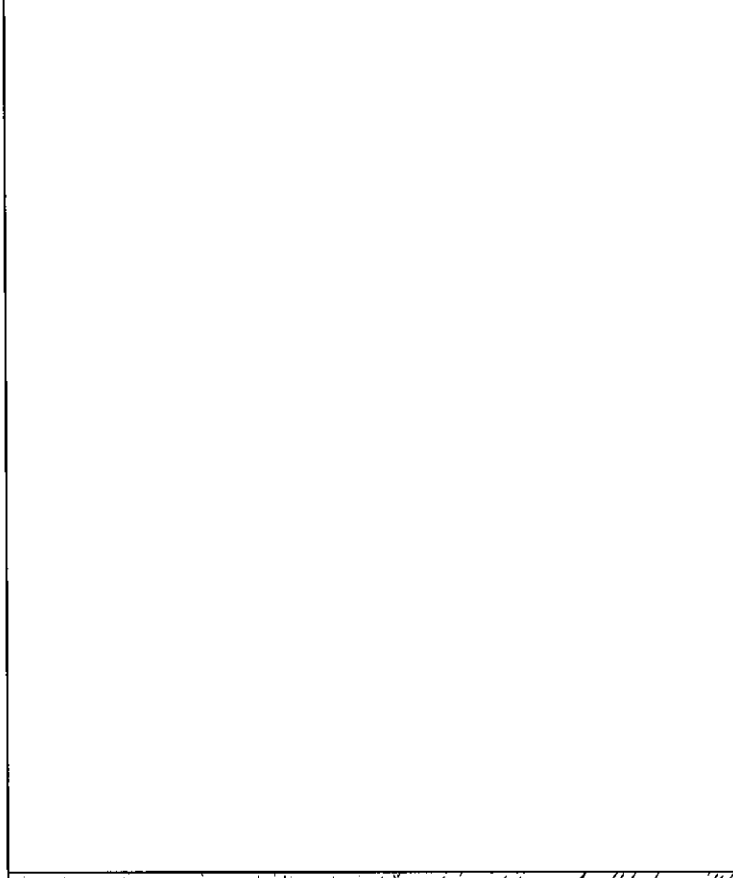

DATE: 17/01/08  
SCALE: AS SHOWN  
STATUS: WORKING DRAWING

**Leighton JV**

Contract No. HY/2011/08  
Central – Wan Chai Bypass – Tunnel Buildings, Systems and Fittings, and  
Works Associated with Tunnel Commissioning  
Landscape Plan

## **Appendix D Layout Plan of Hoarding Works and Hoarding Designs**

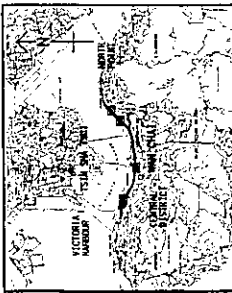

**KEY PLAN**  
SCALE: 1:10000

- NOTES:**
1. DETAILS OF TENDERS STANDARD HOARDING SHALL REFER TO THE STANDARD DRAWINGS 1610 AND 1611.
  2. THE CONTRACTOR SHALL PROVIDE THREE (3) TERMINATING POINTS OF HOARDING TO BE SET OUT AND MARKED WITH CLAUSE 1.8A.
  3. THE CONTRACTOR MAY ADJUST THE HOARDING PANELS TO SUIT THE SITE CONDITIONS, SUBJECT TO THE APPROVAL OF THE CONSULTING ENGINEER.
  4. HOARDING SHALL BE PROPERLY LIT AT NIGHT.

- LEGEND:**
- SITE BOUNDARY
  - TYPE-A HOARDING (TYPE A/B/C)
  - TYPE-B HOARDING (TYPE A/B/C)
  - TYPE-C HOARDING (TYPE A/B/C)
  - TYPE-D HOARDING (TYPE A/B/C)
  - TYPE-E HOARDING (TYPE A/B/C)
  - ACCESS GATE, DETAILS TO BE SET OUT TO SUIT THE SITE CONDITIONS

A	TENDER ADDENDUM NO. 1	REVISED JUN 13
B	TENDER DRAWING	UNREVISED MAY 13
C	REVISION	REVISED MAY 13

Highways Department 路政署  
Major Works Project Management Office

CENTRAL - WAH CHAI BYPASS AND EC LINK  
工務計劃項目編號

PWP ITEM NO. 579 TH  
CENTRAL - WAH CHAI BYPASS - TUNNEL BUILDING, SYSTEM AND FITTINGS AND WORKS ASSOCIATED WITH TUNNEL CONSTRUCTION

**HOARDING LAYOUT PLAN**

**AECOM**

PROJECT NO. 60095653/RW/1121A  
DATE: 11/2011/09  
SCALE: 1:1000

DESIGNED BY: [Name]  
DRAWN BY: [Name]  
CHECKED BY: [Name]  
DATE: 11/2011/09

© COPYRIGHT RESERVED

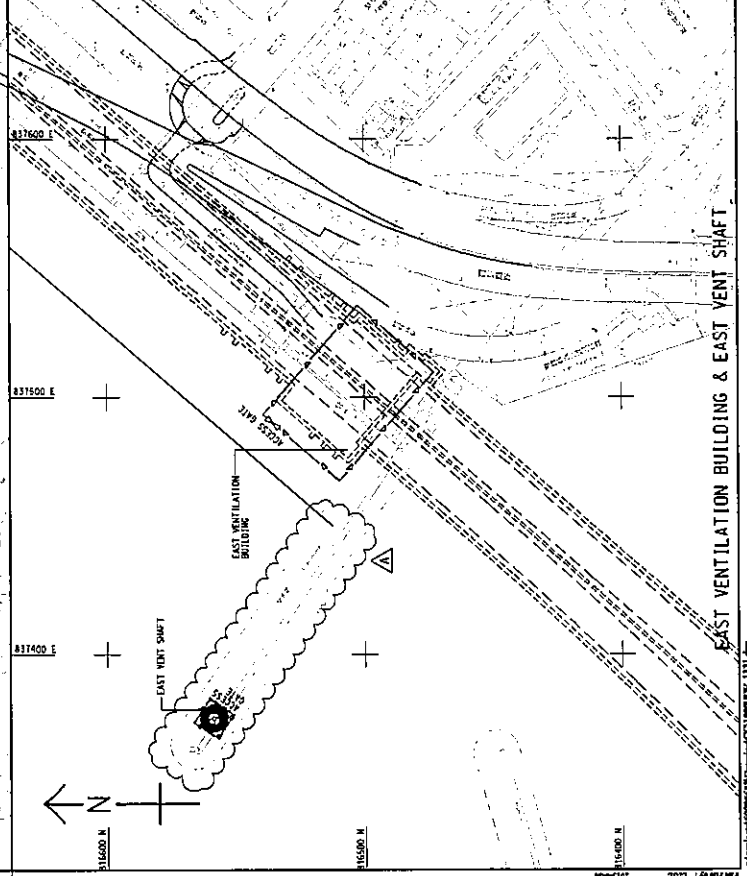
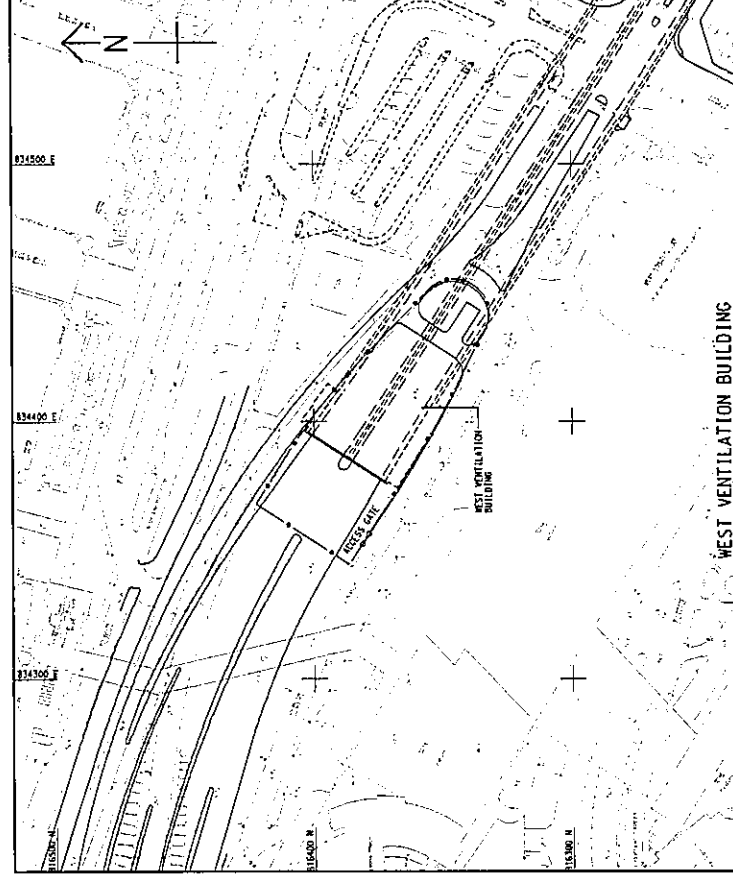
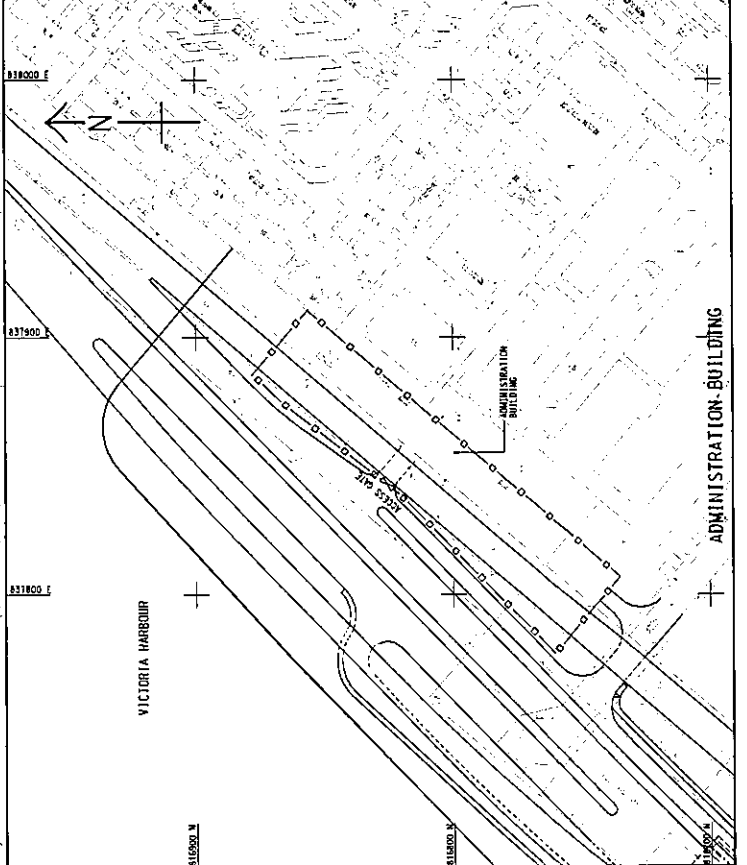
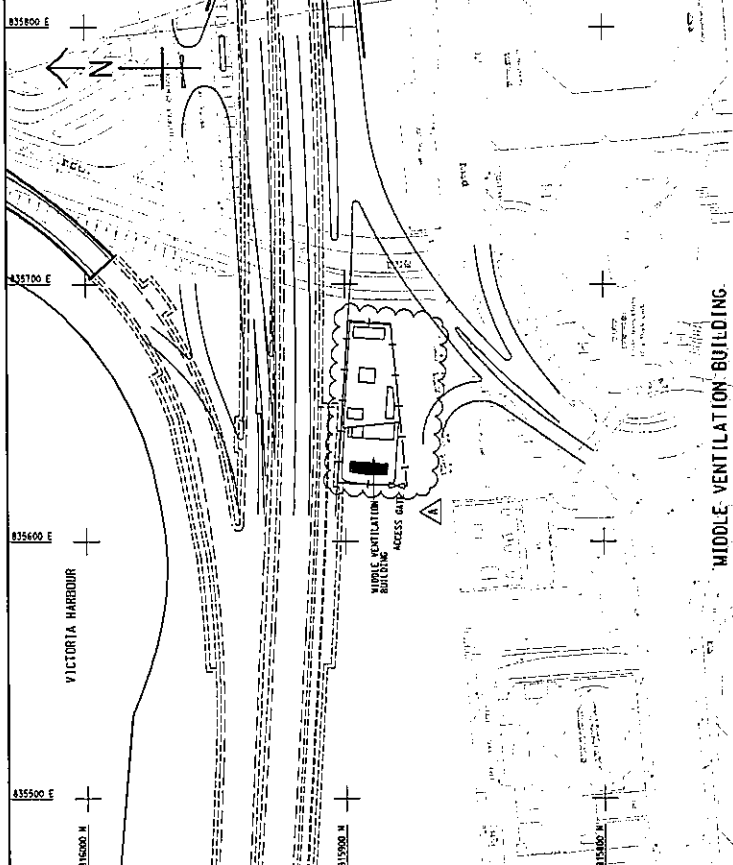

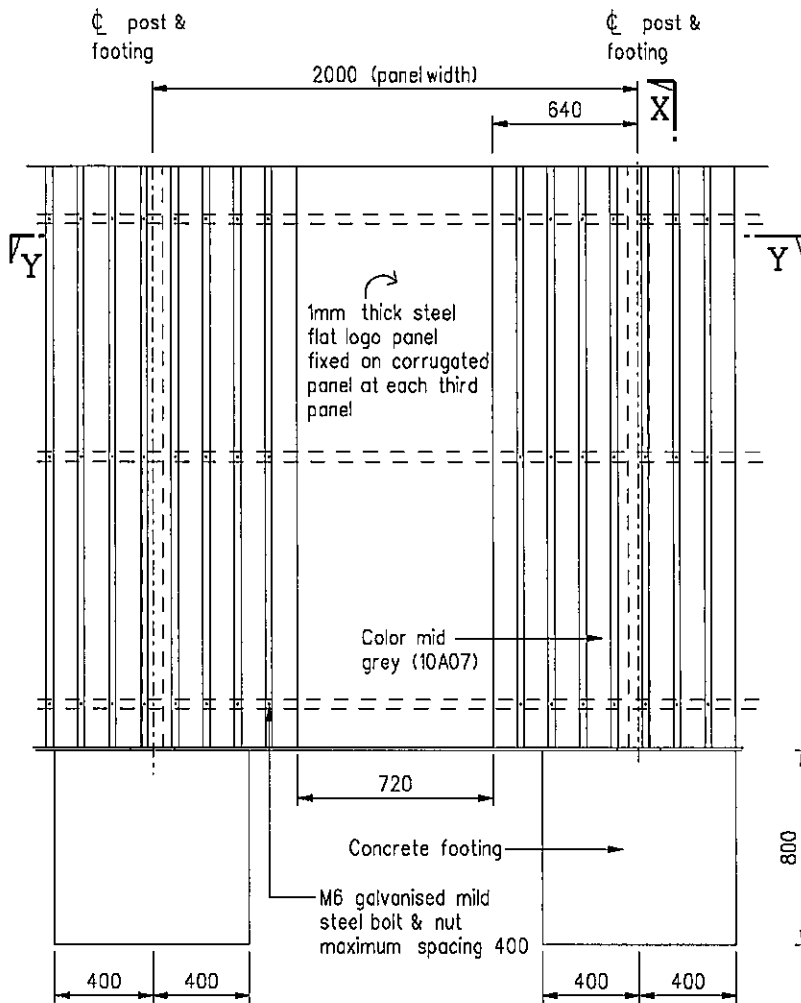

ELEVATION

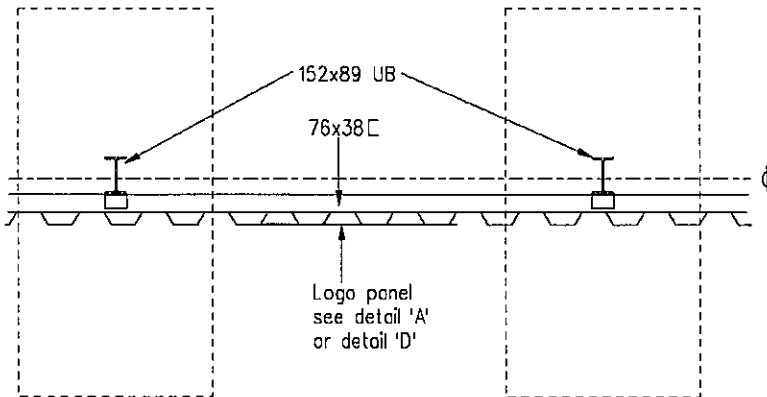

SECTION Y - Y

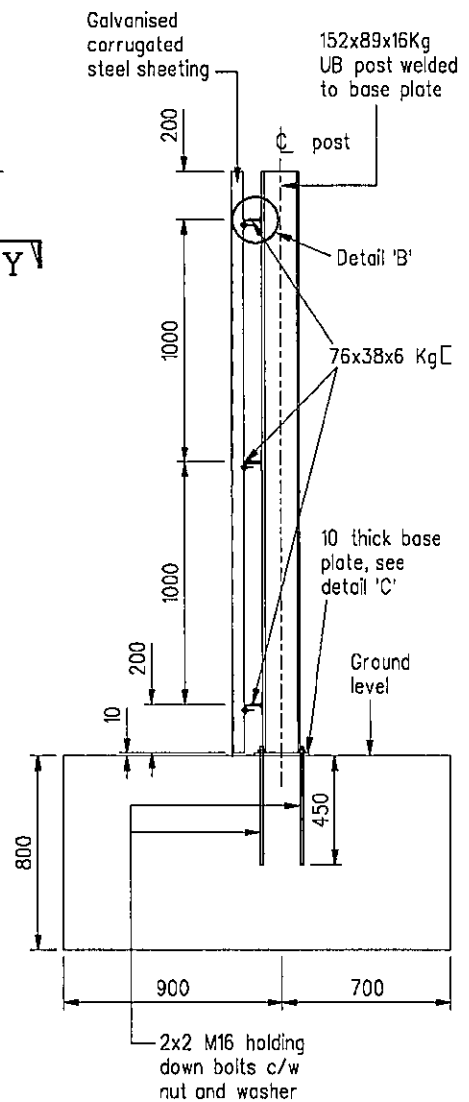

SECTION X - X

Notes :

1. For notes, see Drg. H6111.
2. Where the concrete footing is located in block paved footpath, the footing should be lowered to allow for the paving blocks and the sand course.
3. Logo to details 'A' and 'D' shall be displayed alternately.

C	Note 3 added, notes in section Y-Y revised and dimensions in Elevation revised for clarity		Jul 11
B	Note 2 added		Nov 99
A	Height of steel sheeting and sizes of post & footing revised		June 97
	Former Drg. No. H6007/1A		June 94
REF.	REVISION	SIGNATURE	DATE

**SITE HOARDINGS  
(SHEET 1 OF 2)**

**HIGHWAYS DEPARTMENT**

REFERENCE	DRAWING No.	CAD
SCALE	H 6110C	
1:30		

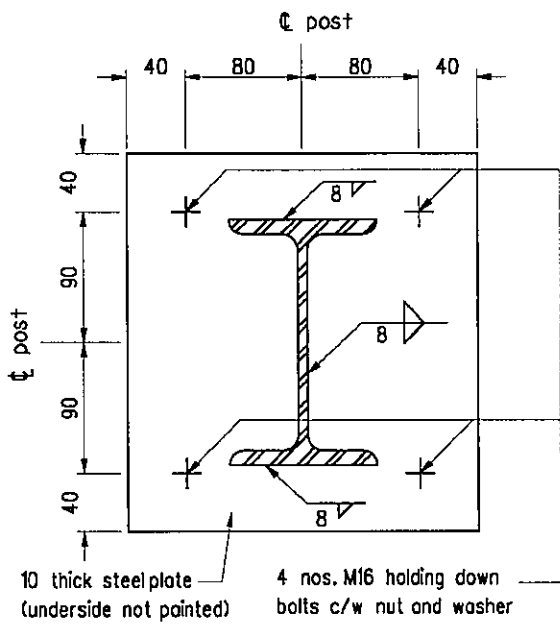

**DETAIL 'C'**  
(Scale 1:5)

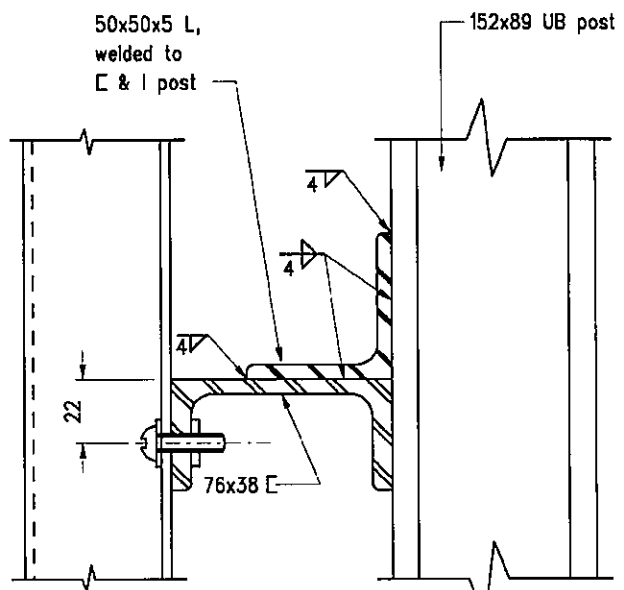

**DETAIL 'B'**  
(Scale 1:2.5)

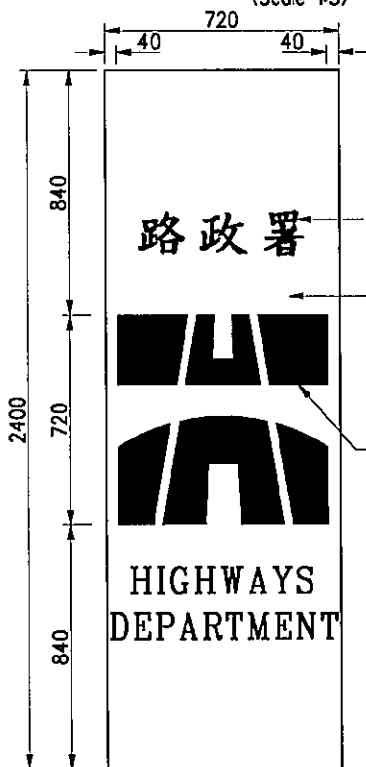

**DETAIL 'A'**

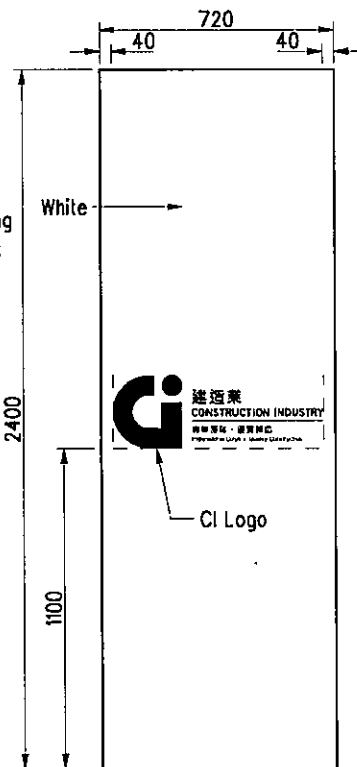

**DETAIL 'D'**

**Notes:**

1. Dimensions are in millimetres.
2. For details of Highways Department logo and Construction Industry Logo, see Drg. H6101 and H6163 respectively.
3. All steelwork except corrugated steel sheeting shall be painted with system A stated in clause 18.63 of G.S. 2006.
4. All concrete shall be grade 20/20. The use of recycled aggregates may be considered.
5. Corrugated steel sheeting shall have section modulus not less than 2000mm<sup>3</sup>/m. The sheeting shall be to BS3083 8/3 G350.
6. Alternative construction details (including foundation details) for the site hoarding, which must be capable of withstanding a wind pressure of 1.2 KPa, shall be agreed to by the Engineer.

D	Note 2 revised, detail 'D' added and dimensions of detail 'A' revised for clarity		Jul 11
C	Notes 3, 4 and 6 revised		Nov 07
B	Highways Department in Chinese is placed at the top of the logo		Dec 99
A	Sizes of post & steel plate and details of welding revised		Jun 97
	Former Drg. No. H6007/2		Jun 94
REF.	REVISION	SIGNATURE	DATE

**SITE HOARDINGS  
(SHEET 2 OF 2)**

**HIGHWAYS DEPARTMENT**

REFERENCE

DRAWING No.

CAD

SCALE

1:25 or As shown

**H 6111D**

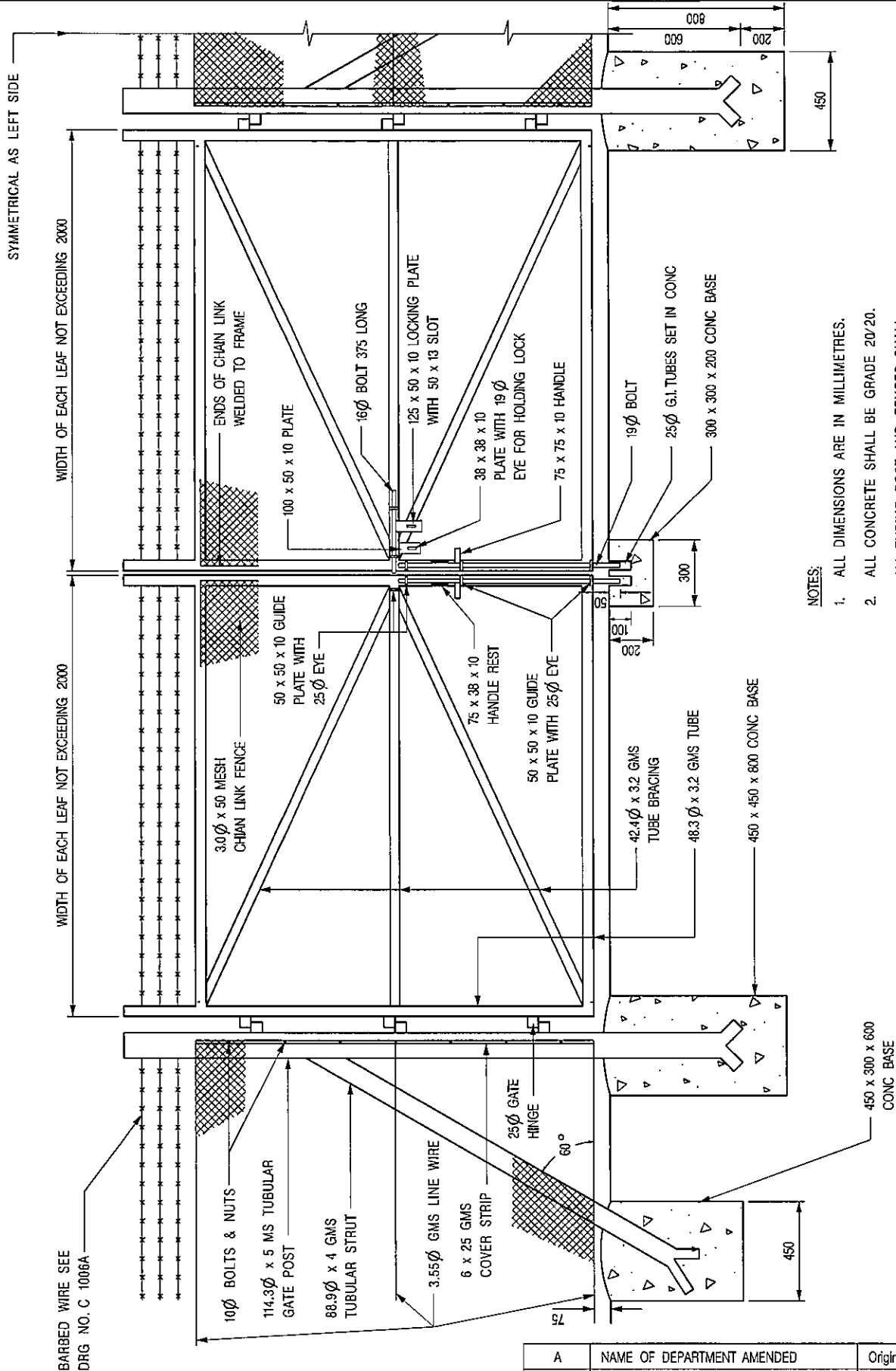

- NOTES:
1. ALL DIMENSIONS ARE IN MILLIMETRES.
  2. ALL CONCRETE SHALL BE GRADE 20/20.
  3. ALL TUBING, POST AND FENCES SHALL BE HOT DIP GALVANIZED TO BS 729.
  4. WELDS SHALL BE WIRE BRUSHED AND PAINTED WITH TWO COATS OF ALUMINIUM PAINT.

BARBED WIRE SEE DRG NO. C 1006A

GATE TYPE I

A	NAME OF DEPARTMENT AMENDED	Original Signed	02.2005
REF.	REVISION	SIGNATURE	DATE

**CEDD** CIVIL ENGINEERING AND DEVELOPMENT DEPARTMENT

SCALE 1 : 25      DRAWING NO. C1007A

DATE JAN 1991

# The Perspective of Hoarding

路政署



HIGHWAYS  
DEPARTMENT

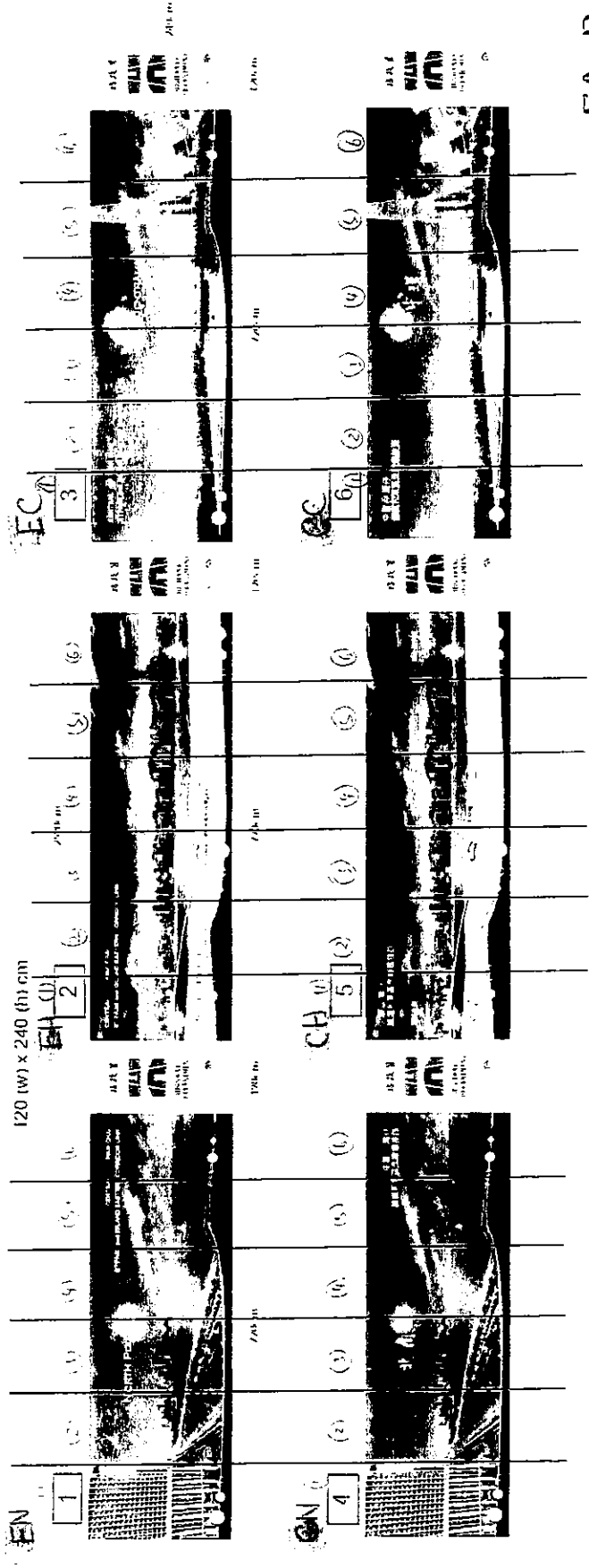
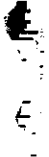

Type A (Chinese Version)

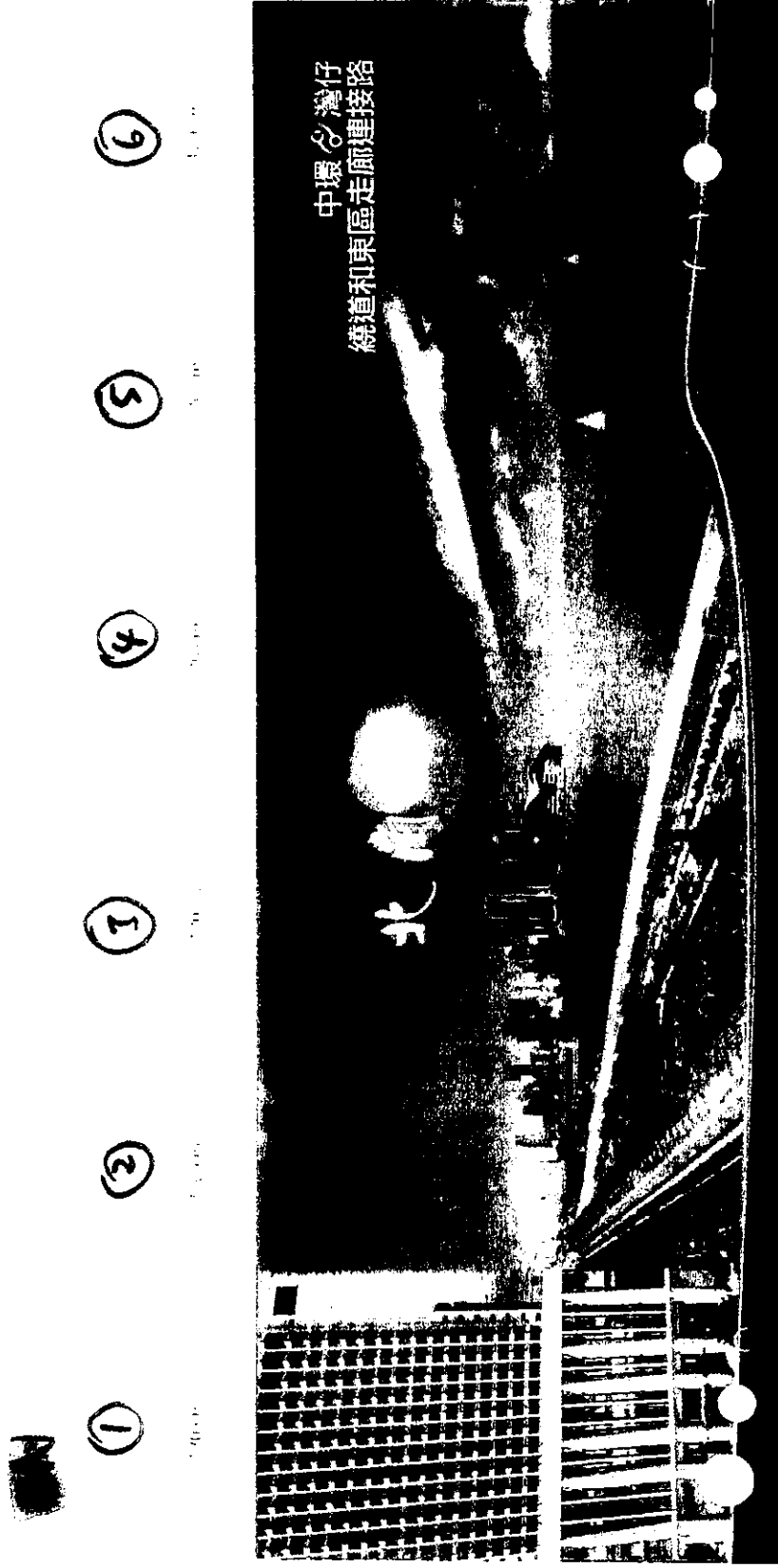

720 (w) x 210 (h) cm



Type A (English Version)



- ①
- ②
- ③
- ④
- ⑤
- ⑥



720 (w) x 240 (h) cm

Type B (Chinese Version)

GH

- ①
- ②
- ③
- ④
- ⑤
- ⑥

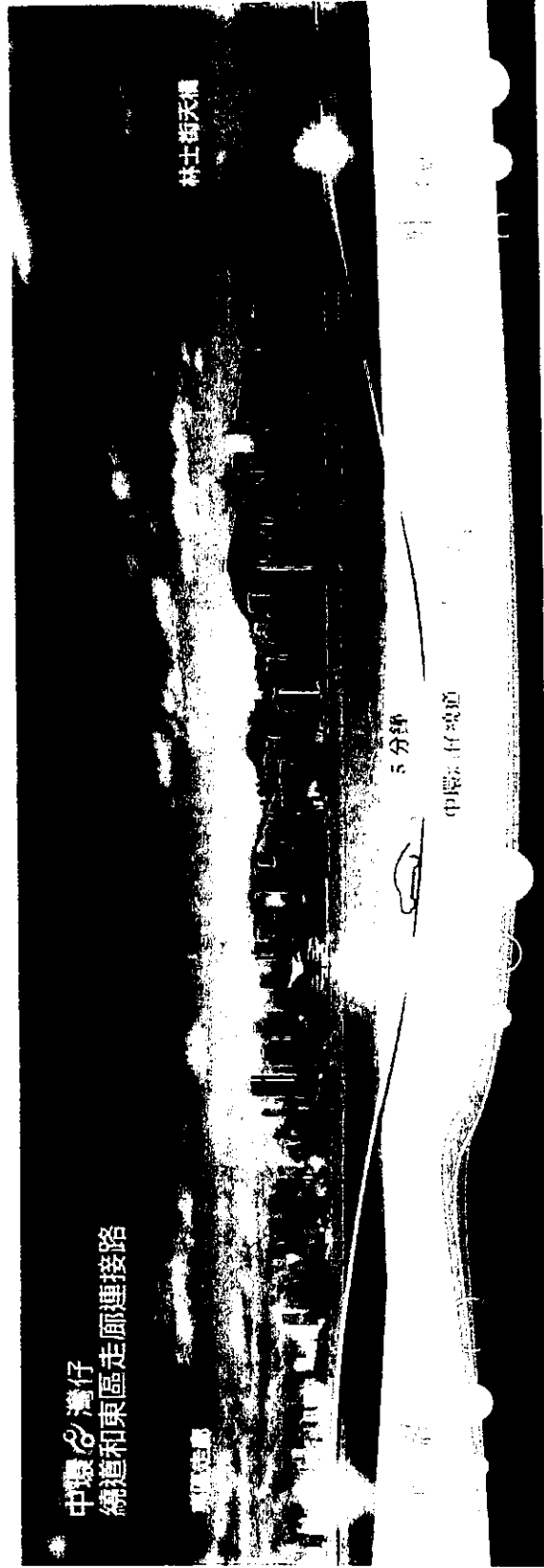

720 (w) x 265 (h) cm

Type B (English Version)



- ①
- ②
- ③
- ④
- ⑤
- ⑥

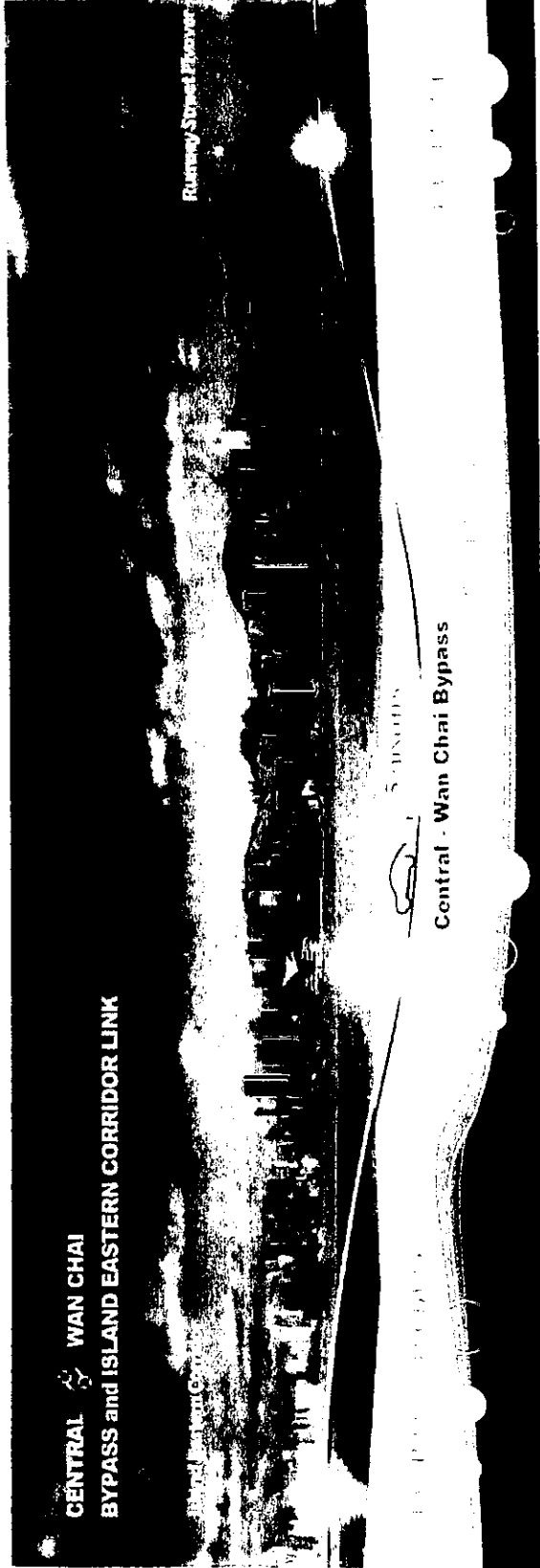

Type C (Chinese Version)

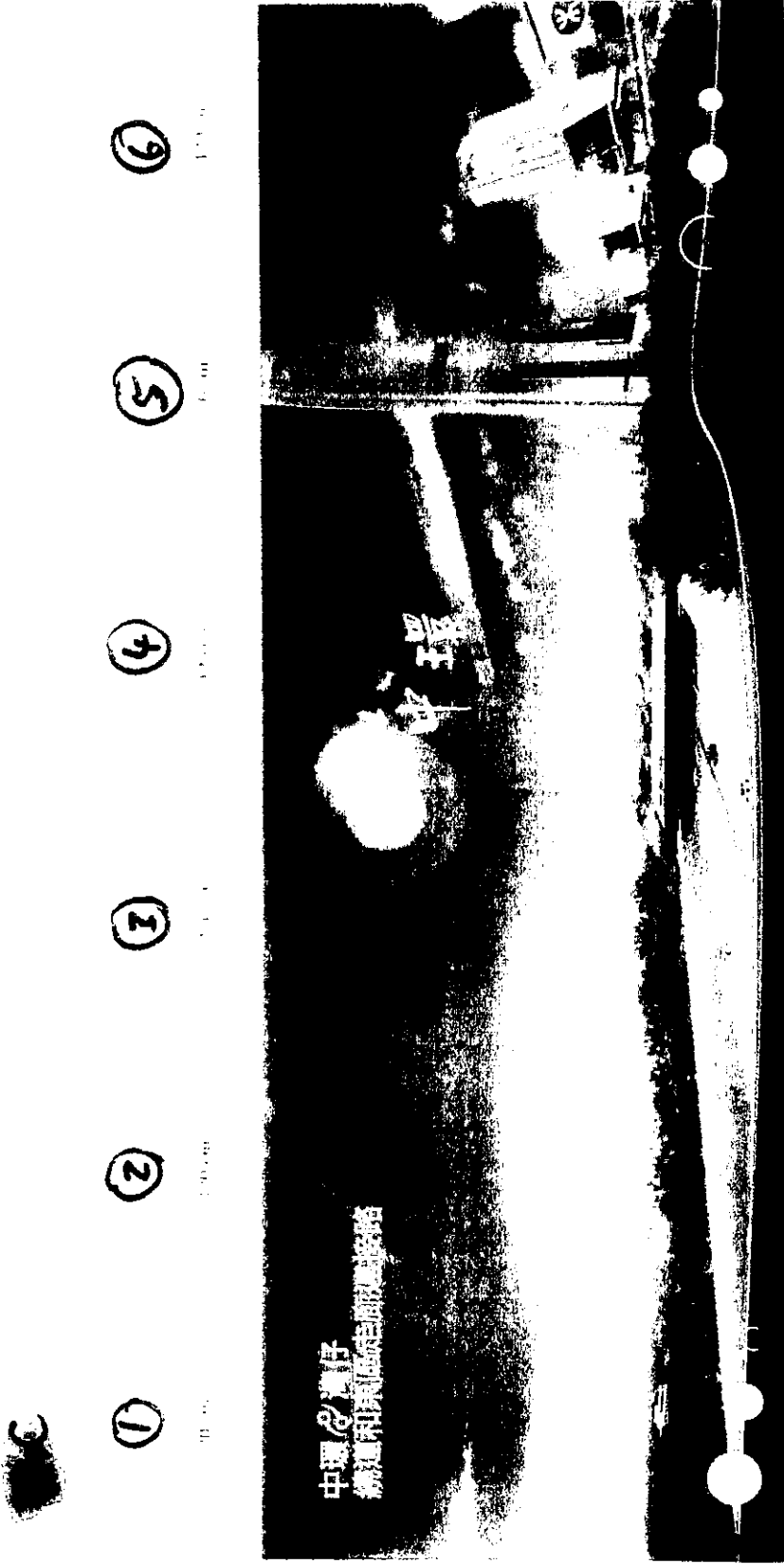

1:20 (A1) x 260 (H) cm

# Type C (English Version)



①

②

③

④

⑤

⑥

10000 10000 10000 10000 10000 10000



10000 10000 10000 10000 10000 10000