

MTR Corporation Limited

**Shatin to Central Link –
Tai Wai to Hung Hom Section and
Stabling Sidings at Hung Hom Freight Yard**

As-Built Drawings of Measures for Mitigating
Landscape and Visual Impacts

(December 2020)

Certified by: Lisa Poon 

Position: Environmental Team Leader

Date: - 8 DEC 2020

MTR Corporation Limited

**Shatin to Central Link –
Tai Wai to Hung Hom Section and
Stabling Sidings at Hung Hom Freight Yard**

As-Built Drawings of Measures for Mitigating
Landscape and Visual Impacts

(December 2020)

Certified by:  _____
Claudine Lee

Position: Independent Environmental Checker

Date: _____ 8 Dec 2020 _____

1. Submission Summary of As-Built Drawings for Landscape and Visual Mitigation Measures

Works Contract	Area	Location	Type of Mitigation Measures	Drawing No.	Reference Drawing No. in Approved VLTP	Remarks	Handover Information
SCL 1101	Tai Wai Area	Noise Cover at Mei Tin Road	OM3	1101/Z/TAW/SFJ/C23/A101B	Annex Figure B1-1	Previously submitted to EPD in Dec 2015.	Handed over to MTR Operation Team in Q4 2015
SCL 1101		Noise Cover at Mei Tin Road	OM3	1101/Z/TAW/SFJ/C23/A102B	Annex Figure B1-2	Previously submitted to EPD in Dec 2015.	
SCL 1102		Mei Tin Road Sitting-out Area	OM1	1102/B/300/T73/A58/600	Annex E2 1102/B/300/T73/A58/600	Previously submitted to EPD in Feb 2020.	Handed over to LCSD in Q4 2015
SCL 1101	Shek Mun Area	Shek Mun Playground	OM1	1101/W/300/T73/SFK/A58/001A	Annex E2 1101/W/300/T73/SFK/A58/001A	Previously submitted to EPD in Feb 2020.	Handed over to LCSD in Q4 2014
SCL 1102	Hin Keng Area	Hin Keng Station and Approach Structures	OM1	1102/W/HIK/POC/A58/300F	Annex E2 1102/W/HIK/POC/A58/300F	Previously submitted to EPD in Feb 2020.	Handed over to MTR Operatiin Team in Q4 2018
SCL 1102		Hin Keng Station and Approach Structures	OM1	1102/B/HIK/T73/A58/101A	Annex E2 1102/B/HIK/T73/A58/101A	Previously submitted to EPD in Feb 2020.	Handed over to MTR Operatiin Team in Q4 2018
SCL 1102		Hin Keng Station and Approach Structures	OM1, OM2a and OM2b	1102/B/HIK/T73/A58/102A	Annex E2 1102/B/HIK/T73/A58/102A	Previously submitted to EPD in Feb 2020.	Handed over to MTR Operatiin Team in Q4 2018
SCL 1102		Hin Keng Station and Approach Structures	OM1	1102/B/HIK/T73/A58/200F	Annex E2 1102/B/HIK/T73/A58/200F	Previously submitted to EPD in Feb 2020.	Handed over to MTR Operatiin Team in Q4 2018
SCL 1102		Hin Keng Station and Approach Structures	OM1	1102/B/HIK/T73/A58/300C	Annex E2 1102/B/HIK/T73/A58/300C	Previously submitted to EPD in Feb 2020.	Handed over to MTR Operatiin Team in Q4 2018
SCL 1102		Hin Keng Station and Approach Structures	OM8	1102/Z/HIK/T73/A58/016A1	Annex Figure B2-3	Previously submitted to EPD in Feb 2020.	Handed over to MTR Operatiin Team in Q4 2018
SCL 1102		Hin Keng Station and Approach Structures	OM2a, OM4 and OM8	1102/W/HIK/T73/A58/017	Annex Figure B2-4	Previously submitted to EPD in Feb 2020.	Handed over to MTR Operatiin Team in Q4 2018
SCL 1102		Hin Keng Station and Approach Structures	OM1, OM2a, OM2b, OM6, and OM9	1102/B/300/T73/A58/300D	Annex E2 1102/B/300/T73/A58/300D	Previously submitted to EPD in Feb 2020.	Handed over to LCSD in Q3 2018
SCL 1102		Hin Keng Station and Approach Structures	OM9	1102/W/HIK/POC/C10/301	-	Previously submitted to EPD in May 2018.	Handed over to MTR Operatiin Team in Q4 2018
SCL 1102		Hin Keng Station and Approach Structures	OM9	KHL2330b/NP/RW/3A/ST/003Z	-	Previously submitted to EPD in May 2018.	Handed over to MTR Operatiin Team in Q4 2018
SCL 1102		Hin Keng Station and Approach Structures	OM9	KHL2330b/NP/ST/007Z	-	Previously submitted to EPD in May 2018.	Handed over to MTR Operatiin Team in Q4 2018
SCL 1102		Hin Keng Station and Approach Structures	OM9	KHL2330b/NP/RW/7/ST/007Z	-	Previously submitted to EPD in May 2018.	Handed over to MTR Operatiin Team in Q4 2018
SCL 1102		NT South Animal Management Centre and Shatin Plant Quarantine Station at Shatin	OM1	1113/W/320/T73/A58/001	Annex E2 1113/W/320/T73/A58/001	Previously submitted to EPD in Feb 2020.	Handed over to AFCD in Q2 2015
SCL 1103		Hin Keng To Diamond Hill Tunnel	OM1	1103/B/321/HAL/A58/232B	Annex E3 1103/B/321/HAL/A58/232B	Previously submitted to EPD in Feb 2020.	Handed over to MTR Operatiin Team in Q4 2018
SCL 1103		Hin Keng To Diamond Hill Tunnel	OM1	1103/B/321/HAL/C24/052F	Annex E3 1103/B/321/HAL/C24/052F	Previously submitted to EPD in Feb 2020.	Handed over to HIK Estate MO in Q4 2018
SCL 1103	Hin Keng To Diamond Hill Tunnel	OM1	1103/B/321/HAL/C24/051C	Annex E3 1103/B/321/HAL/C24/051C	Previously submitted to EPD in Feb 2020.	Handed over to HIK Estate MO in Q4 2018	
SCL 1103	Ma Chai Hang and Fung Tak Area	Ma Chai Hang Ventilation Building	OM1	1103/B/323/HAL/C24/051G	Annex E3 1103/B/323/HAL/C24/051G	Previously submitted to EPD in Feb 2020.	Handed over to MTR Operatiin Team in Q4 2018
SCL 1103		Ma Chai Hang Ventilation Building	OM2a, OM2b, OM3, and OM8	1103/A/MCV/MTR/438/001	Annex Figure B3-1	Previously submitted to EPD in Feb 2020.	Handed over to MTR Operatiin Team in Q4 2018
SCL 1103		Ma Chai Hang Ventilation Building	OM6	-	-	To be submitted by Q4 2024*	-
SCL 1103		Ma Chai Hang Ventilation Building	OM2a, OM3 and OM8	1103/A/MCV/MTR/438/002	Annex Figure B3-3	Previously submitted to EPD in Feb 2020.	Handed over to MTR Operatiin Team in Q4 2018
SCL 1103		Fung Tak EAP/EEP Building	OM2a, OM3 and OM8	1103/A/FTA/MTR/438/001	Annex Figure B3-2	Previously submitted to EPD in Feb 2020.	Handed over to MTR Operatiin Team in Q4 2018
SCL 1103		Fung Tak EAP/EEP Building	OM2a, OM3 and OM8	1103/A/FTA/MTR/438/002	Annex E3 1103/K/333/HAL/A58/006A	Previously submitted to EPD in Feb 2020.	Handed over to MTR Operatiin Team in Q4 2018
SCL 1103		Fung Tak EAP/EEP Building	OM1	1103/A/FTA/MTR/438/003	Annex E3 1103/K/333/HAL/A58/006A	Previously submitted to EPD in Feb 2020.	Under handover process
SCL 1106	Diamond Hill Station Area	Diamond Hill Station – Entrance A2	OM2a, OM3, OM7 and OM8	1106/W/DIH/ACM/A14/202C	Annex Figure B4-2	Previously submitted to EPD in Feb 2020.	Handed over to MTR Operation Team in Q4 2019
SCL 1106		Diamond Hill Station – Means of Escape (MOE)	OM2a, OM3, OM7 and OM8	1106/W/DIH/ACM/A14/203D	Annex Figure B4-3	Previously submitted to EPD in Feb 2020.	Handed over to MTR Operation Team in Q4 2019
SCL 1106		Diamond Hill Station – West Ventilation Building	OM2a, OM3, OM7 and OM8	1106/W/DIH/ACM/A14/204B	Annex Figure B4-4	Previously submitted to EPD in Feb 2020.	Handed over to MTR Operation Team in Q4 2019
SCL 1106		Diamond Hill Station – West Ventilation Building	OM2a, OM3, OM7 and OM8	1106/W/DIH/ACM/A14/205B	Annex Figure B4-5	Previously submitted to EPD in Feb 2020.	Handed over to MTR Operation Team in Q4 2019
SCL 1106		Diamond Hill Station – East Ventilation Building	OM2a, OM3, OM7 and OM8	1106/W/DIH/ACM/A14/206B	Annex Figure B4-6	Previously submitted to EPD in Feb 2020.	Handed over to MTR Operation Team in Q4 2019
SCL 1106		Diamond Hill Station – East Ventilation Building	OM2a, OM3, OM7 and OM8	1106/W/DIH/ACM/A14/207B	Annex Figure B4-7	Previously submitted to EPD in Feb 2020.	Handed over to MTR Operation Team in Q4 2019
SCL 1106		Diamond Hill Station	OM2b/ OM5	1106/Z/DIH/BKC/A58/111A	Annex Figure H-5A	Previously submitted to EPD in Feb 2020.	Handed over to MTR Operation Team in Q4 2019
SCL 1106		Diamond Hill Station	OM2b/ OM5	1106/Z/DIH/BKC/A58/112A	Annex Figure H-5B	Previously submitted to EPD in Feb 2020.	Handed over to MTR Operation Team in Q4 2019
SCL 1106		Diamond Hill Station	OM8	1106/W/DIH/ACM/A58/000A3	Annex Figure B4-1	Previously submitted to EPD in Feb 2020.	Handed over to MTR Operation Team in Q2 2019
SCL 1106		Diamond Hill Station	Tree transplant	WT05/3/TS/L/LO-101	Annex E4 WT05/3/TS/L/LO-101	Previously submitted to EPD in Feb 2020.	Handed over to HA in Q2 2018
SCL 1108		Kai Tak Area	Kai Tak Station – Entrance A	OM3	1108/W/KAT/MHK/A14/401D	Annex Figure B5-2	Previously submitted to EPD in Feb 2020.
SCL 1108	Kai Tak Station – Entrance B		OM3	1108/W/KAT/MHK/A14/501C	Annex Figure B5-3	Previously submitted to EPD in Feb 2020.	Handed over to MTR Operation Team in Q4 2018
SCL 1108	Kai Tak Station – Entrance D		OM3	1108/W/KAT/MHK/A14/601B	Annex Figure B5-4	Previously submitted to EPD in Feb 2020.	Handed over to MTR Operation Team in Q4 2018
SCL 1108	Kai Tak Station – Entrance D and Dedicated Emergency Entrance		OM3	1108/W/KAT/MHK/A14/602C	Annex Figure B5-5	Previously submitted to EPD in Feb 2020.	Handed over to MTR Operation Team in Q4 2018
SCL 1108	Kai Tak Station – Southern Vent Shaft		OM3	1108/W/KAT/MHK/A14/801C	Annex Figure B5-6	Previously submitted to EPD in Feb 2020.	Handed over to MTR Operation Team in Q4 2018
SCL 1108	Kai Tak Station – Northern Vent Shaft		OM3	1108/W/KAT/MHK/A14/802D	Annex Figure B5-7	Previously submitted to EPD in Feb 2020.	Handed over to MTR Operation Team in Q4 2018
SCL 1108	Kai Tak Station Square		OM1 and OM2a	-	-	To be submitted by Q4 2024*	-
SCL 1109	Sung Wong Toi Area	Sung Wong Toi Station - Entrance A	OM3	1109/W/SUW/OAP/A14/011C1	Annex Figure B6-9 1109/W/SUW/OAP/A14/011C1	Previously submitted to EPD in Feb 2020.	Handed over to MTR Operation Team in Q4 2019
SCL 1109		Sung Wong Toi Station - Entrance A	OM2a and OM3	1109/W/SUW/OAP/A14/012C2	Annex Figure B6-10 1109/W/SUW/OAP/A14/012C2	Previously submitted to EPD in Feb 2020.	Handed over to MTR Operation Team in Q4 2019
SCL 1109		Sung Wong Toi Station - Entrance B2	OM3	1109/W/302/OAP/A14/036C5	Annex Figure B6-11 1109/W/302/OAP/A14/036C5	Previously submitted to EPD in Feb 2020.	Handed over to MTR Operation Team in Q4 2019
SCL 1109		Sung Wong Toi Station - Entrance B3	OM3	1109/W/302/OAP/A14/041C2	Annex Figure B6-12 1109/W/302/OAP/A14/041C2	Previously submitted to EPD in Feb 2020.	Handed over to MTR Operation Team in Q4 2019
SCL 1109		Sung Wong Toi Station - Entrance D	OM3	1109/W/SUW/OAP/A14/026D2	Annex Figure B6-14 1109/W/SUW/OAP/A14/026D2	Previously submitted to EPD in Feb 2020.	Handed over to MTR Operation Team in Q4 2019
SCL 1109		Sung Wong Toi Station - Entrance D	OM3	1109/W/SUW/OAP/A14/027D2	Annex Figure B6-15 1109/W/SUW/OAP/A14/027D2	Previously submitted to EPD in Feb 2020.	Handed over to MTR Operation Team in Q4 2019
SCL 1109		Sung Wong Toi Station - Ventilation Shaft B	OM3	1109/W/SUW/OAP/A14/032D2	Annex Figure B6-16 1109/W/SUW/OAP/A14/032D2	Previously submitted to EPD in Feb 2020.	Handed over to MTR Operation Team in Q4 2019
SCL 1109		Sung Wong Toi Station - Ventilation Shaft B	OM2a and OM3	1109/W/SUW/OAP/A14/033D2	Annex Figure B6-17 1109/W/SUW/OAP/A14/033D2	Previously submitted to EPD in Feb 2020.	Handed over to MTR Operation Team in Q4 2019
SCL 1109		Sung Wong Toi Station - Adit B Ventilation Building	OM2a and OM3	1109/W/302/OAP/A14/045B2	Annex Figure B6-18 1109/W/302/OAP/A14/045B2	Previously submitted to EPD in Feb 2020.	Handed over to MTR Operation Team in Q4 2019
SCL 1109		To Kwa Wan Station - Entrance A	OM2a and OM3	1109/W/TKW/OAP/A14/105E2	Annex Figure B6-23 1109/W/TKW/OAP/A14/105D3	Previously submitted to EPD in Feb 2020.	Handed over to MTR Operation Team in Q4 2019
SCL 1109	To Kwa Wan Station - Entrance B	OM3	1109/W/TKW/OAP/A14/115D2	Annex Figure B6-24 1109/W/TKW/OAP/A14/115D2	Previously submitted to EPD in Feb 2020.	Handed over to MTR Operation Team in Q4 2019	
SCL 1109	To Kwa Wan Station - Entrance C	OM3	1109/W/TKW/OAP/A14/125D3	Annex Figure B6-25 1109/W/TKW/OAP/A14/125D3	Previously submitted to EPD in Feb 2020.	Handed over to MTR Operation Team in Q4 2019	
SCL 1109	To Kwa Wan Station - Entrance D	OM3	1109/W/TKW/OAP/A14/135D3	Annex Figure B6-26 1109/W/TKW/OAP/A14/135D3	Previously submitted to EPD in Feb 2020.	Handed over to MTR Operation Team in Q4 2019	
SCL 1109	To Kwa Wan Station - Entrance D	OM2a and OM3	1109/W/TKW/OAP/A14/136D2	Annex Figure B6-27 1109/W/TKW/OAP/A14/136D2	Previously submitted to EPD in Feb 2020.	Handed over to MTR Operation Team in Q4 2019	
SCL 1109	To Kwa Wan Station - Ventilation Shaft	OM2a and OM3	1109/W/TKW/OAP/A14/150D1	Annex Figure B6-28 1109/W/TKW/OAP/A14/150D1	Previously submitted to EPD in Feb 2020.	Handed over to MTR Operation Team in Q4 2019	
SCL 1109	To Kwa Wan Ancillary Building	OM2a and OM3	1109/W/310/OAP/A14/101C4	Annex Figure B6-30 1109/W/310/OAP/A14/101C4	Previously submitted to EPD in Feb 2020.	Handed over to MTR Operation Team in Q4 2019	
SCL 1109	Olympic Garden	OM1	1109/B/304/OAP/A58/204A	Annex E7 1109/B/SUW/OAP/A58/005K	Previously submitted to EPD in Feb 2020.	Handed over to LCSD in Q3 2019	

Works Contract	Area	Location	Type of Mitigation Measures	Drawing No.	Reference Drawing No. in Approved VLTP	Remarks	Handover Information
SCL 1109	Sung Wong Toi Area	Olympic Garden	Summary Table of As Built Compensation Trees at Olympic Garden	1109/B/SUW/MTR/438/001	Annex E7 1109/B/SUW/OAP/A58/005K	Previously submitted to EPD in Feb 2020.	Handed over to LCSD in Q3 2019
SCL 1109		Sung Wong Toi Playground	OM1	1109/B/304/OAP/A58/211A	Annex E7 1109/B/SUW/OAP/A58/005K	Previously submitted to EPD in Feb 2020.	Handed over to LCSD in Q3 2019
SCL 1109		Price Edward Road West	OM1	1109/Z/SUW/SCJ/A58/002A1	Annex E7 1109/B/SUW/OAP/A58/011L	Previously submitted to EPD in Feb 2020.	Under handover process
SCL 1109	To Kwa Wan Area	Tam Kung Road	OM1	1109-SUR-014019	Annex E7 1109/B/SUW/OAP/A58/013F	Previously submitted to EPD in Feb 2020.	Under handover process
SCL 1109	Hung Hom Area	Hung Hom Road	OM1	Insk1607	Annex E7 1109/B/SUW/OAP/A58/015C	Previously submitted to EPD in Feb 2020.	Handed over to LCSD in Q4 2019
SCL 1109	Sung Wong Toi Area	Kowloon City Road	OM1	1109-SUR-013921	Annex E7 1109/B/SUW/OAP/A58/204H	Previously submitted to EPD in Feb 2020.	Under handover process
SCL 1109	To Kwa Wan Area	San Shan Road	OM1	1109/B/SUR/013853	Annex E7 1109/B/TKW/OAP/A58/018B	Previously submitted to EPD in Feb 2020.	Handed over to LCSD in Q3 2019
SCL 1109	Hung Hom Area	Wa Shun Street	OM1	Insk1600	3389C12B	Submitted under previous submission in Feb 2020. Additional compensation trees out of latest approved VLTP were planted at agreed location to fulfill the requirements of final maintenance party.	Handed over to LCSD in Q4 2019
SCL 1109		Wa Shun Street	OM1	Insk1599	-	Submitted under previous submission in Feb 2020. Additional compensation trees out of latest approved VLTP were planted at agreed location to fulfill the requirements of final maintenance party.	Handed over to LCSD in Q4 2019
SCL 1109	To Kwa Wan Area	Ma Tau Wai Road/To Kwa Wan Road Garden	OM1	1109/Z/309/OAP/A58/104A	Annex E7 1109/B/TKW/OAP/A58/012H	Submitted under current submission	Handed over to LandsD in Q4 2019
SCL 1109		Lok Shan Road Playground and To Kwa Wan Complex Playground	OM1	Insk1583	Annex E7 1109/B/TKW/OAP/A58/013E	Previously submitted to EPD in Feb 2020.	Lok Shan Road Playground : Handed over to LCSD in Q3 2019 To Kwa Wan Complex Playground: Handed over to LandsD in Q3 2019
SCL 1109		Ma Tau Chung Road/Tam Kung Road Rest Garden	OM1	1109/B/309/OAP/A58/164A	Annex E7 1109/B/TKW/OAP/A58/016F	Previously submitted to EPD in Feb 2020.	Under handover process
SCL 1109		Ma Tau Wai Road/Chikiang Street Amenity Area	OM1	1109/Z/309/OAP/A58/154A	Annex E7 1109/B/TKW/OAP/A58/017F	Submitted under current submission	Handed over to LCSD in Q3 2020
SCL 1109	Hung Hom Area	Hung Luen Road	OM1	Insk1601	Annex E7 1109/B/SUW/OAP/A58/023A	Submitted under previous submission in Feb 2020. Additional compensation trees out of latest approved VLTP were planted at agreed location to fulfill the requirements of final maintenance party.	Handed over to LCSD in Q4 2019
SCL 1109	-	Cornwall Street Children Playground	OM1	Insk1608	-	Submitted under previous submission in Feb 2020. Additional compensation trees out of latest approved VLTP were planted at agreed location to fulfill the requirements of final maintenance party.	Handed over to LCSD in Q1 2020
SCL 1109	Hung Hom Area	Hung Lok Road	OM1	Insk1598	-	Submitted under previous submission in Feb 2020. Additional compensation trees out of latest approved VLTP were planted at agreed location to fulfill the requirements of final maintenance party.	Handed over to LCSD in Q4 2019
SCL 1109		Yan Yung Street and Hung Hom South Road Rest Garden	OM1	Insk1602	-	Submitted under previous submission in Feb 2020. Additional compensation trees out of latest approved VLTP were planted at agreed location to fulfill the requirements of final maintenance party.	Handed over to LCSD in Q4 2019
SCL 1111	Hung Hom North Approach Tunnels	Chatham Road North	OM1, OM2b and OM6	C1106/B/000/ATK/C04/153L	Annex E8 C1106/B/000/ATK/C04/153L C1106/B/000/ATK/C04/156L	Previously submitted to EPD in Feb 2020.	Under handover process
SCL 1111		Winslow Street Playground	OM1 and OM6	1111/W/000/ATK/A58/052D2	C1106/B/000/ATK/C04/158F	Previously submitted to EPD in Feb 2020.	Handed over to LCSD in Q2 2019
SCL 1111		Public Open Space at Chatham Road North	OM1 and OM6	1111/W/000/ATK/A58/053C	C1106/B/000/ATK/C04/159J	Previously submitted to EPD in Feb 2020.	Under handover process
SCL 1111		Public Open Space at Chatham Road North	OM1 and OM6	1111/W/000/ATK/A58/056D1	C1106/B/000/ATK/C04/157J	Previously submitted to EPD in Feb 2020.	Under handover process
SCL 1111		Noise Mitigation Measure P3	OM9	Appendix2.2B	Annex Figure B7-4	Previously submitted to EPD in 20 Mar 2018 and approved on 19 Jul 2018.	Handed over to MTR Operation Team in Q4 2018
SCL 1111		Noise Mitigation Measure P3	OM9	1111/C/362/GKJ/SK/301B	Annex Figure B7-10	Previously submitted to EPD in 20 Mar 2018 and approved on 19 Jul 2018.	Handed over to MTR Operation Team in Q4 2018
SCL 1111	Noise Mitigation Measure P3	OM9	1111/C/362/GKJ/SK/302B	Annex Figure B7-11	Previously submitted to EPD in 20 Mar 2018 and approved on 19 Jul 2018.	Handed over to MTR Operation Team in Q4 2018	
SCL 1112	Hung Hom Station and Stabling Sidings	Hung Hom Station and Stabling Sidings (South)	OM1	SCL/DWG001A0	Annex E8 C1106/B/000/ATK/C04/353F	Submitted under current submission	Under handover process
SCL 1112		Hung Hom Station and Stabling Sidings (South)	OM1		Annex E8 1121/C/304/HCL/A58/310A3	Submitted under current submission	Under handover process
SCL 1112		Noise Mitigation Measure P1 Semi-enclosure	OM3 and OM9	Appendix2.2B	Annex Figure B7-4	Previously submitted to EPD in 20 Mar 2018 and approved on 19 Jul 2018.	Handed over to MTR Operation Team in Q4 2018
SCL 1112		Noise Mitigation Measure P1 Semi-enclosure	OM3 and OM9	3404C03A	Annex Figure B7-5	Previously submitted to EPD in 20 Mar 2018 and approved on 19 Jul 2018.	Handed over to MTR Operation Team in Q4 2018
SCL 1112		Noise Mitigation Measure P1 Semi-enclosure	OM3 and OM9	3404C04A	Annex Figure B7-6	Previously submitted to EPD in 20 Mar 2018 and approved on 19 Jul 2018.	Handed over to MTR Operation Team in Q4 2018
SCL 1112		Noise Mitigation Measure P1 Semi-enclosure	OM3 and OM9	3405C05A	Annex Figure B7-7	Previously submitted to EPD in 20 Mar 2018 and approved on 19 Jul 2018.	Handed over to MTR Operation Team in Q4 2018
SCL 1112		Noise Mitigation Measure P2	OM9	Appendix2.2B	Annex Figure B7-4	Previously submitted to EPD in Feb 2020.	Under handover process
SCL 1112		Noise Mitigation Measure P2	OM9	3404C01B	Annex Figure B7-8	Previously submitted to EPD in Feb 2020.	Under handover process
SCL 1112		Noise Mitigation Measure P2	OM9	3404C02B	Annex Figure B7-9	Previously submitted to EPD in Feb 2020.	Under handover process

Note: * - The submission date is subject to progress of the project or further update on VLTP, if any.

2. Explanatory Statement to Demonstrate Compliance

Under Condition 2.33 of the Environmental Permit no. EP-438/2012/K for the Shatin to Central Link – Tai Wai to Hung Hom Section [SCL(TAW-HUH)], the as-built drawing(s) of landscape and visual mitigation measures with an explanatory statement showing the final locations, size, number and species of planting to demonstrate compliance with the approved submissions under Condition 2.13 of the SCL(TAW-HUH) EP shall be deposited with the Director of EPD. The as-built submission shall be certified by the ET Leader and verified by the IEC that the Visual, Landscape, Tree Planting and Tree Protection Plan (VLTP) approved under Condition 2.13 has been fully and properly implemented.

According to the approved VLTP, the proposed landscape and visual mitigation measures have been implemented at different area of SCL(TAW-HUH) as follows:

2.1 Noise Cover at Mei Tin Road (Works Contract 1101)

This drawings were submitted to EPD on 28 Dec 2015 and was approved by EPD on 4 Feb 2016 (EPD reference: f(19) in Ax(2) to EP2/G/A/124 Pt.22).

Aesthetic landscape and architectural treatment (OM3)

The installed Mei Tin Road noise cover comprises proprietary standing seam roofing system with modular corrugated metal panel, proper rain water drainage provision and noise absorption panel. A lighter grey has been adopted for the metal roofing and associated structural elements. Colour of the cover has been duly considered to achieve a harmony effect with nearby fairface concrete roof at Tai Wai Station and to match colour with existing metal roofing of the station.

In order to improve aesthetic quality, narrow strip of corrugated metal roofing panels in green have been added to create roofing pattern and provide embellishment effect. Green panels have been framed with metal U-channels to enhance articulation when viewing from high level.

2.2. Hin Ken Station (HIK) and Approach Structures (Works Contract 1102)

Compensation Tree Planting (OM1)

Compensation Tree Planting has been provided to compensate for felled trees as far as practicable. Minor amendments were made in Mei Tin Road Sitting-out Area due to unavailability of tree in the market in 2014. The approved 18 nos. of *Terminalia manatalyi* with 150mm DBH each of compensatory planting of trees had to be replaced by 13 nos. of *Bauhinia variegata*, 2 nos. of *Plumeria rubro* and 15 nos. of *Lagerstoremia speciose* to match with the total DBH of 270mm for compensatory trees in the approved TRA. The changing of tree species, quantity of trees and trees layout had been agreed by LCSD and the implementation of the compensatory planting of trees was completed to the satisfaction of LCSD.

Screen Planting (OM2a)

Vertical greening was applied to the southern ventilation structure, façade of enclosed viaduct and at-graded box section. Climbers and hanging vines were provided such that they can be grown over the façade in the future and hence minimize the visibility of building mass behind.

Landscape Re-instatement (OM2b)

All hard and soft landscape areas temporarily disturbed during construction phase had been reinstated to the satisfaction of the relevant government departments.

Aesthetic design of viaduct and the at-grade box section at Hin Keng (OM4)

Vertical greening was applied to the southern ventilation structure, façade of enclosed viaduct and at-graded box section. Climbers and hanging vines were provided such that they can be grown over the façade in the future and hence minimize the visibility of building mass behind.

Re-provision of public open spaces (OM6)

Re-provision and replacement of affected facilities had been incorporated in the design of the public open space at Hin Tin Playground with the tree planting arrangement.

Roof greening of large built structures (OM8)

Extensive Green Roof System was used to cover the platform roofs of Hin Keng Station, ventilation plant room, the viaduct and part of the at-grade box.

Aesthetic design on Noise Barrier (OM9)

Retaining wall and vertical noise barrier with use of absorptive panels (non-transparent type) have been provided along the rail track between HIK and TAW to reduce noise impact to NSRs in the vicinity. Solid noise barrier panel of non-reflective material in neutral colours adopted together with aesthetic treatment to minimize any potential visual impact.

2.3. Hin Keng to Diamond Hill Tunnels (Works Contract 1103)

Compensation Tree Planting (OM1)

Compensation tree planting has been provided to compensate for felled trees as far as practicable.

Screen Planting (OM2a)

Tree planting/hanging vines was provided at Ma Chai Hang Ventilation Building (MCV) for the visual screening to ventilation building. Tree planting and a green wall of hanging vines/climbers were provided to the Emergency Access/Emergency Escape Access (EA/EEA) at Wong Tai Sin.

Landscape Re-instatement (OM2b)

All hard and soft landscape area temporarily disturbed during construction of MCV and EA/EEA were reinstated to the satisfaction of the relevant government departments.

Aesthetic landscape and architectural treatment (OM3)

Natural colours were provided for aboveground buildings. The design of buildings had adopted low roof level and tree planting/floating vine climber have been adopted to provide screening.

Re-provision of public open spaces (OM6)

Since additional recreational facilities will be provided at Ma Chai Hang site in response to the request of Wong Tai Sin District Council (WTSDC), Leisure and Cultural Services Department (LCSD), Railway Development Office

(RDO) and stakeholders, the permanent reinstatement works at the site will be conducted at later stage and undertaken by another works contract.

Roof greening of large built structures (OM8)

Green roof had been provided at MCV ventilation building and EA/EEA at Fung Tak/Wong Tai Sin as far as practicable according to the operational requirements to further reduce visual impact when viewed from either ground or high levels.

2.4. Diamond Hill (DIH) Station (Works Contract 1106)

Compensation Tree Planting (OM1)

Compensation tree planting will be provided to compensate for felled trees as far as practicable in Kai Tak Station Square by ASD. The compensation trees planting works are tentative to be completed on or after 2022.

Screen Planting (OM2a)

Vertical greenings have been provided to particular exposed faces of the West and East Ventilation Shafts, Means of Escape (MOE) and Entrance A2 of DIH station.

Landscape Re-instatement (OM2b)

Reinstatement of temporarily disturbed landscape areas has been fully considered in the design and to be provided by other projects within Diamond Hill CDA site development. Temporarily landscape greening treatment in the form of hydroseeding has been provided in DIH area.

Aesthetic landscape and architectural treatment (OM3)

Architectural design and the element with color, texture and tonal quality of the DIH station entrances, MOE and ventilation shafts are comparable to the existing urban and future urban context.

Re-instatement of excavated area (OM5)

Re-instatement of excavated area and disturbed area for temporary works utilities diversion, temporary road diversion and pipeline works has been completed.

Aesthetic landscape and architectural treatment for DIH (OM7)

The element with color, texture and tonal quality of the DIH station entrances, MOE and ventilation shafts is comparable to the existing urban and future urban context.

Roof greening of large built structures (OM8)

Green roof has been provided for West and East Ventilation Shafts, MOE and Entrance A2 of DIH station.

2.5. Kai Tak Station and Associated Tunnels (Works Contract 1108)

Compensation Tree Planting (OM1)

Compensation tree planting will be provided to compensate for felled trees as far as practicable in Kai Tak Station Square by ASD. The compensation trees planting works are tentative to be completed on or after 2022.

Screen Planting (OM2a)

Screen tree planting will be provided along the boundary of the station entrances and ventilation shafts by ASD. The trees planting works are tentative to be completed on or after 2020. Outward facing walls of the South Ventilation Shaft and North Ventilation Shaft have been provided with shrub as much as practicable according to operation requirements.

Aesthetic landscape and architectural treatment (OM3)

All station entrances, ventilation shafts and all above ground structures were sensitively designed to minimize the potential adverse landscape and visual impacts.

Entrances A and B are of an open design, surrounded by glazing, with a large central skylight in the roof. Entrance D and Designated Emergency Entrance (DEE) have been provided with a central skylight in the roof to collect as much natural light as possible into the concourse level below.

Re-instatement of excavated area (OM5)

All excavated area and disturbed area for temporary works utilities diversion, temporary road diversion, and pipeline works were reinstated to former conditions or better, to the satisfaction of the relevant Government departments.

2.6. Stations and Tunnels of Kowloon City Section (Works Contract 1109) Compensation Tree Planting (OM1)

Compensation tree planting had been provided to compensate for felled trees as far as practicable, and the compensation trees planting works have completed.

The number of compensatory trees at Ma Tau Chung Road/Tam Kung Road Rest Garden is changed from 11 to 6, since the location of 5 numbers of trees clashes with the existing underground utilities, and the planter area will be compensated with shrubs similar to the rest of the planter area.

Screen Planting (OM2a)

Vertical greenings and landscape planters had been provided to the relevant Entrances and Ventilation Buildings of SUW and TKW.

Landscape Re-instatement (OM2b)

All hard and soft landscape areas temporarily distributed during construction phase will be reinstated, and the reinstated works had been completed.

Aesthetic landscape and architectural treatment (OM3)

Station entrances, ventilation shafts and above ground structure have adopted architectural design, and softened visually by the selection of palette of materials and integrated landscaping.

Re-instatement of excavated area (OM5)

Re-instatement of excavated area and disturbed area for temporary works utilities diversion, temporary road diversion and pipeline works had been completed.

Re-provision of public open spaces (OM6)

Olympia Garden, Sung Wong Toi Playground, To Kwa Wan Complex Playground, Ma Tau Wai Road/To Kwa Wan Road Garden and Lo Shan Road Playground had been re-provided.

2.7. Hung Hom North Approach Tunnels (Works Contract 1111) and Hung Hom Station and Stabling Sidings (Works Contract 1112)

Compensation Tree Planting (OM1)

Compensation tree planting was implemented to compensate for felled trees as far as practicable. At Winslow Street Playground, changes of species, sizes and layout of compensatory trees had been agreed by LCSD. Compensatory tree planting was completed to the satisfaction of LCSD. In the public open space at Chatham Road North, tree species, sizes and layout had been updated due to site constraint and unavailability of the tree in the market. Compensatory tree planting was completed and is awaiting handover to LCSD. Compensatory tree planting at the south of Hung Hom Station and Stabling Sidings would be completed by Q2 2021 tentatively.

Landscape Re-instatement (OM2b)

Hard and soft landscape areas along Chatham Road North temporarily disturbed during construction phase had been reinstated as far as practicable to the satisfaction of the relevant government departments.

Aesthetic landscape and architectural treatment (OM3) and aesthetic design on Noise Barrier (OM9)

The semi noise enclosure extending from the edge of the existing podium of Hung Hom Station to the realigned Cheong Wan Road Bridge has been installed with exposed roof surface adopted a green colour palette. Additional graduation of darker and lighter green tones has been applied to accentuate the roof panel contours to express a more comfortable change of colours when viewed from visually sensitive receivers afar and closed up.

Noise barrier at south of Chatham Road North has been installed. Noise absorptive panels of neutral colours have been adopted to minimize any potential visual impact.

For noise barrier at the north of new realigned Cheong Wan Road, installation works would be completed in 2019 tentatively. Noise absorptive panels of neutral colour will be adopted to minimize any potential visual impact.

Re-provision of public open spaces (OM6)

Re-provision and replacement of affected facilities had been incorporated in the design of the Winslow Street Playground and Public Open Space at Chatham Road North with the tree planting arrangement.

Details could be referred to the enclosed as-built drawings listed in submission summary in Section 1.

As-built Drawings

Sung Wong Toi and
To Kwa Wan Area
(Contract 1109)

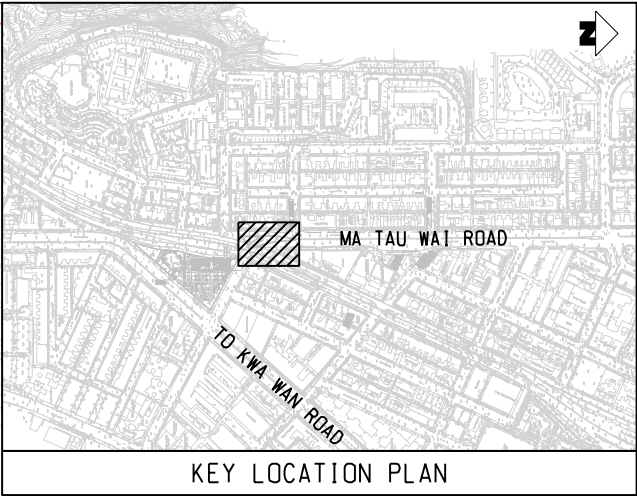
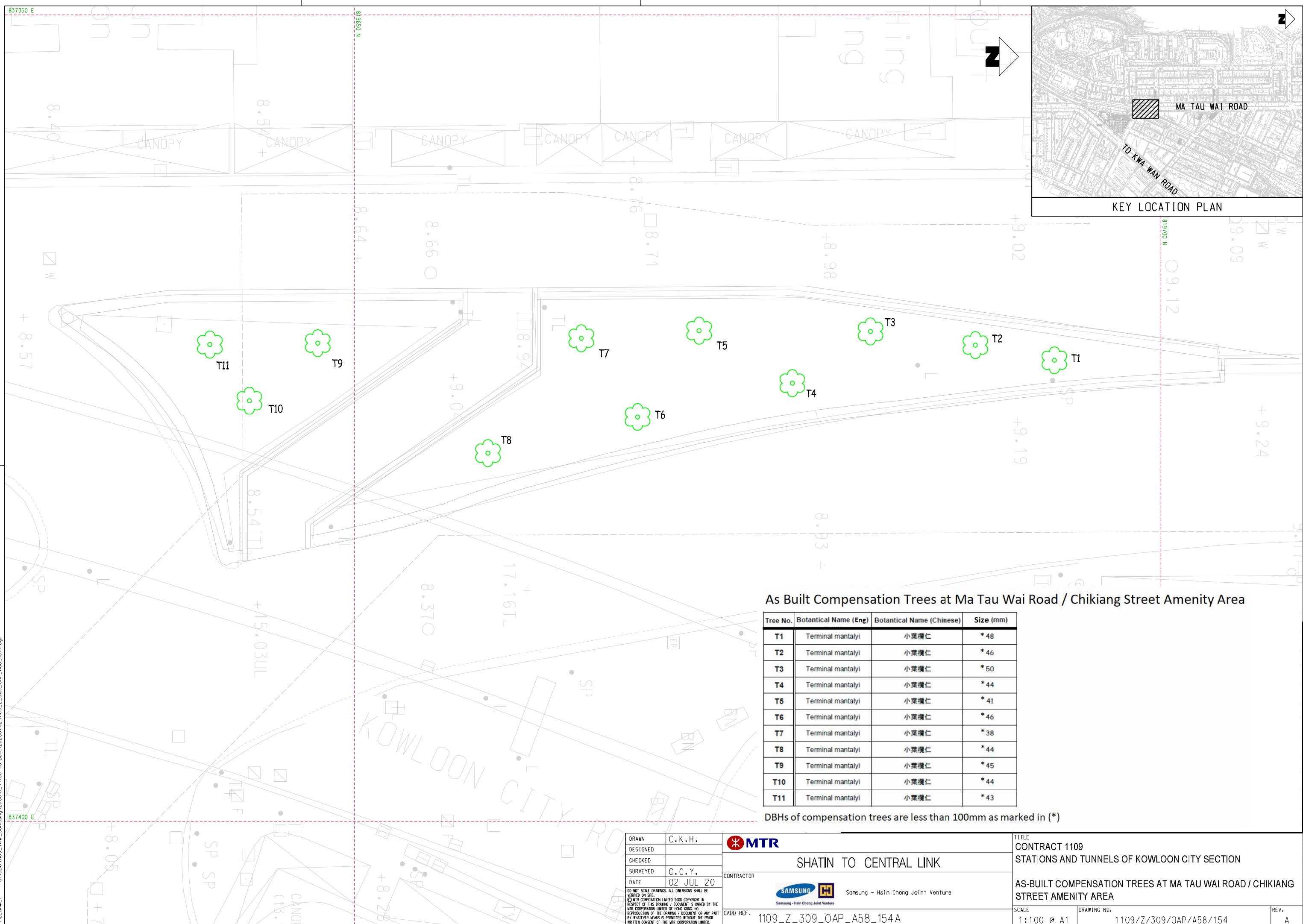

As Built Compensation Trees at Ma Tau Wai Road / Chikiang Street Amenity Area

Tree No.	Botanical Name (Eng)	Botanical Name (Chinese)	Size (mm)
T1	Terminal mantalyi	小葉欖仁	* 48
T2	Terminal mantalyi	小葉欖仁	* 46
T3	Terminal mantalyi	小葉欖仁	* 50
T4	Terminal mantalyi	小葉欖仁	* 44
T5	Terminal mantalyi	小葉欖仁	* 41
T6	Terminal mantalyi	小葉欖仁	* 46
T7	Terminal mantalyi	小葉欖仁	* 38
T8	Terminal mantalyi	小葉欖仁	* 44
T9	Terminal mantalyi	小葉欖仁	* 45
T10	Terminal mantalyi	小葉欖仁	* 44
T11	Terminal mantalyi	小葉欖仁	* 43

DBHs of compensation trees are less than 100mm as marked in (*)

C:\ProgramData\Bentley\PowerRoads V8i (SELECTseries 3)\Workspace\system\plcrg\printer\pic1g
 Detail - 2/7/2020 15:57:46
 MODELNAME: G:\SBA\1109_Z_109_OAP_A58_A58_154.dgn
 FILENAME:

DRAWN C.K.H. DESIGNED CHECKED SURVEYED C.C.Y. DATE 02 JUL 20 <small>DO NOT SCALE DRAWINGS. ALL DIMENSIONS SHALL BE VERIFIED ON SITE. © MTR CORPORATION LIMITED 2008 COPYRIGHT IN RESPECT OF THIS DRAWING / DOCUMENT IS OWNED BY THE MTR CORPORATION LIMITED OF HONG KONG. NO REPRODUCTION OF THE DRAWING / DOCUMENT OR ANY PART BY WHATEVER MEANS IS PERMITTED WITHOUT THE PRIOR WRITTEN CONSENT OF THE MTR CORPORATION LIMITED.</small>		SHATIN TO CENTRAL LINK CONTRACTOR Samsung - Hsin Chong Joint Venture	TITLE CONTRACT 1109 STATIONS AND TUNNELS OF KOWLOON CITY SECTION AS-BUILT COMPENSATION TREES AT MA TAU WAI ROAD / CHIKIANG STREET AMENITY AREA
CADD REF. 1109_Z_309_OAP_A58_154A	SCALE 1:100 @ A1	DRAWING NO. 1109/Z/309/OAP/A58/154	REV. A

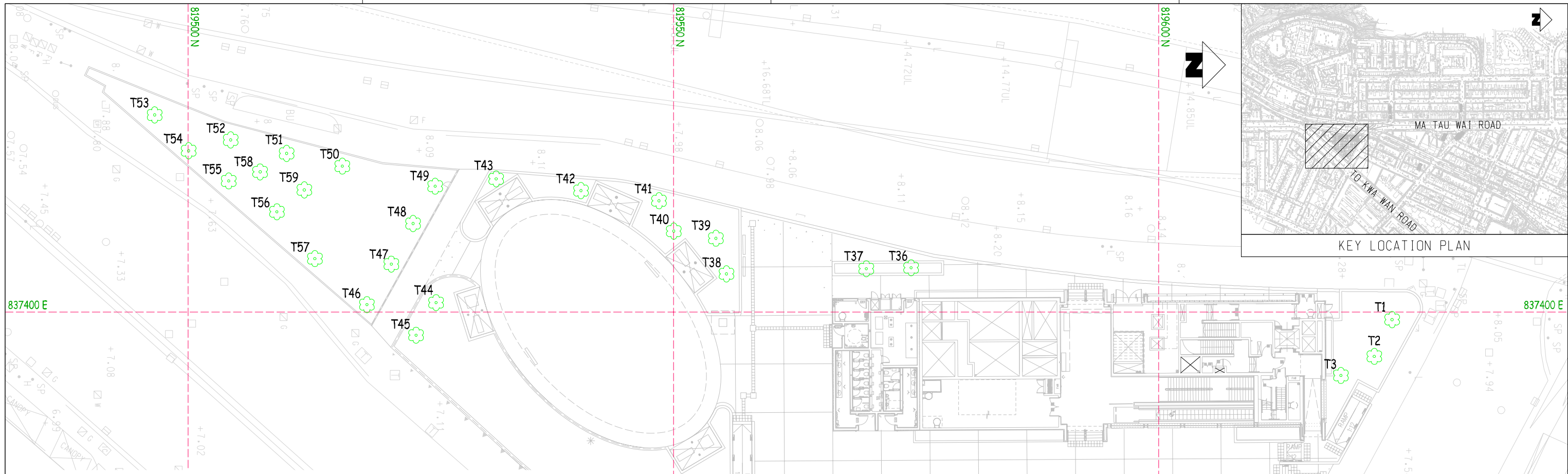

As Built Compensation Trees at Ma Tau Wai Road / To Kwa Wan Road Garden

Tree No.	Botanical Name (Eng)	Botanical Name (Chinese)	Size (mm)	Tree No.	Botanical Name (Eng)	Botanical Name (Chinese)	Size (mm)
T1	Bauhinia variegata	宮粉羊蹄甲	* 76	T30	Jacaranda Mimosifolia	藍花楸	120
T2	Bauhinia variegata	宮粉羊蹄甲	* 75	T31	Jacaranda Mimosifolia	藍花楸	109
T3	Bauhinia variegata	宮粉羊蹄甲	* 80	T32	Jacaranda Mimosifolia	藍花楸	113
T4	Bauhinia variegata	宮粉羊蹄甲	* 77	T33	Jacaranda Mimosifolia	藍花楸	116
T5	Bauhinia variegata	宮粉羊蹄甲	* 75	T34	Jacaranda Mimosifolia	藍花楸	125
T6	Liquidambar formosana	楓香	* 75	T35	Jacaranda Mimosifolia	藍花楸	108
T7	Liquidambar formosana	楓香	* 81	T36	Jacaranda Mimosifolia	藍花楸	* 71
T8	Liquidambar formosana	楓香	* 77	T37	Jacaranda Mimosifolia	藍花楸	* 60
T9	Liquidambar formosana	楓香	* 65	T38	Liquidambar formosana	楓香	* 61
T10	Liquidambar formosana	楓香	* 65	T39	Liquidambar formosana	楓香	* 63
T11	Liquidambar formosana	楓香	* 72	T40	Liquidambar formosana	楓香	* 61
T12	Liquidambar formosana	楓香	* 86	T41	Liquidambar formosana	楓香	* 62
T13	Liquidambar formosana	楓香	* 65	T42	Liquidambar formosana	楓香	* 69
T14	Liquidambar formosana	楓香	* 65	T43	Lagerstroemia indica	細葉紫薇	* 64
T15	Liquidambar formosana	楓香	* 76	T44	Lagerstroemia indica	細葉紫薇	* 62
T16	Liquidambar formosana	楓香	* 72	T45	Lagerstroemia indica	細葉紫薇	* 60
T17	Sterculia lanceolata	假蒴婆	* 93	T46	Lagerstroemia indica	細葉紫薇	* 62
T18	Sterculia lanceolata	假蒴婆	* 84	T47	Lagerstroemia indica	細葉紫薇	* 61
T19	Sterculia lanceolata	假蒴婆	* 88	T48	Lagerstroemia indica	細葉紫薇	* 62
T20	Sterculia lanceolata	假蒴婆	* 82	T49	Lagerstroemia indica	細葉紫薇	* 60
T21	Sterculia lanceolata	假蒴婆	* 94	T50	Bauhinia variegata	宮粉羊蹄甲	* 96
T22	Sterculia lanceolata	假蒴婆	* 92	T51	Bauhinia variegata	宮粉羊蹄甲	* 82
T23	Jacaranda Mimosifolia	藍花楸	110	T52	Bauhinia variegata	宮粉羊蹄甲	* 65
T24	Jacaranda Mimosifolia	藍花楸	113	T53	Bauhinia variegata	宮粉羊蹄甲	* 78
T25	Jacaranda Mimosifolia	藍花楸	114	T54	Bauhinia variegata	宮粉羊蹄甲	* 90
T26	Jacaranda Mimosifolia	藍花楸	113	T55	Bauhinia variegata	宮粉羊蹄甲	* 77
T27	Jacaranda Mimosifolia	藍花楸	108	T56	Bauhinia variegata	宮粉羊蹄甲	* 90
T28	Jacaranda Mimosifolia	藍花楸	107	T57	Bauhinia variegata	宮粉羊蹄甲	* 66
T29	Jacaranda Mimosifolia	藍花楸	109	T58	Plumeria rubra	雞蛋花	* 86
				T59	Plumeria rubra	雞蛋花	* 80

Remarks:

- (1) DBHs of compensation trees are less than 100mm as marked in (*)
- (2) Total DBH of as-built compensation trees is greater than the total DBH of compensation trees proposed in the approved VLTPP.

DRAWN C.K.H. DESIGNED CHECKED SURVEYED C.C.Y. DATE 19 MAR 20 <small>DO NOT SCALE DRAWINGS. ALL DIMENSIONS SHALL BE VERIFIED ON SITE. © MTR CORPORATION LIMITED 2008. COPYRIGHT IN RESPECT OF THIS DRAWING / DOCUMENT IS OWNED BY THE MTR CORPORATION LIMITED OF HONG KONG. NO REPRODUCTION OF THE DRAWING / DOCUMENT OR ANY PART BY WHATEVER MEANS IS PERMITTED WITHOUT THE PRIOR WRITTEN CONSENT OF THE MTR CORPORATION LIMITED.</small>	 SHATIN TO CENTRAL LINK CONTRACTOR Samsung - Hsin Chong Joint Venture CADD REF. 1109_Z_309_OAP_A58_104A	TITLE CONTRACT 1109 STATIONS AND TUNNELS OF KOWLOON CITY SECTION AS-BUILT COMPENSATION TREES AT MA TAU WAI RD / TO KWA WAN RD GARDEN SCALE 1:200 @ A1 DRAWING NO. 1109/Z/309/OAP/A58/104 REV. A
---	--	--

X:\CADD_Library\MicroStation\Workspaces\1109_Z_309_OAP_A58_104.dgn
 Detail
 FILENAME: \workspace\1109_Z_309_OAP_A58_104.dgn
 PLOT DRIVE: X:\CADD_Library\MicroStation\Workspaces\1109_Z_309_OAP_A58_104.dgn
 MODELNAME: 1109_Z_309_OAP_A58_104.dgn

Hung Hom Station and Stabling Slidings

(Works Contract 1112)

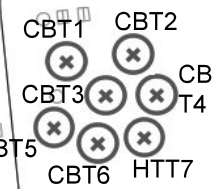
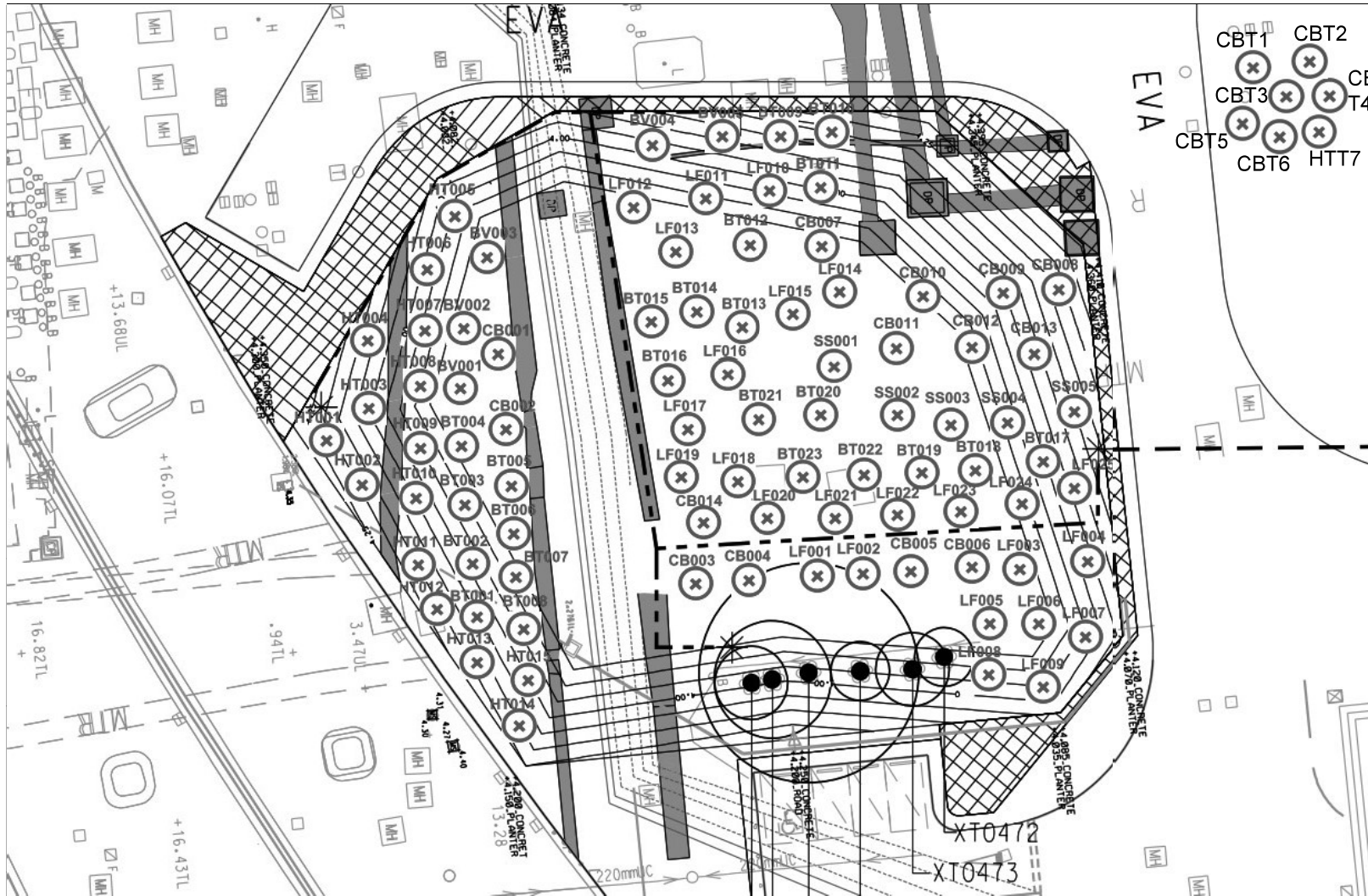

TREE LEGEND:

COMPENSATORY TREE PLANTING

EXISTING TREE TO BE RETAINED

**Shatin to Central Link
As-built Compensation Trees
at Hung Hom Area**

Code	Bontanical Name	Chinese Name	Quantity	Size (mm)
BT	<i>Bischofia trifoliata</i>	秋楓	23	150 or above
BV	<i>Bauhinia variegata</i>	宮粉羊蹄甲	5	
CB	<i>Cinnamomum burmannii</i>	陰香	20	
HT	<i>Hibicus tiliaceus</i>	黃槿	16	
LF	<i>Liquidambar formosana</i>	楓香	25	
SS	<i>Sapium sebiferum</i>	烏桕	5	
Total			94	

Scale:-

Date:-

Project No.:-

DRAWING NO:
SCL/DWG001A0