



AECOM

12/F, Grand Central Plaza, Tower 2,
138 Shatin Rural Committee Road,
Shatin, Hong Kong
香港新界沙田鄉事會路 138 號
新城市中央廣場第 2 座 12 樓
www.aecom.com

Engineer's Representative's Office
25 Hung Hing Road,
Causeway Bay, Hong Kong
香港銅鑼灣鴻興道 25 號
+852 3912 3000 tel
+852 3912 3010 fax

Your Ref. :

Our Ref. : CWB/(HY/2009/18)/M45/150/18B011924

17 June 2020

Highways Department
Major Works Project Management Office
Major Work Office (2)
3/F., Ho Man Tin Government Offices,
88 Chung Hau Street,
Ho Man Tin,
Kowloon

Attn.: Mr. Tony Cheung, SE4/CWB

Dear Sir,

Agreement No. CE5/95

**Design and Construction of Central – Wan Chai Bypass and Island Eastern Corridor Link
Supplementary Agreement No. 3 – Design, Tender and Construction Phases**

Contract No. HY/2009/18

Central-Wan Chai Bypass – Central Interchange

Environmental Permit No. EP-482/2013/C

As-built Drawings of Landscape and Visual Mitigation Measures

----- Pursuant to Condition 2.10 of Environmental Permit No. EP-482/2013/C, I enclose for your onward submission to EPD four hard copies and on electronic copy of the as-built drawings of the landscape and visual mitigation measures in the deposited Landscape Plan for Contract No. HY/2009/18, together with a certification letter from ET and verification letter from IEC.

Two extra hard copies and one electronic copy of the as-built drawings are also enclosed for your retention.

Yours faithfully,
For and on behalf of
AECOM Asia Co. Ltd.

David Kwan
Principal Resident Engineer

Encl. (6 hard copies + 2 soft copies)

c.c. ET (Lam)	- Attn.: Mr. Raymond L.M. Dai] – w/o encl.
IEC (Environ)	- Attn.: Mr. David B.K. Yeung] – w/o encl.
CWB (HY/2019/18)] – w/o encl.
e.c. AECOM	- Attn.: Mr. Alex Li / Ms. Ivy Chung	
DK/EW/DY/al		



Lam Geotechnics Limited

Ground Investigation & Instrumentation Professionals

華益土力有限公司

Ref : G1938/CS/L118/AECOM
Date : 16 Jun 2020

Highways Department
Major Works Project Management Office
Major Works Office (2)
3rd Floor
Ho Man Tin Government Offices,
88 Chung Hau Street,
Ho Man Tin,
Kowloon

By Post & Fax: 2714 5289

Attn: Mr. Tony Cheung (Sr Engr 4/Central Wanchai Bypass)

Dear Mr. Cheung,

**Contract No. HY/2019/18
Wanchai Development Phase II and Central-Wanchai Bypass Sampling, Field
Measurement and Testing Works (Stage 4)
As-Built Drawing of Landscape and Visual Mitigation Measures for Contract No.
HY/2009/18 (Rev.1) (under Condition 2.10 of Environmental Permit No. EP-482/2013/C)**

Referring to the captioned submission for Contract No. HY/2009/18 received through RSS's email on 12 June 2020, 9:43 a.m., we have reviewed the submitted details and hereby certified this submission in accordance with Condition 2.10 of EP-482/2013/C.

We understand that the as-built drawings of the landscape and visual mitigation measures for other Contracts including HK/2009/02, HK/2012/08, HY/2009/19, HY/2010/08 and HY/2011/08 will be submitted once available. We shall certify the submission in accordance with Condition 2.10 of EP-482/2013/C accordingly.

Should you have any enquiry, please feel free to contact the undersigned at 2839 5666.

Yours faithfully,
For and On Behalf of
Lam Geotechnics Limited

Raymond Dai
Environmental Team Leader

c.c. AECOM CWB	- Mr. David Kwan	(By Fax: 3912 3010)
AECOM WDII	- Mr. S.K Lo	(By Fax: 2587 1877)
Ramboll	- Mr. David Yeung	(By Fax: 3465 2899)





Ref.: AACWBIECEM00_0_12223L.20

16 June 2020

By Post and Fax (2691 2649)

AECOM Asia Company Limited
8/F., Grand Central Plaza, Tower 2
138 Shatin Rural Committee Road, Shatin
New Territories, Hong Kong

Attention: Mr. Conrad Ng

Dear Sir,

**Re: Contract No. HY/2009/18
Central – Wan Chai Bypass – Central Interchange**

**As-built Drawings of Landscape and Visual Mitigation Measures (Rev. 1)
under Condition 2.10 of EP-482/2013/C**

Reference is made to the receipt of captioned submission from RSS via e-mail dated 12 June 2020, and certified by the ET Leader (ET's ref.: "G1938/CS/L118/AECOM" dated 16 June 2020).

We are pleased to inform that we have no adverse comments on the captioned submission. We write to verify the captioned submission in accordance with Condition 2.10 of EP-482/2013/C.

Thank you very much for your kind attention and please do not hesitate to contact the undersigned should you have any queries.

Yours faithfully,
For and on behalf of
Ramboll Hong Kong Limited

David Yeung
Independent Environmental Checker

C.C.

HyD	Attn.: Mr. Tony Cheung	(By Fax: 2714 5289)
AECOM	Attn.: Mr. David Kwan	(By Fax: 3912 3010)
Lam	Attn.: Mr. Raymond Dai	(By Fax: 2882 3331)

Q:\Projects\AACWBIECEM00\Corr\AACWBIECEM00_0_12223L.20.doc

Central – Wan Chai Bypass
and Island Eastern Corridor Link

**As-built Drawings of the Landscape
and Visual Mitigation Measures for
Contract HY/2009/18 (Rev.1)**

(under Condition 2.10 of EP-482/2013/C)

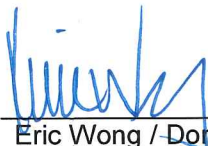
Prepared by: 
Eric Wong / Donald Ip Date: 16 JUNE 2020

Position: SRE (S&E) / RE (Env)
AECOM

Endorsed by: 
David Kwan Date: 19 June 2020

Position: Principal Resident Engineer
AECOM

As-built Drawings of the Landscape and Visual Mitigation Measures

(CONDITION 2.10 OF OPERATION ENVIRONMENTAL PERMIT, EP-482/2013/C)

- 1. As-built drawings of the landscape and visual mitigation measures for HY/2009/18**
 - 1.1 The submission includes the as-built drawings of the landscape and visual mitigation measures for contract HY/2009/18, in which the landscape and visual mitigation measures were implemented and included in the Final Landscape Plan (Rev. D4) submitted under Condition 2.10 of the FEP-05/364/2009/A and was approved by EPD on 7 November 2019.
- 2 As-built drawings of the landscape and visual mitigation measures for other CWB contracts**
 - 2.1 As for other CWB contracts including HY/2009/19, HY/2010/08 and HY/2011/08, the landscape works are underway and the as-built drawings of the landscape and visual mitigation measures for contracts HY/2009/19, HY/2010/08 and HY/2011/08 will be submitted once available.
- 3 As-built drawings of the landscape and visual mitigation measures For WDII contracts**
 - 3.1 For WDII contracts including HK/2009/02 and HK/2012/08, the shrubs planting works has commenced and is underway. The tree planting plan is being further refined with LCSD and works will be carried once the completion of the tree planting plan review. The as-built drawings of the landscape and visual mitigation measures for contracts HK/2009/02 and HK/2012/08 will be submitted once available.
- 4 Long Term Landscape Monitoring**
 - 4.1 Under the updated EM&A Manual (Dec 2010) table 6.1, monitoring of the long-term management of the planting works shall be carried out in the period up to 5 years after completion of the construction works. The monitoring report shall be compiled by ET or Maintenance Agency and counter-sign by Management Agency or IEC.

GENERAL NOTES FOR LANDSCAPE WORKS:

- GENERAL INFORMATION**
THESE DRAWING PACKAGES INTENDS TO SHOW SOFT LANDSCAPE TREATMENT ONLY. FOR SETTING OUT AND STRUCTURAL DESIGNS, REFER TO ENGINEERING PACKAGE. FOR CONSTRUCTION OF ALL ENGINEERING WORKS INCLUDING ROADWAYS, BRIDGE AND UTILITIES, REFER TO ENGINEERING DRAWING PACKAGE. THE CONTRACTOR SHALL REPORT TO THE SUPERVISING OFFICER IMMEDIATELY FOR ANY DISCREPANCY BETWEEN THE ENGINEERING AND LANDSCAPE DRAWINGS.
- DRAWING DIMENSIONS**
ALL DIMENSIONS ARE IN MILLIMETRES UNLESS OTHERWISE STATED.
- EXISTING TREES/VEGETATION**
THE CONTRACTOR SHOULD PROTECT ALL TREES WERE RETAINED ON SITE AS STIPULATED IN G.S. SECTION 26. THE CONTRACTOR SHOULD BE RESPONSIBLE FOR REINSTATING EXISTING/RETAINED VEGETATION AFFECTED BY THE CONSTRUCTION WORKS.
- TREE FELLING**
NO TREES SHOULD BE FELLED OR REMOVED WITHOUT THE OLD APPROVAL.
- GROUND PREPARATION WORKS**
GROUND PREPARATION WORKS SHOULD BE CARRIED OUT TO ALL AREAS (EXCEPT SLOPE AREA) WERE PLANTED AS SPECIFIED.
- SOIL MIX AND SOIL CONDITIONER**
SOIL MIX SHALL CONSIST OF FRIABLE COMPLETELY DECOMPOSED GRANITE AND SOIL CONDITIONER IN THE PROPORTIONS 3:1 BY VOLUME AND SHOULD BE FREE OF DELETERIOUS MATERIALS AS SPECIFIED IN G.S. CLAUSE 3.30 - SOIL-MIX AND G.S. CLAUSE 3.31 FOR SOIL CONDITIONER.
- MULCHING**
TREE PLANTING AND SHOULD BE MULCHED TO A DEPTH OF 25mm. THE MULCH SHALL BE 25mm TO 50mm IN SIZE AND SHALL COMPLY WITH G.S. CLAUSE 3.34 FOR MULCHING.
- PLANT NAME**
BOTANICAL NAME SHOULD TAKE PRECEDENCE TO ENGLISH AND CHINESE NAME.
- PLANTING PATTERN**
ALL PLANTS WERE PLANTED IN STAGGERED PATTERN AT SPACING INDICATED IN THE SCHEDULE. CLIMBING PLANTS SHOULD BE PLANTED AGAINST SUPPORTING STRUCTURE.
- TREE PLANTING**
LOCATION OF TREES WAS SHOWN ON THE DRAWING. SPACING INDICATED IN THE PLANT SCHEDULE WAS INDICATIVE. TREES SHOULD BE LOCATED TO AVOID ANY UNDERGROUND UTILITIES. ALL SOIL LEVELS SHOULD BE SURVEYED AND VERIFIED PRIOR TO COMMENCEMENT OF PLANTING.
- STAKING**
BAMBOO STAKES SHOULD BE USED FOR ALL TREES EXCEPT WHIPS AS SPECIFIED IN G.S. 3.36. TREE TRUNKS SHOULD BE PROTECTED BY USING RUBBER HOUSE PROTECTIVE SLEEVING OR SIMILAR, AND SHOULD BE LOOSENED TWICE A YEAR.
- DRAINAGE**
ALL PLANTER DRAINAGE DETAILS AND WEEPHOLES DETAILS SHOULD REFER TO ENGINEER DRAWING.
- UNDERGROUND UTILITIES**
UTILITY COVERS SERVICES SHOWN ON THE PLANTS ARE INDICATIVE. EXACT LOCATIONS WAS CONFIRMED BY THE ENGINEER. NO TREES SHOULD BE PLANTED WITHIN 1m OF A MANHOLE OR DRAINAGE U-CHANNEL. THERE SHOULD BE NO PLANTING WITHIN THE SPACE OF 1.5m AROUND THE COVER OF ANY HYDRANT VALVE OR THE COVER OF WSD'S VALVES, OR WITHIN A DISTANCE OF 1m FROM ANY HYDRANT OUTLET. NO TREES SHOULD BE PLANTED WITHIN 2m OF A ROAD KERB OR ENGINEERING STRUCTURE.
- WATERING**
THE CONTRACTOR SHOULD PROVIDE ADEQUATE WATERING TO ALL PLANTED AREAS AS SPECIFIED IN G.S. 3.84-WATERING.

PLANTING SCHEDULE TREE PLANTING					
CODE	BOTANICAL NAME	CHINESE NAME	SIZE	SPACING (MM)	QUANTITY
CS	XANTHOSTEMON CHRYSANTHUS	金盞花	STANDARD	AS SHOWN	22
FE	TERMINALIA MANTALI 'TRICOLOR'	紫葉櫻仁	HEAVY STANDARD	AS SHOWN	55
PT	PELTOPHORUM TONKINENSE	銀珠	HEAVY STANDARD	AS SHOWN	32
TC	TABEUBIA CHRYSANTHA	黃花蕙蘭木	HEAVY STANDARD	AS SHOWN	43

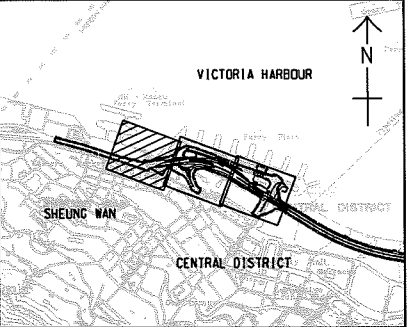

KEY PLAN
SCALE A1 1 : 20000
A3 1 : 40000

NOTE:
1. THIS DRAWING SHOULD BE READ IN CONJUNCTION WITH DRG. NO. 60095653/CI/9012 AND 9013.

- LEGEND:**
- SITE BOUNDARY
 - T1853(R) EXISTING TREE WAS RETAINED
 - PROPOSED TREE PLANTING
 - COMPENSATORY PALM PLANTING
 - T1389 COMPENSATORY TREE WITH HEAVY STANDARD SIZE
 - T11710(T) FINAL LOCATION OF TRANSPLANTED TREE AFTER CONSTRUCTION WORKS

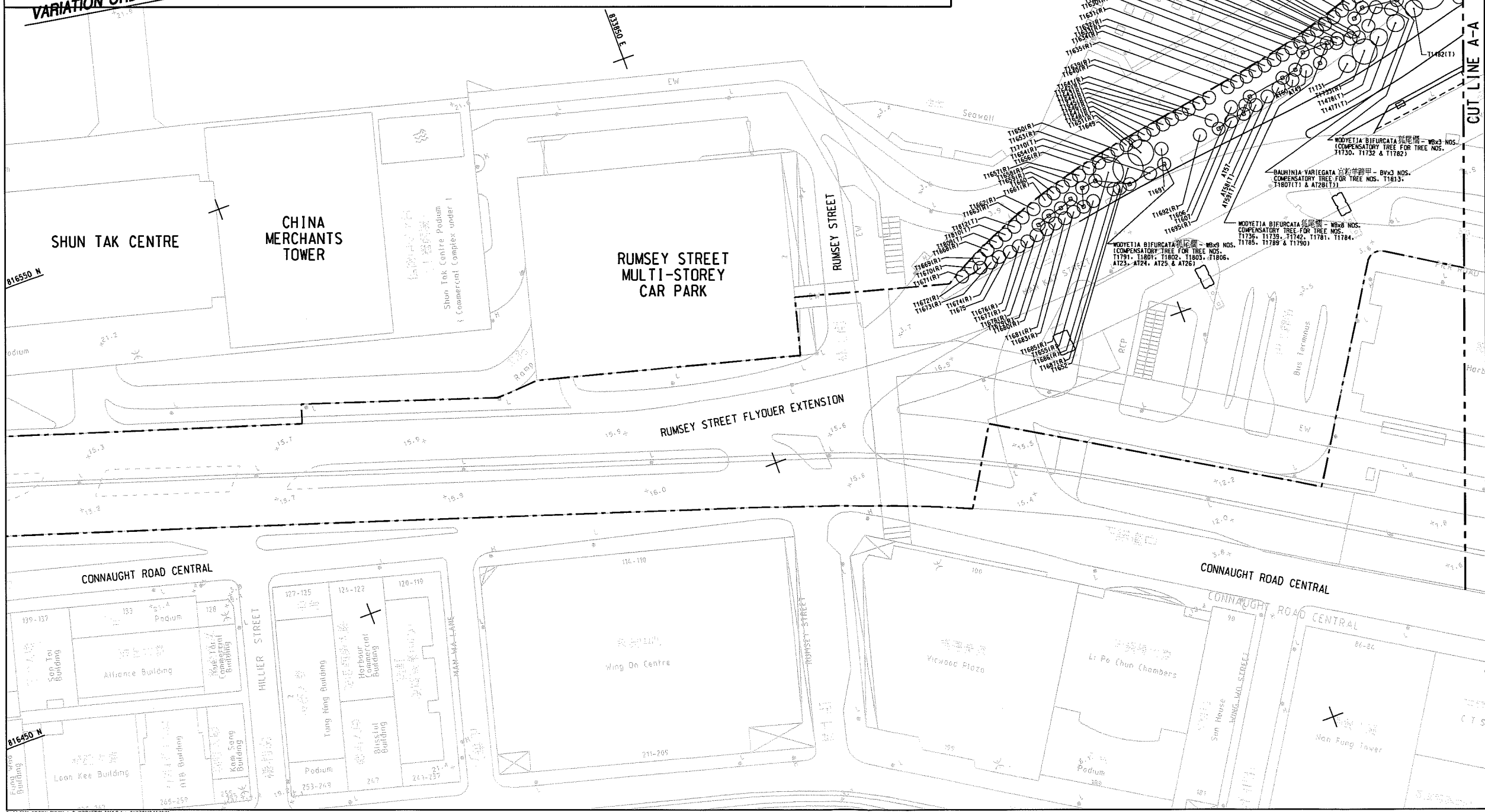

C	AS-BUILT DRAWING	HC	RY	APR 18
B	WORKING DRAWING	ACHAN	BCC	OCT 10
A	TENDER ADDENDUM NO. 1	ACHAN	BCC	JUN 10
-	TENDER DRAWING	ACHAN	BCC	APR 10

Highways Department 路政署
Major Works Project Management Office

CENTRAL - WAN CHAI BYPASS AND IEC LINK

PWP ITEM NO. 579 TH
工務計劃項目編號

CENTRAL - WAN CHAI BYPASS - CENTRAL INTERCHANGE

TREE PLANTING PLAN
SHEET 1 OF 3



DRGNO. 圖紙編號	60095653/CI/9011C
DESIGNED BY 設計	VLMK
CONTRACT NO. 合約編號	HY/2009/18
PL. BY / APPROVED 校對人 / 核准人	CM
SCALE 比例	A1 1 : 500 A3 1 : 1000
STATUS 圖紙狀態	AS BUILT DRAWING
REVISIONS ARE IN 大改	© COPYRIGHT RESERVED 版權所有

HY_2009_180000_R0000_A01/0000/CI/9011C.dwg 24/02/2018 11:03:31

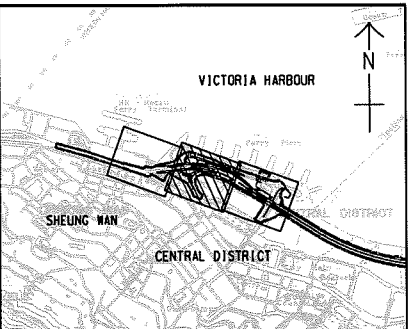
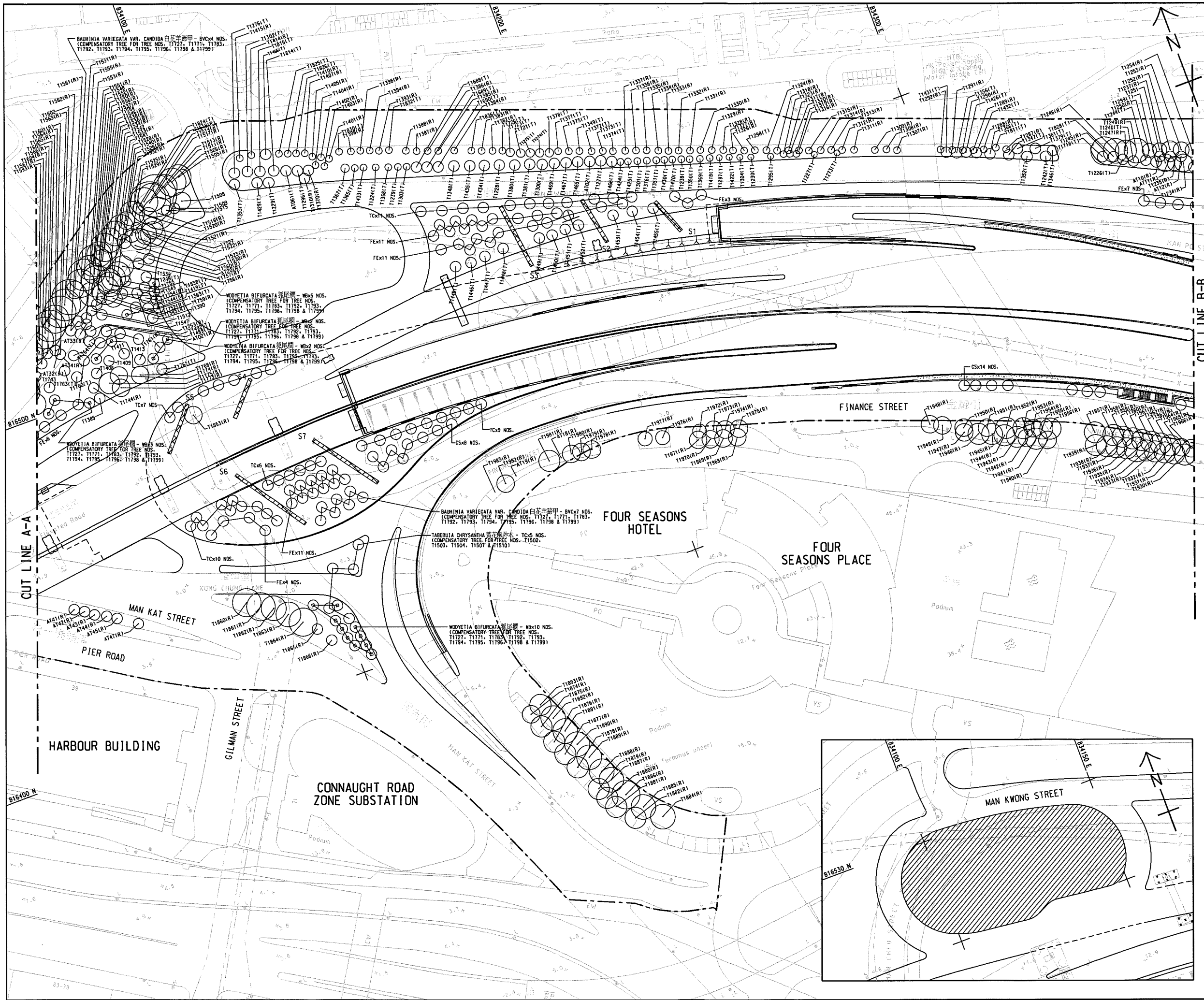

KEY PLAN
SCALE A1 : 2000
A3 : 4000

NOTE:
1. FOR NOTES AND LEGEND SEE DRG. NO. 60095653/CI/9011.
2. THIS DRAWING SHOULD BE READ IN CONJUNCTION WITH DRG. NO. 60095653/CI/9011 AND 9013.

LEGEND:
[Hatched Box] LOCATION A

C	AS-BUILT DRAWING	NC	RY	APR 18
B	WORKING DRAWING	ACHAN	BCC	OCT 10
A	TENDER ADDENDUM NO. 1	ACHAN	BCC	JUN 10
-	TENDER DRAWING	ACHAN	BCC	APR 10

Highways Department 路政署
Major Works Project Management Office

CENTRAL - WAN CHAI BYPASS AND IEC LINK

PWP ITEM NO. 579 TH
工務計劃項目編號

CENTRAL - WAN CHAI BYPASS - CENTRAL INTERCHANGE

TREE PLANTING PLAN

SHEET 2 OF 3



DRG.NO. 60095653/CI/9012C
圖紙編號

DESIGNED BY VLAK	CONTRACT NO. HY/2009/18	P. REV. APPROVED CW
DRAWN BY LHC	STATUS AS BUILT DRAWING	
SCALE A1 : 500 A3 : 1000	DIMENSIONS ARE IN METRES	

© COPYRIGHT RESERVED
版權所有

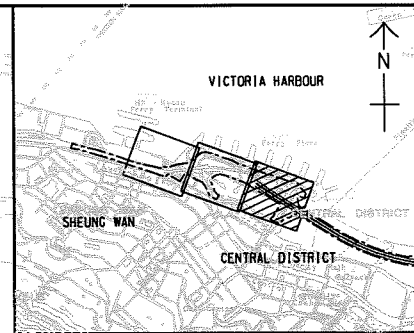
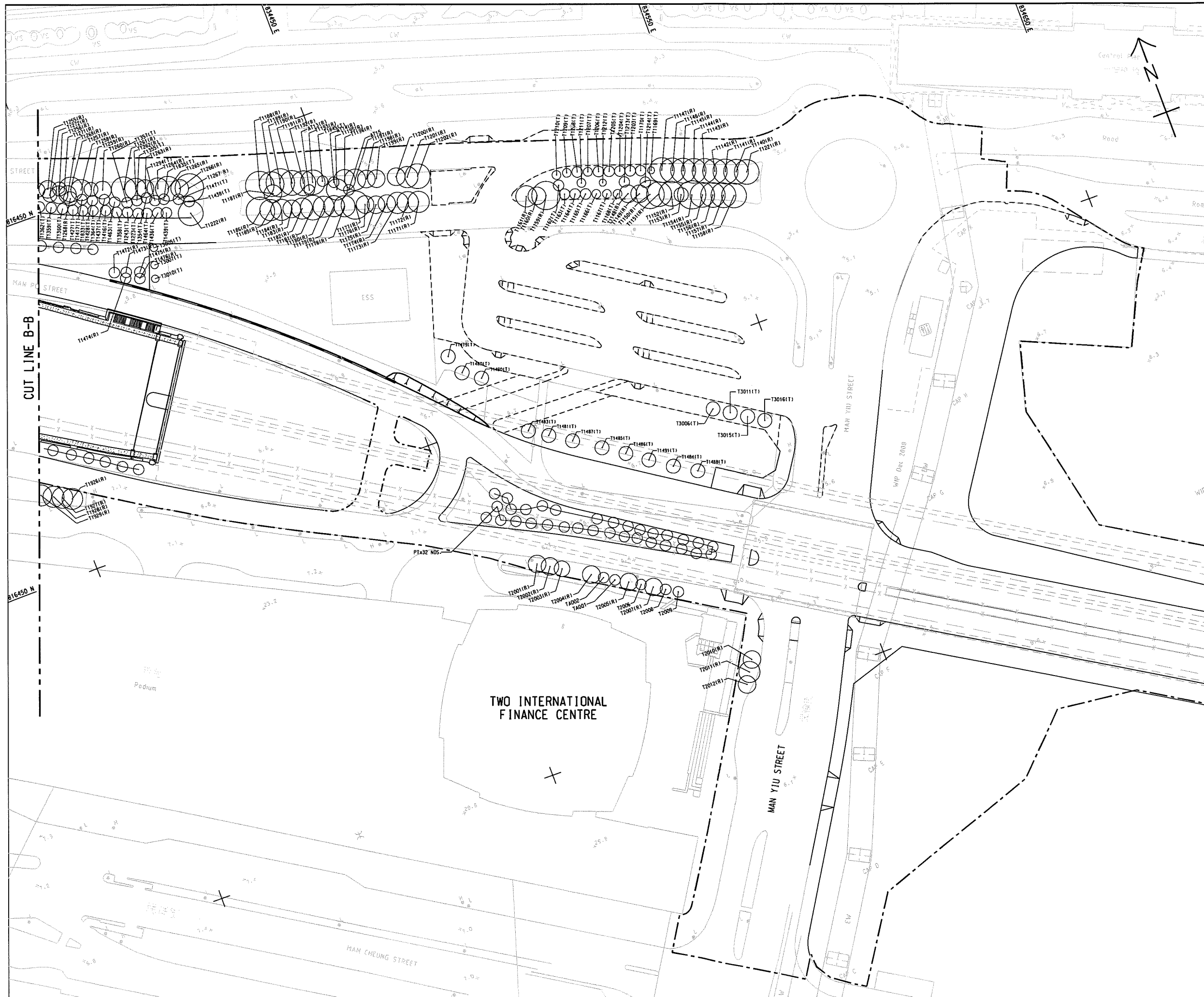

KEY PLAN
SCALE A1 1 : 20000
A3 1 : 40000

- NOTES:**
1. FOR NOTES AND LEGEND SEE DRG. NO. 60095653/CI/9011.
 2. THIS DRAWING SHOULD BE READ IN CONJUNCTION WITH DRAWING NOS. 60095653/CI/9011 AND 9012.

C	AS-BUILT DRAWING	NC	RY	APR 18
B	WORKING DRAWING	ACHAN	BCC	OCT 10
A	TENDER ADDENDUM NO. 1	ACHAN	BCC	JUN 10
-	TENDER DRAWING	ACHAN	BCC	APR 10
REV	DESCRIPTION	DATE	BY	DATE

Highways Department 路政署
Major Works Project Management Office

CENTRAL - WAN CHAI BYPASS AND IEC LINK

PWP ITEM NO. 579 TH
工務計劃項目編號

CENTRAL - WAN CHAI BYPASS - CENTRAL INTERCHANGE

TREE PLANTING PLAN

SHEET 3 OF 3



DRG. NO. 60095653/CI/9013C
圖紙編號

DESIGNED BY VLK	CONTRACT NO. HY/2009/18	P. DIR. APPROVED CN
DRAWN BY NHP	STATUS AS BUILT DRAWING	
SCALE A1 1 : 500 A3 1 : 1000	DIMENSIONS ARE IN METRES	

© COPYRIGHT RESERVED

NOTES:

1. THIS DRAWING TO BE READ IN CONJUNCTION WITH DRAWING NO. 60095653/CI/9031.
2. ALL DIMENSION ARE IN MILLIMETERS UNLESS SPECIFIED OTHERWISE.
3. THE DIMENSIONS AND LEVELS AS SHOWN ON THIS DRAWING IS INDICATIVE ONLY. THE EXACT LEVELS AND DIMENSION FOR THE PROPOSED WORKS SHALL REFER TO RELEVANT DRAWING.

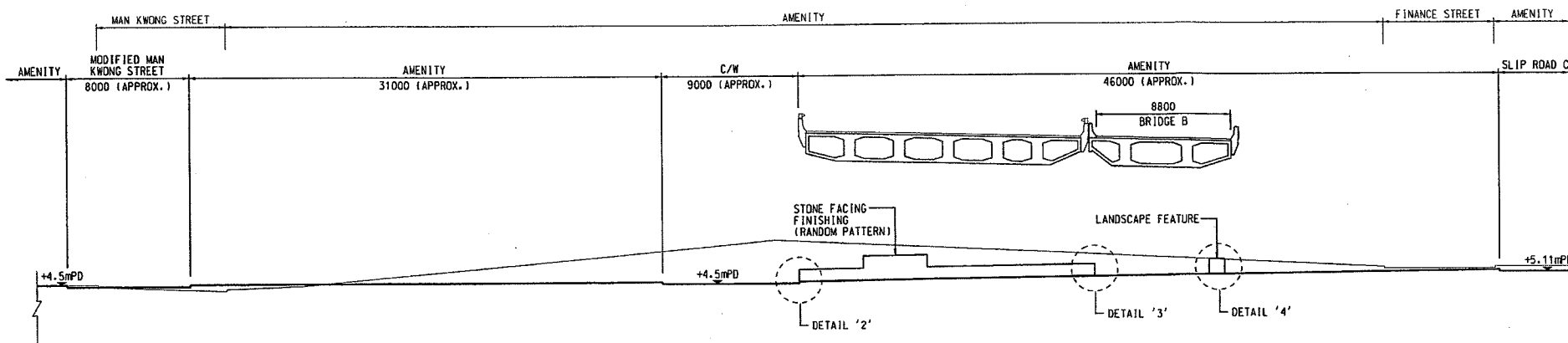

SECTION A - A
SCALE A1 1 : 200
A3 1 : 400

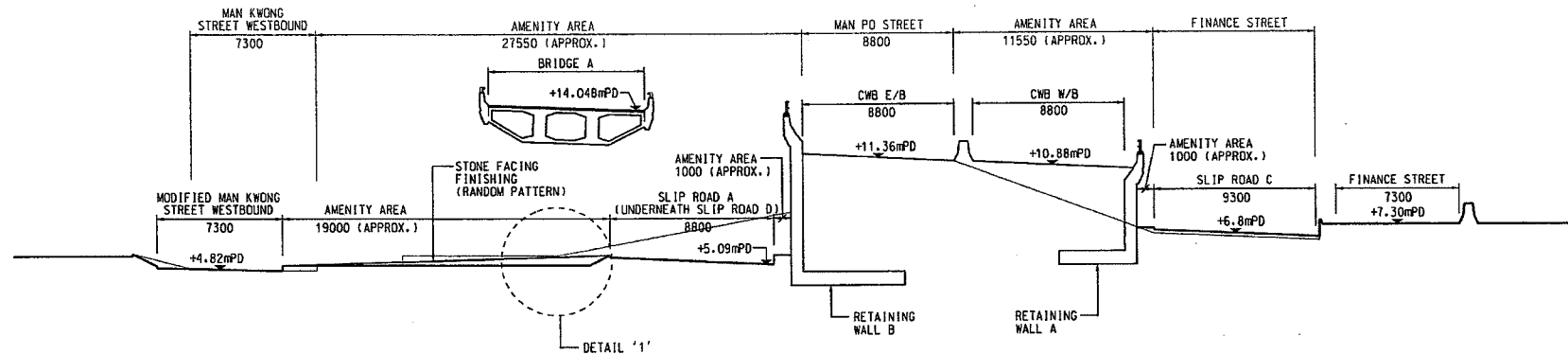

SECTION B - B
SCALE A1 1 : 200
A3 1 : 400

REV	DESCRIPTION	DATE
A	WORKING DRAWING	OCT 10
-	TENDER DRAWING	APR 10

Highways Department 路政署
Major Works Project Management Office

CENTRAL - WAN CHAI BYPASS AND IEC LINK

PWP ITEM NO. **579 TH**
工務計劃項目編號

CENTRAL - WAN CHAI BYPASS - CENTRAL INTERCHANGE

HARD LANDSCAPE SECTIONS AND DETAILS

SHEET 1 OF 2

AECOM

DRG. NO. 圖紙編號	60095653/CI/9041A
DESIGNED BY 設計	CONTRACT NO. 合約編號
VLNK	HY/2009/18
DRAWN BY 繪圖	STATUS 狀態
NHP	WORKING DRAWING
SCALE 比例	A1 1 : 200 A3 1 : 400
DIMENSIONS ARE IN 尺寸	MILLIMETERS
© COPYRIGHT RESERVED 版權所有	

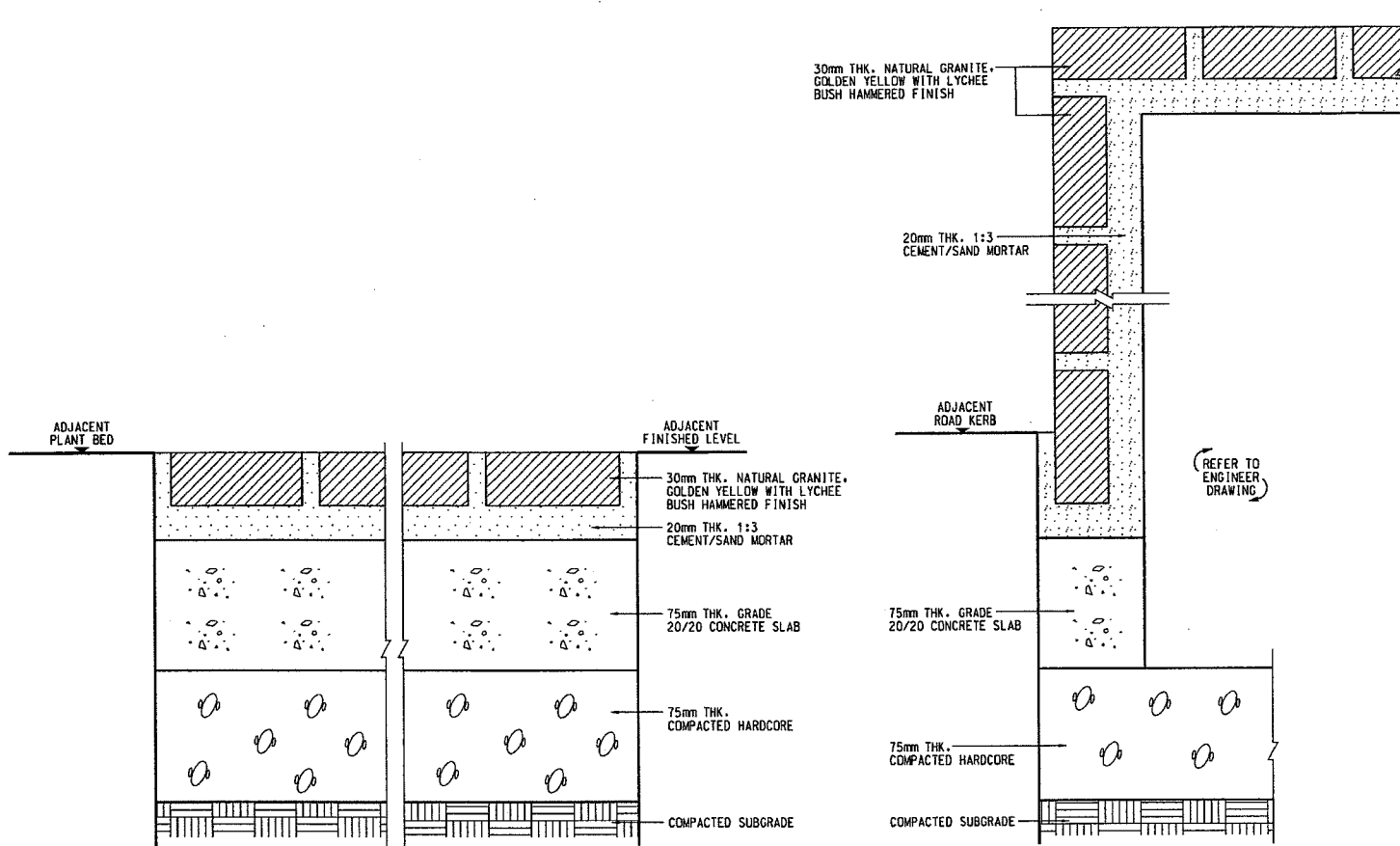

DETAIL '1'
SCALE A1 1 : 2
A3 1 : 4

DETAIL '2'
SCALE A1 1 : 2
A3 1 : 4

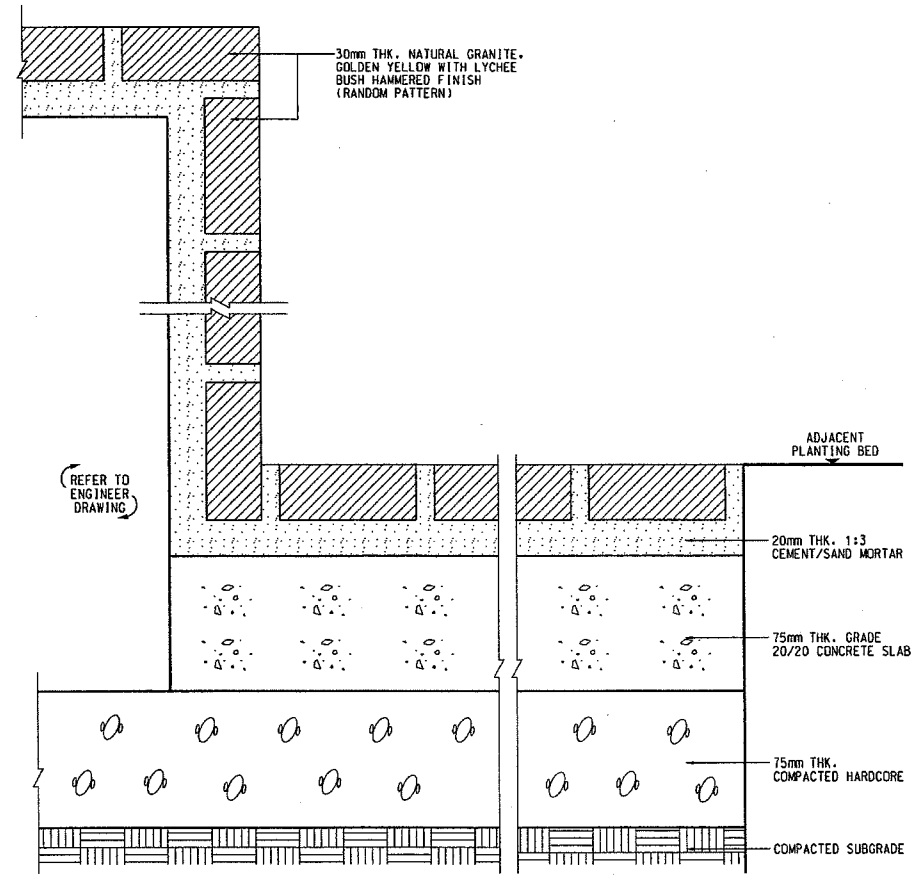

DETAIL '3'
SCALE A1 1 : 2
A3 1 : 4

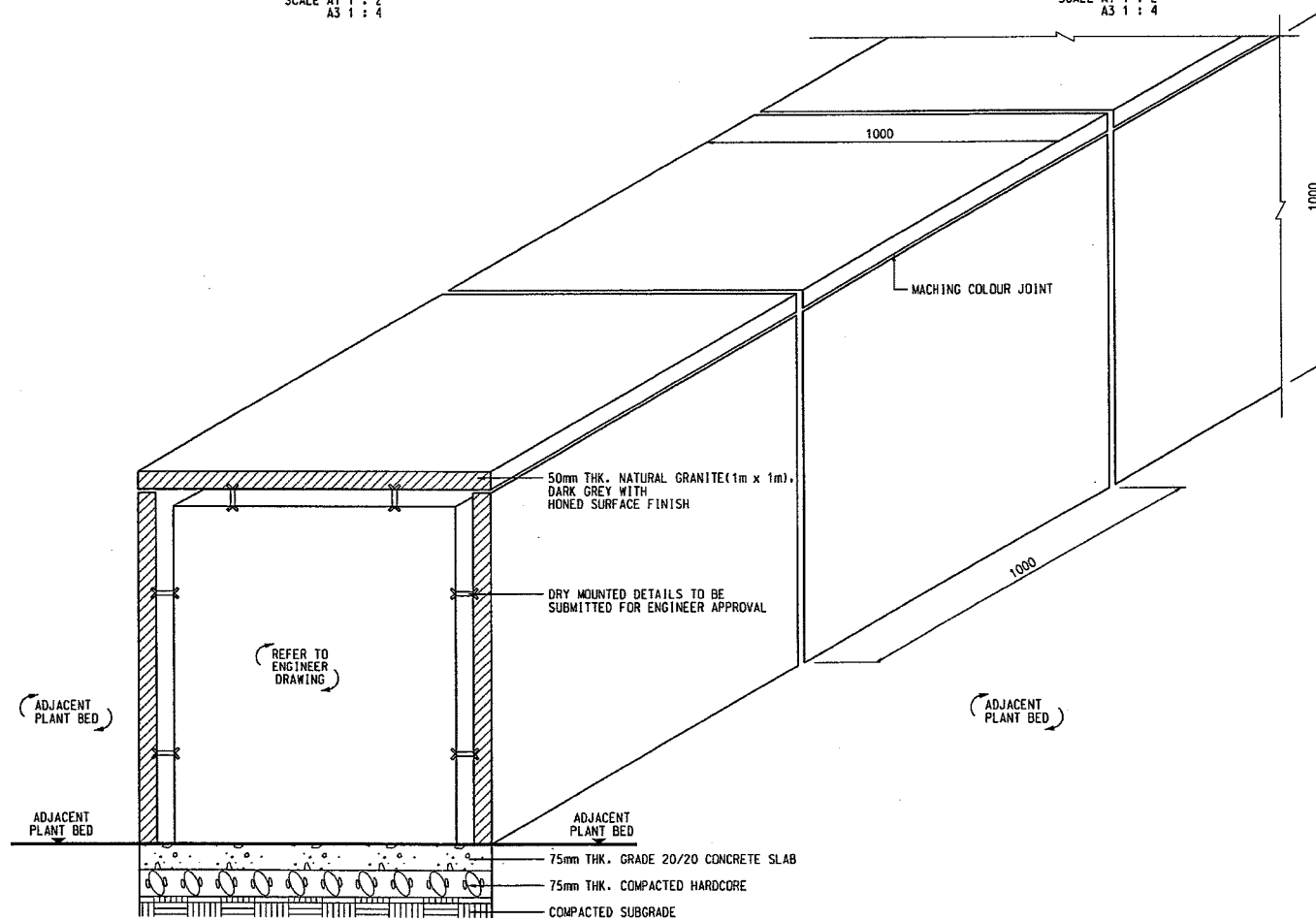

DETAIL '4'
SCALE A1 1 : 10
A3 1 : 20

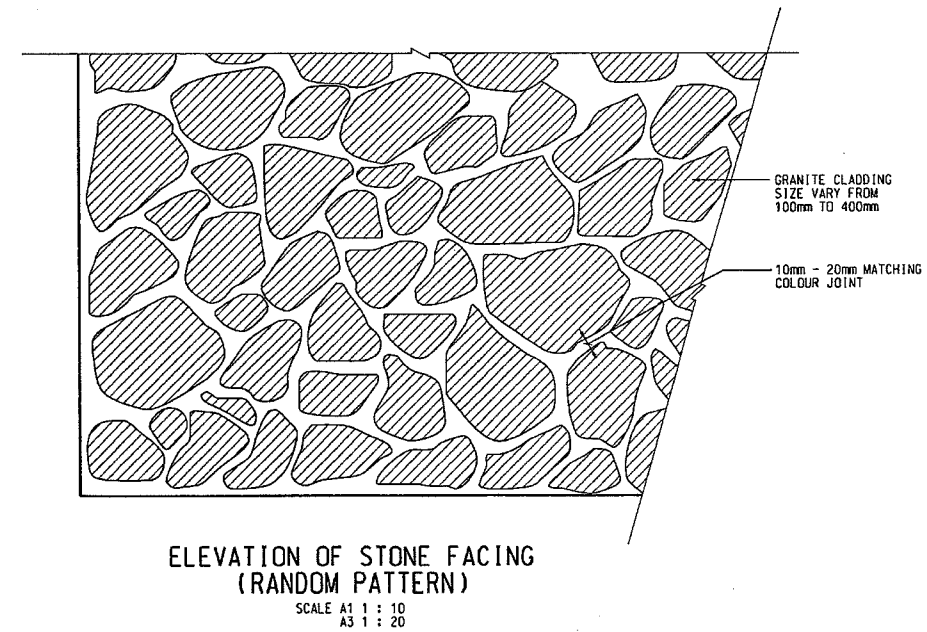

NOTES:

- THIS DRAWING TO BE READ IN CONJUNCTION WITH DRAWING NO. 60095653/C1/9041.
- ALL DIMENSION ARE IN MILLIMETERS UNLESS SPECIFIED OTHERWISE.
- THE DIMENSIONS AND LEVELS AS SHOWN ON THIS DRAWING IS INDICATIVE ONLY. THE EXACT LEVELS AND DIMENSION FOR THE PROPOSED WORKS SHALL REFER TO RELEVANT DRAWING.
- NATURAL GRANITE FINISHING FOR THE HARD LANDSCAPE FEATURES SHALL BE DRY MOUNT.
- CONTRACTOR SHALL PROVIDE SHOP DRAWING SHOWING THE DETAILS AND DETAILED SETTING OUT OF THE HARD LANDSCAPE FEATURES AND THE DETAILS OF THE STONE FACING FINISHING FOR ENGINEER'S APPROVAL PRIOR TO CONSTRUCTION.

A	WORKING DRAWING	ACHAN/BCC	OCT 10
-	TENDER DRAWING	ACHAN/BCC	APR 10
NO.	DESCRIPTION	DATE	BY
01	ISSUED FOR TENDER	10/04/10	ACHAN
02	ISSUED FOR CONSTRUCTION	10/04/10	ACHAN

Highways Department 路政署
Major Works Project Management Office

CENTRAL - WAN CHAI BYPASS AND IEC LINK

PWP ITEM NO. 579 TH
工務計劃項目編號

CENTRAL - WAN CHAI BYPASS - CENTRAL INTERCHANGE

HARD LANDSCAPE SECTIONS AND DETAILS

SHEET 2 OF 2

AECOM

DRG. NO. 60095653/C1/9042A
圖紙編號

DESIGNED BY 設計	VLAK	CONTRACT NO. 合約編號	HY/2009/18	P. BY - APPROVED 校對人	CW
DRAWN BY 繪圖	LHC	STATUS 狀態	WORKING DRAWING		
SCALE 比例	A1 AS SHOWN A3 AS SHOWN				
DIMENSIONS ARE IN 尺寸單位	MILLIMETERS				

© COPYRIGHT RESERVED
版權所有

PLANTING SCHEDULE

CODE	BOTANICAL NAME	CHINESE NAME	SPECIFICATION (mm) HEIGHT(H)xSPREAD	SPACING (mm)	NO./m ²	QUANTITY	COMMENT
SHRUB PLANTING							
ACW	ACALYPHA WILKESIANA 'TRICOLOR'	五彩大葉紅桑	500(H)x500(S)	400	7.25	1540	PLANT ALL SPECIES IN A STAGGERED PATTERN
AIZ	ALPINTIA ZERUMBERT 'VARIEGATA'	花葉山薑	400(H)x400(S)	300	12.54	3471	
CAM	CALATHEA MAKOYANA	孔雀冬蕪	300(H)x200(S)	200	29	520	
CAJ	CAMELLIA JAPONICA	山茶	500(H)x500(S)	400	7.25	3393	
CDV	CODIAEUM VARIEGATUM	洒金榕	400(H)x400(S)	300	12.54	6447	
CTR	CORYDINE TERMINALIS 'RUBRA'	朱蕉	500(H)x400(S)	300	12.54	11722	
CUH	CUPHEA HYSSOPIFOLIA	樹葉等距花/細葉雪海菜	150(H)x100(S)	150	51.32	4980	
DRG	DURANTA REPENS 'GOLDEN'	金邊刺楸	400(H)x400(S)	300	12.54	16386	
DRV	DURANTA REPENS - CV GOLDEN EDGE	黃邊刺楸	300(H)x300(S)	250	18.48	10536	
ERD	ERVATAMIA DIVARICATA	狗牙花	500(H)x500(S)	400	7.25	550	
FMG	FIGUS MICROCARPA 'GOLDEN LEAF'	黃榕	500(H)x500(S)	400	7.25	3931	
HRS	HIBISCUS ROAS-SINENSIS 'YELLOW'	扶桑黃花	500(H)x500(S)	400	7.25	6598	
HYL	HYOPHORBE LAGENICALLIS	酒蒸椰子	1000(H)x1500(S)	AS SHOWN	-	8	
IXC	LXORA COCCINEA 'LUTEA'	黃花銀船花	400(H)x400(S)	300	12.54	11503	
IXW	LXORA WILLIAMIRI 'SUNKIST'	矮銀船	300(H)x300(S)	300	12.54	3520	
JAS	JASMINUM SAMBAC	茉莉	500(H)x500(S)	400	7.25	1058	
LOC	LODOPETALUM CHINENSE F. RUBRUM	紅花繼木	400(H)x400(S)	300	12.54	7693	
OSF	OSMANTHUS FRAGRANS	桂花	500(H)x500(S)	400	7.25	4277	
PEL	PENTAS LANCEOLATA	五星花	300(H)x300(S)	300	12.54	660	
PIT	PITTIOSPORUM TOBIRA	海桐花	500(H)x500(S)	400	7.25	723	
RHE	RHAPIS EXCELSA	榕竹	1000(H)x750(S)	600	3.21	87	
RHP	RHODODENDRON PULCHRUM	紫杜鵑	500(H)x500(S)	400	7.25	1785	
SAJ	SCHEFFLERA ARBORICOLA 'JANINE'	黃金鶴腳木	500(H)x500(S)	400	7.25	592	
SCA	SCHEFFLERA ARBORICOLA 'VARIEGATA'	花葉八角	500(H)x500(S)	400	7.25	3356	
SCA-1	SCINDAPSUS AUREUM CV. 'ALL GOLD'	金葉蓮	150(H)x200(S)	200	29	1212	
SPS	SPATHIOPHYLLUM SP.	白麗蕓	300(H)x300(S)	200	29	50	
SYP	SYNGONIUM PODOPHYLLUM CV. 'PINKY'	錦葉合果芋(紅粉佳人)	150(H)x200(S)	200	29	494	
TES	TECOMA STANS	黃藤花	500(H)x500(S)	400	7.25	3750	
GROUND COVER PLANTING							
ASS	ASPARAGUS SPRENGERI	夾冬	200(H)x200(S)	200	29	4663	
LAC	LANTANA CAMARA 'FLAVA'	黃花馬纓丹	200(H)x200(S)	200	29	3925	
ZEG	ZEPHYRANTHES GRANDIFLORA	風雨花	100(H)x200(S)	200	29	13030	
TURF PLANTING							
AXC	AXONOPUS COMPRESSUS	地毯草/大葉草	500(L)x300(W)	-	-	147(m ²)	AS PER GS CLAUSE 3.27

GENERAL NOTES FOR LANDSCAPE WORKS:

- GENERAL INFORMATION**
THESE DRAWING PACKAGES INTENDS TO SHOW SOFT LANDSCAPE TREATMENT ONLY. FOR SETTING OUT AND STRUCTURAL DESIGNS, REFER TO ENGINEERING PACKAGE. FOR CONSTRUCTION OF ALL ENGINEERING WORKS INCLUDING ROADWAYS, BRIDGE AND UTILITIES, REFER TO ENGINEERING DRAWING PACKAGE. THE CONTRACTOR SHOULD REPORT TO THE SUPERVISING OFFICER IMMEDIATELY FOR ANY DISCREPANCY BETWEEN THE ENGINEERING AND LANDSCAPE DRAWINGS.
- DRAWING DIMENSIONS**
ALL DIMENSIONS ARE IN MILLIMETERS UNLESS OTHERWISE STATED.
- EXISTING TREES/VEGETATION**
THE CONTRACTOR SHOULD PROTECT ALL TREES WERE RETAINED ON SITE AS STIPULATED IN G.S. SECTION 26. THE CONTRACTOR SHALL BE RESPONSIBLE FOR REINSTATING EXISTING/RETAINED VEGETATION AFFECTED BY THE CONSTRUCTION WORKS.
- TREE FELLING**
NO TREES SHOULD BE FELLED OR REMOVED WITHOUT THE DLO APPROVAL.
- GROUND PREPARATION WORKS**
GROUND PREPARATION WORKS SHOULD BE CARRIED OUT TO ALL AREAS (EXCEPT SLOPE AREA) WERE PLANTED AS SPECIFIED.
- SOIL MIX AND SOIL CONDITIONER**
SOIL MIX SHOULD CONSIST OF FRIABLE COMPLETELY DECOMPOSED GRANITE AND SOIL CONDITIONER IN THE PROPORTIONS 3:1 BY VOLUME AND SHOULD BE FREE OF DELETERIOUS MATERIALS AS SPECIFIED IN G.S. CLAUSE 3.30 - SOIL-MIX AND G.S. CLAUSE 3.31 FOR SOIL CONDITIONER.
- MULCHING**
TREE PLANTING AND SHRUB AREAS SHOULD BE MULCHED TO A DEPTH OF 50mm. FINISH LEVEL OF MULCH SHOULD BE 25mm BELOW ADJACENT FINISHED SURFACES, AND COMPLY WITH G.S. CLAUSE 3.32-MULCH.
- PLANT NAME**
BOTANICAL NAME SHOULD TAKE PRECEDENCE TO ENGLISH AND CHINESE NAME.
- PLANTING PATTERN**
ALL PLANTS WERE PLANTED IN STAGGERED PATTERN AT SPACING INDICATED IN THE SCHEDULE. CLIMBING PLANTS SHOULD BE PLANTED AGAINST SUPPORTING STRUCTURE.
- TREE PLANTING**
LOCATION OF TREES WAS SHOWN ON THE DRAWING. SPACING INDICATED IN THE PLANT SCHEDULE IS INDICATIVE. TREES SHOULD BE LOCATED TO AVOID ANY UNDERGROUND UTILITIES. ALL SOIL LEVELS SHOULD BE SURVEYED AND VERIFIED PRIOR TO COMMENCEMENT OF PLANTING.
- STAKING**
BAMBOO STAKES SHOULD BE USED FOR ALL TREES EXCEPT WHIPS AS SPECIFIED IN G.S. 3.36. TREE TRUNKS SHOULD BE PROTECTED BY USING RUBBER HOUSE PROTECTIVE SLEEVING OR SIMILAR, AND SHOULD BE LOOSENED TWICE A YEAR.
- DRAINAGE**
ALL PLANTER DRAINAGE DETAILS AND WEEPHOLES DETAILS SHOULD REFER TO ENGINEER DRAWING.
- UNDERGROUND UTILITIES**
UTILITY COVERS SERVICES SHOWN ON THE PLANTS ARE INDICATIVE. EXACT LOCATIONS WERE CONFIRMED BY THE ENGINEER. NO TREES SHOULD BE PLANTED WITHIN 1m OF A MANHOLE OR DRAINAGE U-CHANNEL. THERE SHOULD BE NO PLANTING WITHIN THE SPACE OF 1.5m AROUND THE COVER OF ANY HYDRANT VALVE OR THE COVER OF WSD'S VALVES. OR WITHIN A DISTANCE OF 1m FROM ANY HYDRANT OUTLET. NO TREES SHOULD BE PLANTED WITHIN 2m OF A ROAD KERB OR ENGINEERING STRUCTURE.
- WATERING**
THE CONTRACTOR SHOULD PROVIDE ADEQUATE WATERING TO ALL PLANTED AREAS AS SPECIFIED IN G.S. 3.84-WATERING.

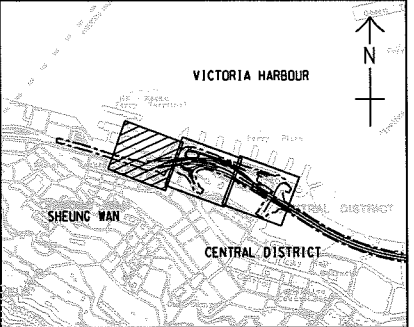

KEY PLAN
SCALE A1 : 20000
A3 : 40000

- NOTES:**
- THIS DRAWING SHOULD BE READ IN CONJUNCTION WITH DRG. NO. 60095653/C1/9052 AND 9053.
 - EXISTING TREES NOT SHOWN WOULD NOT BE AFFECTED BY THE PROJECT.

LEGEND:

- SITE BOUNDARY
- [Pattern] EXISTING PLANTER WOULD BE AFFECTED BY THE PROJECT AND REPLANTED BY OTHERS
- [Pattern] LANDSCAPE FEATURE AND LIGHTING (DETAILS REFER TO DWG. NO. 60095653 /C1/9031, 9041, 9042 AND 9061)
- [Pattern] STONE FACING FINISHING
- (CAM 520) SHRUB CODE QUANTITY

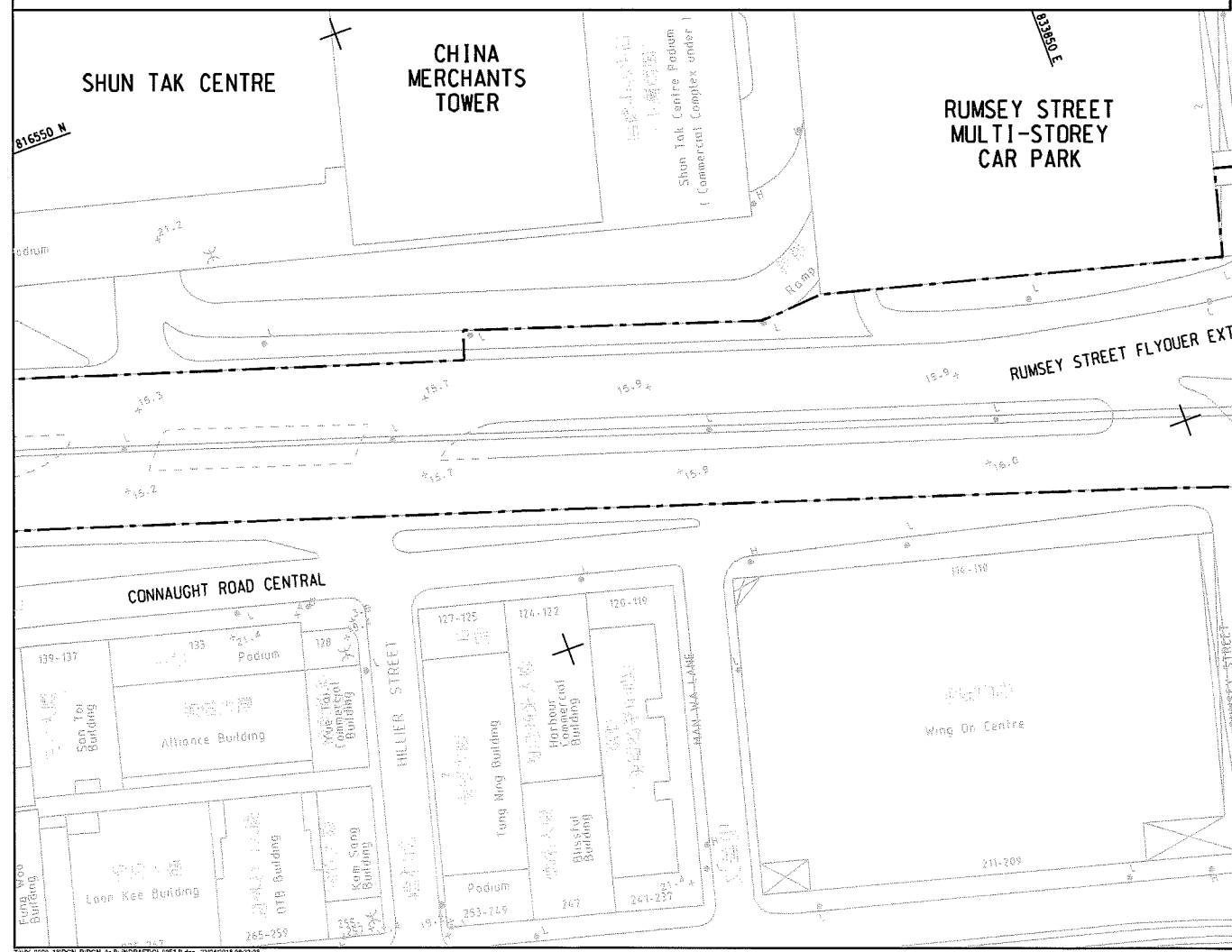
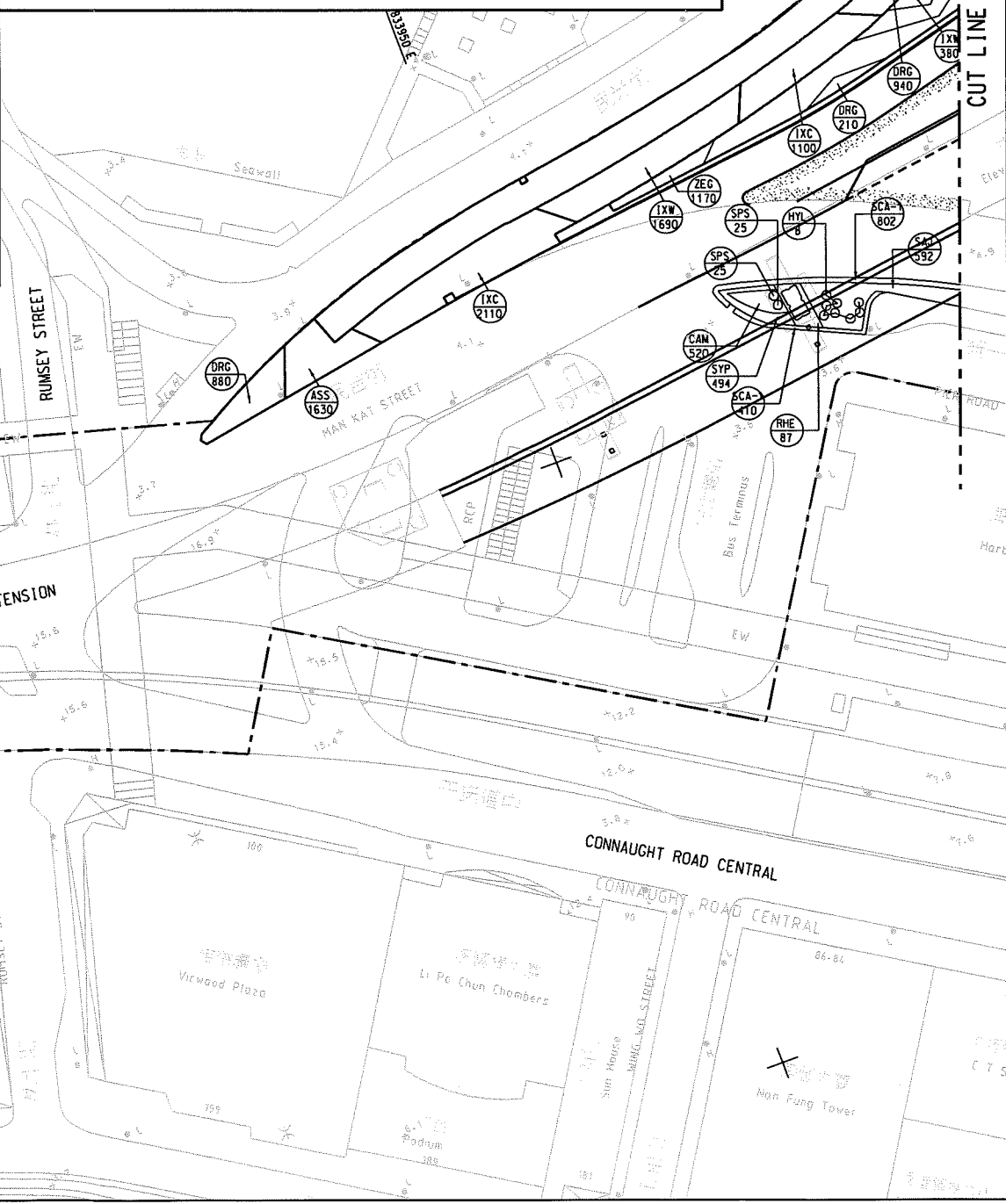

B	AS-BUILT DRAWING	NC	RY	APR 18
A	WORKING DRAWING	ACHAN	BCC	OCT 10
-	TENDER DRAWING	ACHAN	BCC	APR 10

Highways Department 路政署
Major Works Project Management Office

CENTRAL - WAN CHAI BYPASS AND IEC LINK

PWP ITEM NO. 579 TH
工務計劃項目編號

CENTRAL - WAN CHAI BYPASS - CENTRAL INTERCHANGE

SHRUB PLANTING PLAN
SHEET 1 OF 3



DRG. NO. 圖紙編號	60095653/C1/9051B	CONTRACT NO. 合約編號	HY/2005/18	APPROVED 核准	CW
DESIGNED BY 設計	VLAK	STATUS 狀態	LHC	AS BUILT DRAWING	
SCALE 比例	A1 : 500 A3 : 1000	COPYRIGHT RESERVED 版權所有			
UNITS 單位	METRES				

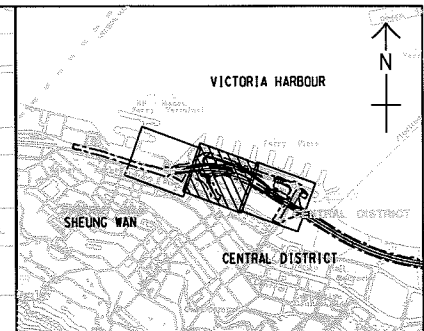
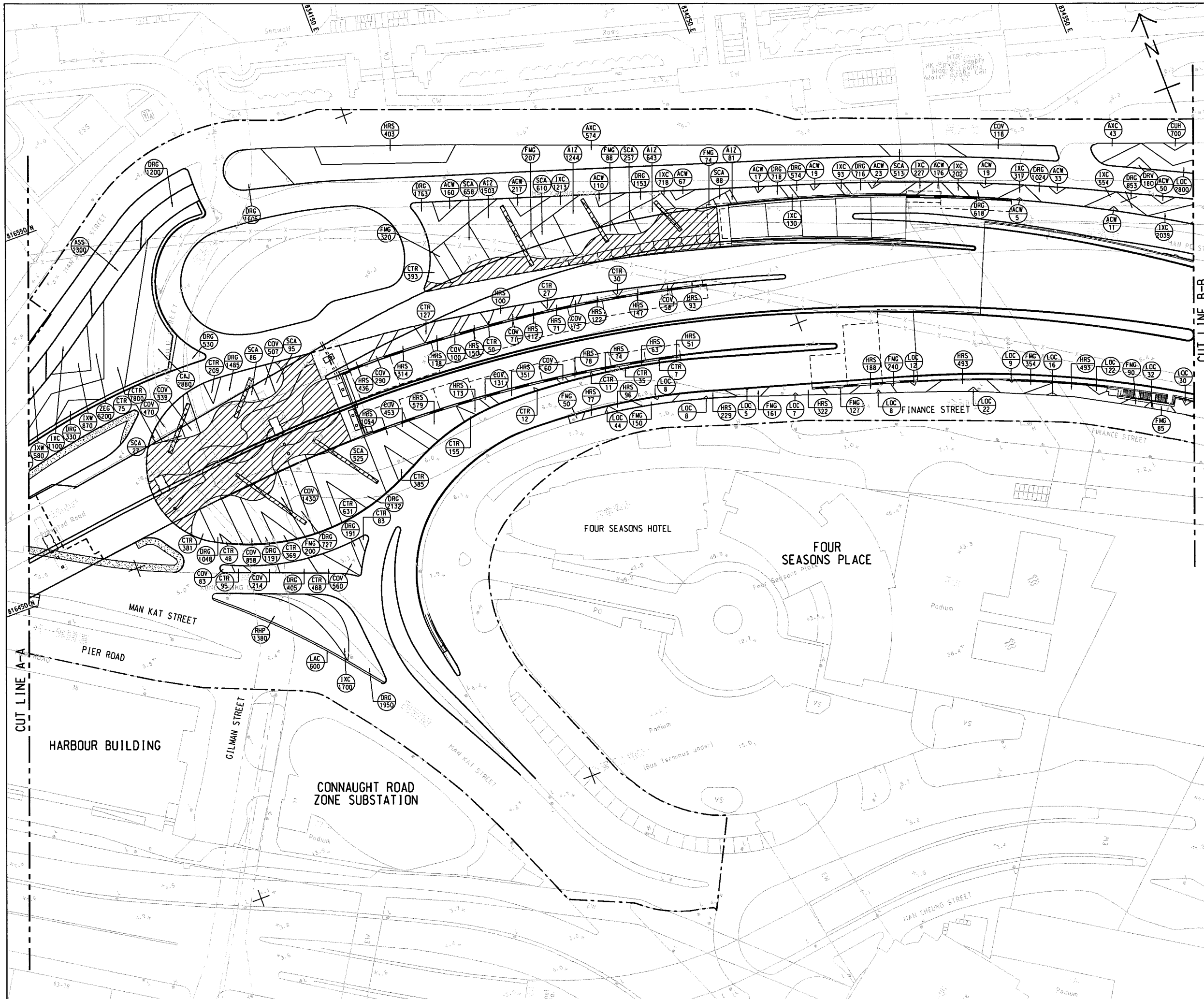

KEY PLAN
SCALE A1 : 2000
A3 : 4000

NOTE:
1. FOR NOTES AND LEGEND SEE DRG. NO. 60095653/CI/9051.

B	AS-BUILT DRAWING	NC	RY	APR 18
A	WORKING DRAWING	ACHAN	BCC	OCT 10
-	TENDER DRAWING	ACHAN	BCC	MAR 10
REV. NO.	DESCRIPTION	DATE	BY	CHK

Highways Department 路政署
Major Works Project Management Office

CENTRAL - WAN CHAI BYPASS AND IEC LINK

PWP ITEM NO. 579 TH
工務計劃項目編號

CENTRAL - WAN CHAI BYPASS - CENTRAL INTERCHANGE

SHRUB PLANTING PLAN
SHEET 2 OF 3



DRG. NO. 60095653/CI/9052B
圖紙編號

DESIGNED BY 設計	VLNK	CONTRACT NO. 合約編號	HY/2009/18	P. DIV. APPROVED 批核	CW
DRAWN BY 繪圖	WYP	STATUS 狀態	AS BUILT DRAWING		
SCALE 比例	A1 : 500 A3 : 1000	DIMENSIONS ARE IN METRES			
© COPYRIGHT RESERVED 版權所有					

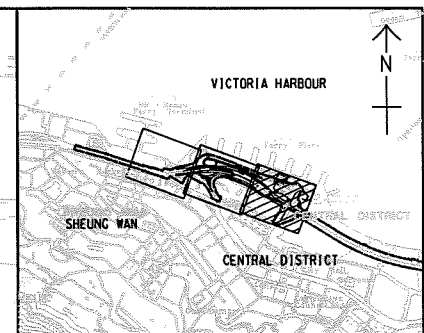
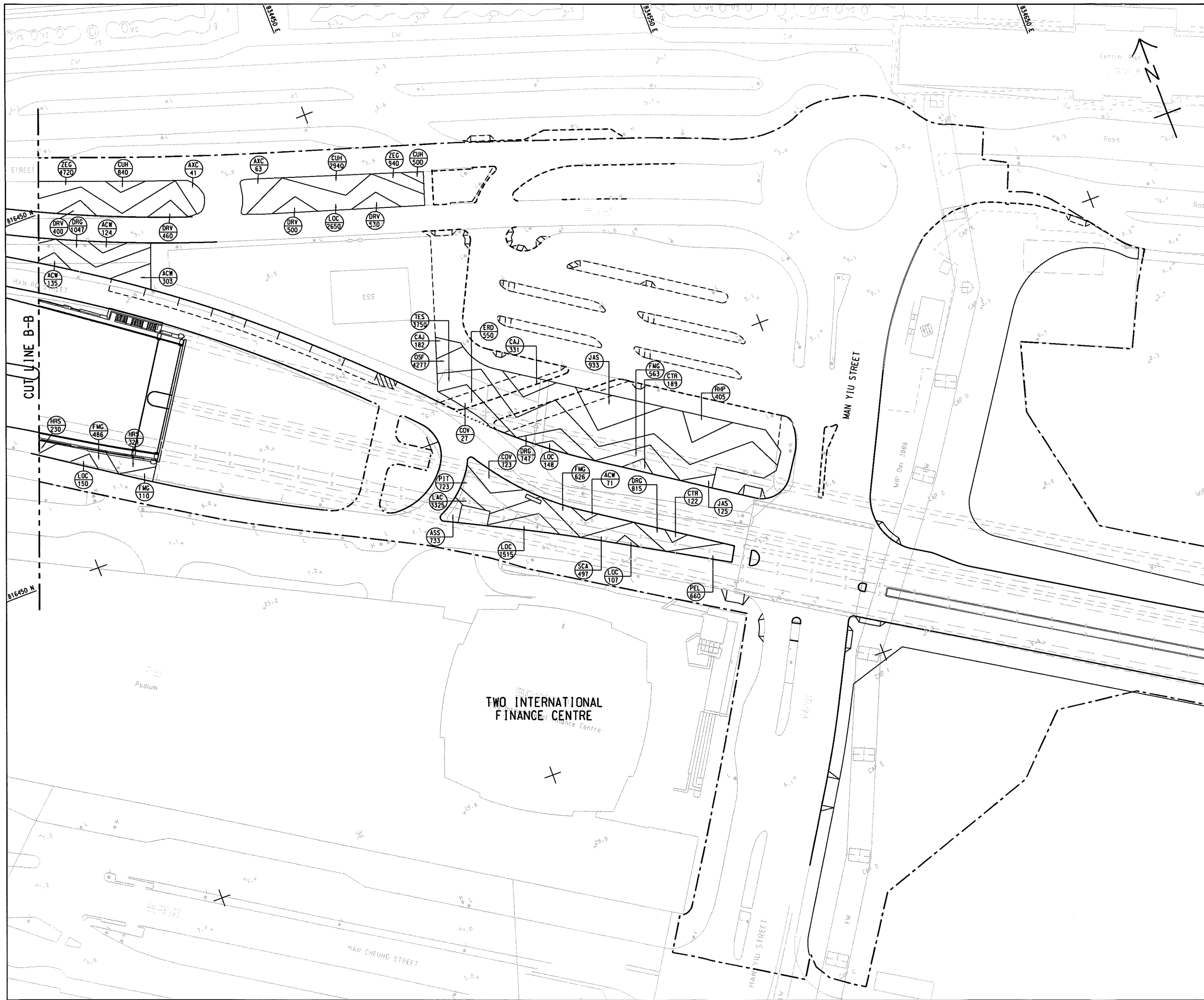

KEY PLAN
 SCALE A1 : 20000
 A3 : 40000

- NOTES:**
- FOR NOTES AND LEGEND SEE DRG. NO. 60095653/CI/9051.
 - THIS DRAWING SHOULD BE READ IN CONJUNCTION WITH DRAWING NOS. 60095653/CI/9051 AND 9052.
 - PUBLIC TRANSPORT INTERCHANGE (PTI) AND PAVEMENT AT MAN KWONG STREET AND MAN YIU STREET WAS CONSTRUCTED BY HYD'S TERM CONTRACTOR. THE CONTRACTOR SHOULD CO-ORDINATE WITH HYD'S TERM CONTRACTOR IN ORDER TO FACILITATE THE CONSTRUCTION WORK.

LEGEND:

--- WORKS WERE CONSTRUCTED BY OTHERS (HYD'S TERM CONTRACTOR)

B	AS-BUILT DRAWING	NC	RY	APR 18
A	WORKING DRAWING	ACHAN	BCC	OCT 10
-	TENDER DRAWING	ACHAN	BCC	APR 10
REV	DESCRIPTION	DATE	BY	CHKD

Highways Department 路政署
Major Works Project Management Office

CENTRAL - WAN CHAI BYPASS AND IEC LINK

PWP ITEM NO. 579 TH
 工務計劃項目編號

CENTRAL - WAN CHAI BYPASS - CENTRAL INTERCHANGE

SHRUB PLANTING PLAN
 SHEET 3 OF 3

AECOM

DRG. NO. 60095653/CI/9053B
 圖紙編號

DESIGNED BY	VLNK	CONTRACT NO.	HY/2009/18	P. DIR. APPROVED	CM
DRAWN BY	LJ	STATUS	AS BUILT DRAWING		
SCALE	A1 : 500 A3 : 1000	DIMENSIONS ARE IN METRES			

© COPYRIGHT RESERVED
 版權所有

DRG. NO. 60095653/CI/9053/3/01 (18/04/18)

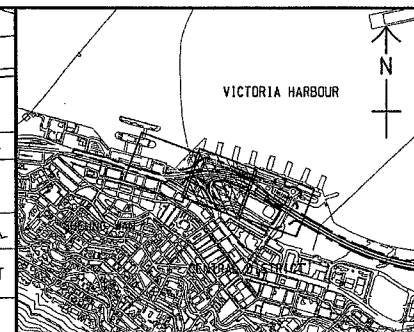
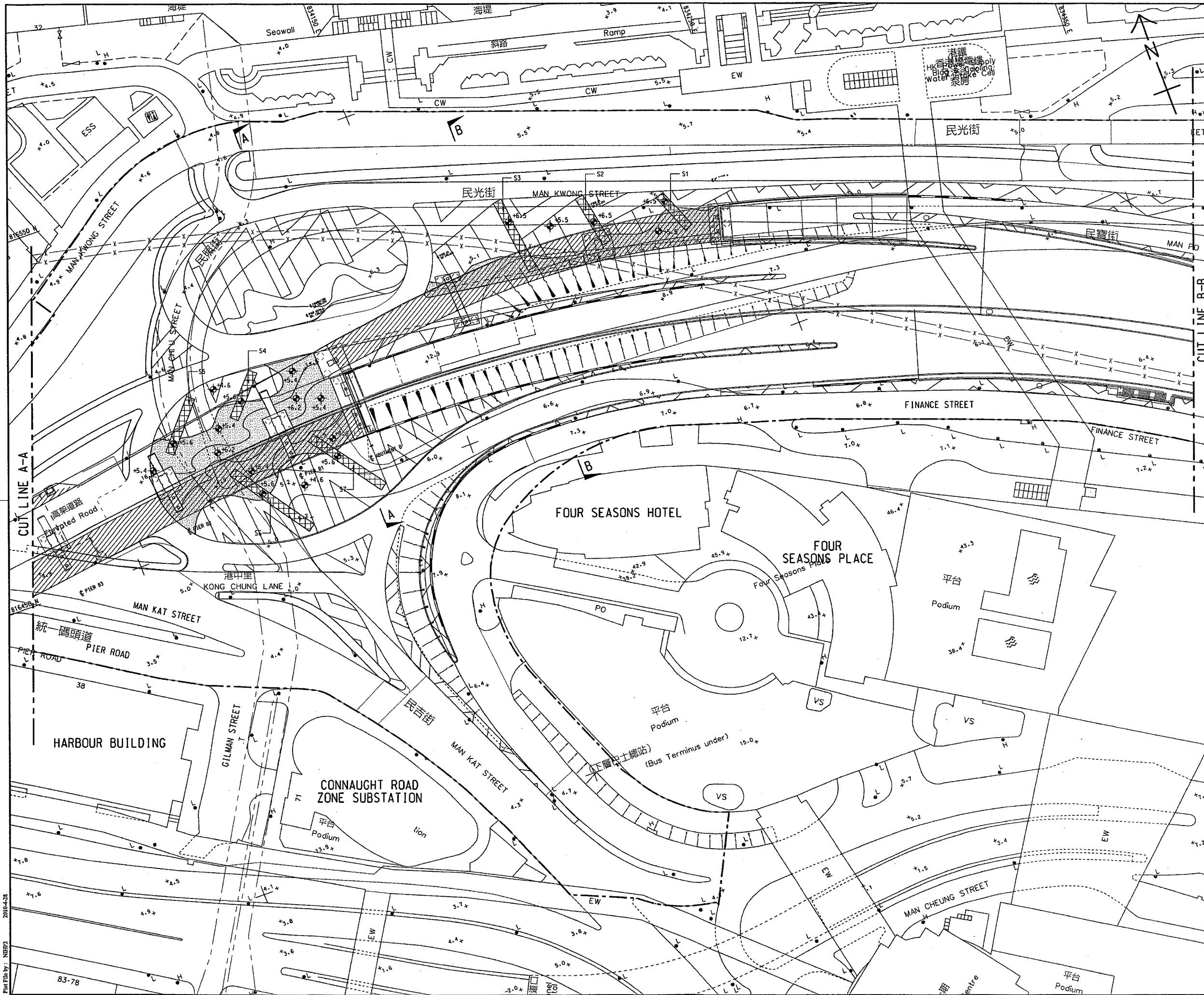

KEY PLAN
SCALE A1 1 : 20000
A3 1 : 40000

- NOTES:**
1. ALL LEVELS ARE IN METRES AND REFER TO PRINCIPAL DATUM.
 2. FOR SECTIONS REFER TO DRAWING NO. 60095653/CI/9041.
 3. DETAILS OF THE LANDSCAPE FEATURES AND STONE FACING FINISHING REFER TO DRAWING NO. 60095653/CI/9042.
 4. SIZES OF LANDSCAPE FEATURES
S1 11L x 1W x 1H
S2 14L x 1W x 1H
S3 19L x 1W x 1H
S4 13L x 1W x 1H
S5 15L x 1W x 1H
S6 24L x 1W x 1H
S7 22L x 1W x 1H

- LEGEND:**
- [Cross-hatched symbol] LANDSCAPE FEATURE S1 TO S7
 - [Stippled symbol] STONE FACING FINISHING

A	WORKING DRAWING	ASIAN SEC	OCT 10
-	TENDER DRAWING	ACHA SEC	APR 10
REV.	DESCRIPTION	DATE	DATE

Highways Department 路政署
Major Works Project Management Office

CENTRAL - WAN CHAI BYPASS AND IEC LINK

PWP ITEM NO. 579 TH
工務計劃項目編號

CENTRAL - WAN CHAI BYPASS - CENTRAL INTERCHANGE

HARD LANDSCAPE PLAN

AECOM

DRG.NO. 60095653/CI/9031A
圖紙編號

DESIGNED BY VLWK	CONTRACT NO. HY/2009/18	APPROVED BY CW
---------------------	----------------------------	-------------------

SCALE A1 1 : 500
A3 1 : 1000
DIMENSIONS ARE IN METRES

WORKING DRAWING

© COPYRIGHT RESERVED
版權所有

2010-4-28
Plot File by: NHP2