

Environmental Permit
No.:EP-324/2008/E

環境許可證編
號:EP-324/2008/E



Project:

Widening of Tolo
Highway/Fanling Highway
between Island House
Interchange and Fanling

Title:

Proposed Location of
Proposed-Built Noise Barrier
During Construction

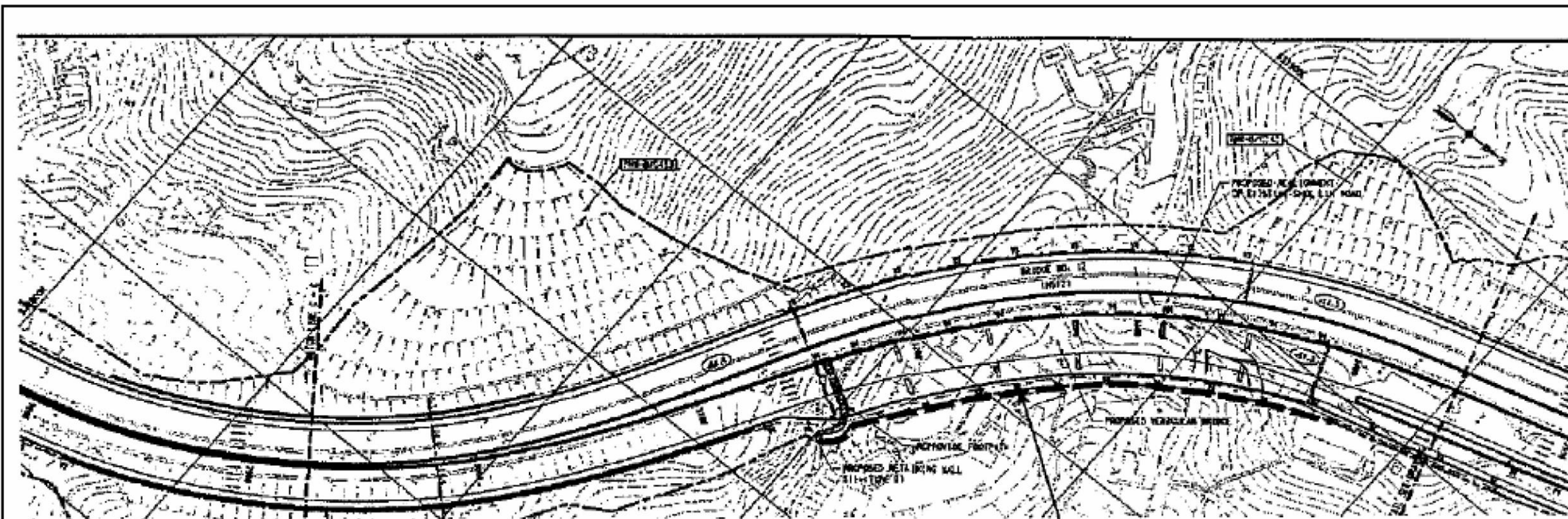

**3 m high vertical barrier at ground level for bridge foundation and substructure &
2 m high vertical barrier at bridge level for bridge superstructure work**

Figure 2b
圖二 b