

**Maunsell** in association with  
 WHA, DLN,  
 EHS, MEMCL, MGS

YAU TONG BAY DEVELOPMENT  
 ENVIRONMENTAL IMPACT ASSESSMENT STUDY  
 LOCATION OF DISSENTING LOTS

<b>MAIN WEALTH DEVELOPMENT LIMITED</b>	
Scale: 1 3000	Code Ref: 94697/01/1/q3.1.dgn
Date: DEC 00	Figure No: <b>FIG 31</b>

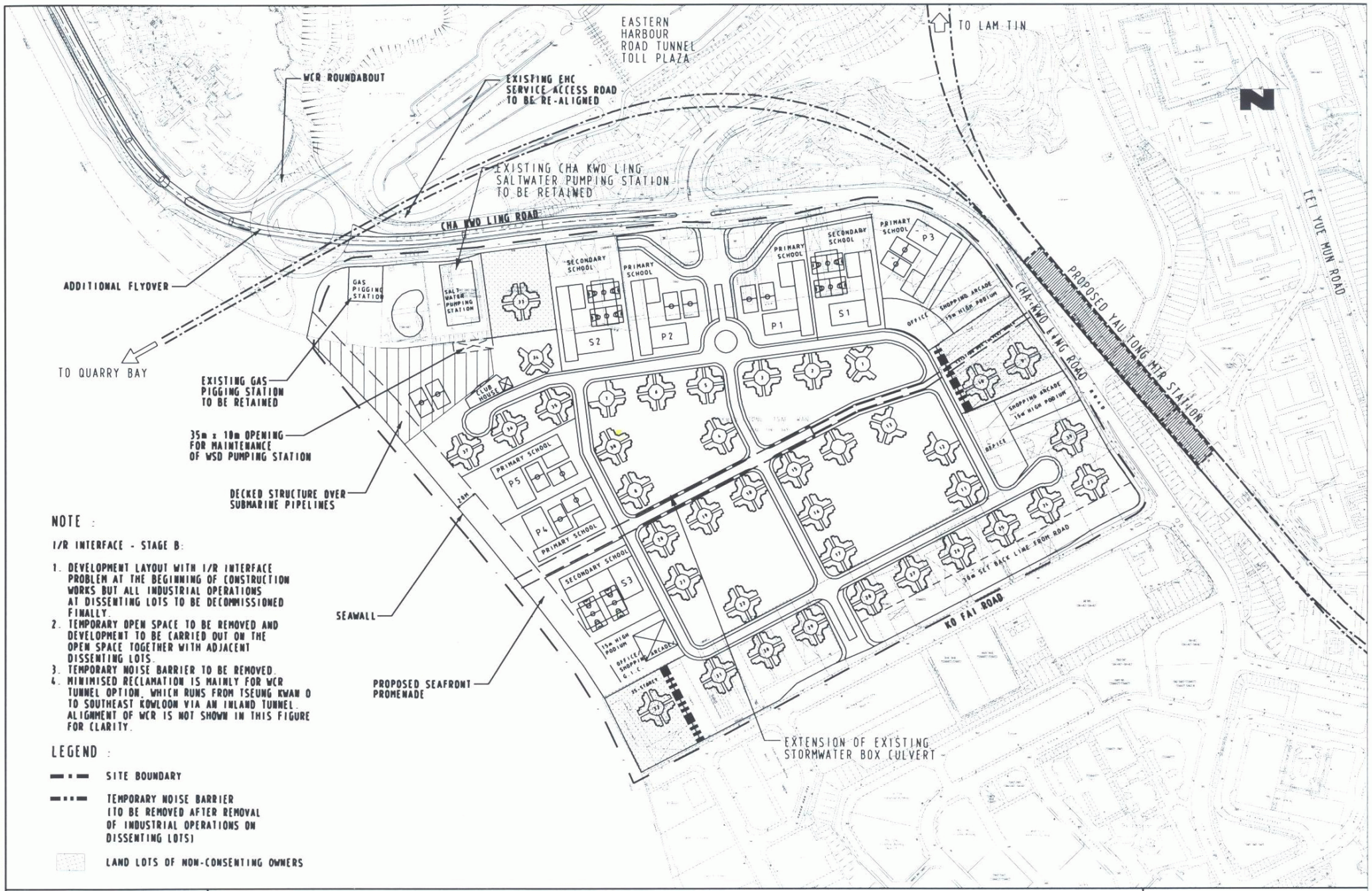

**NOTE :**

**1/R INTERFACE - STAGE B:**

1. DEVELOPMENT LAYOUT WITH 1/R INTERFACE PROBLEM AT THE BEGINNING OF CONSTRUCTION WORKS BUT ALL INDUSTRIAL OPERATIONS AT DISSSENTING LOTS TO BE DECOMMISSIONED FINALLY.
2. TEMPORARY OPEN SPACE TO BE REMOVED AND DEVELOPMENT TO BE CARRIED OUT ON THE OPEN SPACE TOGETHER WITH ADJACENT DISSSENTING LOTS.
3. TEMPORARY NOISE BARRIER TO BE REMOVED.
4. MINIMISED RECLAMATION IS MAINLY FOR WCR TUNNEL OPTION, WHICH RUNS FROM TSEUNG KWAN O TO SOUTHEAST KOWLOON VIA AN INLAND TUNNEL. ALIGNMENT OF WCR IS NOT SHOWN IN THIS FIGURE FOR CLARITY.

**LEGEND :**

- SITE BOUNDARY
- TEMPORARY NOISE BARRIER (TO BE REMOVED AFTER REMOVAL OF INDUSTRIAL OPERATIONS ON DISSSENTING LOTS)
- LAND LOTS OF NON-CONSENTING OWNERS

**Maunsell** in association with  
 WHA, DLN,  
 EHS, MEMCL, MGS

YAU TONG BAY DEVELOPMENT  
 ENVIRONMENTAL IMPACT ASSESSMENT STUDY  
 LAYOUT PLAN (MINIMISED RECLAMATION WITH 1/R INTERFACE STAGE B)

MAIN WEALTH DEVELOPMENT LIMITED	
Scale 1 : 3000	Cont. No. Ma017/01/02/1/ig) 2.dgn
Date SEP 01	Figure No. FIG 3.2

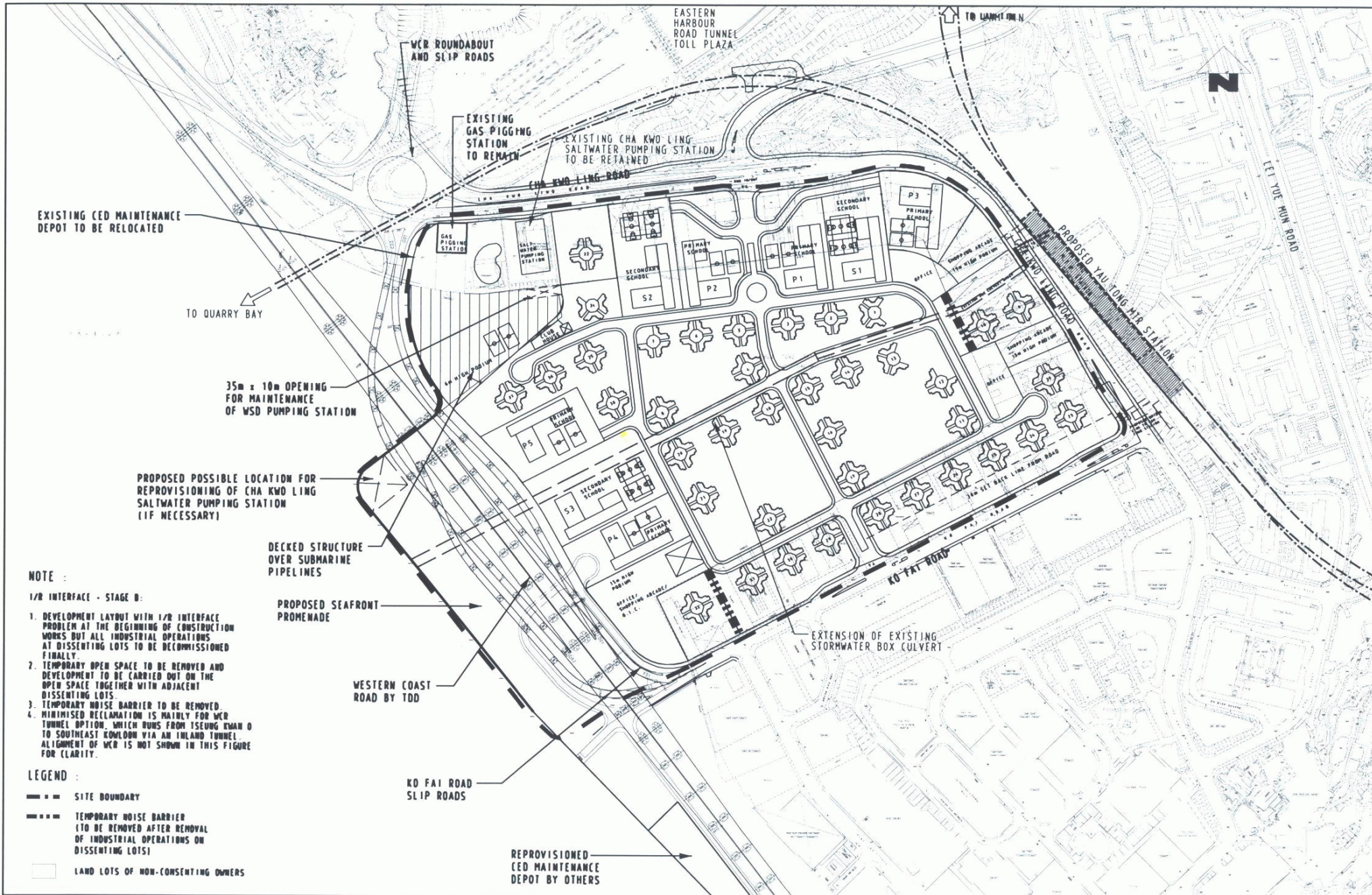

**NOTE :**

**1/R INTERFACE - STAGE B:**

1. DEVELOPMENT LAYOUT WITH 1/R INTERFACE PROBLEM AT THE BEGINNING OF CONSTRUCTION WORKS BUT ALL INDUSTRIAL OPERATIONS AT DISSIDENTING LOTS TO BE DECOMMISSIONED FINALLY.
2. TEMPORARY OPEN SPACE TO BE REMOVED AND DEVELOPMENT TO BE CARRIED OUT ON THE OPEN SPACE TOGETHER WITH ADJACENT DISSIDENTING LOTS.
3. TEMPORARY NOISE BARRIER TO BE REMOVED.
4. MINIMISED RECLAMATION IS MAINLY FOR WCR TUNNEL OPTION, WHICH RUNS FROM TSEUNG KWAN O TO SOUTHEAST KOWLOON VIA AN INLAND TUNNEL ALIGNMENT OF WCR IS NOT SHOWN IN THIS FIGURE FOR CLARITY.

**LEGEND :**

- — — SITE BOUNDARY
- · — · — TEMPORARY NOISE BARRIER (TO BE REMOVED AFTER REMOVAL OF INDUSTRIAL OPERATIONS ON DISSIDENTING LOTS)
- LAND LOTS OF NON-CONSENTING OWNERS

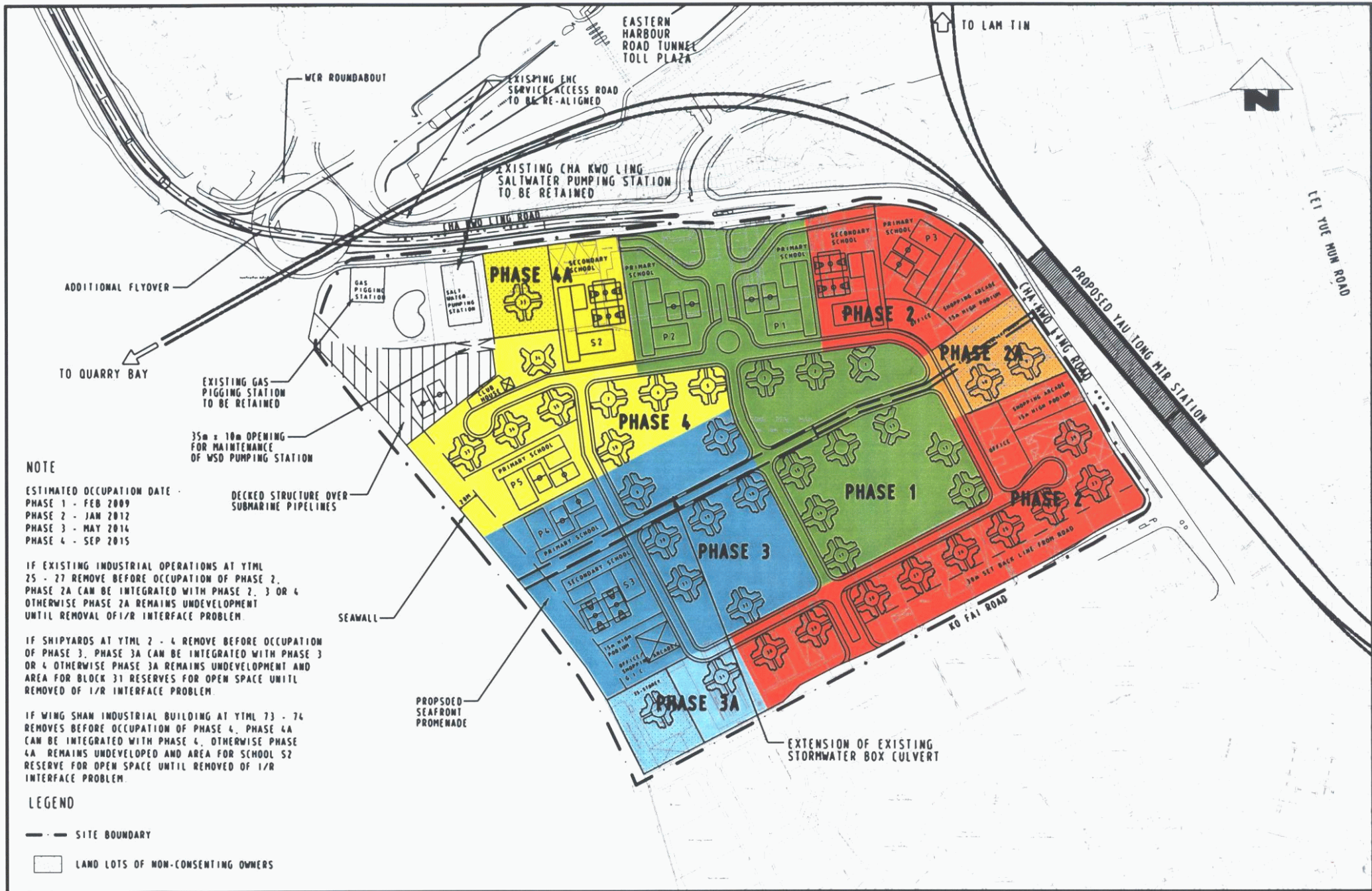

ADDITIONAL FLYOVER

TO QUARRY BAY

EXISTING GAS PIGGING STATION TO BE RETAINED  
 35m x 10m OPENING FOR MAINTENANCE OF WSD PUMPING STATION

DECKED STRUCTURE OVER SUBMARINE PIPELINES

SEAWALL

PROPOSED SEAFRONT PROMENADE

EXTENSION OF EXISTING STORMWATER BOX (CULVERT)

TO LAM TIN



CEI YUE HUN ROAD

PROPOSED YAU TONG H/R STATION  
 CHA KWO LING ROAD

KO FAI ROAD  
 300 SET BACK LINE FROM ROAD

**NOTE**

ESTIMATED OCCUPATION DATE  
 PHASE 1 - FEB 2009  
 PHASE 2 - JAN 2012  
 PHASE 3 - MAY 2014  
 PHASE 4 - SEP 2015

IF EXISTING INDUSTRIAL OPERATIONS AT YTM 25 - 27 REMOVE BEFORE OCCUPATION OF PHASE 2. PHASE 2A CAN BE INTEGRATED WITH PHASE 2, 3 OR 4 OTHERWISE PHASE 2A REMAINS UNDEVELOPMENT UNTIL REMOVAL OF I/R INTERFACE PROBLEM

IF SHIPYARDS AT YTM 2 - 4 REMOVE BEFORE OCCUPATION OF PHASE 3. PHASE 3A CAN BE INTEGRATED WITH PHASE 3 OR 4 OTHERWISE PHASE 3A REMAINS UNDEVELOPMENT AND AREA FOR BLOCK 31 RESERVES FOR OPEN SPACE UNTIL REMOVED OF I/R INTERFACE PROBLEM

IF WING SHAM INDUSTRIAL BUILDING AT YTM 73 - 74 REMOVES BEFORE OCCUPATION OF PHASE 4. PHASE 4A CAN BE INTEGRATED WITH PHASE 4, OTHERWISE PHASE 4A REMAINS UNDEVELOPED AND AREA FOR SCHOOL S2 RESERVE FOR OPEN SPACE UNTIL REMOVED OF I/R INTERFACE PROBLEM

**LEGEND**

- SITE BOUNDARY
- LAND LOTS OF NON-CONSENTING OWNERS

**Maunsell** in association with  
 WHA, DLN,  
 EHS, MEMCL, MGS

YAU TONG BAY DEVELOPMENT  
 ENVIRONMENTAL IMPACT ASSESSMENT STUDY  
 PROVISIONAL DEVELOPMENT PHASING PLAN  
 (UNDER MINIMISED RECLAMATION WITH I/R INTERFACE)

MAIN WEALTH DEVELOPMENT LIMITED  
 Scale 1 : 3000  
 Date APR 01  
 FIG 3.4

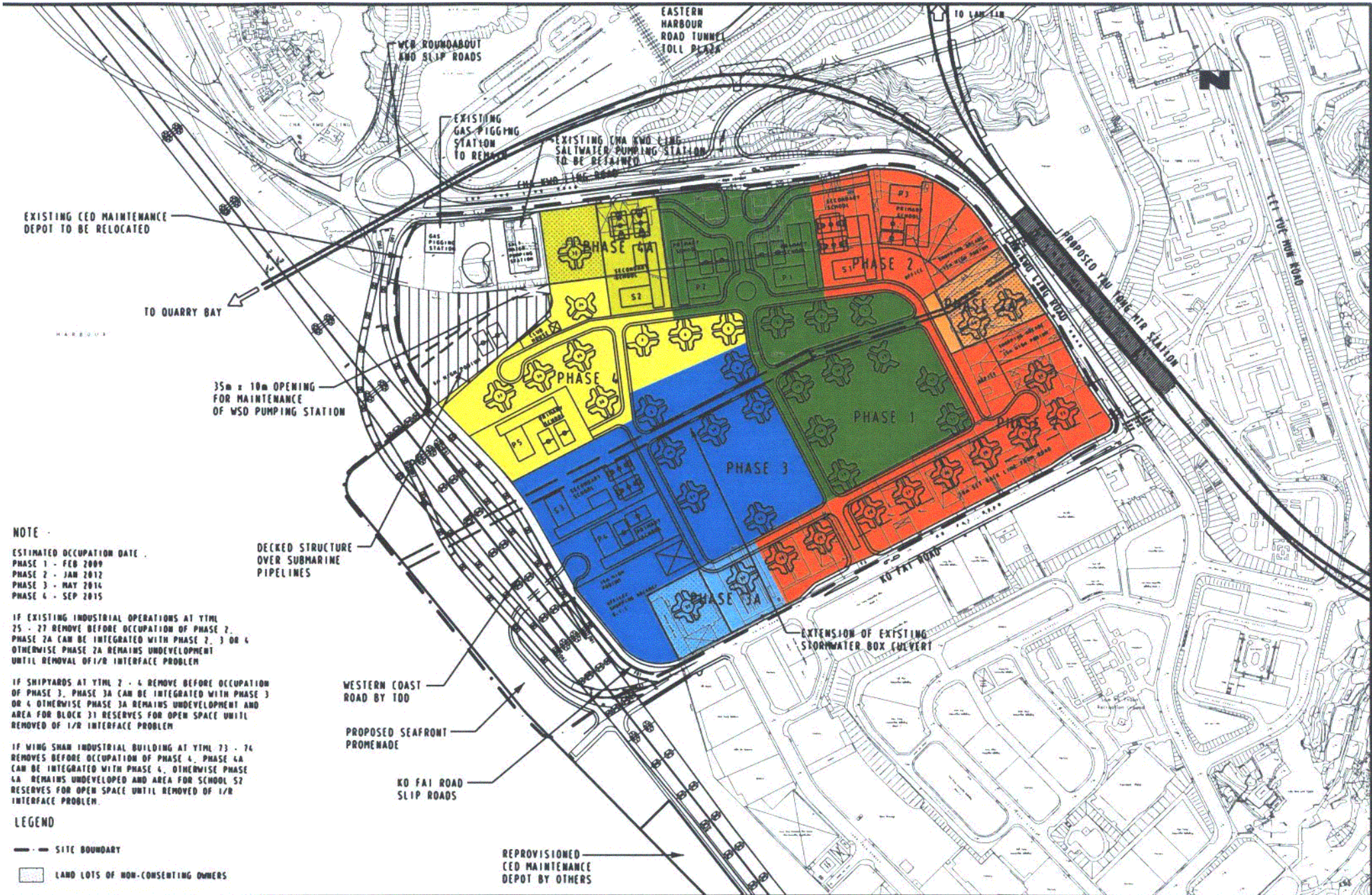

**NOTE**

- ESTIMATED OCCUPATION DATE
  - PHASE 1 - FEB 2009
  - PHASE 2 - JAN 2012
  - PHASE 3 - MAY 2014
  - PHASE 4 - SEP 2015
- IF EXISTING INDUSTRIAL OPERATIONS AT YTM 25 - 27 REMOVE BEFORE OCCUPATION OF PHASE 2, PHASE 2A CAN BE INTEGRATED WITH PHASE 2, 3 OR 4 OTHERWISE PHASE 2A REMAINS UNDEVELOPMENT UNTIL REMOVAL OF I/R INTERFACE PROBLEM
  - IF SHIPYARDS AT YTM 2 - 4 REMOVE BEFORE OCCUPATION OF PHASE 3, PHASE 3A CAN BE INTEGRATED WITH PHASE 3 OR 4 OTHERWISE PHASE 3A REMAINS UNDEVELOPMENT AND AREA FOR BLOCK 31 RESERVES FOR OPEN SPACE UNTIL REMOVED OF I/R INTERFACE PROBLEM
  - IF WING SHAN INDUSTRIAL BUILDING AT YTM 73 - 74 REMOVES BEFORE OCCUPATION OF PHASE 4, PHASE 4A CAN BE INTEGRATED WITH PHASE 4, OTHERWISE PHASE 4A REMAINS UNDEVELOPED AND AREA FOR SCHOOL S2 RESERVES FOR OPEN SPACE UNTIL REMOVED OF I/R INTERFACE PROBLEM.

**LEGEND**

- SITE BOUNDARY
- LAND LOTS OF NON-CONSENTING OWNERS

**Wauhsell** in association with  
 #HA, DLN,  
 #HS, MEMCL, MGS

**YAU TONG BAY DEVELOPMENT**  
 ENVIRONMENTAL IMPACT ASSESSMENT STUDY  
 PROVISIONAL DEVELOPMENT PHASING PLAN (UNDER FULL RECLAMATION WITH I/R INTERFACE)

<b>MAIN WEALTH DEVELOPMENT LIMITED</b>	
Scale	1 : 3500
Date	APR 01
Figure No.	FIG 3.5



(842570,817880)

Podium  
+13.0mPD

841700,817250)

**Maunsell** in association with  
WHA, DLN,  
EHS, MEMCL, MGS

YAU TONG BAY DEVELOPMENT  
ENVIRONMENT IMPACT ASSESSMENT STUDY  
CUMULATIVE DAILY AVERAGE TOTAL SUSPENDED PARTICULATES CONCENTRATION AT PODIUM ( $\mu\text{g}/\text{m}^3$ )

MAIN WEALTH DEVELOPMENT LIMITED  
Scale: NTS  
Date: JAN 02  
Rev. No: 04/07/01/2/fig. 3.6  
FIG 3.6



(842570,817880)

1/F  
+18.0mPD

(841700,817250)

**Maunsell** in association with  
WHA, DLN,  
EHS, MEMCL, MGS

YAU TONG BAY DEVELOPMENT  
ENVIRONMENT IMPACT ASSESSMENT STUDY  
CUMULATIVE DAILY AVERAGE TOTAL SUSPENDED PARTICULATES CONCENTRATION AT 1/F FLOOR ( $\mu\text{g}/\text{m}^3$ )

MAIN WEALTH DEVELOPMENT LIMITED  
Scale: NTS  
Date: JAN 02  
Cod Ref: 96092/01/fig3.0.dgn  
Figure No: FIG 3.7



(842570,817880)

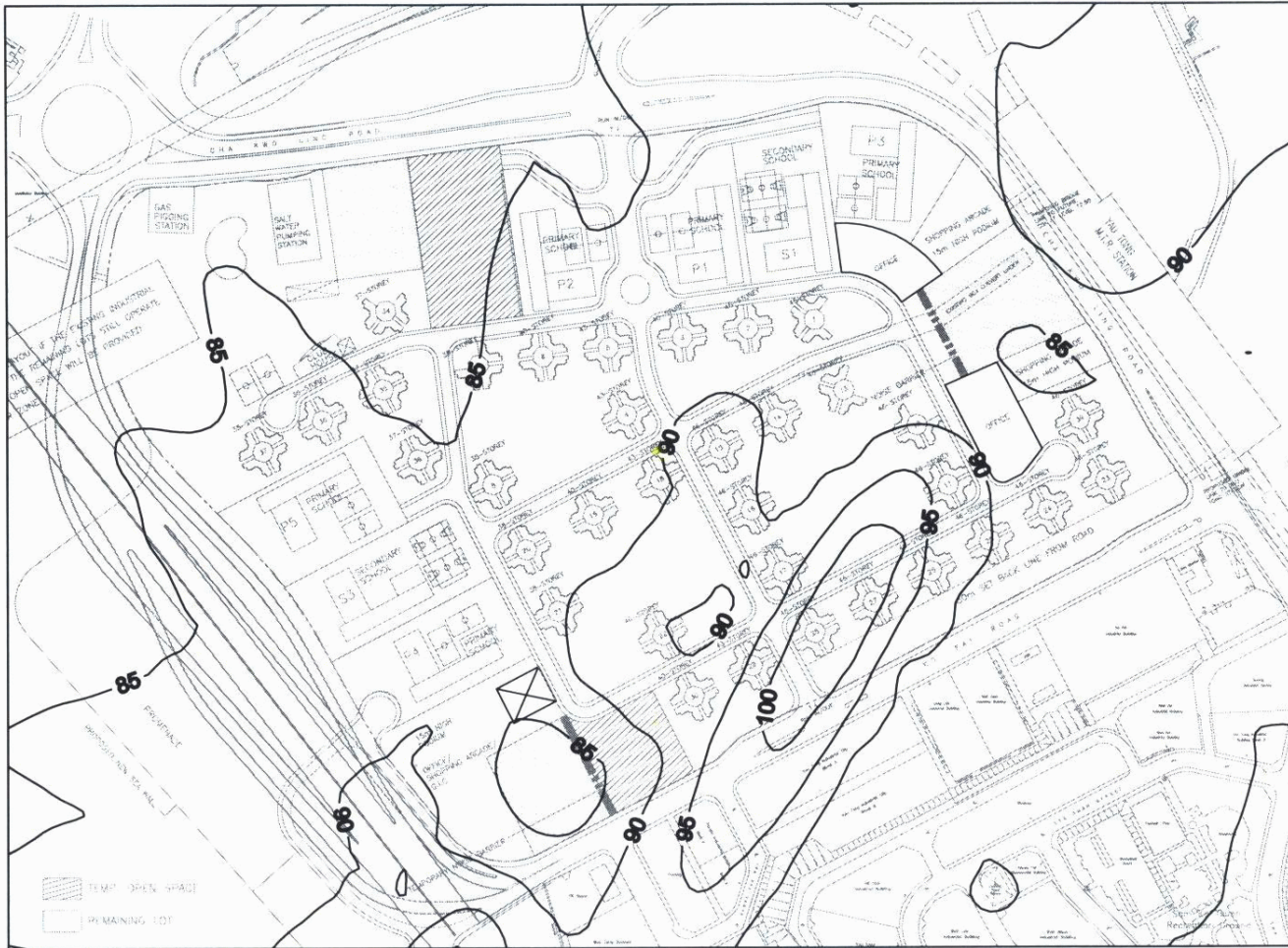

4/F  
26.4mPD

(841700,817250)

**Maunsell** in association with  
WHA, DLN,  
EHS, MEMCL, MGS

YAU TONG BAY DEVELOPMENT  
ENVIRONMENT IMPACT ASSESSMENT STUDY  
CUMULATIVE DAILY AVERAGE TOTAL SUSPENDED PARTICULATES CONCENTRATION AT 4F FLOOR ( $\mu\text{g}/\text{m}^3$ )

MAIN WEALTH DEVELOPMENT LIMITED	
Scale	NTS
Date	JAN 02
Code Ref.	842570/817/fig. 3.dwg
Figure No.	FIG 3.8



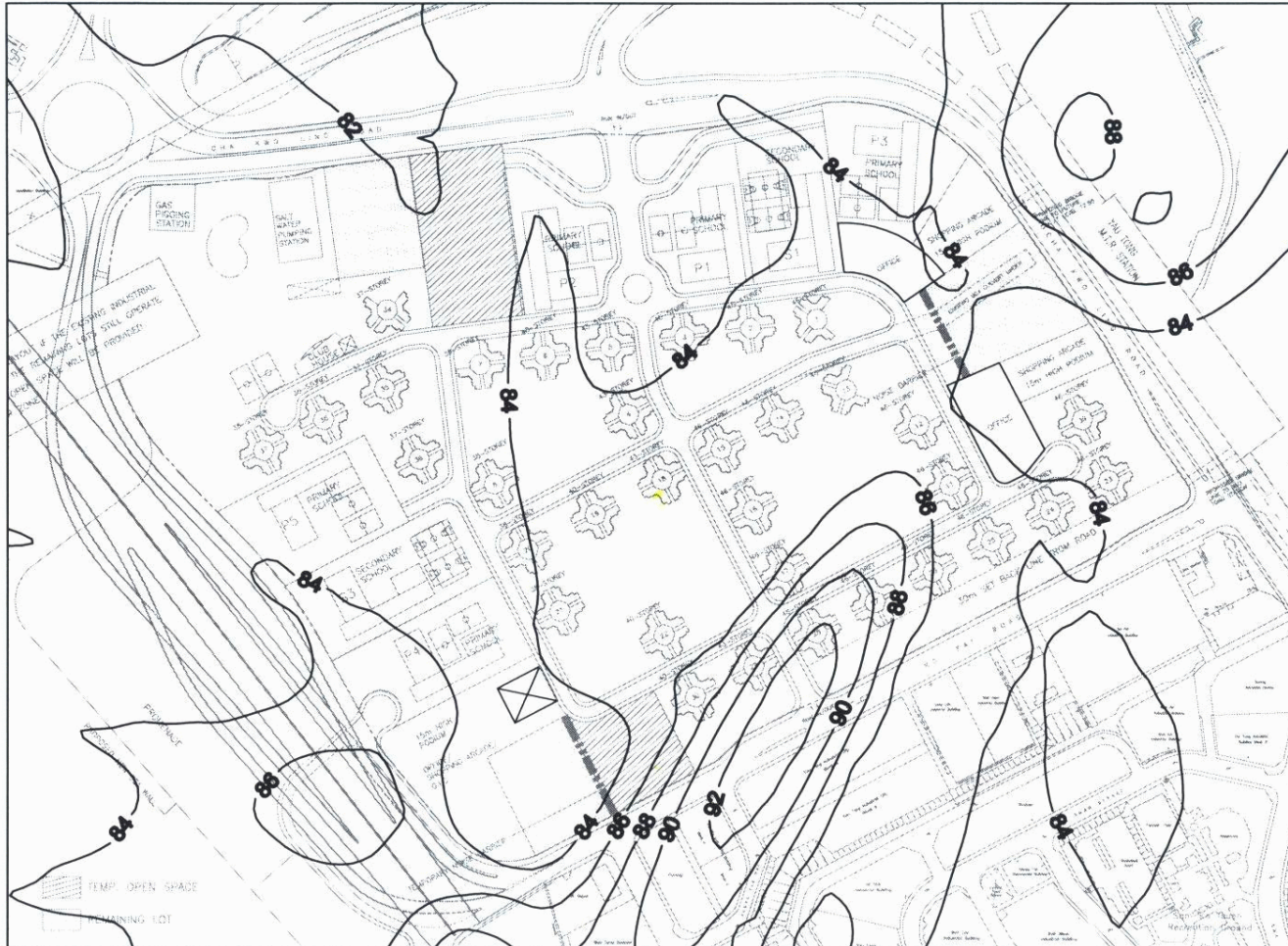

(842570,817880)

7/F  
+34.8mPD

(841700,817250)

**Maunsell** in association with  
WHA, DLN,  
EHS, MEMCL, MGS

YAU TONG BAY DEVELOPMENT  
ENVIRONMENTAL IMPACT ASSESSMENT STUDY  
CUMULATIVE DAILY AVERAGE TOTAL SUSPENDED PARTICULATES CONCENTRATION AT 7/F FLOOR ( $\mu\text{g}/\text{m}^3$ )

MAIN WEALTH DEVELOPMENT LIMITED	
Scale	NTS
Date	JAN 02
Fig. No.	FIG 3.9



(842570,817880)

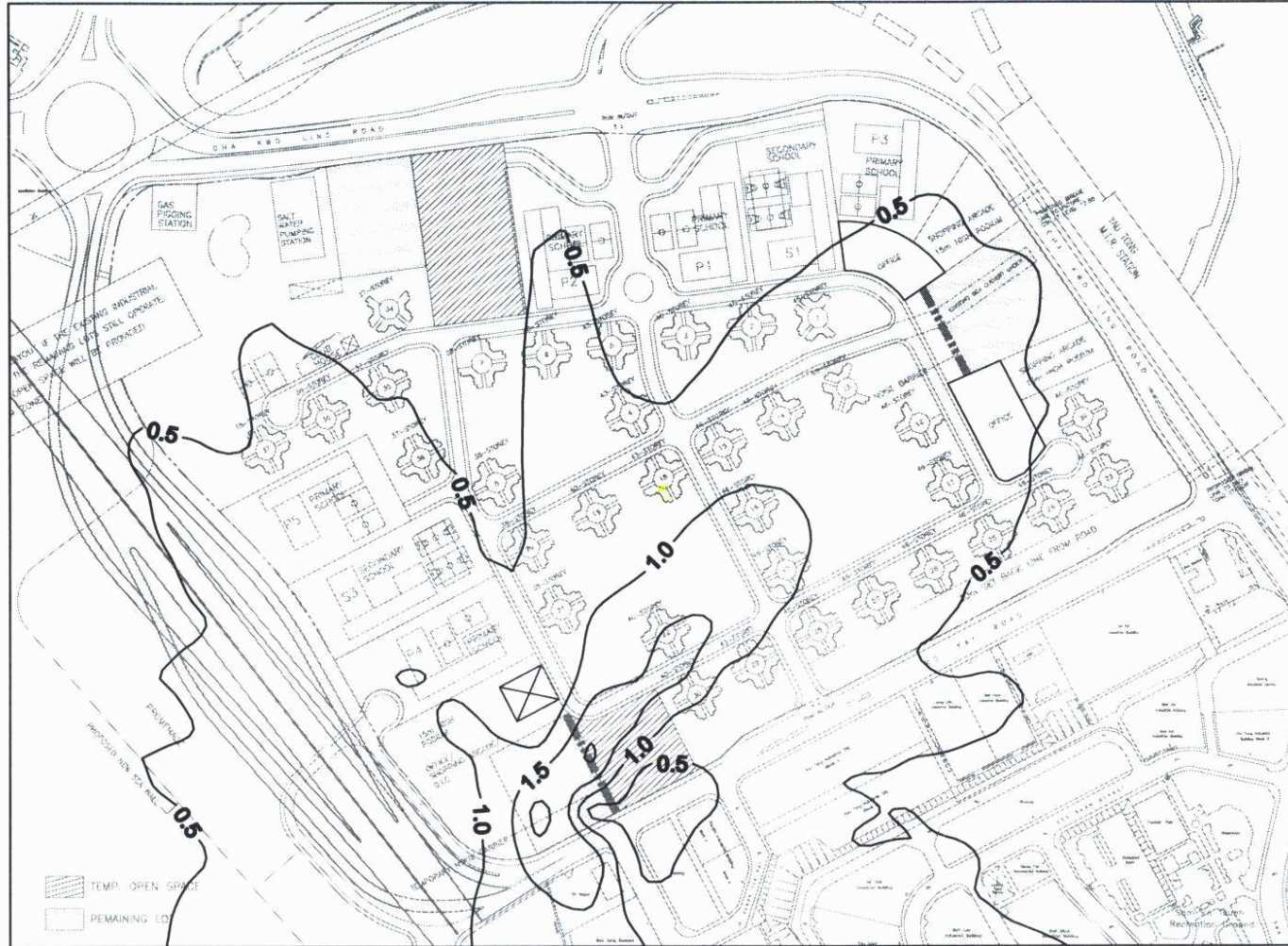

Podium  
+13.0mPD

(841700,817250)

**Maunsell** in association with  
WHA, DLN,  
EHS, MEMCL, MGS

YAU TONG BAY DEVELOPMENT  
ENVIRONMENT IMPACT ASSESSMENT STUDY  
PREDICTED DAILY AVERAGE XYLENE CONCENTRATION AT PODIUM ( $\mu\text{g}/\text{m}^3$ )

MAIN WEALTH DEVELOPMENT LIMITED	
State NTS	Code Ref 96697/01/fig3.0.dgn
Date JAN 02	Figure No. FIG 3.10



(842570,817880)

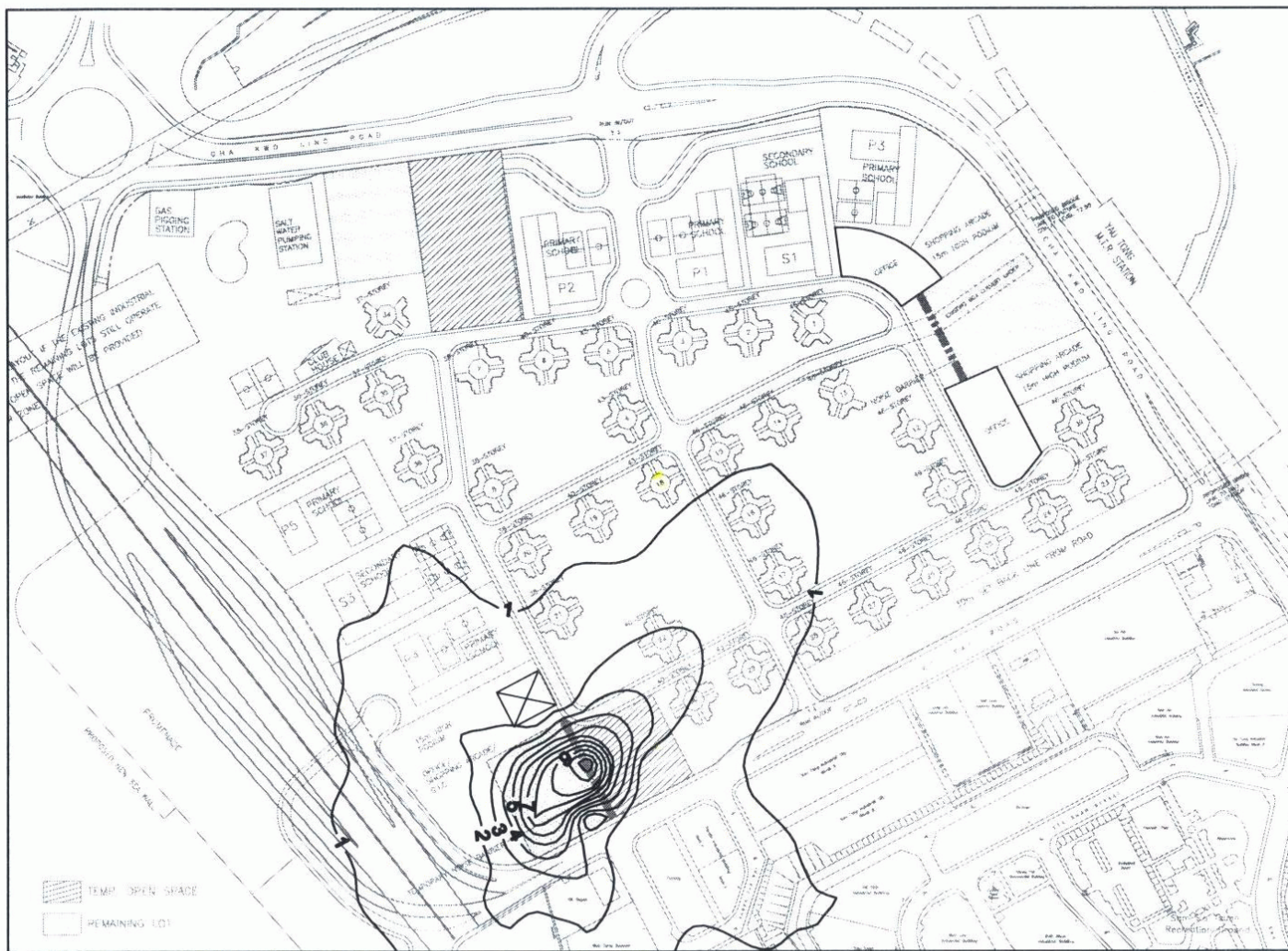

1/F  
+18.0mPD

(841700,817250)

**Maunsell** in association with  
 WHA, DLN,  
 EHS, MEMCL, MGS

YAU TONG BAY DEVELOPMENT  
 ENVIRONMENT IMPACT ASSESSMENT STUDY  
 PREDICTED DAILY AVERAGE XYLENE CONCENTRATION AT 1/F FLOOR ( $\mu\text{g}/\text{m}^3$ )

MAIN WEALTH DEVELOPMENT LIMITED	
Scale	Cad Ref. 06697/01/fig3.d.dwg
NTS	Figure No.
Date JAN 02	FIG 3.11



(842570,817880)

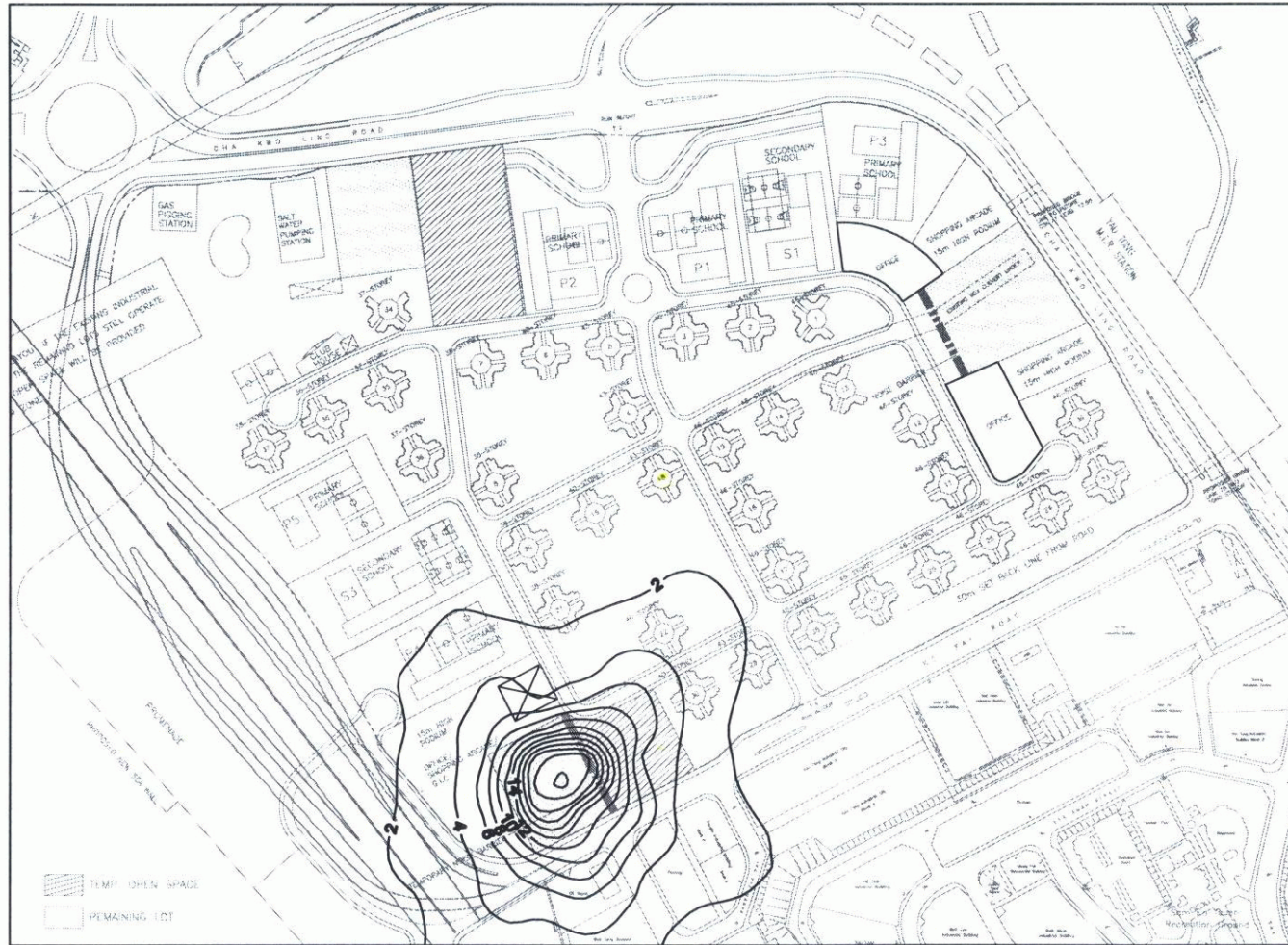

4/F  
26.4mPD

(841700,817250)

**Maunsell** in association with  
WHA, DLN,  
EHS, MEMCL, MGS

YAU TONG BAY DEVELOPMENT  
ENVIRONMENT IMPACT ASSESSMENT STUDY  
PREDICTED DAILY AVERAGE XYLENE CONCENTRATION AT 4/F FLOOR ( $\mu\text{g}/\text{m}^3$ )

MAIN WEALTH DEVELOPMENT LIMITED		
Scale	NTS	Code Ref: 94497/01/fig3.6.dwg
Date	JAN 02	Figure No. FIG 3.12

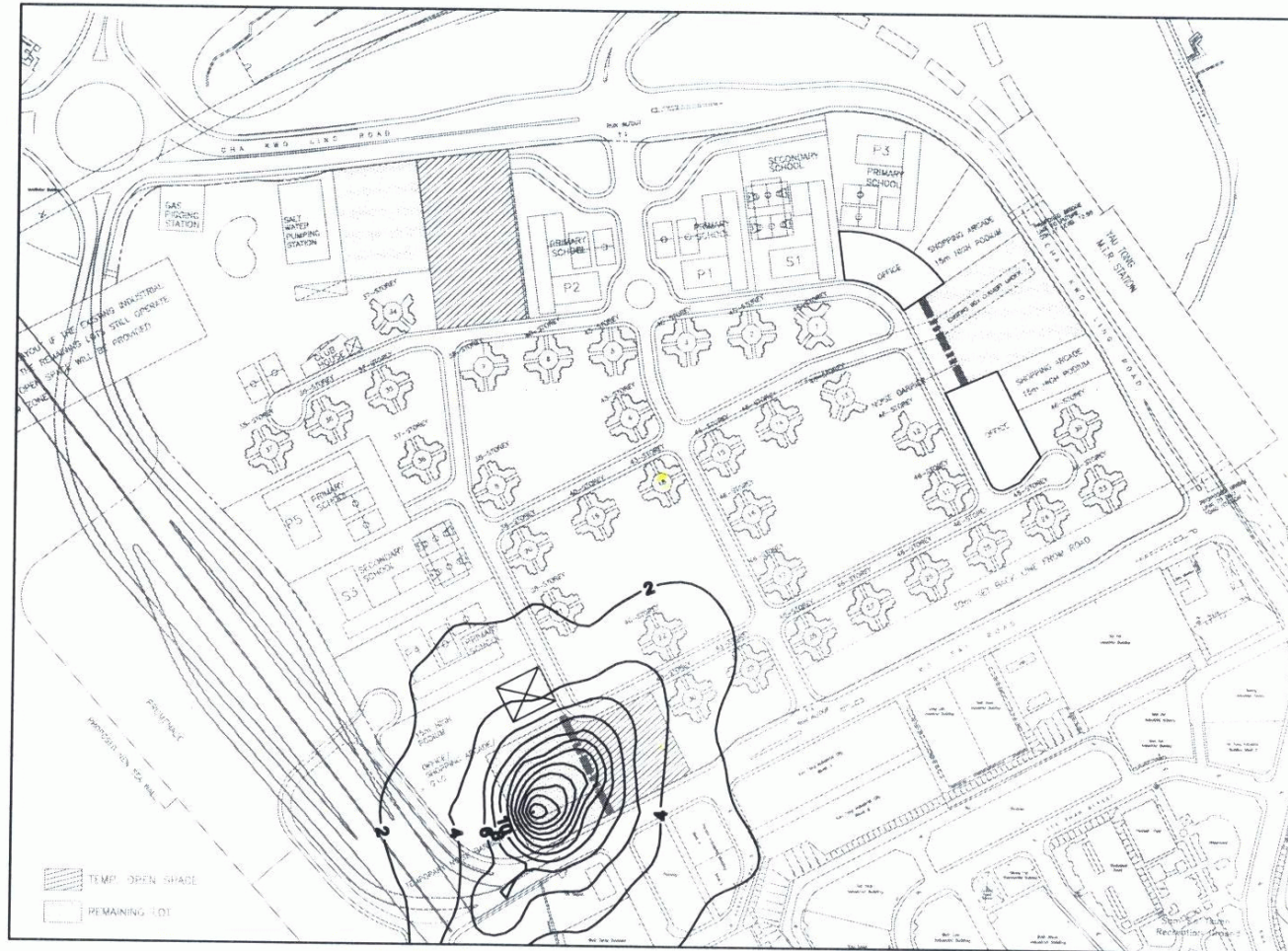

(842570,817880)

7/F  
+34.8mPD

841700,817250)

**Maunsell** in association  
with  
WHA, DLN,  
EHS, MEMCL, MGS

YAU TONG BAY DEVELOPMENT  
ENVIRONMENT IMPACT ASSESSMENT STUDY  
PREDICTED DAILY AVERAGE XYLENE CONCENTRATION AT 7/F FLOOR ( $\mu\text{g}/\text{m}^3$ )

MAIN WEALTH DEVELOPMENT LIMITED		
Scale	NTS	Cad Ref 94897/01/fig.3.6.dwg
Date	JAN 02	Figure No FIG 3.13

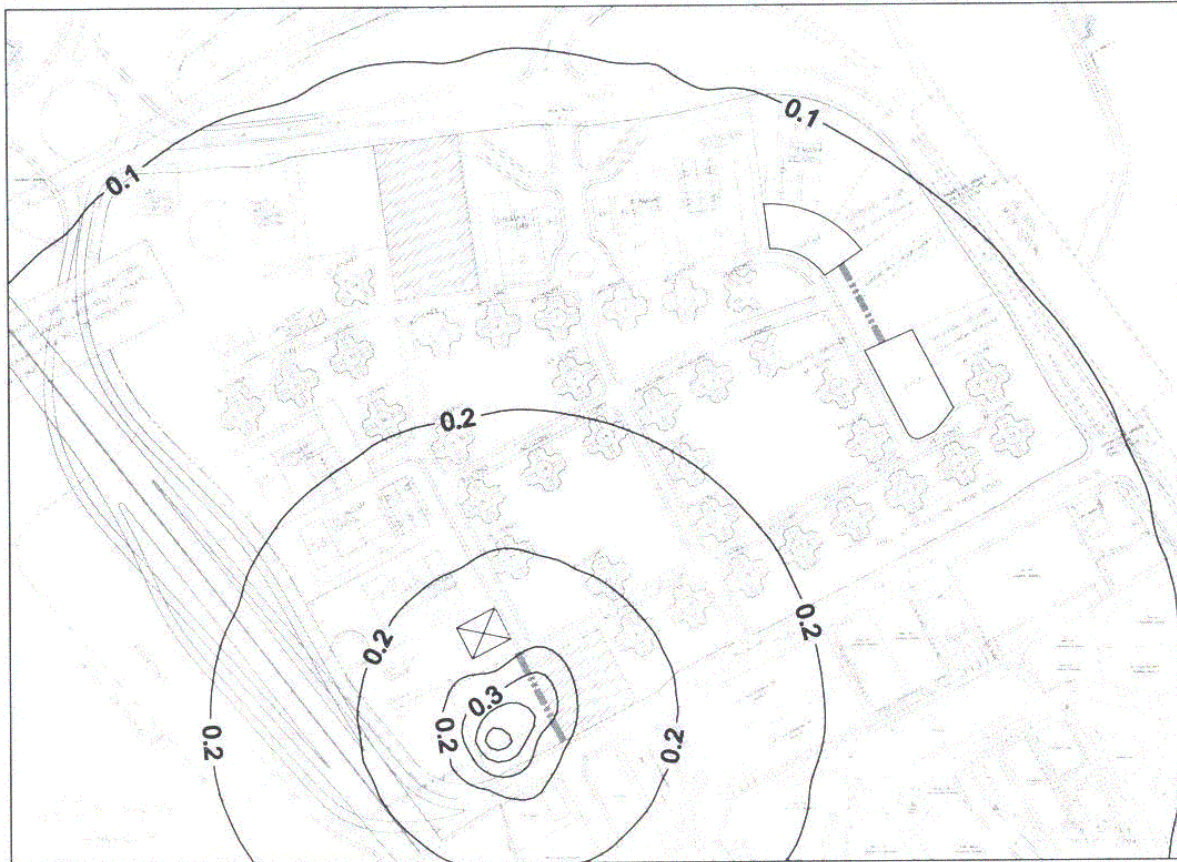

(842570,817880)

Podium  
+13.0mPD

(841700,817250)

**Maunsell** in association  
with  
WHA, DLN,  
EHS, MEMCL, MGS

YAU TONG BAY DEVELOPMENT  
ENVIRONMENTAL IMPACT ASSESSMENT STUDY  
PREDICTED 5 SECOND AVERAGE METHYL ISOBUTYL KETONE CONCENTRATION (OU) AT PODIUM

MAIN WEALTH DEVELOPMENT LIMITED	
Scale	NTS
Date	OCT 01
Code Ref:	94697/01/p2/fig.2b.dgn
Figure No.	FIG 3.14



(842570,817880)

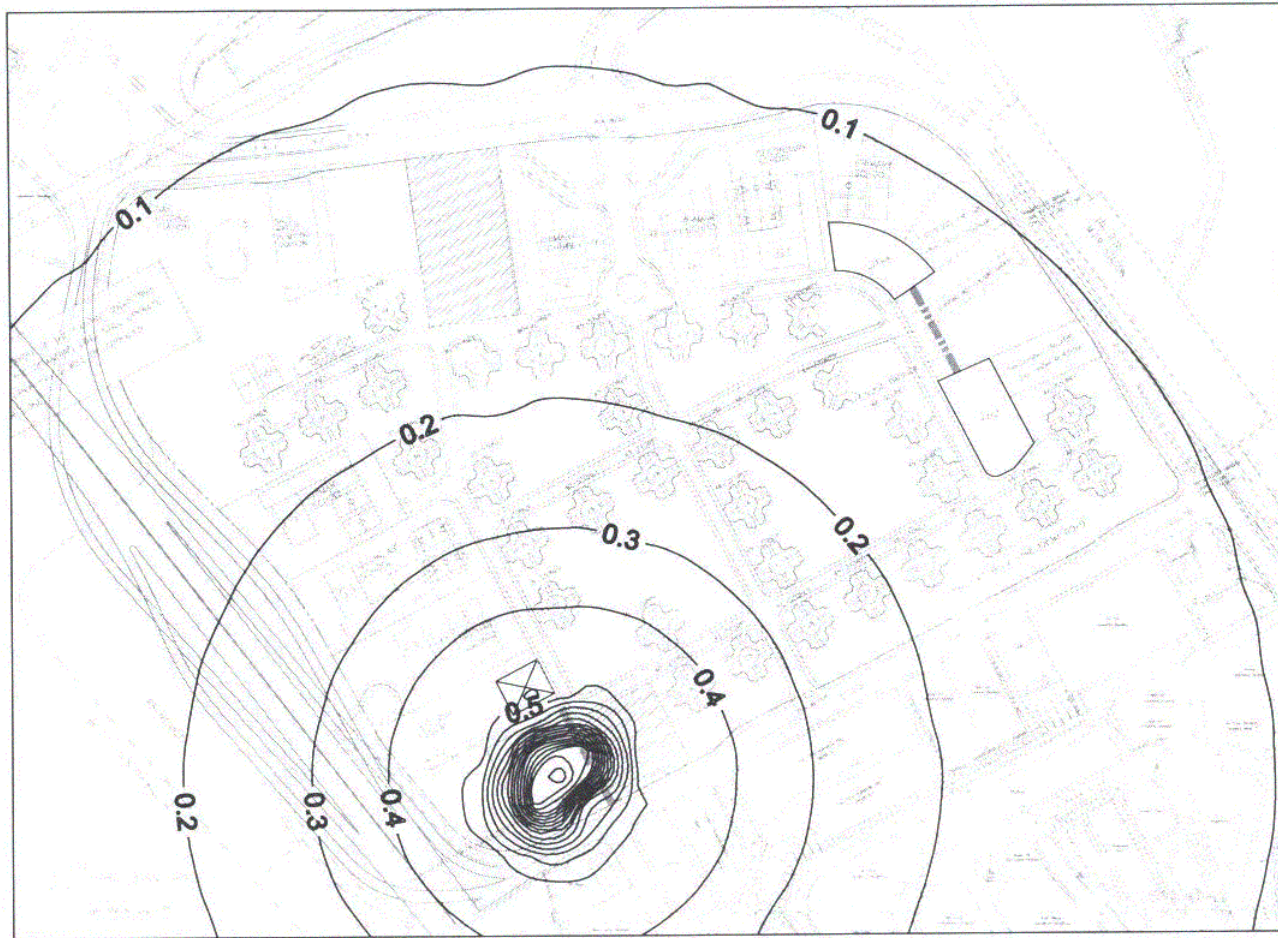

1/F  
+18.0mPD

(841700,817250)

**Maunsell** in association with  
WHA, DLN,  
EHS, MEMCL, MGS

YAU TONG BAY DEVELOPMENT  
ENVIRONMENTAL IMPACT ASSESSMENT STUDY  
PREDICTED 5 SECOND AVERAGE METHYL ISOBUTYL KETONE CONCENTRATION (OU) AT 1/F FLOOR

<b>MAIN WEALTH DEVELOPMENT LIMITED</b>	
Scale	NTS
Date	OCT 01
Cod Ref.	94697/01/p2/fig2.2b.dgn
Figure No.	FIG 3.15

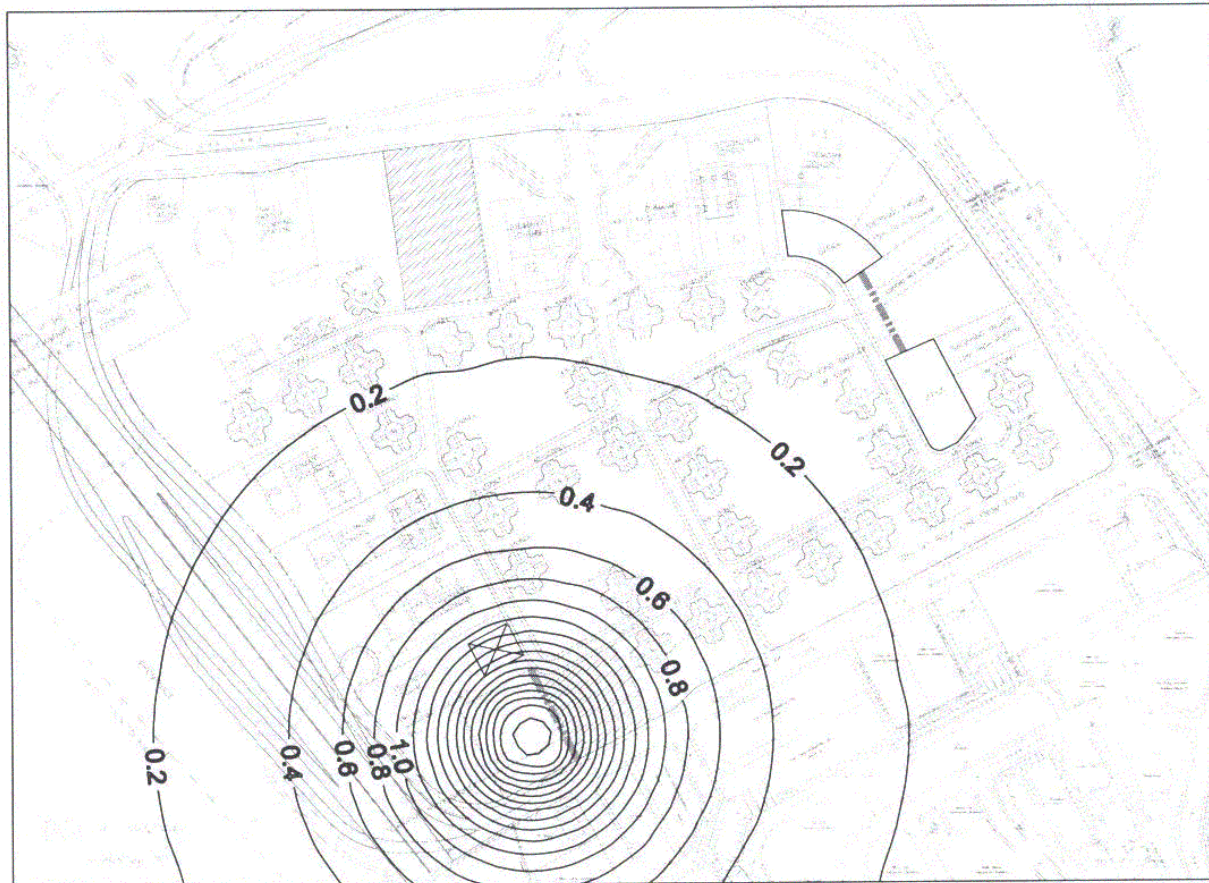

(842570,817880)

(841700,817250)

4/F  
26.4mPD

**Maunsell** in association  
with  
WHA, DLN,  
EHS, MEMCL, MGS

YAU TONG BAY DEVELOPMENT  
ENVIRONMENTAL IMPACT ASSESSMENT STUDY  
PREDICTED 5 SECOND AVERAGE METHYL ISOBUTYL KETONE CONCENTRATION (OU) AT 4/F FLOOR

MAIN WEALTH DEVELOPMENT LIMITED	
Scale	NTS
Date	OCT 01
Code Ref.	94697/01/p2/fig.2b.dgn
Figure No.	FIG 3.16



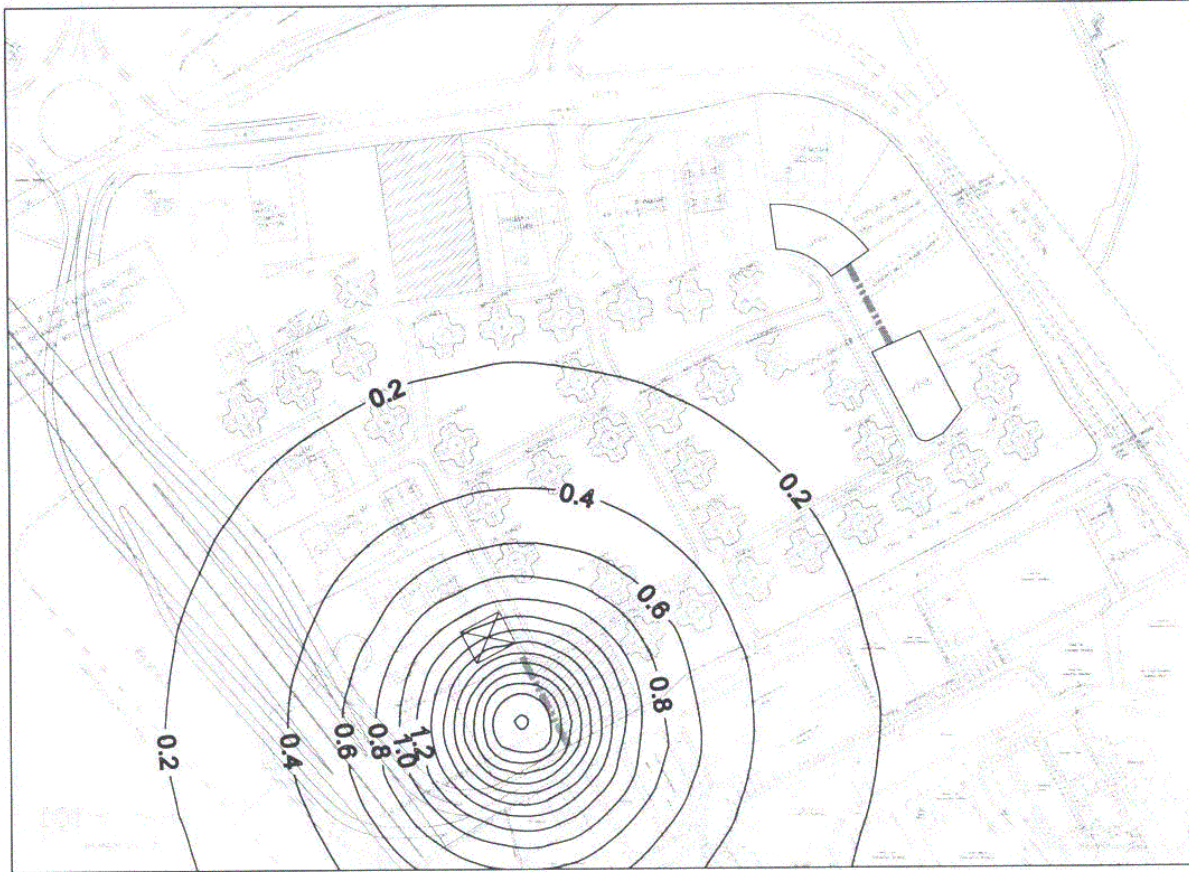

(842570,817880)

7/F  
+34.8mPD

(841700,817250)

**Maunsell** in association  
with  
WHA, DLN,  
EHS, MEMCL, MGS

YAU TONG BAY DEVELOPMENT  
ENVIRONMENTAL IMPACT ASSESSMENT STUDY  
PREDICTED 5 SECOND AVERAGE METHYL ISOBUTYL KETONE CONCENTRATION (OU) AT 7/F FLOOR

MAIN WEALTH DEVELOPMENT LIMITED	
Scale	NTS
Date	OCT 01
Code Ref.	94587/01/02/11/g2.2b.dgn
Figure No.	FIG 3.17

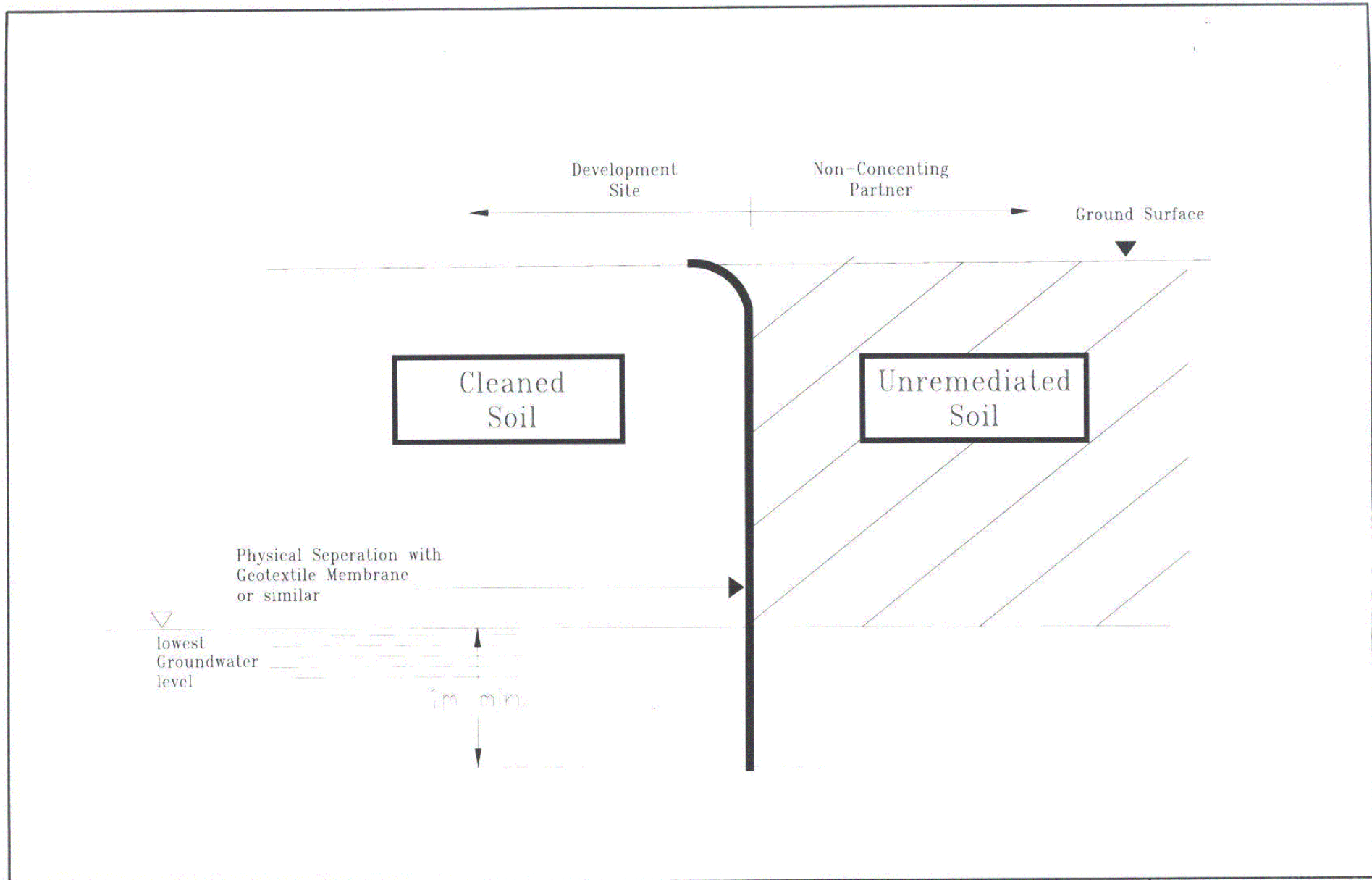

**Maunsell** in association with  
 WHA, DLN,  
 EHS, MEMCL, MGS

YAU TONG BAY DEVELOPMENT  
 ENVIRONMENTAL IMPACT ASSESSMENT STUDY  
 A CONCEPTUAL DIAGRAM SHOWING THE CROSS-SECTION OF THE MEMBRANE

<b>MAIN WEALTH DEVELOPMENT LIMITED</b>	
Scale 1 : 3000	Cod Ref. 3463/201/ep2/11g2-2b-dp
Date DEC 00	Figure No. FIG 3.18

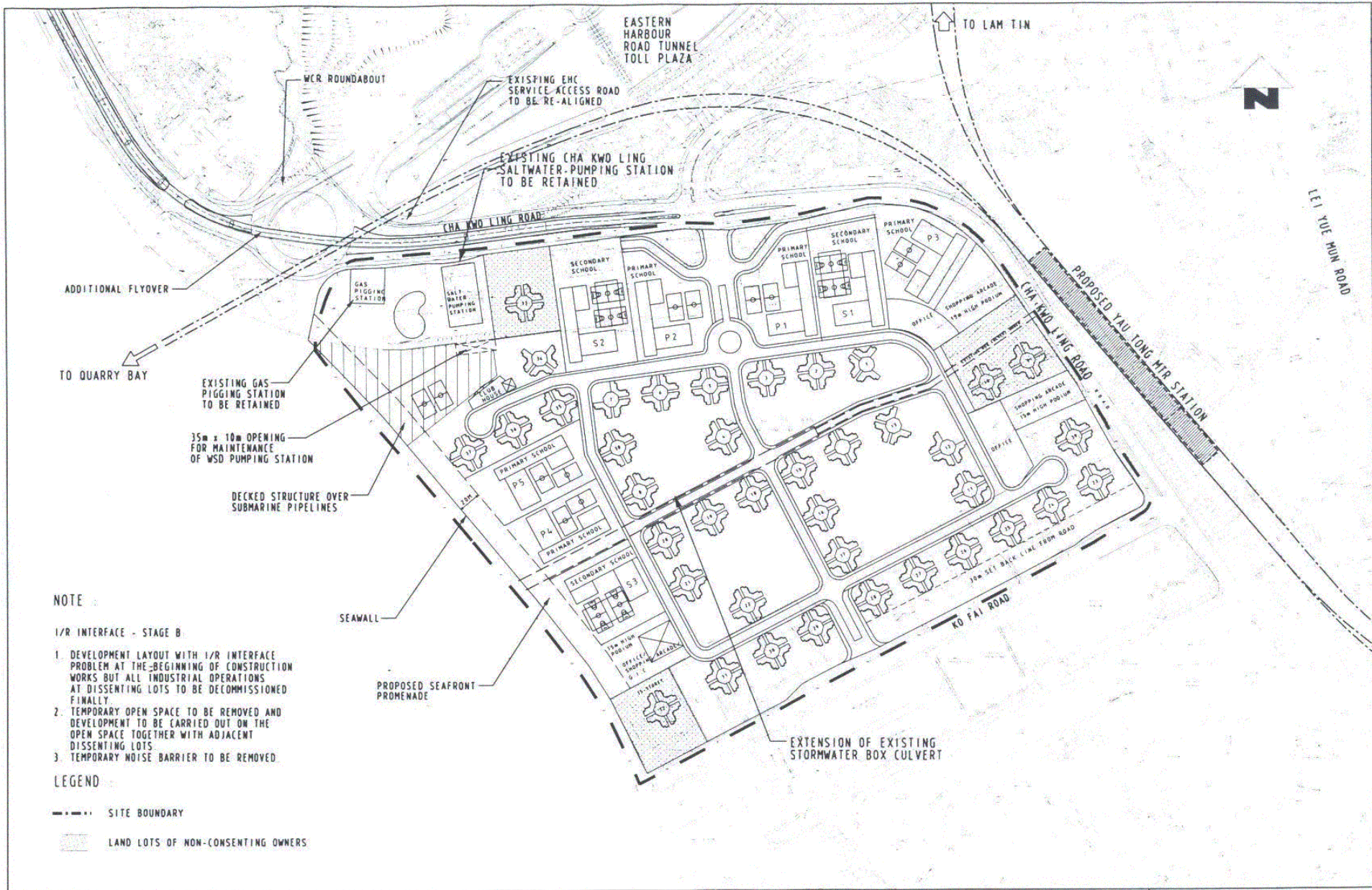

**Maunsell** in association with  
 WHA, DLN,  
 EHS, MEMCL, MGS

YAU TONG BAY DEVELOPMENT  
 ENVIRONMENTAL IMPACT ASSESSMENT STUDY  
 LAYOUT PLAN (MINIMISED RECLAMATION WITH I/R INTERFACE STAGE B)

MAIN WEALTH DEVELOPMENT LIMITED	
Scale 1 3000	Case No. N697/01/22/1/3 2.dgn
Date SEP 01	Figure No. FIG 3.2

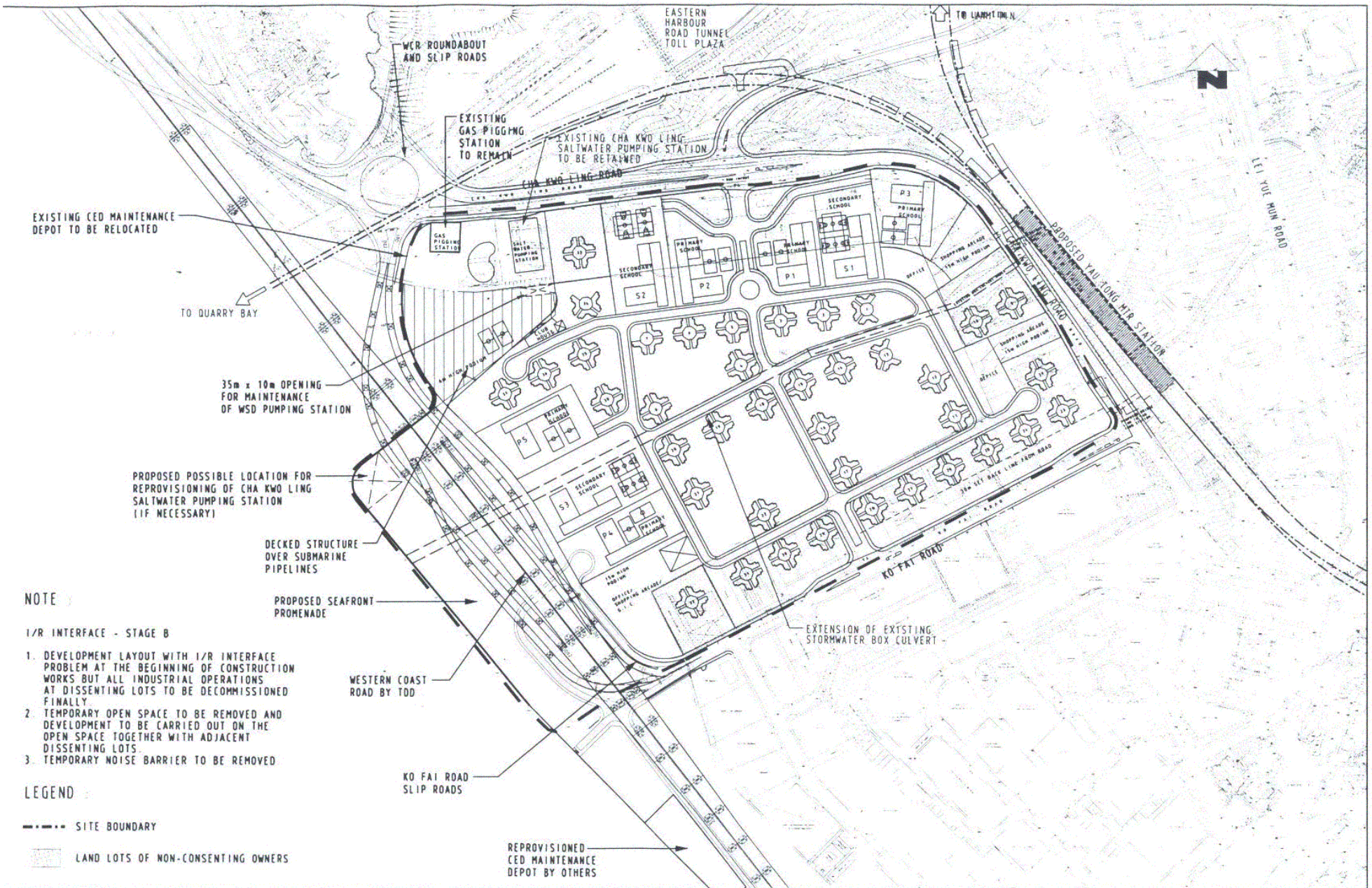

**NOTE**

**1/R INTERFACE - STAGE B**

1. DEVELOPMENT LAYOUT WITH 1/R INTERFACE PROBLEM AT THE BEGINNING OF CONSTRUCTION WORKS BUT ALL INDUSTRIAL OPERATIONS AT DISSSENTING LOTS TO BE DECOMMISSIONED FINALLY.
2. TEMPORARY OPEN SPACE TO BE REMOVED AND DEVELOPMENT TO BE CARRIED OUT ON THE OPEN SPACE TOGETHER WITH ADJACENT DISSSENTING LOTS
3. TEMPORARY NOISE BARRIER TO BE REMOVED

**LEGEND**

- SITE BOUNDARY
- LAND LOTS OF NON-CONSENTING OWNERS

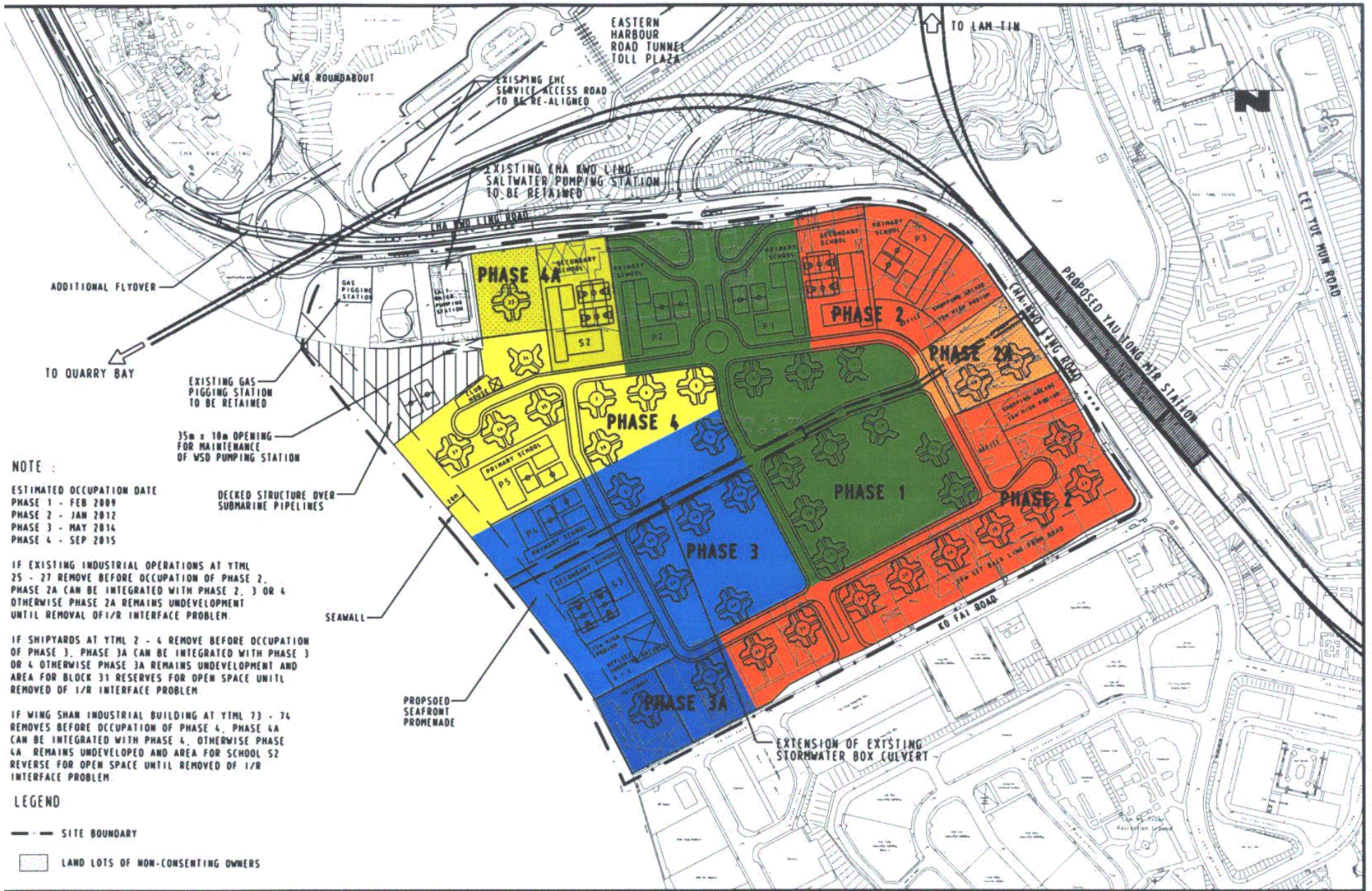

**NOTE :**

ESTIMATED OCCUPATION DATE  
 PHASE 1 - FEB 2009  
 PHASE 2 - JAN 2012  
 PHASE 3 - MAY 2014  
 PHASE 4 - SEP 2015

IF EXISTING INDUSTRIAL OPERATIONS AT YTM 25 - 27 REMOVE BEFORE OCCUPATION OF PHASE 2, PHASE 2A CAN BE INTEGRATED WITH PHASE 2, 3 OR 4 OTHERWISE PHASE 2A REMAINS UNDEVELOPMENT UNTIL REMOVAL OF I/R INTERFACE PROBLEM.

IF SHIPYARDS AT YTM 2 - 4 REMOVE BEFORE OCCUPATION OF PHASE 3, PHASE 3A CAN BE INTEGRATED WITH PHASE 3 OR 4 OTHERWISE PHASE 3A REMAINS UNDEVELOPMENT AND AREA FOR BLOCK 31 RESERVES FOR OPEN SPACE UNTIL REMOVED OF I/R INTERFACE PROBLEM.

IF WING SHAN INDUSTRIAL BUILDING AT YTM 73 - 74 REMOVES BEFORE OCCUPATION OF PHASE 4, PHASE 4A CAN BE INTEGRATED WITH PHASE 4, OTHERWISE PHASE 4A REMAINS UNDEVELOPMENT AND AREA FOR SCHOOL S2 REVERSE FOR OPEN SPACE UNTIL REMOVED OF I/R INTERFACE PROBLEM.

**LEGEND**

- SITE BOUNDARY
- LAND LOTS OF NON-CONSENTING OWNERS

**Maunsell** in association with  
 IHA, DLN,  
 HS, MEMCL, MGS

YAU TONG BAY DEVELOPMENT  
 ENVIRONMENTAL IMPACT ASSESSMENT STUDY  
**PROVISIONAL DEVELOPMENT PHASING PLAN**  
 (UNDER MINIMISED RECLAMATION WITH I/R INTERFACE)

<b>MAIN WEALTH DEVELOPMENT LIMITED</b>	
Scale 1 3000	Code Ref MWD/2012/03/2011/1 & app
Date APR 01	Figure No FIG 3.4

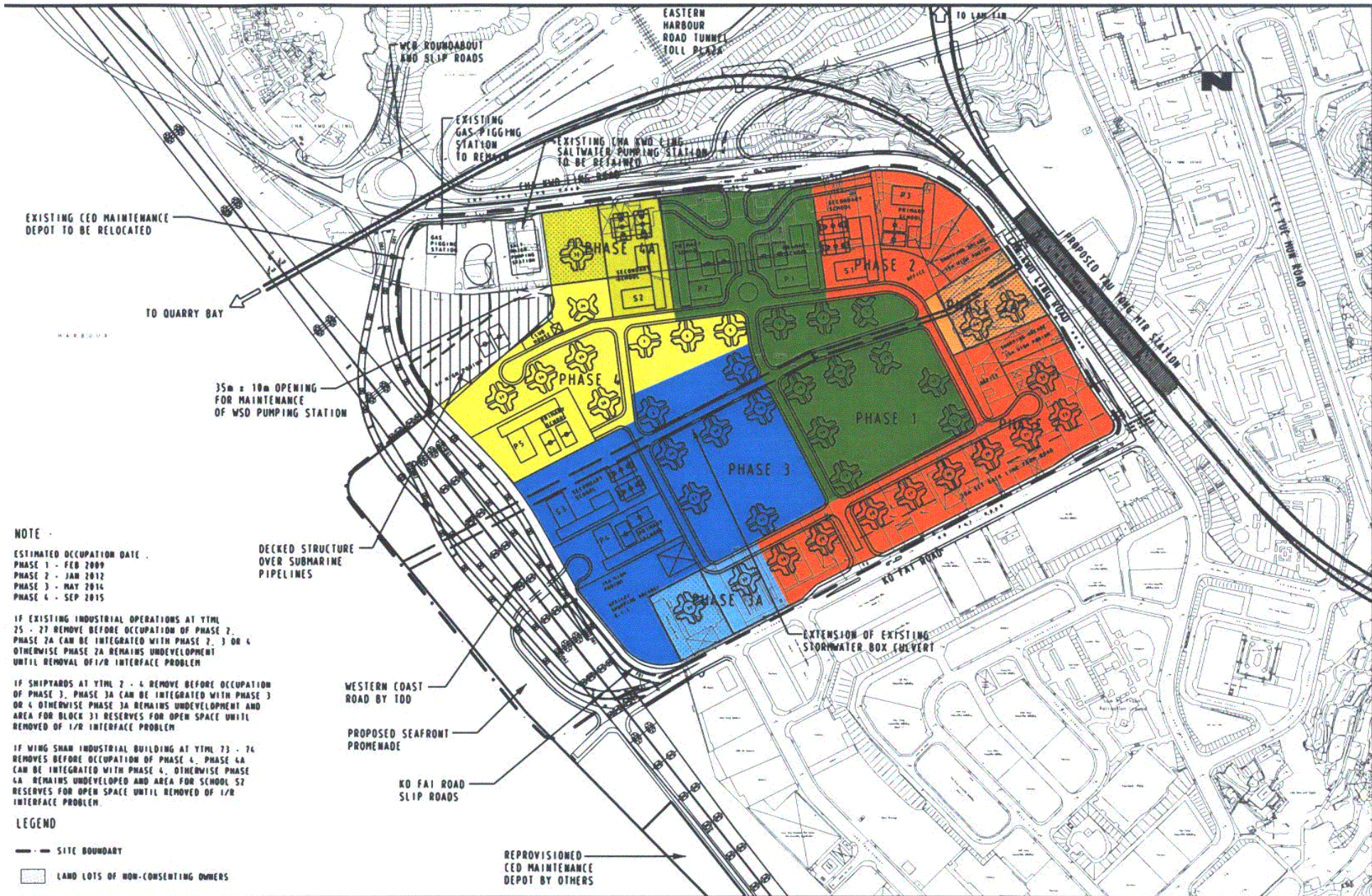

**Maunsell** in association with  
 JHA, DLN,  
 H.S. MEMCL, MGS

YAU TONG BAY DEVELOPMENT  
 ENVIRONMENTAL IMPACT ASSESSMENT STUDY  
 PROVISIONAL DEVELOPMENT PHASING PLAN (UNDER FULL RECLAMATION WITH 1/R INTERFACE)

MAIN WEALTH DEVELOPMENT LIMITED	
Scale 1 : 3500	Code Ref MWD/2012/01/01/01
Date APR 01	Figure No. FIG 3.5

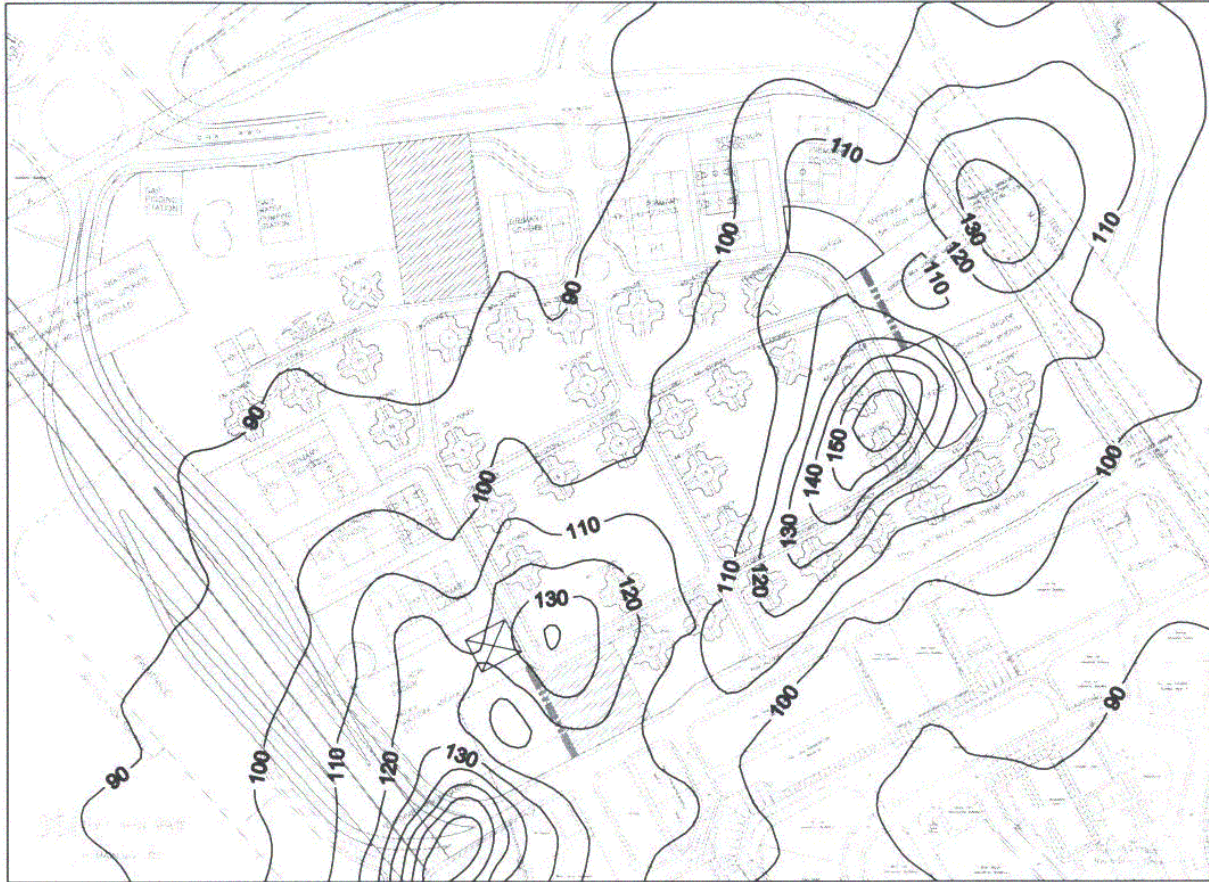

(842570,817880)

(841700,817250)

Podium  
+13.0mPD

**Maunsell** in association  
with  
WHA, DLN,  
EHS, MEMCL, MGS

YAU TONG BAY DEVELOPMENT  
ENVIRONMENTAL IMPACT ASSESSMENT STUDY

CUMULATIVE DAILY AVERAGE TOTAL SUSPENDED PARTICULATES CONCENTRATION AT PODIUM ( $\mu\text{G}/\text{m}^3$ )

MAIN WEALTH DEVELOPMENT LIMITED

Scale	NTS	Code Ref.	94697/01/r02/fig2.2b.dgn
Date	OCT 01	Figure No.	FIG 3.6



(842570,817880)

1/F  
+18.0mPD

(841700,817250)

**Maunsell** in association with  
WHA, DLN,  
EHS, MEMCL, MGS

YAU TONG BAY DEVELOPMENT  
ENVIRONMENTAL IMPACT ASSESSMENT STUDY  
CUMULATIVE DAILY AVERAGE TOTAL SUSPENDED PARTICULATES CONCENTRATION AT 1/F FLOOR ( $\mu\text{G}/\text{m}^3$ )

MAIN WEALTH DEVELOPMENT LIMITED	
Scale	NTS
Date	OCT 01
Cad No.	94697/01/p2/fig2.2b.dgn
Figure No.	FIG 3.7



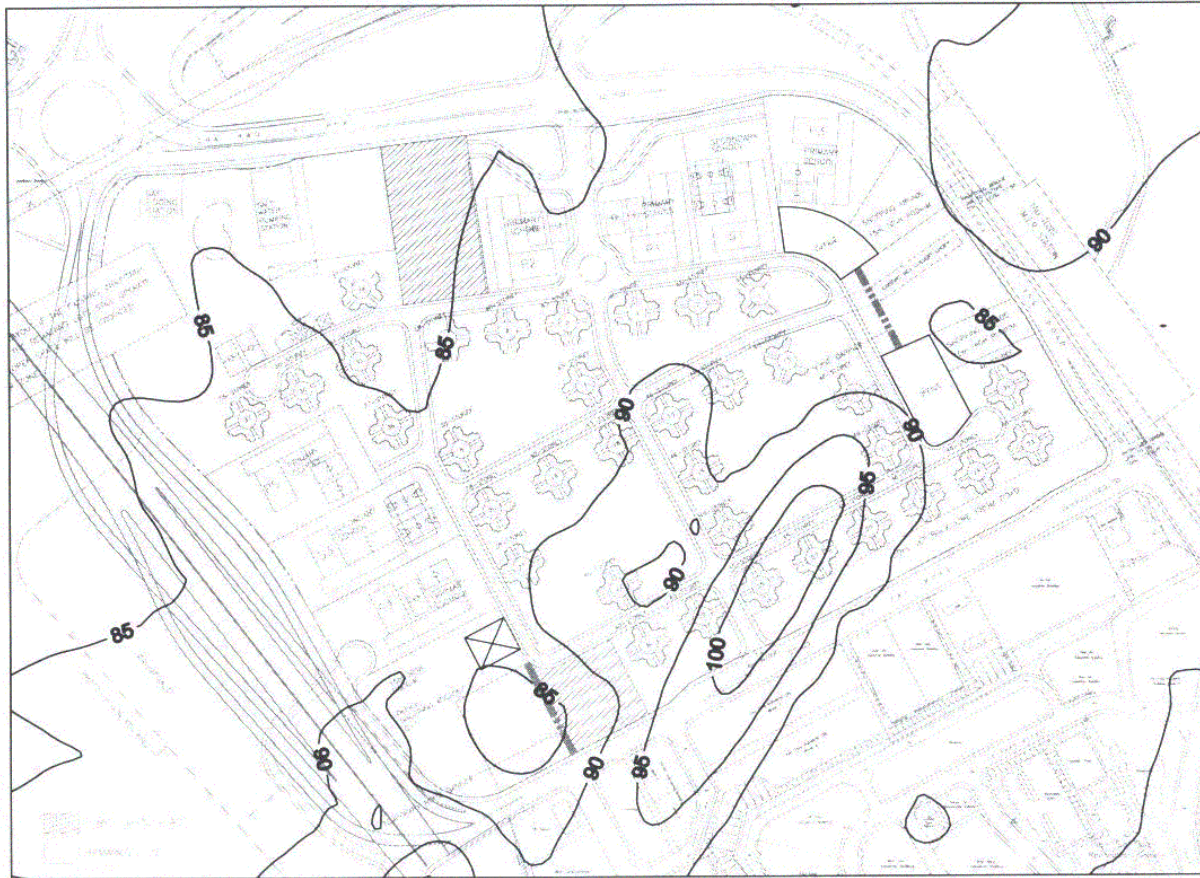

(842570,817880)

(841700,817250)

4/F  
26.4mPD

**Maunsell** in association  
with  
WHA, DLN,  
EHS, MEMCL, MGS

YAU TONG BAY DEVELOPMENT  
ENVIRONMENTAL IMPACT ASSESSMENT STUDY  
CUMULATIVE DAILY AVERAGE TOTAL SUSPENDED PARTICULATES CONCENTRATION AT 4/F FLOOR ( $\mu\text{G}/\text{m}^3$ )

MAIN WEALTH DEVELOPMENT LIMITED	
Scale	NTS
Date	OCT 01
Cod Ref.	94697/01/p2/fig2.2b.dgn
Figure No.	FIG 3.8

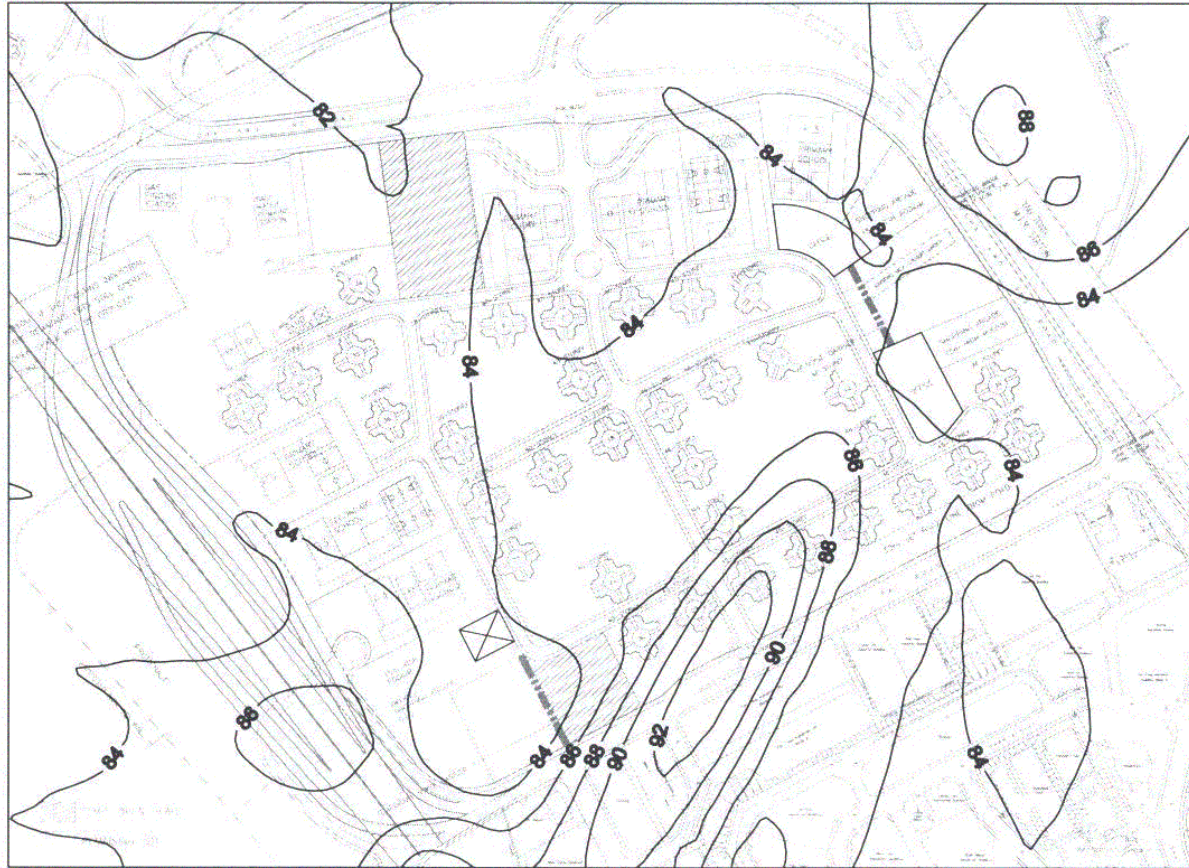

(842570,817880)

(841700,817250)

7/F  
+34.8mPD

**Maunsell** in association with  
WHA, DLN,  
EHS, MEMCL, MGS

YAU TONG BAY DEVELOPMENT  
ENVIRONMENTAL IMPACT ASSESSMENT STUDY  
CUMULATIVE DAILY AVERAGE TOTAL SUSPENDED PARTICULATES CONCENTRATION AT 7/F FLOOR ( $\mu\text{G}/\text{m}^3$ )

MAIN WEALTH DEVELOPMENT LIMITED	
Scale	NTS
Date	OCT 01
Cad Ref.	94657/01/02/11g2.2b.dgn
Figure No.	FIG 3.9