



- LEGEND :
-  TEMPORARY WORKS AREA
 -  PERMANENT ALIENATION OF LAND FOR SHAFT CHAMBER



Revision	Date	Description		Initial	
		Assigned	Checked	Drawn	Checked
Initial		TY	DCA	SZ	STL
Date		01/04	01/04	01/04	01/04

Approved

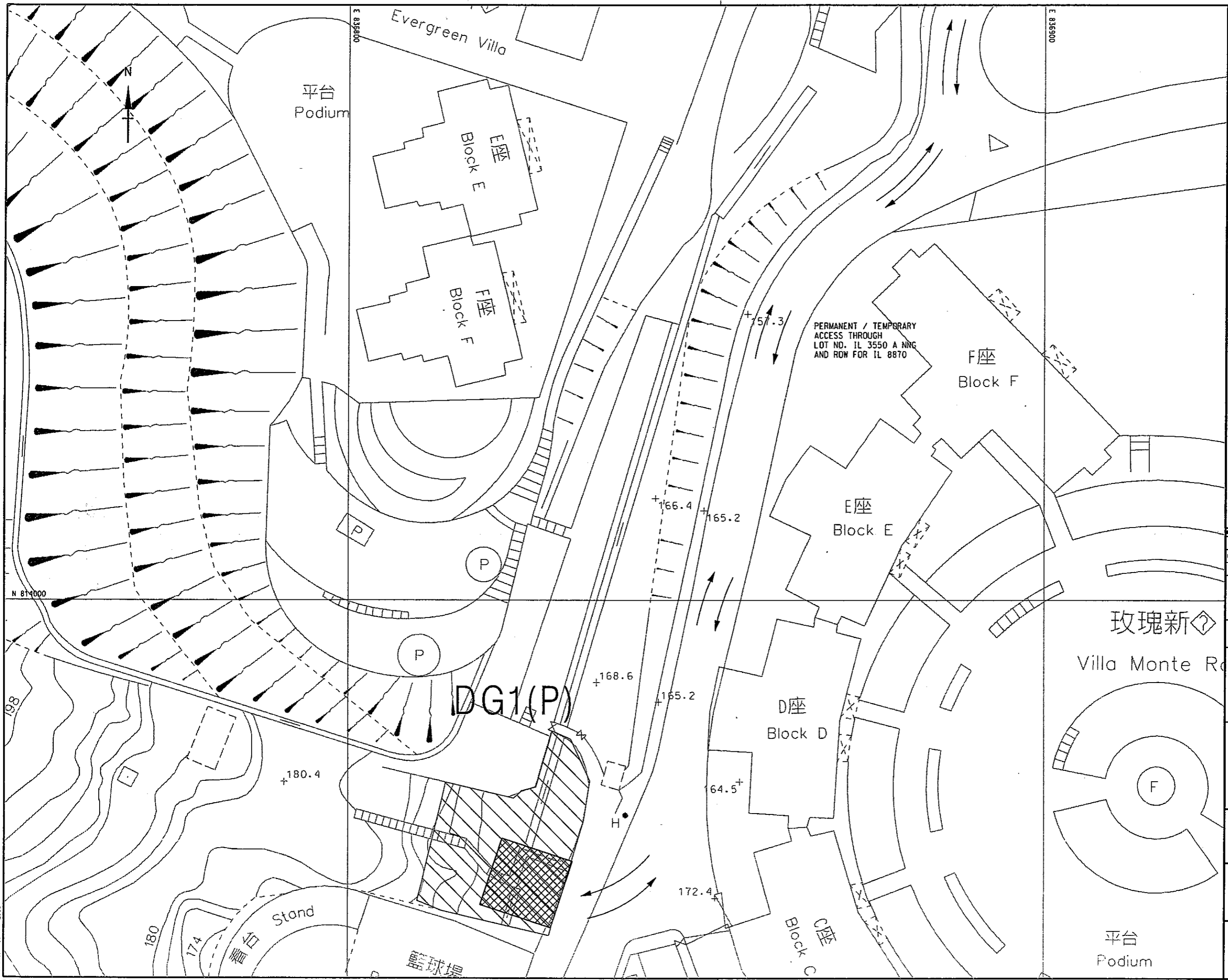
Agreement no. CE 25/2002 (DS)

Contract title
DRAINAGE IMPROVEMENT IN NORTHERN HONG KONG ISLAND - HONG KONG WEST DRAINAGE TUNNEL AND LOWER CATCHMENT IMPROVEMENT - INVESTIGATION

Drawing title
LAND REQUIREMENT PLAN-SHAFT DG1(P)
(SHEET 7 OF 35)

Drawing no. FIGURE 2.3-7
Scale 1:500 (A3)

 香港特別行政區政府渠務署
THE GOVERNMENT OF THE HONG KONG
SPECIAL ADMINISTRATIVE REGION
DRAINAGE SERVICES DEPARTMENT

 BLACK & VEATCH HONG KONG LIMITED
博威工程顧問有限公司