

LEGEND:

- EXTENT OF RECLAMATION (SHOWN FOR INFORMATION ONLY, NOT PART OF DP6)
- - - - - DP6: DREDGING FOR THE CROSS-HARBOUR WATER MAINS

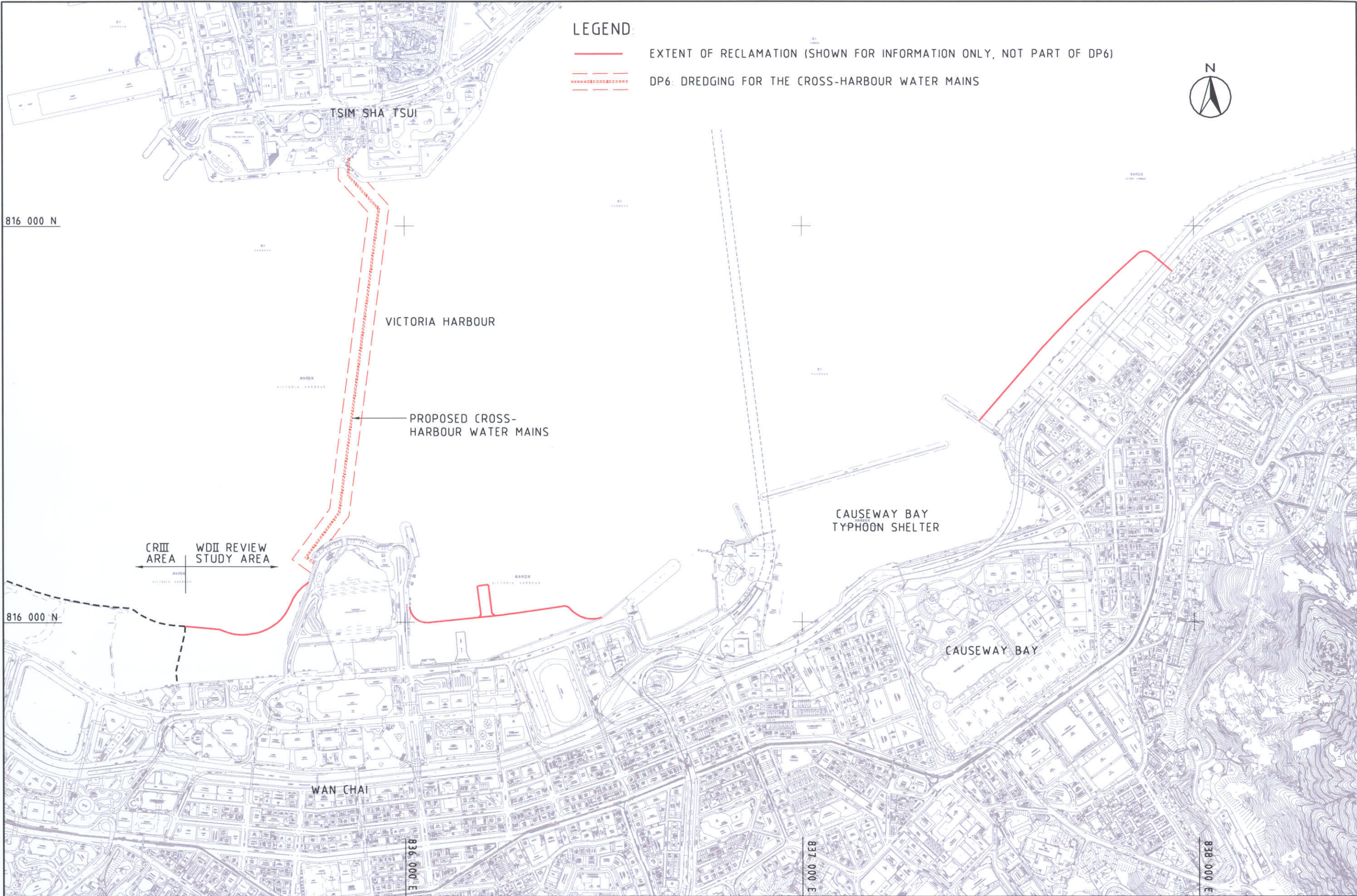

DATE: 2007-9-25 14:56:36

**MAUNSELL | AECOM**  
Maunsell Consultants Asia Ltd

WAN CHAI DEVELOPMENT PHASE II - PLANNING AND ENGINEERING REVIEW

DESIGNATED PROJECT 6 -  
DREDGING FOR THE CROSS-HARBOUR WATER MAINS FROM WAN CHAI TO TSIM SHA TSUI

FIGURE 1.2f