

LEGEND

- C COMMERCIAL
- C/R COMMERCIAL / RESIDENTIAL
- R(A) RESIDENTIAL (GROUP A)
- R(B) RESIDENTIAL (GROUP B)
- R(C) RESIDENTIAL (GROUP C)
- G/IC GOVERNMENT, INSTITUTION OR COMMUNITY
- O OPEN SPACE
- OU OTHER SPECIFIED USES

BASEMAP EXTRACTED FROM CENTRAL DISTRICT (EXTENSION) OZP (NO.S/H/24/6)

- DP1 CENTRAL-WANCHAI BYPASS (CWB) INCLUDING ITS ROAD TUNNEL AND SLIP ROADS
- DP2 ROAD P2 AND OTHER ROADS WHICH ARE CLASSIFIED AS PRIMARY/DISTRICT DISTRIBUTOR ROADS
- DP3 RECLAMATION WORKS INCLUDING ASSOCIATED DREDGING WORKS

維多利亞港
VICTORIA HARBOUR

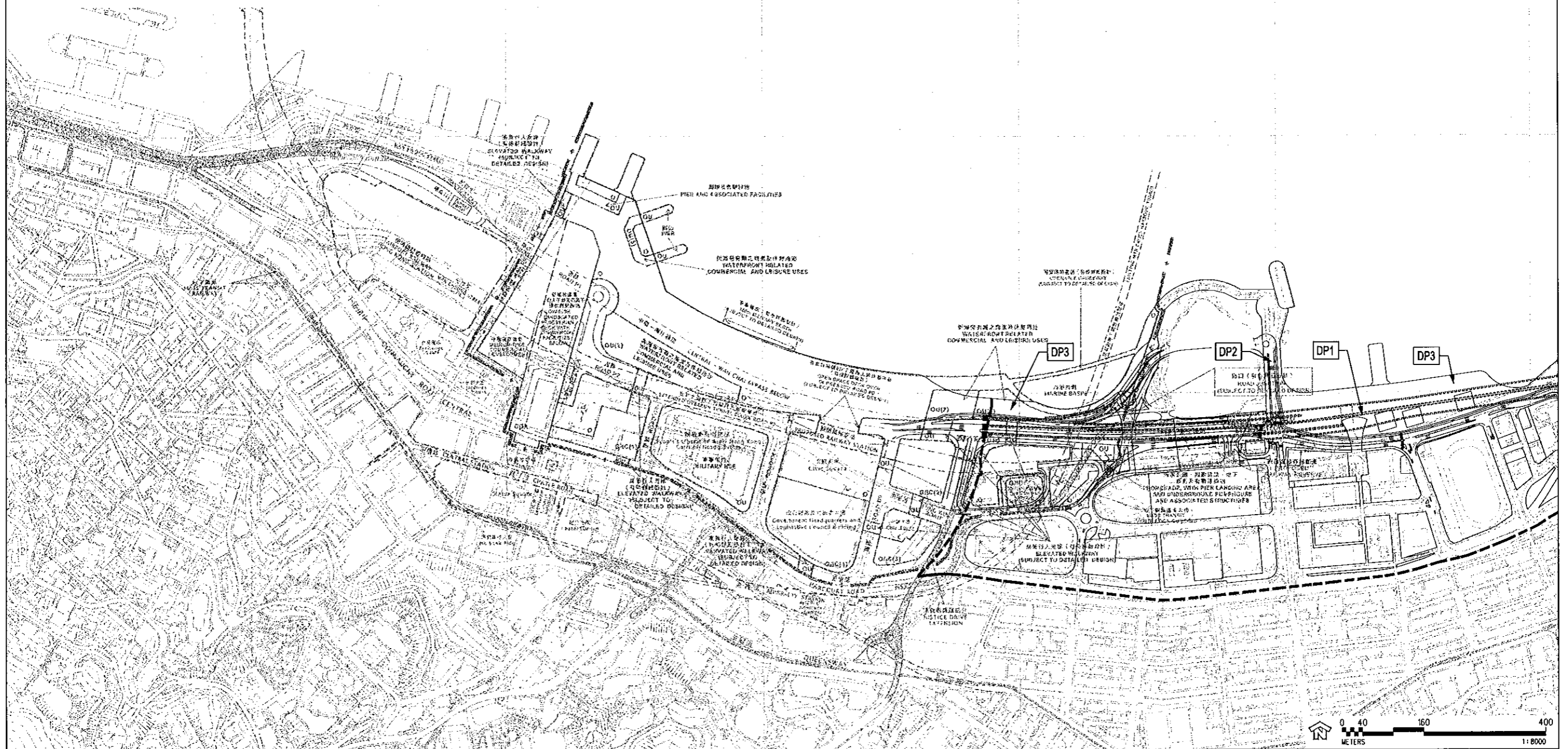

WAN CHAI DEVELOPMENT PHASE II - PLANNING AND ENGINEERING REVIEW

REVIEW OF PLANNING FRAMEWORK PLAN (SHEET 1 OF 3)

FIGURE 10.1.1

LEGEND

- C COMMERCIAL
- C/R COMMERCIAL / RESIDENTIAL
- R(A) RESIDENTIAL (GROUP A)
- R(B) RESIDENTIAL (GROUP B)
- R(C) RESIDENTIAL (GROUP C)
- G/IC GOVERNMENT, INSTITUTION OR COMMUNITY
- O OPEN SPACE
- OU OTHER SPECIFIED USES

BASEMAP EXTRACTED FROM WAN CHAI NORTH (HPA25) OUTLINE ZONING PLAN (NO.S/H25/1)

- DP1 CENTRAL-WANCHAI BYPASS (CWB) INCLUDING ITS ROAD TUNNEL AND SLIP ROADS
- DP2 ROAD P2 AND OTHER ROADS WHICH ARE CLASSIFIED AS PRIMARY/DISTRICT DISTRIBUTOR ROADS
- DP3 RECLAMATION WORKS INCLUDING ASSOCIATED DREDGING WORKS

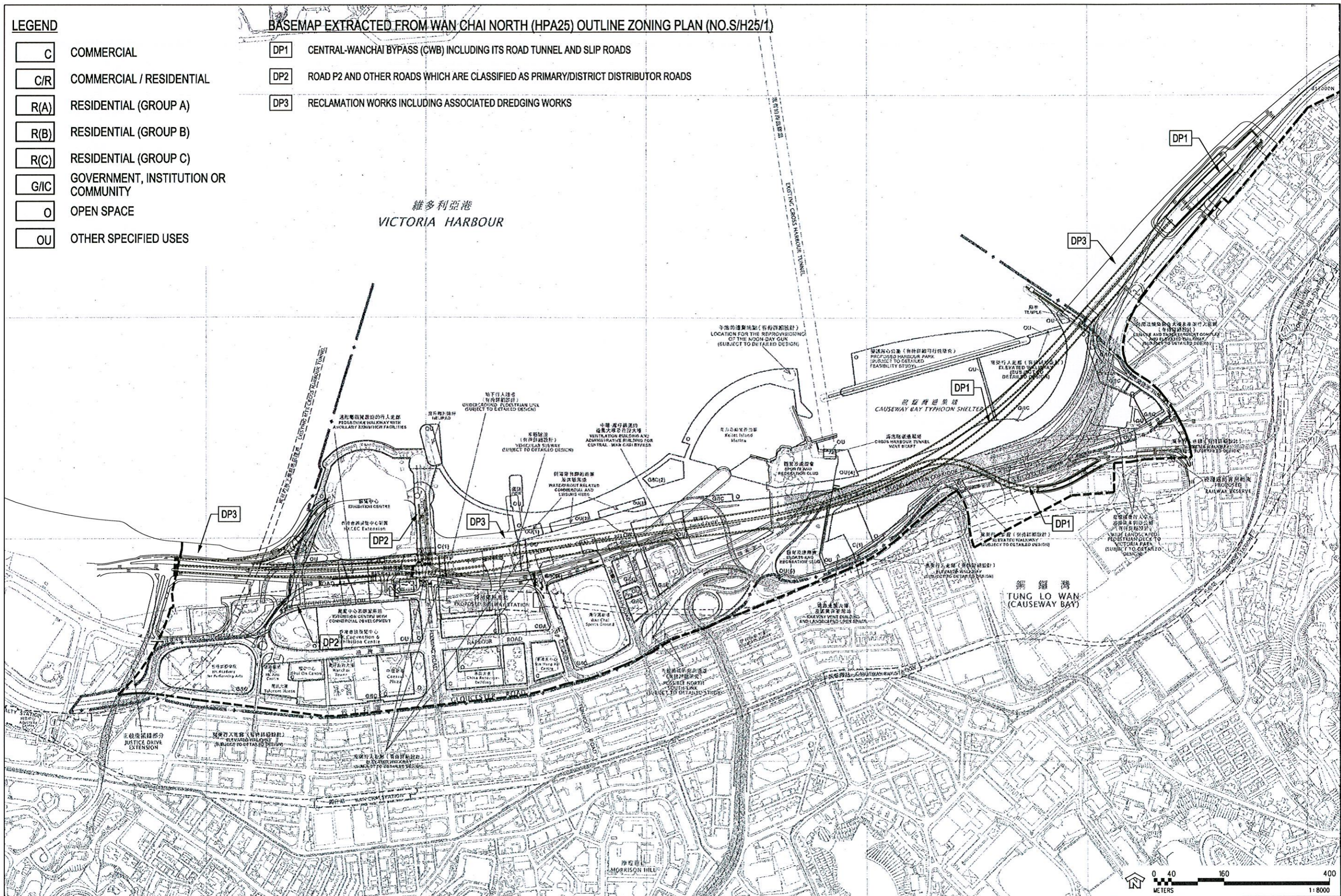

LEGEND

- C COMMERCIAL
- C/R COMMERCIAL / RESIDENTIAL
- R(A) RESIDENTIAL (GROUP A)
- R(B) RESIDENTIAL (GROUP B)
- R(C) RESIDENTIAL (GROUP C)
- G/C GOVERNMENT, INSTITUTION OR COMMUNITY
- O OPEN SPACE
- OU OTHER SPECIFIED USES

BASEMAP EXTRACTED FROM NORTH POINT OZP (NO.S/H8/19)

- DP1 CENTRAL-WANCHAI BYPASS (CWB) INCLUDING ITS ROAD TUNNEL AND SLIP ROADS
- DP2 ROAD P2 AND OTHER ROADS WHICH ARE CLASSIFIED AS PRIMARY/DISTRICT DISTRIBUTOR ROADS
- DP3 RECLAMATION WORKS INCLUDING ASSOCIATED DREDGING WORKS

維多利亞港
VICTORIA HARBOUR

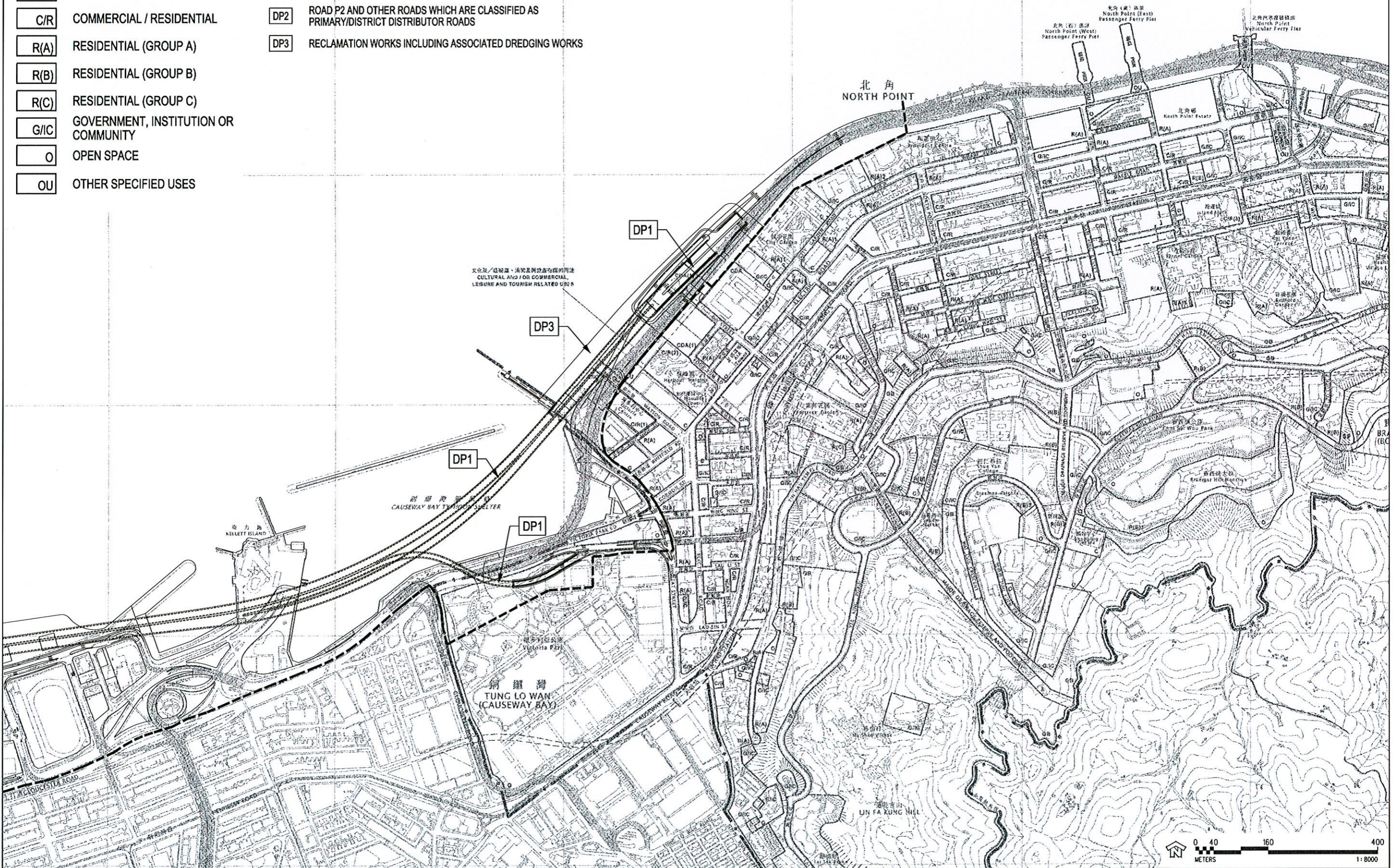

7/9/2007 17:52:47

FILE : ...wanchai\DG\FIGURE 10-1-3.dgn