

**LEGEND:**

- - - EXTENT OF RECLAMATION
- - - TRUNK ROAD IN TUNNEL
- EXTENT OF NEW ROAD
- LANDSCAPED DECK
- 12.8 SPOT LEVELS

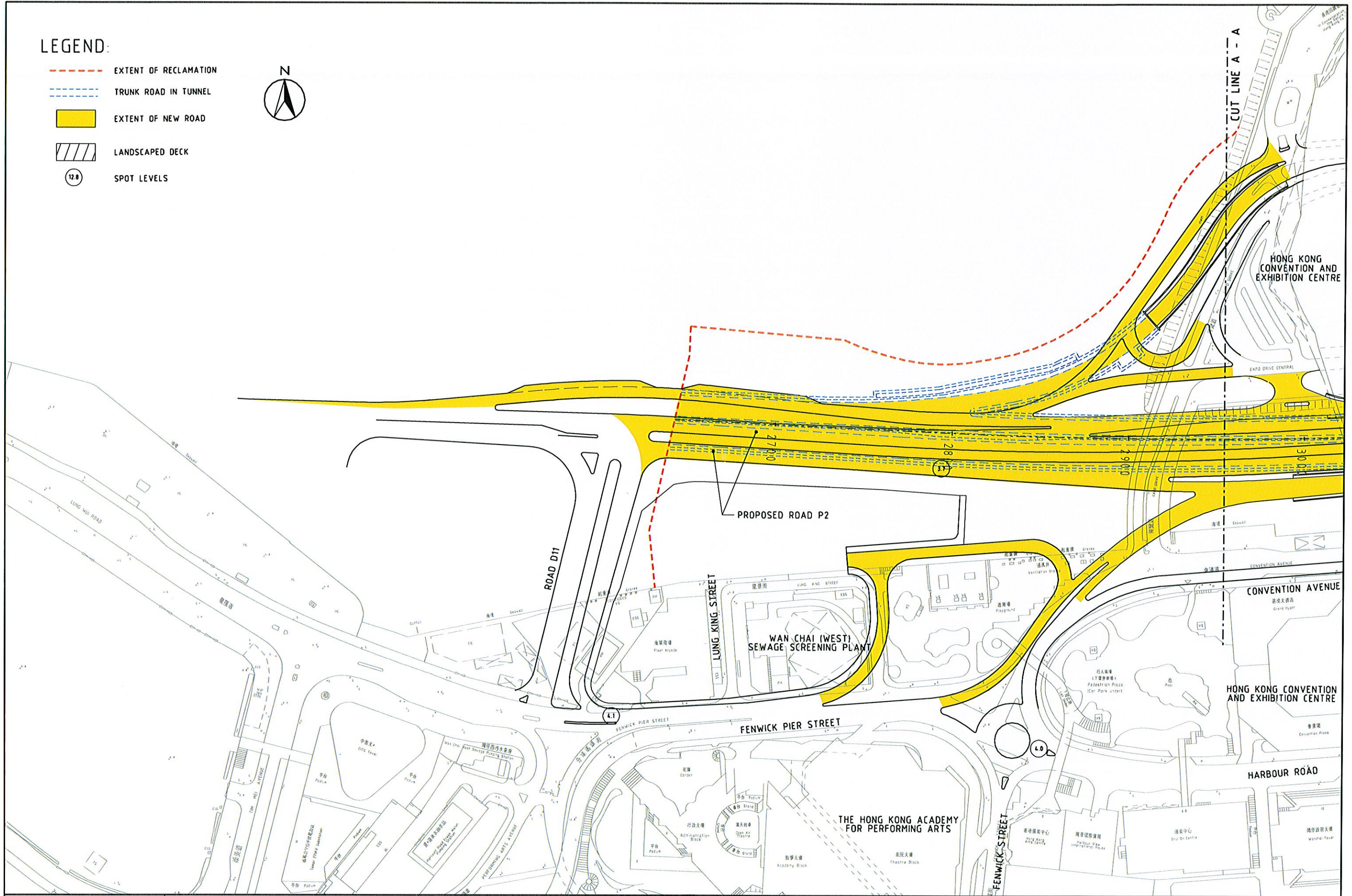

DATE: 2007-9-6 14:19:06

**MAUNSELL | AECOM**  
Maunsell Consultants Asia Ltd

WAN CHAI DEVELOPMENT PHASE II - PLANNING AND ENGINEERING REVIEW  
**EXTENT OF 'NEW' ROADS UNDER THE PROJECT**

**FIGURE 4.2**