

LEGEND:

- BOUNDARY OF STUDY AREA
- DP1: TRUNK ROAD IN TUNNEL
- DP1: TRUNK ROAD AT GROUND LEVEL
- DP1: SLIP ROAD IN TUNNEL
- DP1: SLIP ROAD AT GROUND LEVEL
- DP1: ELEVATED ROAD
- DP2: GROUND LEVEL ROAD
- DP3: EXTENT OF PERMANENT RECLAMATION
- DP3: INDICATIVE EXTENT OF TEMPORARY RECLAMATION
- DP3: DREDGING AREA FOR MITIGATION OF ODOUR
- DP4: TEMPORARY TYPHOON SHELTER
- DP5: WAN CHAI EAST SEWAGE OUTFALL
- DP6: CROSS-HARBOUR WATER MAINS

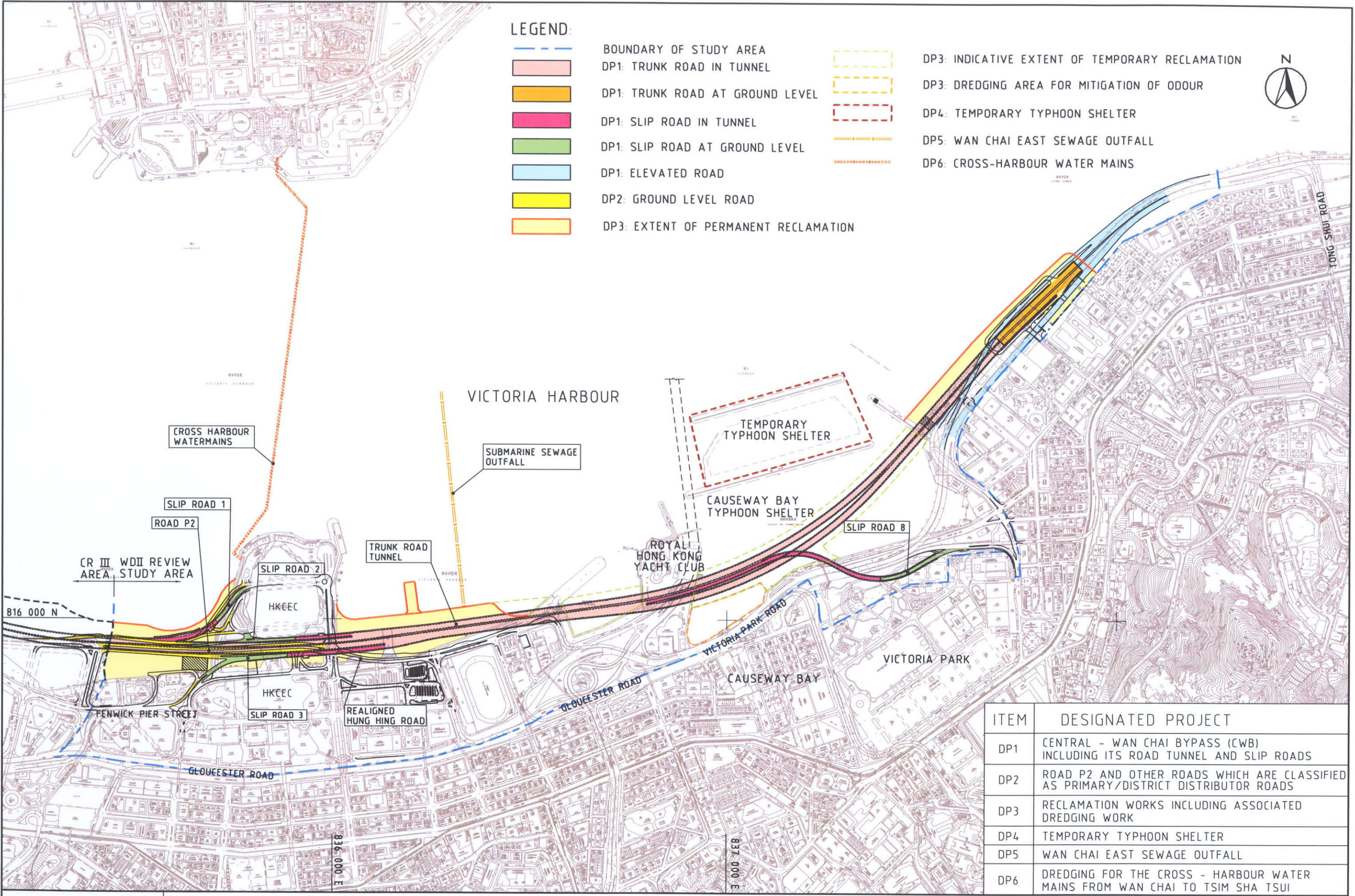

ITEM	DESIGNATED PROJECT
DP1	CENTRAL - WAN CHAI BYPASS (CWB) INCLUDING ITS ROAD TUNNEL AND SLIP ROADS
DP2	ROAD P2 AND OTHER ROADS WHICH ARE CLASSIFIED AS PRIMARY/DISTRICT DISTRIBUTOR ROADS
DP3	RECLAMATION WORKS INCLUDING ASSOCIATED DREDGING WORK
DP4	TEMPORARY TYPHOON SHELTER
DP5	WAN CHAI EAST SEWAGE OUTFALL
DP6	DREDGING FOR THE CROSS - HARBOUR WATER MAINS FROM WAN CHAI TO TSIM SHA TSUI

WAN CHAI DEVELOPMENT PHASE II - PLANNING AND ENGINEERING REVIEW

DESIGNATED PROJECTS

FIGURE 1.2

DATE: 2007-11-28 13:23:02

MAUNSELL | AECOM
Maunsell Consultants Asia Ltd