

Appendix 5.1b
Pile Layout for East Bridge, West Bridge
and Seafront Promenade

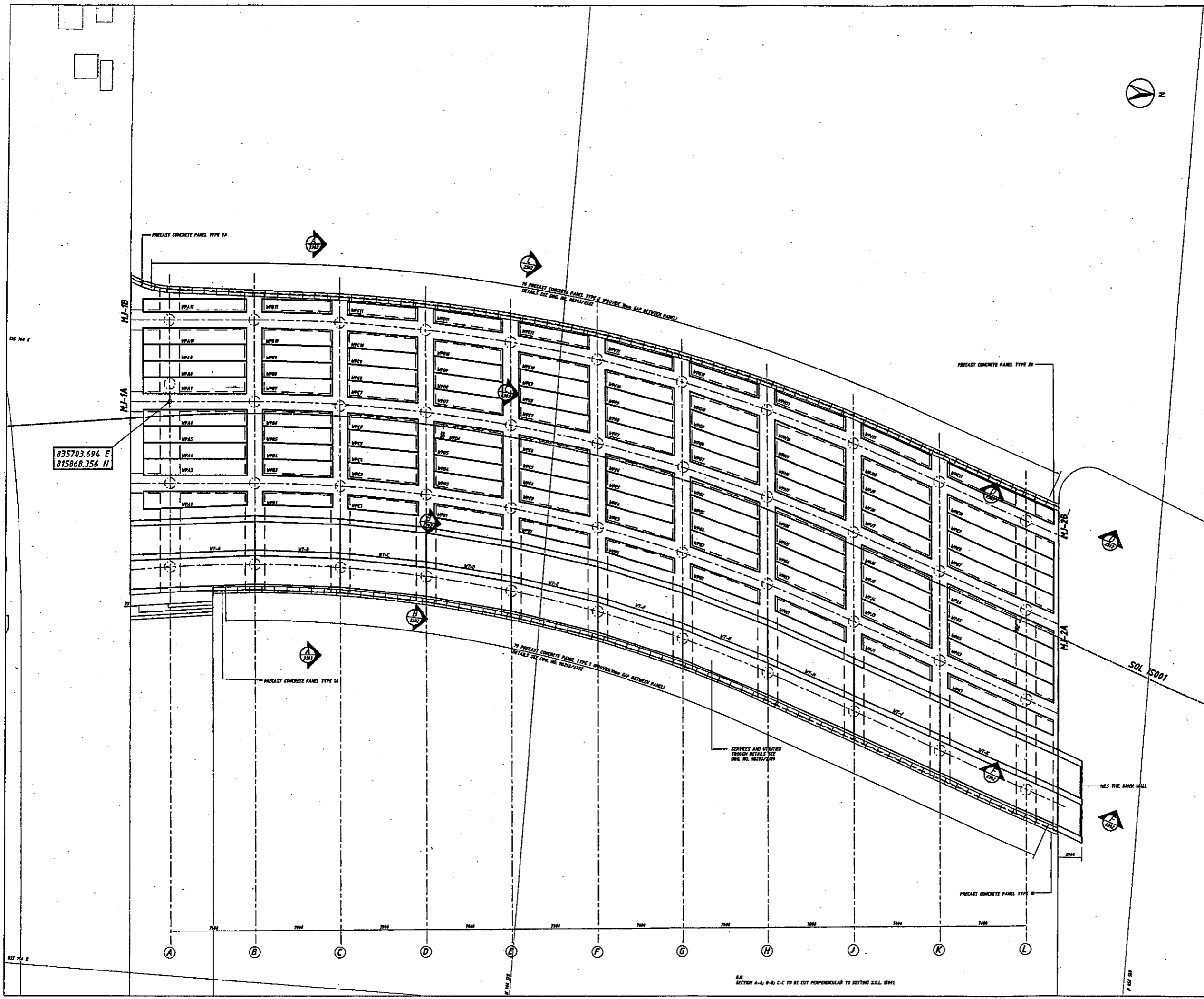

- GENERAL NOTES:**
- UNLESS OTHERWISE STATED ON A PARTICULAR DRAWING NOTES OF THIS DRAWING APPLY TO ALL STRUCTURAL DRAWINGS.
 - ALL LEVELS ARE IN METRES WITH REFERENCE TO PRINCIPAL DATUM.
 - ALL DIMENSIONS ARE IN MILLIMETRES.
 - ALL LEVELS SHOWN ARE STRUCTURAL LEVELS. THE CONTRACTOR SHALL VERIFY ALL SETTING BUT DIMENSIONS AND LEVELS AGAINST THE LATEST RELEVANT DRAWINGS BEFORE WORK COMMENCES. NOTIFY THE ENGINEER IMMEDIATELY OF ANY DISCREPANCY DISCOVERED.
 - UNLESS OTHERWISE STATED, CONCRETE CLASSES FOR PLAINS, TOPPING, SERVICES AND UTILITIES, THROUGH BEAMS, SLABS, AND OTHER STRUCTURAL ELEMENTS ARE GRADE 45/50 DESIGN MIX.

UNFORMED	45
FORMED	50
NOT EXPOSED TO DIRECT PUBLIC VIEW	F4
EXPOSED TO DIRECT PUBLIC VIEW	F5
 - THE CONTRACTOR PROPOSED AND SUBMITTED METHODS FOR LIFTING, PLACING AND TEMPORARY SUPPORTING OF ALL PRECAST ELEMENTS INCLUDING PLAINS, SERVICES AND UTILITIES, THROUGH BEAMS, SLABS TO THE SATISFACTION OF THE ENGINEER. THE PROPOSED METHODS FOR LIFTING, PLACING AND TEMPORARY SUPPORTING THE PRECAST ELEMENTS SHALL NOT INDUCE ADVERSE EFFECTS TO ANY PARTS OF THE WORKS.
 - NO PRECASTING OF PILING BEAMS WILL BE ALLOWED UNTIL CONTRACTOR HAS SUBMITTED DETAILS OF HIS PROPOSED METHOD FOR SUPPORTING THE BEAMS OFF THE PILE CAPS TO THE SATISFACTION OF THE ENGINEER.
 - STRUCTURAL MEMBERS SUPPORTING PRECAST ELEMENTS SHALL HAVE A MINIMUM COMPRESSIVE STRENGTH OF 45 N/mm² BEFORE ELEMENTS PLACED.
 - THE PRECAST CONCRETE ELEMENTS SHALL NOT BE LIFTED UNTIL IT HAS ATTAINED A COMPRESSIVE STRENGTH OF 45 N/mm².
 - ALL SURFACES OF PRECAST CONCRETE ELEMENTS WHICH WILL BE IN CONTACT WITH IN-SITU CONCRETE SHALL BE TREATED TO REMOVE THE LANTANCE AND EXPOSE THE LAUNDER ADEQUATE TO THE SATISFACTION OF THE ENGINEER.
 - NO WORKING SHALL BE ALLOWED IN STRUCTURAL MEMBERS WITHOUT PRIOR WRITTEN APPROVAL OF THE ENGINEER. THE DETAILS AND EXACT POSITION OF ANY MEMBER IN STRUCTURAL MEMBERS SHALL BE SUBMITTED TO THE SATISFACTION OF ENGINEER, UNLESS NOTED OTHERWISE.
 - TWO LIFTING HOOPS WERE PROVIDED AT ONE-THIRD AND TWO-THIRD POSITIONS OF EACH PLAIN.
 - ALL CHAMBERS TO EXPOSED CONCRETE ANGLES ARE ISSUES UNLESS OTHERWISE STATED.
 - EXACT LOCATIONS AND DIMENSIONS OF SAFETY BARRIERS AND PEDESTRIAN BARRIERS WERE SUBMITTED BY THE CONTRACTOR TO THE APPROVAL OF ENGINEER.
 - WELDED DOWN BOLTS ARE MADE OF STAINLESS STEEL GRADE A1-60 TO BS5836.
 - NOT DIP GALVANIZATOR SHALL COMPLY WITH BS 799.
 - DRY MIX FOR PRECAST PLAINS BOLLING SHALL CONSIST OF OPC AND SAND IN THE PROPORTIONS AS BY POLYLINE.

LEGEND:-

- MPA1, MPA2, ETC. PRECAST PLAIN NUMBER
- AND LINE DESIGNATION X
- VT-A, VT-B, ETC. PRECAST SERVICES & UTILITIES THROUGH
- M1-M4, M1-A, ETC. MOVEMENT JOINT

C	AS-BUILT DRAWING	SEP 92	
B	REVISED REFER TO S.I. M	NOV. 91	
A	EXISTING SEAWALL, PANELS, SETTING-OUT LINE REVISION	NOV. 91	
A	NOTE NO. 10 ADDED	M/A/P/1	
REV. NO.	DESCRIPTION	DATE	CHECKED
1	ISSUED	12/91	W/B

Territory Development Department, Hong Kong
 Hong Kong Island And Islands Development Office
WAN CHAI RECLAMATION, PHASE I RECLAMATION AND WEST BRIDGE

WEST BRIDGE GENERAL ARRANGEMENT
 SHEET 1 OF 3

DESIGNED BY	T.L.	
CHECKED BY	T.L.	
SCALE	1:100	DRG. NO. 9B293/2301^C 圖號編號
DATE	DEC. 91	CONTRACT NO. 98-2/91 合約編號
SCALE	1:500	AS-BUILT DRAWING 實地圖
DATE	DEC. 91	CONTRACT NO. 98-2/91 合約編號
SCALE	1:500	AS-BUILT DRAWING 實地圖
DATE	DEC. 91	CONTRACT NO. 98-2/91 合約編號
SCALE	1:500	AS-BUILT DRAWING 實地圖

© COPYRIGHT RESERVED 版權所有

835703.694 E
815868.356 N

赤@赤@

SECTION A-A, B-B, C-C TO BE CUT PERPENDICULAR TO SETTING S.O.L. 50%
 1:500

