

CONSTRUCTION PHASE MITIGATION MEASURES

CM1	- The construction area and contractor' s temporary works areas should be minimised.
CM2	- Screening of construction works by hoarding / noise barriers.
CM3	- Reduction of construction period to practical minimum.
CM4	- Topsoil, where identified, should be stripped and stored for re-use.
CM5	- Hydroseeding or sheeting of soil stockpiles.
CM6	- Advance Screen Planting to Noise Barriers.
CM7	- Control night-time lighting and glare by hooding all lights.
CM8	- Ensure no run-off into streams adjacent to Site.
CM9	- Protection of existing trees on boundary of site.
CM10	- Trees unavoidably affected by the works shall be transplanted where practical.

LEGEND	
	SITE BOUNDARY
	2.5/3 STOREY DETACHED HOUSE
	2.5/3 STOREY DETACHED HOUSE
	2.5/3 STOREY SEMI-DETACHED HOUSE
	4 STOREY DUPLEX-ON-DUPLEX
	WETLAND RESTORATION AREA
	AMENITY WATER BODY
	TREE/WOODLAND VEGETATION
	LANDSCAPE FINGER PARKS - PASSIVE RECREATION
	CAR WASH SERVICE CENTRE

NOTE :
FOR WETLAND RESTORATION
AREA DESIGN, SEE WETLAND
RESTORATION PLAN

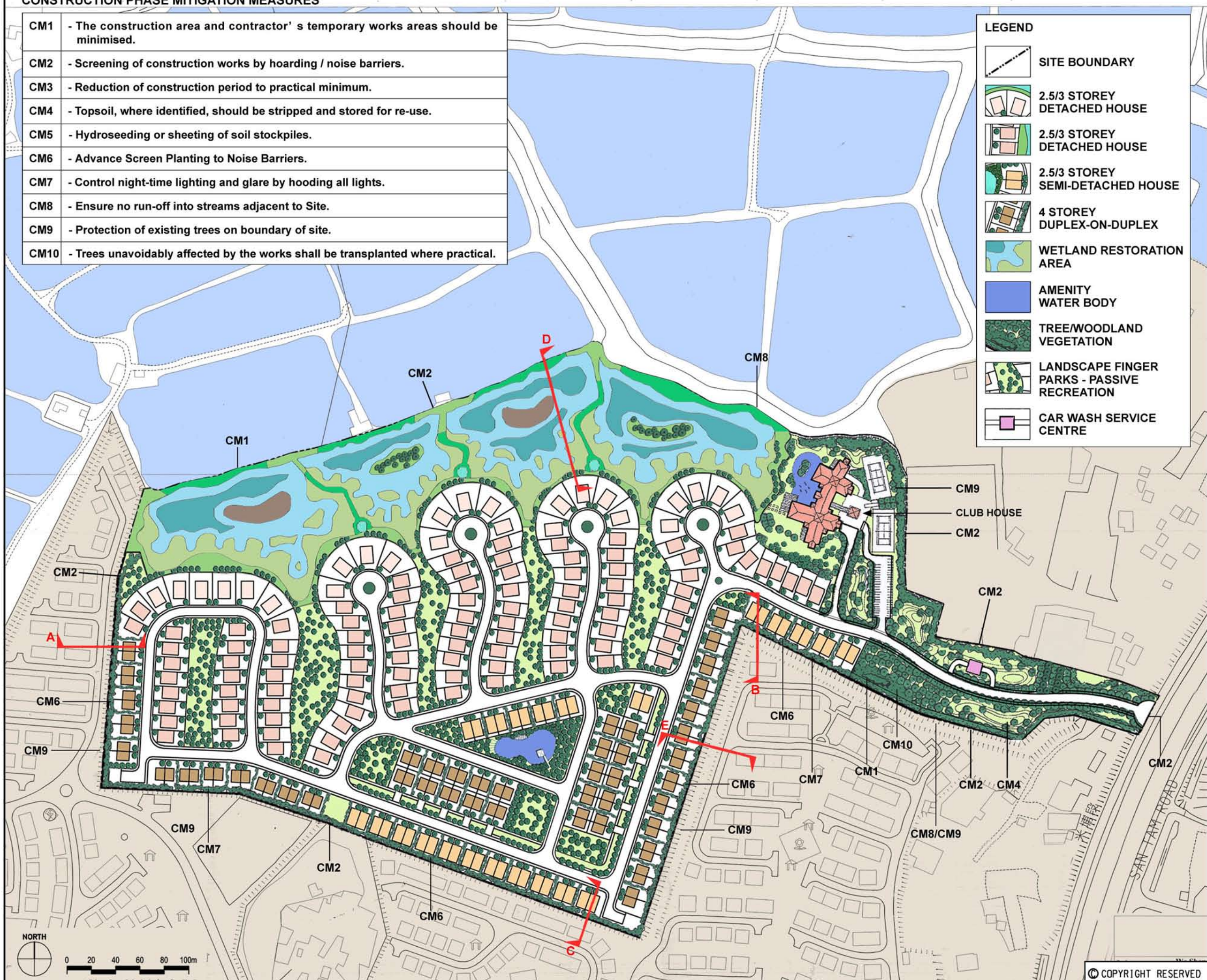

A		03/01/08		DK		GENERAL REVISION		CD		CD		
Rev	Date	Drawn/Description				Chk'd/App'd						
		Mott Connell				Mott Connell Limited 40/F Hopewell Centre 183 Queen's Road East Hong Kong Tel 2828 5757 Fax 2827 1823 Wed www.motimac.com						
Client												
PROFIT POINT ENTERPRISES LTD.												
Project												
PROPOSED COMPREHENSIVE DEVELOPMENT AT WO SHANG WAI, YUEN LONG												
Title												
LANDSCAPE AND VISUAL MITIGATION MEASURES (2 OF 7)												
Designed				Eng.Chk.								
Drawn	DK			Coordination								
Dwg.Chk.	CD			Approved		CD						
Scale			Project	221005						Status		
			CAD File									
Drawing No.										FIGURE 11.24B	Rev	A

© COPYRIGHT RESERVED