

LEGENDS:

- LANDSCAPE IMPACT ASSESSMENT AREA (500m FROM SITE)
- PROJECT AREA
- LANDSCAPE RESOURCE WITH REF. No.

SIGNIFICANCE OF LANDSCAPE IMPACT

- SLIGHT POSITIVE
- INSUBSTANTIAL
- SLIGHT NEGATIVE
- MODERATE NEGATIVE
- SUBSTANTIAL NEGATIVE

A	03/01/08	PL	GENERAL REVISION	CD	CD
Rev	Date	Drawn	Description	Ch'k'd App'd	



Mott Connell Limited
40/F Hopewell Centre
183 Queen's Road East
Hong Kong
Tel 2828 5757
Fax 2827 1823
Wed www.mottmac.com

Client
PROFIT POINT ENTERPRISES LTD.

Project
PROPOSED COMPREHENSIVE DEVELOPMENT
AT WO SHANG WAI, YUEN LONG

Title
LANDSCAPE RESOURCES IMPACTS
IN CONSTRUCTION PHASE

Designed		Eng.Chk.		
Drawn	TAI	Coordination		
Dwg.Chk.	CD	Approved	CD	
Scale	1:4000@A1 1:8000@A3	Project	221005	Status
Drawing No.		CAD File Figure-11.27.DWG		Rev

Identity No.	Landscape Resource	Identity No.	Landscape Resource	Identity No.	Landscape Resource	Identity No.	Landscape Resource	Identity No.	Landscape Resource	Identity No.	Landscape Resource
LR1	Trees Along East Side of San Tin Highway	LR16	Fruit Trees North of Ki Lung Shan Foothills I	LR31	Trees on northern Boundary of Royal Palms	LR46	Field west of Mai Po Lo Wai	LR61	Trees beside Fishponds north of Tam Kon Chau Road	LR76	Fish Pond west of Palm Springs
LR2	Roadside Trees Surrounding Mai Po Substation	LR17	Woodland North of Ki Lung Shan Foothills II	LR32	Grassland with Seasonal Marsh Patches and Sols on Site	LR47	Pond west of Mai Po San Tsuen	LR62	Fishponds north-west of Site	LR77	Fishponds west of Palm Springs
LR3	Trees Opposite Mai Po San Tsuen	LR18	Trees on Ki Lung Shan Foothills II	LR33	Trees Group on Site	LR48	Channel west of Mai Po San Tsuen	LR63	Trees beside Fishponds northwest of Site	LR78	Trees beside Fishponds west of Palm Springs
LR4	Field East of San Tam Road	LR19	Trees on Ki Lung Shan Foothills I	LR34	Banana trees on Site	LR49	Channel beside DSD building	LR64	Fishponds north of Tam Kon Chau	LR79	Fishponds west of Palm Springs
LR5	Ponds In Field East of San Tam Road	LR20	Trees in Maple Gardens	LR35	Stream flowing from Tam Kon Chau to the site	LR50	Woodland along Castle Peak Road (Mai Po)	LR65	Trees beside Fishponds north of Tam Kon Chau	LR80	Trees beside Fishponds west of Palm Springs
LR6	Trees Behind Field east of San Tam Road	LR21	Grassland on Ki Lung Shan Foothills	LR36	Trees in Open Storage Area	LR51	Fishponds along Tam Kon Chau Road	LR66	Trees in Tam Kon Chau	LR81	Fishponds west of Palm Springs
LR7	Stream Next to Field east of San Tam Road	LR22	Trees between San Tin Highway and Maple Gardens	LR37	Not Used	LR52	Trees north of Tam Kon Chau Road	LR67	Pond south of Tam Kon Chau	LR82	Trees beside Fishponds west of Palm Springs
LR8	Pond East of San Tam Road	LR23	Chunk Kai Horticultural Nursery	LR38	Trees inside Open Storage Area	LR53	Dry Pond north of Tam Kon Chau Road	LR68	Fish Ponds south of Tam Kon Chau	LR83	Stream west of Palm Springs
LR9	Trees along East Side of San Tam Road	LR24	Trees along San Tin Highway	LR39	Trees along Castle Peak Road (Mai Po)	LR54	Fishponds south of Tam Kon Chau Road	LR69	Fishponds south-west of Tam Kon Chau	LR84	Fishponds west of Palm Springs
LR10	Drainage Channel East of San Tam Road	LR25	Pond east of Royal Palms	LR40	Trees in Cottage Area east of Castle Peak Road	LR55	Trees beside Fishponds south of Tam Kon Chau Road	LR70	Fish Pond west of Palm Springs	LR85	Trees beside Fishponds west of Palm Springs
LR11	Grassland East of San Tam Road	LR26	Field east of Royal Palms	LR41	Pond behind Mai Po San Tsuen	LR56	Fish Ponds northeast of Site	LR71	Trees beside Fish Pond west of Palm Springs	LR86	Trees in northern Palm Springs
LR12	Trees around Cottage Area east of San Tam Road	LR27	Trees east of Royal Palms	LR42	Grassland besides DSD building	LR57	Trees beside Fishponds northeast of Site	LR72	Fishponds north-west of Palm Springs	LR87	Trees in western Palm Springs
LR13	Slope adjoining San Tam Road	LR28	Trees outside Royal Palms near Palm Canyon Drive	LR43	Trees in Mai Po San Tsuen	LR58	Stream north of Tam Kon Chau Road	LR73	Fishponds west of Palm Springs	LR88	Trees in southern Palm Springs
LR14	Trees North of Scenic Heights	LR29	Drainage channel at east of site	LR44	Trees behind Mai Po San Tsuen	LR59	Trees beside Stream north of Tam Kon Chau Road	LR74	Trees beside Fishponds west of Palm Springs	LR89	Trees In Car Park in Palm Springs
LR15	Trees Inside Scenic Heights	LR30	Freshwater Marsh	LR45	Trees in Mai Po Lo Wai	LR60	Fishponds north of Tam Kon Chau Road	LR75	Fishponds west of Palm Springs	LR90	Pond In Wo Shang Wai Village

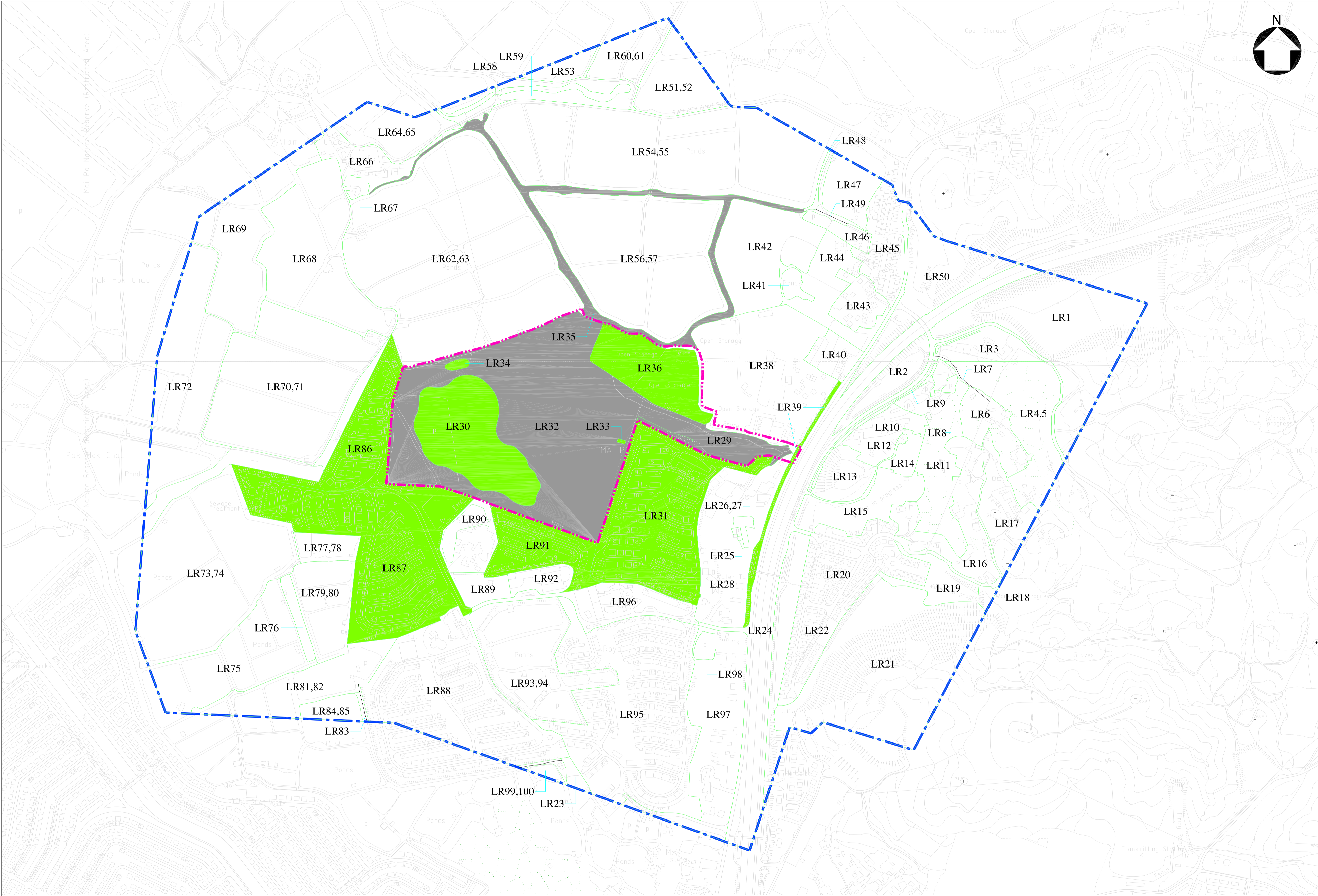

- LEGENDS:
- LANDSCAPE IMPACT ASSESSMENT AREA (500m FROM SITE)
 - PROJECT AREA
 - LANDSCAPE RESOURCE WITH REF. No.

SIGNIFICANCE OF LANDSCAPE IMPACT

- SLIGHT POSITIVE
- INSUBSTANTIAL
- SLIGHT NEGATIVE
- MODERATE NEGATIVE
- SUBSTANTIAL NEGATIVE

A	03/01/08	PL	GENERAL REVISION	CD	CD
Rev	Date	Drawn	Description	Ch'k'd App'd	



Mott Connell 萬隆

Mott Connell Limited
40/F Hopewell Centre
183 Queen's Road East
Hong Kong

Tel 2828 5757
Fax 2827 1823
Web www.mottmac.com

Client

PROFIT POINT ENTERPRISES LTD.

Project

PROPOSED COMPREHENSIVE DEVELOPMENT
AT WO SHANG WAI, YUEN LONG

Title

RESIDUAL LANDSCAPE RESOURCES IMPACTS
IN OPERATION PHASE

Designed			Eng.Chk.		
Drawn	TAI		Coordination		
Dwg.Chk.	CD		Approved	CD	
Scale	1:4000@A1 1:8000@A3	Project	221005	Status	
Drawing No.		CAD File Figure-11.28.DWG		Rev	A

Identity No.	Landscape Resource	Identity No.	Landscape Resource	Identity No.	Landscape Resource	Identity No.	Landscape Resource	Identity No.	Landscape Resource	Identity No.	Landscape Resource
LR1	Trees Along East Side of San Tin Highway	LR16	Fruit Trees North of Ki Lung Shan Foothills I	LR31	Trees on northern Boundary of Royal Palms	LR46	Field west of Mai Po Lo Wai	LR61	Trees beside Fishponds north of Tam KonChau Road	LR76	Fish Pond west of Palm Springs
LR2	Roadside Trees Surrounding Mai Po Substation	LR17	Woodland North of Ki Lung Shan Foothills II	LR32	Grassland with Seasonal Marsh Patches and Soils on Site	LR47	Pond west of Mai Po San Tsuen	LR62	Fishponds north-west of Site	LR77	Fishponds west of Palm Springs
LR3	Trees Opposite Mai Po San Tsuen	LR18	Trees on Ki Lung Shan Foothills II	LR33	Tree Group on Site	LR48	Channel west of Mai Po San Tsuen	LR63	Trees beside Fishponds northwest of Site	LR78	Trees beside Fishponds west of Palm Springs
LR4	Field East of San Tam Road	LR19	Trees on Ki Lung Shan Foothills I	LR34	Banana trees on Site	LR49	Channel beside DSD building	LR64	Fishponds north of Tam Kon Chau	LR79	Fishponds west of Palm Springs
LR5	Ponds in Field East of San Tam Road	LR20	Trees in Maple Gardens	LR35	Stream flowing from Tam Kon Chau to the site	LR50	Woodland along Castle Peak Road (Mai Po)	LR65	Trees beside Fishponds north of Tam Kon Chau	LR80	Trees beside Fishponds west of Palm Springs
LR6	Trees Behind Field east of San Tam Road	LR21	Grassland on Ki Lung Shan Foothills	LR36	Trees in Open Storage Area	LR51	Fishponds along Tam Kon Chau Road	LR66	Trees in Tam Kon Chau	LR81	Fishponds west of Palm Springs
LR7	Stream Next to Field east of San Tam Road	LR22	Trees between San Tin Highway and Maple Gardens	LR37	Not Used	LR52	Trees north of Tam Kon Chau Road	LR67	Pond south of Tam Kon Chau	LR82	Trees beside Fishponds west of Palm Springs
LR8	Pond East of San Tam Road	LR23	Chunk Kai Horticultural Nursery	LR38	Trees inside Open Storage Area	LR53	Dry Pond north of Tam Kan Chau Road	LR68	Fish Ponds south of Tam Kon Chau	LR83	Stream west of Palm Springs
LR9	Trees along East Side of San Tam Road	LR24	Trees along San Tin Highway	LR39	Trees along Castle Peak Road (Mai Po)	LR54	Fishponds south of Tam Kon Chau Road	LR69	Fishponds south-west of Tam Kon Chau	LR84	Fishponds west of Palm Springs
LR10	Drainage Channel East of San Tam Road	LR25	Pond east of Royal Palms	LR40	Trees in Cottage Area east of Castle Peak Road	LR55	Trees beside Fishponds south of Tam Kon Chau Road	LR70	Fish Pond west of Palm Springs	LR85	Trees beside Fishponds west of Palm Springs
LR11	Grassland East of San Tam Road	LR26	Field east of Royal Palms	LR41	Pond behind Mai Po San Tsuen	LR56	Fish Ponds northeast of Site	LR71	Trees beside Fish Pond west of Palm Springs	LR86	Trees in northern Palm Springs
LR12	Trees around Cottage Area east of San Tam Road	LR27	Trees east of Royal Palms	LR42	Grassland besides DSD building	LR57	Trees beside Fishponds northeast of Site	LR72	Trees in western Palm Springs	LR87	Trees in western Palm Springs
LR13	Slope adjoining San Tam Road	LR28	Trees outside Royal Palms near Palm Canyon Drive	LR43	Trees in Mai Po San Tsuen	LR58	Stream north of Tam Kon Chau Road	LR73	Fishponds west of Palm Springs	LR88	Trees in southern Palm Springs
LR14	Trees North of Scenic Heights	LR29	Drainage channel at east of site	LR44	Trees behind Mai Po San Tsuen	LR59	Trees beside Stream north of Tam Kon Chau Road	LR74	Trees beside Fishponds west of Palm Springs	LR89	Trees in Car Park in Palm Springs
LR15	Trees inside Scenic Heights	LR30	Freshwater Marsh	LR45	Trees in Mai Po Lo Wai	LR60	Fishponds north of Tam Kon Chau Road	LR75	Fishponds west of Palm Springs	LR90	Pond in Wo Shang Wai Village

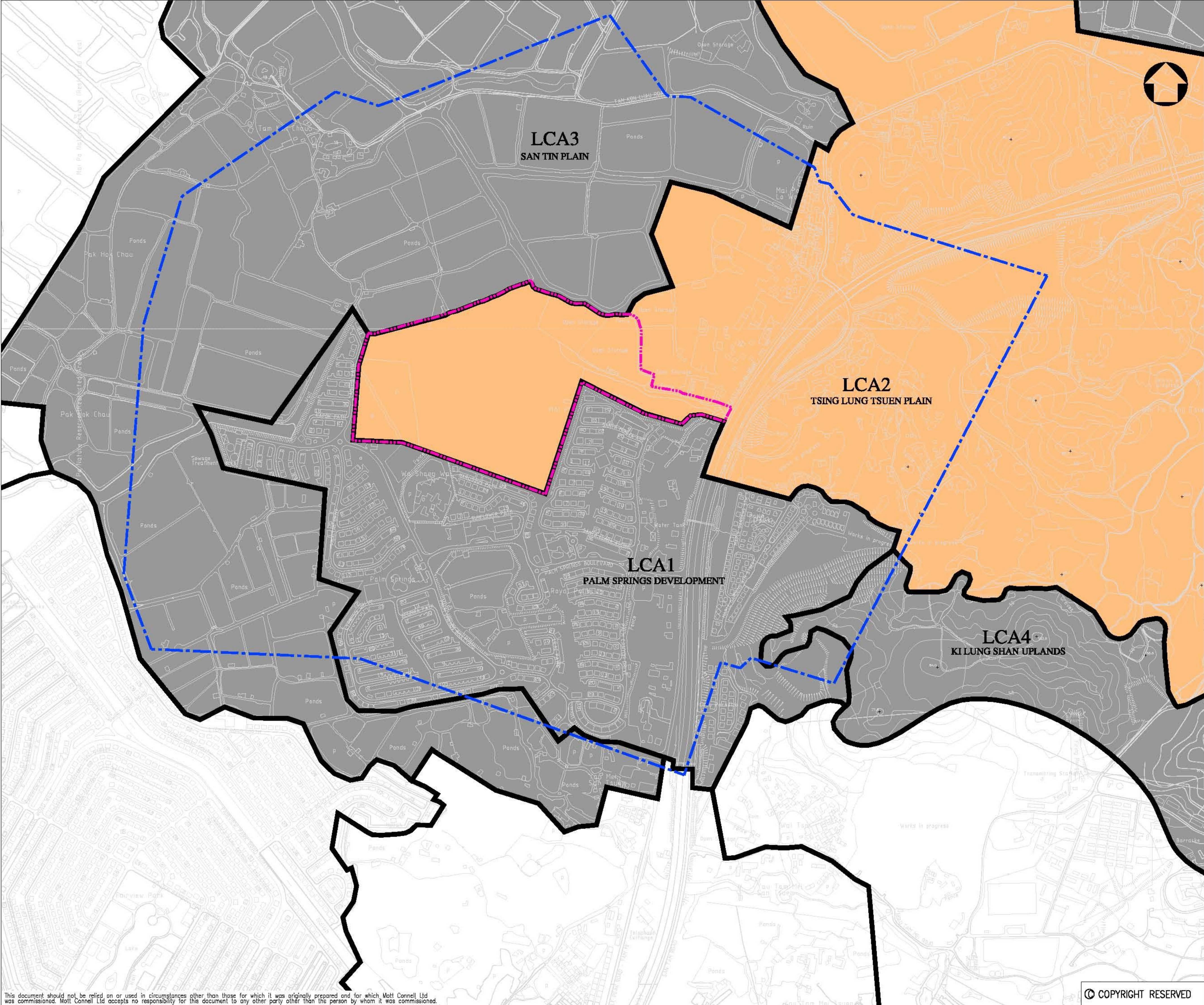

- LEGENDS:
- LANDSCAPE IMPACT ASSESSMENT AREA (500m FROM PROJECT AREA)
 - PROJECT AREA
 - BOUNDARY OF LCA

- SIGNIFICANCE OF LANDSCAPE IMPACT
- SLIGHT POSITIVE
 - INSUBSTANTIAL
 - SLIGHT NEGATIVE
 - MODERATE NEGATIVE
 - SUBSTANTIAL NEGATIVE

Rev	Date	Drawn	Description	Chk'd	App'd
<div><div><div><div><div></div><div></div></div><div><div></div><div></div></div></div><div><div>Mott Connell</div><div>183 Queen's Road East Hong Kong</div></div><div><div>Tel 2828 5757 Fax 2827 1823 Wed www.mottmac.com</div></div></div></div>					

Client	PROFIT POINT ENTERPRISES LTD.
--------	-------------------------------

Project	PROPOSED COMPREHENSIVE DEVELOPMENT AT WO SHANG WAI, YUEN LONG
---------	---

Title	RESIDUAL LANDSCAPE CHARACTER IMPACTS IN CONSTRUCTION PHASE
-------	--

Designed		Eng Chk.		
Drawn		Coordination		
Dwg Chk.		Approved		
Scale	1:4000@A1 1:8000@A3	Project	221005	Status
Drawing No.		CAD File	\$FILE	Rev

© COPYRIGHT RESERVED

FIGURE 11-29

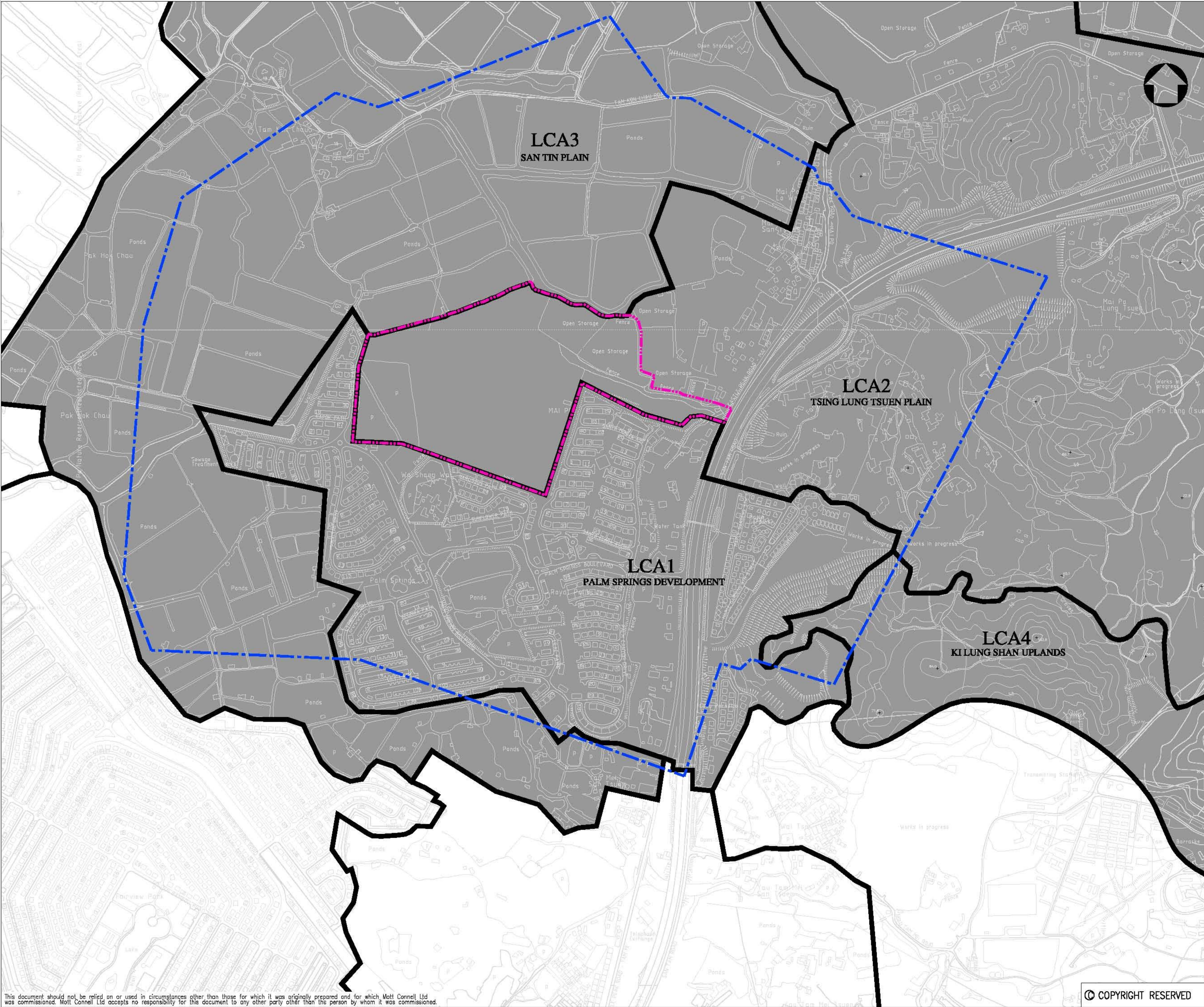

- LEGENDS:
- LANDSCAPE IMPACT ASSESSMENT AREA (500m FROM PROJECT AREA)
 - PROJECT AREA
 - BOUNDARY OF LCA

- SIGNIFICANCE OF LANDSCAPE IMPACT
- SLIGHT POSITIVE
 - INSUBSTANTIAL
 - SLIGHT NEGATIVE
 - MODERATE NEGATIVE
 - SUBSTANTIAL NEGATIVE

Rev	Date	Drawn	Description	Ch'k'd	App'd
<div><div><div><div></div><div></div></div><div>Mott Connell</div></div><div><div>Mott Connell Limited</div><div>40/F Hopewell Centre</div><div>183 Queen's Road East</div><div>Hong Kong</div></div><div><div>Tel 2828 5757</div><div>Fax 2827 1823</div><div>Wed www.mottmac.com</div></div></div>					

Client	PROFIT POINT ENTERPRISES LTD.
--------	-------------------------------

Project	PROPOSED COMPREHENSIVE DEVELOPMENT AT WO SHANG WAI, YUEN LONG
---------	---

Title	RESIDUAL LANDSCAPE CHARACTER IMPACTS IN OPERATION PHASE
-------	---

Designed		Eng Chk.		
Drawn		Coordination		
Dwg Chk.		Approved		
Scale	1:4000@A1 1:8000@A3	Project	221005	Status
Drawing No.		CAD File	\$FILE	Rev

© COPYRIGHT RESERVED

FIGURE 11-30

J:\130\DWG-GA\Figure-11_30.DWG, Layout1, 22-Jun-2007 11:42:43, san

This document should not be relied on or used in circumstances other than those for which it was originally prepared and for which Mott Connell Ltd was commissioned. Mott Connell Ltd accepts no responsibility for this document to any other party other than the person by whom it was commissioned.