

#### Appendix 4.4 On-site Noise Measurements for Existing Facilities at PTWs

North Point PTW					
Major Noise Source *	Measurement Point *	SPL, dB(A)	Distance (m)	SWL, dB(A)	Remarks
S1	P1	61.8	12	91.4	Free-field Measurement

S1 - Inlet Pumping Station

Wan Chai East PTW					
Major Noise Source *	Measurement Point *	SPL, dB(A)	Distance (m)	SWL, dB(A)	Remarks
S1	P1	68.6	16	100.7	Free-field Measurement
S2	P2	72.5	14	103.4	Free-field Measurement
S3	P3	69.7	18	102.8	Free-field Measurement

S1 - Inlet Pumping Station  
 S2 - Screening Plant Building  
 S3 - Grit Trap Area

Central PTW					
Major Noise Source *	Measurement Point *	SPL, dB(A)	Distance (m)	SWL, dB(A)	Remarks
S1	P1	69.9	21	104.3	Free-field Measurement

S1 - Inlet Pumping Station

Sandy Bay PTW					
Major Noise Source *	Measurement Point *	SPL, dB(A)	Distance (m)	SWL, dB(A)	Remarks
S1	P1	61.5	11	90.3	Free-field Measurement

S1 - Preliminary Treatment Works Complex  
 Noise generated from E&M Complex was not noticeable, thus noise measurement was not conducted.

Cyberport PTW					
Major Noise Source *	Measurement Point *	SPL, dB(A)	Distance (m)	SWL, dB(A)	Remarks
S1	P1	68.2	25	101.2	Façade Measurement

S1 - Preliminary Treatment Works Building

Aberdeen PTW					
Major Noise Source *	Measurement Point *	SPL, dB(A)	Distance (m)	SWL, dB(A)	Remarks
S1	P1	68.3	22	103.1	Free-field Measurement

S1 - Inlet Pumping Station

\* See the attached Figure A4.4 for locations of noise sources and measurement points

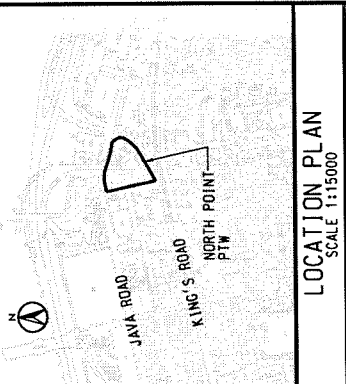
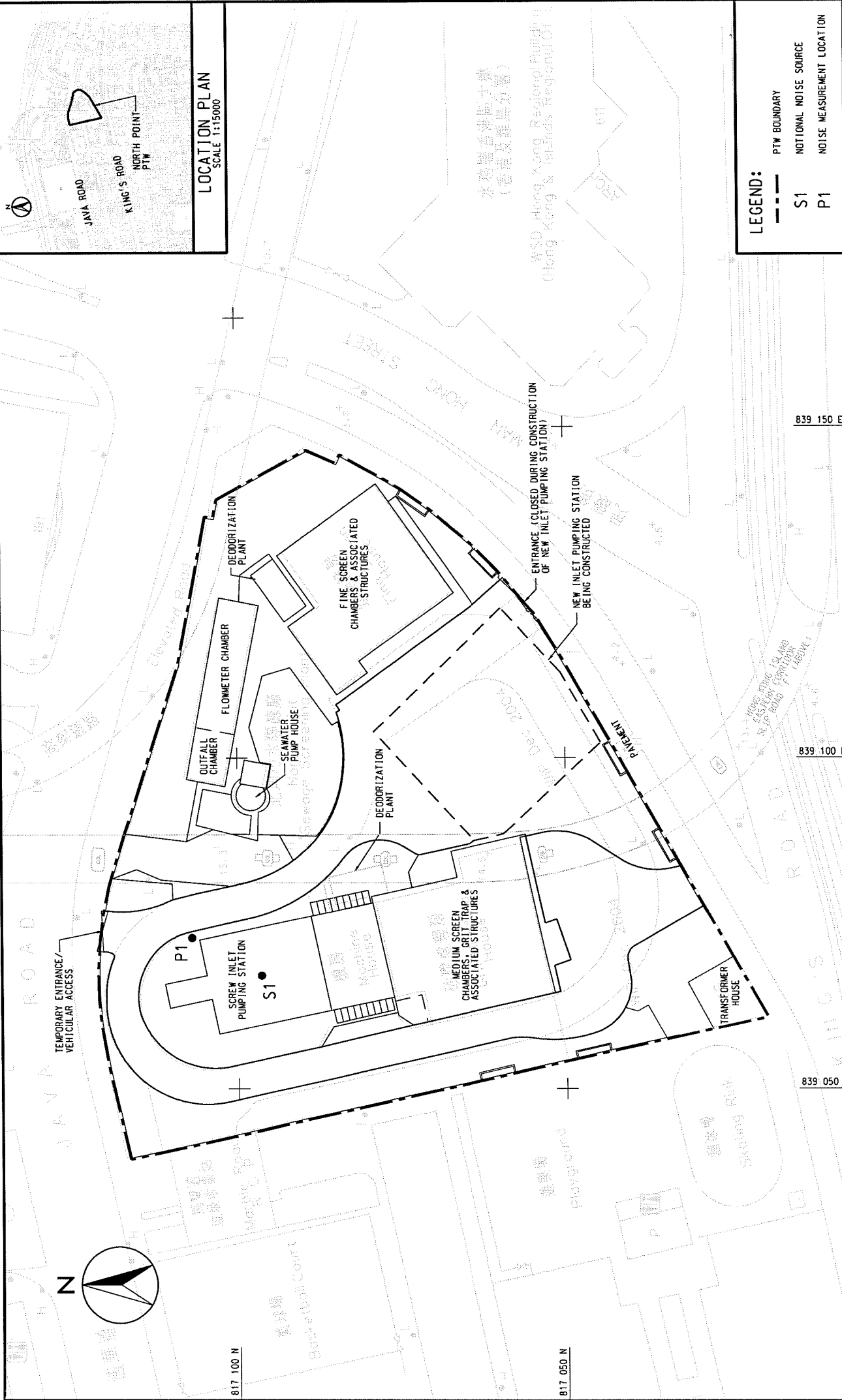

**LEGEND:**

- PTW BOUNDARY
- S1 NOTIONAL NOISE SOURCE
- P1 NOISE MEASUREMENT LOCATION

DATE	NOV 07
DRAWN	IWSL
DRAWING NO.	A4.4
REV	-

SCALE	A4 1:750
CHECK	DCFL
JOB NO.	60017198

AGREEMENT NO. CE 43/2005 (EP)  
 HARBOUR AREA TREATMENT SCHEME (HATS) STAGE 2A  
 ENVIRONMENTAL IMPACT ASSESSMENT STUDY - INVESTIGATION  
**ON-SITE NOISE MEASUREMENTS AT NORTH POINT PTW**

**ENSR | AECOM**



**LOCATION PLAN**  
SCALE 1:15000

**LEGEND:**

- PTW BOUNDARY
- S1-S3 NOTIONAL NOISE SOURCES
- P1-P3 NOISE MEASUREMENT LOCATIONS

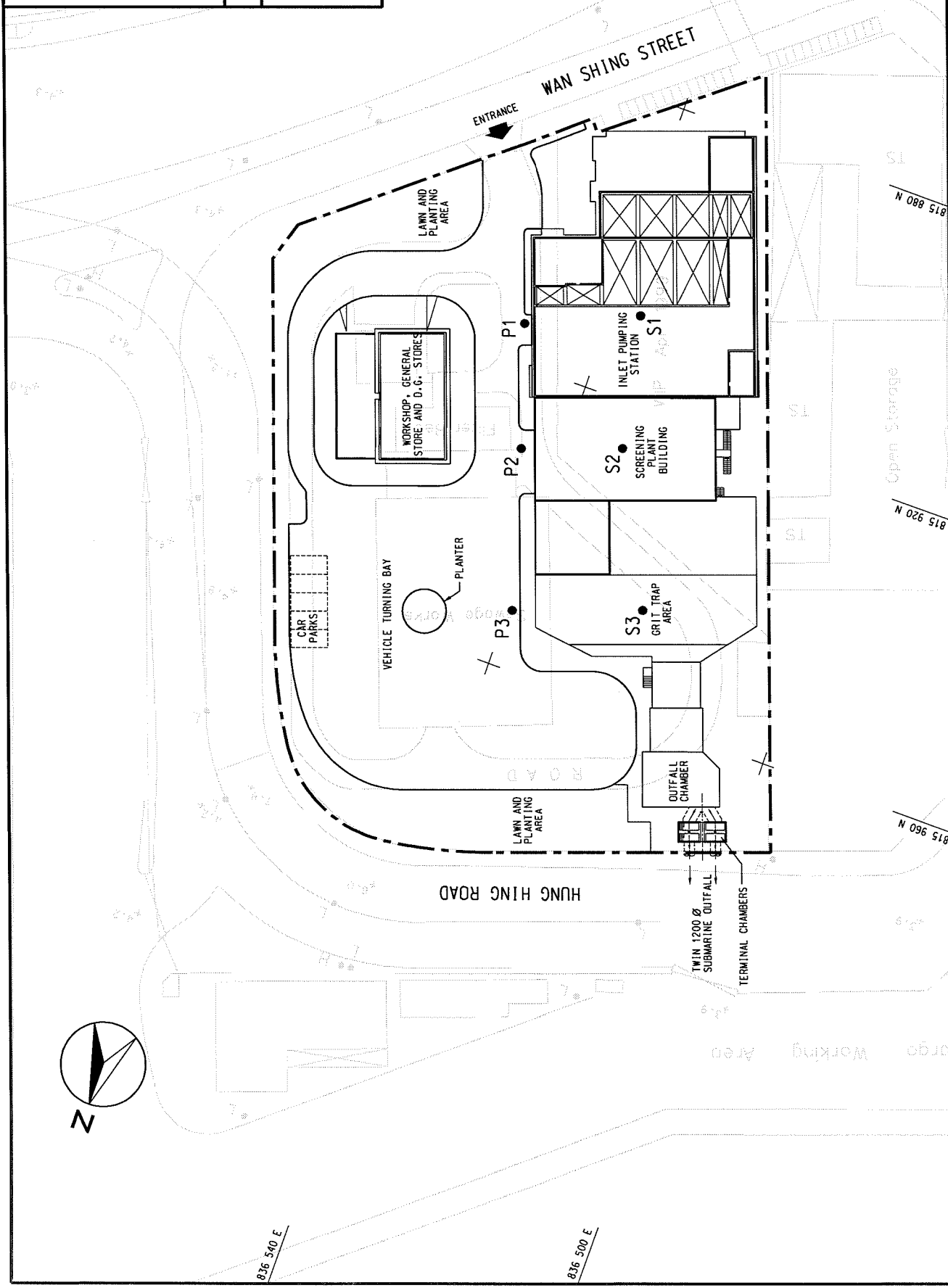
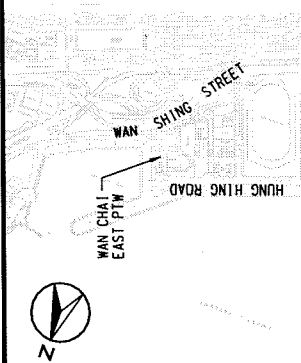

SCALE	A4 1:750	DATE	NOV 07
CHECK	DCFL	DRAWN	IWSL
JOB NO.	60017198	DRAWING NO.	A4.4
		REV	—

AGREEMENT NO. CE 43/2005 (EP)  
HARBOUR AREA TREATMENT SCHEME (HATS) STAGE 2A  
ENVIRONMENTAL IMPACT ASSESSMENT STUDY - INVESTIGATION  
**ON-SITE NOISE MEASUREMENT AT WAN CHAI EAST PTW**

**ENSR | AECOM**

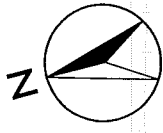

816 800 N

816 750 N

833 200 E

WESTERN FIRE SERVICES STREET

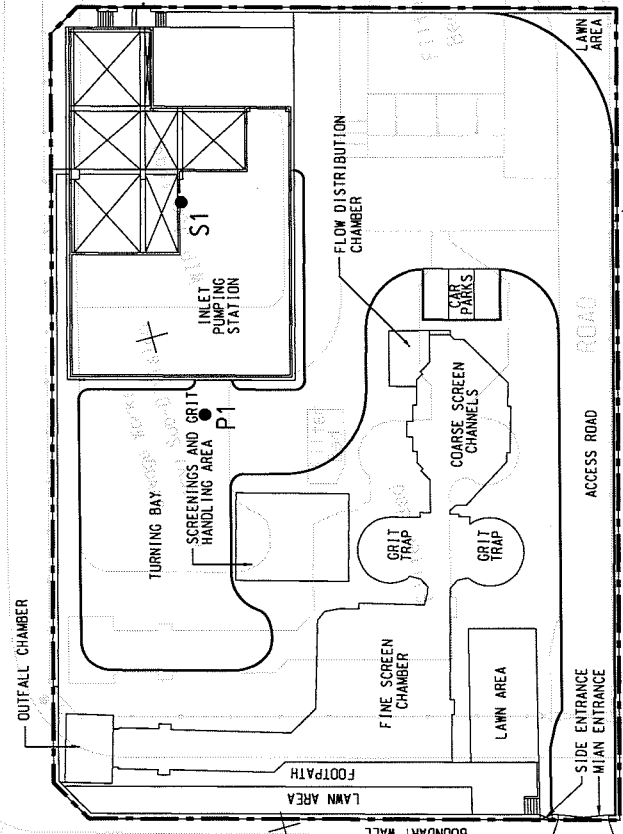

**LEGEND:**  
 --- PTW BOUNDARY  
 S1 NOTIONAL NOISE SOURCE  
 P1 NOISE MEASUREMENT LOCATION

**LOCATION PLAN**  
 SCALE 1:15000

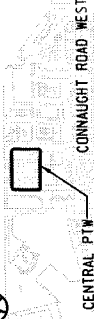

833 350 E

833 300 E

833 250 E

SCALE	A4 1:750	DATE	NOV 07
CHECK	DCFL	DRAWN	IWSL
JOB No.	60017198	DRAWING No.	A4.4
		REV	—

AGREEMENT NO. CE 43/2005 (EP)  
 HARBOUR AREA TREATMENT SCHEME (HATS) STAGE 2A  
 ENVIRONMENTAL IMPACT ASSESSMENT STUDY - INVESTIGATION  
**ON-SITE NOISE MEASUREMENT AT CENTRAL PTW**

ENSR | AECOM

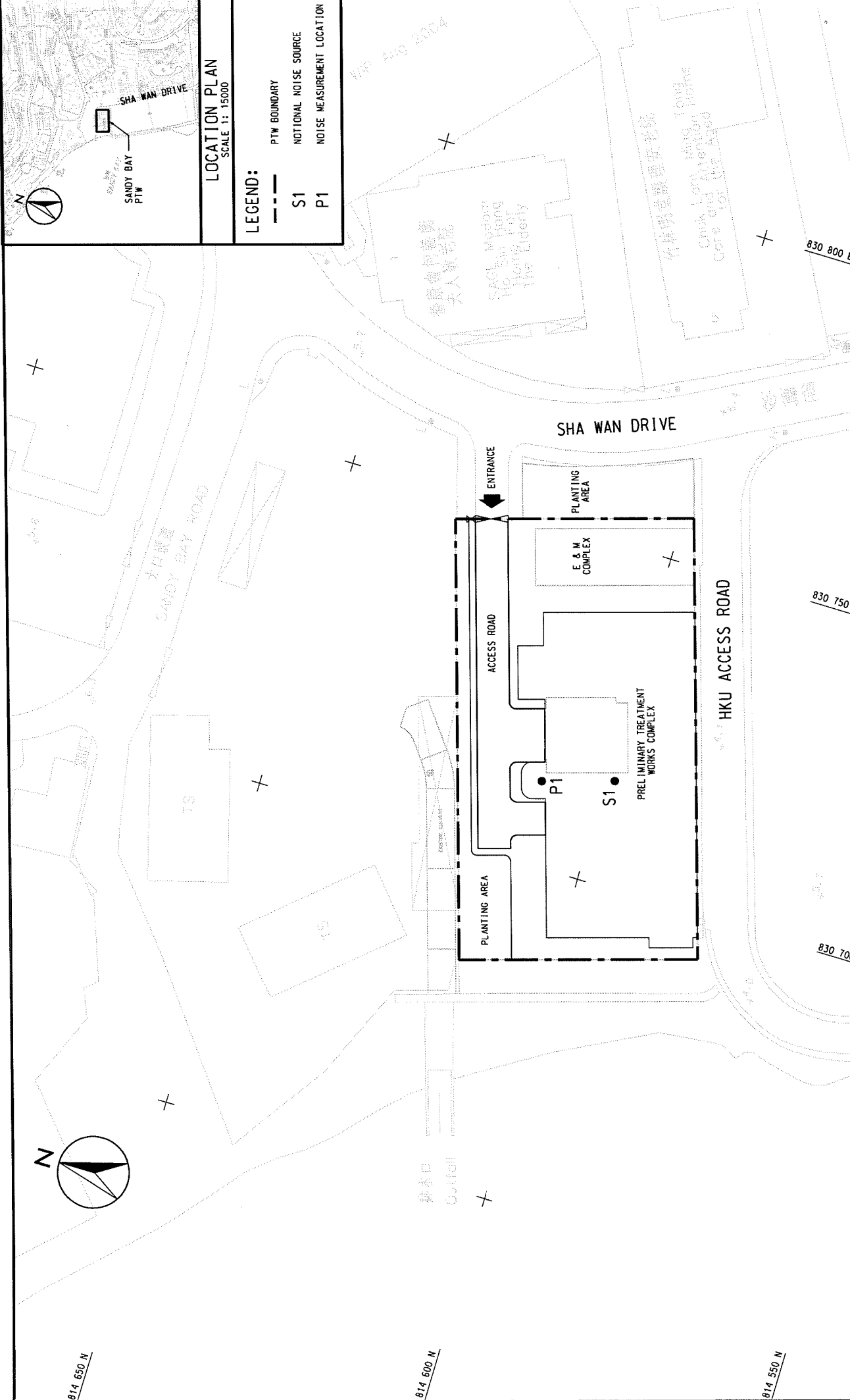

**LOCATION PLAN**  
SCALE 1:15000

- LEGEND:**
- PTW BOUNDARY
  - S1 NOTIONAL NOISE SOURCE
  - P1 NOISE MEASUREMENT LOCATION

SCALE	A4 1:750	DATE	NOV 07
CHECK	DCFL	DRAWN	IWSL
JOB No.	60017198	DRAWING NO.	A4.4
		REV	—

AGREEMENT NO. CE 43/2005 (EP)  
 HARBOUR AREA TREATMENT SCHEME (HATS) STAGE 2A  
 ENVIRONMENTAL IMPACT ASSESSMENT STUDY - INVESTIGATION  
**ON-SITE NOISE MEASUREMENT AT SANDY BAY PTW**

**ENSR | AECOM**

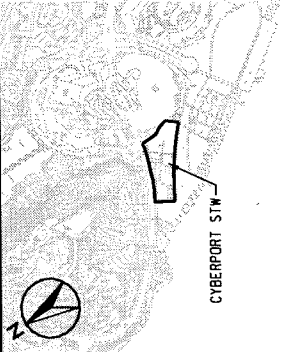

CYBERPORT STW

**LOCATION PLAN**  
SCALE 1:15000

**LEGEND:**

- PTW BOUNDARY
- S1 NOTIONAL NOISE SOURCE
- P1 NOISE MEASUREMENT LOCATION

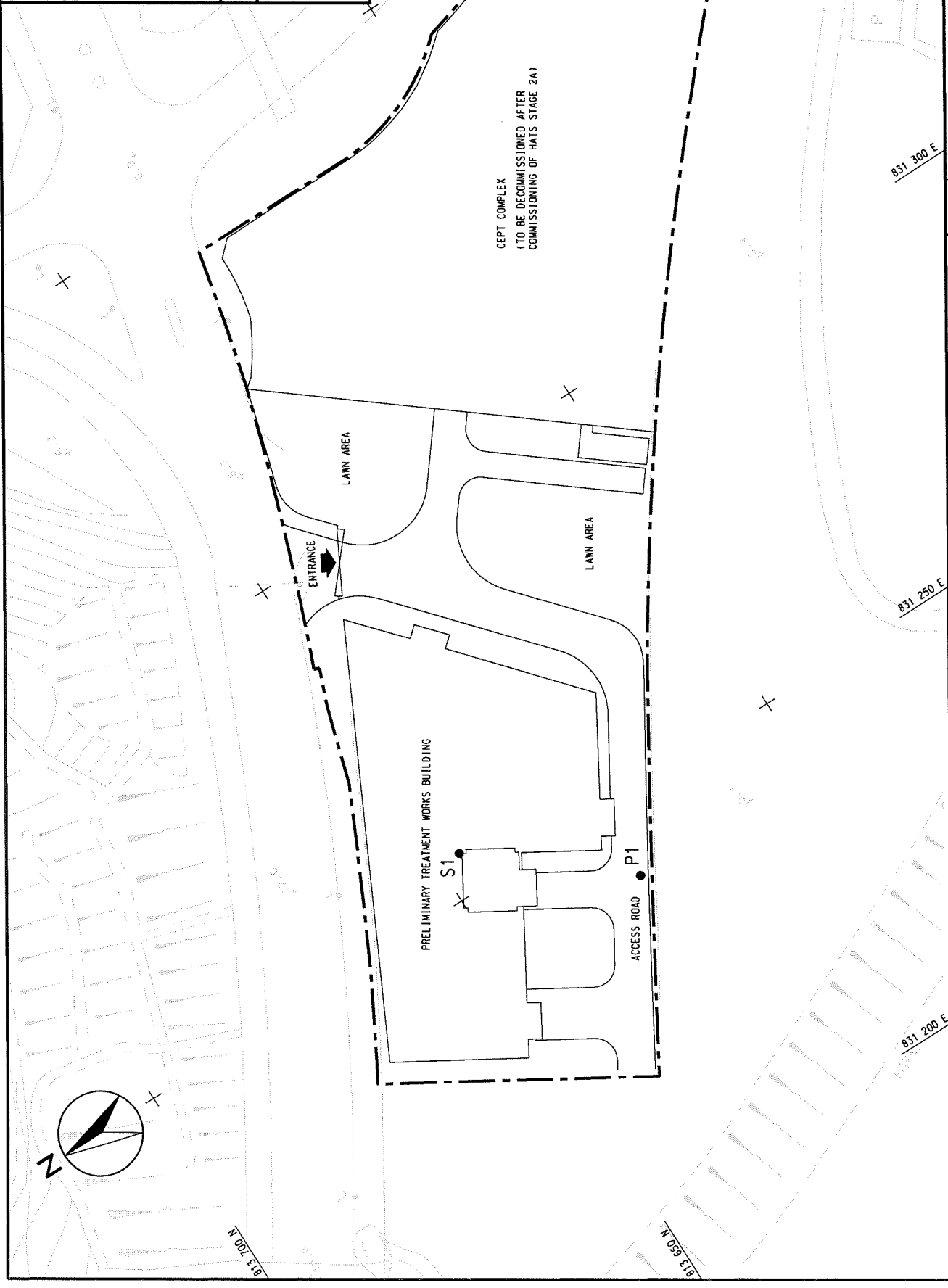

SCALE	A4 1:750	DATE	NOV 07
CHECK	DCFL	DRAWN	IWSL
JOB No.	60017198	DRAWING No.	A4.4
		REV	-

AGREEMENT NO. CE 43/2005 (EP)  
 HARBOUR AREA TREATMENT SCHEME (HATS) STAGE 2A  
 ENVIRONMENTAL IMPACT ASSESSMENT STUDY - INVESTIGATION  
**ON-SITE NOISE MEASUREMENT AT CYBERPORT PTW**



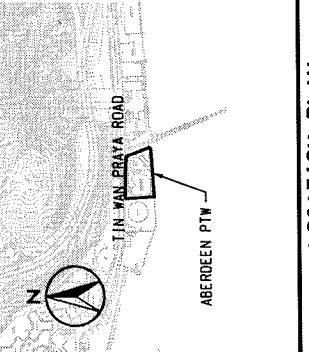

**LOCATION PLAN**  
SCALE 1: 15000

- LEGEND:**
- PTW BOUNDARY
  - S1 NOTIONAL NOISE SOURCE
  - P1 NOISE MEASUREMENT LOCATION

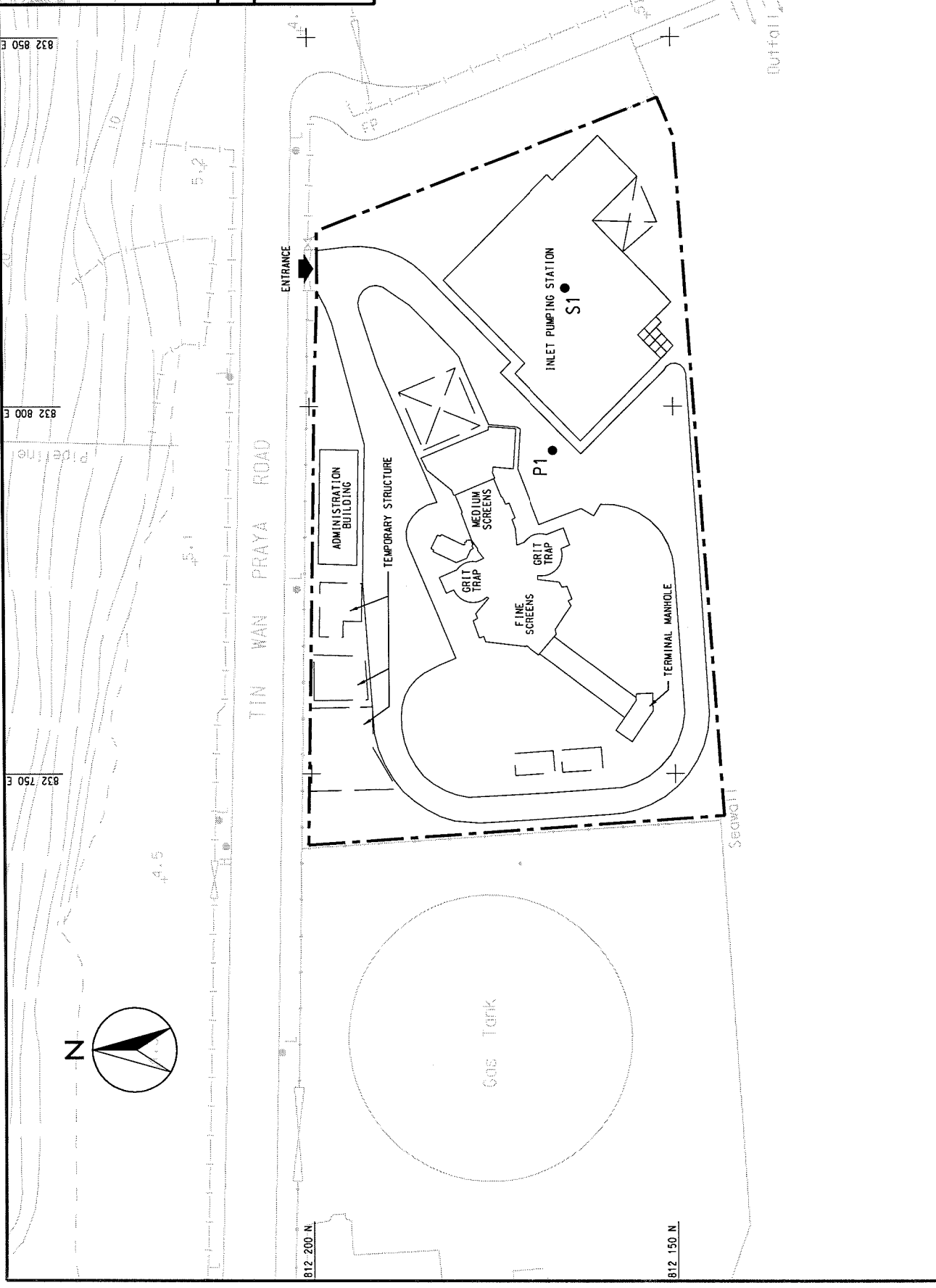

SCALE	A4 1:750	DATE	NOV 07
CHECK	DCFL	DRAWN	IWSL
JOB No.	60017198	DRAWING No.	A4.4
		REV	-

AGREEMENT NO. CE 43/2005 (EP)  
HARBOUR AREA TREATMENT SCHEME (HATS) STAGE 2A  
ENVIRONMENTAL IMPACT ASSESSMENT STUDY - INVESTIGATION  
**ON-SITE NOISE MEASUREMENTS AT ABERDEEN PTW**

**ENSR | AECOM**

P:\60017198\DRAWINGS\DRAWINGS\REPORT\EIA\AB\_NOISE\NOV\_07\06001.dgn