

ENSR | AECOM

HARBOUR AREA TREATMENT SCHEME (HATS) STAGE 2A ENVIRONMENTAL IMPACT ASSESSMENT STUDY - INVESTIGATION  
 LAYOUT OF PROPOSED UPGRADE WORKS AND  
 LOCATIONS OF ODOUR EMISSION SOURCES - NORTH POINT PTW

AGREEMENT NO. CE 43/2005 (EP)

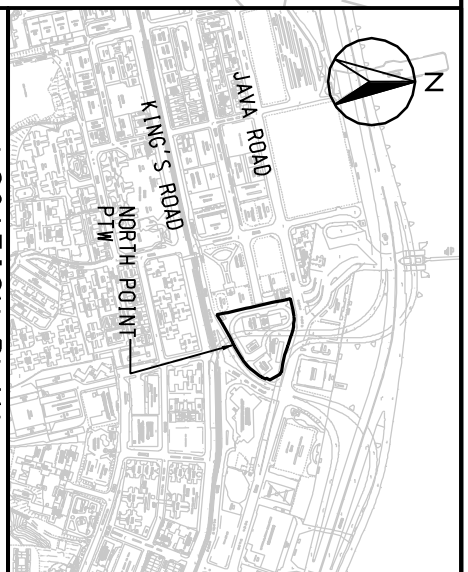
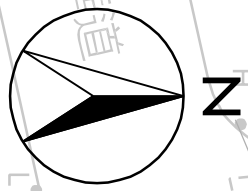
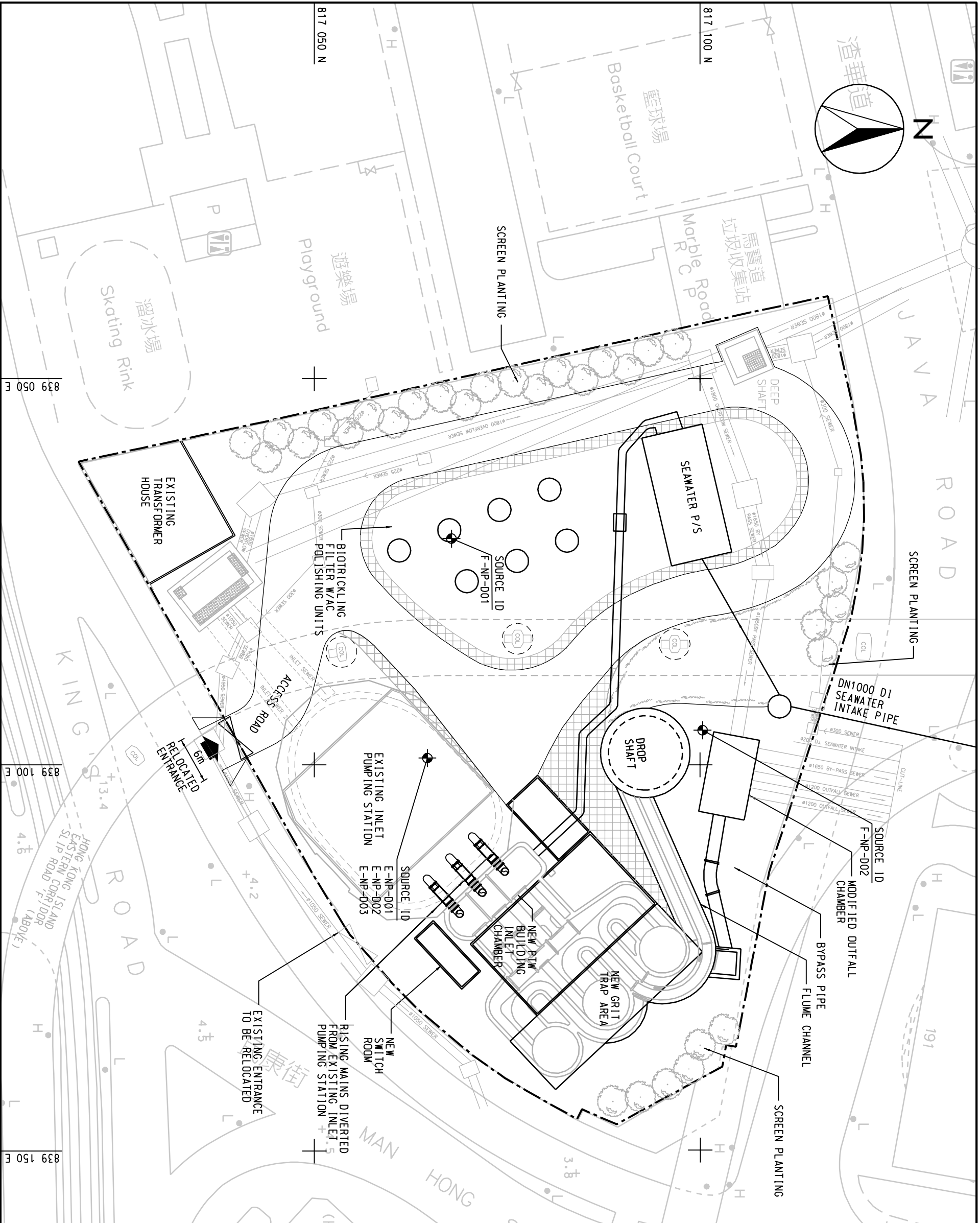

LOCATION PLAN  
SCALE 1:10000

LEGEND:

- PTW BOUNDARY
- BLOCK-PAVING AREA
- EXHAUST POINTS OF DEODORIZERS

SCALE	A3 1:500	DATE	SEP. 07
CHECK	-	DRAWN	LC
JOB NO.	60017198	FIGURE NO.	3.10
		REV	-

ENSR  
AECOM

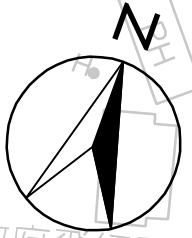
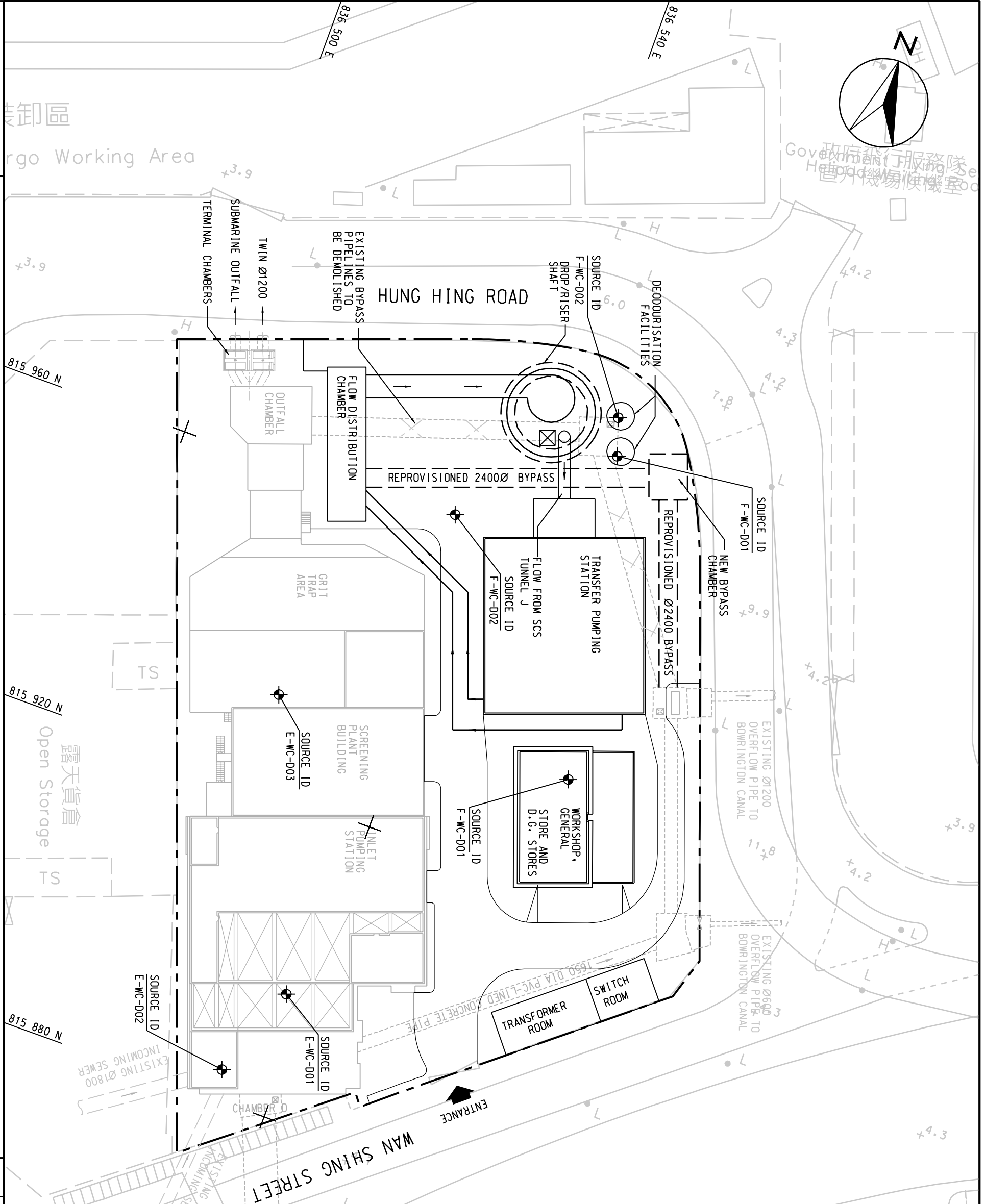

Government飛行服務隊  
香港國際機場  
離地機場候機室

HARBOUR AREA TREATMENT SCHEME (HATS) STAGE 2A ENVIRONMENTAL IMPACT ASSESSMENT STUDY - INVESTIGATION  
LAYOUT OF PROPOSED UPGRADE WORKS AND  
LOCATIONS OF ODOUR EMISSION SOURCES - WAN CHAI EAST PTW

AGREEMENT NO. CE 43/2005 (EP)

SCALE	A3 1:500	DATE	SEP. 07
CHECK	-	DRAWN	LC
JOB NO.	60017198	FIGURE NO.	3.11
		REV	-

**LEGEND:**

- PTW BOUNDARY
- EXHAUST POINTS OF DEODORIZERS

**LOCATION PLAN**  
SCALE 1:10000

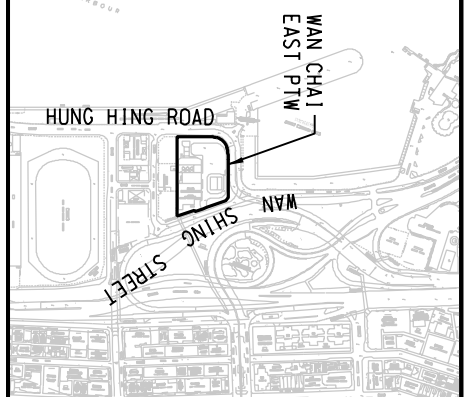

**ENSR** | **AECOM**

HARBOUR AREA TREATMENT SCHEME (HATS) STAGE 2A ENVIRONMENTAL IMPACT ASSESSMENT STUDY - INVESTIGATION  
 LAYOUT OF PROPOSED UPGRADE WORKS AND  
 LOCATIONS OF ODOUR EMISSION SOURCES - CENTRAL PTW

AGREEMENT NO. CE 43/2005 (EP)

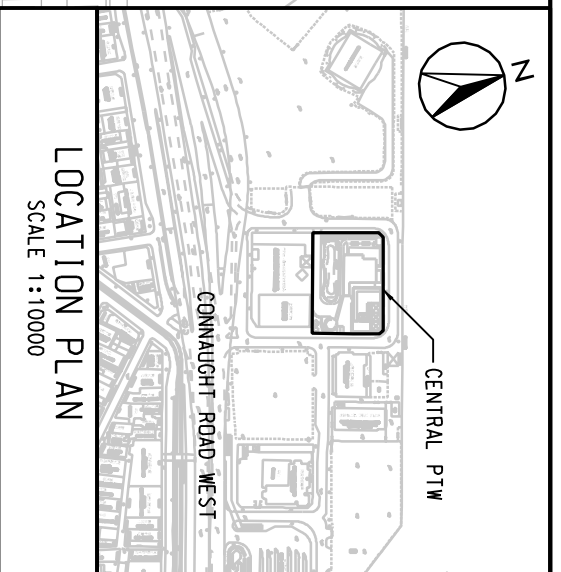
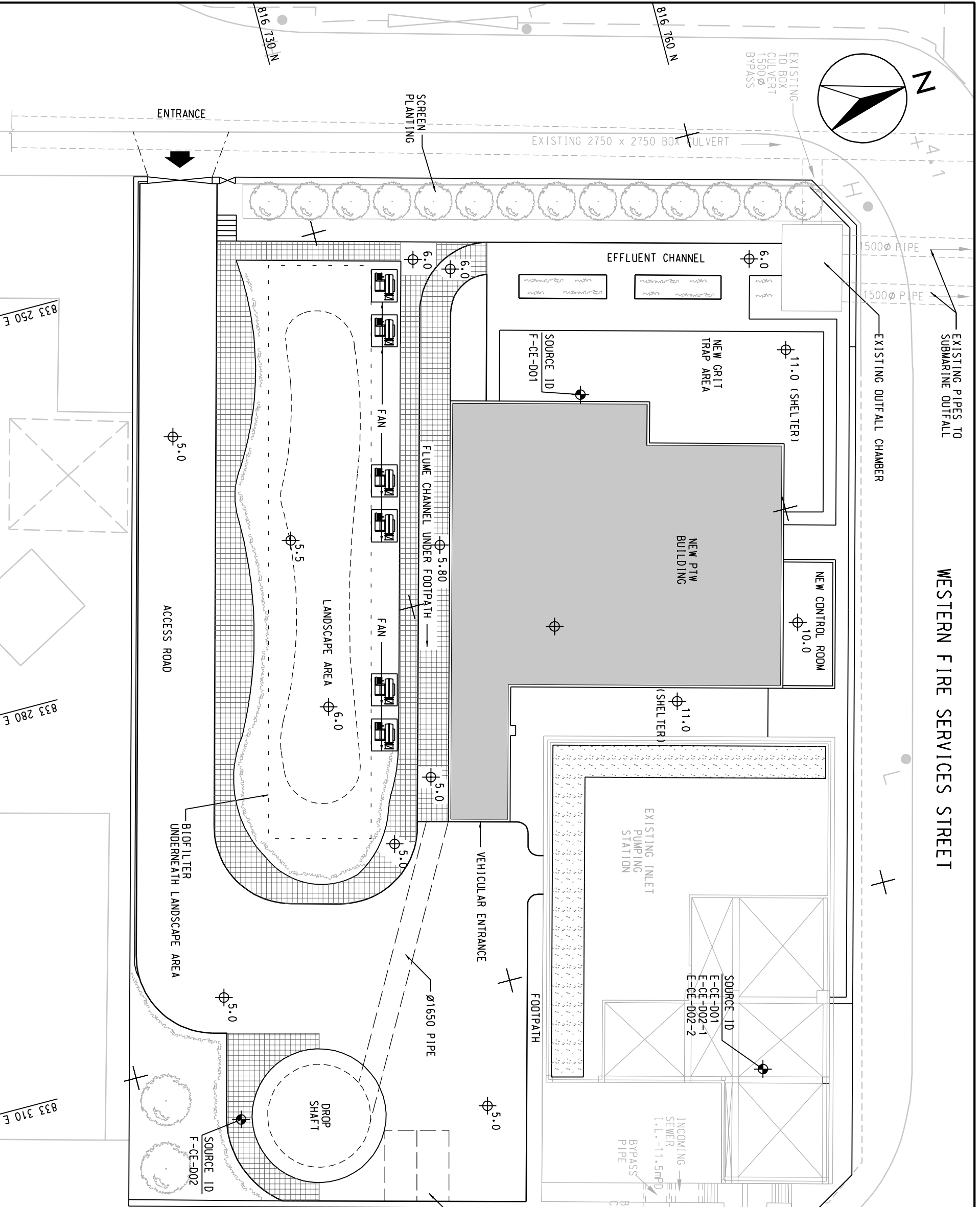

**LEGEND:**

	AREA FOR POTTED/ REMOVABLE PLANTER LANDSCAPE
	BLOCK-PAVING FOOTPATH
	SHRUB AREA
	EXHAUST POINTS OF DEODORIZERS

SCALE	A3 1:300	DATE	SEP. 07
CHECK	-	DRAWN	LC
JOB NO.	60017198	FIGURE NO.	3.12
		REV	-



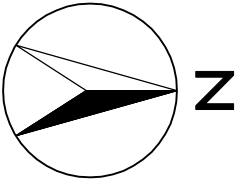

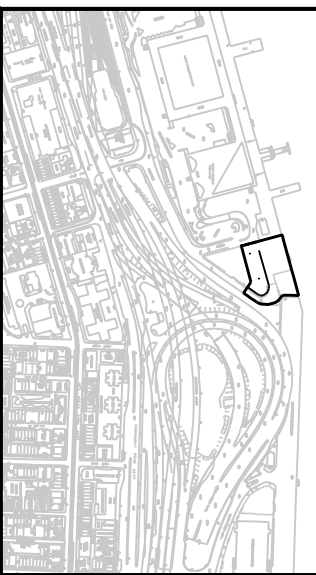

832400 E

832500 E



LOCATION PLAN  
SCALE 1 : 20000

- LEGEND:**
-  SITE BOUNDARY
  -  EXHAUST POINT OF DEODORIZER

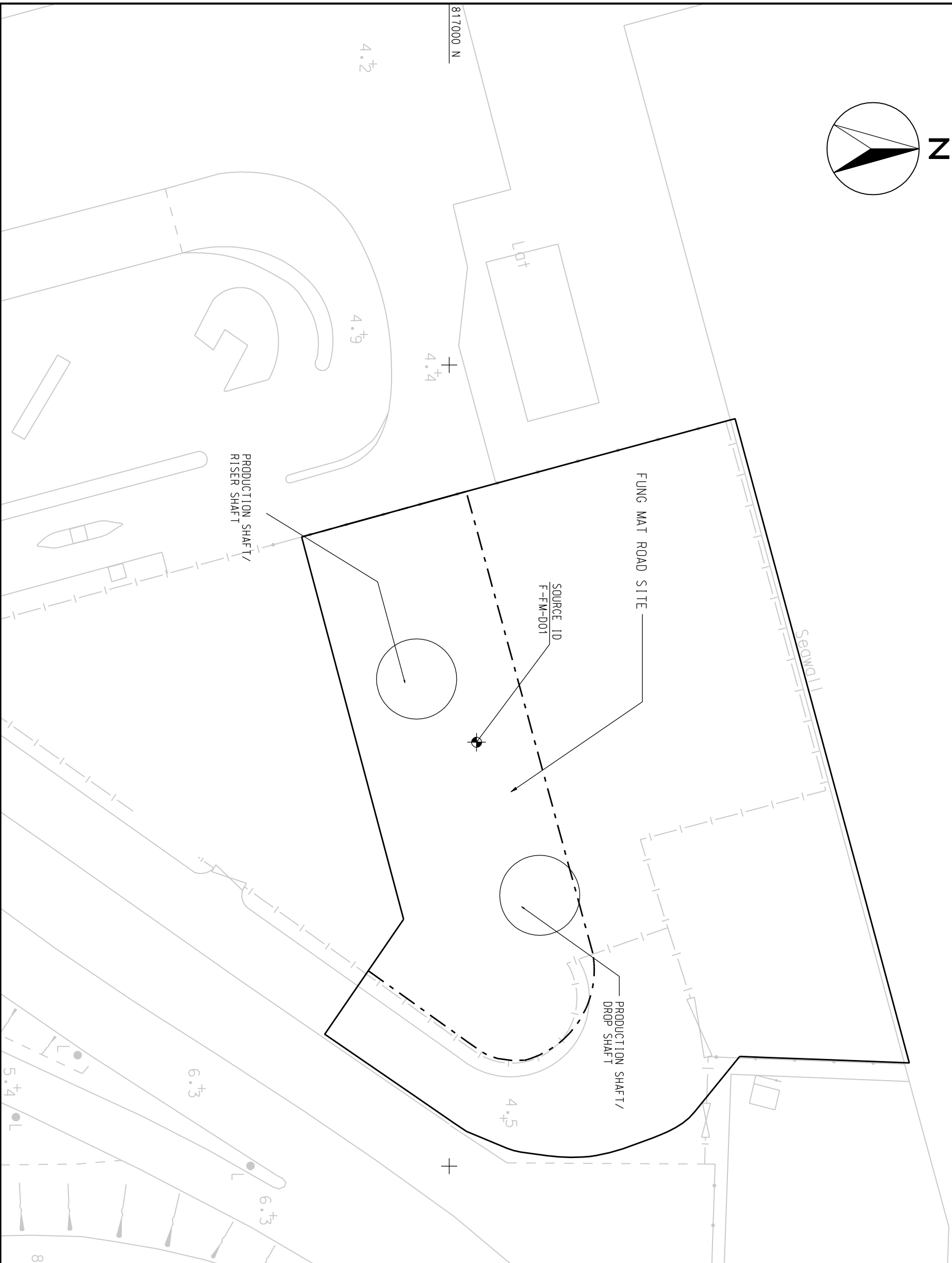

AGREEMENT NO. CE 43/2005 (EP)  
HARBOUR AREA TREATMENT SCHEME (HATS) STAGE 2A ENVIRONMENTAL IMPACT ASSESSMENT STUDY - INVESTIGATION  
LAYOUT OF PROPOSED UPGRADE WORKS AND  
LOCATION OF ODOUR EMISSION SOURCE - FUNG MAT ROAD SITE

\$DATE\$ \$TIME\$ \$USER\$

SCALE	A3 1:500	DATE	SEP 07
CHECK	SWCW	DRAWN	VCYL
JOB NO.	60017198	FIGURE NO.	3.13
		REV	-

\$FILES

ENSR | AECOM

HARBOUR AREA TREATMENT SCHEME (HATS) STAGE 2A ENVIRONMENTAL IMPACT ASSESSMENT STUDY - INVESTIGATION  
 AGREEMENT NO. CE 43/2005 (EP)  
 LAYOUT OF PROPOSED UPGRADE WORKS AND  
 LOCATIONS OF ODOUR EMISSION SOURCES - SANDY BAY PTW

SCALE	A3 1:500	DATE	SEP. 2007
CHECK	-	DRAWN	LC
JOB NO.	60017198	FIGURE NO.	3.14
		REV	-

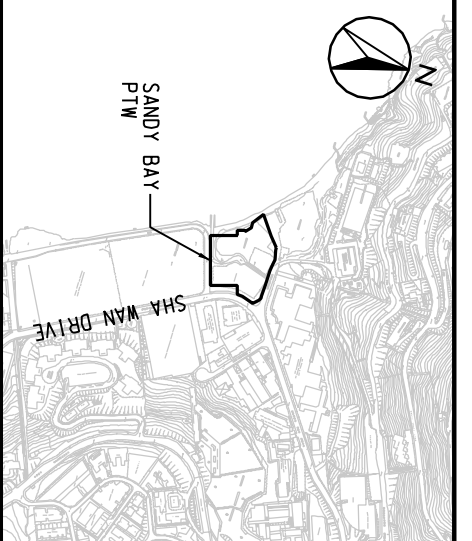
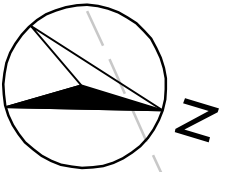
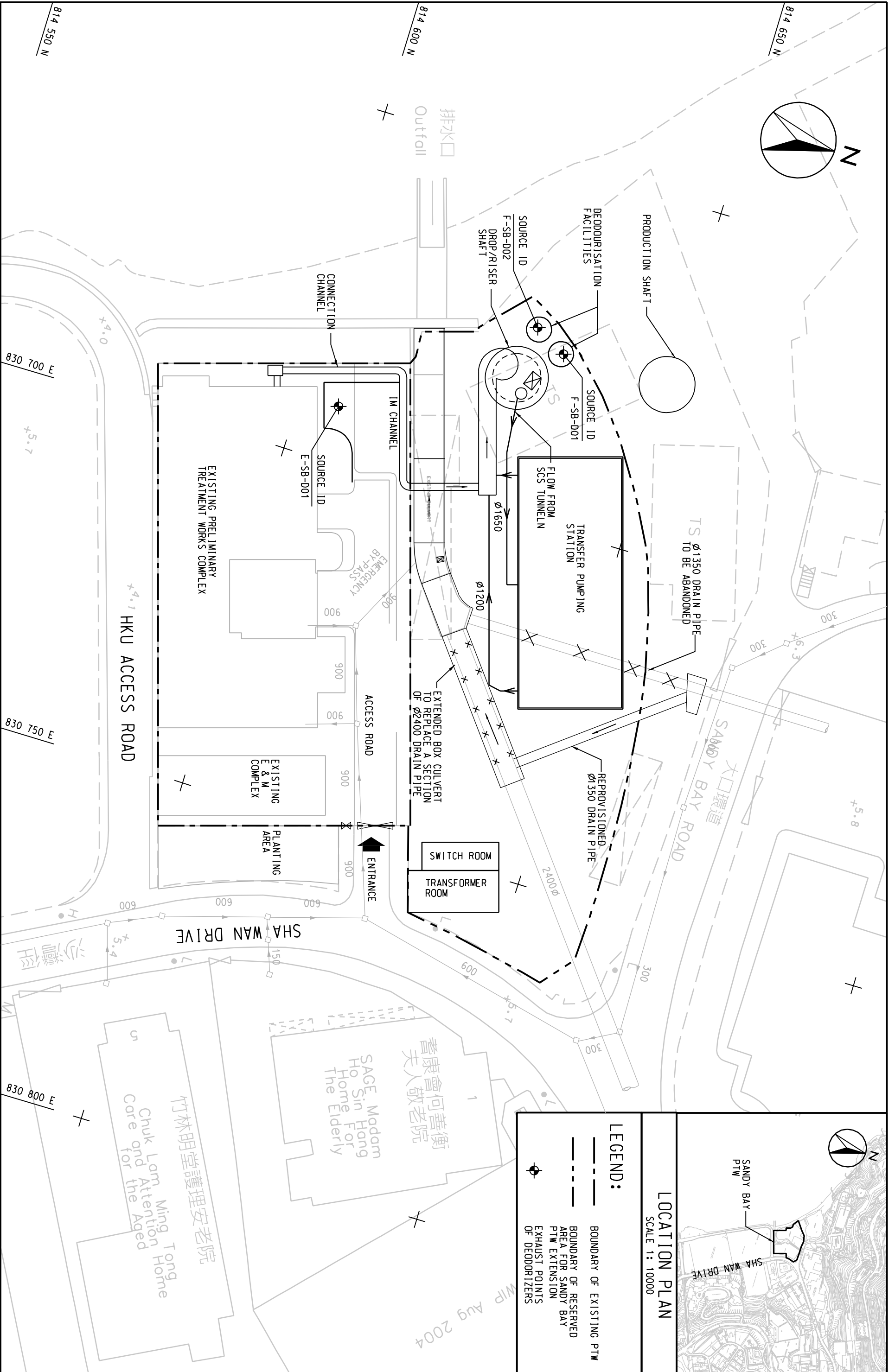

LOCATION PLAN  
 SCALE 1: 10000

**LEGEND:**

- BOUNDARY OF EXISTING PTW
- BOUNDARY OF RESERVED AREA FOR SANDY BAY PTW EXTENSION
- EXHAUST POINTS OF DEODORIZERS

MIP Aug 2004

**ENSR** | **AECOM**

HARBOUR AREA TREATMENT SCHEME (HATS) STAGE 2A ENVIRONMENTAL IMPACT ASSESSMENT STUDY - INVESTIGATION  
 LAYOUT OF PROPOSED UPGRADE WORKS AND  
 LOCATIONS OF ODOUR EMISSION SOURCES - CYBERPORT PTW

AGREEMENT NO. CE 43/2005 (EP)

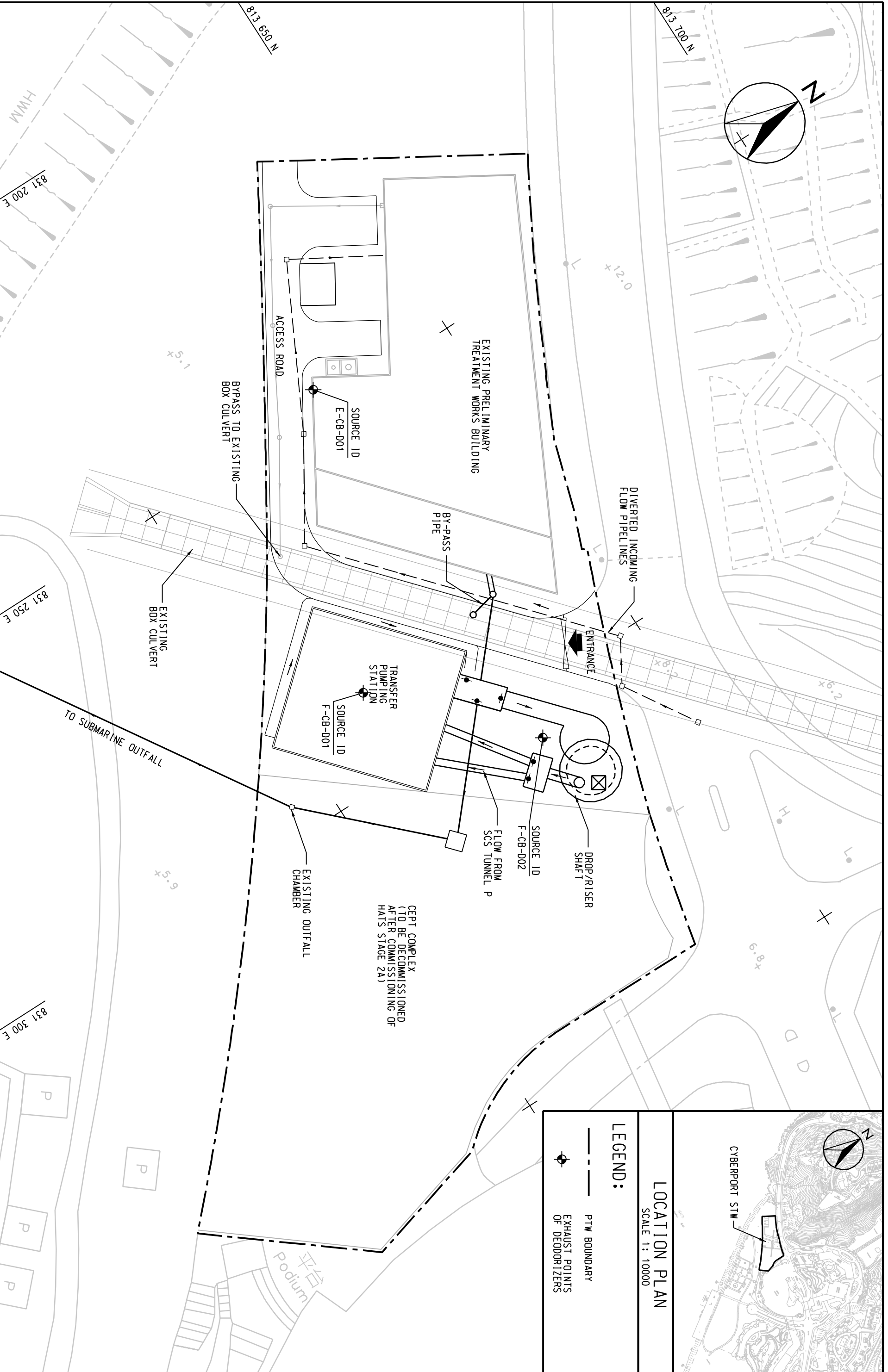

**LOCATION PLAN**  
 SCALE 1 : 10000

- LEGEND:**
- PTW BOUNDARY
  - ⊕ EXHAUST POINTS OF DEODORIZERS

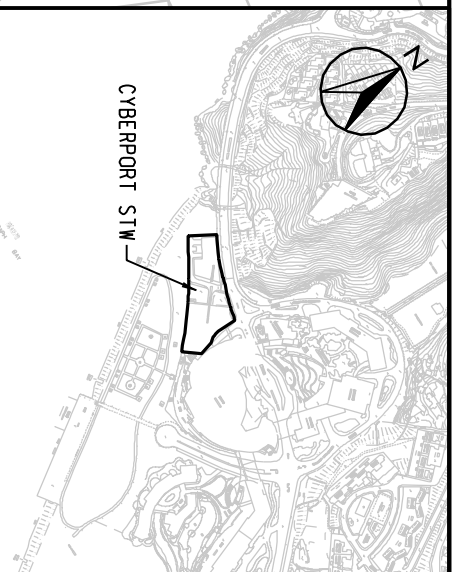

SCALE	A3 1:500	DATE	SEP. 07
CHECK	-	DRAWN	LC
JOB NO.	60017198	FIGURE NO.	3.15
		REV	-

**ENSR** | **AECOM**

HARBOUR AREA TREATMENT SCHEME (HATS) STAGE 2A ENVIRONMENTAL IMPACT ASSESSMENT STUDY - INVESTIGATION  
 LAYOUT OF PROPOSED UPGRADE WORKS AND  
 LOCATIONS OF ODOUR EMISSION SOURCES - WAH FU PTW

AGREEMENT NO. CE 43/2005 (EP)

SCALE	A3 1:200	DATE	SEP. 07
CHECK	-	DRAWN	LC
JOB NO.	60017198	FIGURE NO.	3.16
		REV	

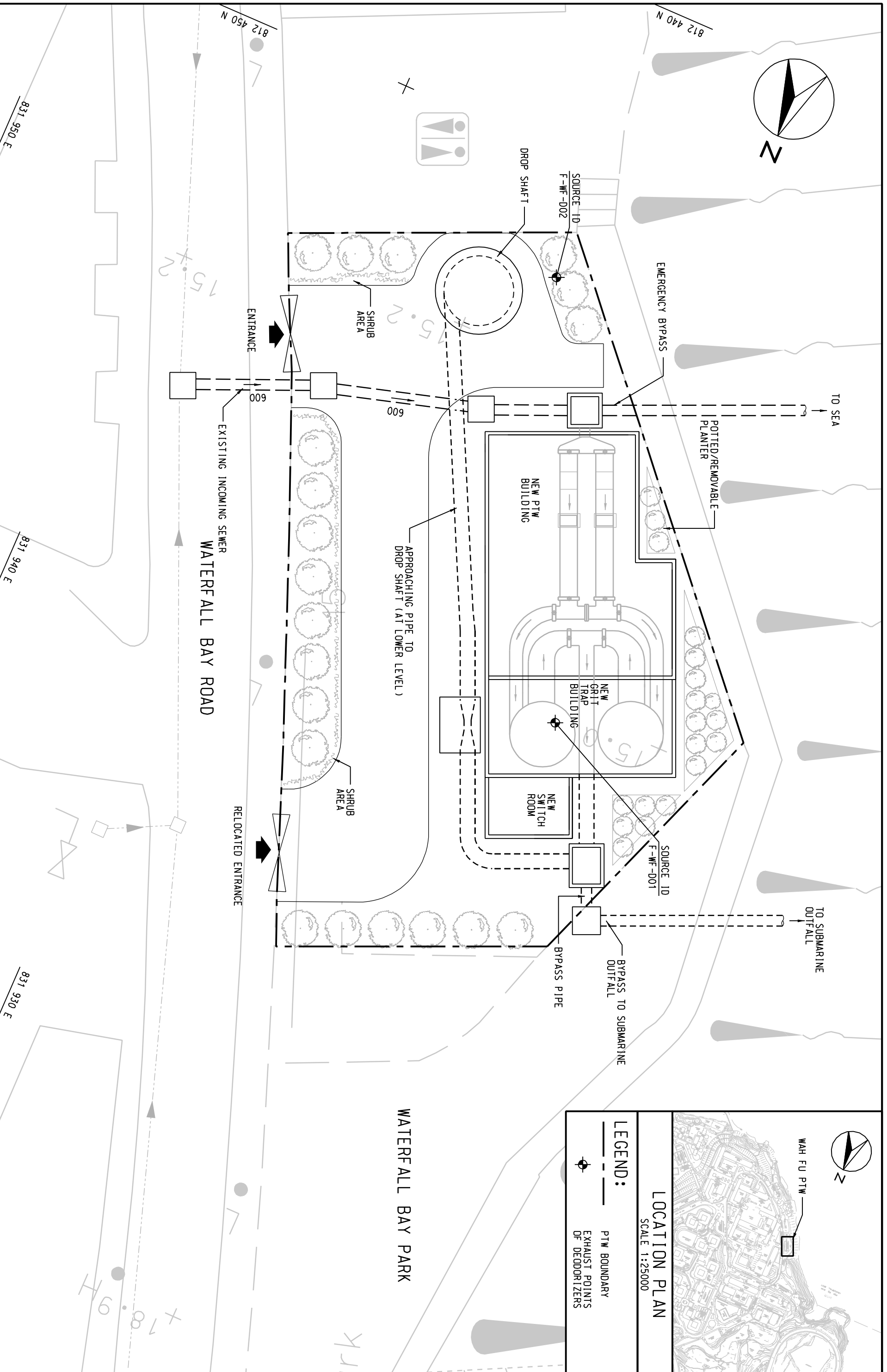

**LEGEND:**  
 - - - - - PTW BOUNDARY  
 ● EXHAUST POINTS OF DEODORIZERS

**LOCATION PLAN**  
 SCALE 1:25000





**ENSR** | **AECOM**

HARBOUR AREA TREATMENT SCHEME (HATS) STAGE 2A ENVIRONMENTAL IMPACT ASSESSMENT STUDY - INVESTIGATION  
 LAYOUT OF PROPOSED UPGRADE WORKS AND  
 LOCATIONS OF ODOUR EMISSION SOURCES - ABERDEEN PTW

AGREEMENT NO. CE 43/2005 (EP)

SCALE	1:500	DATE	SEP. 07
CHECK	-	DRAWN	LC
JOB NO.	60017198	FIGURE NO.	3.17
		REV	-

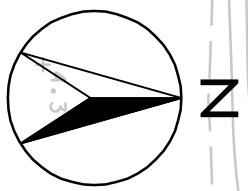
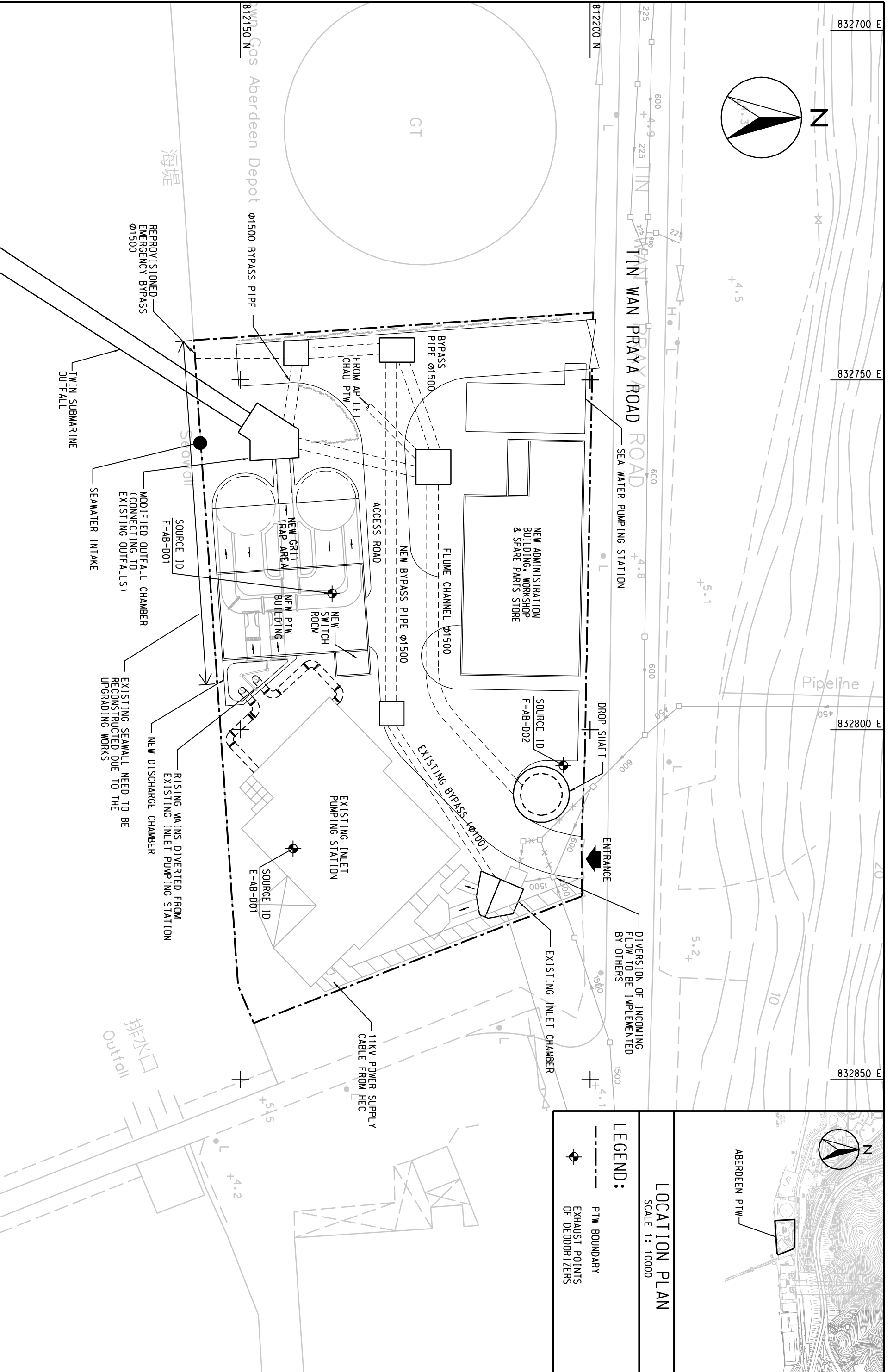

**LOCATION PLAN**

SCALE 1: 10000

- LEGEND:**
- PTW BOUNDARY
  - EXHAUST POINTS OF DEODORIZERS

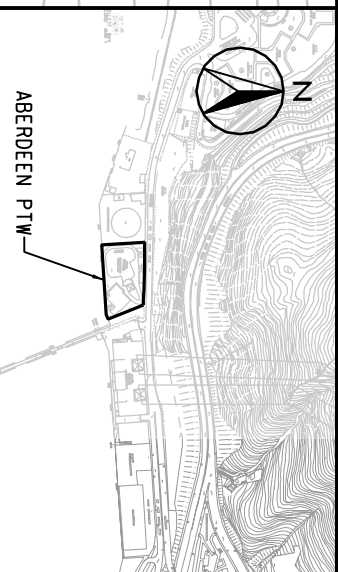

832700 E  
 832750 E  
 832800 E  
 832850 E