

NOTES:

1. FOR INDICATIVE USE ONLY
2. FINAL SITE LAYOUT TO BE SUBMITTED BY CONTRACTOR FOR ENGINEER'S AGREEMENT.
3. THE EXACT BOUNDARY OF THE SITE IS SUBJECT TO REFINEMENT BY THE ENGINEER ON SITE.
4. THE ARRANGEMENT OF THE PROPOSED FEATURES INCLUDING THE TEMPORARY ACCESS ROAD WITHIN THE SITE SHALL BE PROPOSED BY THE CONTRACTOR FOR THE ENGINEER'S APPROVAL.

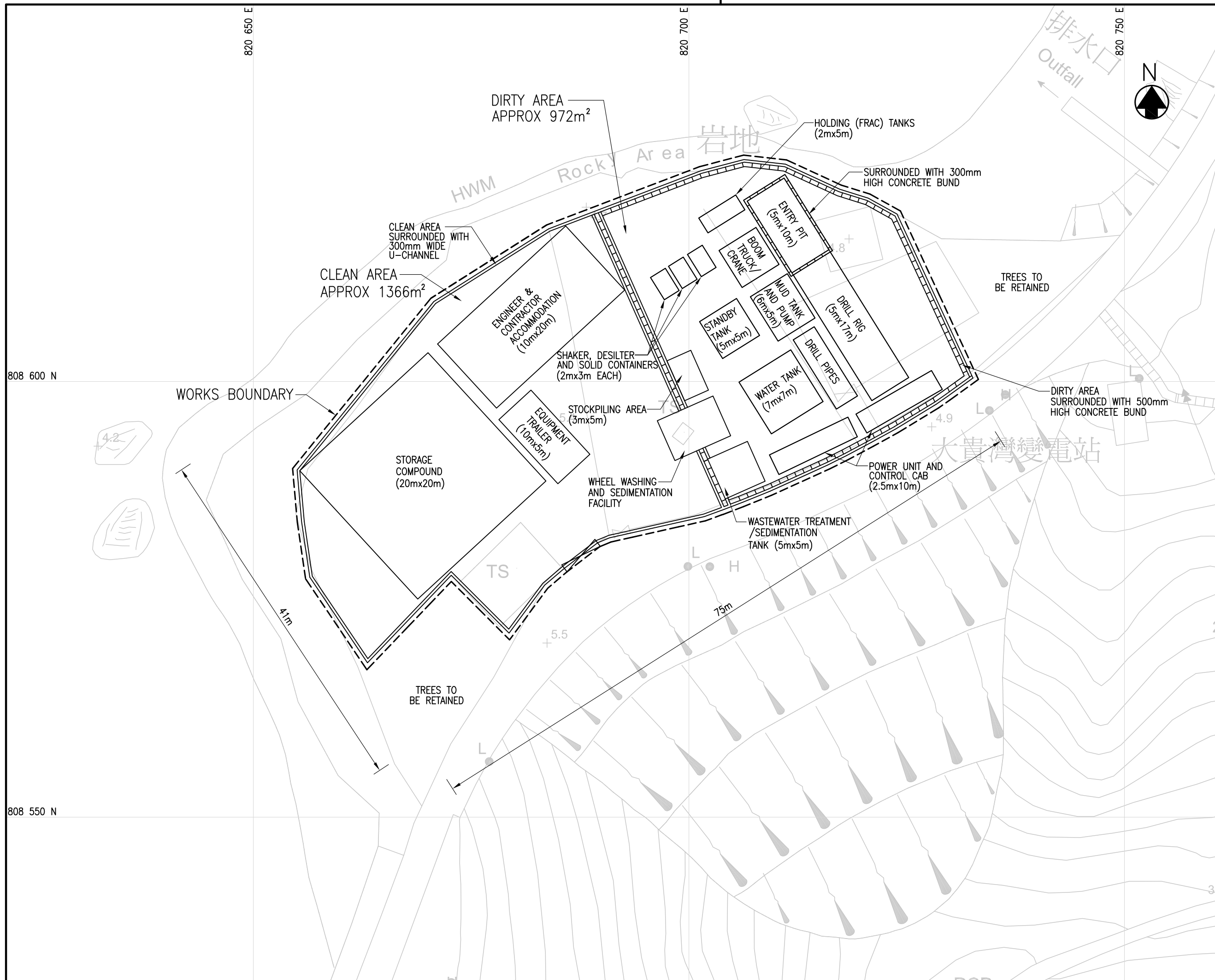

Revision	Date	Description			Initial
		Designed	Checked	Drawn	
Initial	HLC	TL	SZ	WLS	
Date	08/09	08/09	08/09	08/09	08/09

Approved

Agreement No. CE 1/2008 (WS)

Agreement Title
IMPROVEMENT OF FRESH WATER SUPPLY TO CHEUNG CHAU - INVESTIGATION

Drawing Title
SCHEMATIC LAYOUT OF PROPOSED LAUNCHING SITE AT CHEUNG CHAU

Drawing No. **FIGURE 2.4** Revision

Scale A3 1:400



BLACK & VEATCH HONG KONG LIMITED
博達工程顧問有限公司

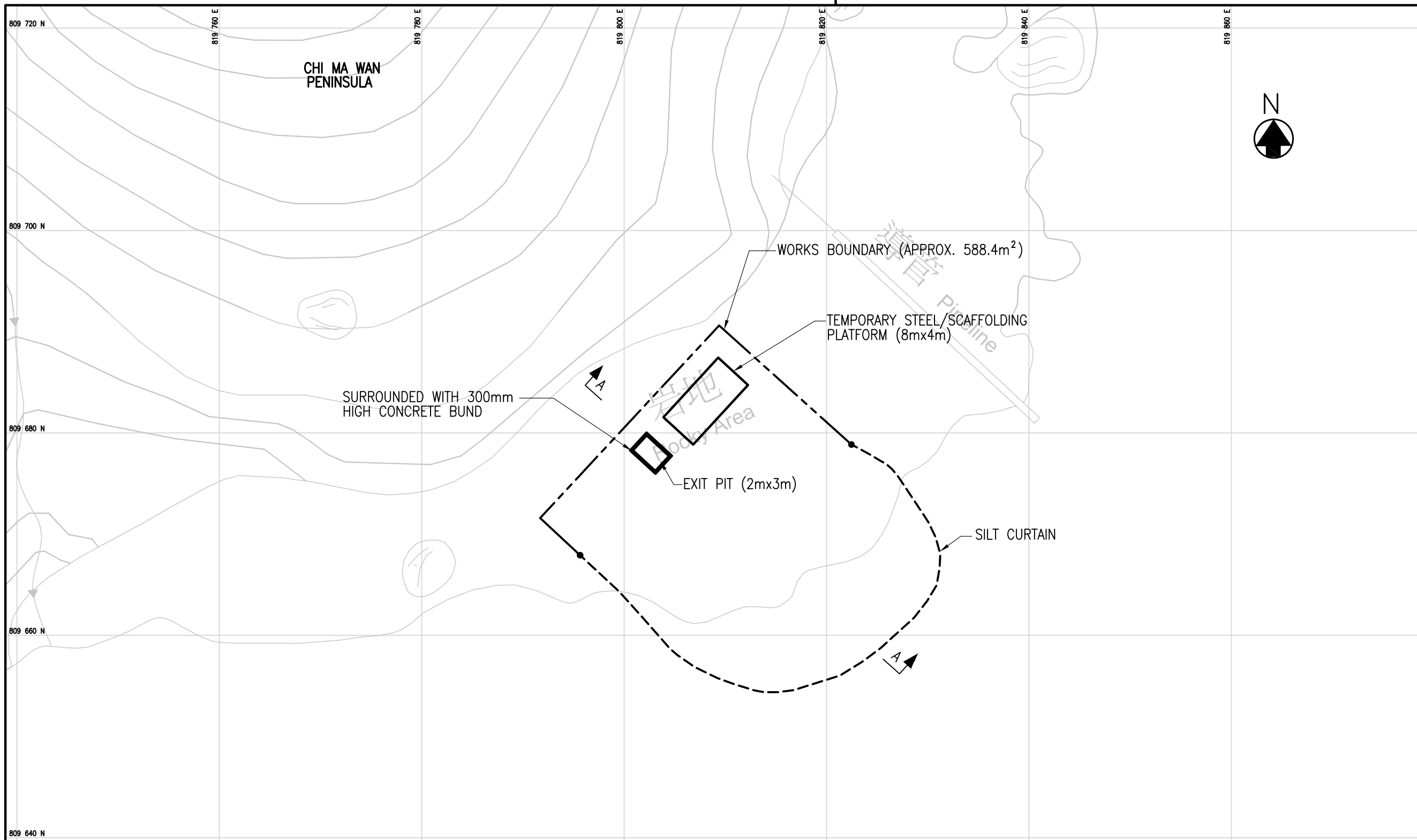

© Copyright by Black & Veatch Hong Kong Limited

NOTES:

1. FOR INDICATIVE USE ONLY
2. FINAL SITE LAYOUT TO BE SUBMITTED BY CONTRACTOR FOR ENGINEER'S AGREEMENT.
3. THE EXACT BOUNDARY OF THE SITE IS SUBJECT TO REFINEMENT BY THE ENGINEER ON SITE.
4. THE ARRANGEMENT OF THE PROPOSED FEATURES INCLUDING THE TEMPORARY ACCESS ROAD WITHIN THE SITE SHALL BE PROPOSED BY THE CONTRACTOR FOR THE ENGINEER'S APPROVAL.

LEGEND:

--- WORKS BOUNDARY

Revision	Date	Description			Initial
		Designed	Checked	Drawn	
Initial		TL	FD	SZ	WLS
Date	09/09	09/09	09/09	09/09	09/09

Approved

Agreement No. CE 1/2008 (WS)

Agreement Title
IMPROVEMENT OF FRESH WATER SUPPLY TO CHEUNG CHAU - INVESTIGATION

Drawing Title
SCHEMATIC LAYOUT OF PROPOSED RECEPTION SITE AT LANTAU

Drawing No. **FIGURE 2.5** Revision

Scale A3 1:400



BLACK & VEATCH HONG KONG LIMITED
博施工程顧問有限公司

