

**NOTES:**

1. FOR INDICATIVE USE ONLY
2. FINAL SITE LAYOUT TO BE SUBMITTED BY CONTRACTOR FOR ENGINEER'S AGREEMENT.
3. THE EXACT BOUNDARY OF THE SITE IS SUBJECT TO REFINEMENT BY THE ENGINEER ON SITE.
4. THE ARRANGEMENT OF THE PROPOSED FEATURES INCLUDING THE TEMPORARY ACCESS ROAD WITHIN THE SITE SHALL BE PROPOSED BY THE CONTRACTOR FOR THE ENGINEER'S APPROVAL.

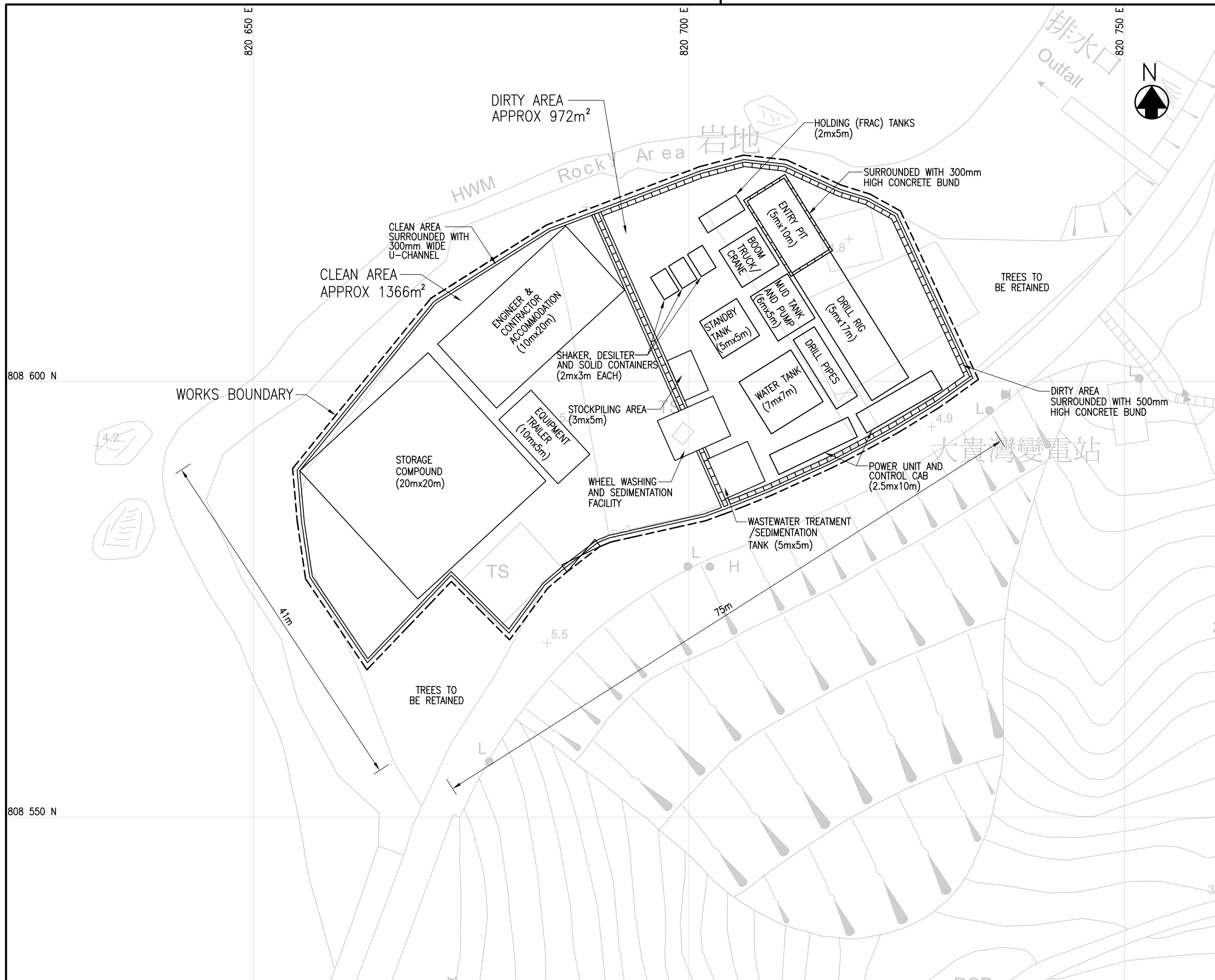

Revision	Date	Description			Initial
		Designed	Checked	Drawn	
Initial	HLC	TL	SZ	WLS	
Date	08/09	08/09	08/09	08/09	08/09

Approved

Agreement No. CE 1/2008 (WS)

Agreement Title  
IMPROVEMENT OF FRESH WATER SUPPLY TO CHEUNG CHAU - INVESTIGATION

Drawing Title  
**SCHEMATIC LAYOUT OF PROPOSED LAUNCHING SITE AT CHEUNG CHAU**

Drawing No. **FIGURE 2.4** Revision

Scale A3 1:400



**BLACK & VEATCH HONG KONG LIMITED**  
博施工程顧問有限公司