

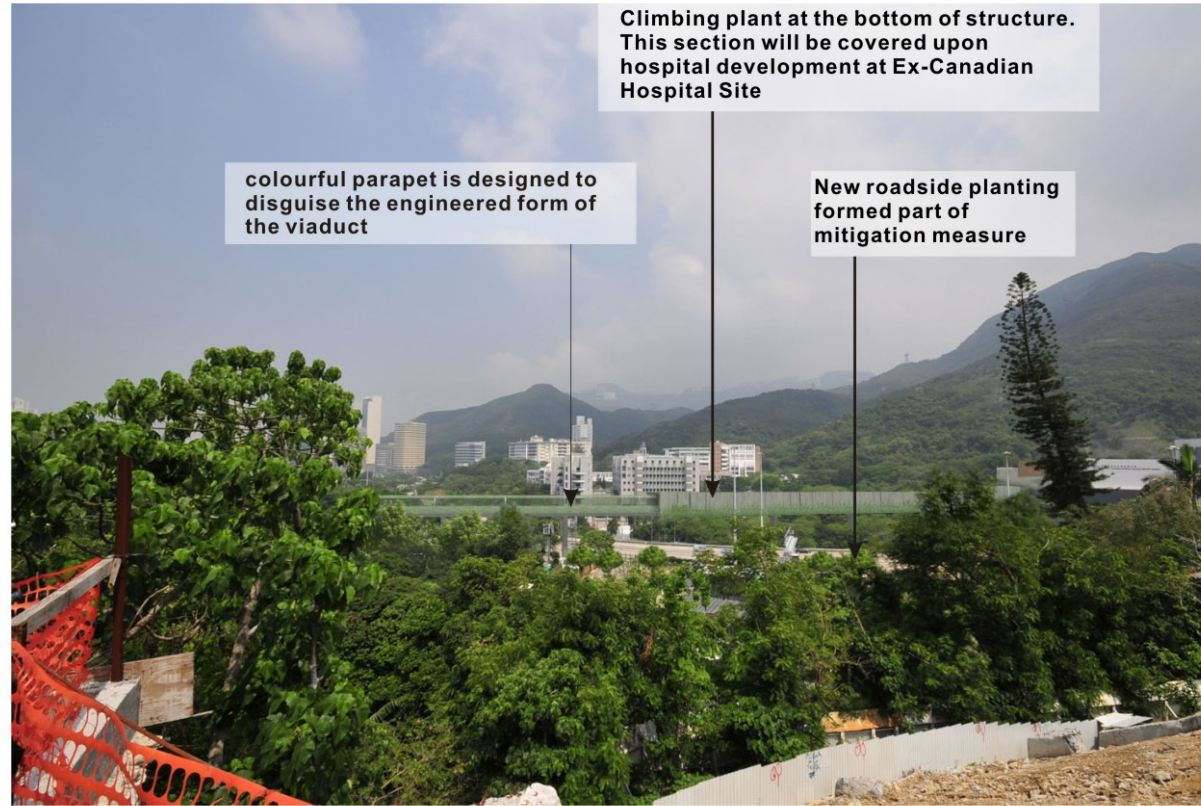

Existing Condition
Vantage Point M - View northwest at an elevated level from a construction site at Shouson Hill looking towards the proposed viaduct from Nam Fung Portal to OCP station



Day 1 of Operation Phase with landscape mitigation measures



Day 1 of Operation Phase without landscape mitigation measures



Year 10 of Operation Phase with landscape mitigation measures fully established

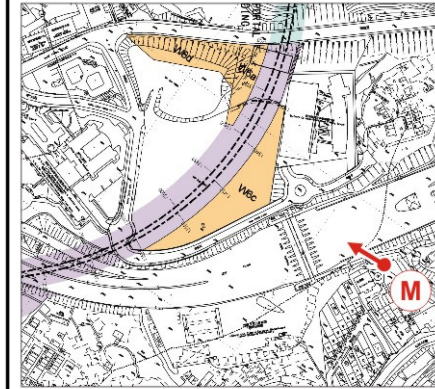

Key Plan

(Represents VSRs having views looking towards proposed the box structure and viaduct leading to OCP Station including Residents of developments on Shouson Hill (VSR9), Residents of Wong Chuk Hang Hospital and Complex for the Elderly (VSR 8) and Staff and Students of the St. Paul Co-educational College Primary School (VSR 010))

Note:

1. Indicative design of built structure and landscape proposals provided by Detailed Design Consultants.
2. The final details will be subject to detailed design development.
3. The extent of noise barrier / enclosure is indicative only.

Rev	Date	Drawn/Description	Ch'kd/App'd
Client			



Mott MacDonald Hong Kong Ltd
7th Floor
West Wing Office Building
New World Centre
20 Salisbury Road
Tsim Sha Tsui, Kowloon
Hong Kong
Tel 2828 5757
Fax 2827 1823
Web www.mottmac.com.hk

Project
**CONSULTANCY AGREEMENT NO. NEX/2301
SOUTH ISLAND LINE (EAST)
ENVIRONMENTAL IMPACT ASSESSMENT**

Title
Photomontage - Vantage Points M

Designed	SOP	07/10	Eng.Chk.	
Drawn	ELK	07/10	Coordination	CJF 07/10
Dwg.Chk.			Approved	

Scale	N.T.S.	Project	Status
		CAD File	

Drawing No.	Figure 6.10.20	Rev	
-------------	----------------	-----	--



Existing Condition

Vantage Point N - A private viewpoint at 6A Shouson Hill Road to represent view of Shouson Hill VSR towards Nam Fung Portal

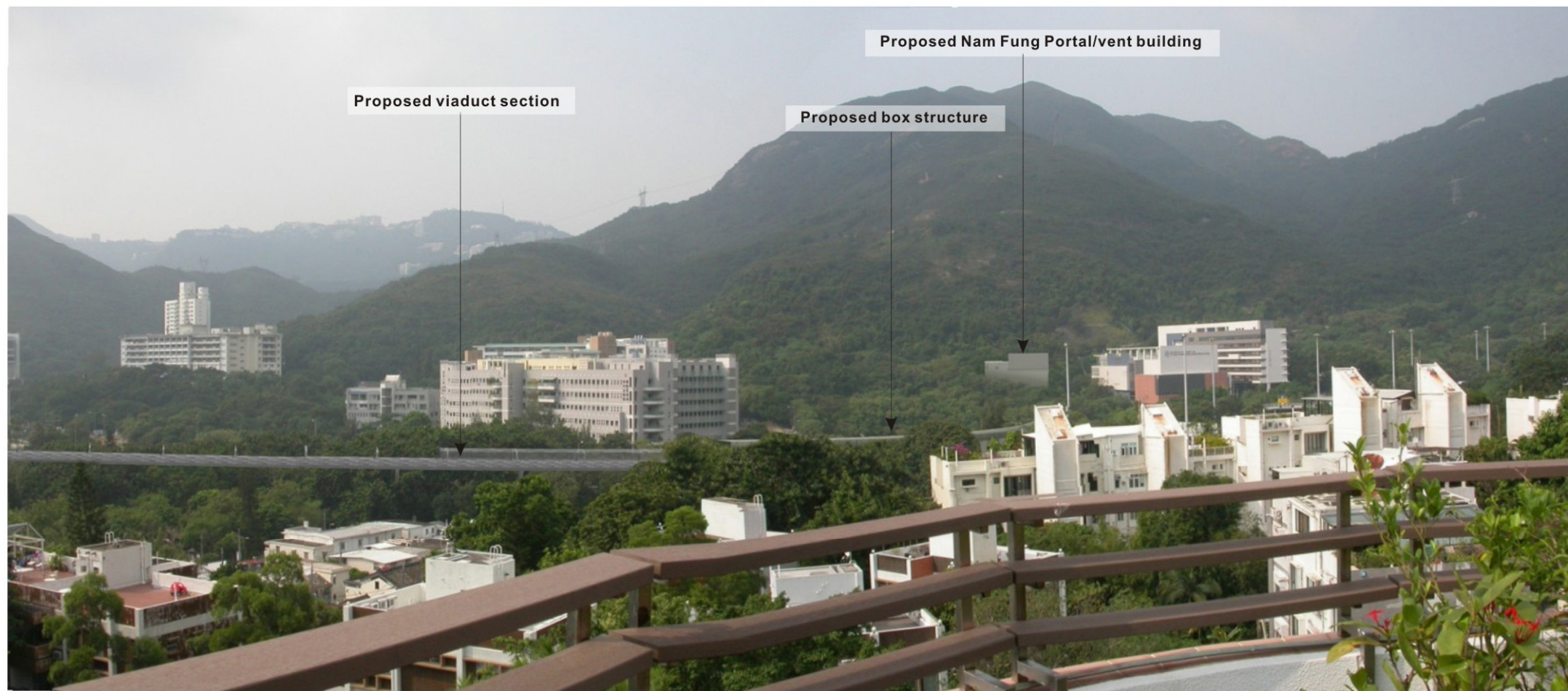

Day 1 of Operation Phase without landscape mitigation measures

© Mott MacDonald Hong Kong Limited

This document should not be relied on or used in circumstances other than those for which it was originally prepared and for which Mott MacDonald Hong Kong Limited was commissioned. Mott MacDonald Hong Kong Limited accepts no responsibility for this document to any other party other than the person by whom it was commissioned.

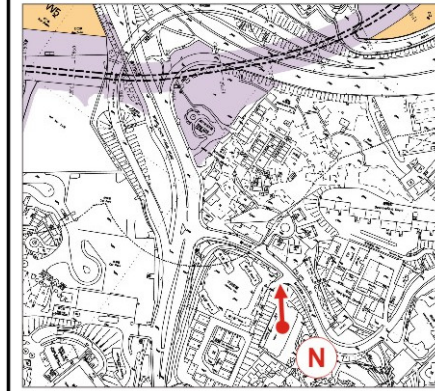

Key Plan

(Represents VSRs having views looking towards proposed the box structure and viaduct leading to OCP Station including Residents of developments on Shouson Hill (VSRR9), Residents of Wong Chuk Hang Hospital and Complex for the Elderly (VSR R8) and Staff and Students of the St. Paul Co-educational College Primary School (VSR O10))

Note:

1. Indicative design of built structure and landscape proposals provided by Detailed Design Consultants.
2. The final details will be subject to detailed design development.
3. The extent of noise barrier / enclosure is indicative only.

Rev	Date	Drawn/Description	Ch'kd/App'd
Client			



Mott MacDonald Hong Kong Ltd
7th Floor
West Wing Office Building
New World Centre
20 Salisbury Road
Tsim Sha Tsui, Kowloon
Hong Kong
Tel 2828 5757
Fax 2827 1823
Web www.mottmac.com.hk

Project
**CONSULTANCY AGREEMENT NO. NEX/2301
SOUTH ISLAND LINE (EAST)
ENVIRONMENTAL IMPACT ASSESSMENT**

Title
Photomontage - Vantage Points N

Designed	SOP	06/10	Eng.Chk.		
Drawn	ELK	06/10	Coordination	CJF	06/10
Dwg.Chk.			Approved		

Scale	N.T.S.	Project	Status
		CAD File	

Drawing No.	Figure 6.10.21	Rev	
-------------	----------------	-----	--

© COPYRIGHT RESERVED

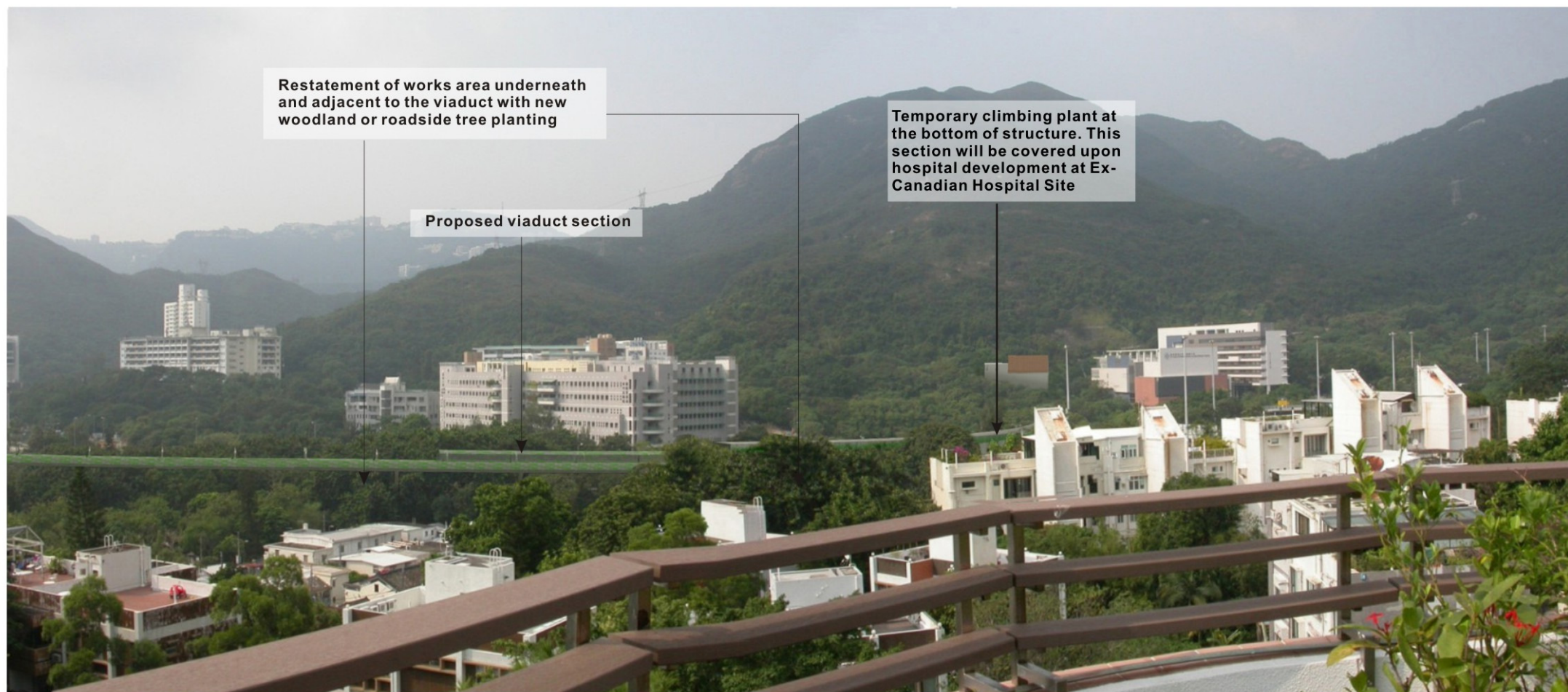

Day 1 of Operation Phase with landscape mitigation measures



Year 10 of Operation Phase with landscape mitigation measures fully established

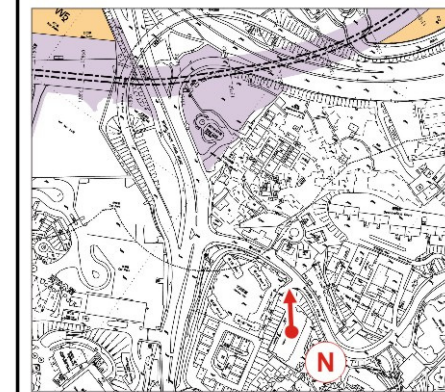

Key Plan

(Represents VSRs having views looking towards proposed the box structure and viaduct leading to OCP Station including Residents of developments on Shouson Hill (VSRR9), Residents of Wong Chuk Hang Hospital and Complex for the Elderly (VSR R8) and Staff and Students of the St. Paul Co-educational College Primary School (VSR O10))

Note:

1. Indicative design of built structure and landscape proposals provided by Detailed Design Consultants.
2. The final details will be subject to detailed design development.
3. The extent of noise barrier / enclosure is indicative only.

Rev	Date	Drawn/Description	Ch'kd	App'd
Client				



Mott MacDonald Hong Kong Ltd
7th Floor
West Wing Office Building
New World Centre
20 Salisbury Road
Tsim Sha Tsui, Kowloon
Hong Kong
Tel 2828 5757
Fax 2827 1823
Web www.mottmac.com.hk

Project
**CONSULTANCY AGREEMENT NO. NEX/2301
SOUTH ISLAND LINE (EAST)
ENVIRONMENTAL IMPACT ASSESSMENT**

Title
Photomontage - Vantage Points N

Designed	SOP	07/10	Eng.Chk.		
Drawn	ELK	07/10	Coordination	CJF	07/10
Dwg.Chk.			Approved		
Scale	N.T.S.	Project	CAD File		Status
Drawing No.					Rev