

Maps reproduced with permission of the Director of Lands, © Hong Kong Government

REPRESENTATIVE NOISE SENSITIVE RECEIVER	CONSTRUCTION PHASE	
	ABN - CONSTRUCTION	GBN - CONSTRUCTION
OM1 SHUN MAN HOUSE, OI MAN ESTATE	Y	
OM2 PARC PALAIS, BLOCK 6	Y	
OM3 PARC PALAIS, BLOCK 1	Y	
OM4a CARMEL SECONDARY SCHOOL (SOUTH BLOCK)	Y	
HH1 WYLIE COURT, BLOCK C	Y	
HH2 WING FUNG BUILDING	Y	
HH4 ROYAL PENINSULA BLOCK 2	Y	
HH7 THE METROPOLIS RESIDENCE	Y	Y
HH9 HARBOURFRONT HORIZON	Y	

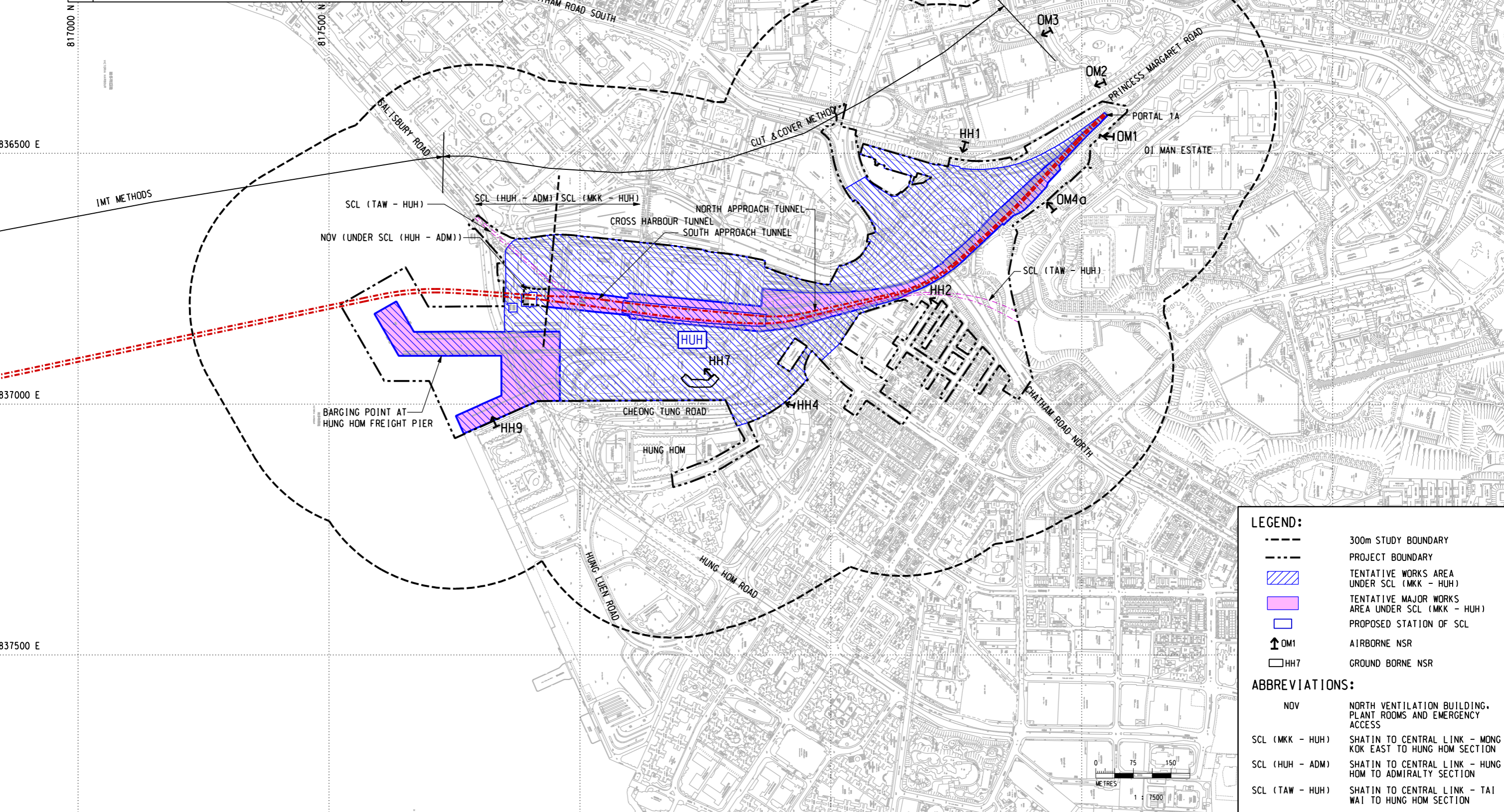

LEGEND:

- 300m STUDY BOUNDARY
- - - PROJECT BOUNDARY
- TENTATIVE WORKS AREA UNDER SCL (MKK - HUH)
- TENTATIVE MAJOR WORKS AREA UNDER SCL (MKK - HUH)
- PROPOSED STATION OF SCL
- ↑ OM1 AIRBORNE NSR
- HH7 GROUND BORNE NSR

ABBREVIATIONS:

- NOV NORTH VENTILATION BUILDING, PLANT ROOMS AND EMERGENCY ACCESS
- SCL (MKK - HUH) SHATIN TO CENTRAL LINK - MONG KOK EAST TO HUNG HOM SECTION
- SCL (HUH - ADM) SHATIN TO CENTRAL LINK - HUNG HOM TO ADMIRALTY SECTION
- SCL (TAW - HUH) SHATIN TO CENTRAL LINK - TAI WAI TO HUNG HOM SECTION

PLOT DRY: R:\us\mset\NTR\PI\DRIVER\WINDOWS_V3_C01_016.dgn
 MODELNAME: M:\projects\G0050763\DRAWINGS\000\N\ENR\M2213_C_361_ENS_M52_501A.dgn
 FILENAME:

REV	DESCRIPTION	BY	DATE	APPROVED	REV	DESCRIPTION	BY	DATE	APPROVED

DRAWN	WDF
DESIGNED	---
CHECKED	LCR
APPROVED	---
DATE	10/AUG/2010

SHATIN TO CENTRAL LINK

DO NOT SCALE DRAWINGS. ALL DIMENSIONS SHALL BE VERIFIED ON SITE.
 © MTR CORPORATION LIMITED 2008. COPYRIGHT IN RESPECT OF THIS DRAWING / DOCUMENT IS OWNED BY THE MTR CORPORATION LIMITED OF HONG KONG. NO REPRODUCTION OF THE DRAWING / DOCUMENT OR ANY PART BY WHATEVER MEANS IS PERMITTED WITHOUT THE PRIOR WRITTEN CONSENT OF THE MTR CORPORATION LIMITED.

CADD REF. NEX2213_C_361_ENS_M52_501A.dgn

TITLE
 NEX/2213
 EIA STUDY FOR SCL (MKK - HUH)
 LOCATION OF REPRESENTATIVE NOISE
 SENSITIVE RECEIVERS FOR CONSTRUCTION PHASE
 (SCL - MONG KOK EAST TO HUNG HOM SECTION)

SCALE 1 : 7500 (A3) FIGURE NO. NEX2213/C/361/ENS/M52/501 REV. A