

PLOT DRY: R:\us\mst\mtr\p\p\DRIVER\WINDOWS\X3 COL 016.dgn
 MODELNAME: M:\projects\60050763\DRAWINGS\0001\X3\ENS\M57_505A.dgn
 FILENAME: M57_505A.dgn

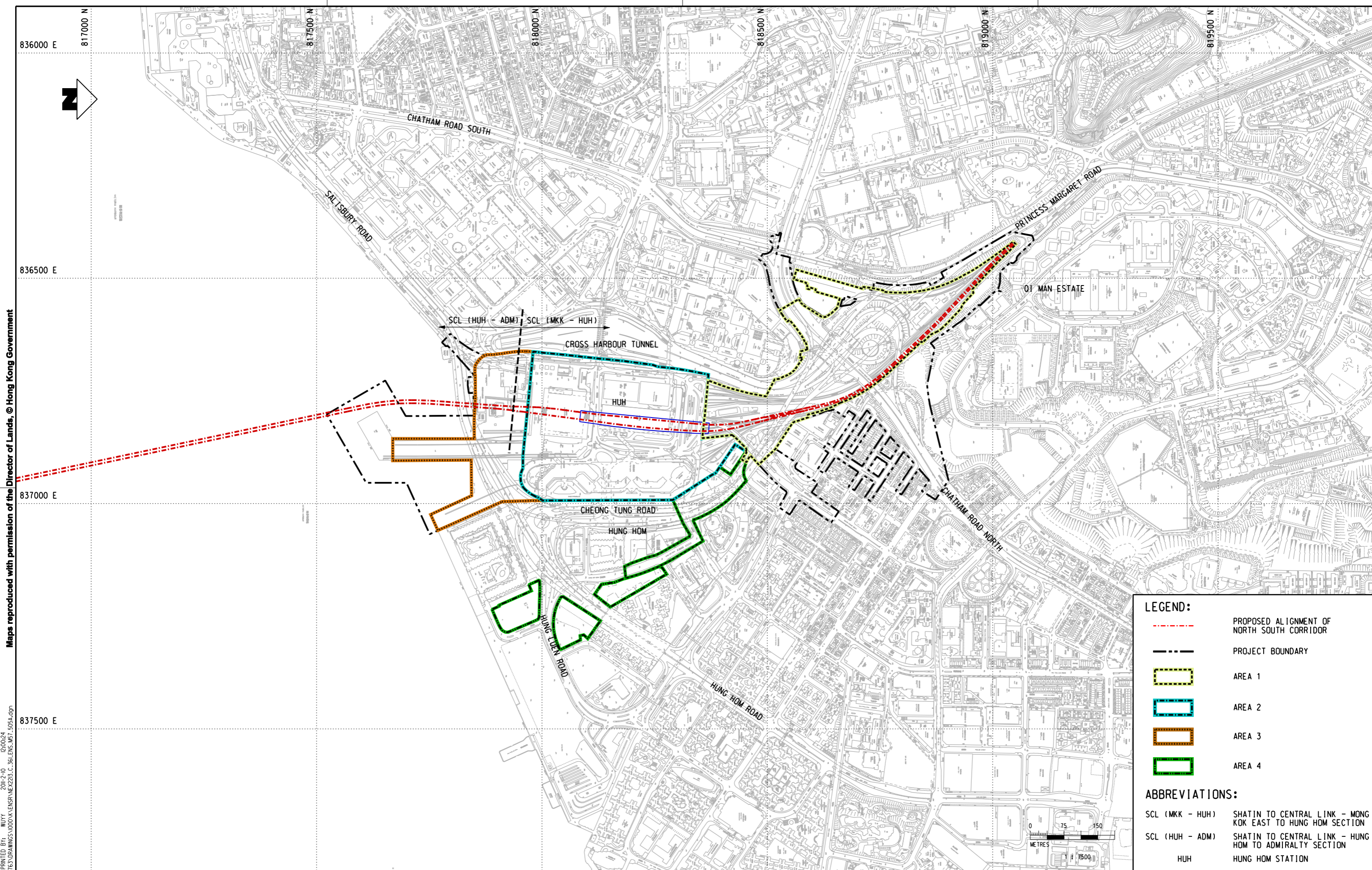

LEGEND:

- - - - - PROPOSED ALIGNMENT OF NORTH SOUTH CORRIDOR
- PROJECT BOUNDARY
- AREA 1
- AREA 2
- AREA 3
- AREA 4

ABBREVIATIONS:

- SCL (MKK - HUH) SHATIN TO CENTRAL LINK - MONG KOK EAST TO HUNG HOM SECTION
- SCL (HUH - ADM) SHATIN TO CENTRAL LINK - HUNG HOM TO ADMIRALTY SECTION
- HUH HUNG HOM STATION

				DRAWN WDF	 MTR	SHATIN TO CENTRAL LINK		TITLE NEX/2213 EIA STUDY FOR SCL (MKK - HUH) LAYOUT OF ASSESSMENT AREAS 1-4 AS PROPOSED IN THE APPROVED CAPS			
				DESIGNED ---		ORIGINATOR AECOM			SCALE 1 : 7500 (A3)	FIGURE NO. NEX2213/C/361/ENS/M57/505	REV. A
				CHECKED LCR							
				APPROVED ---							
				DATE 17/SEP/2010	CADD REF. NEX2213_C_361_ENS_M57_505A.dgn						
<small>DO NOT SCALE DRAWINGS. ALL DIMENSIONS SHALL BE VERIFIED ON SITE. © MTR CORPORATION LIMITED 2008 COPYRIGHT IN RESPECT OF THIS DRAWING / DOCUMENT IS OWNED BY THE MTR CORPORATION LIMITED OF HONG KONG. NO REPRODUCTION OF THE DRAWING / DOCUMENT OR ANY PART BY WHATEVER MEANS IS PERMITTED WITHOUT THE PRIOR WRITTEN CONSENT OF THE MTR CORPORATION LIMITED.</small>											
REV	DESCRIPTION	BY	DATE	APPROVED	REV	DESCRIPTION	BY	DATE	APPROVED	REV	