

VISUAL SENSITIVE RECEIVERS WITHIN ROAD D3A & D4A

VSR	Location
Residential VSRs	
R14	Laguna Verde, Whampoa Garden and Harbour Front Landmark
R16	Grand Waterfront (Same Planned Use Under KTD)
R17	Wylar Gardens
R18	Low Rise Residential Development Adjacent to Waterfront (Same Planned Use Under KTD)
R26	Existing Vacant Site (Planned Residential Development in Runway Precinct)
Occupational VSRs	
C4	Newport Centre (Planned Residential Use Under KTD)
C5	Existing Vacant Site (Planned Hotel Development in Runway Precinct)
GIC9	Mixed GIC Use
GIC12	Existing Vacant Site (Planned GIC Use Under KTD)
GIC14	Holy Carpenter Primary School and Oblate Father's Primary School (Same Planned Use Under KTD)
GIC15	To Kwa Wan Motor Vehicle Inspection Centre and cargo working area along Long Yuet Street (Planned Open Space Under KTD)
GIC18	EMSD Workshops (Planned Sewage Pumping Station and Open Space Under KTD)
GIC22	Kowloon City Ferry Pier and Bus Terminal (Planned Ventilation Shafts and Waterfront Promenade Under KTD)
GIC24A	Existing Vacant Site (Planned Government (Hospital and Fire Station) Facilities)
GIC24B	Existing Vacant Site (Planned Government (Hospital) Facilities)
I5A	Industrial / Office Developments and Godowns at Cheung Yip Street (Planned Commercial Use at Kai Hing Road Under KTD)
I5B	Industrial / Office Developments and Godowns at Cheung Yip Street (Planned Residential Use at Kai Hing Road Under KTD)
OU2	Business and Industrial Developments in Kowloon Bay (Planned Commercial Use in Operation Stage)
OU4	Business and Industrial Developments in Hung Hom (Planned Commercial Use in Operation Stage)
OU5B	Business and Industrial Developments in Kwun Tong between Wai Yip Street and Hoi Bun Road (Planned Commercial Use)
OU6	Existing Vacant Site (Hong Kong International Trade and Exhibition Centre Same Planned Use Under KTD)
OU9	Existing Vacant Site (Planned Public Infrastructure Facilities Site)
OU10	Existing Vacant Site (Planned Stadium)
OU11	Existing Vacant Site (Planned Tourism Node)
OU12	Existing Vacant Site (Planned Cruise Terminal in Runway Precinct)
Recreational VSRs	
O7	Visitors at King Wan Street Playground (Same Planned Use Under KTD)
O13	Visitors at Hoi Sham Park (Same Planned Use Under KTD)
O14	Visitors at Hoi Bun Road Park
O17	Visitors at Hung Hom Waterfront, Tai Wan Shan Park and Tai Wan Shan Swimming Pool
O19	Existing Vacant Site (Planned Metro Park in Runway Precinct)
O20	Existing Vacant Site (Planned Waterfront Promenade on North Side of Runway Precinct)
O21	Existing Vacant Site (Planned Runway Park DOS)
O24	Promenade Along Ma Tau Kok (Same Planned Use Under KTD)
Travelling VSRs	
T3	Motorists on Kwun Tong Bypass
T4	Travellers of Harbour Traffic
T16	Motorists / Pedestrians on Planned Taxiway Bridge
T18	Motorists / Pedestrians on Planned Central Kowloon Route 6
T19	Motorists / Pedestrians on Planned L16

Note:
 C = Commercial, CDA = Comprehensive Development Area, GIC = Government/Institution/Community,
 O = Open space, OU = Other use, R = Residential, T = Transport related

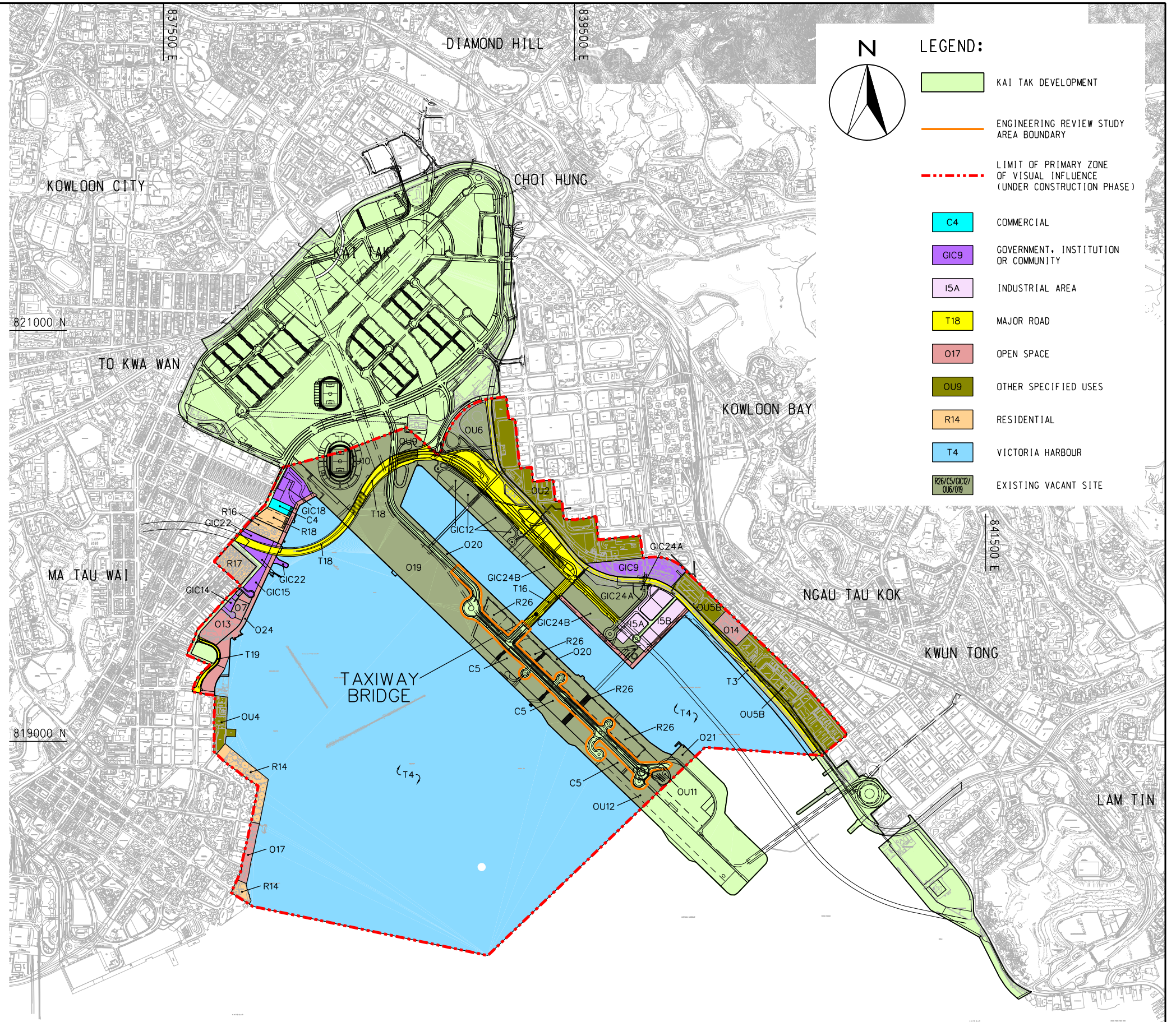

AGREEMENT NO. CE 30/2008 (CE)
 KAI TAK DEVELOPMENT - INFRASTRUCTURE AT FORMER RUNWAY AND REMAINING AREAS OF NORTH APRON AND IMPROVEMENT OF ADJACENT WATERWAYS - DESIGN AND CONSTRUCTION
 LOCATIONS OF LOCAL VISUALLY SENSITIVE RECEIVERS (VSRs) - CONSTRUCTION PHASE

SCALE	A3 1 : 20000	DATE	NOV 2012
CHECK	--	DRAWN	JIC
JOB NO.	60102100	DRAWING No.	FIGURE 7.8.4.1
		REV	B