

Printed by : 12/14/2012  
 Filename : G:\env\project\217722-70\13 Drawing Deliverables\11 EIA Report\05 Final\Chapter 11 - Cultural Heritage (Archaeology)\Figure 11.5.1.dgn

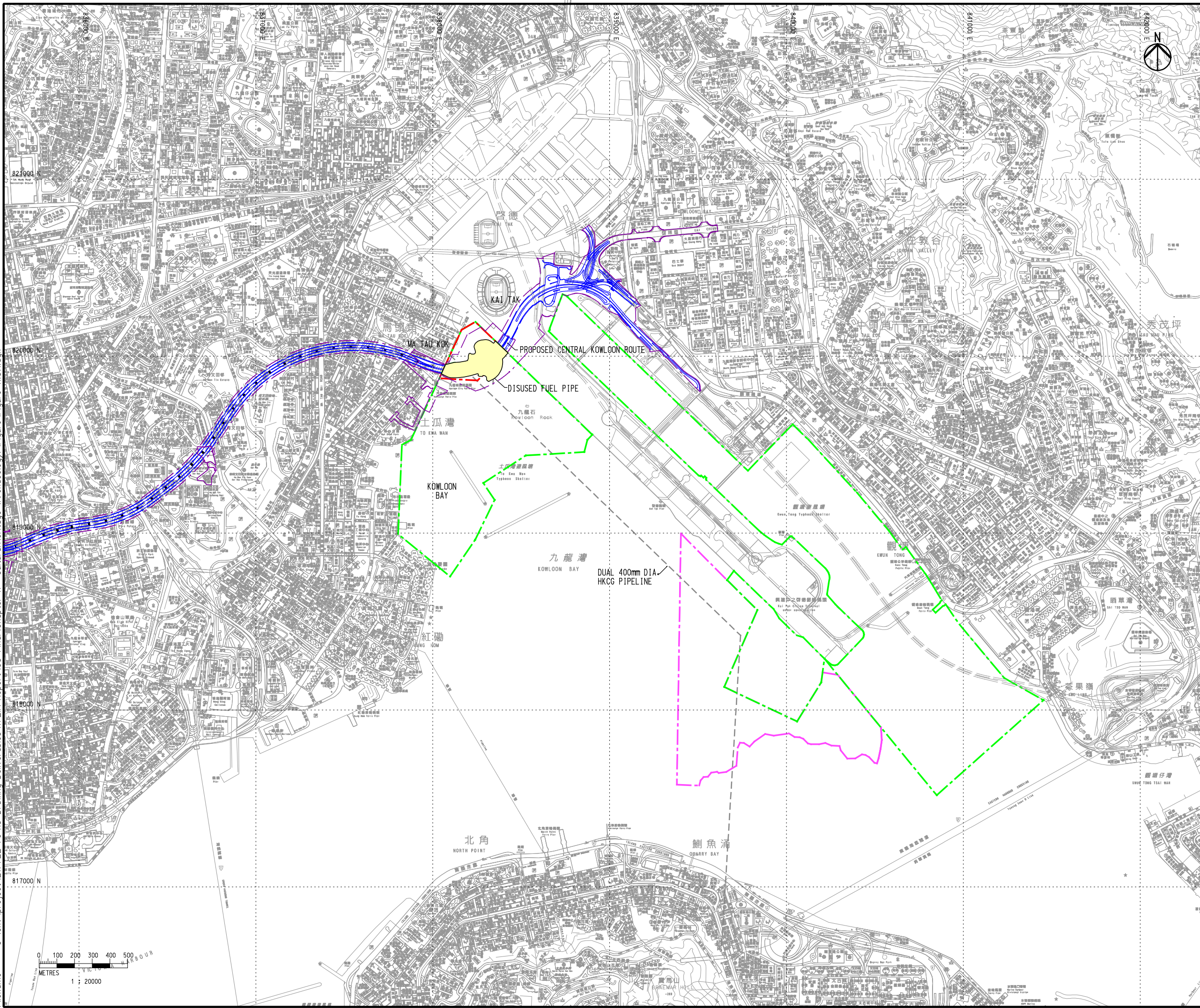

- LEGEND
- POSSIBLE DREDGING FOR UNDERWATER TUNNEL CONSTRUCTION AND NAVIGATION DURING CONSTRUCTION STAGE
  - BOUNDARY OF GEOPHYSICAL SURVEY CONDUCTED IN 2008 (UNDER CE58/2006(HY))
  - BOUNDARY OF GEOPHYSICAL SURVEY CONDUCTED IN 2007 (UNDER AGREEMENT NO. KDO 01/2006)
  - BOUNDARY OF GEOPHYSICAL SURVEY CONDUCTED IN 2001 (UNDER CED CONTRACT GE/2001/20, WORKS ORDER NO. GE2001/20/04)
  - CKR ALIGNMENT
  - WORKS LIMIT

D	FOURTH ISSUE	GL	12/12
C	THIRD ISSUE	GL	09/12
B	SECOND ISSUE	GL	06/12
A	FIRST ISSUE	GL	01/12
Rev	Description	By	Date

Consultant

**ARUP**

Project title  
**Agreement No. CE 43/2010 (HY)**  
**Central Kowloon Route - Design and Construction**

Drawing title  
**Previous MAI Coverage**

Drawing no. <b>Figure 11.5.1</b>		Rev. <b>D</b>	
Drawn GL	Date 12/12	Checked FC	Approved ST
Scale 1:20000 ON A3		Status <b>PRELIMINARY</b>	

COPYRIGHT RESERVED

**路政署**  
**HIGHWAYS DEPARTMENT**  
 主要工程管理處  
 MAJOR WORKS PROJECT MANAGEMENT OFFICE