

Printed by : 12/27/2012
 Filename : G:\env\project\217722-70\13 Drawing Deliverables\11 EIA Report\05 Final\Chapter 5 - Noise\Figure\Figure 5.10.dgn

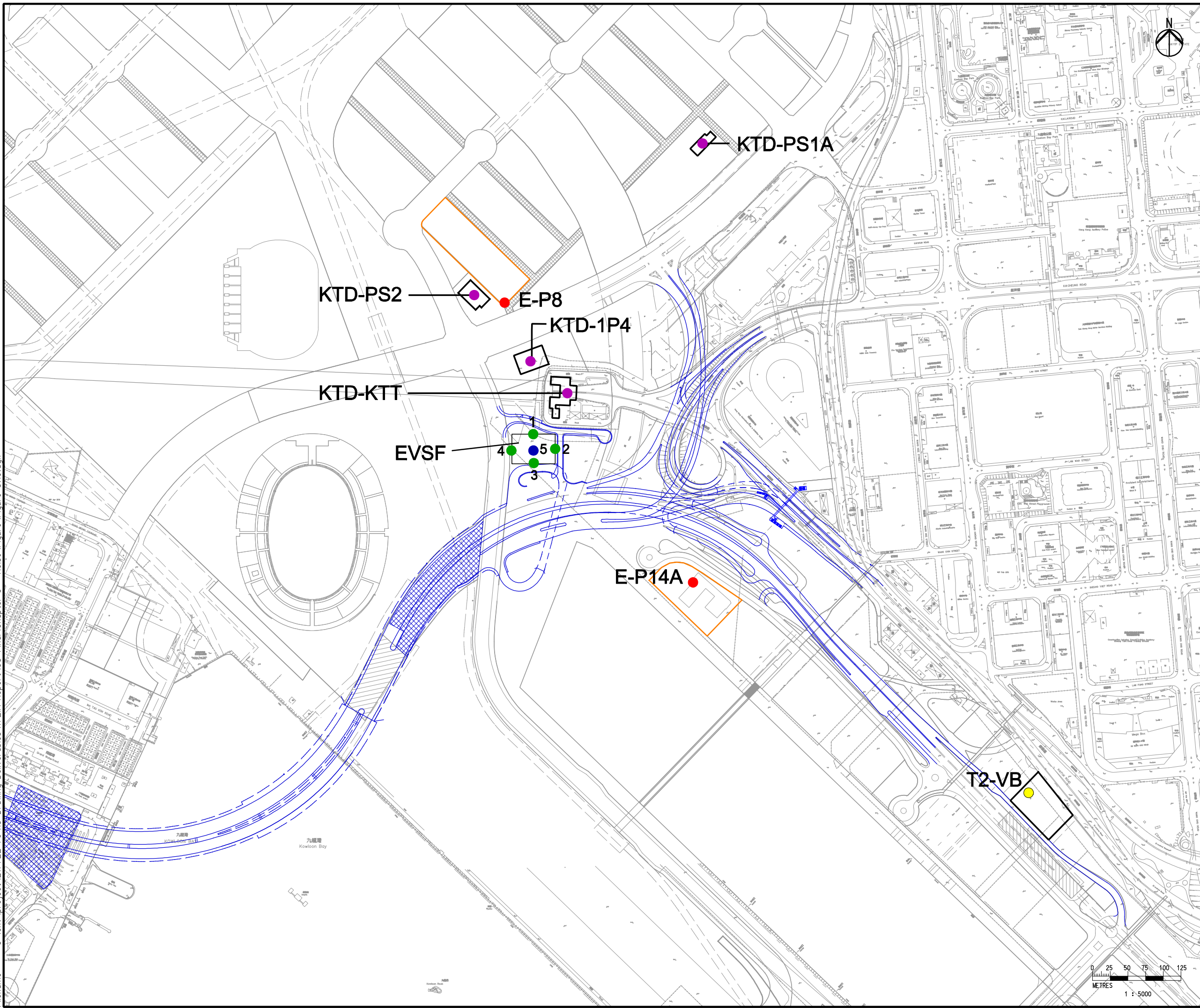

- LEGEND**
- CKR Alignment
 - Planned NSR
 - Ventilation Building
 - Assessment Point for Fix Plant Noise Calculation
 - Approximated Noise Source Location for CKR (Facade)
 - Approximated Noise Source Location for CKR (Top)
 - Approximated Noise Source Location for KTD (Top)
 - Approximated Noise Source Location for T2

E	FIFTH ISSUE	GL	12/12
D	FOURTH ISSUE	GL	09/12
C	THIRD ISSUE	GL	06/12
B	SECOND ISSUE	GL	03/12
A	FIRST ISSUE	GL	12/11
Rev	Description	By	Date

Consultant

ARUP

Project title
Agreement No. CE 43/2010 (HY)
Central Kowloon Route - Design and Construction

Drawing title
Location of Fixed Plant Noise (East Portion)

Drawing no. Figure 5.10		Rev. E	
Drawn GL	Date 12/12	Checked FC	Approved ST
Scale 1:5000 ON A3		Status PRELIMINARY	

COPYRIGHT RESERVED

路政署
HIGHWAYS DEPARTMENT
 主要工程管理處
 MAJOR WORKS PROJECT MANAGEMENT OFFICE