

Printed by : 2/24/2013  
 Filename : G:\env\project\217722-70\13 Drawing Deliverables\11 EIA Report\06 Final Submission\Chapter 5 - Noise\Figure\Figure 5.3.1.dgn

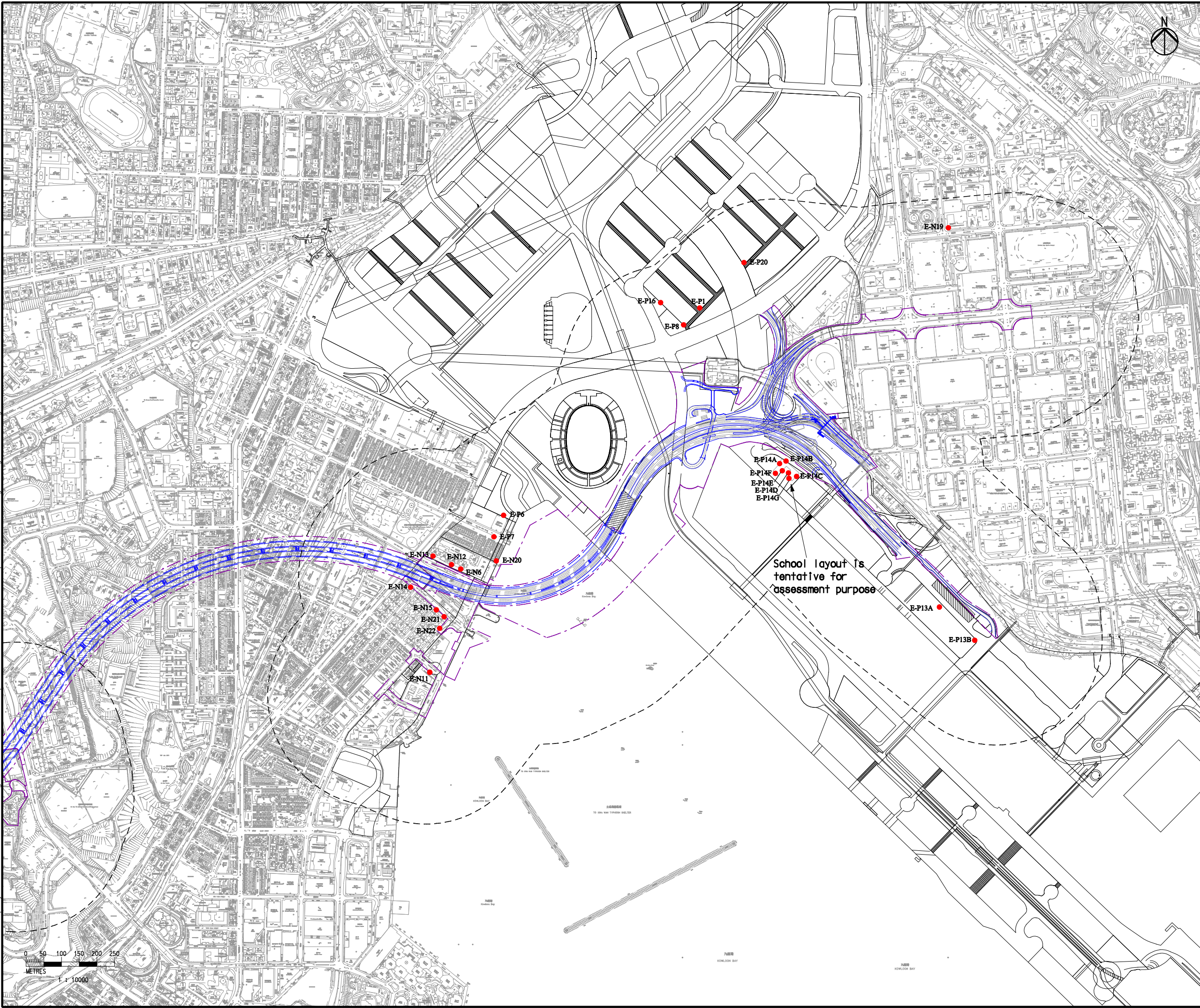

**Legend**

- CKR Alignment
- - - Works Limit
- - - 300m Assessment Area
- NSRs

F	SIXTH ISSUE	GL	02/13
E	FIFTH ISSUE	GL	12/12
D	FOURTH ISSUE	GL	09/12
C	THIRD ISSUE	GL	07/12
B	SECOND ISSUE	GL	03/12
A	FIRST ISSUE	GL	12/11
Rev	Description	By	Date

Consultant

**ARUP**

Project title  
**Agreement No. CE 43/2010 (HY)**  
**Central Kowloon Route -  
 Design and Construction**

Drawing title  
**Location of Assessment Area  
 and Noise Sensitive  
 Receivers  
 (East Portion)**

Drawing no. <b>Figure 5.3.1</b>		Rev. <b>F</b>	
Drawn GL	Date 02/13	Checked FC	Approved ST
Scale 1:10000 ON A3		Status <b>PRELIMINARY</b>	

COPYRIGHT RESERVED

**路政署  
 HIGHWAYS DEPARTMENT**  
 主要工程管理处  
 MAJOR WORKS PROJECT MANAGEMENT OFFICE