

Inset 1: Avoid any sensitive facade with openable window facing Central Kowloon Route

- Legend
- CKR Alignment
 - Planned G/IC Zone
 - Landscape Deck
 - Full-enclosure
 - Semi-enclosure
 - Vertical Barrier
 - Cantilevered Barrier
 - Avoid any sensitive facade with openable window facing Central Kowloon Route

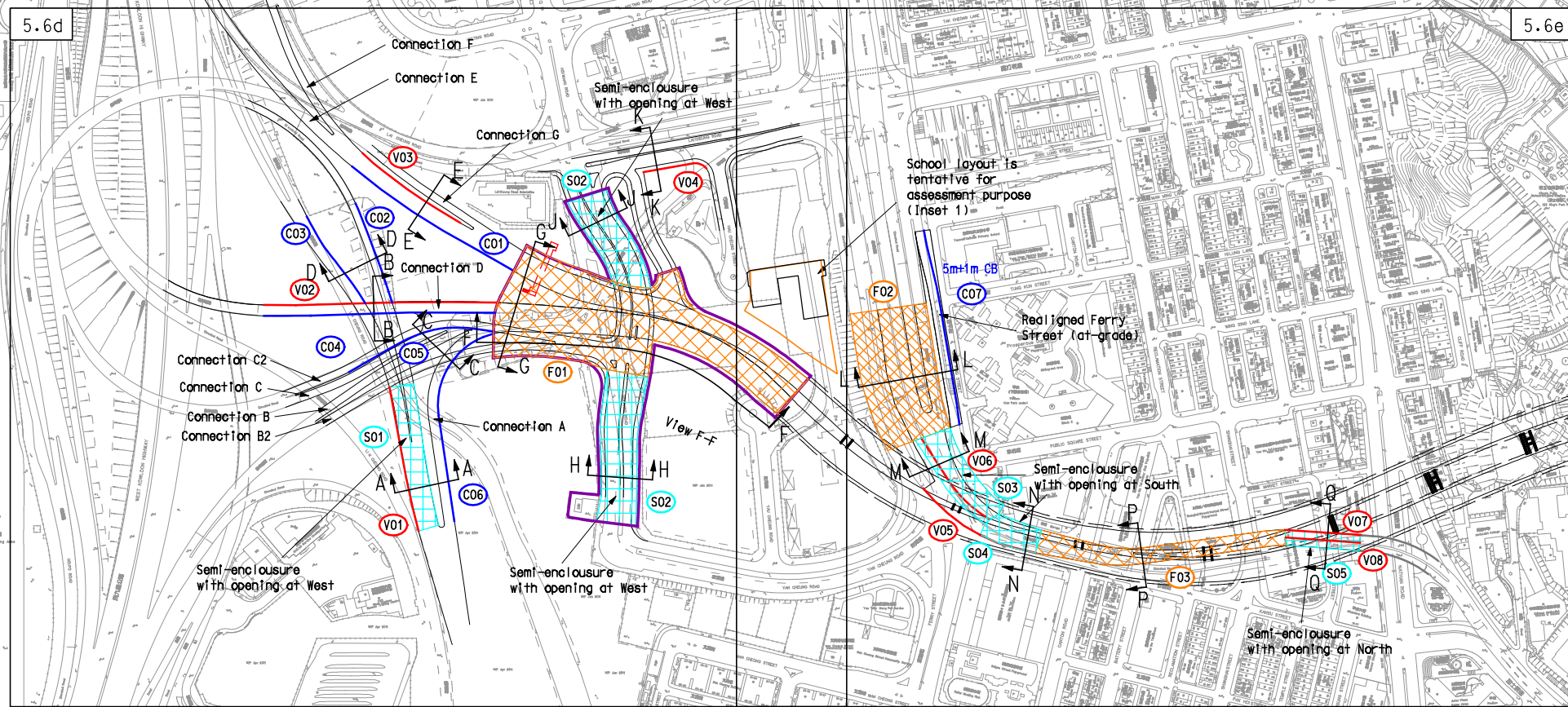

Printed by : 3/8/2013
 Filename : G:\env\project\217722-70\13 Drawing Deliverables\11 EIA Report\06 Final Submission\Chapter 5 - Noise\Figure\Figure 5.6c.dgn

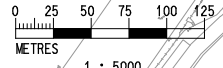

E	FIFTH ISSUE	GL	01/13
D	FOURTH ISSUE	GL	12/12
C	THIRD ISSUE	GL	09/12
B	SECOND ISSUE	GL	06/12
A	FIRST ISSUE	GL	12/11
Rev	Description	By	Date

Consultant

Project title
Agreement No. CE 43/2010 (HY)
Central Kowloon Route - Design and Construction

Drawing title
Location of Proposed Noise Mitigation Measures for Road Traffic Noise (West Portion) (Sheet 3 of 5)

Drawing no. Figure 5.6c		Rev. E	
Drawn GL	Date 01/13	Checked FC	Approved ST
Scale 1:5000 ON A3	Status PRELIMINARY		

COPYRIGHT RESERVED

路政署
HIGHWAYS DEPARTMENT
 主要工程管理處
 MAJOR WORKS PROJECT MANAGEMENT OFFICE