

Printed by : 2/24/2013
 Filename : G:\env\project\217722-70\13 Drawing Deliverables\11 EIA Report\06 Final Submission\Chapter 5 - Noise\Figure\Figure 5.7a.dgn

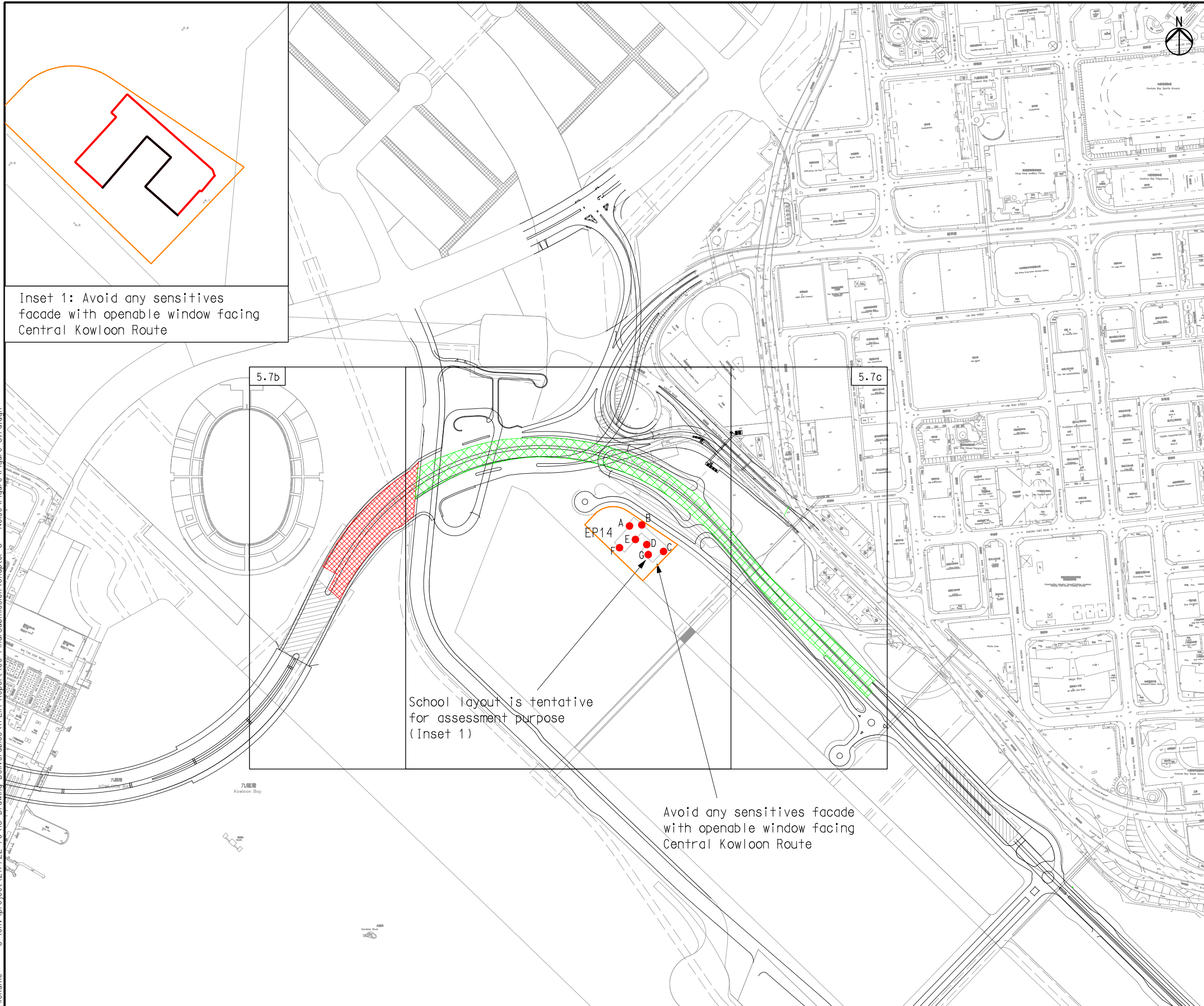

Inset 1: Avoid any sensitive facade with openable window facing Central Kowloon Route

5.7b

5.7c

EP14
 A
 B
 C
 D
 E
 F
 G

School layout is tentative for assessment purpose (Inset 1)

Avoid any sensitive facade with openable window facing Central Kowloon Route

- Legend
- CKR Alignment
 - Planned Site 3B1
 - Low Noise Road Surfacing
 - Landscape Deck
 - Avoid any sensitive facade with openable window facing Central Kowloon Route

F	SIXTH ISSUE	GL	02/13
E	FIFTH ISSUE	GL	12/12
D	FOURTH ISSUE	GL	09/12
C	THIRD ISSUE	GL	06/12
B	SECOND ISSUE	GL	03/12
A	FIRST ISSUE	GL	12/11
Rev	Description	By	Date

Consultant

Project title
Agreement No. CE 43/2010 (HY)
Central Kowloon Route - Design and Construction

Drawing title
Location of Proposed Noise Mitigation Measures for Road Traffic Noise (East Portion) (Sheet 1 of 3)

Drawing no. Figure 5.7a		Rev. F	
Drawn GL	Date 02/13	Checked FC	Approved ST
Scale 1:5000 ON A3	Status PRELIMINARY		

COPYRIGHT RESERVED

路政署
HIGHWAYS DEPARTMENT
 主要工程管理處
 MAJOR WORKS PROJECT MANAGEMENT OFFICE