

Printed by : 3/2/2013
 Filename : G:\env\project\217722-70\13 Drawing Deliverables\18 EM&A Manual\06 Final Submission\Ch. 6\Figure 6.6.dgn

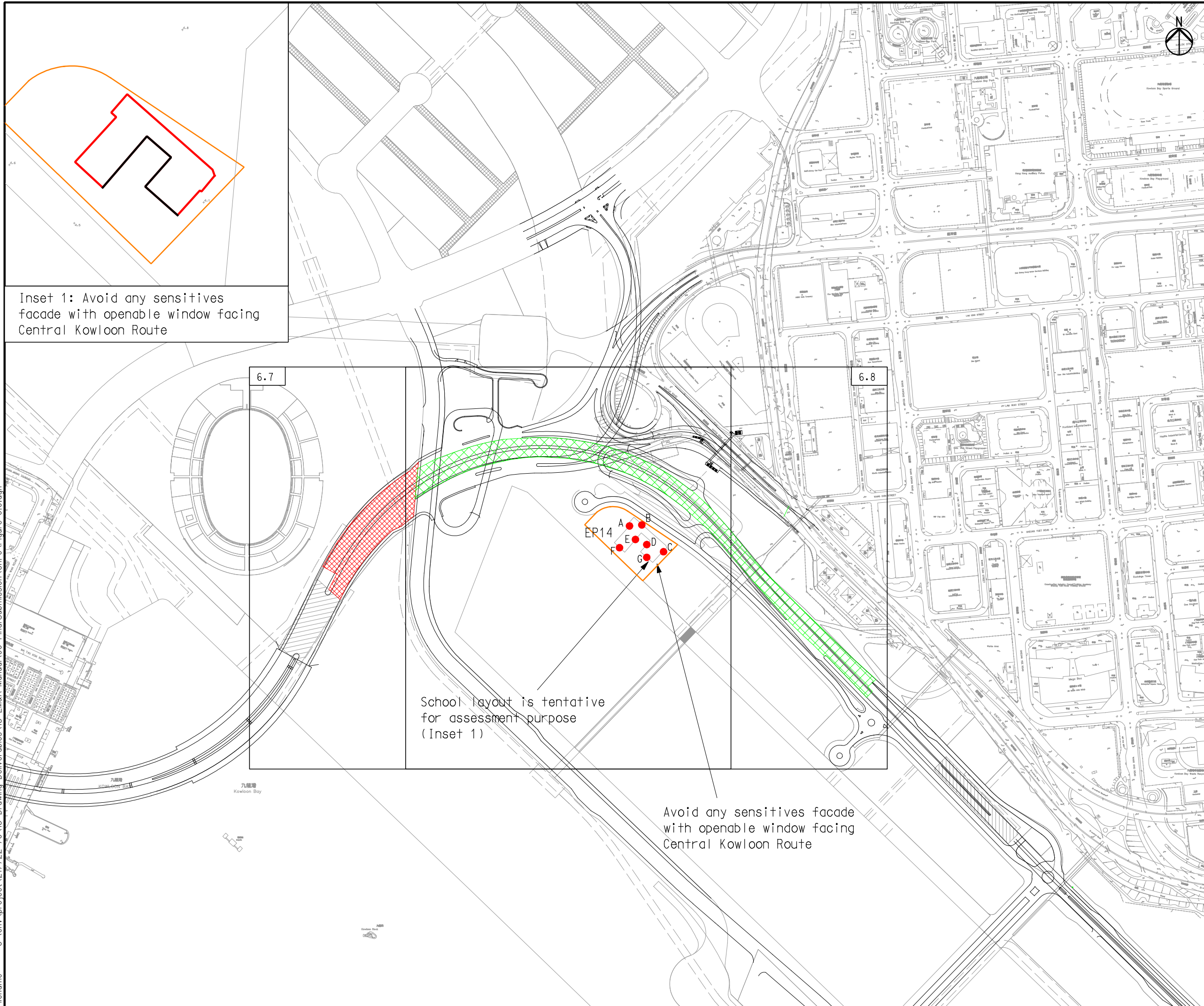

Inset 1: Avoid any sensitive facade with openable window facing Central Kowloon Route

6.7

6.8

School layout is tentative for assessment purpose (Inset 1)

Avoid any sensitive facade with openable window facing Central Kowloon Route

- Legend
- CKR Alignment
 - Planned Site 3B1
 - Low Noise Road Surfacing
 - Landscape Deck
 - Avoid any sensitive facade with openable window facing Central Kowloon Route

E	FIFTH ISSUE	GL	12/12
D	FOURTH ISSUE	GL	09/12
C	THIRD ISSUE	GL	06/12
B	SECOND ISSUE	GL	03/12
A	FIRST ISSUE	GL	12/11
Rev	Description	By	Date

Consultant

Project title
Agreement No. CE 43/2010 (HY)
Central Kowloon Route - Design and Construction

Drawing title
Location of Proposed Noise Mitigation Measures for Road Traffic Noise (East Portion) (Sheet 1 of 3)

Drawing no. Figure 6.6		Rev. E	
Drawn GL	Date 12/12	Checked FC	Approved ST
Scale 1:5000 ON A3	Status PRELIMINARY		

COPYRIGHT RESERVED

路政署
HIGHWAYS DEPARTMENT
 主要工程管理處
 MAJOR WORKS PROJECT MANAGEMENT OFFICE