





Appendix 4.1a Photographs of Existing NSRs

<p>NSR: Yau Lai Estate Phase 1 AP: N1101 – N1104</p>	<p>NSR: Yau Lai Estate Phase 1 AP: N1201 – N1204</p>
 A low-angle photograph of several tall, beige residential towers. The towers are densely packed with windows and balconies. A glass-enclosed walkway or skybridge is visible at the bottom of the frame.	 A low-angle photograph of tall residential towers, similar to the previous one. A prominent glass-enclosed walkway or skybridge is visible in the foreground, partially obscuring the base of the towers.
<p>NSR: Yau Lai Estate Phase 1 AP: N1301, N1302</p>	<p>NSR: Yau Lai Estate Phase 1 AP: N1303 – N1304</p>
 A low-angle photograph of tall residential towers, showing multiple towers side-by-side. The towers are beige with many windows and balconies.	 A low-angle photograph of tall residential towers, showing multiple towers side-by-side. The towers are beige with many windows and balconies.

Appendix 4.1a Photographs of Existing NSRs

<p>NSR: Yau Lai Estate Phase 1 AP: N1401 –N1404</p> 	<p>NSR: Yau Lai Estate Phase 1 AP: N1501 – N1503</p> 
<p>NSR: Yau Lai Estate Phase 1 AP: N1601, N1602</p> 	<p>NSR: Yau Lai Estate Phase 5 AP: N2101 –N2105</p> 

Appendix 4.1a Photographs of Existing NSRs

<p>NSR: Yau Lai Estate Phase 5 AP: N2201- N2204</p> 	<p>NSR: Yau Lai Estate Phase 5 AP: N2205 –N2206</p> 
<p>NSR: Tin Hau Temple AP: N3101a-N3101b</p> 	<p>NSR: Physartrain 90's Sports & Leisure Centre AP: N3102, N3103</p> 





Appendix 4.1a Photographs of Existing NSRs

<p>NSR: No. 121 Cha Kwo Ling Village AP: N3104</p>	<p>NSR: No. 100 Cha Kwo Ling Village AP: N3105</p>
	
<p>NSR: Kwong Ching House, Kwong Tin Estate AP: N3201</p>	<p>NSR: Kei Faat Primary School AP: N4101</p>
	
<p>NSR: SKH Yau Tong Kei Hin Primary School AP: N4101</p>	
	





Appendix 4.1a Photographs of Existing NSRs

<p>NSR: Ocean Shores AP: N5011-N5012</p>	<p>NSR: Ocean Shores AP: N5013</p>
	
<p>NSR: Ocean Shores AP: N5071-N5073</p>	<p>NSR: Ocean Shores AP: N5171-N5173</p>
	

Appendix 4.1a Photographs of Existing NSRs

<p>NSR: Metro Town AP: N6101-N6102</p>	<p>NSR: Metro Town AP: N6201, N6202</p>
	
<p>NSR: Metro Town AP: N6301, N6302</p>	<p>NSR: Park Central AP: N7201, N7301, N7501, N7603 - N7605</p>
	

Appendix 4.1a Photographs of Existing NSRs

<p>NSR: Park Central AP: N7001-N7002, N7102, N7202, N7302, N7502</p>	<p>NSR: Park Central AP: N7601-N7602</p>
	
<p>NSR: Park Central AP: N7701</p>	<p>NSR: Park Central AP: N7702-N7703</p>
	

Appendix 4.1a Photographs of Existing NSRs

<p>NSR: Tong Ming Court AP: N8101 - N8102</p>	<p>NSR: Choi Ming Court AP: N8103</p>
 A photograph showing several high-rise residential buildings of Tong Ming Court. The buildings are tall and modern, with a mix of white and grey facades. In the foreground, there is a road with a concrete barrier and some greenery. The sky is overcast.	 A photograph of Choi Ming Court residential buildings. The buildings are tall and modern, with a mix of white and grey facades. There are trees in the foreground, and a blue signpost is visible. The sky is overcast.
<p>NSR: Choi Ming Court AP: N8104</p>	<p>NSR: Po Kok Secondary School AP: N9101</p>
 A photograph of Choi Ming Court residential buildings. The buildings are tall and modern, with a mix of white and grey facades. The sky is overcast.	 A photograph of Po Kok Secondary School. The school building is a multi-story structure with a pinkish facade. In the foreground, there is a construction site with a blue crane and a red and white striped barrier. The sky is overcast.

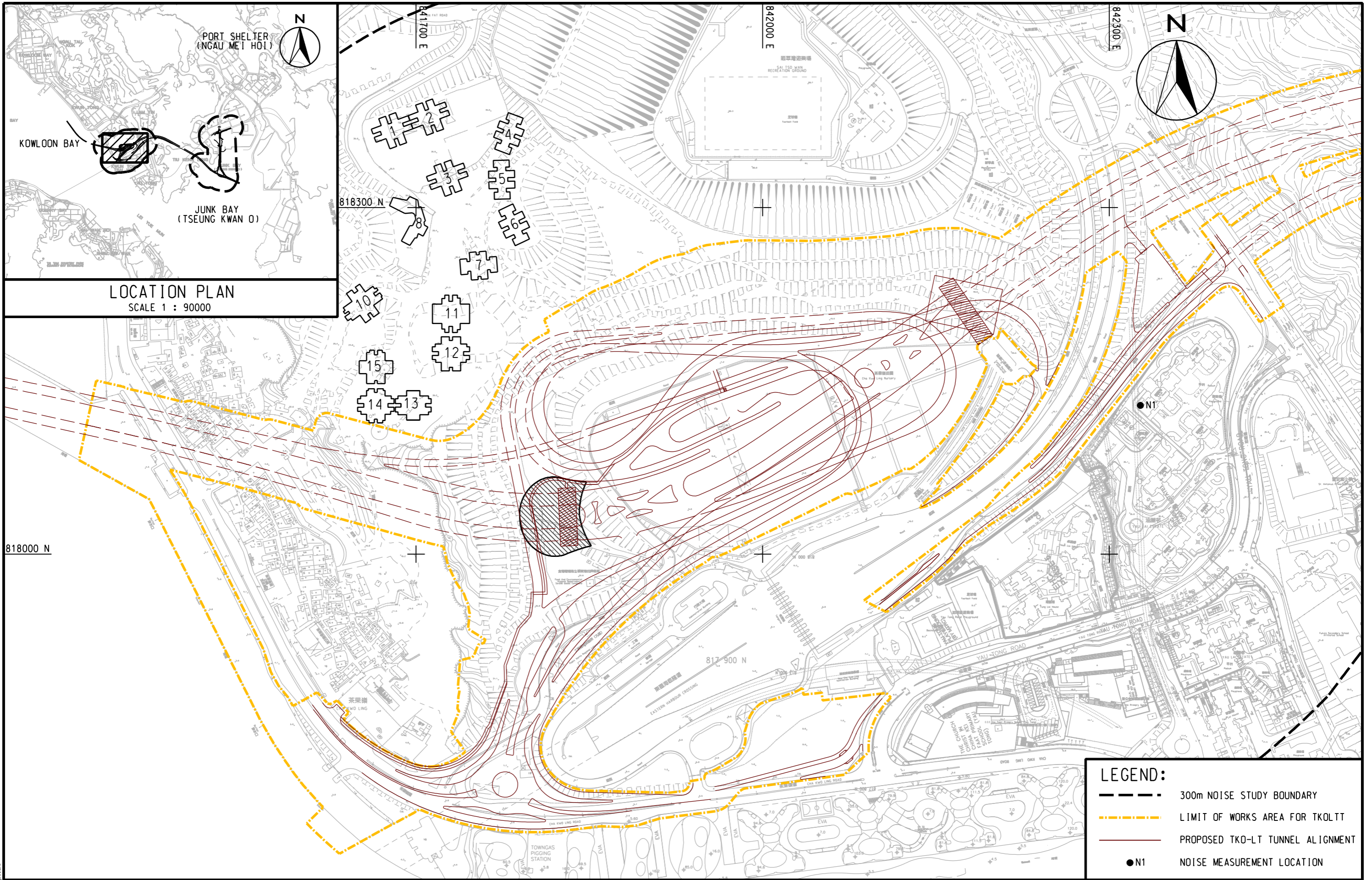
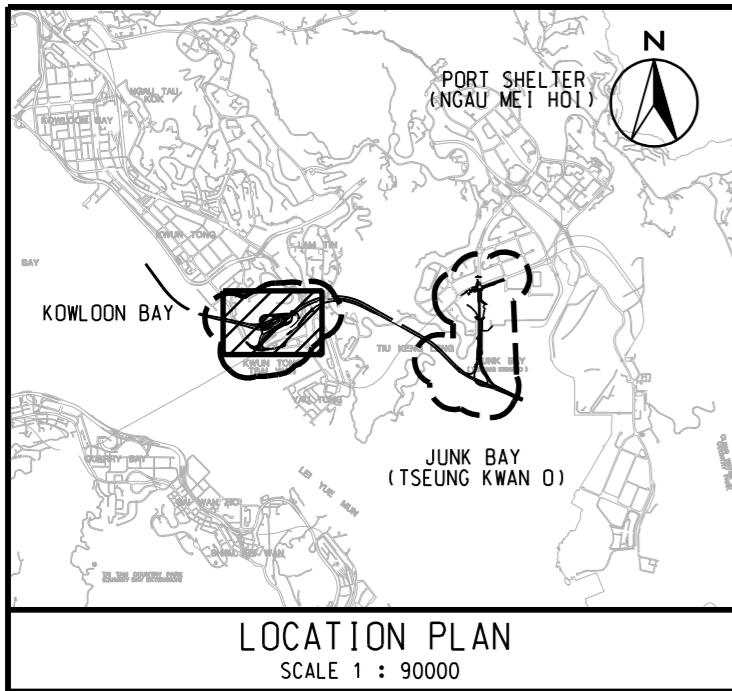

LEGEND:

- 300m NOISE STUDY BOUNDARY
- - - - - LIMIT OF WORKS AREA FOR TKOLTT
- PROPOSED TKO-LT TUNNEL ALIGNMENT
- N1 NOISE MEASUREMENT LOCATION

AGREEMENT NO. CE 42/2008 (CE)
TSEUNG KWAN O - LAM TIN TUNNEL AND ASSOCIATED WORKS - INVESTIGATION
BACKGROUND NOISE MEASUREMENT LOCATIONS

SHEET 1 OF 2

SCALE	A3 1 : 3000	DATE	JAN. 2013
CHECK	---	DRAWN	HLL
JOB No.	60097677	DRAWING No.	APPENDIX 4.1b
		REV	---



Plot File by : 1/26/2013 QTCAM

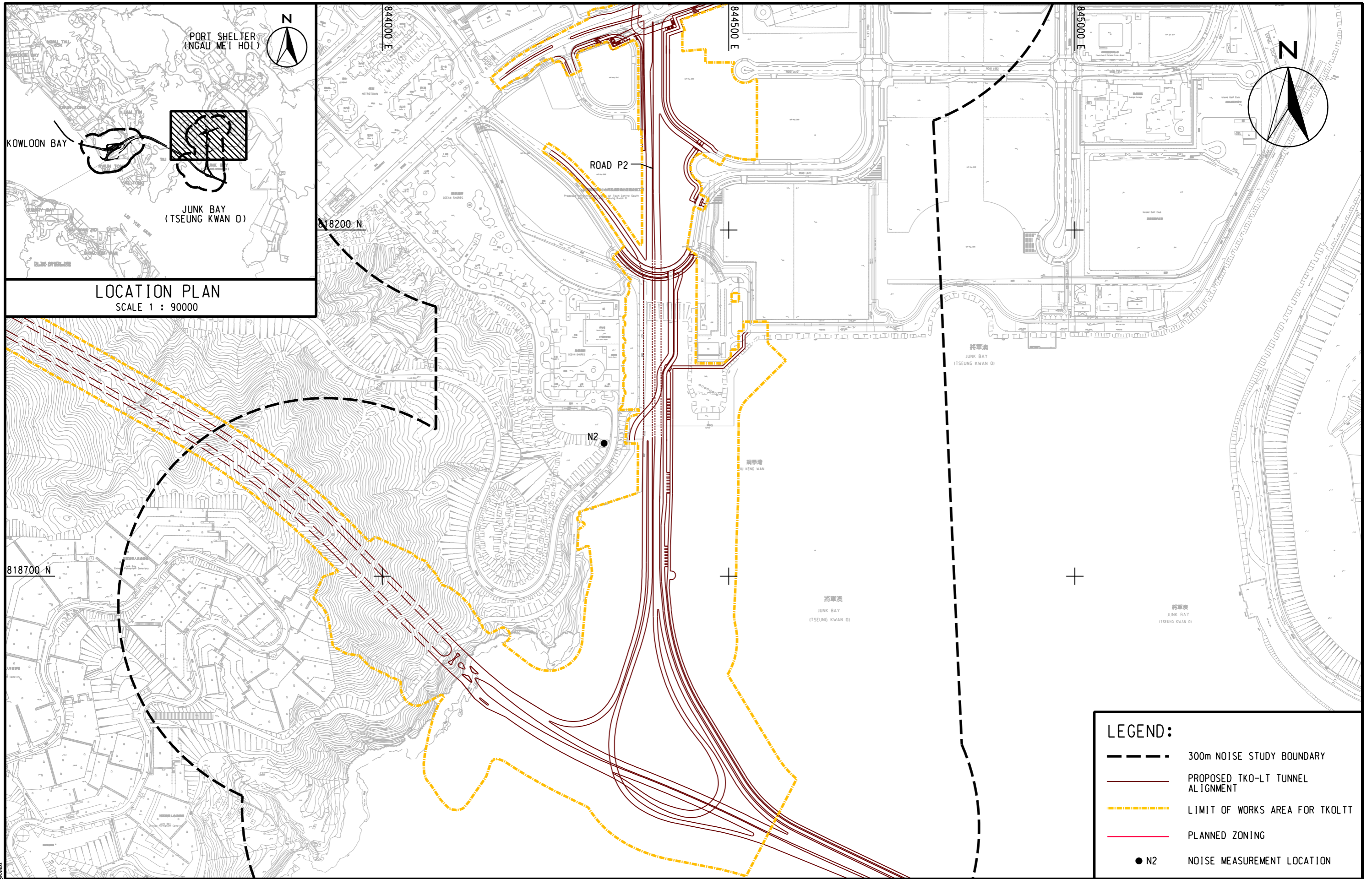

LOCATION PLAN
SCALE 1 : 9000

LEGEND:			
	300m NOISE STUDY BOUNDARY		PROPOSED TKO-LT TUNNEL ALIGNMENT
	LIMIT OF WORKS AREA FOR TKOLTT		PLANNED ZONING
	N2		NOISE MEASUREMENT LOCATION



AGREEMENT NO. CE 42/2008 (CE)
TSEUNG KWAN O - LAM TIN TUNNEL AND ASSOCIATED WORKS - INVESTIGATION
BACKGROUND NOISE MEASUREMENT LOCATIONS

SHEET 2 OF 2

SCALE	A3 1 : 5000	DATE	JAN. 2013
CHECK	--	DRAWN	HLLS
JOB No.	60097677	DRAWING No.	APPENDIX 4.1b
		REV	--

Plot File by : 1/26/2013 QTCAM