

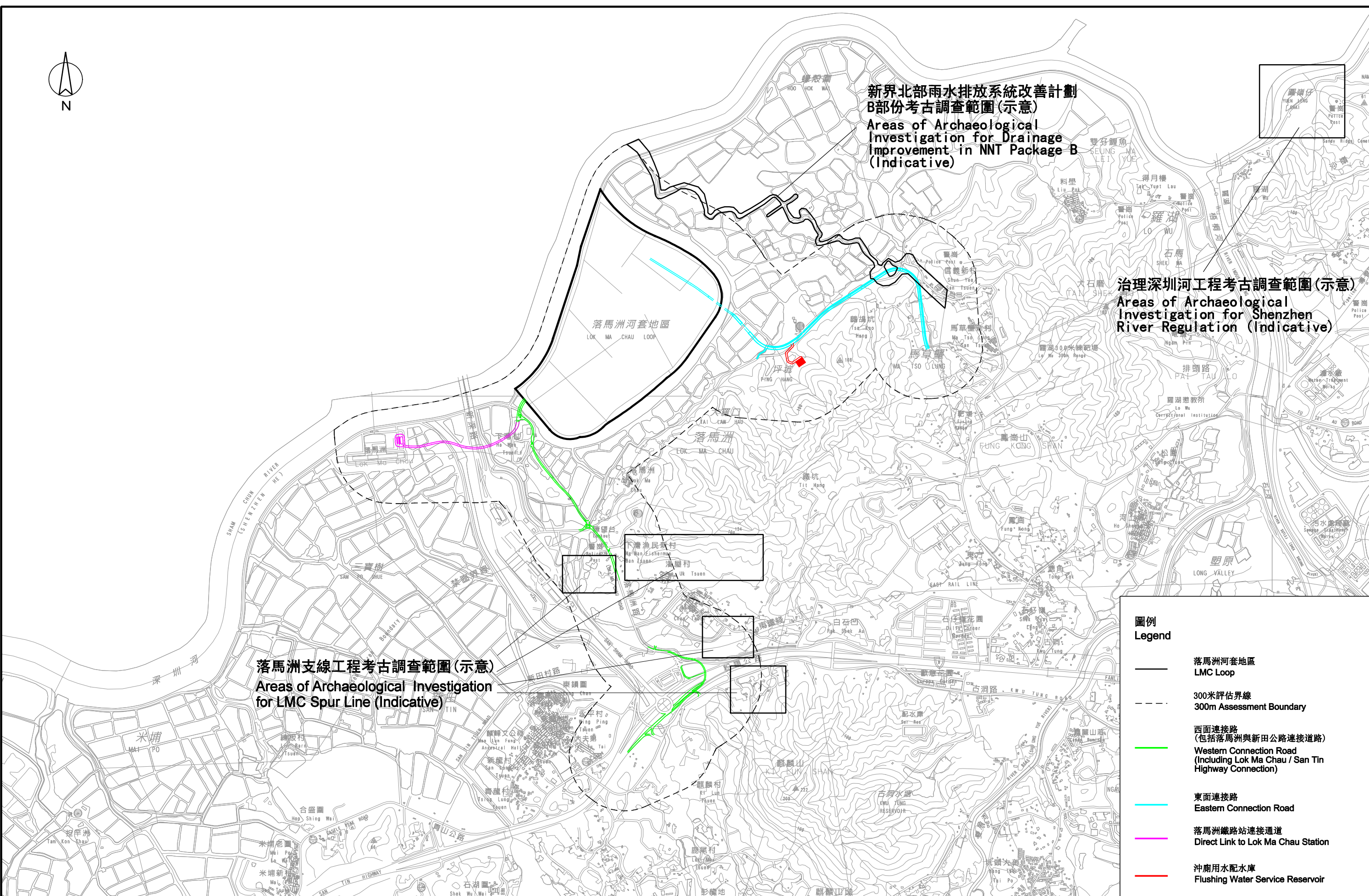

新界北部雨水排放系統改善計劃
B部份考古調查範圍(示意)
Areas of Archaeological
Investigation for Drainage
Improvement in NNT Package B
(Indicative)

治理深圳河工程考古調查範圍(示意)
Areas of Archaeological
Investigation for Shenzhen
River Regulation (Indicative)

落馬洲支線工程考古調查範圍(示意)
Areas of Archaeological Investigation
for LMC Spur Line (Indicative)



- 圖例**
Legend
- 落馬洲河套地區
LMC Loop
 - 300米評估界線
300m Assessment Boundary
 - 西面連接路
(包括落馬洲與新田公路連接道路)
Western Connection Road
(Including Lok Ma Chau / San Tin
Highway Connection)
 - 東面連接路
Eastern Connection Road
 - 落馬洲鐵路站連接通道
Direct Link to Lok Ma Chau Station
 - 沖廁用水配水庫
Flushing Water Service Reservoir