

**圖例**  
**LEGEND**

-  落馬洲河套地區  
LMC Loop
-  500米評估界線  
500m Assessment Boundary
-  西面連接路 (包括落馬洲與新田公路連接道路)  
Western Connection Road  
(Including Lok Ma Chau / San Tin Highway Connection)
-  東面連接路  
Eastern Connection Road
-  落馬洲鐵路站連接通道  
Direct Link to Lok Ma Chau Station
-  沖廁用水配水庫  
Flushing Water Service Reservoir
-  空氣敏感受體  
Air Sensitive Receivers

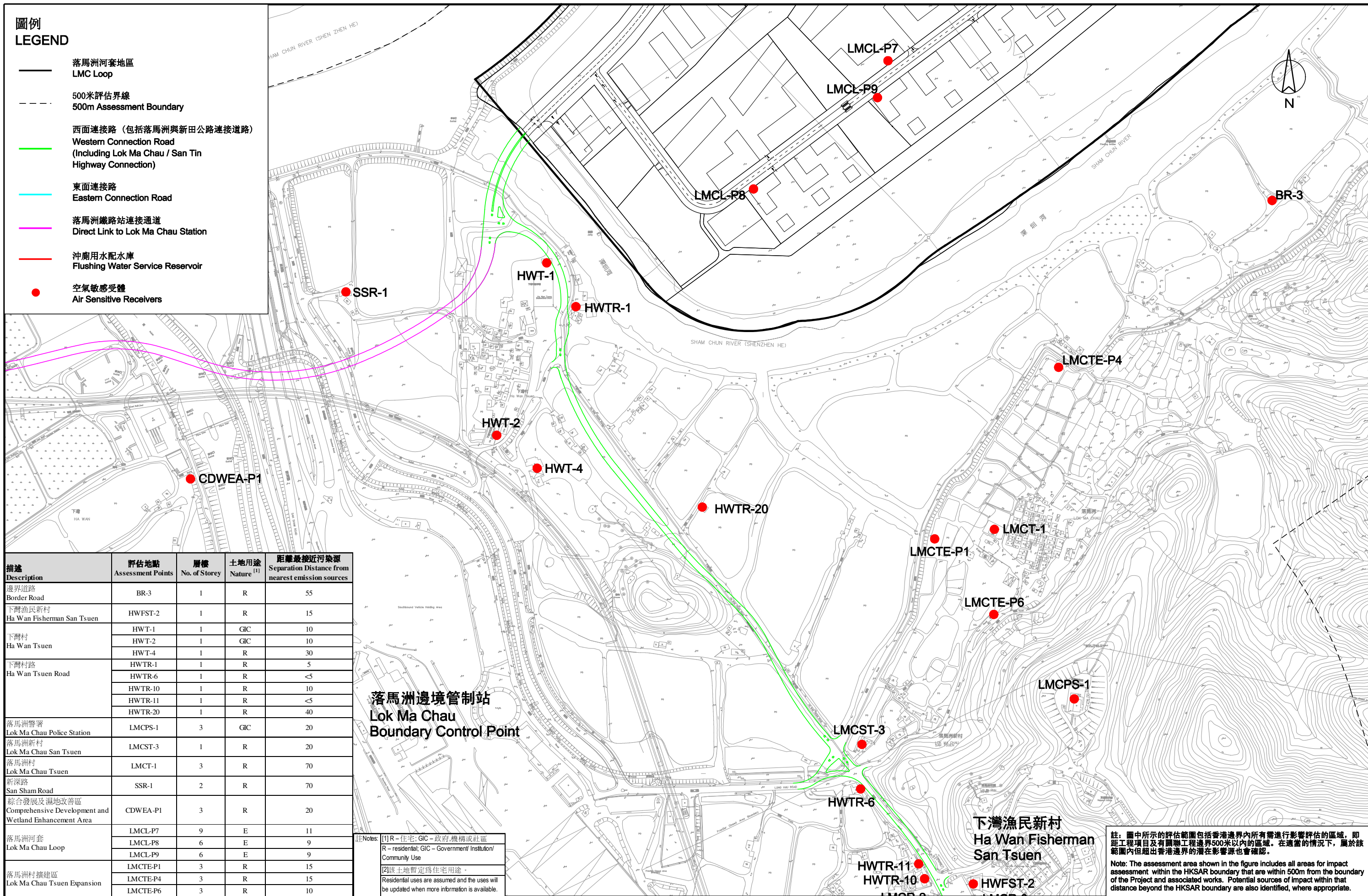

描述 Description	評估地點 Assessment Points	層樓 No. of Storey	土地用途 Nature <sup>(1)</sup>	距離最近污染源 Separation Distance from nearest emission sources
邊界道路 Border Road	BR-3	1	R	55
下灣漁民新村 Ha Wan Fisherman San Tsuen	HWFST-2	1	R	15
下灣村 Ha Wan Tsuen	HWT-1	1	GIC	10
	HWT-2	1	GIC	10
	HWT-4	1	R	30
下灣村路 Ha Wan Tsuen Road	HWTR-1	1	R	5
	HWTR-6	1	R	<5
	HWTR-10	1	R	10
	HWTR-11	1	R	<5
	HWTR-20	1	R	40
落馬洲警署 Lok Ma Chau Police Station	LMCPS-1	3	GIC	20
落馬洲新村 Lok Ma Chau San Tsuen	LMCST-3	1	R	20
落馬洲村 Lok Ma Chau Tsuen	LMCT-1	3	R	70
新深路 San Sham Road	SSR-1	2	R	70
綜合發展及濕地改善區 Comprehensive Development and Wetland Enhancement Area	CDWEA-P1	3	R	20
落馬洲河套 Lok Ma Chau Loop	LMCL-P7	9	E	11
	LMCL-P8	6	E	9
	LMCL-P9	6	E	9
	LMCTE-P1	3	R	15
落馬洲村擴建區 Lok Ma Chau Tsuen Expansion	LMCTE-P4	3	R	15
	LMCTE-P6	3	R	10

落馬洲邊境管制站  
Lok Ma Chau  
Boundary Control Point

下灣漁民新村  
Ha Wan Fisherman  
San Tsuen

註: (1) R - 住宅; GIC - 政府、機構或社區  
R - residential; GIC - Government/Institution/  
Community Use  
(2) 該土地暫定為住宅用途。  
Residential uses are assumed and the uses will  
be updated when more information is available.

註: 圖中所示的評估範圍包括香港邊界內所有需進行影響評估的區域, 即距工程項目及有關聯工程邊界500米以內的區域。在適當的情況下, 屬於該範圍內但超出香港邊界的潛在影響源也會確認。  
Note: The assessment area shown in the figure includes all areas for impact assessment within the HKSAR boundary that are within 500m from the boundary of the Project and associated works. Potential sources of impact within that distance beyond the HKSAR boundary are also identified, where appropriate.