

圖例
LEGEND

- 落馬洲河套地區
LMC Loop
- 500米評估界線
500m Assessment Boundary
- 西面連接路 (包括落馬洲與新田公路連接道路)
Western Connection Road
(Including Lok Ma Chau / San Tin Highway Connection)
- 東面連接路
Eastern Connection Road
- 落馬洲鐵路站連接通道
Direct Link to Lok Ma Chau Station
- 沖廁用水配水庫
Flush Water Service Reservoir
- 空氣敏感受體
Air Sensitive Receivers

注：图中所示的评估范围包括香港边界内所有需进行影响的区域，即距工程项目及有相关工程边界500米以内的区域。在适当的情况下，属于该范围内但超出香港边界的潜在影响源也会确认。
 Note: The assessment area shown in the figure includes all areas for impact assessment within the HKSAR boundary that are within 500m from the boundary of the Project and associated works. Potential sources of impact within that distance beyond the HKSAR boundary are also identified, where appropriate.

CEDD 土木工程拓展署
CIVIL ENGINEERING AND DEVELOPMENT DEPARTMENT

PLANNING DEPARTMENT
規劃署

ARUP
奧雅納工程顧問
Ove Arup & Partners
Hong Kong Limited

研究項目 Job Title
合約編號 Agreement No. CE 53/2008 (CE)
落馬洲河套地區發展規劃及工程研究 - 調查研究
Planning and Engineering Study on
Development of Lok Ma Chau Loop - Investigation

圖則項目 Title
現存及擬建的空氣敏感受體位置 (索引圖)
Locations of Existing and Planned Air Sensitive Receivers (Key Plan)

圖則編號 Figure No.
3.2

圖則 Scale
1:20000 ON A3

修訂編號 Rev.
-

描述 Description	評估地點 Assessment Points	層樓 No. of Storey	土地用途 Nature ^[1]
洲頭村 Chau Tau Tsuen	CTT-3	3	R
下灣村路 Ha Wan Tsuen Road	HWTR-11	1	R
	HWTR-20	1	R
	LMCR-2	2	R
落馬洲路 Lok Ma Chau Road	LMCR-5	2	R
	LMCR-8	1	R
	LMCR-12	1	W
	LMCR-14	3	W
潘屋村 Pun Uk Tsuen	LMCR-15	3	R
	PUT-2	3	R
永平村 Near Wing Ping Tsuen	WPT-1	3	R

註Notes: [1] R - 住宅; GIC - 政府、機構或社區
R - residential; GIC - Government/Institution/Community Use
[2] 該土地暫定為住宅用途。
Residential uses are assumed and the uses will be updated when more information is available.

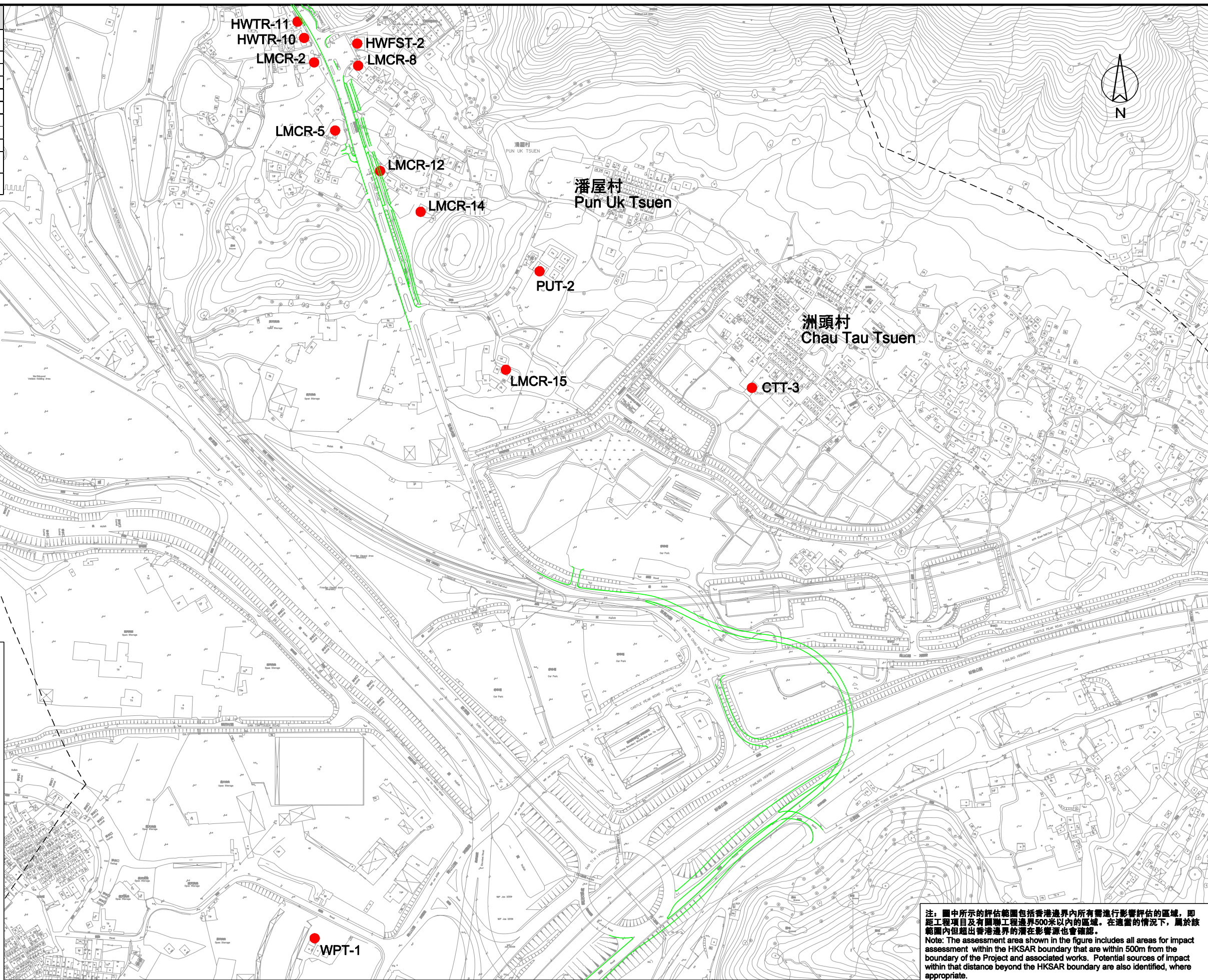

**圖例
LEGEND**

- 落馬洲河套地區
LMC Loop
- 500米評估界線
500m Assessment Boundary
- 西面連接路 (包括落馬洲與新田公路連接道路)
Western Connection Road
(Including Lok Ma Chau / San Tin Highway Connection)
- 東面連接路
Eastern Connection Road
- 落馬洲鐵路站連接通道
Direct Link to Lok Ma Chau Station
- 沖廁用水配水庫
Flush Water Service Reservoir
- 空氣敏感受體
Air Sensitive Receivers

注：圖中所示的評估範圍包括香港邊界內所有需進行影響評估的區域，即距工程項目及有關聯工程邊界500米以內的區域。在適當的情況下，屬於該範圍內但超出香港邊界的潛在影響源也會確認。
Note: The assessment area shown in the figure includes all areas for impact assessment within the HKSAR boundary that are within 500m from the boundary of the Project and associated works. Potential sources of impact within that distance beyond the HKSAR boundary are also identified, where appropriate.

圖例
LEGEND

- 落馬洲河套地區
LMC Loop
- 500米評估界線
500m Assessment Boundary
- 西面連接路 (包括落馬洲與新田公路連接道路)
Western Connection Road
(Including Lok Ma Chau / San Tin Highway Connection)
- 東面連接路
Eastern Connection Road
- 落馬洲鐵路站連接通道
Direct Link to Lok Ma Chau Station
- 沖廁用水配水庫
Flush Water Service Reservoir
- 空氣敏感受體
Air Sensitive Receivers

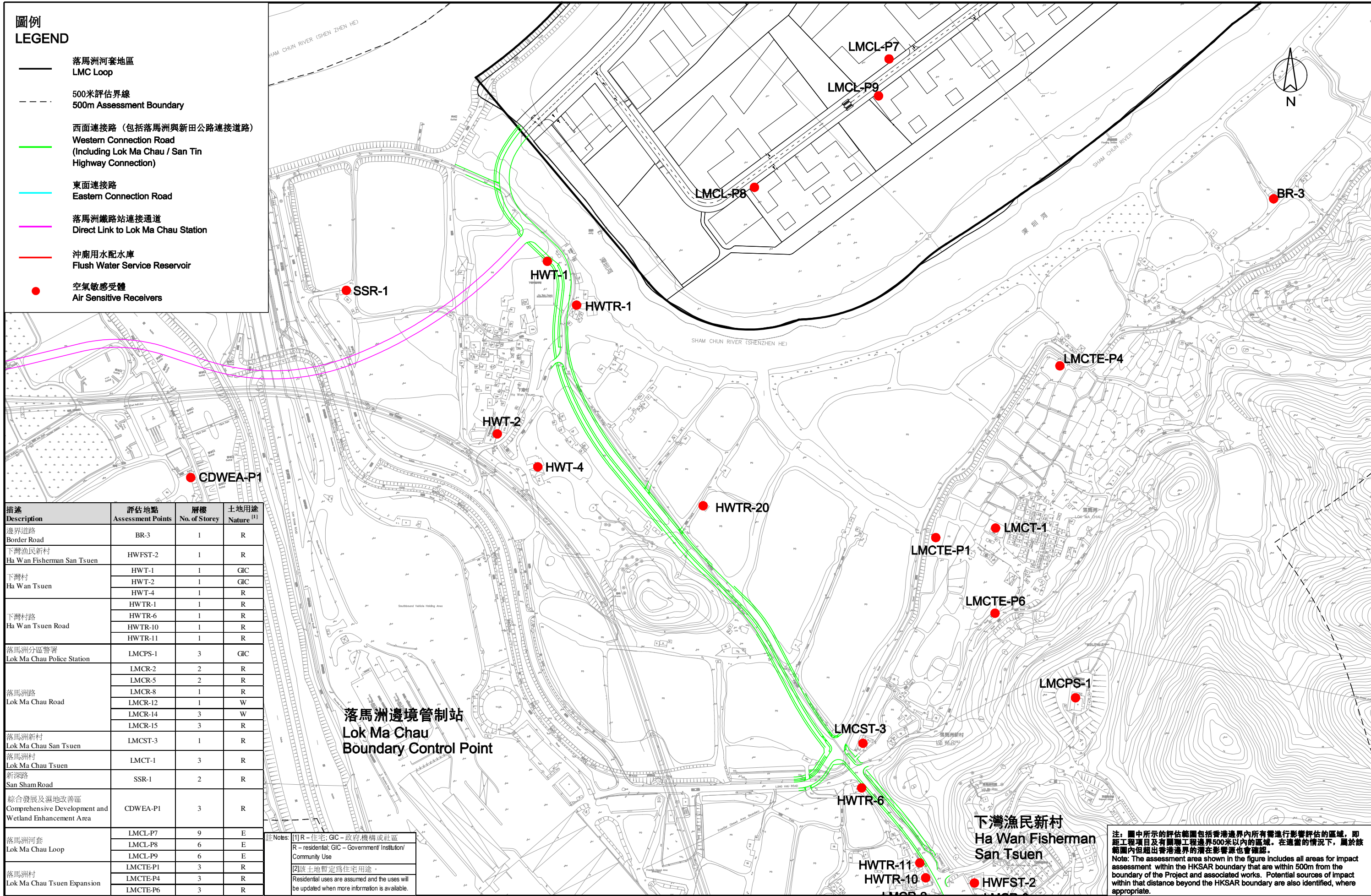

描述 Description	評估地點 Assessment Points	層樓 No. of Storey	土地用途 Nature ^[1]
邊界道路 Border Road	BR-3	1	R
下灣漁民新村 Ha Wan Fisherman San Tsuen	HWFS-2	1	R
	HWT-1	1	GIC
下灣村 Ha Wan Tsuen	HWT-2	1	GIC
	HWT-4	1	R
下灣村路 Ha Wan Tsuen Road	HWT-1	1	R
	HWTR-6	1	R
	HWTR-10	1	R
	HWTR-11	1	R
落馬洲分區警署 Lok Ma Chau Police Station	LMCP-1	3	GIC
	LMCR-2	2	R
	LMCR-5	2	R
	LMCR-8	1	R
	LMCR-12	1	W
落馬洲路 Lok Ma Chau Road	LMCR-14	3	W
	LMCR-15	3	R
	LMCS-3	1	R
落馬洲新村 Lok Ma Chau San Tsuen	LMCT-1	3	R
落馬洲村 Lok Ma Chau Tsuen	LMCT-1	3	R
新深路 San Sham Road	SSR-1	2	R
綜合發展及濕地改善區 Comprehensive Development and Wetland Enhancement Area	CDWEA-P1	3	R
落馬洲河套 Lok Ma Chau Loop	LMCL-P7	9	E
	LMCL-P8	6	E
	LMCL-P9	6	E
	LMCTE-P1	3	R
落馬洲村 Lok Ma Chau Tsuen Expansion	LMCTE-P4	3	R
	LMCTE-P6	3	R
	LMCTE-P9	3	R

註: [1] R - 住宅; GIC - 政府機構或社區
R - residential; GIC - Government Institution/Community Use
[2] 該土地暫定為住宅用途
Residential uses are assumed and the uses will be updated when more information is available.

注: 圖中所示的評估範圍包括香港邊界內所有需進行影響評估的區域, 即距工程項目及有關聯工程邊界500米以內的區域。在適當的情況下, 屬於該範圍內但超出香港邊界的潛在影響源也會確認。
Note: The assessment area shown in the figure includes all areas for impact assessment within the HKSAR boundary that are within 500m from the boundary of the Project and associated works. Potential sources of impact within that distance beyond the HKSAR boundary are also identified, where appropriate.

落馬洲邊境管制站
Lok Ma Chau Boundary Control Point

下灣漁民新村
Ha Wan Fisherman San Tsuen

描述 Description	評估地點 Assessment Points	層樓 No. of Storey	土地用途 Nature ^[1]
邊界道路 Border Road	BR-4	2	R
落馬洲河套 Lok Ma Chau Loop	LMCL-P1	8	E
	LMCL-P2	8	E
	LMCL-P4	10	E
	LMCL-P6	9	E
	LMCL-P7	9	E
	LMCL-P11	6	E
	LMCL-P12	8	E
	LMCL-P15	8	E
	LMCL-P16	10	E
	LMCL-P17	10	E
	LMCL-P18	9	E
	LMCL-P19	9	E
	LMCL-P21	9	E
LMCL-P23	9	E	
LMCL-P24	10	E	
LMCL-P25	10	E	
LMCL-P26	6	E	
LMCL-P27	6	E	
LMCL-P28	6	E	
建議消防局及救護站 Proposed Fire Station and Ambulance Depot	FS-P1	10	GIC

註Notes: [1] R - 住宅; GIC - 政府、機構或社區
R - residential; GIC - Government/Institution/Community Use
[2] 該土地暫定為住宅用途。
Residential uses are assumed and the uses will be updated when more information is available.

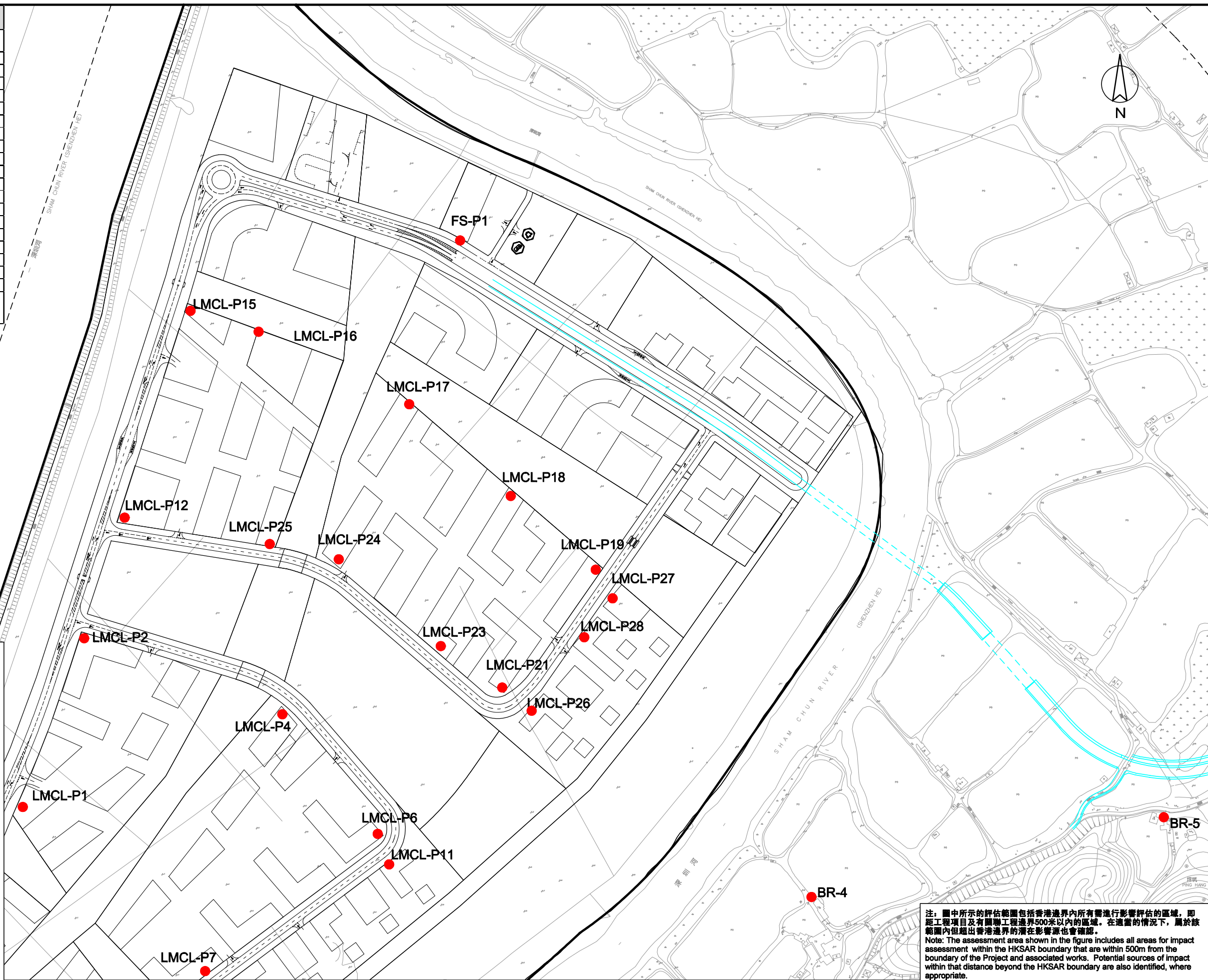

**圖例
LEGEND**

- 落馬洲河套地區
LMC Loop
- 500米評估界線
500m Assessment Boundary
- 西面連接路 (包括落馬洲與新田公路連接道路)
Western Connection Road
(Including Lok Ma Chau / San Tin Highway Connection)
- 東面連接路
Eastern Connection Road
- 落馬洲鐵路站連接通道
Direct Link to Lok Ma Chau Station
- 沖廁用水配水庫
Flush Water Service Reservoir
- 空氣敏感受體
Air Sensitive Receivers

注: 圖中所示的評估範圍包括香港邊界內所有需進行影響評估的區域, 即距工程項目及有關聯工程邊界500米以內的區域。在適當的情況下, 屬於該範圍內但超出香港邊界的潛在影響源也會確認。
Note: The assessment area shown in the figure includes all areas for impact assessment within the HKSAR boundary that are within 500m from the boundary of the Project and associated works. Potential sources of impact within that distance beyond the HKSAR boundary are also identified, where appropriate.

圖例
LEGEND

-  落馬洲河套地區
LMC Loop
-  500米評估界線
500m Assessment Boundary
-  西面連接路 (包括落馬洲與新田公路連接道路)
Western Connection Road
(Including Lok Ma Chau / San Tin Highway Connection)
-  東面連接路
Eastern Connection Road
-  落馬洲鐵路站連接通道
Direct Link to Lok Ma Chau Station
-  沖廁用水配水庫
Flush Water Service Reservoir
-  空氣敏感受體
Air Sensitive Receivers

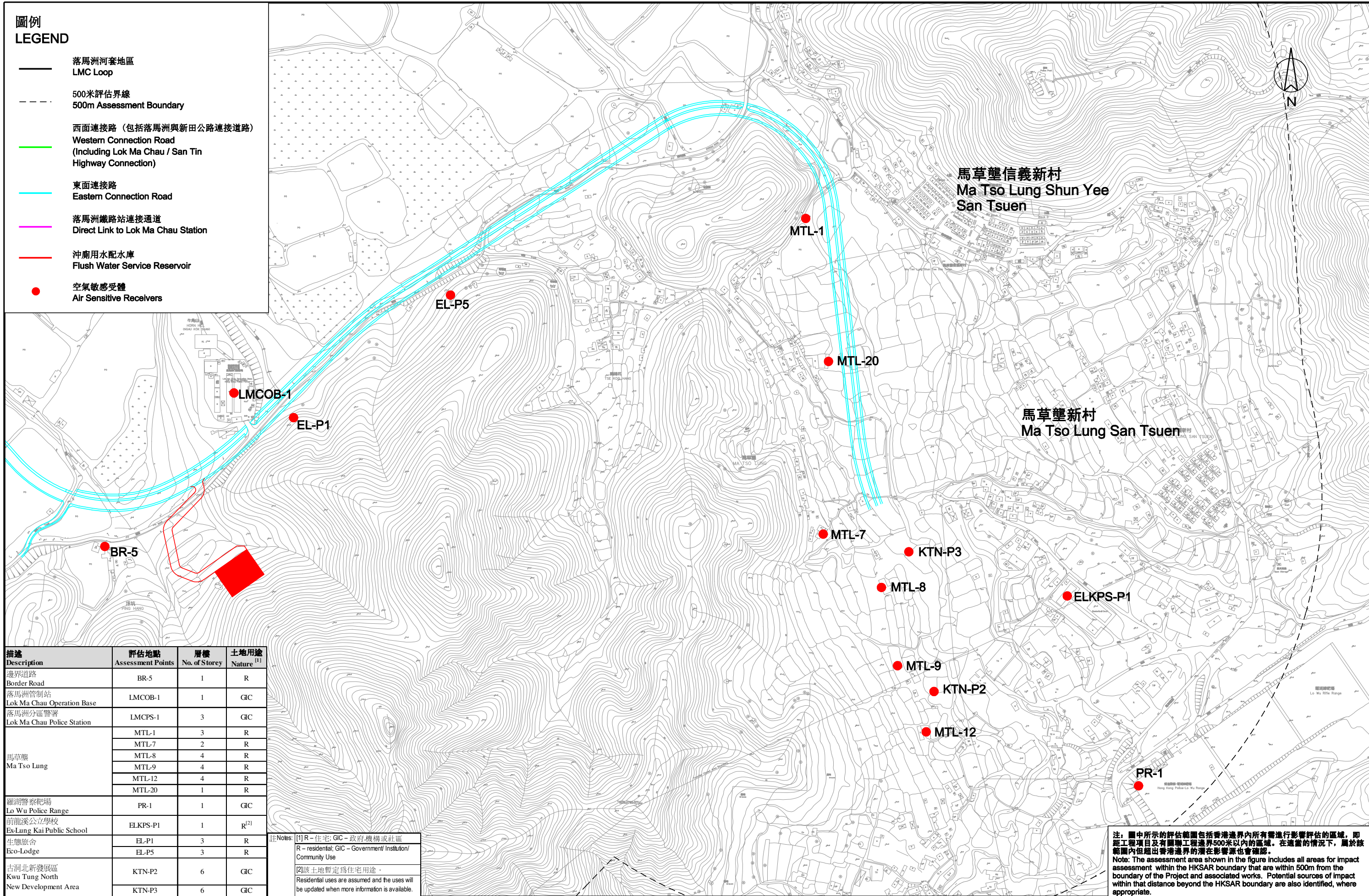

描述 Description	評估地點 Assessment Points	層樓 No. of Storey	土地用途 Nature ^[1]
邊界道路 Border Road	BR-5	1	R
落馬洲管制站 Lok Ma Chau Operation Base	LMCOB-1	1	GIC
落馬洲分區警署 Lok Ma Chau Police Station	LMCPS-1	3	GIC
馬草壟 Ma Tso Lung	MTL-1	3	R
	MTL-7	2	R
	MTL-8	4	R
	MTL-9	4	R
	MTL-12	4	R
羅湖警察靶場 Lo Wu Police Range	PR-1	1	GIC
前龍溪公立學校 Ex-Lung Kai Public School	ELKPS-P1	1	R ^[2]
生態旅舍 Eco-Lodge	EL-P1	3	R
	EL-P5	3	R
古洞北新發展區 Kwu Tung North New Development Area	KTN-P2	6	GIC
	KTN-P3	6	GIC

註: [1] R - 住宅; GIC - 政府機構或社區
R - residential; GIC - Government/ Institution/ Community Use
[2] 該土地暫定為住宅用途。
Residential uses are assumed and the uses will be updated when more information is available.

注: 圖中所示的評估範圍包括香港邊界內所有需進行影響評估的區域, 即距工程項目及有關工程邊界500米以內的區域。在適當的情況下, 屬於該範圍內但超出香港邊界的潛在影響源也會確認。
Note: The assessment area shown in the figure includes all areas for impact assessment within the HKSAR boundary that are within 500m from the boundary of the Project and associated works. Potential sources of impact within that distance beyond the HKSAR boundary are also identified, where appropriate.