

TYPICAL CROSS SECTION OF TWIN SUBMARINE OUTFALLS
 (WITHOUT DIFFUSERS FROM CH. 0.00 TO CH. 968.0)
 SCALE 1 : 250

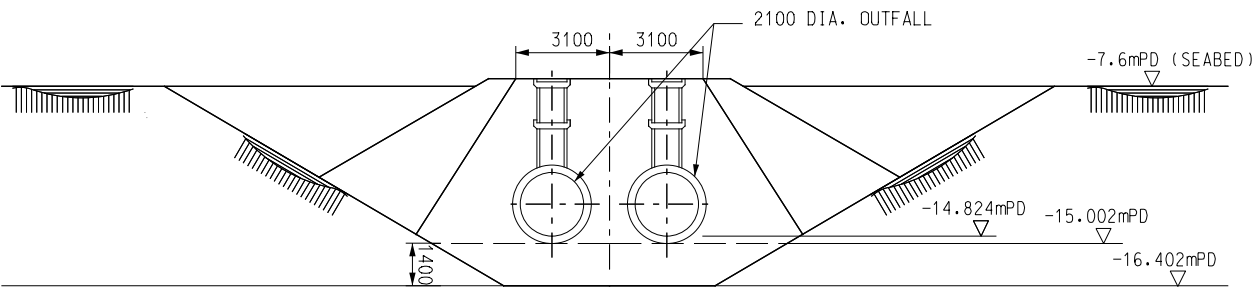

TYPICAL CROSS SECTION OF TWIN SUBMARINE OUTFALLS
 (WITH DIFFUSERS FROM CH. 968.0 TO CH. 1370.8)
 SCALE 1 : 250

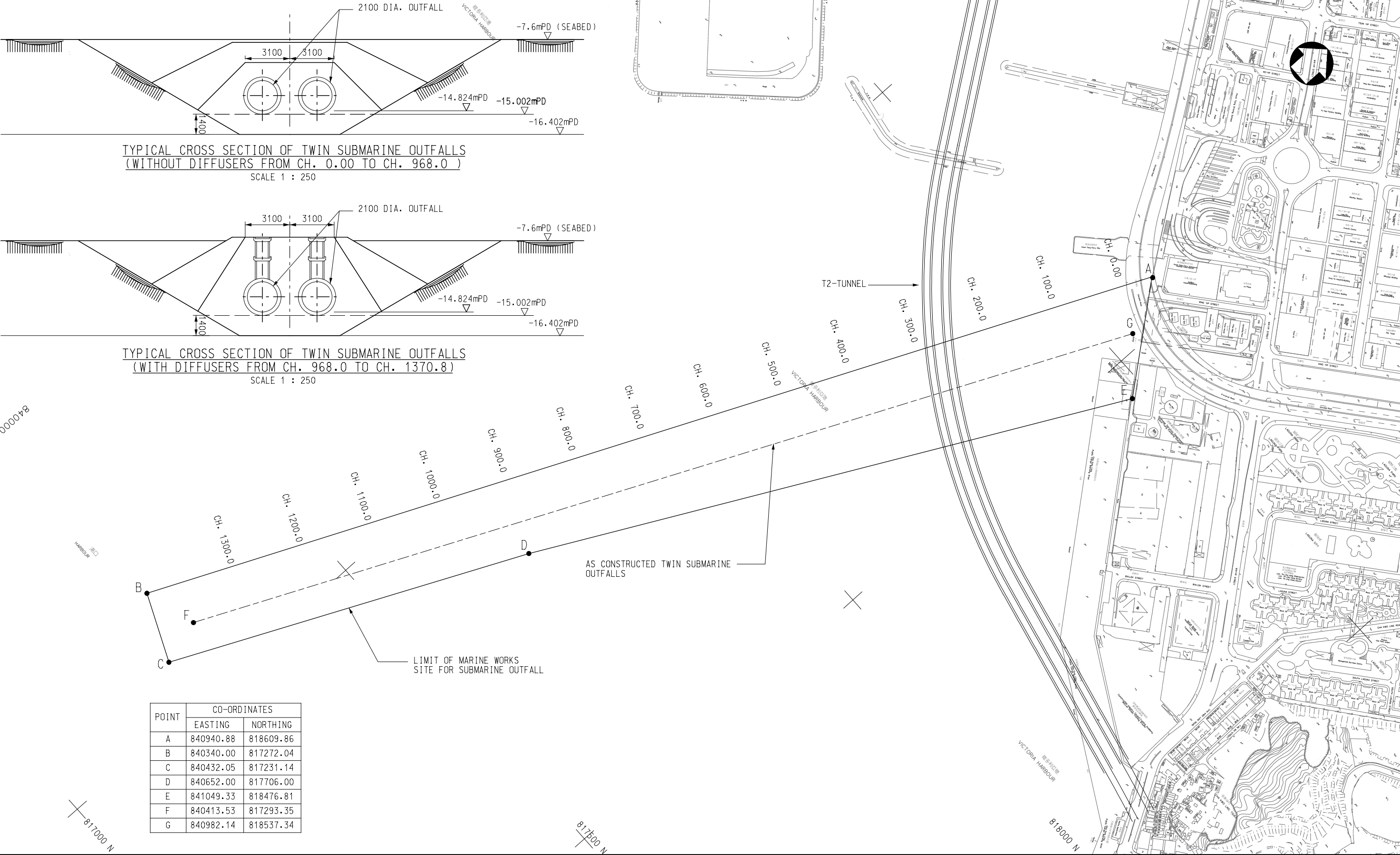

POINT	CO-ORDINATES	
	EASTING	NORTHING
A	840940.88	818609.86
B	840340.00	817272.04
C	840432.05	817231.14
D	840652.00	817706.00
E	841049.33	818476.81
F	840413.53	817293.35
G	840982.14	818537.34

Drawing title

TYPICAL ARRANGEMENT OF
 SUBMARINE OUTFALL

Original Size

A3

Scale 1 : 5000 Date DEC. 2012

File name EB000560_K_HCL_EIACH2_FIG.2-7.DGN

© Copyright reserved

Drawing No.

FIGURE 2.7

Rev.

1