

NOTE:

1. COORDINATES AREA RELATED TO HONG KONG METRIC GRID (1980)
2. CONCENTRATION SHOWN IN THIS DRAWING IS IN  $\mu\text{g}/\text{m}^3$
3. THE AQO CRITERIA FOR 24-HOUR AVERAGE CONCENTRATION OF  $\text{NO}_2$  AT 1.5m ABOVE GROUND IS  $150 \mu\text{g}/\text{m}^3$

LEGEND:

- SITE BOUNDARY
- AIR SENSITIVE RECEIVER
- 500m FROM SITE BOUNDARY

Rev.	Date	Description	Drawn	Checked

Department (Project Proponent) 部門 (項目營辦人):



Department (Works) 部門 (工程):



Lead Architect (Consultancy Agreement No. 9AX 034):  
建築顧問 (顧問合約編號 9AX 034)



Project Title 項目名稱  
REPROVISIONING OF FEHD SAI YEE STREET ENVIRONMENTAL HYGIENE OFFICES-CUM-VEHICLE DEPOT AT YEN MING ROAD, WEST KOWLOON RECLAMATION AREA  
在西九龍填海區欽明路重置食物環境衛生署洗衣街環境衛生辦事處車房

Drawing Title 圖則名稱

Contours of 24-Hour Average Concentration of  $\text{NO}_2$  at 1.5m Above Ground

Design	Drawn	Checked	Scale	Status
設計 TKHO	繪圖 DCYO	校核 ICWR	比例 AS SHOWN	狀態

Approved	Date	

URS Hong Kong Ltd

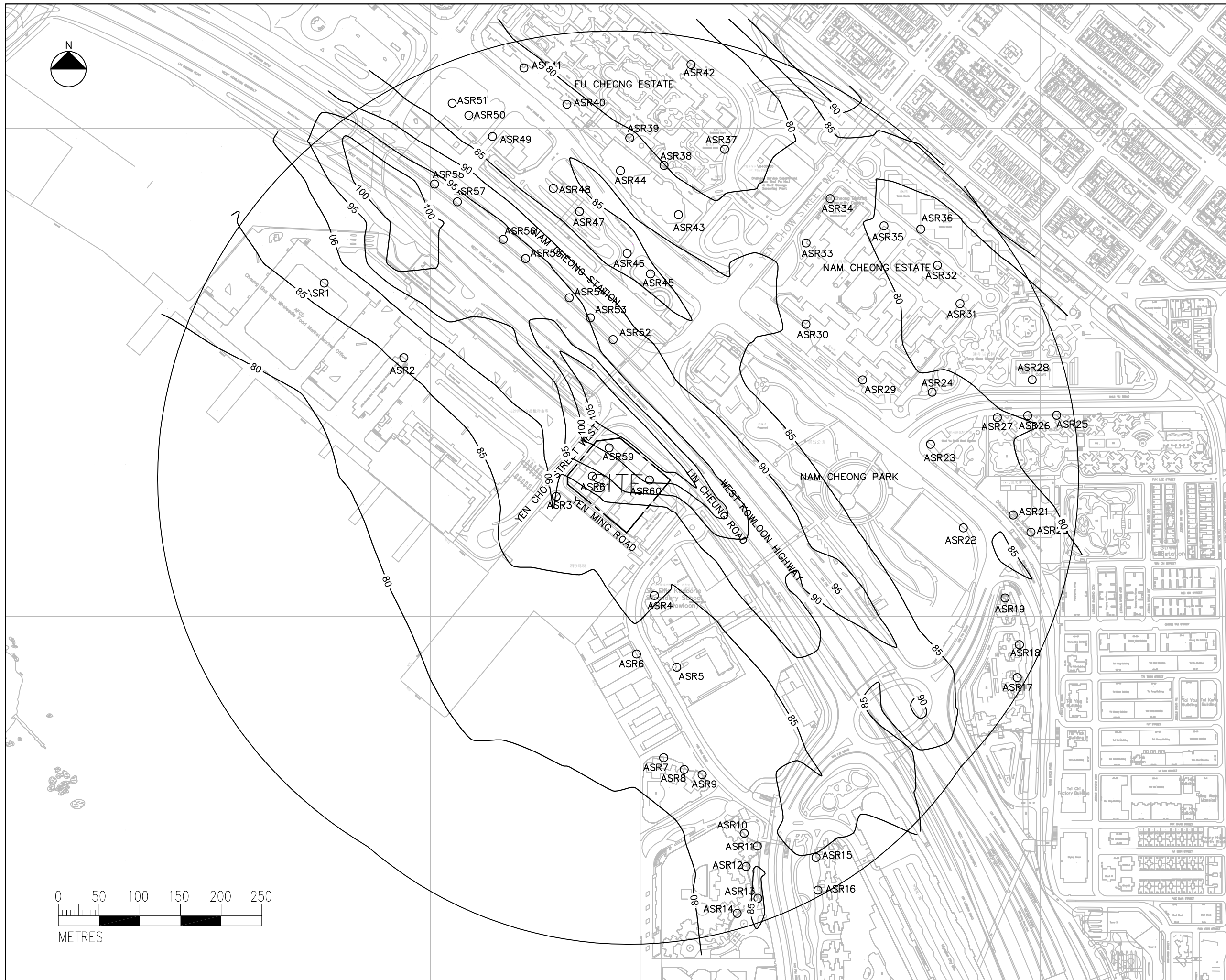

NOTE:

1. COORDINATES AREA RELATED TO HONG KONG METRIC GRID (1980)
2. CONCENTRATION SHOWN IN THIS DRAWING IS IN  $\mu\text{g}/\text{m}^3$
3. THE AQO CRITERIA FOR 24-HOUR AVERAGE CONCENTRATION OF  $\text{NO}_2$  AT 5m ABOVE GROUND IS  $150 \mu\text{g}/\text{m}^3$

LEGEND:

- SITE BOUNDARY
- AIR SENSITIVE RECEIVER
- 500m FROM SITE BOUNDARY

Rev.	Date	Description	Drawn	Checked

Department (Project Proponent) 部門 (項目申請人):

 Food and Environmental Hygiene Department  
食物環境衛生署

Department (Works) 部門 (工程):

 Architectural Services Department  
建築署

Lead Architect (Consultancy Agreement No. 9AX 034):  
建築顧問 (顧問合約編號 9AX 034)

 P&T Architects and Engineers Ltd  
巴馬丹拿建築及工程師有限公司

Project Title 項目名稱  
REPROVISIONING OF FEHD SAI YEE STREET ENVIRONMENTAL HYGIENE OFFICES-CUM-VEHICLE DEPOT AT YEN MING ROAD, WEST KOWLOON RECLAMATION AREA  
在西九龍填海區欽明路重置食物環境衛生署洗衣街環境衛生辦事處車房

Drawing Title 圖則名稱

Contours of 24-Hour Average Concentration of  $\text{NO}_2$  at 5m Above Ground

Drawing No. 圖則編號		Figure 4-4B			
Designed 設計	TKHO	Drawn 繪圖	DCYO	Checked 校核	ICWR
Approved 校核	HTMI	Date 日期	JUN 2013	Status 狀態	AS SHOWN
					FINAL

 URS Hong Kong Ltd

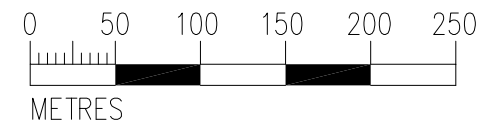
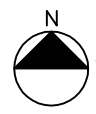
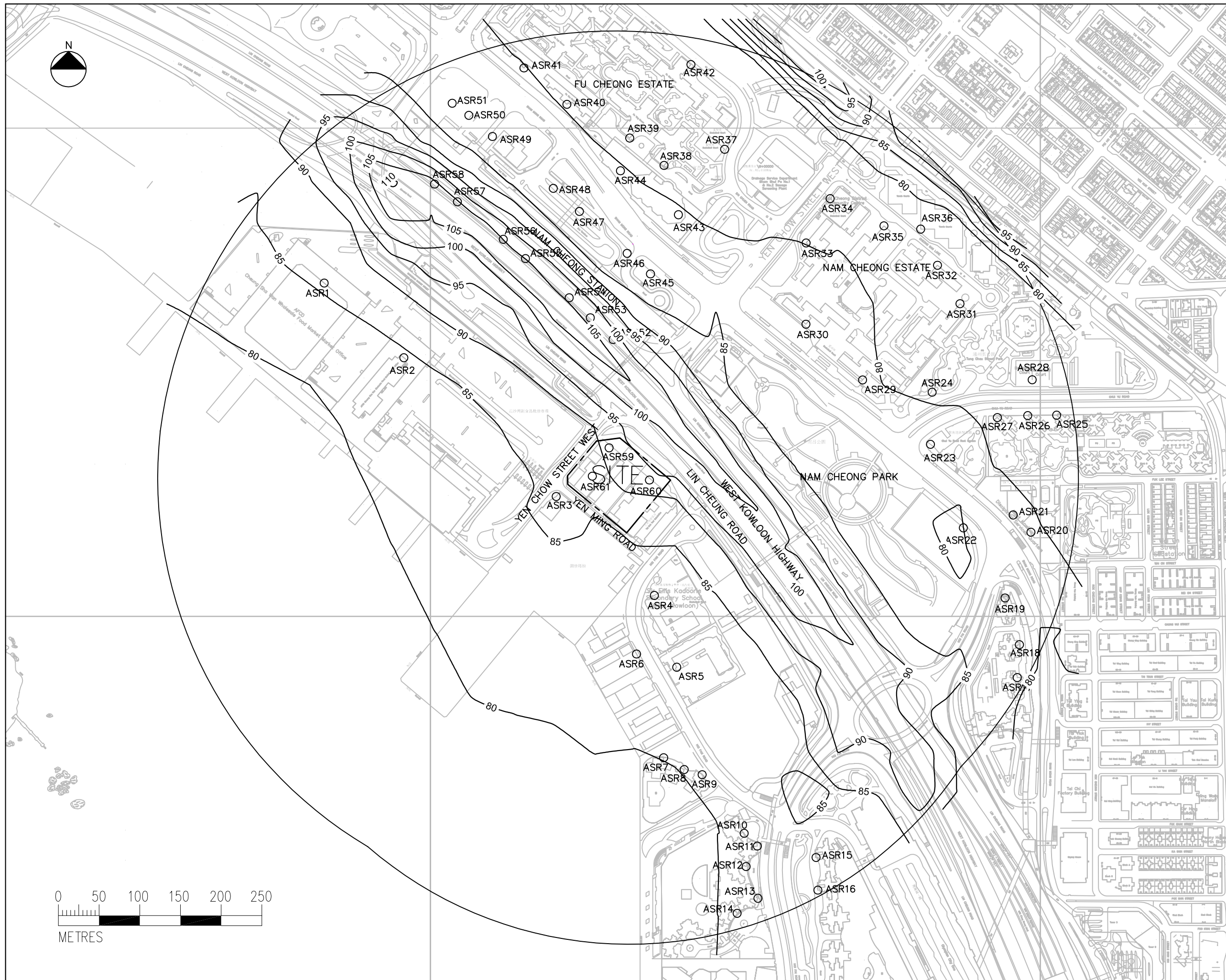

- NOTE:
- COORDINATES AREA RELATED TO HONG KONG METRIC GRID (1980)
  - CONCENTRATION SHOWN IN THIS DRAWING IS IN  $\mu\text{g}/\text{m}^3$
  - THE AQO CRITERIA FOR 24-HOUR AVERAGE CONCENTRATION OF  $\text{NO}_2$  AT 10m ABOVE GROUND IS  $150 \mu\text{g}/\text{m}^3$

- LEGEND:
- SITE BOUNDARY
  - AIR SENSITIVE RECEIVER
  - 500m FROM SITE BOUNDARY

Rev.	Date	Description	Drawn	Checked

Department (Project Proponent) 部門 (項目建議人):  
**Food and Environmental Hygiene Department**  
 食物環境衛生署

Department (Works) 部門 (工程):  
**Architectural Services Department**  
 建築署

Lead Architect (Consultancy Agreement No. 9AX 034):  
 建築顧問 (顧問合約編號 9AX 034)  
**P&T Architects and Engineers Ltd**  
 巴馬丹拿建築及工程師有限公司

Project Title 項目名稱:  
 REPROVISIONING OF FEHD SAI YEE STREET ENVIRONMENTAL HYGIENE OFFICES-CUM-VEHICLE DEPOT AT YEN MING ROAD, WEST KOWLOON RECLAMATION AREA  
 在西九龍填海區欽明路重置食物環境衛生署洗衣街環境衛生辦事處車房

Drawing Title 圖則名稱:  
**Contours of 24-Hour Average Concentration of  $\text{NO}_2$  at 10m Above Ground**

Design No.	Drawn	Checked	Scale	Status

URS Hong Kong Ltd

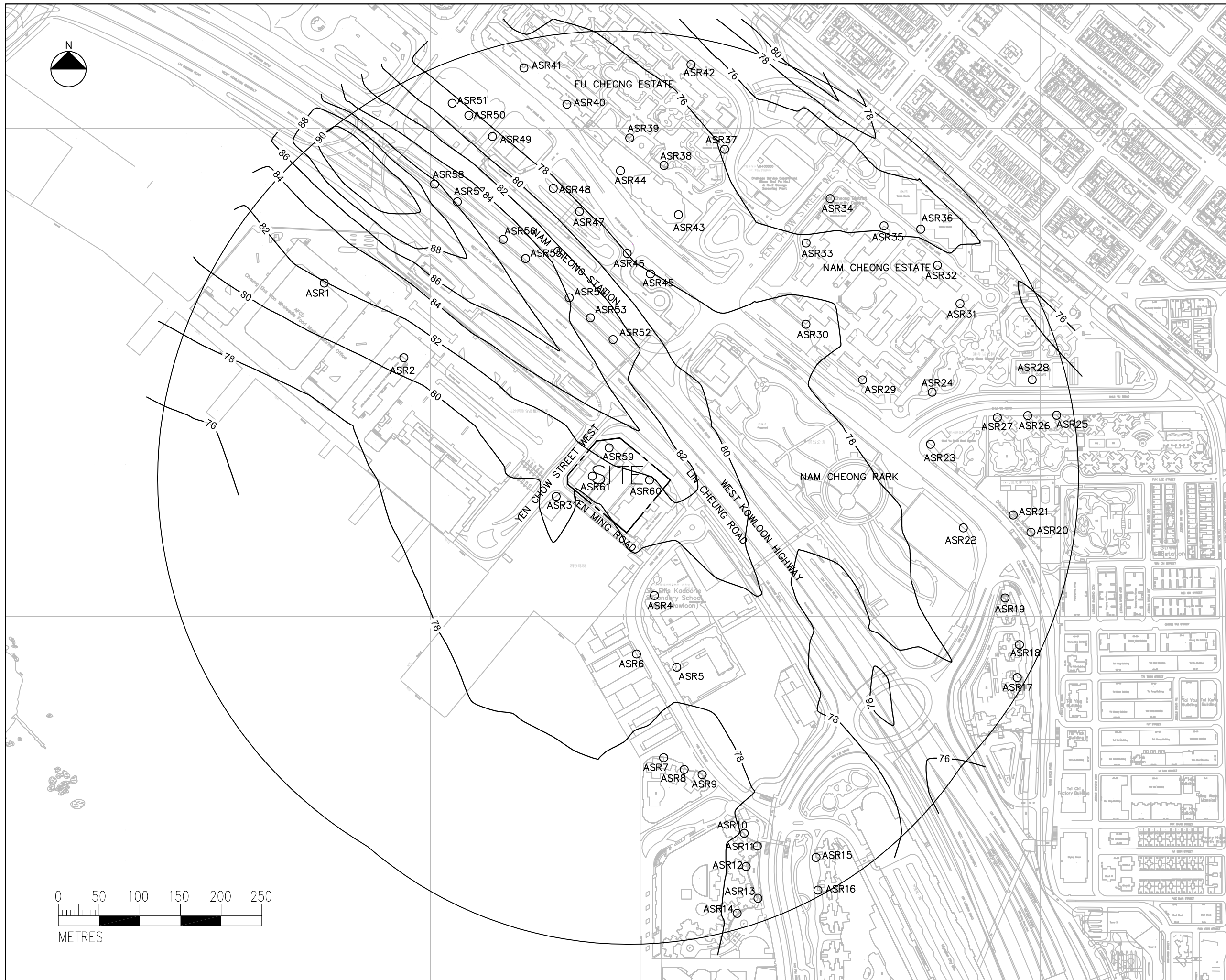

NOTE:

1. COORDINATES AREA RELATED TO HONG KONG METRIC GRID (1980)
2. CONCENTRATION SHOWN IN THIS DRAWING IS IN  $\mu\text{g}/\text{m}^3$
3. THE AQO CRITERIA FOR 24-HOUR AVERAGE CONCENTRATION OF  $\text{NO}_2$  AT 20m ABOVE GROUND IS  $150 \mu\text{g}/\text{m}^3$

LEGEND:

- SITE BOUNDARY
- AIR SENSITIVE RECEIVER
- 500m FROM SITE BOUNDARY

Rev.	Date	Description	Drawn	Checked

Department (Project Proponent) 部門 (項目申請人):

Food and Environmental Hygiene Department  
食物環境衛生署

Department (Works) 部門 (工程):

Architectural Services Department  
建築署

Lead Architect (Consultancy Agreement No. 9AX 034):  
建築顧問 (顧問合約編號 9AX 034)

P&T Architects and Engineers Ltd  
巴馬丹拿建築及工程師有限公司

Project Title 項目名稱  
REPROVISIONING OF FEHD SAI YEE STREET ENVIRONMENTAL HYGIENE OFFICES-CUM-VEHICLE DEPOT AT YEN MING ROAD, WEST KOWLOON RECLAMATION AREA  
在西九龍填海區欽明路重置食物環境衛生署洗衣街環境衛生辦事處車房

Drawing Title 圖則名稱

Contours of 24-Hour Average Concentration of  $\text{NO}_2$  at 20m Above Ground

Design	Drawn	Checked	Scale	Status
設計 TKHO	繪圖 DCYO	校核 ICWR	比例 AS SHOWN	狀態

Approved 日期 2013 狀態 FINAL

URS URS Hong Kong Ltd

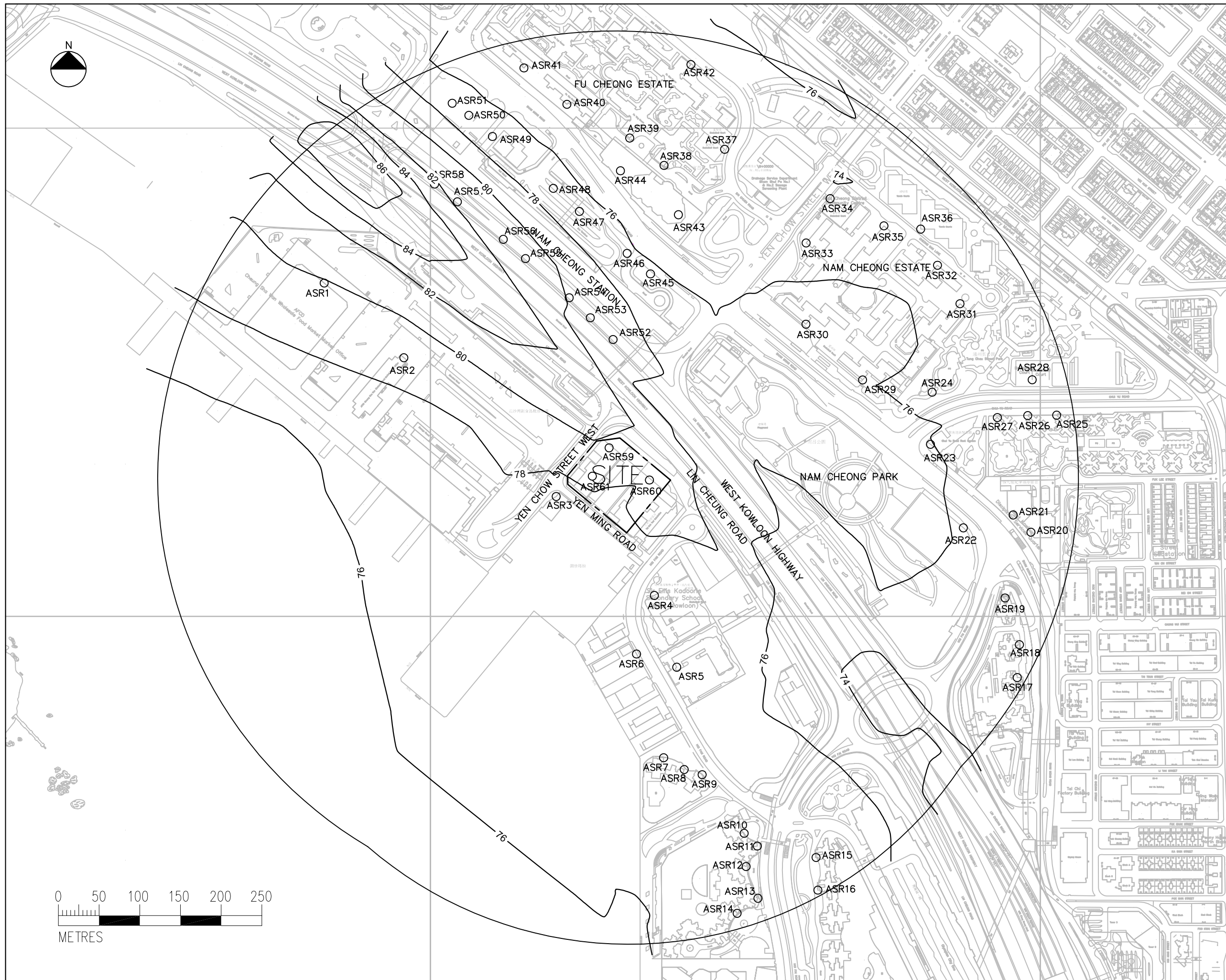

NOTE:

1. COORDINATES AREA RELATED TO HONG KONG METRIC GRID (1980)
2. CONCENTRATION SHOWN IN THIS DRAWING IS IN  $\mu\text{g}/\text{m}^3$
3. THE AQO CRITERIA FOR 24-HOUR AVERAGE CONCENTRATION OF  $\text{NO}_2$  AT 25m ABOVE GROUND IS  $150 \mu\text{g}/\text{m}^3$

LEGEND:

- SITE BOUNDARY
- AIR SENSITIVE RECEIVER
- 500m FROM SITE BOUNDARY

Rev.	Date	Description	Drawn	Checked

Department (Project Proponent) 部門 (項目營辦人):

Food and Environmental Hygiene Department  
食物環境衛生署

Department (Works) 部門 (工程):

Architectural Services Department  
建築署

Lead Architect (Consultancy Agreement No. 9AX 034):  
建築顧問 (顧問合約編號 9AX 034)

P&T Architects and Engineers Ltd  
巴馬丹拿建築及工程師有限公司

Project Title 項目名稱  
REPROVISIONING OF FEHD SAI YEE STREET ENVIRONMENTAL HYGIENE OFFICES-CUM-VEHICLE DEPOT AT YEN MING ROAD, WEST KOWLOON RECLAMATION AREA  
在西九龍填海區欽明路重置食物環境衛生署洗衣街環境衛生辦事處車房

Drawing Title 圖則名稱  
Contours of 24-Hour Average Concentration of  $\text{NO}_2$  at 25m Above Ground

Design	Drawn	Checked	Scale	Status
設計 TKHO	繪圖 JLCM	校核 ICWR	比例 AS SHOWN	狀態 FINAL

URS URS Hong Kong Ltd

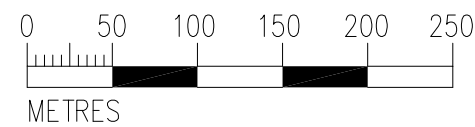
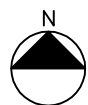
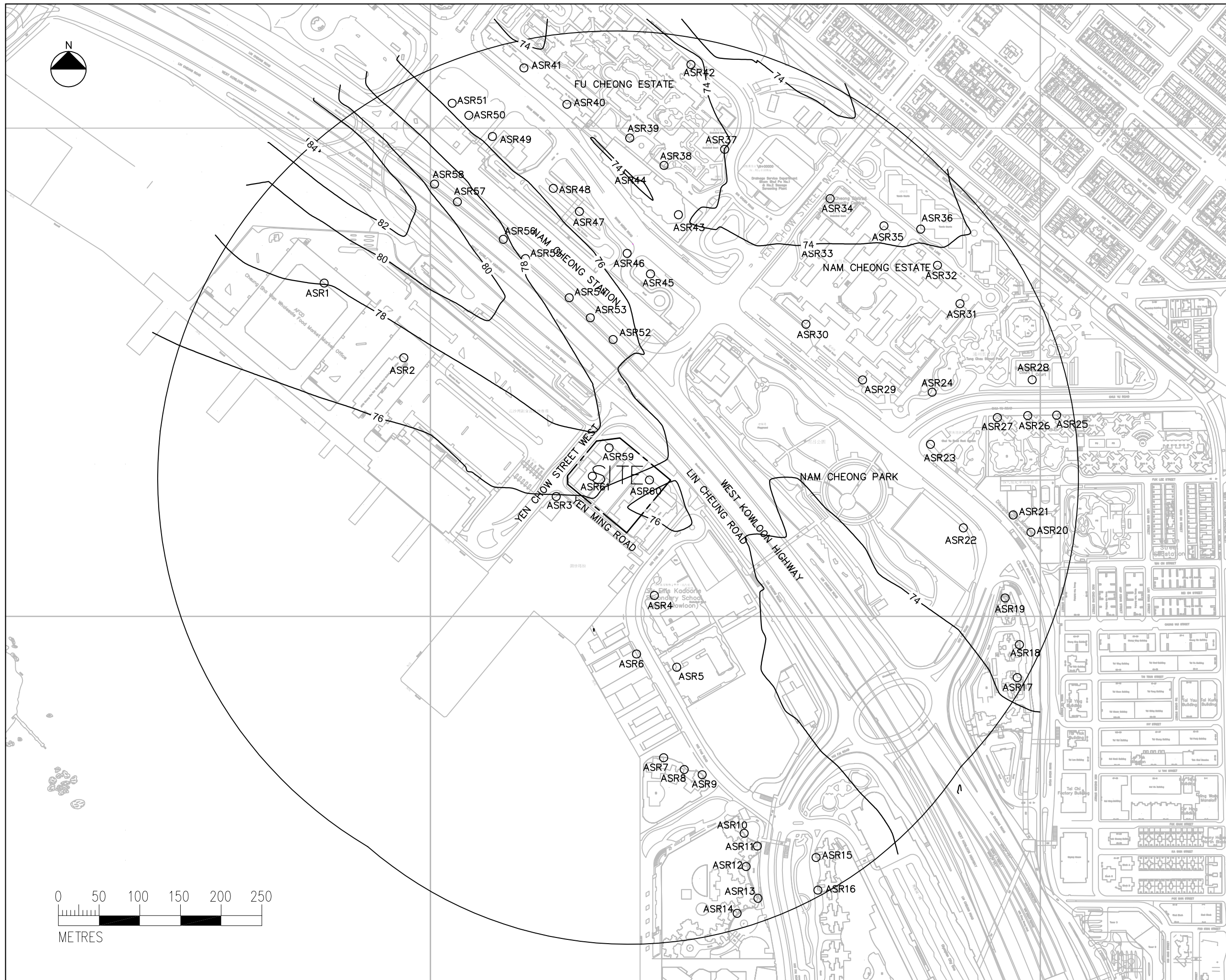

NOTE:

1. COORDINATES AREA RELATED TO HONG KONG METRIC GRID (1980)
2. CONCENTRATION SHOWN IN THIS DRAWING IS IN  $\mu\text{g}/\text{m}^3$
3. THE AQO CRITERIA FOR 24-HOUR AVERAGE CONCENTRATION OF  $\text{NO}_2$  AT 30m ABOVE GROUND IS  $150 \mu\text{g}/\text{m}^3$

LEGEND:

- SITE BOUNDARY
- AIR SENSITIVE RECEIVER
- 500m FROM SITE BOUNDARY

Rev.	Date	Description	Drawn	Checked

Department (Project Proponent) 部門 (項目營辦人):



Department (Works) 部門 (工程):



Lead Architect (Consultancy Agreement No. 9AX 034):  
建築顧問 (顧問合約編號 9AX 034)



Project Title 項目名稱  
REPROVISIONING OF FEHD SAI YEE STREET ENVIRONMENTAL HYGIENE OFFICES-CUM-VEHICLE DEPOT AT YEN MING ROAD, WEST KOWLOON RECLAMATION AREA  
在西九龍填海區欽明路重置食物環境衛生署洗衣街環境衛生辦事處車房

Drawing Title 圖則名稱

Contours of 24-Hour Average Concentration of  $\text{NO}_2$  at 30m Above Ground

Design No.	Drawn	Checked	Scale	AS SHOWN

Designed	Drawn	Checked	Date	Status
TKHO	JLCM	ICWR	JUN	FINAL

URS Hong Kong Ltd