

Printed by : 10/6/2013
 File name : X:\2512043 (HKG-HYD West KLN)\CADD\DRAWING\REPORT\20130611 (EIA REPORT)\PBA-CE44-K-TR-7.6a.dgn

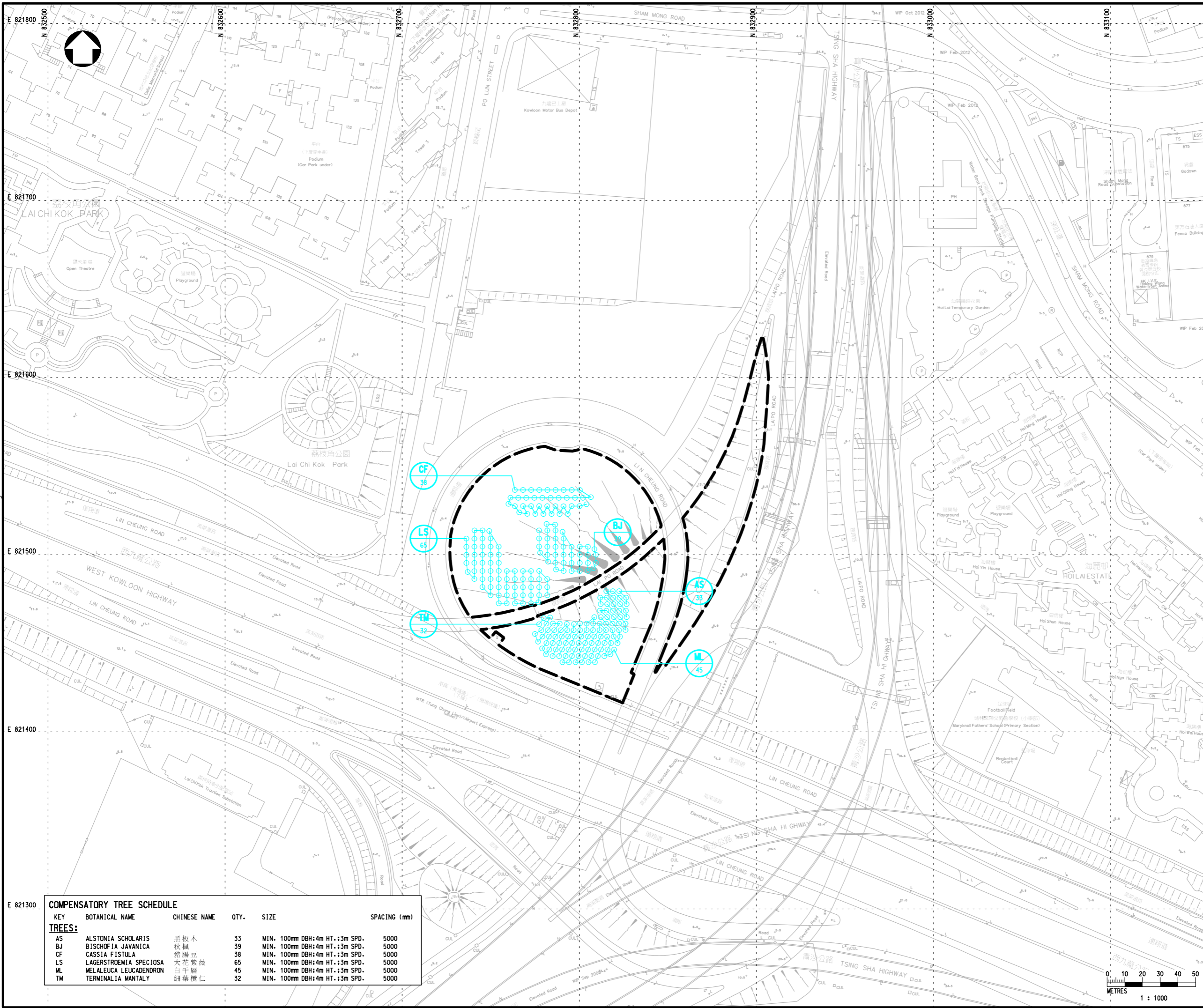

LEGEND :

- WK1297 RETAINED TREE
- WK1677 PROPOSED TREE FOR TRANSPLANTED TREE
- PROPOSED LOCATION FOR COMPENSATORY TREE
- HYD SIMAR SLOPE / FEATURE
- PROPOSED WORKS SITE

COMPENSATORY TREE SCHEDULE

KEY	BOTANICAL NAME	CHINESE NAME	QTY.	SIZE	SPACING (mm)
AS	ALSTONIA SCHOLARIS	黑板木	33	MIN. 100mm DBH;4m HT.;3m SPD.	5000
BJ	BISCHOFIA JAVANICA	秋楓	39	MIN. 100mm DBH;4m HT.;3m SPD.	5000
CF	CASSIA FISTULA	豬蹄豆	38	MIN. 100mm DBH;4m HT.;3m SPD.	5000
LS	LAGERSTROEMIA SPECIOSA	大花紫薇	65	MIN. 100mm DBH;4m HT.;3m SPD.	5000
ML	MELALEUCA LEUCADENDRON	白千層	45	MIN. 100mm DBH;4m HT.;3m SPD.	5000
TM	TERMINALIA MANTALY	細葉欖仁	32	MIN. 100mm DBH;4m HT.;3m SPD.	5000

Rev	Description	By	Date

Consultant
PARSONS BRINCKERHOFF

Project title
 AGREEMENT NO. CE 44/2011 (HY)
 PROPOSED ROAD IMPROVEMENT WORKS IN WEST KOWLOON RECLAMATION DEVELOPMENT - PHASE 1 INVESTIGATION, DESIGN AND CONSTRUCTION

Drawing title
TREE COMPENSATION PLAN
 SHEET 1 OF 9

Drawing no. FIGURE 7.6a		Rev. -	
Drawn CAD	Date -	Checked -	Approved -
Scale 1:1000 (A1)		Status PRELIMINARY DESIGN	

© COPYRIGHT RESERVED

路政署
 HIGHWAYS DEPARTMENT
 主要工程管理處
 MAJOR WORKS PROJECT MANAGEMENT OFFICE

