

LOCATION PLAN

- LEGEND:
- AM1/NM1 (AIR MONITORING STATION/NOISE MONITORING STATION)
 - WORKS BOUNDARY

Rev	Description	By	Date

Consultant
PARSONS BRINCKERHOFF

漢臻 **CINOTECH**

Project title
 AGREEMENT NO. CE 44/2011 (HY)
 PROPOSED ROAD IMPROVEMENT WORKS IN WEST KOWLOON RECLAMATION DEVELOPMENT – PHASE 1 INVESTIGATION, DESIGN AND CONSTRUCTION

Drawing title
LOCATION OF MONITORING STATIONS (PAGE 1 OF 2)

Drawing no. CE44/T/ST/EM03		Rev. 2	
Drawn MC	Date AUG13	Checked KS	Approved LC
Scale A3 1:5000		Status PRELIMINARY	

© COPYRIGHT RESERVED

路政署
HIGHWAYS DEPARTMENT
 主要工程管理處
 MAJOR WORKS PROJECT MANAGEMENT OFFICE

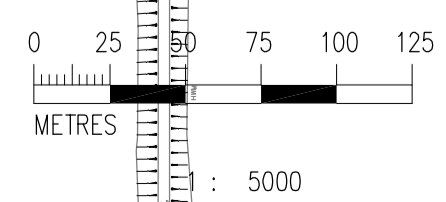

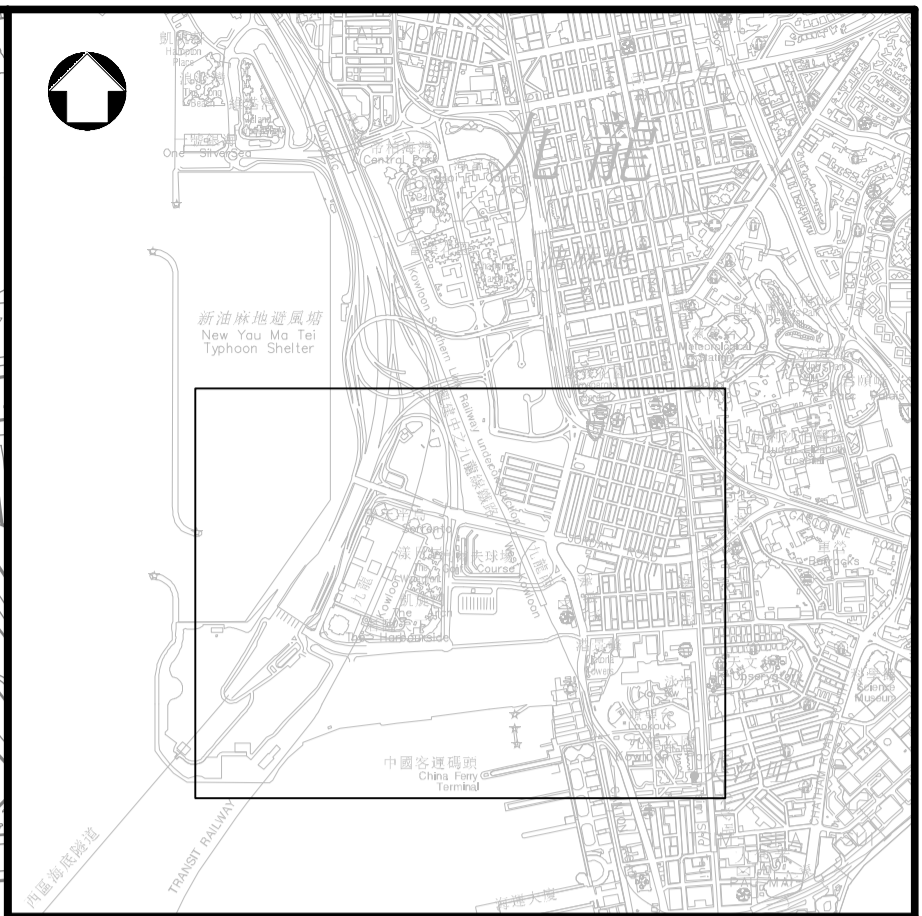
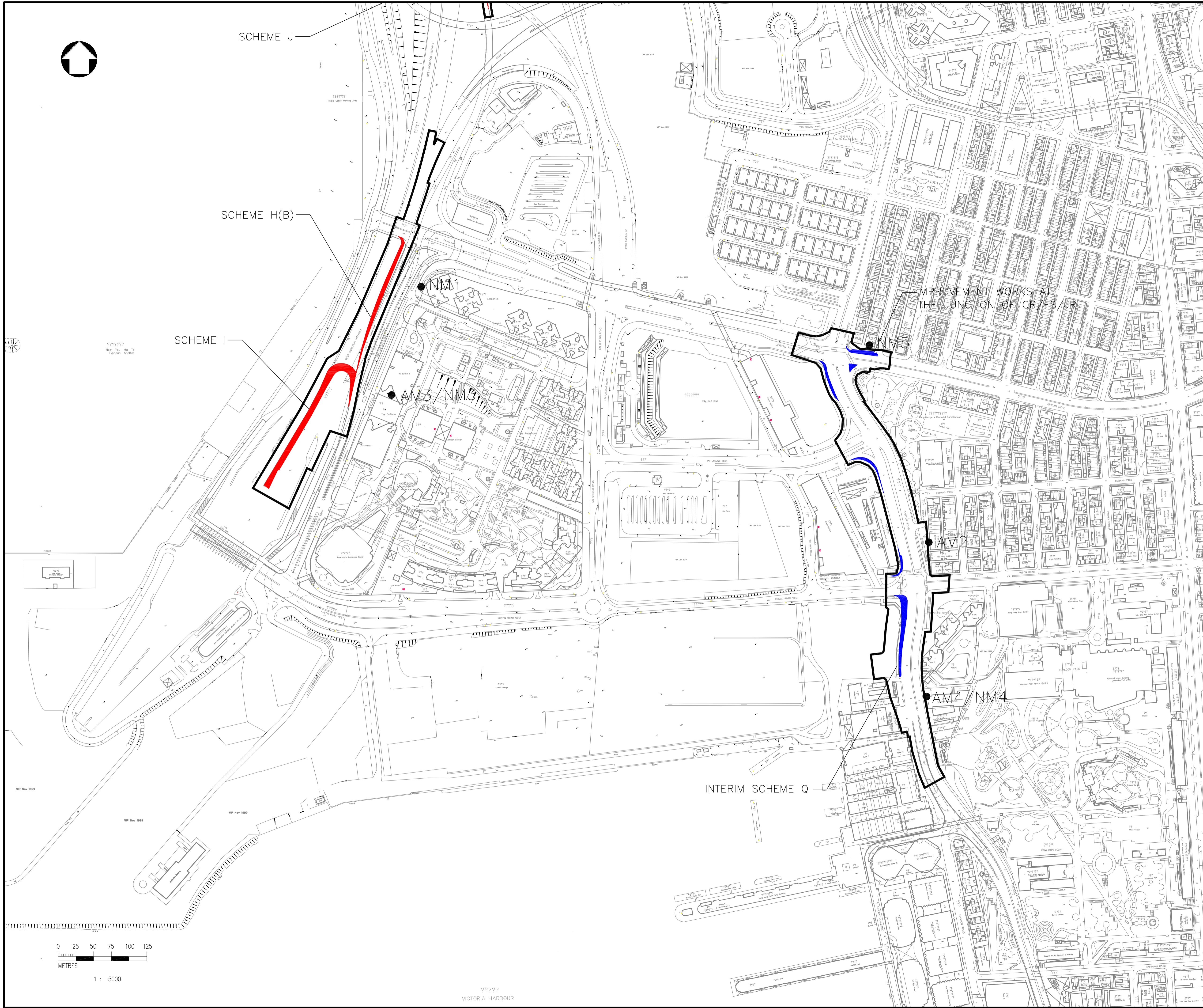

LOCATION PLAN

- LEGEND:
- AM1/NM1 (AIR MONITORING STATION/NOISE MONITORING STATION)
 - WORKS BOUNDARY

Rev	Description	By	Date

Consultant
PARSONS BRINCKERHOFF

漢臻 **CINOTECH**

Project title
 AGREEMENT NO. CE 44/2011 (HY)
 PROPOSED ROAD IMPROVEMENT WORKS IN WEST KOWLOON RECLAMATION DEVELOPMENT – PHASE 1 INVESTIGATION, DESIGN AND CONSTRUCTION

Drawing title
LOCATION OF MONITORING STATIONS (PAGE 2 OF 2)

Drawing no. CE44/T/ST/EM04		Rev. 2	
Drawn MC	Date AUG13	Checked KS	Approved LC
Scale A3 1:5000		Status PRELIMINARY	

© COPYRIGHT RESERVED

路政署
HIGHWAYS DEPARTMENT
 主要工程管理處
 MAJOR WORKS PROJECT MANAGEMENT OFFICE

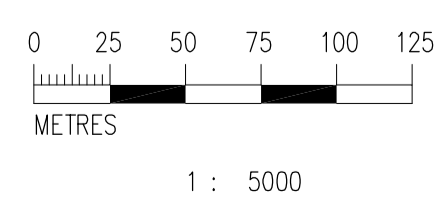
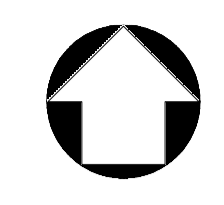

VICTORIA HARBOUR