



804000 E

806000 E

808000 E

810000 E

812000 E

814000 E

SHA CHAU

822000 N

TAI MO TO

820000 N

818000 N

816000 N

NOTE

Source: Airport Authority Hong Kong, Hong Kong International Airport, Contract P132 - Engineering Feasibility and Environmental Assessment Study for Airport Master Plan 2030, Comparative Environmental Assessment Report, (Deliverable D1.8), May 2009, Mott MacDonald Hong Kong Limited

0 250 500 750 1000 m

1 : 30 000 SCALE BAR

Copyright in this document and all proprietary rights in the information it contains belong to the AA. It is a condition of the supply of this document, in whatever form, that the recipient shall hold it in confidence and shall not duplicate or otherwise reproduce it in whole or in part, nor disclose its contents without the written consent of the AA.

| Rev. | Date    | Description | Checked |
|------|---------|-------------|---------|
| A    | 05APR13 | FIRST ISSUE | DC      |
|      |         |             |         |
|      |         |             |         |



香港 HONG KONG INTERNATIONAL AIRPORT 國際機場



ARUP Atkins China Limited Clymene Enterprises Deltares Ecosystems Limited SDA Marine Limited Urbis Limited URS Limited

Title P132 - ENGINEERING FEASIBILITY & ENVIRONMENTAL ASSESSMENT STUDY FOR AIRPORT MASTER PLAN 2030 LAYOUT OF AIRPORT EXPANSION OPTION 1

| Consultant's Signatures for Approval |     | Date    |
|--------------------------------------|-----|---------|
| Design                               | DC  | 05APR13 |
| Checkers                             | DC  | 05APR13 |
| Design Supervisor                    | EC  | 21MAR14 |
| Authorised Representative            | AFK | 21MAR14 |

| EXPANSION OF HONG KONG INTERNATIONAL AIRPORT INTO A THREE-RUNWAY SYSTEM |                          |
|---|--------------------------|
| Drawing No.   | MCL / P132 / EIA / 3-001 |
| Scale at A3   | 1 : 30000                |
| Rev.  | A                        |



804000 E

806000 E

808000 E

810000 E

812000 E

814000 E

SHA CHAU

822000 N

TAI MO TO

820000 N

818000 N

816000 N

**NOTE**  
 Source: Airport Authority Hong Kong, Hong Kong International Airport, Contract P132 – Engineering Feasibility and Environmental Assessment Study for Airport Master Plan 2030, Comparative Environmental Assessment Report, (Deliverable D1.8), May 2009, Mott MacDonald Hong Kong Limited

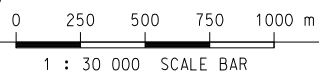

Copyright in this document and all proprietary rights in the information it contains belong to the AA. It is a condition of the supply of this document, in whatever form, that the recipient shall hold it in confidence and shall not duplicate or otherwise reproduce it in whole or in part, nor disclose its contents without the written consent of the AA.

| Rev. | Date    | Description | Checked |
|------|---------|-------------|---------|
| A    | 05APR13 | FIRST ISSUE | DC      |
|      |         |             |         |
|      |         |             |         |



Title  
**P132 – ENGINEERING FEASIBILITY & ENVIRONMENTAL ASSESSMENT STUDY FOR AIRPORT MASTER PLAN 2030 LAYOUT OF AIRPORT EXPANSION OPTION 2**

| Consultant's Signatures for Approval |     | Date    |
|--------------------------------------|-----|---------|
| Design                               | DC  | 05APR13 |
| Checkers                             | DC  | 05APR13 |
| Design Supervisor                    | EC  | 21MAR14 |
| Authorised Representative            | AFK | 21MAR14 |

EXPANSION OF HONG KONG INTERNATIONAL AIRPORT INTO A THREE-RUNWAY SYSTEM

Drawing No. **MCL / P132 / EIA / 3-002**

Scale at A3 **1 : 30000**

Rev. **A**



804000 E

806000 E

808000 E

810000 E

812000 E

814000 E

SHA CHAU

822000 N

TAI MO TO

820000 N

818000 N

816000 N

**NOTE**  
 Source: Airport Authority Hong Kong, Hong Kong International Airport, Contract P132 - Engineering Feasibility and Environmental Assessment Study for Airport Master Plan 2030, Comparative Environmental Assessment Report, (Deliverable D1.8), May 2009, Mott MacDonald Hong Kong Limited

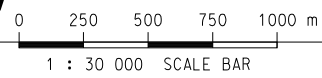

Copyright in this document and all proprietary rights in the information it contains belong to the AA. It is a condition of the supply of this document, in whatever form, that the recipient shall hold it in confidence and shall not duplicate or otherwise reproduce it in whole or in part, nor disclose its contents without the written consent of the AA.

| Rev. | Date    | Description | Checked |
|------|---------|-------------|---------|
| A    | 05APR13 | FIRST ISSUE | DC      |
|      |         |             |         |
|      |         |             |         |

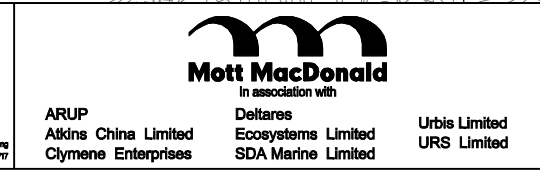

Title  
**P132 - ENGINEERING FEASIBILITY & ENVIRONMENTAL ASSESSMENT STUDY FOR AIRPORT MASTER PLAN 2030 LAYOUT OF AIRPORT EXPANSION OPTION 3**

| Consultant's Signatures for Approval |     | Date    |
|--------------------------------------|-----|---------|
| Design                               | DC  | 05APR13 |
| Checkers                             | DC  | 05APR13 |
| Design Supervisor                    | EC  | 21MAR14 |
| Authorised Representative            | AFK | 21MAR14 |

| EXPANSION OF HONG KONG INTERNATIONAL AIRPORT INTO A THREE-RUNWAY SYSTEM |                          |
|---|--------------------------|
| Drawing No.   | MCL / P132 / EIA / 3-003 |
| Scale at A3   | 1 : 30000                |
| Rev.  | A                        |





804000 E

806000 E

808000 E

810000 E

812000 E

814000 E

SHA CHAU

822000 N

TAI MO TO

820000 N

818000 N

816000 N

**NOTE**  
 Source: Airport Authority Hong Kong, Hong Kong International Airport,  
 Contract P132 – Engineering Feasibility and Environmental Assessment Study  
 for Airport Master Plan 2030, Comparative Environmental Assessment Report,  
 (Deliverable D1.8), May 2009, Mott MacDonald Hong Kong Limited

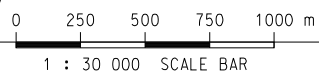
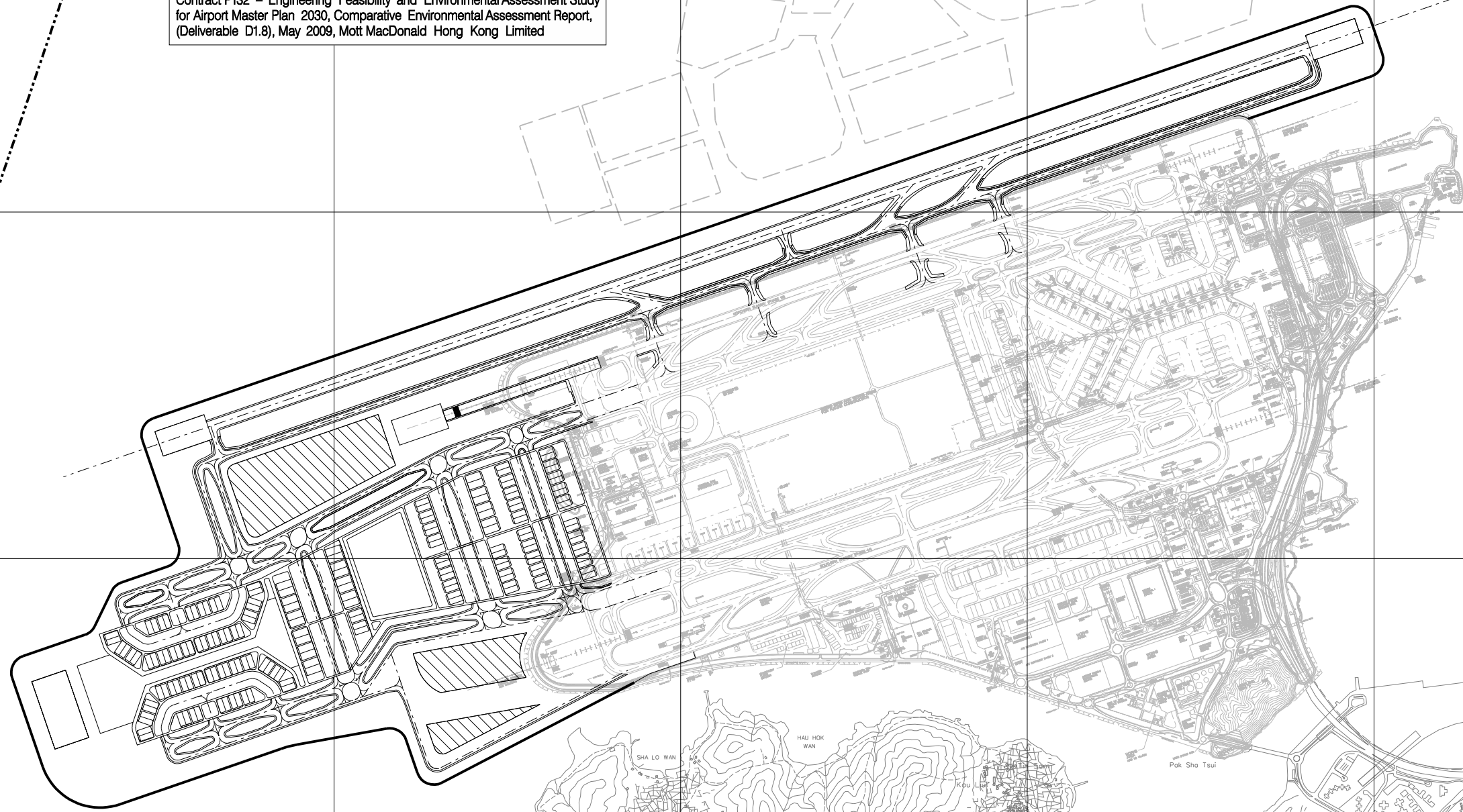

1 : 30 000 SCALE BAR

Copyright in this document and all proprietary rights in the information it contains belong to the AA. It is a condition of the supply of this document, in whatever form, that the recipient shall hold it in confidence and shall not duplicate or otherwise reproduce it in whole or in part, nor disclose its contents without the written consent of the AA.

| Rev. | Date    | Description | Checked |
|------|---------|-------------|---------|
| A    | 05APR13 | FIRST ISSUE | DC      |
|      |         |             |         |
|      |         |             |         |

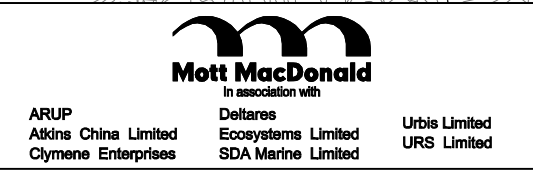

Title  
**P132 – ENGINEERING FEASIBILITY & ENVIRONMENTAL ASSESSMENT STUDY FOR AIRPORT MASTER PLAN 2030 LAYOUT OF AIRPORT EXPANSION OPTION 4**

| Consultant's Signatures for Approval |     | Date    |
|--------------------------------------|-----|---------|
| Design                               | DC  | 05APR13 |
| Checkers                             | DC  | 05APR13 |
| Design Supervisor                    | EC  | 21MAR14 |
| Authorised Representative            | AFK | 21MAR14 |

| EXPANSION OF HONG KONG INTERNATIONAL AIRPORT INTO A THREE-RUNWAY SYSTEM |                          |
|---|--------------------------|
| Drawing No.   | MCL / P132 / EIA / 3-004 |
| Scale at A3   | 1 : 30000                |
| Rev.  | A                        |