

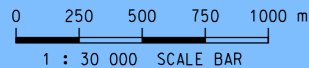

SHA CHAU AND LUNG KWU CHAU MARINE PARK  
PAK CHAU

- Potential Land Formation Footprint for the Proposed Airport Expansion
- Areas Reserved for Aviation Support Development
- Existing Airport Island

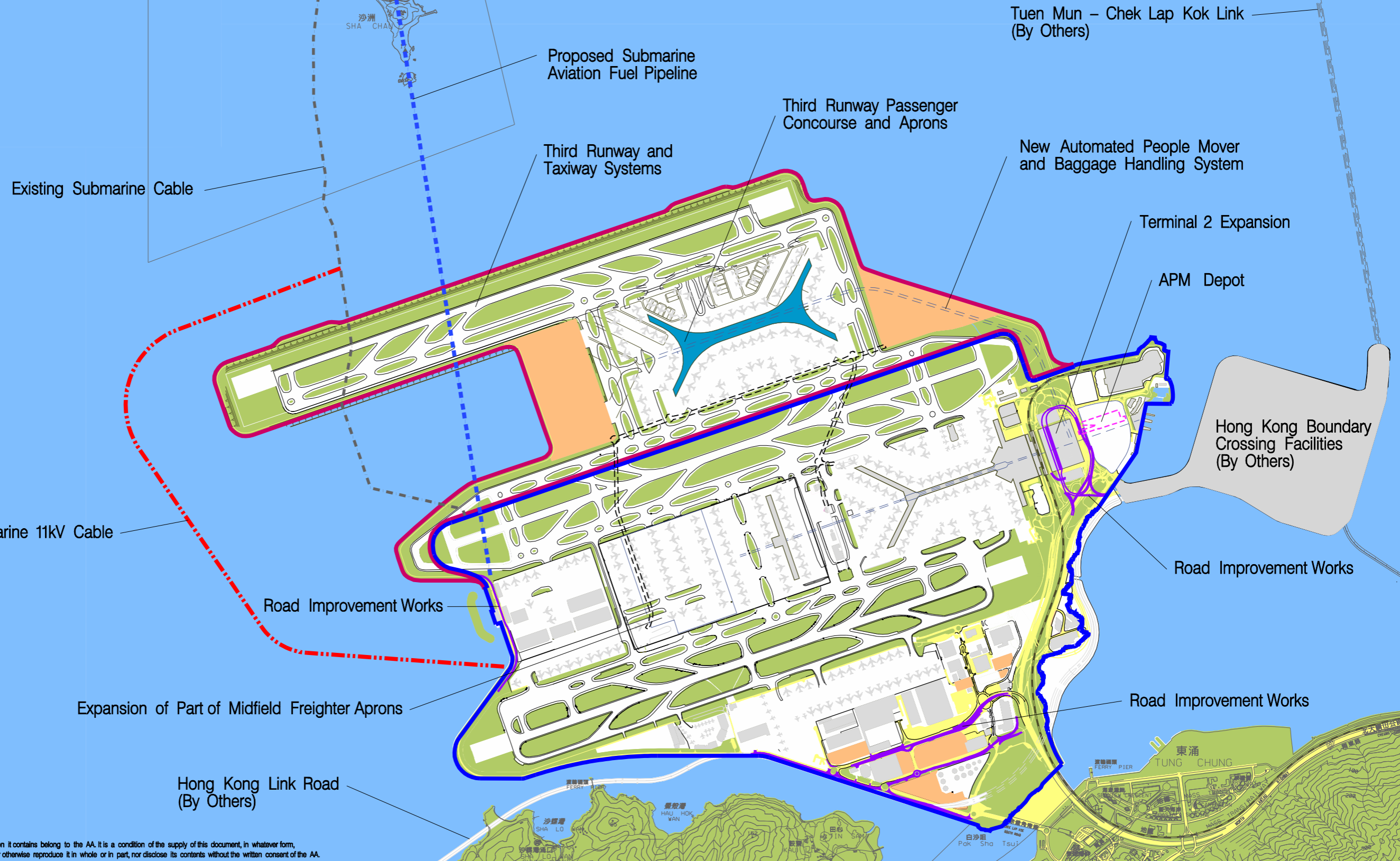

Copyright in this document and all proprietary rights in the information it contains belong to the AA. It is a condition of the supply of this document, in whatever form, that the recipient shall hold it in confidence and shall not duplicate or otherwise reproduce it in whole or in part, nor disclose its contents without the written consent of the AA.

Rev.	Date	Description	Checked
A	13NOV13	FIRST ISSUE	EC
B	14APR14	GENERAL REVISION	EC



Title  
**PREFERRED AIRPORT LAYOUT OPTION**

Consultant's Signatures for Approval		Date
Design	EY	13NOV13
Checkers	EY	13NOV13
Design Supervisor	EC	21MAR14
Authorised Representative	AFK	21MAR14

EXPANSION OF HONG KONG INTERNATIONAL AIRPORT INTO A THREE-RUNWAY SYSTEM	
Drawing No.	MCL / P132 / ES / 3-001
Scale at A3	1 : 30000
Rev.	B