

**SPECIES OF CONSERVATION IMPORTANCE:**

**Coral**

- C1: *Balanophyllia* sp. (ahermatypic cup coral)
- C2: *Paracyathus rotundatus* (ahermatypic cup coral)

**Estuarine Fish and Fauna**

- E6: *Takifugu ocellatus* (Archpatch puffer)

**Marine Fish**

- F2: *Clupanodon thrissa* (Chinese gizzard shad)
- F3: *Dasyatis akajei* (red stingray)
- F4: *Dasyatis zugei* (pale-edged stingray)
- F6: *Epinephelus bruneus* (longtooth grouper)
- F7: *Epinephelus coioides* (Orange-spotted grouper)
- F8: *Inimicus japonicus* (Devil stinger)
- F9: *Larimichthys crocea* (Yellow croaker)

- F10: *Nemichthys scolopaceus* (Slender snipe eel)
- F12: *Otolithes ruber* (Tiger-toothed croaker)

**Horseshoe Crab**

- H2: *Tachypleus tridentatus*

**Other Marine Species**

- O1: *Oliva mustelina* (Sea snail)

**Seahorse and Pipefish**

- S3: *Syngnathus schlegelii*

Sources: AFCD Biodiversity Survey (2002-2013), HKZMB EIA (2009), Tung Chung New Town Extension (2013), CMP EM&A (2006 -2013), HKLR (2009), Green Power & EERC, Sadovy and Cheung (2003)

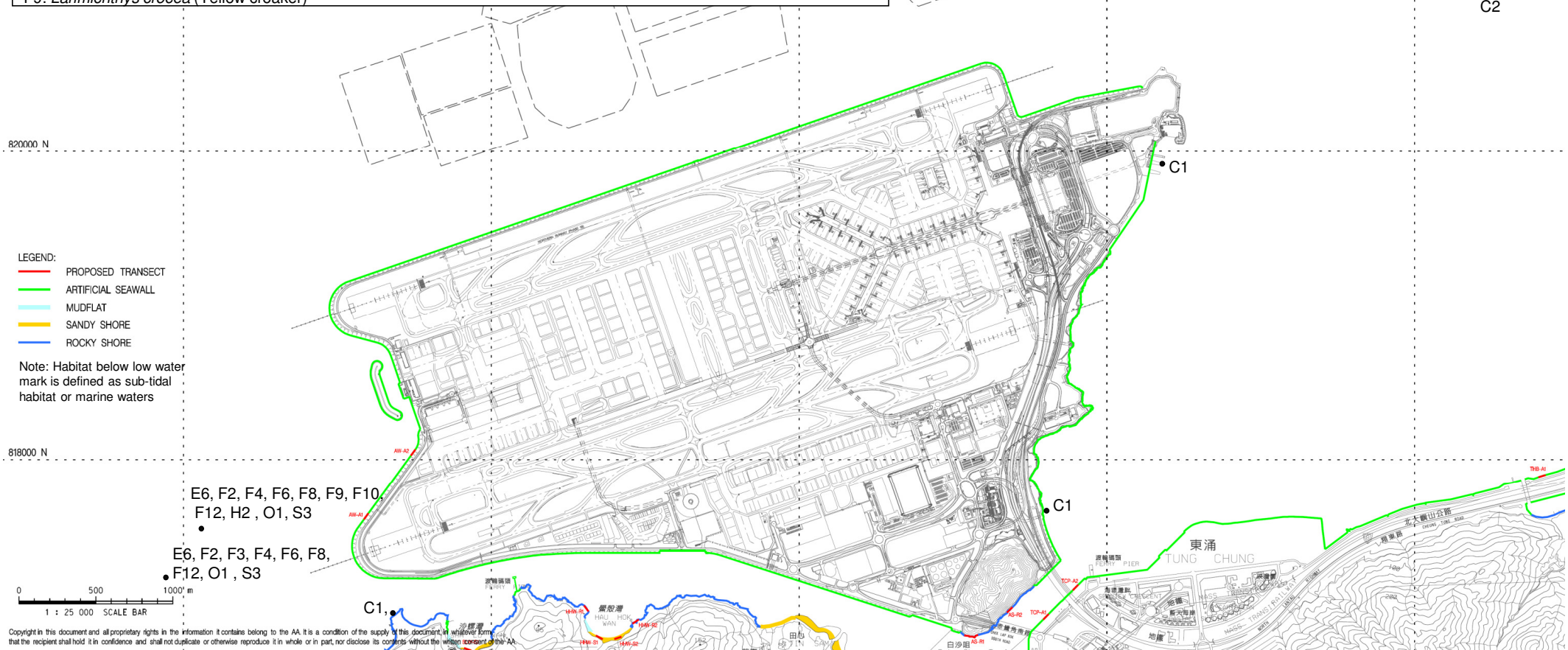
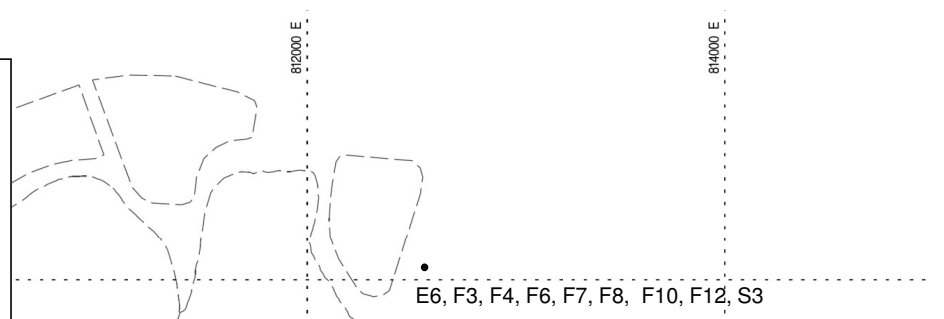

- LEGEND:**
- PROPOSED TRANSECT
  - ARTIFICIAL SEAWALL
  - MUDFLAT
  - SANDY SHORE
  - ROCKY SHORE

Note: Habitat below low water mark is defined as sub-tidal habitat or marine waters

Rev.	Date	Description	Checked
A	16SEP13	FIRST ISSUE	GC
B	10JAN14	GENERAL REVISION	JC



Title: LOCATION OF SPECIES OF CONSERVATION IMPORTANCE IDENTIFIED FROM LITERATURE REVIEW – AIRPORT ISLAND

Consultant's Signatures for Approval		Date
Design	GC	10JAN14
Checkers	JC	10JAN14
Design Supervisor	EC	21MAR14
Authorised Representative	AFK	21MAR14

EXPANSION OF HONG KONG INTERNATIONAL AIRPORT INTO A THREE-RUNWAY SYSTEM  
 Drawing No. **MCL/P132/EIA/13-002**  
 Scale at A3: 1:25000  
 Rev. **B**

Copyright in this document and all proprietary rights in the information it contains belong to the AA. It is a condition of the supply of this document in whatever form that the recipient shall hold it in confidence and shall not duplicate or otherwise reproduce it in whole or in part, nor disclose its contents without the written consent of the AA.

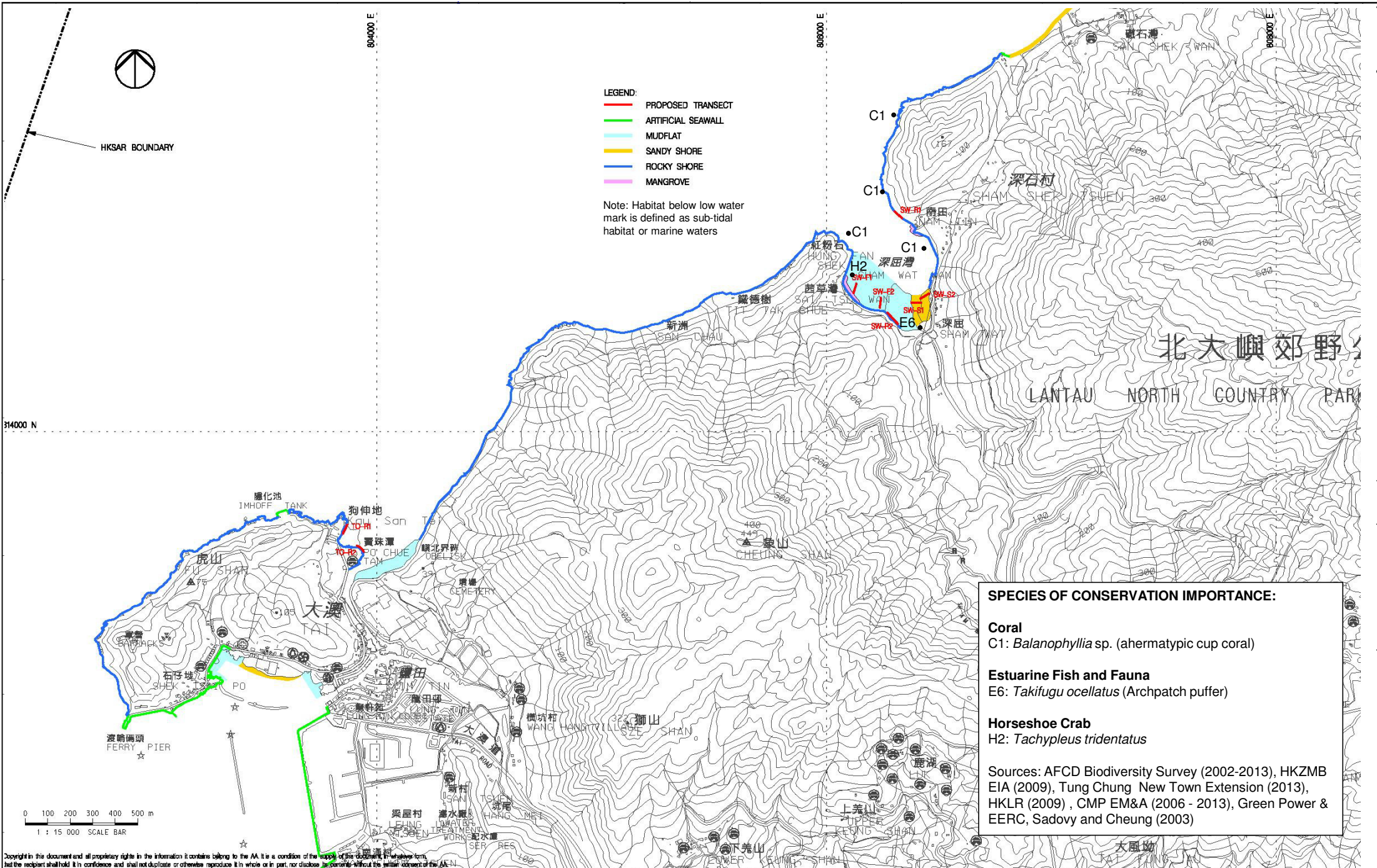

**SPECIES OF CONSERVATION IMPORTANCE:**

**Coral**  
 C1: *Balanophyllia* sp. (ahermatypic cup coral)

**Estuarine Fish and Fauna**  
 E6: *Takifugu ocellatus* (Archpatch puffer)

**Horseshoe Crab**  
 H2: *Tachypleus tridentatus*

Sources: AFCD Biodiversity Survey (2002-2013), HKZMB EIA (2009), Tung Chung New Town Extension (2013), HKLR (2009), CMP EM&A (2006 - 2013), Green Power & EERC, Sadovy and Cheung (2003)

Copyright in this document and all proprietary rights in the information it contains belong to the AA. It is a condition of the supply of this document that the recipient shall hold it in confidence and shall not duplicate or otherwise reproduce it in whole or in part, nor disclose its contents without the written consent of the AA.

Rev.	Date	Description	Checked
A	16SEP13	FIRST ISSUE	GC
B	10JAN14	GENERAL REVISION	JC



**Mott MacDonald**  
 In association with

ARUP  
 Atkins China Limited  
 Clymene Enterprises

Dollarus  
 EcoSystems Limited  
 SDA Marine Limited

Urbis Limited  
 URS Scott Wilson Limited

Title: LOCATION OF SPECIES OF CONSERVATION IMPORTANCE IDENTIFIED FROM LITERATURE REVIEW - SHAM WAT

Consultant's Signatures for Approval		Date
Design	GC	10JAN14
Checkers	JC	10JAN14
Design Supervisor	EC	21MAR14
Authorised Representative	AFK	21MAR14

EXPANSION OF HONG KONG INTERNATIONAL AIRPORT INTO A THREE-RUNWAY SYSTEM		Scale at A3
Drawing No.		1:15000
<b>MCL/P132/EIA/13-003</b>		Rev. B

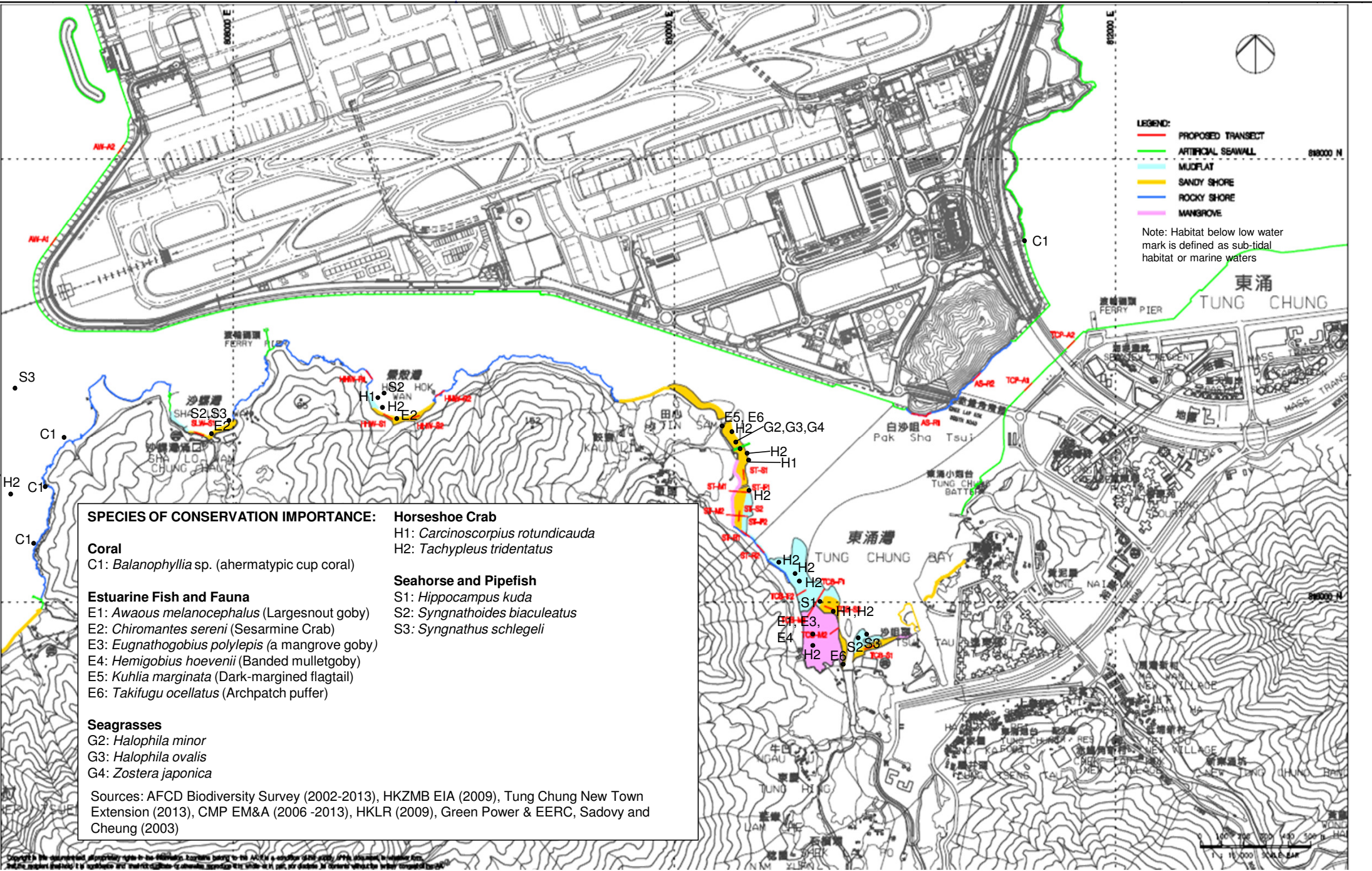

- LEGEND:**
- PROPOSED TRANSECT
  - ARTIFICIAL SEAWALL
  - MUDFLAT
  - SANDY SHORE
  - ROCKY SHORE
  - MANGROVE

Note: Habitat below low water mark is defined as sub-tidal habitat or marine waters

**SPECIES OF CONSERVATION IMPORTANCE:**

**Coral**  
 C1: *Balanophyllia* sp. (ahermatypic cup coral)

**Estuarine Fish and Fauna**  
 E1: *Awaous melanocephalus* (Largesnout goby)  
 E2: *Chromantes sereni* (Sesarmine Crab)  
 E3: *Eugnathogobius polylepis* (a mangrove goby)  
 E4: *Hemigobius hoevenii* (Banded mulletgoby)  
 E5: *Kuhlia marginata* (Dark-margined flagtail)  
 E6: *Takifugu ocellatus* (Archpatch puffer)

**Seagrasses**  
 G2: *Halophila minor*  
 G3: *Halophila ovalis*  
 G4: *Zostera japonica*

Sources: AFCD Biodiversity Survey (2002-2013), HKZMB EIA (2009), Tung Chung New Town Extension (2013), CMP EM&A (2006 -2013), HKLR (2009), Green Power & EERC, Sadovy and Cheung (2003)

**Horseshoe Crab**  
 H1: *Carcinoscorpius rotundicauda*  
 H2: *Tachypleus tridentatus*

**Seahorse and Pipefish**  
 S1: *Hippocampus kuda*  
 S2: *Syngnathoides biaculeatus*  
 S3: *Syngnathus schlegelii*

Rev.	Date	Description	Checked
A	16SEP13	FIRST ISSUE	GC
B	10JAN14	GENERAL REVISION	JC



**Mott MacDonald**  
 In association with

ARUP  
 Atkins China Limited  
 Clymene Enterprises

Deltarac  
 Ecosystems Limited  
 SDA Marine Limited

Urbis Limited  
 URS Scott Wilson Limited

Title: LOCATION OF SPECIES OF CONSERVATION IMPORTANCE IDENTIFIED FROM LITERATURE REVIEW – SHA LO WAN, HAU HOK WAN, SAN TAU AND TUNG CHUNG BAY

Consultant's Signatures for Approval		Date
Design	GC	10JAN14
Checkers	JC	10JAN14
Design Supervisor	EC	21MAR14
Authorised Representative	AFK	21MAR14

EXPANSION OF HONG KONG INTERNATIONAL AIRPORT INTO A THREE-RUNWAY SYSTEM		Scale at A3
Drawing No. MCL/P132/EIA/13-004		1:15000
Rev. B		

**SPECIES OF CONSERVATION IMPORTANCE:**

**Coral**

- C1: *Balanophyllia* sp. (ahermatypic cup coral)
- C2: *Paracyathus rotundatus* (ahermatypic cup coral)

**Seagrasses**

- G1: *Halophila beccarii*

**Horseshoe Crab**

- H1: *Carcinoscorpius rotundicauda*
- H2: *Tachypleus tridentatus*

**Estuarine Fish and fauna**

- E6: *Takifugu ocellatus* (Archpatch puffer)

Sources: AFCD Biodiversity Survey (2002-2013), HKZMB EIA (2009), Tung Chung New Town Extension (2013), HKLR (2009) CMP EM&A (2006 - 2013), Green Power & EERC, Sadovy and Cheung (2003)

**LEGEND:**

- PROPOSED TRANSECT
- ARTIFICIAL SEAWALL
- MUDFLAT
- SANDY SHORE
- ROCKY SHORE
- MANGROVE

Note: Habitat below low water mark is defined as sub-tidal habitat or marine waters

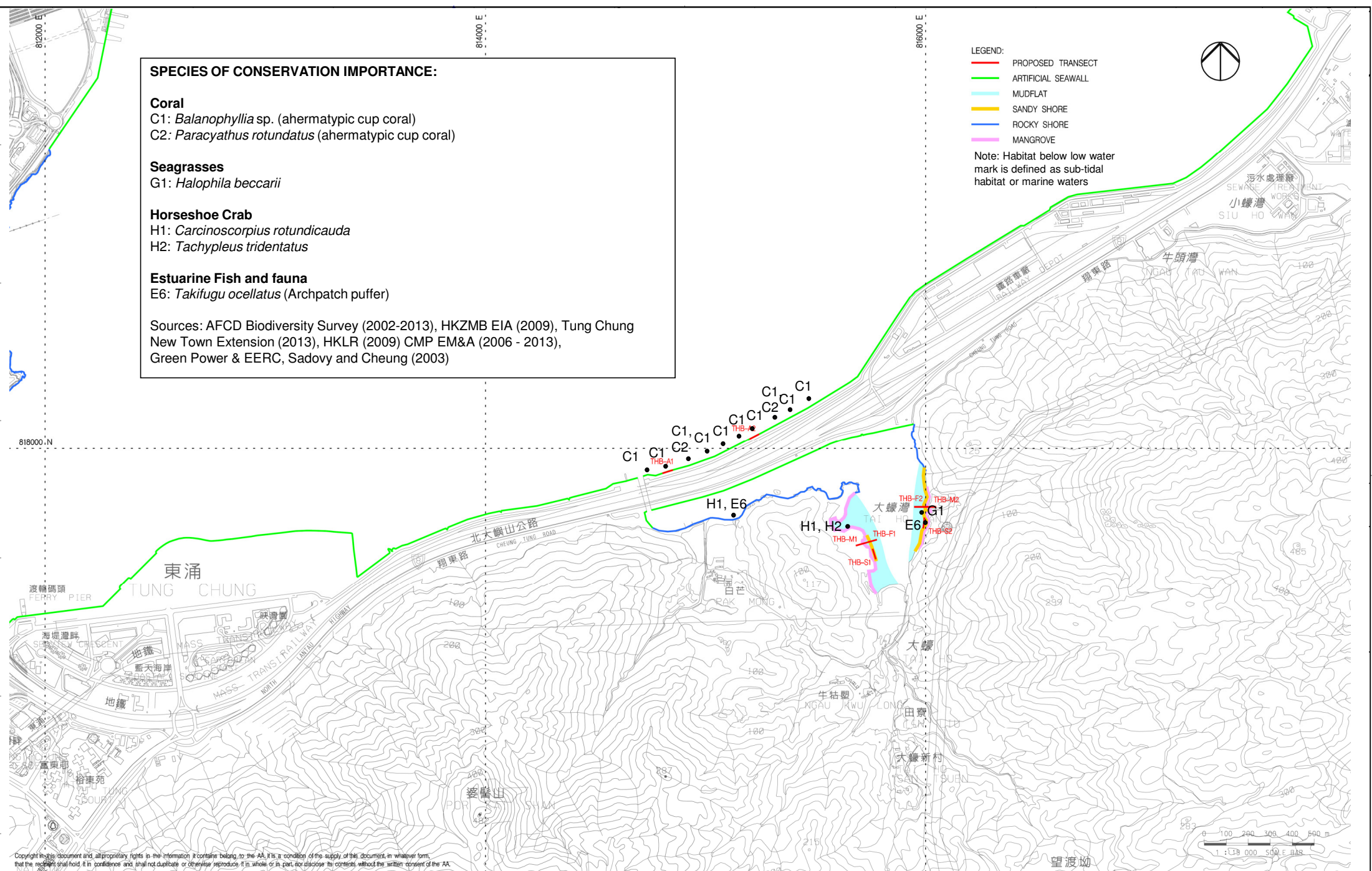

Copyright in this document and all proprietary rights in the information it contains belong to the AA. It is a condition of the supply of this document, in whatever form, that the recipient shall hold it in confidence and shall not duplicate or otherwise reproduce it in whole or in part, nor disclose its contents without the written consent of the AA.

Rev.	Date	Description	Checked
A	16SEP13	FIRST ISSUE	GC
B	10JAN14	GENERAL REVISION	JC



In association with

**Mott MacDonald**

ARUP  
Atkins China Limited  
Clymene Enterprises

Dollarus  
EcoSystems Limited  
SDA Marine Limited

Urbis Limited  
URS Scott Wilson Limited

Title: LOCATION OF SPECIES OF CONSERVATION IMPORTANCE IDENTIFIED FROM LITERATURE REIVEW – TAI HO WAN

Consultant's Signatures for Approval		Date
Design	GC	10JAN14
Checkers	JC	10JAN14
Design Supervisor	EC	21MAR14
Authorised Representative	AFK	21MAR14

EXPANSION OF HONG KONG INTERNATIONAL AIRPORT INTO A THREE-RUNWAY SYSTEM		Scale at A3
Drawing No.		1:15000
<b>MCL/P132/EIA/13-005</b>		Rev. B

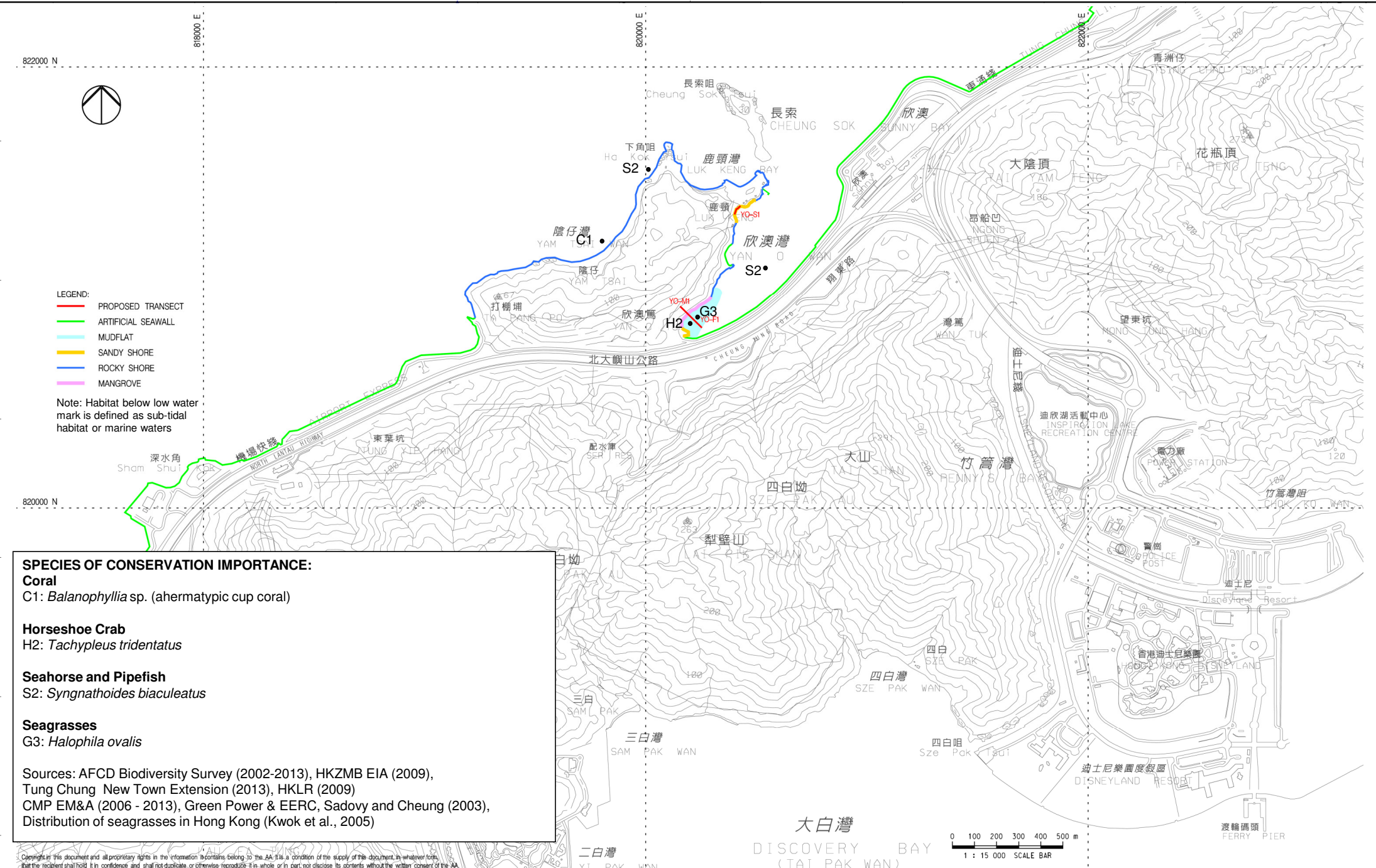

**SPECIES OF CONSERVATION IMPORTANCE:**

**Coral**  
 C1: *Balanophyllia* sp. (ahermatypic cup coral)

**Horseshoe Crab**  
 H2: *Tachypleus tridentatus*

**Seahorse and Pipefish**  
 S2: *Syngnathoides biaculeatus*

**Seagrasses**  
 G3: *Halophila ovalis*

Sources: AFCD Biodiversity Survey (2002-2013), HKZMB EIA (2009), Tung Chung New Town Extension (2013), HKLR (2009), CMP EM&A (2006 - 2013), Green Power & EERC, Sadovy and Cheung (2003), Distribution of seagrasses in Hong Kong (Kwok et al., 2005)

Copyright in this document and all proprietary rights in the information it contains belong to the AA. It is a condition of the supply of this document, in whatever form, that the recipient shall hold it in confidence and shall not duplicate or otherwise reproduce it in whole or in part, nor disclose its contents without the written consent of the AA.

Rev.	Date	Description	Checked
A	16SEP13	FIRST ISSUE	GC
B	10JAN14	GENERAL REVISION	JC



Title: LOCATION OF SPECIES OF CONSERVATION IMPORTANCE IDENTIFIED FROM LITERATURE REVIEW – YAN O

Consultant's Signatures for Approval		Date
Design	GC	10JAN14
Checkers	JC	10JAN14
Design Supervisor	EC	21MAR14
Authorised Representative	AFK	21MAR14

EXPANSION OF HONG KONG INTERNATIONAL AIRPORT INTO A THREE-RUNWAY SYSTEM		Scale at A3
Drawing No.		1 : 15000
<b>MCL/P132/EIA/13-006</b>		Rev. B



# 沙洲及龍鼓洲海岸公園

SHA CHAU AND LUNG KWU CHAU MARINE PARK



白洲  
PAK CHAI

白排  
Bai Pai

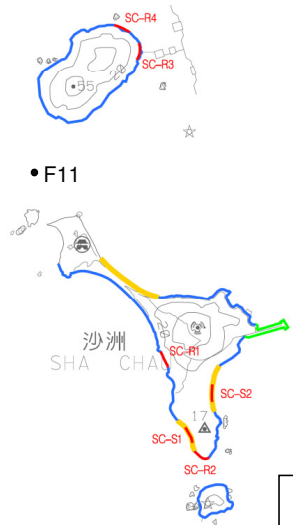

• E6, F2, F3, F4, F6, F8,  
F10, F13, H1, H2, O1, S3

• F11

• C3

Note: Habitat below low water mark is defined as sub-tidal habitat or marine waters

LEGEND:

- PROPOSED TRANSECT
- ARTIFICIAL SEAWALL
- SANDY SHORE
- ROCKY SHORE

### SPECIES OF CONSERVATION IMPORTANCE:

#### Coral

C3: Hard Coral (Faviidae)

#### Estuarine Fish and Fauna

E6: *Takifugu ocellatus* (Archpatch puffer)

#### Marine Fish

- F2: *Clupanodon thrissa* (Chinese gizzard shad)
- F3: *Dasyatis akajei* (red stingray)
- F4: *Dasyatis zugei* (pale-edged stingray)
- F6: *Epinephelus bruneus* (longtooth grouper)
- F8: *Inimicus japonicus* (Devil stinger)
- F10: *Nemichthys scolopaceus* (Slender snipe eel)
- F11: *Nemipterus virgatus* (Golden threadfin bream)
- F13: *Zebrias crossolepis*

#### Horseshoe Crab

- H1: *Carcinoscorpius rotundicauda*
- H2: *Tachypleus tridentatus*

#### Other Marine Species

O1: *Oliva mustelina* (Sea snail)

#### Seahorse and Pipefish

S3: *Syngnathus schlegelii*

Sources: AFCD Biodiversity Survey (2002-2013), HKZMB EIA (2009), Tung Chung New Town Extension (2013), HKLR (2009), CMP EM&A (2006 - 2013), Green Power & EERC, Sadovy and Cheung (2003)

Copyright in this document and all proprietary rights in the information it contains belong to the AA. It is a condition of the supply of this document, in whatever form, that the recipient shall hold it in confidence and shall not duplicate or otherwise reproduce it in whole or in part, nor disclose its contents without the written consent of the AA.

Rev.	Date	Description	Checked
A	16SEP13	FIRST ISSUE	GC
B	10JAN14	GENERAL REVISION	JC



ARUP  
Atkins China Limited  
Clymene Enterprises



In association with  
Deltaros  
EcoSystems Limited  
URS Limited  
URS Scott Wilson Limited

Title

LOCATION OF SPECIES OF CONSERVATION IMPORTANCE IDENTIFIED FROM LITERATURE REVIEW- SHA CHAU

Consultant's Signatures for Approval		Date
Design	GC	10JAN14
Checkers	JC	10JAN14
Design Supervisor	EC	21MAR14
Authorised Representative	AFK	21MAR14

EXPANSION OF HONG KONG INTERNATIONAL AIRPORT INTO A THREE-RUNWAY SYSTEM		Scale at A3
Drawing No.		1:15000
<b>MCL/P132/EIA/13-007</b>		Rev. B