

- LEGEND:**
- EXISTING TRAFFIC DIRECTION (ONE ARROW REPRESENTS ONE LANE)
 - PROPOSED VIADUCT / WIDENING OF BRIDGE DECK
 - OPTION 1A: ROUTING
 - DRAINAGE RESERVE
 - PROPOSED NOISE ENCLOSURE
 - PROPOSED MOVEMENT JOINT BETWEEN EXISTING AND PROPOSED STRUCTURES
 - PROPOSED MONOLITHIC STITCHED JOINT BETWEEN EXISTING AND PROPOSED STRUCTURES
 - EXISTING COLUMN
 - PROPOSED COLUMN
 - PROPOSED PORTAL FRAME SPAN ACROSS DRAINAGE RESERVE
 - ROUTE 3 - TO TSIM SHA TSUI, HONG KONG (W), LANTAU
 - ROUTE 5 - TO KWUN TONG, LAI CHI KOK, MONG KOK
 - EXISTING ROAD LEVEL IN mPD (APPROX.)
 - PROPOSED ROAD LEVEL IN mPD (APPROX.)

- ABBREVIATIONS:**
- PVI - POINT OF VERTICAL INTERSECTION
 - PVC - POINT OF VERTICAL CURVATURE
 - PVT - POINT OF VERTICAL TANGENCY
 - RL - FINISHED ROAD LEVEL

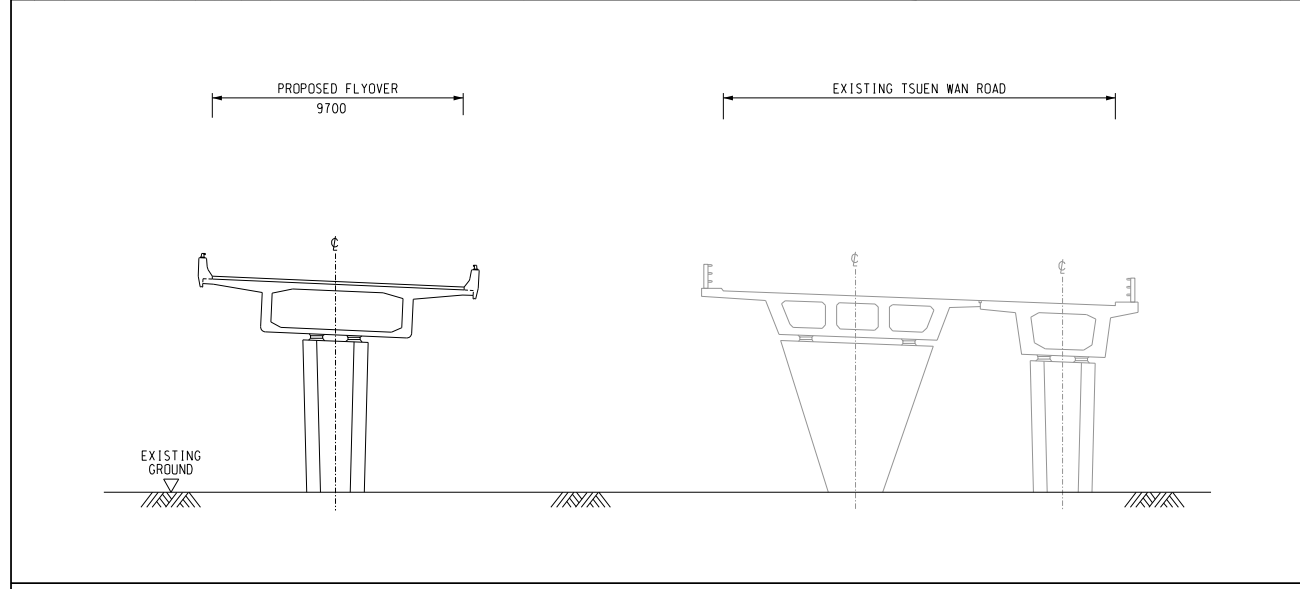

SECTION 1 - 1
SCALE N.T.S.

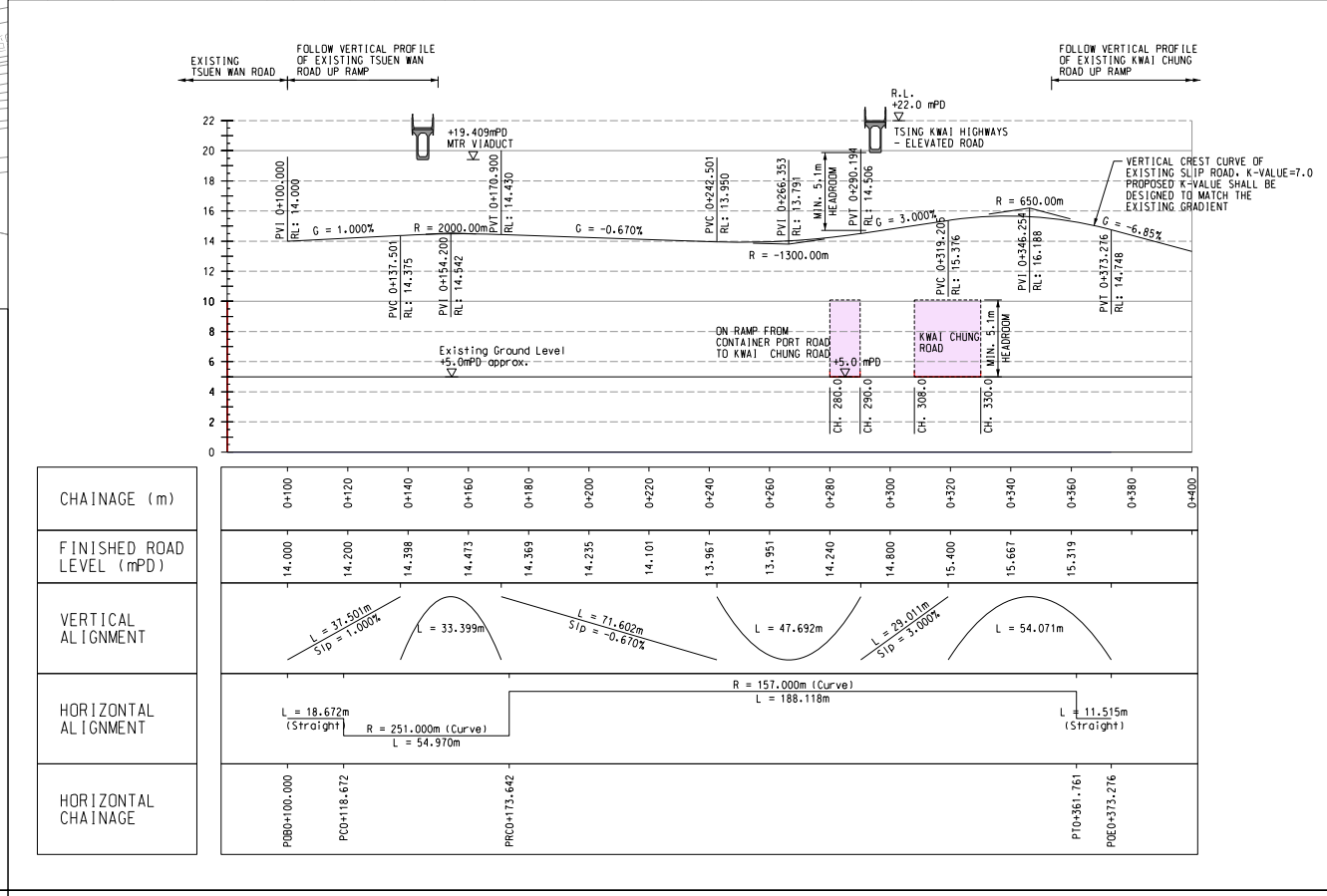

VERTICAL PROFILE
SCALE N.T.S.

Rev.	Date	Description	Drawn	Checked
C	MAY13	MINOR AMENDMENT	ELVIS	ESH
B	APR13	EXISTING MTR'S COLUMNS ADDED	ELVIS	ESH
A	MAR13	PROPOSED COLUMNS AND GRID ADDED	ELVIS	ESH

土木工務拓展署
CEDD Civil Engineering and Development Department

OFFICE
NEW TERRITORIES NORTH AND WEST DEVELOPMENT OFFICE
AGREEMENT NO. CE 8/2012 (HY)
FLYOVER FROM KWAI TSING INTERCHANGE UP-RAMP TO KWAI CHUNG ROAD - INVESTIGATION

OPTION 1A: SEPARATE VIADUCT ON EAST SIDE OF TWR (DESIGN SPEED 70KM/H)

Drawing No. 圖則編號	FIGURE 2.4			
Designed 設計	HC	Drawn 繪圖	CMH	Checked 校核
Approved 校核	TSN	Date 日期	12/14	Status 校核 PRELIMINARY

