

ISO A1 594mm x 841mm
 Approved:
 Checked:
 Designer:
 Project Management Initials:

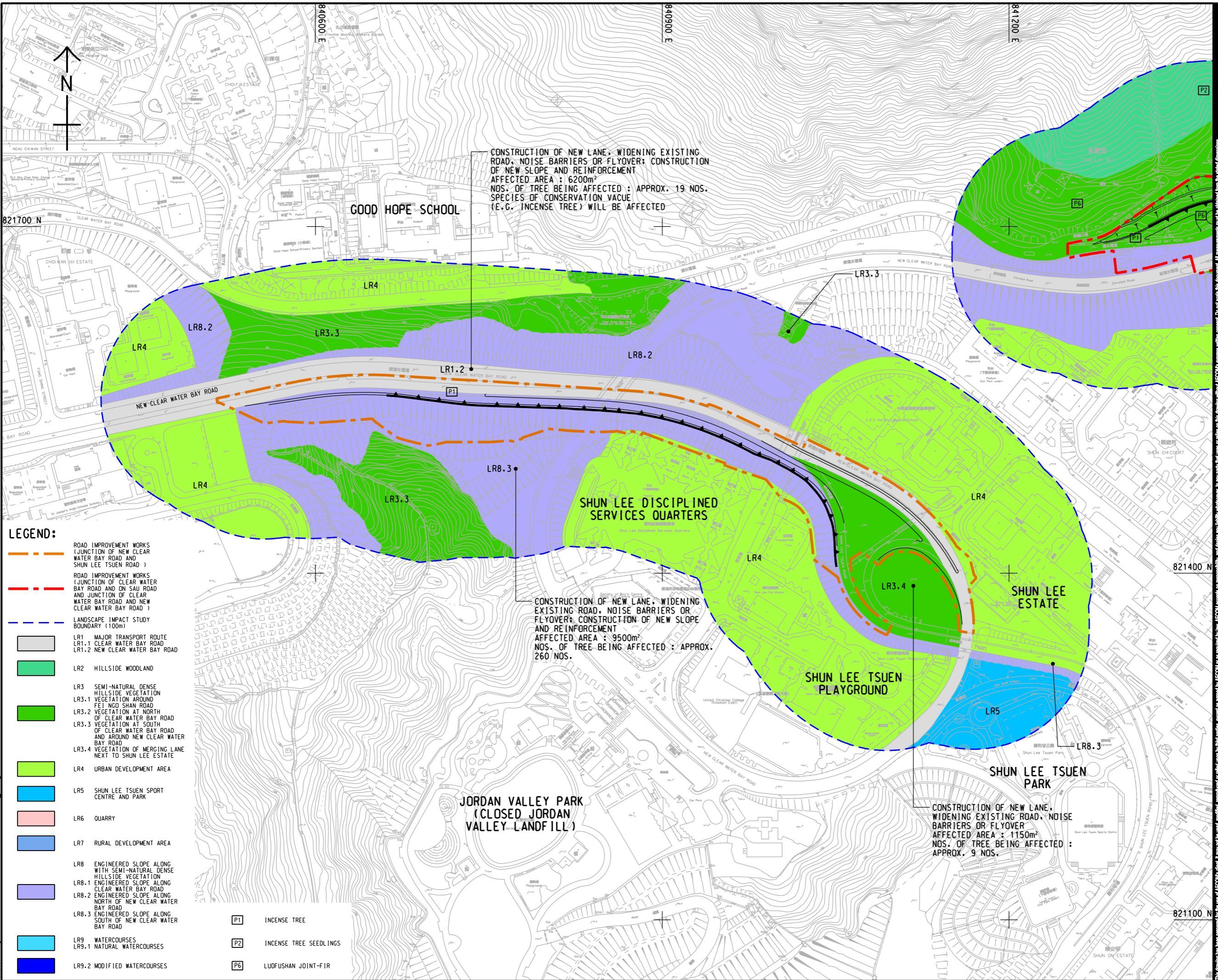

- LEGEND:**
- ROAD IMPROVEMENT WORKS (JUNCTION OF NEW CLEAR WATER BAY ROAD AND SHUN LEE TSUEN ROAD)
 - ROAD IMPROVEMENT WORKS (JUNCTION OF CLEAR WATER BAY ROAD AND ON SAU ROAD AND JUNCTION OF CLEAR WATER BAY ROAD AND NEW CLEAR WATER BAY ROAD)
 - LANDSCAPE IMPACT STUDY BOUNDARY (100m)
 - LR1 MAJOR TRANSPORT ROUTE
LR1.1 CLEAR WATER BAY ROAD
LR1.2 NEW CLEAR WATER BAY ROAD
 - LR2 HILLSIDE WOODLAND
 - LR3 SEMI-NATURAL DENSE HILLSIDE VEGETATION
LR3.1 VEGETATION AROUND FEI NGO SHAN ROAD
LR3.2 VEGETATION AT NORTH OF CLEAR WATER BAY ROAD
LR3.3 VEGETATION AT SOUTH OF CLEAR WATER BAY ROAD AND AROUND NEW CLEAR WATER BAY ROAD
LR3.4 VEGETATION OF MERGING LANE NEXT TO SHUN LEE ESTATE
 - LR4 URBAN DEVELOPMENT AREA
 - LR5 SHUN LEE TSUEN SPORT CENTRE AND PARK
 - LR6 QUARRY
 - LR7 RURAL DEVELOPMENT AREA
 - LR8 ENGINEERED SLOPE ALONG WITH SEMI-NATURAL DENSE HILLSIDE VEGETATION
LR8.1 ENGINEERED SLOPE ALONG CLEAR WATER BAY ROAD
LR8.2 ENGINEERED SLOPE ALONG NORTH OF NEW CLEAR WATER BAY ROAD
LR8.3 ENGINEERED SLOPE ALONG SOUTH OF NEW CLEAR WATER BAY ROAD
 - LR9 WATERCOURSES
LR9.1 NATURAL WATERCOURSES
LR9.2 MODIFIED WATERCOURSES
 - P1 INCENSE TREE
 - P2 INCENSE TREE SEEDLINGS
 - P6 LUOFUSHAN JOINT-FIR

CONSTRUCTION OF NEW LANE, WIDENING EXISTING ROAD, NOISE BARRIERS OR FLYOVER; CONSTRUCTION OF NEW SLOPE AND REINFORCEMENT
 AFFECTED AREA : 6200m²
 NOS. OF TREE BEING AFFECTED : APPROX. 19 NOS.
 SPECIES OF CONSERVATION VALUE (E.G. INCENSE TREE) WILL BE AFFECTED

CONSTRUCTION OF NEW LANE, WIDENING EXISTING ROAD, NOISE BARRIERS OR FLYOVER; CONSTRUCTION OF NEW SLOPE AND REINFORCEMENT
 AFFECTED AREA : 9500m²
 NOS. OF TREE BEING AFFECTED : APPROX. 260 NOS.

CONSTRUCTION OF NEW LANE, WIDENING EXISTING ROAD, NOISE BARRIERS OR FLYOVER
 AFFECTED AREA : 1150m²
 NOS. OF TREE BEING AFFECTED : APPROX. 9 NOS.



PROJECT
 項目
DEVELOPMENT OF ANDERSON ROAD QUARRY SITE - INVESTIGATION, DESIGN AND CONSTRUCTION

CLIENT
 業主
 土木工程拓展署
 Civil Engineering and Development Department

CONSULTANT
 顧問公司
 AECOM Asia Company Ltd.
 www.aecom.com

SUB-CONSULTANTS
 分門工程顧問公司

ISSUE/REVISION
 修訂

IR/ 修訂	DATE/ 日期	DESCRIPTION/ 內容摘要	CHK/ 核實

STATUS
 階段

SCALE
 比例
 A3 1 : 3000
DIMENSION UNIT
 尺寸單位
 METRES

KEY PLAN A3 1 : 16000
 索引圖

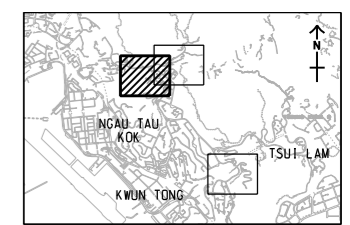

PROJECT NO.
 項目編號
 60328348
CONTRACT NO.
 合約編號
 CE 10/2014 (CE)

SHEET TITLE
 圖紙名稱
IMPACT ON LANDSCAPE RESOURCES

SHEET NUMBER
 圖紙編號
 60328348/VISUAL/FIGURE 10.40

SHEET 1 OF 3

This drawing has been prepared for the use of AECOM's client. It may not be used, modified, reproduced or relied upon by third parties, except as agreed by AECOM or as required by law. AECOM accepts no responsibility, and denies any liability whatsoever, for any party that uses or relies on this drawing without AECOM's express written consent. Do not scale this document. All measurements must be obtained from the stated dimensions.

Pld File by: XIAOCHENG 2016/10/18
 PATH: P:\projects\60328348\DRAWING\REPORT\VISUAL\VISUAL_724.dgn