

ISO A1 594mm x 841mm
Approved:
Checked:
Designer:
Project Management Initials:
Pld File by: WANGGLW_20150911
PATH_P:\proj\60328348\DRAWING\REPORT\EA_RIW\EA_RIW_122.dgn

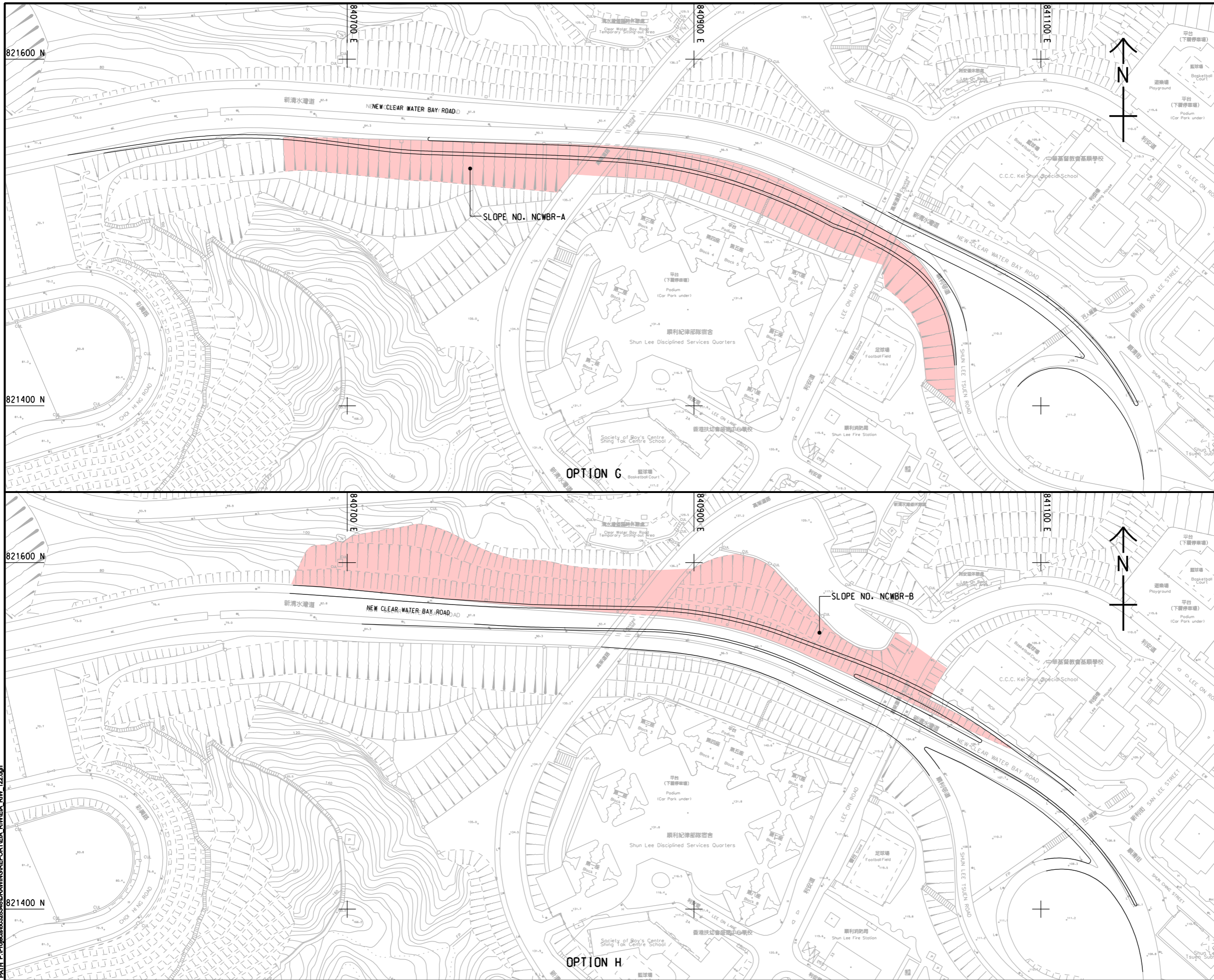

AECOM

PROJECT
DEVELOPMENT OF ANDERSON ROAD QUARRY SITE - INVESTIGATION, DESIGN AND CONSTRUCTION

CLIENT
 土木工程拓展署
CEDD Civil Engineering and Development Department

CONSULTANT
 AECOM Asia Company Ltd.
 www.aecom.com

SUB-CONSULTANTS
 分判工程顧問公司

ISSUE/REVISION

NO.	DATE	DESCRIPTION	CHK.

STATUS
 預設

SCALE
 1:1000

DIMENSION UNIT
 公尺

KEY PLAN A11: 60000

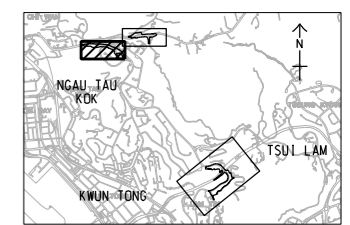

PROJECT NO.
 60328348

CONTRACT NO.
 CE 10/2014 (CE)

SHEET TITLE
 OPTIONS OF RIW AT J/O NEW CLEAR WATER BAY ROAD NEAR SHUN LEE TSUEN ROAD

SHEET NUMBER
 60328348/EIA_RIW/FIGURE 3.3

This drawing has been prepared for the use of AECOM's client. It may not be used, modified, reproduced or relied upon by third parties, except as agreed by AECOM or as required by law. AECOM accepts no responsibility, except as required by law, AECOM accepts no responsibility, and does not warrant, for any part, but does or makes on this drawing without AECOM's express written consent. Do not scale this document. All measurements must be obtained from the related dimensions.