

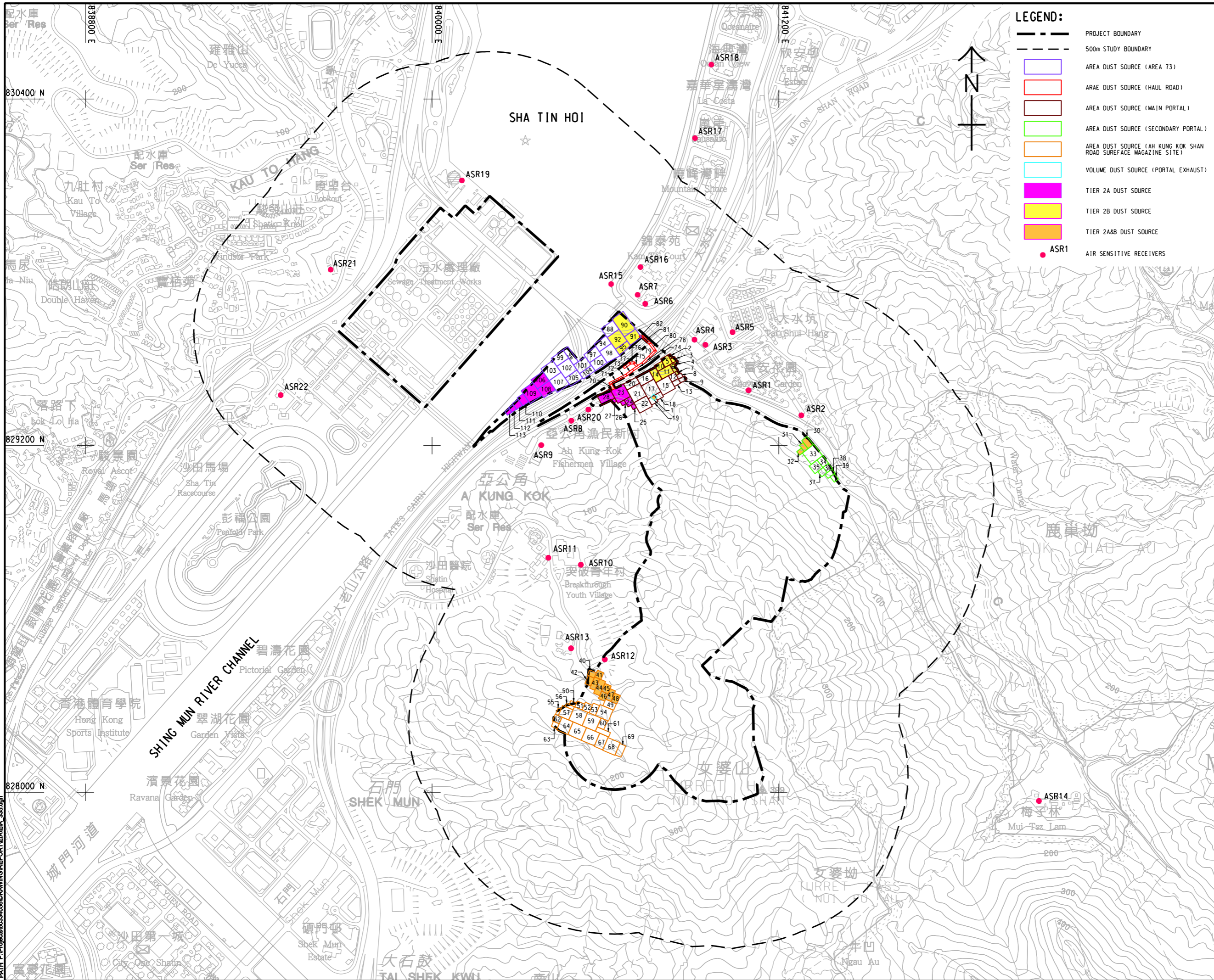





ISO A1 594mm x 841mm  
 Approved:  
 Checked:  
 Designer:  
 Project Management Initials:  
 Pld File by: PENGMW 20160221  
 PATH: P:\proj\60334056\DRAWING\REPORT\EAIA\_335.dgn



**LEGEND:**

- PROJECT BOUNDARY
- 500m STUDY BOUNDARY
- AREA DUST SOURCE (AREA 73)
- AREA DUST SOURCE (HAUL ROAD)
- AREA DUST SOURCE (MAIN PORTAL)
- AREA DUST SOURCE (SECONDARY PORTAL)
- AREA DUST SOURCE (AH KUNG KOK SHAN ROAD SURFACE MAGAZINE SITE)
- VOLUME DUST SOURCE (PORTAL EXHAUST)
- TIER 2A DUST SOURCE
- TIER 2B DUST SOURCE
- TIER 2A&B DUST SOURCE
- ASR1
- AIR SENSITIVE RECEIVERS



**PROJECT**  
 項目  
**RELOCATION OF SHA TIN SEWAGE TREATMENT WORKS TO CAVERNS: CAVERNS AND SEWAGE TREATMENT WORKS - INVESTIGATION, DESIGN AND CONSTRUCTION**

**CLIENT**  
 業主  
 渠務署  
 Drainage Services Department

**CONSULTANT**  
 工程顧問公司  
 AECOM Asia Company Ltd.  
 www.aecom.com

**SUB-CONSULTANTS**  
 外聘工程顧問公司

**ISSUE/REVISION**  
 修訂

No.	Date	Description	CHK.
A	JAN. 16	EIA	
-	SEP. 15	EIA (DRAFT)	

**STATUS**  
 階段

**SCALE**  
 比例  
 A3 1: 12000

**DIMENSION UNIT**  
 尺寸單位  
 METRES

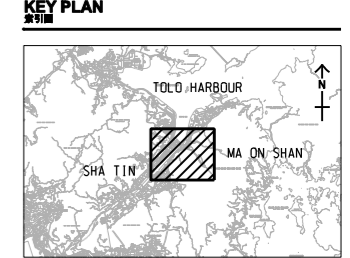

**PROJECT NO.**  
 項目編號  
 60334056

**CONTRACT NO.**  
 合約編號  
 CE 30/2014 (DS)

**SHEET TITLE**  
 圖紙標題  
 LOCATION OF CONSTRUCTION DUST EMISSIONS SOURCE (CONSTRUCTION OF CSTW)

**SHEET NUMBER**  
 圖紙編號  
 60334056/EIA/3.35A

This drawing has been prepared for the use of AECOM's client. It may not be used, modified, reproduced or relied upon by third parties, except as agreed by AECOM or as required by law. AECOM accepts no responsibility, and denies any liability whatsoever, for any party that uses or relies on this drawing without AECOM's express written consent. Do not scale this document. All measurements must be obtained from the stated dimensions.

**Appendix 3.02e Demolition of Existing STSTW - Calculation of Dust Emission Source**

**Demolition of Existing STSTW**

**Emission rates for Short-term Average Prediction (Tier 1)**

Location	Source	Emission Rates	(Unmitigated)	(Mitigated)	Parameters	Remarks			
Construction Sites at Existing STSTW	Construction Activities Source ID: 1 - 83	Heavy Construction Area Source (g/m <sup>2</sup> /s)	2.075617E-04	2.594522E-05	TSP emission factor (Mg/hectare/month of activity)	2.69 from AP-42, S13.2.3, 1/95 ed.			
					Percentage area actively operating (%)	100 Full strength (Tier 1 Test)			
					% of dust suppression	87.5 Assuming watering eight times a day, reference to Kai Tak Development EIA Report			
					no. of operation hour (hr)	12 Assumed typical working hours of work site referenced in AP-42			
					Emission height (m)	0.5			
		Wind Erosion Area Source (g/m <sup>2</sup> /s)	9.81767E-05	1.22721E-05	RSP emission factor (Mg/hectare/month of activity)	1.27237	from USEPA AP-42, 5th ed. 11/06 ed. S13.2.4		
					% fraction of TSP	0.473			
					FSP emission factor (Mg/hectare/month of activity)	0.19368		from USEPA AP-42, 5th ed. 11/06 ed. S13.2.4	
						% fraction of TSP			0.072
						TSP emission factor (Mg/hectare/yr)			0.85 AP-42, 5th ed., Table 11.9.4
Percentage area actively operating (%)	100 Full strength (Tier 1 Test)								
Emission height (m)	0.5								
Wind Erosion Area Source (g/m <sup>2</sup> /s)	1.27489E-06	1.86806E-06	RSP emission factor (Mg/hectare/month of activity)	0.40205	from USEPA AP-42, Appendix B.2 Table 2.2 Category 3				
			% fraction of TSP	0.473					
			FSP emission factor (Mg/hectare/month of activity)	0.0612					
% fraction of TSP	0.072	from USEPA AP-42, 5th ed. 11/06 ed. S13.2.4							

**Emission rates for Short-term Average Prediction (Tier 2)**

Location	Source	Emission Rates	(Unmitigated)	(Mitigated)	Parameters	Remarks			
Construction Sites at Main Portal	Construction Activities Source ID: 1 - 83	Heavy Construction Area Source (g/m <sup>2</sup> /s)	2.075617E-04	2.594522E-05	TSP emission factor (Mg/hectare/month of activity)	2.69 from AP-42, S13.2.3, 1/95 ed.			
					Percentage area actively operating (%)	100 Full strength (Tier 2 Test)			
					% of dust suppression	87.5 Assuming watering eight times a day, reference to Kai Tak Development EIA Report			
					no. of operation hour (hr)	12 Assumed typical working hours of work site referenced in AP-42			
					Emission height (m)	0.5			
		Wind Erosion Area Source (g/m <sup>2</sup> /s)	9.81767E-05	1.22721E-05	RSP emission factor (Mg/hectare/month of activity)	1.27237	from USEPA AP-42, 5th ed. 11/06 ed. S13.2.4		
					% fraction of TSP	0.473			
					FSP emission factor (Mg/hectare/month of activity)	0.19368		from USEPA AP-42, 5th ed. 11/06 ed. S13.2.4	
						% fraction of TSP			0.072
						TSP emission factor (Mg/hectare/yr)			0.85 AP-42, 5th ed., Table 11.9.4
Percentage area actively operating (%)	100 Full strength (Tier 2 Test)								
Emission height (m)	0.5								
Wind Erosion Area Source (g/m <sup>2</sup> /s)	1.27489E-06	1.86806E-06	RSP emission factor (Mg/hectare/month of activity)	0.40205	from USEPA AP-42, 5th ed. 11/06 ed. S13.2.4				
			% fraction of TSP	0.473					
			FSP emission factor (Mg/hectare/month of activity)	0.0612					
% fraction of TSP	0.072	from USEPA AP-42, 5th ed. 11/06 ed. S13.2.4							

**Appendix 3.02e Demolition of Existing STSTW - Calculation of Dust Emission Source**  
**Demolition of Existing STSTW**

**Emission rates for Long-term Average Prediction (Annual)**

Location	Source	Emission Rates	(Unmitigated)	(Mitigated)	Parameters	Remarks	
Construction Sites at Main Portal	Construction Activities  Source ID: 1 - 83	Heavy Construction Area Source (g/m <sup>2</sup> /s)	2.075617E-05	2.594522E-06	TSP emission factor (Mg/hectare/month of activity)	2.69	from AP-42, S13.2.3, 1/95 ed.
					Percentage area actively operating (%)	10	Worst case assumption, refer to Justification of Percentage Active Works Area for Caverns for Relocation of STSTW
					% of dust suppression	87.5	Assuming watering eight times a day, reference to Kai Tak Development EIA Report
					no. of operation hour (hr)	12	Assumed typical working hours of work site referenced in AP-42
					Emission height (m)	0.5	
		Wind Erosion Area Source (g/m <sup>2</sup> /s)	9.81767E-06	1.22721E-06	RSP emission factor (Mg/hectare/month of activity)	1.27237	
					% fraction of TSP	0.473	from USEPA AP-42, 5th ed. 11/06 ed. S13.2.4
					FSP emission factor (Mg/hectare/month of activity)	0.19368	
					% fraction of TSP	0.072	from USEPA AP-42, 5th ed. 11/06 ed. S13.2.4
					TSP emission factor (Mg/hectare/yr)	0.85	AP-42, 5th ed., Table 11.9.4
	2.695332E-07	1.27489E-07	Percentage area actively operating (%)	10	from engineer		
			Emission height (m)	0.5			
			RSP emission factor (Mg/hectare/month of activity)	0.40205			
			% fraction of TSP	0.473	from USEPA AP-42, 5th ed. 11/06 ed. S13.2.4		
			FSP emission factor (Mg/hectare/month of activity)	0.0612			
	1.94064E-08	0.072	from USEPA AP-42, 5th ed. 11/06 ed. S13.2.4				

## Appendix 3.02e Demolition of Existing STSTW - Calculations of Construction Dust Emission Rates

### Justification of Percentage Active Works Area for Caverns for Relocation of STSTW

Construction Peak Year = 2027  
 Total Area of for Works Area for Caverns = 280019 m<sup>2</sup>

#### A1450 Demolition of Existing STSTW

Plant	Percentage of Usage (%)	Plan Size			Area in term of Time of Usage (m <sup>2</sup> )
		B (m)	L (m)	No. of Item	
Excavator	100%	3.2	8	20	512
Excavator with rock breakers	100%	3.2	8	40	1024
Dump Truck	100%	2.4	10	40	960
Air compressor	100%	-	-	20	-
Generator	100%	-	-	20	-
Lorry	100%	2.4	10	20	480
Mobile Crane	100%	2.6	10	10	260
Cutter	100%	-	-	20	-
Pneumatic Breaker	100%	-	-	40	-
<b>A1450</b>		<b>Total:</b>			<b>3236</b>
		<b>Percentage of Usage Area to Works Area:</b>			<b>1.2%</b>

As a worst case assumption, all construction activities are assumed to be carried out at the same time

<b>Total Percentage of Usage Area to Works Area for CSTS</b>	<b>1.2%</b>
<b>Percentage adopted in Dust model for Short-term Assessment</b>	<b>20%</b>
<b>Percentage adopted in Dust model for Annual Assessment</b>	<b>10%</b>









Pd File by: PENGMW 20160221  
 PATH: P:\Projects\60334056\DRAWING\REPORT\EA\EA\_336.dgn  
 Project Management Initials: Designer: Checked: Approved: ISO A1 594mm x 841mm

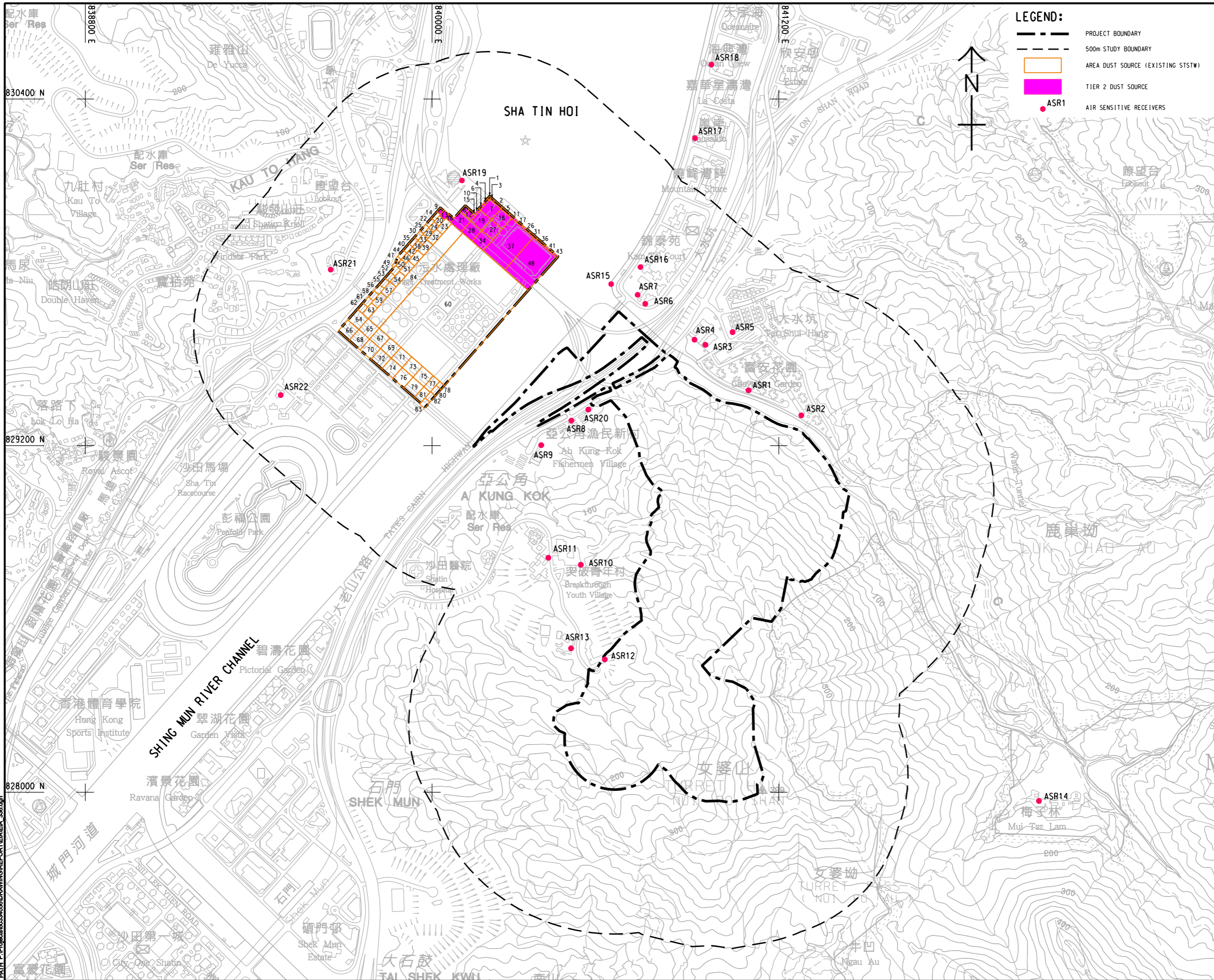

**AECOM**

**PROJECT**  
 項目  
**RELOCATION OF SHA TIN SEWAGE TREATMENT WORKS TO CAVERNS: CAVERNS AND SEWAGE TREATMENT WORKS - INVESTIGATION, DESIGN AND CONSTRUCTION**

**CLIENT**  
 業主  
 渠務署  
 Drainage Services Department

**CONSULTANT**  
 工程顧問公司  
 AECOM Asia Company Ltd.  
 www.aecom.com

**SUB-CONSULTANTS**  
 分判工程顧問公司

---

**ISSUE/REVISION**  
 修訂

NO.	DATE	DESCRIPTION	CHK.
A	JAN. 16	EIA	
-	SEP. 15	EIA (DRAFT)	

**STATUS**  
 階段

**SCALE**  
 比例  
 A3 1: 12000

**DIMENSION UNIT**  
 尺寸單位  
 METRES

**KEY PLAN**  
 索引圖

**PROJECT NO.**  
 項目編號  
 60334056

**CONTRACT NO.**  
 合約編號  
 CE 30/2014 (DS)

**SHEET TITLE**  
 圖紙名稱  
 LOCATION OF CONSTRUCTION DUST EMISSION SOURCE (DEMOLITION OF EXISTING STSTW)

**SHEET NUMBER**  
 圖紙編號  
 60334056/EIA/3.36A

This drawing has been prepared for the use of AECOM's client. It may not be used, modified, reproduced or relied upon by third parties, except as approved by AECOM or as required by law. AECOM accepts no responsibility, and denies any liability whatsoever, to any party that uses or relies on this drawing without AECOM's express written consent. Do not scale this document. All measurements must be obtained from the stated dimensions.