

Appendix 3.02e Demolition of Existing STSTW - Calculation of Dust Emission Source

Demolition of Existing STSTW

Emission rates for Short-term Average Prediction (Tier 1)

Location	Source	Emission Rates	(Unmitigated)	(Mitigated)	Parameters	Remarks
Construction Sites at Existing STSTW	Construction Activities Source ID: 1 - 83	Heavy Construction Area Source (g/m ² /s)	2.075617E-04	2.594522E-05	TSP emission factor (Mg/hectare/month of activity)	2.69 from AP-42, S13.2.3, 1/95 ed.
					Percentage area actively operating (%)	100 Full strength (Tier 1 Test)
					% of dust suppression	87.5 Assuming watering eight times a day, reference to Kai Tak Development EIA Report
					no. of operation hour (hr)	12 Assumed typical working hours of work site referenced in AP-42
					Emission height (m)	0.5
		Wind Erosion Area Source (g/m ² /s)	2.695332E-06	TSP emission factor (Mg/hectare/yr)	0.85 AP-42, 5th ed., Table 11.9.4	
				Percentage area actively operating (%)	100 Full strength (Tier 1 Test)	
				Emission height (m)	0.5	
		9.81767E-05	1.22721E-05	RSP emission factor (Mg/hectare/month of activity)	1.27237	
				% fraction of TSP	0.473	from USEPA AP-42, 5th ed. 11/06 ed. S13.2.4
		1.49444E-05	1.86806E-06	FSP emission factor (Mg/hectare/month of activity)	0.19368	
				% fraction of TSP	0.072	from USEPA AP-42, 5th ed. 11/06 ed. S13.2.4
				RSP emission factor (Mg/hectare/month of activity)	0.40205	
				% fraction of TSP	0.473	from USEPA AP-42, Appendix B.2 Table 2.2 Category 3
				FSP emission factor (Mg/hectare/month of activity)	0.0612	
				% fraction of TSP	0.072	from USEPA AP-42, 5th ed. 11/06 ed. S13.2.4

Emission rates for Short-term Average Prediction (Tier 2)

Location	Source	Emission Rates	(Unmitigated)	(Mitigated)	Parameters	Remarks
Construction Sites at Main Portal	Construction Activities Source ID: 1 - 83	Heavy Construction Area Source (g/m ² /s)	2.075617E-04	2.594522E-05	TSP emission factor (Mg/hectare/month of activity)	2.69 from AP-42, S13.2.3, 1/95 ed.
					Percentage area actively operating (%)	100 Full strength (Tier 2 Test)
					% of dust suppression	87.5 Assuming watering eight times a day, reference to Kai Tak Development EIA Report
					no. of operation hour (hr)	12 Assumed typical working hours of work site referenced in AP-42
					Emission height (m)	0.5
		Wind Erosion Area Source (g/m ² /s)	2.695332E-06	TSP emission factor (Mg/hectare/yr)	0.85 AP-42, 5th ed., Table 11.9.4	
				Percentage area actively operating (%)	100 Full strength (Tier 2 Test)	
				Emission height (m)	0.5	
		9.81767E-05	1.22721E-05	RSP emission factor (Mg/hectare/month of activity)	1.27237	
				% fraction of TSP	0.473	from USEPA AP-42, 5th ed. 11/06 ed. S13.2.4
		1.49444E-05	1.86806E-06	FSP emission factor (Mg/hectare/month of activity)	0.19368	
				% fraction of TSP	0.072	from USEPA AP-42, 5th ed. 11/06 ed. S13.2.4
				RSP emission factor (Mg/hectare/month of activity)	0.40205	
				% fraction of TSP	0.473	from USEPA AP-42, 5th ed. 11/06 ed. S13.2.4
				FSP emission factor (Mg/hectare/month of activity)	0.0612	
				% fraction of TSP	0.072	from USEPA AP-42, 5th ed. 11/06 ed. S13.2.4

Appendix 3.02e Demolition of Existing STSTW - Calculation of Dust Emission Source
Demolition of Existing STSTW

Emission rates for Long-term Average Prediction (Annual)

Location	Source	Emission Rates	(Unmitigated)	(Mitigated)	Parameters	Remarks	
Construction Sites at Main Portal	Construction Activities Source ID: 1 - 83	Heavy Construction Area Source (g/m ² /s)	2.075617E-05	2.594522E-06	TSP emission factor (Mg/hectare/month of activity)	2.69	from AP-42, S13.2.3, 1/95 ed.
					Percentage area actively operating (%)	10	Worst case assumption, refer to Justification of Percentage Active Works Area for Caverns for Relocation of STSTW
					% of dust suppression	87.5	Assuming watering eight times a day, reference to Kai Tak Development EIA Report
					no. of operation hour (hr)	12	Assumed typical working hours of work site referenced in AP-42
					Emission height (m)	0.5	
		Wind Erosion Area Source (g/m ² /s)	9.81767E-06	1.22721E-06	RSP emission factor (Mg/hectare/month of activity)	1.27237	
					% fraction of TSP	0.473	from USEPA AP-42, 5th ed. 11/06 ed. S13.2.4
					FSP emission factor (Mg/hectare/month of activity)	0.19368	
					% fraction of TSP	0.072	from USEPA AP-42, 5th ed. 11/06 ed. S13.2.4
					TSP emission factor (Mg/hectare/yr)	0.85	AP-42, 5th ed., Table 11.9.4
	2.695332E-07	1.27489E-07	Percentage area actively operating (%)	10	from engineer		
			Emission height (m)	0.5			
			RSP emission factor (Mg/hectare/month of activity)	0.40205			
			% fraction of TSP	0.473	from USEPA AP-42, 5th ed. 11/06 ed. S13.2.4		
			FSP emission factor (Mg/hectare/month of activity)	0.0612			
	1.94064E-08	0.072	from USEPA AP-42, 5th ed. 11/06 ed. S13.2.4				

Appendix 3.02e Demolition of Existing STSTW - Calculations of Construction Dust Emission Rates

Justification of Percentage Active Works Area for Caverns for Relocation of STSTW

Construction Peak Year = 2027
 Total Area of for Works Area for Caverns = 280019 m²

A1450 Demolition of Existing STSTW

Plant	Percentage of Usage (%)	Plan Size			Area in term of Time of Usage (m ²)
		B (m)	L (m)	No. of Item	
Excavator	100%	3.2	8	20	512
Excavator with rock breakers	100%	3.2	8	40	1024
Dump Truck	100%	2.4	10	40	960
Air compressor	100%	-	-	20	-
Generator	100%	-	-	20	-
Lorry	100%	2.4	10	20	480
Mobile Crane	100%	2.6	10	10	260
Cutter	100%	-	-	20	-
Pneumatic Breaker	100%	-	-	40	-
A1450		Total:			3236
		Percentage of Usage Area to Works Area:			1.2%

As a worst case assumption, all construction activities are assumed to be carried out at the same time

Total Percentage of Usage Area to Works Area for CSTS	1.2%
Percentage adopted in Dust model for Short-term Assessment	20%
Percentage adopted in Dust model for Annual Assessment	10%

Appendix 3.02e Demolition of Existing STSTW - Calculation of Dust Emission Source
Dust Emission Source Listing in FDM
Demolition of STSTW (Unmitigated Scenario)

Source	Type	X1	Y1	X2	Y2	Height (m)	Width / Angle	Working Hour	TSP Emission Rate (g/m ² -s)				RSP Emission Rate (g/m ² -s)				FSP Emission Rate (g/m ² -s)					
									Short-term Assessment (Tier 1)		Short-term Assessment		Annual Assessment		Short-term Assessment		Annual Assessment		Short-term Assessment		Annual Assessment	
									Working hours	Non-working hours	Working hours	Non-working hours	Working hours	Non-working hours	Working hours	Non-working hours	Working hours	Non-working hours	Working hours	Non-working hours	Working hours	Non-working hours
1	Area	840198.54	830056.88	12.06	7.62	0.5	48.72	07.00 - 19.00	2.076E-04	2.695E-06	9.818E-05	1.275E-06	9.818E-06	1.275E-07	1.494E-05	1.941E-07	1.494E-06	1.941E-08				
2	Area	840226.99	830034.92	7.59	35.87	0.5	48.72	07.00 - 19.00	2.076E-04	2.695E-06	9.818E-05	1.275E-06	9.818E-06	1.275E-07	1.494E-05	1.941E-07	1.494E-06	1.941E-08				
3	Area	840208.18	830051.38	7.51	14.12	0.5	48.72	07.00 - 19.00	2.076E-04	2.695E-06	9.818E-05	1.275E-06	9.818E-06	1.275E-07	1.494E-05	1.941E-07	1.494E-06	1.941E-08				
4	Area	840187.05	830043.81	22.75	7.64	0.5	48.72	07.00 - 19.00	2.076E-04	2.695E-06	9.818E-05	1.275E-06	9.818E-06	1.275E-07	1.494E-05	1.941E-07	1.494E-06	1.941E-08				
5	Area	840253.94	830011.26	7.59	35.87	0.5	48.72	07.00 - 19.00	2.076E-04	2.695E-06	9.818E-05	1.275E-06	9.818E-06	1.275E-07	1.494E-05	1.941E-07	1.494E-06	1.941E-08				
6	Area	840172.04	830026.72	22.75	7.64	0.5	48.72	07.00 - 19.00	2.076E-04	2.695E-06	9.818E-05	1.275E-06	9.818E-06	1.275E-07	1.494E-05	1.941E-07	1.494E-06	1.941E-08				
7	Area	840202.68	830011.95	50	50	0.5	48.72	07.00 - 19.00	2.076E-04	2.695E-06	9.818E-05	1.275E-06	9.818E-06	1.275E-07	1.494E-05	1.941E-07	1.494E-06	1.941E-08				
8	Area	840113.25	830014.76	27.21	19.58	0.5	48.72	07.00 - 19.00	2.076E-04	2.695E-06	9.818E-05	1.275E-06	9.818E-06	1.275E-07	1.494E-05	1.941E-07	1.494E-06	1.941E-08				
9	Area	840028.8	830011.58	17.95	15.79	0.5	48.72	07.00 - 19.00	2.076E-04	2.695E-06	9.818E-05	1.275E-06	9.818E-06	1.275E-07	1.494E-05	1.941E-07	1.494E-06	1.941E-08				
10	Area	840157.02	830009.63	22.75	7.64	0.5	48.72	07.00 - 19.00	2.076E-04	2.695E-06	9.818E-05	1.275E-06	9.818E-06	1.275E-07	1.494E-05	1.941E-07	1.494E-06	1.941E-08				
11	Area	840280.89	829987.6	7.59	35.87	0.5	48.72	07.00 - 19.00	2.076E-04	2.695E-06	9.818E-05	1.275E-06	9.818E-06	1.275E-07	1.494E-05	1.941E-07	1.494E-06	1.941E-08				
12	Area	840127.97	830001.84	27.21	19.58	0.5	48.72	07.00 - 19.00	2.076E-04	2.695E-06	9.818E-05	1.275E-06	9.818E-06	1.275E-07	1.494E-05	1.941E-07	1.494E-06	1.941E-08				
13	Area	840042.7	829998.69	25.32	22.1	0.5	48.72	07.00 - 19.00	2.076E-04	2.695E-06	9.818E-05	1.275E-06	9.818E-06	1.275E-07	1.494E-05	1.941E-07	1.494E-06	1.941E-08				
14	Area	840013.15	829993.78	29.43	15.88	0.5	48.72	07.00 - 19.00	2.076E-04	2.695E-06	9.818E-05	1.275E-06	9.818E-06	1.275E-07	1.494E-05	1.941E-07	1.494E-06	1.941E-08				
15	Area	840139.37	829991.86	27.25	10.72	0.5	48.72	07.00 - 19.00	2.076E-04	2.695E-06	9.818E-05	1.275E-06	9.818E-06	1.275E-07	1.494E-05	1.941E-07	1.494E-06	1.941E-08				
16	Area	840061.6	829987.21	17.64	21.46	0.5	48.72	07.00 - 19.00	2.076E-04	2.695E-06	9.818E-05	1.275E-06	9.818E-06	1.275E-07	1.494E-05	1.941E-07	1.494E-06	1.941E-08				
17	Area	840303.15	829967.79	7.2	23.72	0.5	48.72	07.00 - 19.00	2.076E-04	2.695E-06	9.818E-05	1.275E-06	9.818E-06	1.275E-07	1.494E-05	1.941E-07	1.494E-06	1.941E-08				
18	Area	840240.25	829984.96	50	50	0.5	48.72	07.00 - 19.00	2.076E-04	2.695E-06	9.818E-05	1.275E-06	9.818E-06	1.275E-07	1.494E-05	1.941E-07	1.494E-06	1.941E-08				
19	Area	840169.69	829980.38	50	50	0.5	48.72	07.00 - 19.00	2.076E-04	2.695E-06	9.818E-05	1.275E-06	9.818E-06	1.275E-07	1.494E-05	1.941E-07	1.494E-06	1.941E-08				
20	Area	840024.87	829978.38	28.73	22.1	0.5	48.72	07.00 - 19.00	2.076E-04	2.695E-06	9.818E-05	1.275E-06	9.818E-06	1.275E-07	1.494E-05	1.941E-07	1.494E-06	1.941E-08				
21	Area	840099.13	829975.79	50	50	0.5	48.72	07.00 - 19.00	2.076E-04	2.695E-06	9.818E-05	1.275E-06	9.818E-06	1.275E-07	1.494E-05	1.941E-07	1.494E-06	1.941E-08				
22	Area	839993.74	829971.66	29.43	15.88	0.5	48.72	07.00 - 19.00	2.076E-04	2.695E-06	9.818E-05	1.275E-06	9.818E-06	1.275E-07	1.494E-05	1.941E-07	1.494E-06	1.941E-08				
23	Area	840041.58	829959.53	50.28	27.9	0.5	48.72	07.00 - 19.00	2.076E-04	2.695E-06	9.818E-05	1.275E-06	9.818E-06	1.275E-07	1.494E-05	1.941E-07	1.494E-06	1.941E-08				
24	Area	840005.91	829956.79	28.73	22.1	0.5	48.72	07.00 - 19.00	2.076E-04	2.695E-06	9.818E-05	1.275E-06	9.818E-06	1.275E-07	1.494E-05	1.941E-07	1.494E-06	1.941E-08				
25	Area	839974.33	829949.54	29.43	15.88	0.5	48.72	07.00 - 19.00	2.076E-04	2.695E-06	9.818E-05	1.275E-06	9.818E-06	1.275E-07	1.494E-05	1.941E-07	1.494E-06	1.941E-08				
26	Area	840324.9	829948.7	7.2	33.71	0.5	48.72	07.00 - 19.00	2.076E-04	2.695E-06	9.818E-05	1.275E-06	9.818E-06	1.275E-07	1.494E-05	1.941E-07	1.494E-06	1.941E-08				
27	Area	840207.26	829947.39	50	50	0.5	48.72	07.00 - 19.00	2.076E-04	2.695E-06	9.818E-05	1.275E-06	9.818E-06	1.275E-07	1.494E-05	1.941E-07	1.494E-06	1.941E-08				
28	Area	840136.7	829942.8	50	50	0.5	48.72	07.00 - 19.00	2.076E-04	2.695E-06	9.818E-05	1.275E-06	9.818E-06	1.275E-07	1.494E-05	1.941E-07	1.494E-06	1.941E-08				
29	Area	839986.95	829935.2	28.73	22.1	0.5	48.72	07.00 - 19.00	2.076E-04	2.695E-06	9.818E-05	1.275E-06	9.818E-06	1.275E-07	1.494E-05	1.941E-07	1.494E-06	1.941E-08				
30	Area	839954.87	829927.45	29.43	15.88	0.5	48.72	07.00 - 19.00	2.076E-04	2.695E-06	9.818E-05	1.275E-06	9.818E-06	1.275E-07	1.494E-05	1.941E-07	1.494E-06	1.941E-08				
31	Area	840350.23	829926.45	7.2	33.71	0.5	48.72	07.00 - 19.00	2.076E-04	2.695E-06	9.818E-05	1.275E-06	9.818E-06	1.275E-07	1.494E-05	1.941E-07	1.494E-06	1.941E-08				
32	Area	840008.95	829922.36	48.54	27.9	0.5	48.72	07.00 - 19.01	2.076E-04	2.695E-06	9.818E-05	1.275E-06	9.818E-06	1.275E-07	1.494E-05	1.941E-07	1.494E-06	1.941E-08				
33	Area	839967.99	829913.61	28.73	22.1	0.5	48.72	07.00 - 19.02	2.076E-04	2.695E-06	9.818E-05	1.275E-06	9.818E-06	1.275E-07	1.494E-05	1.941E-07	1.494E-06	1.941E-08				
34	Area	840174.27	829909.81	50	50	0.5	48.72	07.00 - 19.03	2.076E-04	2.695E-06	9.818E-05	1.275E-06	9.818E-06	1.275E-07	1.494E-05	1.941E-07	1.494E-06	1.941E-08				
35	Area	839935.46	829905.33	29.43	15.88	0.5	48.72	07.00 - 19.04	2.076E-04	2.695E-06	9.818E-05	1.275E-06	9.818E-06	1.275E-07	1.494E-05	1.941E-07	1.494E-06	1.941E-08				
36	Area	840375.57	829904.21	7.2	33.71	0.5	48.72	07.00 - 19.05	2.076E-04	2.695E-06	9.818E-05	1.275E-06	9.818E-06	1.275E-07	1.494E-05	1.941E-07	1.494E-06	1.941E-08				
37	Area	840263.62	829897.9	150	100	0.5	48.72	07.00 - 19.06	2.076E-04	2.695E-06	9.818E-05	1.275E-06	9.818E-06	1.275E-07	1.494E-05	1.941E-07	1.494E-06	1.941E-08				
38	Area	839949.04	829892.02	28.73	22.1	0.5	48.72	07.00 - 19.07	2.076E-04	2.695E-06	9.818E-05	1.275E-06	9.818E-06	1.275E-07	1.494E-05	1.941E-07	1.494E-06	1.941E-08				
39	Area	839976.92	829885.89	48.54	27.9	0.5	48.72	07.00 - 19.08	2.076E-04	2.695E-06	9.818E-05	1.275E-06	9.818E-06	1.275E-07	1.494E-05	1.941E-07	1.494E-06	1.941E-08				
40	Area	839916.04	829883.22	29.43	15.88	0.5	48.72	07.00 - 19.09	2.076E-04	2.695E-06	9.818E-05	1.275E-06	9.818E-06	1.275E-07	1.494E-05	1.941E-07	1.494E-06	1.941E-08				
41	Area	840400.9	829881.97	7.2	33.71	0.5	48.72	07.00 - 19.10	2.076E-04	2.695E-06	9.818E-05	1.275E-06	9.818E-06	1.275E-07	1.494E-05	1.941E-07	1.494E-06	1.941E-08				
42	Area	839930.08	829880.42	28.73	22.1	0.5	48.72	07.00 - 19.11	2.076E-04	2.695E-06	9.818E-05	1.275E-06	9.818E-06	1.275E-07	1.494E-05	1.941E-07	1.494E-06	1.941E-08				
43	Area	840423.91	829881.77	7.2	27.52	0.5	48.72	07.00 - 19.12	2.076E-04	2.695E-06	9.818E-05	1.275E-06	9.818E-06	1.275E-07	1.494E-05	1.941E-07	1.494E-06	1.941E-08				
44	Area	839896.62	829881.1	29.43	15.88	0.5	48.72	07.00 - 19.13	2.076E-04	2.695E-06	9.818E-05	1.275E-06	9.818E-06	1.275E-07	1.494E-05	1.941E-07	1.494E-06	1.941E-08				
45	Area	839944.9	829849.41	48.54	27.9	0.5	48.72	07.00 - 19.14	2.076E-04	2.695E-06	9.818E-05	1.275E-06	9.818E-06	1.275E-07	1.494E-05	1.941E-07	1.494E-06	1.941E-08				
46	Area	839911.12	829848.83	28.73	22.1	0.5	48.72	07.00 - 19.15	2.076E-04	2.695E-06	9.818E-05	1.275E-06	9.818E-06	1.275E-07	1.494E-05	1.941E-07	1.494E-06	1.941E-08				
47	Area	839882.13	829844.6	14.49	15.88	0.5	48.72	07.00 - 19.16	2.076E-04	2.695E-06	9.818E-05	1.275E-06	9.818E-06	1.275E-07	1.494E-05	1.941E-07	1.494E-06	1.941E-08				
48	Area	840341.79	829829.27	150	108.05	0.5	48.72	07.00 - 19.17	2.076E-04	2.695E-06	9.818E-05	1.275E-06	9.818E-06	1.275E-07	1.494E-05	1.941E-07	1.494E-06	1.941E-08				
49	Area	839871.65	829828.14	24.06	9.91	0.5	48.72	07.00 - 19.18	2.076E-04	2.695E-06	9.818E-05	1.275E-06	9.818E-06	1.275E-07	1.494E-05	1.941E-07	1.494E-06	1.941E-08				
50	Area	839892.16	829827.24	28.73	22.1	0.5	48.72	07.00 - 19.19	2.076E-04	2.695E-06	9.818E-0											

Appendix 3.02e Demolition of Existing STSTW - Calculation of Dust Emission Source

Dust Emission Source Listing in FDM

Demolition of STSTW (Mitigated Scenario)

Source	Type	X1	Y1	X2	Y2	Height (m)	Width / Angle	Working Hour	TSP Emission Rate (g/m ² -s)			
									Short-term Assessment (Tier 1)		Short-term Assessment (Tier 2)	
									Working hours	Non-working hours	Working hours	Non-working hours
1	Area	840198.54	830056.88	12.06	7.62	0.5	48.72	07:00 - 19:00	2.595E-05	2.695E-06	2.595E-05	2.695E-06
2	Area	840226.99	830034.92	7.59	35.87	0.5	48.72	07:00 - 19:00	2.595E-05	2.695E-06	2.595E-05	2.695E-06
3	Area	840208.18	830051.38	7.51	14.12	0.5	48.72	07:00 - 19:00	2.595E-05	2.695E-06	2.595E-05	2.695E-06
4	Area	840187.05	830043.81	22.75	7.64	0.5	48.72	07:00 - 19:00	2.595E-05	2.695E-06	2.595E-05	2.695E-06
5	Area	840253.94	830011.26	7.59	35.87	0.5	48.72	07:00 - 19:00	2.595E-05	2.695E-06	2.595E-05	2.695E-06
6	Area	840172.04	830026.72	22.75	7.64	0.5	48.72	07:00 - 19:00	2.595E-05	2.695E-06	2.595E-05	2.695E-06
7	Area	840202.68	830017.95	50	50	0.5	48.72	07:00 - 19:00	2.595E-05	2.695E-06	2.595E-05	2.695E-06
8	Area	840113.25	830014.76	27.21	19.58	0.5	48.72	07:00 - 19:00	2.595E-05	2.695E-06	2.595E-05	2.695E-06
9	Area	840028.8	830011.58	17.95	15.79	0.5	48.72	07:00 - 19:00	2.595E-05	2.695E-06	2.595E-05	2.695E-06
10	Area	840157.02	830009.63	22.75	7.64	0.5	48.72	07:00 - 19:00	2.595E-05	2.695E-06	2.595E-05	2.695E-06
11	Area	840280.89	829987.6	7.59	35.87	0.5	48.72	07:00 - 19:00	2.595E-05	2.695E-06	2.595E-05	2.695E-06
12	Area	840127.97	830001.84	27.21	19.58	0.5	48.72	07:00 - 19:00	2.595E-05	2.695E-06	2.595E-05	2.695E-06
13	Area	840042.7	829998.69	25.32	22.1	0.5	48.72	07:00 - 19:00	2.595E-05	2.695E-06	2.595E-05	2.695E-06
14	Area	840013.15	829993.78	29.43	15.88	0.5	48.72	07:00 - 19:00	2.595E-05	2.695E-06	0.000E+00	0.000E+00
15	Area	840139.37	829991.86	27.25	10.72	0.5	48.72	07:00 - 19:00	2.595E-05	2.695E-06	2.595E-05	2.695E-06
16	Area	840061.6	829987.21	17.64	21.46	0.5	48.72	07:00 - 19:00	2.595E-05	2.695E-06	2.595E-05	2.695E-06
17	Area	840303.15	829967.79	7.2	23.72	0.5	48.72	07:00 - 19:00	2.595E-05	2.695E-06	2.595E-05	2.695E-06
18	Area	840240.25	829984.96	50	50	0.5	48.72	07:00 - 19:00	2.595E-05	2.695E-06	2.595E-05	2.695E-06
19	Area	840169.69	829980.38	50	50	0.5	48.72	07:00 - 19:00	2.595E-05	2.695E-06	2.595E-05	2.695E-06
20	Area	840024.87	829978.38	28.73	22.1	0.5	48.72	07:00 - 19:00	2.595E-05	2.695E-06	0.000E+00	0.000E+00
21	Area	840099.13	829975.79	50	50	0.5	48.72	07:00 - 19:00	2.595E-05	2.695E-06	2.595E-05	2.695E-06
22	Area	839993.74	829971.66	29.43	15.88	0.5	48.72	07:00 - 19:00	2.595E-05	2.695E-06	0.000E+00	0.000E+00
23	Area	840041.58	829959.53	50.38	27.9	0.5	48.72	07:00 - 19:00	2.595E-05	2.695E-06	0.000E+00	0.000E+00
24	Area	840005.91	829956.79	28.73	22.1	0.5	48.72	07:00 - 19:00	2.595E-05	2.695E-06	0.000E+00	0.000E+00
25	Area	839974.33	829949.54	29.43	15.88	0.5	48.72	07:00 - 19:00	2.595E-05	2.695E-06	0.000E+00	0.000E+00
26	Area	840324.9	829948.7	7.2	33.71	0.5	48.72	07:00 - 19:00	2.595E-05	2.695E-06	2.595E-05	2.695E-06
27	Area	840207.26	829947.39	50	50	0.5	48.72	07:00 - 19:00	2.595E-05	2.695E-06	2.595E-05	2.695E-06
28	Area	840136.7	829942.8	50	50	0.5	48.72	07:00 - 19:00	2.595E-05	2.695E-06	2.595E-05	2.695E-06
29	Area	839986.95	829935.2	28.73	22.1	0.5	48.72	07:00 - 19:00	2.595E-05	2.695E-06	0.000E+00	0.000E+00
30	Area	839954.87	829927.45	29.43	15.88	0.5	48.72	07:00 - 19:00	2.595E-05	2.695E-06	0.000E+00	0.000E+00
31	Area	840350.23	829926.45	7.2	33.71	0.5	48.72	07:00 - 19:00	2.595E-05	2.695E-06	2.595E-05	2.695E-06
32	Area	840008.95	829922.36	48.54	27.9	0.5	48.72	07:00 - 19:01	2.595E-05	2.695E-06	0.000E+00	0.000E+00
33	Area	839967.99	829913.61	28.73	22.1	0.5	48.72	07:00 - 19:02	2.595E-05	2.695E-06	0.000E+00	0.000E+00
34	Area	840174.27	829909.81	50	50	0.5	48.72	07:00 - 19:03	2.595E-05	2.695E-06	2.595E-05	2.695E-06
35	Area	839935.46	829905.33	29.43	15.88	0.5	48.72	07:00 - 19:04	2.595E-05	2.695E-06	0.000E+00	0.000E+00
36	Area	840375.57	829904.21	7.2	33.71	0.5	48.72	07:00 - 19:05	2.595E-05	2.695E-06	2.595E-05	2.695E-06
37	Area	840263.62	829897.9	150	100	0.5	48.72	07:00 - 19:06	2.595E-05	2.695E-06	2.595E-05	2.695E-06
38	Area	839949.04	829892.02	28.73	22.1	0.5	48.72	07:00 - 19:07	2.595E-05	2.695E-06	0.000E+00	0.000E+00
39	Area	839976.92	829885.89	48.54	27.9	0.5	48.72	07:00 - 19:08	2.595E-05	2.695E-06	0.000E+00	0.000E+00
40	Area	839916.04	829883.22	29.43	15.88	0.5	48.72	07:00 - 19:09	2.595E-05	2.695E-06	0.000E+00	0.000E+00
41	Area	840400.9	829881.97	7.2	33.71	0.5	48.72	07:00 - 19:10	2.595E-05	2.695E-06	2.595E-05	2.695E-06
42	Area	839930.08	829870.42	28.73	22.1	0.5	48.72	07:00 - 19:11	2.595E-05	2.695E-06	0.000E+00	0.000E+00
43	Area	840423.91	829861.77	7.2	27.52	0.5	48.72	07:00 - 19:12	2.595E-05	2.695E-06	2.595E-05	2.695E-06
44	Area	839896.62	829861.1	29.43	15.88	0.5	48.72	07:00 - 19:13	2.595E-05	2.695E-06	0.000E+00	0.000E+00
45	Area	839944.9	829849.41	48.54	27.9	0.5	48.72	07:00 - 19:14	2.595E-05	2.695E-06	0.000E+00	0.000E+00
46	Area	839911.12	829848.83	28.73	22.1	0.5	48.72	07:00 - 19:15	2.595E-05	2.695E-06	0.000E+00	0.000E+00
47	Area	839882.13	829844.6	14.49	15.88	0.5	48.72	07:00 - 19:16	2.595E-05	2.695E-06	0.000E+00	0.000E+00
48	Area	840341.79	829829.27	150	108.05	0.5	48.72	07:00 - 19:17	2.595E-05	2.695E-06	2.595E-05	2.695E-06
49	Area	839871.65	829828.14	24.06	9.91	0.5	48.72	07:00 - 19:18	2.595E-05	2.695E-06	0.000E+00	0.000E+00
50	Area	839892.16	829827.24	28.73	22.1	0.5	48.72	07:00 - 19:19	2.595E-05	2.695E-06	0.000E+00	0.000E+00
51	Area	839912.88	829812.94	48.54	27.9	0.5	48.72	07:00 - 19:20	2.595E-05	2.695E-06	0.000E+00	0.000E+00
52	Area	839873.2	829805.65	28.73	22.1	0.5	48.72	07:00 - 19:21	2.595E-05	2.695E-06	0.000E+00	0.000E+00
53	Area	839854.25	829784.06	28.73	22.1	0.5	48.72	07:00 - 19:22	2.595E-05	2.695E-06	0.000E+00	0.000E+00
54	Area	839880.85	829776.47	48.54	27.9	0.5	48.72	07:00 - 19:23	2.595E-05	2.695E-06	0.000E+00	0.000E+00
55	Area	839835.29	829762.46	28.73	22.1	0.5	48.72	07:00 - 19:24	2.595E-05	2.695E-06	0.000E+00	0.000E+00
56	Area	839816.33	829740.87	28.73	22.1	0.5	48.72	07:00 - 19:25	2.595E-05	2.695E-06	0.000E+00	0.000E+00
57	Area	839848.83	829739.99	48.54	27.9	0.5	48.72	07:00 - 19:26	2.595E-05	2.695E-06	0.000E+00	0.000E+00
58	Area	839797.37	829719.28	28.73	22.1	0.5	48.72	07:00 - 19:27	2.595E-05	2.695E-06	0.000E+00	0.000E+00
59	Area	839816.8	829703.52	48.54	27.9	0.5	48.72	07:00 - 19:28	2.595E-05	2.695E-06	0.000E+00	0.000E+00
60	Area	840074.73	829672.06	438.6	301.25	0.5	48.72	07:00 - 19:29	2.595E-05	2.695E-06	0.000E+00	0.000E+00
61	Area	839778.41	829697.69	28.73	22.1	0.5	48.72	07:00 - 19:30	2.595E-05	2.695E-06	0.000E+00	0.000E+00
62	Area	839759.46	829676.09	28.73	22.1	0.5	48.72	07:00 - 19:31	2.595E-05	2.695E-06	0.000E+00	0.000E+00
63	Area	839784.78	829667.04	48.54	27.9	0.5	48.72	07:00 - 19:32	2.595E-05	2.695E-06	0.000E+00	0.000E+00
64	Area	839743.97	829637.31	50	50	0.5	48.72	07:00 - 19:33	2.595E-05	2.695E-06	0.000E+00	0.000E+00
65	Area	839781.54	829604.32	50	50	0.5	48.72	07:00 - 19:34	2.595E-05	2.695E-06	0.000E+00	0.000E+00
66	Area	839710.98	829599.74	50	50	0.5	48.72	07:00 - 19:35	2.595E-05	2.695E-06	0.000E+00	0.000E+00
67	Area	839819.11	829571.33	50	50	0.5	48.72	07:00 - 19:36	2.595E-05	2.695E-06	0.000E+00	0.000E+00
68	Area	839748.57	829566.77	50	50	0.5	48.72	07:00 - 19:37	2.595E-05	2.695E-06	0.000E+00	0.000E+00
69	Area	839856.75	829538.41	50	50	0.5	48.72	07:00 - 19:38	2.595E-05	2.695E-06	0.000E+00	0.000E+00
70	Area	839786.14	829533.78	50	50	0.5	48.72	07:00 - 19:39	2.595E-05	2.695E-06	0.000E+00	0.000E+00
71	Area	839894.32	829505.42	50	50	0.5	48.72	07:00 - 19:40	2.595E-05	2.695E-06	0.000E+00	0.000E+00
72	Area	839823.76	829500.84	50	50	0.5	48.72	07:00 - 19:41	2.595E-05	2.695E-06	0.000E+00	0.000E+00
73	Area	839931.89	829472.43	50	50	0.5	48.72	07:00 - 19:42	2.595E-05	2.695E-06	0.000E+00	0.000E+00
74	Area	839861.35	829467.87	50	50	0.5	48.72	07:00 - 19:43	2.595E-05	2.695E-06	0.000E+00	0.000E+00
75	Area	839969.51	829439.49	50	50	0.5	48.72	07:00 - 19:44	2.595E-05	2.695E-06	0.000E+00	0.000E+00
76	Area	839898.92	829434.88	50	50	0.5	48.72	07:00 - 19:45	2.595E-05	2.695E-06	0.000E+00	0.000E+00
77	Area	839999.21	829413.39	49.91	29.09	0.5	48.72	07:00 - 19:46	2.595E-05	2.695E-06	0.000E+00	0.000E+00
78	Area	840028.74	829408.23	18.7	22.1	0.5	48.72	07				

Appendix 3.02e Demolition of Existing STSTW - Calculation of Dust Emission Source

Dust Emission Source Listing in FDM

Demolition of STSTW (Mitigated Scenario)

Source	Type	X1	Y1	X2	Y2	Height (m)	Width / Angle	Working Hour	RSP Emission Rate (g/m ² -s)				FSP Emission Rate (g/m ² -s)			
									Short-term Assessment		Annual Assessment		Short-term Assessment		Annual Assessment	
									Working hours	Non-working hours	Working hours	Non-working hours	Working hours	Non-working hours	Working hours	Non-working hours
1	Area	840198.54	830056.88	12.06	7.62	0.5	48.72	07:00 - 19:00	1.227E-05	1.275E-06	1.227E-06	1.275E-07	1.868E-06	1.941E-07	1.868E-07	1.941E-08
2	Area	840226.99	830034.92	7.59	35.87	0.5	48.72	07:00 - 19:00	1.227E-05	1.275E-06	1.227E-06	1.275E-07	1.868E-06	1.941E-07	1.868E-07	1.941E-08
3	Area	840208.18	830051.38	7.51	14.12	0.5	48.72	07:00 - 19:00	1.227E-05	1.275E-06	1.227E-06	1.275E-07	1.868E-06	1.941E-07	1.868E-07	1.941E-08
4	Area	840187.05	830043.81	22.75	7.64	0.5	48.72	07:00 - 19:00	1.227E-05	1.275E-06	1.227E-06	1.275E-07	1.868E-06	1.941E-07	1.868E-07	1.941E-08
5	Area	840253.94	830011.26	7.59	35.87	0.5	48.72	07:00 - 19:00	1.227E-05	1.275E-06	1.227E-06	1.275E-07	1.868E-06	1.941E-07	1.868E-07	1.941E-08
6	Area	840172.04	830026.72	22.75	7.64	0.5	48.72	07:00 - 19:00	1.227E-05	1.275E-06	1.227E-06	1.275E-07	1.868E-06	1.941E-07	1.868E-07	1.941E-08
7	Area	840202.68	830017.95	50	50	0.5	48.72	07:00 - 19:00	1.227E-05	1.275E-06	1.227E-06	1.275E-07	1.868E-06	1.941E-07	1.868E-07	1.941E-08
8	Area	840113.25	830014.76	27.21	19.58	0.5	48.72	07:00 - 19:00	1.227E-05	1.275E-06	1.227E-06	1.275E-07	1.868E-06	1.941E-07	1.868E-07	1.941E-08
9	Area	840028.8	830011.58	17.95	15.79	0.5	48.72	07:00 - 19:00	1.227E-05	1.275E-06	1.227E-06	1.275E-07	1.868E-06	1.941E-07	1.868E-07	1.941E-08
10	Area	840157.02	830009.63	22.75	7.64	0.5	48.72	07:00 - 19:00	1.227E-05	1.275E-06	1.227E-06	1.275E-07	1.868E-06	1.941E-07	1.868E-07	1.941E-08
11	Area	840280.89	829987.6	7.59	35.87	0.5	48.72	07:00 - 19:00	1.227E-05	1.275E-06	1.227E-06	1.275E-07	1.868E-06	1.941E-07	1.868E-07	1.941E-08
12	Area	840127.97	830001.84	27.21	19.58	0.5	48.72	07:00 - 19:00	1.227E-05	1.275E-06	1.227E-06	1.275E-07	1.868E-06	1.941E-07	1.868E-07	1.941E-08
13	Area	840042.7	829998.69	25.32	22.1	0.5	48.72	07:00 - 19:00	1.227E-05	1.275E-06	1.227E-06	1.275E-07	1.868E-06	1.941E-07	1.868E-07	1.941E-08
14	Area	840013.15	829993.78	29.43	15.88	0.5	48.72	07:00 - 19:00	1.227E-05	1.275E-06	1.227E-06	1.275E-07	1.868E-06	1.941E-07	1.868E-07	1.941E-08
15	Area	840139.37	829991.86	27.25	10.72	0.5	48.72	07:00 - 19:00	1.227E-05	1.275E-06	1.227E-06	1.275E-07	1.868E-06	1.941E-07	1.868E-07	1.941E-08
16	Area	840061.6	829987.21	17.64	21.46	0.5	48.72	07:00 - 19:00	1.227E-05	1.275E-06	1.227E-06	1.275E-07	1.868E-06	1.941E-07	1.868E-07	1.941E-08
17	Area	840303.15	829967.79	7.2	23.72	0.5	48.72	07:00 - 19:00	1.227E-05	1.275E-06	1.227E-06	1.275E-07	1.868E-06	1.941E-07	1.868E-07	1.941E-08
18	Area	840240.25	829984.96	50	50	0.5	48.72	07:00 - 19:00	1.227E-05	1.275E-06	1.227E-06	1.275E-07	1.868E-06	1.941E-07	1.868E-07	1.941E-08
19	Area	840169.69	829980.38	50	50	0.5	48.72	07:00 - 19:00	1.227E-05	1.275E-06	1.227E-06	1.275E-07	1.868E-06	1.941E-07	1.868E-07	1.941E-08
20	Area	840024.87	829978.38	28.73	22.1	0.5	48.72	07:00 - 19:00	1.227E-05	1.275E-06	1.227E-06	1.275E-07	1.868E-06	1.941E-07	1.868E-07	1.941E-08
21	Area	840099.13	829975.79	50	50	0.5	48.72	07:00 - 19:00	1.227E-05	1.275E-06	1.227E-06	1.275E-07	1.868E-06	1.941E-07	1.868E-07	1.941E-08
22	Area	839993.74	829971.66	29.43	15.88	0.5	48.72	07:00 - 19:00	1.227E-05	1.275E-06	1.227E-06	1.275E-07	1.868E-06	1.941E-07	1.868E-07	1.941E-08
23	Area	840041.58	829959.53	50.38	27.9	0.5	48.72	07:00 - 19:00	1.227E-05	1.275E-06	1.227E-06	1.275E-07	1.868E-06	1.941E-07	1.868E-07	1.941E-08
24	Area	840005.91	829956.79	28.73	22.1	0.5	48.72	07:00 - 19:00	1.227E-05	1.275E-06	1.227E-06	1.275E-07	1.868E-06	1.941E-07	1.868E-07	1.941E-08
25	Area	839974.33	829949.54	29.43	15.88	0.5	48.72	07:00 - 19:00	1.227E-05	1.275E-06	1.227E-06	1.275E-07	1.868E-06	1.941E-07	1.868E-07	1.941E-08
26	Area	840324.9	829948.7	7.2	33.71	0.5	48.72	07:00 - 19:00	1.227E-05	1.275E-06	1.227E-06	1.275E-07	1.868E-06	1.941E-07	1.868E-07	1.941E-08
27	Area	840207.26	829947.39	50	50	0.5	48.72	07:00 - 19:00	1.227E-05	1.275E-06	1.227E-06	1.275E-07	1.868E-06	1.941E-07	1.868E-07	1.941E-08
28	Area	840136.7	829942.8	50	50	0.5	48.72	07:00 - 19:00	1.227E-05	1.275E-06	1.227E-06	1.275E-07	1.868E-06	1.941E-07	1.868E-07	1.941E-08
29	Area	839986.95	829935.2	28.73	22.1	0.5	48.72	07:00 - 19:00	1.227E-05	1.275E-06	1.227E-06	1.275E-07	1.868E-06	1.941E-07	1.868E-07	1.941E-08
30	Area	839954.87	829927.45	29.43	15.88	0.5	48.72	07:00 - 19:00	1.227E-05	1.275E-06	1.227E-06	1.275E-07	1.868E-06	1.941E-07	1.868E-07	1.941E-08
31	Area	840350.23	829926.45	7.2	33.71	0.5	48.72	07:00 - 19:00	1.227E-05	1.275E-06	1.227E-06	1.275E-07	1.868E-06	1.941E-07	1.868E-07	1.941E-08
32	Area	840008.95	829922.36	48.54	27.9	0.5	48.72	07:00 - 19:01	1.227E-05	1.275E-06	1.227E-06	1.275E-07	1.868E-06	1.941E-07	1.868E-07	1.941E-08
33	Area	839967.99	829913.61	28.73	22.1	0.5	48.72	07:00 - 19:02	1.227E-05	1.275E-06	1.227E-06	1.275E-07	1.868E-06	1.941E-07	1.868E-07	1.941E-08
34	Area	840174.27	829909.81	50	50	0.5	48.72	07:00 - 19:03	1.227E-05	1.275E-06	1.227E-06	1.275E-07	1.868E-06	1.941E-07	1.868E-07	1.941E-08
35	Area	839935.46	829905.33	29.43	15.88	0.5	48.72	07:00 - 19:04	1.227E-05	1.275E-06	1.227E-06	1.275E-07	1.868E-06	1.941E-07	1.868E-07	1.941E-08
36	Area	840375.57	829904.21	7.2	33.71	0.5	48.72	07:00 - 19:05	1.227E-05	1.275E-06	1.227E-06	1.275E-07	1.868E-06	1.941E-07	1.868E-07	1.941E-08
37	Area	840263.62	829897.9	150	100	0.5	48.72	07:00 - 19:06	1.227E-05	1.275E-06	1.227E-06	1.275E-07	1.868E-06	1.941E-07	1.868E-07	1.941E-08
38	Area	839949.04	829892.02	28.73	22.1	0.5	48.72	07:00 - 19:07	1.227E-05	1.275E-06	1.227E-06	1.275E-07	1.868E-06	1.941E-07	1.868E-07	1.941E-08
39	Area	839976.92	829885.89	48.54	27.9	0.5	48.72	07:00 - 19:08	1.227E-05	1.275E-06	1.227E-06	1.275E-07	1.868E-06	1.941E-07	1.868E-07	1.941E-08
40	Area	839916.04	829883.22	29.43	15.88	0.5	48.72	07:00 - 19:09	1.227E-05	1.275E-06	1.227E-06	1.275E-07	1.868E-06	1.941E-07	1.868E-07	1.941E-08
41	Area	840400.9	829881.97	7.2	33.71	0.5	48.72	07:00 - 19:10	1.227E-05	1.275E-06	1.227E-06	1.275E-07	1.868E-06	1.941E-07	1.868E-07	1.941E-08
42	Area	839930.08	829870.42	28.73	22.1	0.5	48.72	07:00 - 19:11	1.227E-05	1.275E-06	1.227E-06	1.275E-07	1.868E-06	1.941E-07	1.868E-07	1.941E-08
43	Area	840423.91	829861.77	7.2	27.52	0.5	48.72	07:00 - 19:12	1.227E-05	1.275E-06	1.227E-06	1.275E-07	1.868E-06	1.941E-07	1.868E-07	1.941E-08
44	Area	839896.62	829861.1	29.43	15.88	0.5	48.72	07:00 - 19:13	1.227E-05	1.275E-06	1.227E-06	1.275E-07	1.868E-06	1.941E-07	1.868E-07	1.941E-08
45	Area	839944.9	829849.41	48.54	27.9	0.5	48.72	07:00 - 19:14	1.227E-05	1.275E-06	1.227E-06	1.275E-07	1.868E-06	1.941E-07	1.868E-07	1.941E-08
46	Area	839911.12	829848.83	28.73	22.1	0.5	48.72	07:00 - 19:15	1.227E-05	1.275E-06	1.227E-06	1.275E-07	1.868E-06	1.941E-07	1.868E-07	1.941E-08
47	Area	839882.13	829844.6	14.49	15.88	0.5	48.72	07:00 - 19:16	1.227E-05	1.275E-06	1.227E-06	1.275E-07	1.868E-06	1.941E-07	1.868E-07	1.941E-08
48	Area	840341.79	829829.27	150	108.05	0.5	48.72	07:00 - 19:17	1.227E-05	1.275E-06	1.227E-06	1.275E-07	1.868E-06	1.941E-07	1.868E-07	1.941E-08
49	Area	839871.65	829828.14	24.06	9.91	0.5	48.72	07:00 - 19:18	1.227E-05	1.275E-06	1.227E-06	1.275E-07	1.868E-06	1.941E-07	1.868E-07	1.941E-08
50	Area	839892.16	829827.24	28.73	22.1	0.5	48.72	07:00 - 19:19	1.227E-05	1.275E-06	1.227E-06	1.275E-07	1.868E-06	1.941E-07	1.868E-07	1.941E-08
51	Area	839912.88	829812.94	48.54	27.9	0.5	48.72	07:00 - 19:20	1.227E-05	1.275E-06	1.227E-06	1.275E-07	1.868E-06	1.941E-07	1.868E-07	1.941E-08
52	Area	839873.2	829805.65	28.73	22.1	0.5	48.72	07:00 - 19:21	1.227E-05	1.275E-06	1.227E-06	1.275E-07	1.868E-06	1.941E-07	1.868E-07	1.941E-08
53	Area	839854.25	829784.06	28.73	22.1	0.5	48.72	07:00 - 19:22	1.227E-05	1.275E-06	1.227E-06	1.275E-07	1.868E-06	1.941E-07	1.868E-07	1.941E-08
54	Area	839880.85	829776.47	48.54	27.9	0.5	48.72	07:00 - 19:23	1.227E-05	1.275E-06	1.227E-06	1.275E-07	1.868E-06	1.941E-07	1.868E-07	1.941E-08
55	Area	839835.29	829762.46	28.73	22.1	0.5	48.72	07:00 - 19:24	1.227E-05	1.275E-06	1.227E-06	1.275E-07	1.868E-06	1.941E-07	1.868E-07	1.941E-08
56	Area	839816.33	829740.87	28.73	22.1	0.5	48.72	07:00 - 19:25	1.227E-05	1.275E-06	1.227E-06	1.275E-07	1.868E-06	1.941E-07	1.868E-07	1.941E-08
57	Area	839848.83	829739.99	48.54	27.9	0.5	48.72	07:00								

Pd File by: PENGMW 20160221
 PATH: P:\p\g\c\6034056\DRAWING\REPORT\EA\EA_336.dgn
 ISO A1 594mm x 841mm
 Approved: _____
 Checked: _____
 Designer: _____
 Project Management Initials: _____

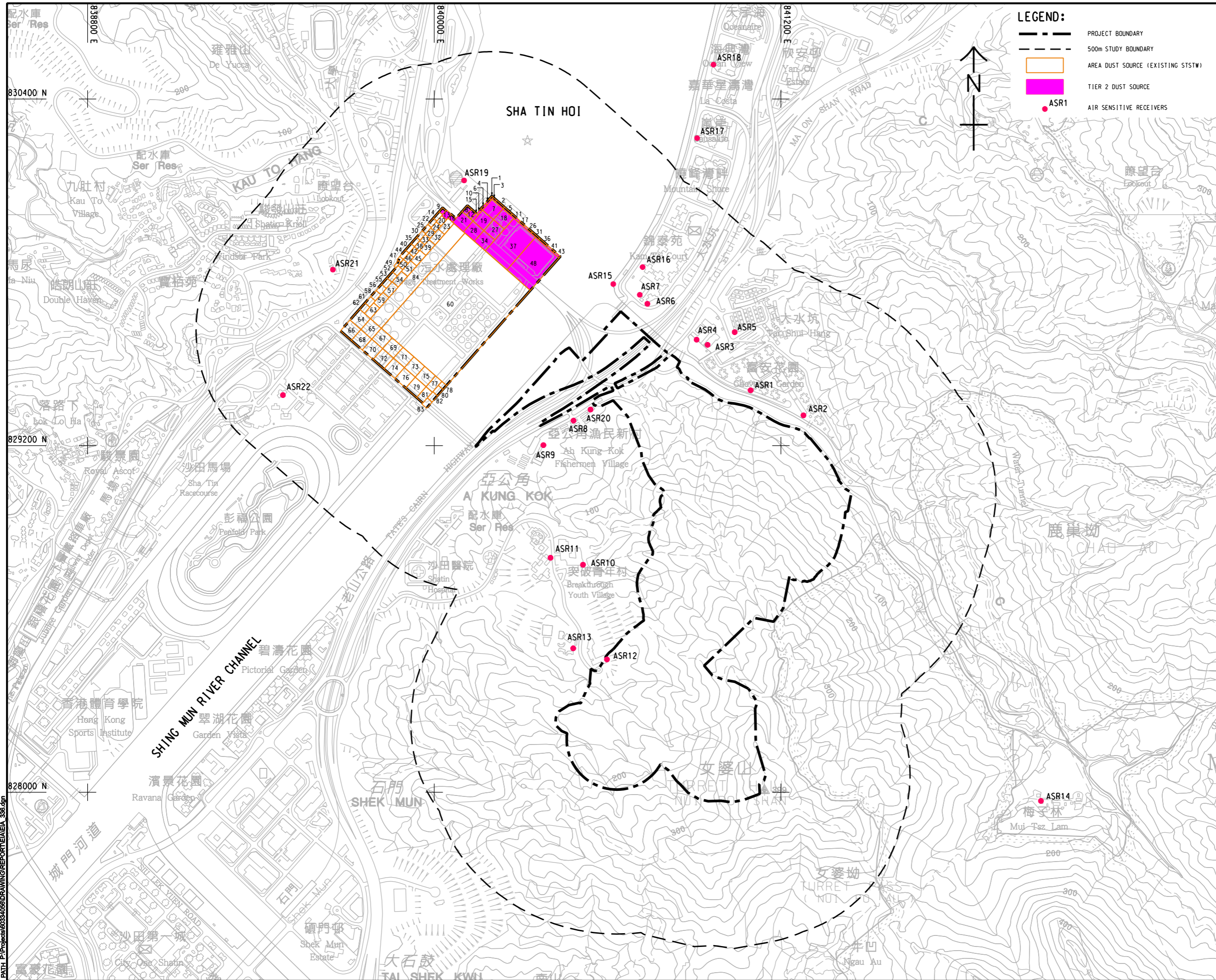

LEGEND:

- PROJECT BOUNDARY
- 500m STUDY BOUNDARY
- AREA DUST SOURCE (EXISTING STSTW)
- TIER 2 DUST SOURCE
- ASR1
- AIR SENSITIVE RECEIVERS

AECOM

PROJECT
 項目
RELOCATION OF SHA TIN SEWAGE TREATMENT WORKS TO CAVERNS: CAVERNS AND SEWAGE TREATMENT WORKS - INVESTIGATION, DESIGN AND CONSTRUCTION

CLIENT
 業主
 渠務署
 Drainage Services Department

CONSULTANT
 工程顧問公司
 AECOM Asia Company Ltd.
 www.aecom.com

SUB-CONSULTANTS
 分判工程顧問公司

ISSUE/REVISION
 修訂

NO.	DATE	DESCRIPTION	CHK.
A	JAN. 16	EIA	
-	SEP. 15	EIA (DRAFT)	

STATUS
 階段

SCALE
 比例
 A3 1: 12000

DIMENSION UNIT
 尺寸單位
 METRES

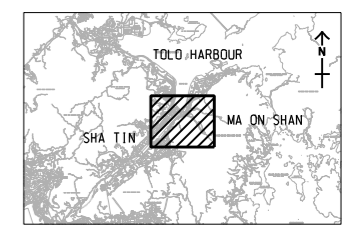

PROJECT NO.
 項目編號
 60334056

CONTRACT NO.
 合約編號
 CE 30/2014 (DS)

SHEET TITLE
 圖紙名稱
 LOCATION OF CONSTRUCTION DUST EMISSION SOURCE (DEMOLITION OF EXISTING STSTW)

SHEET NUMBER
 圖紙編號
 60334056/EIA/3.36A

This drawing has been prepared for the use of AECOM's client. It may not be used, modified, reproduced or relied upon by third parties, except as approved by AECOM or as required by law. AECOM accepts no responsibility, and denies any liability whatsoever, to any party that uses or relies on this drawing without AECOM's express written consent. Do not scale this document. All measurements must be obtained from the stated dimensions.