







Summary of Composite Vehicular Emission Factors for CALINE4

Open Road 24 hour FSP Emission and Traffic Profile

Table with columns for District, Link No., Source ID, Road Type, X-Start, Y-Start, X-End, Y-End, Height, Width, Length, and Hourly Emission factors (Hour 01 to Hour 24) for various pollutants.



Summary of Composite Vehicular Emission Factors for CALINE4

Open Road 24 hour RSP Emission and Traffic Profile

Table with columns: District, Link No., Source ID, Road Type, X-Start, Y-Start, X-End, Y-End, Height, Width, Length, Hour 01-24 Emission factors (Flow, Emission), Hour 25-48 Emission factors (Flow, Emission). The table contains a dense grid of numerical data for each road segment.

Appendix 3.04 Calculation of Vehicular Emission Source

Year 2022 (Construction of CSTS)

Summary of Composite Vehicular Emission Factors for CALINE4

Open Road 24 hour RSP Emission and Traffic Profile

Table with columns: District, Link No, Source ID, Road Type, X-Start, Y-Start, X-End, Y-End, Height, Width, Length, and 24 columns for Hour 01 to Hour 24, each containing Flow and Emf values.

ISO A1 594mm x 841mm  
 Approved:  
 Checked:  
 Designer:  
 Project Management Initials:  
 Pld File by: ZENGFX, 2016/02/19  
 PATH: E:\Project\60334056\Drawing\epc\taieia\_337.dgn

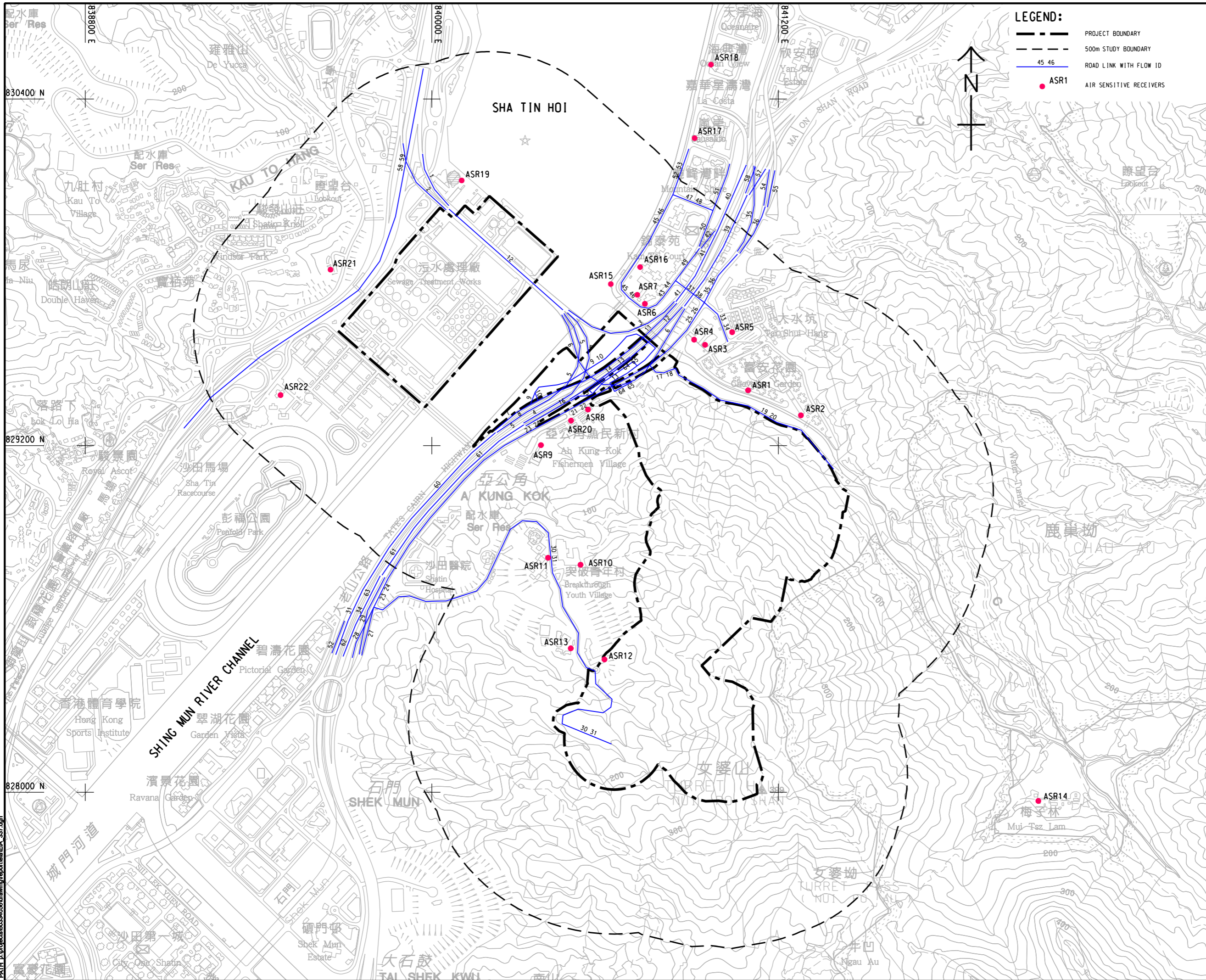

**LEGEND:**

- PROJECT BOUNDARY
- 500m STUDY BOUNDARY
- 45 46 ROAD LINK WITH FLOW ID
- ASR1 AIR SENSITIVE RECEIVERS

**AECOM**

**PROJECT**  
 項目  
**RELOCATION OF SHA TIN SEWAGE TREATMENT WORKS TO CAVERNS: CAVERNS AND SEWAGE TREATMENT WORKS - INVESTIGATION, DESIGN AND CONSTRUCTION**

**CLIENT**  
 業主  
**渠務署**  
 Drainage Services Department

**CONSULTANT**  
 工程顧問公司  
 AECOM Asia Company Ltd.  
 www.aecom.com

**SUB-CONSULTANTS**  
 分判工程顧問公司

**ISSUE/REVISION**  
 修訂

NO.	DATE	DESCRIPTION	CHK.
A	JAN. 16	EIA	
-	SEP. 15	EIA (DRAFT)	

**STATUS**  
 階段

**SCALE**  
 比例  
 A3 1: 12000

**DIMENSION UNIT**  
 尺寸單位  
 METRES

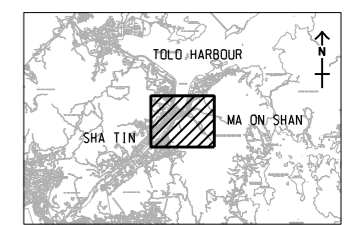

**PROJECT NO.**  
 項目編號  
 60334056

**CONTRACT NO.**  
 合約編號  
 CE 30/2014 (DS)

**SHEET TITLE**  
 圖紙名稱  
 LOCATION OF VEHICULAR EMISSION SOURCE

**SHEET NUMBER**  
 圖紙編號  
 60334056/EIA/3.37A

This drawing has been prepared for the use of AECOM's client. It may not be used, modified, reproduced or relied upon by third parties, except as agreed by AECOM or as required by law. AECOM accepts no responsibility, and denies any liability whatsoever, to any party, for losses or claims on this drawing without AECOM's express written consent. Do not scale this document. All measurements must be obtained from the stated dimensions.









Year 2027 (Demolition of Existing STSTW)

Summary of Composite Vehicular Emission Factors for both CALINE4 and ISC Modelling

Open Road 24 hour FSP Emission and Traffic Profile

District	Link No	Source ID	Road Type	X-Start	Y-Start	X-End	Y-End	Height	Width	Length	Hour 01	Hour 02	Hour 03	Hour 04	Hour 05	Hour 06	Hour 07	Hour 08	Hour 09	Hour 10	Hour 11	Hour 12	Hour 13	Hour 14	Hour 15	Hour 16	Hour 17	Hour 18	Hour 19	Hour 20	Hour 21	Hour 22	Hour 23	Hour 24																								
SHT	11	1	2	840059	830010	840454	829669	10.0	24.0	527.5	2059	0.015	1408	0.015	1080	0.015	927	0.014	804	0.032	932	0.033	2153	0.033	6374	0.031	8010	0.029	6690	0.028	5788	0.033	5416	0.033	5166	0.032	4911	0.038	5241	0.038	5418	0.036	5615	0.031	6142	0.030	6899	0.023	5704	0.020	4199	0.019	3932	0.021	3895	0.015	3140	0.015





