

PdF File by: PENGM 2016/05/26
 PATH: P:\Project\60334056\DRAWING\REPORT\EA/EA_401.dgn
 Project Management Initials: Designer: Checked: Approved: ISO A1 594mm x 841mm

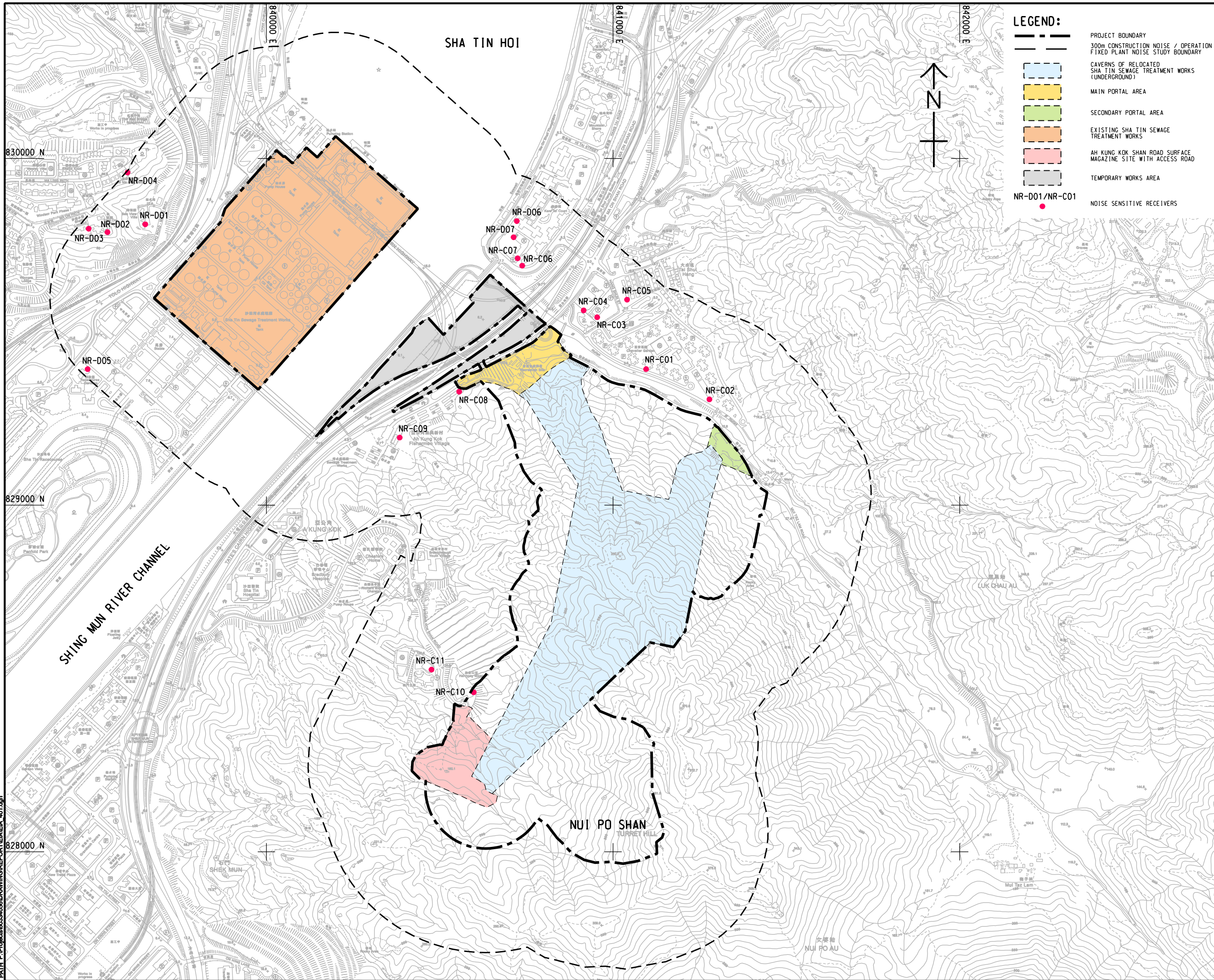

LEGEND:

- PROJECT BOUNDARY
- 300m CONSTRUCTION NOISE / OPERATION FIXED PLANT NOISE STUDY BOUNDARY
- CAVERNS OF RELOCATED SHA TIN SEWAGE TREATMENT WORKS (UNDERGROUND)
- MAIN PORTAL AREA
- SECONDARY PORTAL AREA
- EXISTING SHA TIN SEWAGE TREATMENT WORKS
- AH KUNG KOK SHAN ROAD SURFACE MAGAZINE SITE WITH ACCESS ROAD
- TEMPORARY WORKS AREA
- NR-D01/NR-C01 NOISE SENSITIVE RECEIVERS

AECOM

PROJECT
 項目
RELOCATION OF SHA TIN SEWAGE TREATMENT WORKS TO CAVERNS: CAVERNS AND SEWAGE TREATMENT WORKS - INVESTIGATION, DESIGN AND CONSTRUCTION

CLIENT
 業主
 渠務署
 Drainage Services Department

CONSULTANT
 工程顧問公司
 AECOM Asia Company Ltd.
 www.aecom.com

SUB-CONSULTANTS
 分門工程顧問公司

ISSUE/REVISION
 修訂

IR	DATE	DESCRIPTION	CHK.

STATUS
 階段

SCALE
 比例
 A3 1: 10000

DIMENSION UNIT
 尺寸單位
 METRES

KEY PLAN A3 1: 50000
 索引圖

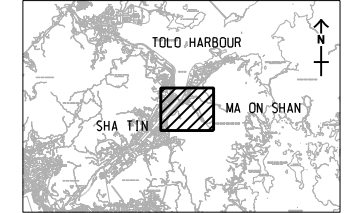

PROJECT NO.
 項目編號
 60334056

CONTRACT NO.
 合約編號
 CE 30/2014 (DS)

SHEET TITLE
 圖號
LOCATIONS OF REPRESENTATIVE NOISE SENSITIVE RECEIVERS FOR CONSTRUCTION NOISE AND OPERATION FIXED PLANT NOISE

SHEET NUMBER
 圖號
 60334056/EIA/4.01

This drawing has been prepared for the use of AECOM's client. It may not be used, modified, reproduced or relied upon by third parties, except as agreed by AECOM or as required by law. AECOM accepts no responsibility, and denies any liability whatsoever, for any party that uses or relies on this drawing without AECOM's express written consent. Do not scale this document. All measurements must be obtained from the stated dimensions.